

**TOWN AND COUNTRY PLANNING ACT 1991**  
**THE REGISTERED BUILDINGS (GENERAL) REGULATIONS 1991**

To: Mr Neville Foot, 2 Athol Buildings, Atholl Place, Peel.

NOTICE IS HEREBY GIVEN that at a meeting held on the 28<sup>th</sup> September, 2001, the PLANNING COMMITTEE of the Department of Local Government and the Environment, in pursuance of its powers under the above Acts and Regulations REGISTERED

**The Old Chapel, former Methodist Chapel, Christian Street, Peel**

as represented by the buildings shown outlined in red on the plan hereto attached, in the PROTECTED BUILDINGS REGISTER by reason of its special architectural and historic interest.

THE EFFECT OF THIS REGISTRATION IS IMMEDIATE and prohibits the alterations or demolition of the structures or appearance of any part of the buildings except in compliance with an obligation imposed by or under any statutory provision or with the prior written consent of the Planning Committee.

Dated this 31<sup>st</sup> day of October, 2001  
By Order of the Committee



**E J Callow**  
**Secretary, Planning Committee**

3<sup>rd</sup> Floor, Murray House  
Mount Havelock  
Douglas

NOTE: Rights to de-registration of the building are provided under the Registered Buildings Regulations and in summary are that:

Application in writing for de-registration may be made by the owner or occupier of, and any other person having an interest in the building, within a period of 28 days of service of this notice. Such



application should be sent to the Secretary, Planning Committee, 3<sup>rd</sup> Floor, Murray House, Mount Havelock, Douglas.

In the event that de-registration is not requested by any party within the 28 day period described above, then de-registration may not be requested within a period of 3 years.

- cc
- 1) Manx National Heritage, Kingswood Grove, Douglas
  - 2) Peel Town Commissioners, Town Hall, Derby Road, Peel
  - 3) The Advisory Council on Planning & the Environment, 52 Alberta Drive, Onchan

A handwritten signature or set of initials, possibly 'G' or 'E', located in the bottom right corner of the page.

Scale 1:500

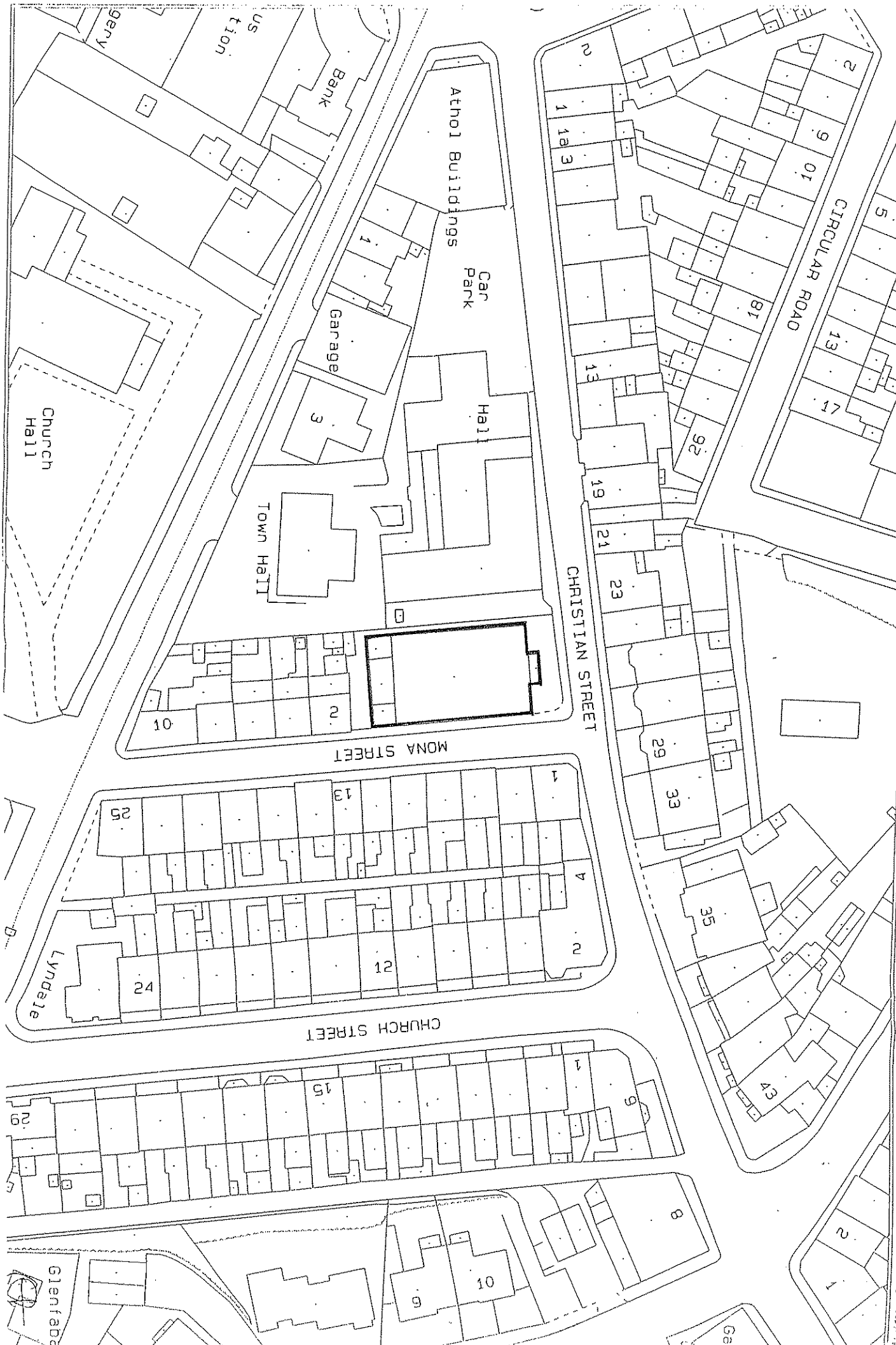

**The Old Chapel,**  
**former Methodist Chapel, Christian Street, Peel**

**Architectural and Historic interest**

The Old Chapel, Christian Street, Peel first opened in 1878 and was then known as the "Primitive Chapel". However, in order to unravel its full history one must regress a further four years to the quarterly meeting of the circuit which gave the Chapel permission "to raise money by all prudent means for the erection of a new chapel" necessitated by sheer overcrowding of the congregation. This initiative is set against the background of religious fervour which led to the great wave of Church and Chapel building found throughout the Island during the reign of Queen Victoria.

The fund raising was led by the Reverend George Smith and some dedicated workers, and not surprisingly, it proved to be a difficult feat in the days when the people "were almost entirely fisher folk, earning a precarious living." When one considers that the Minister's salary was £36 per annum and the Chapel Keeper's only 25/-, more often than not, there would be a balance of two pence reached in the annual financial statement, if it was not, in fact, in the red. However, fund raising efforts were successful with the first third of the £3,000 which it cost to erect the Chapel, coming from small donations given by people "who had not a great deal of this world's goods." The building opened in 1878, lit by candlelight and with seating for 700 people. The final debts for the building however, were not paid off until shortly before the Jubilee in 1928 and the financial struggle to maintain the building continued with collections at the Jubilee services, community hymn singing and other celebrations, raising money for re-roofing the hall and improving the manse.

The church was a place of family worship, with a friendly, welcoming atmosphere where social events were said to be "jolly and organised by a hard working band of church goers." A majority of such organisers were thought to be women. The most well

known events which the church held were the "Easter Effort" which stretched back for over 80 years, as well as the Eisteddfod each winter.

In recent years the fate of the 1870's Church has gone the same as many other Manx Church buildings. With congregational numbers falling, the viability of sustaining so many places of worship in one area, became untenable and on September 1st 1960 the Peel Methodist Churches amalgamated as one. The Christian Street Methodist Church closed its doors in order for the Atholl Street Methodist Church to be re-decorated and to take over as the principal Methodist Church in Peel. Since then, the building has been used as a second hand furniture store which has now closed for business.

## ARCHITECTURE

The exterior of the building remains substantially the same as when it was originally built, save for the removal in recent years, of the front boundary walls, pillars and railings.

The building is simple in its form adopting the oblong, galleried arrangement, typical of Methodist Chapels of this period, with access to the upper galleried level being by way of twin staircases located on either side of the main entrance from Christian Street.

Walls are constructed from local Peel sandstone, of which the front, principal, elevation is rendered in the Neo-Classical style. A similar approach is seen in other large Methodist Churches elsewhere on the Island, as found in Ramsey and Glen Road, Laxey.

The treatment of the main elevation is well ordered and distinguished in appearance. Entrance is by way of a pedimented portico, with corbelled bracket details to the cornice and mouldings to the pediment. A simple frieze is supported on two sets of modified Doric columns, one square and one round in section. Above the Portico is set a large, true arch-headed window, which would have almost stretched the full height of the internal upper level. Other windows on this elevation echo the overall shape of this central window, but are smaller in size and adopt a different approach to the glazing pattern. These windows, together with those on the flank walls would have given a very light and airy quality to the interior of the building.

Two storey, rusticated pilasters give scale to the composition and carry a split cornice, again with corbelled bracket details. Springing from the cornice a simple, inset arch echoes the shape of the central window and above this we find the gable peak expressed above the main roof line and again terminating in a projecting cornice.

One of the most important aspects of this architecturally striking building is found in the rich contribution which it makes to the townscape of Peel and the character of the Conservation Area as a whole. The roof form and upper level of the principal elevation can be clearly seen rising above the more humble vernacular buildings, when viewed from various points around the city of Peel, particularly from the breakwater and from the ramparts of the ancient Castle on St Patrick's Isle.

**The Old Chapel, former Methodist Chapel, Christian Street, Peel is judged worthy of entry into the Protected Buildings Register by virtue of its special architectural and historic interest on the following grounds:-**

1. **Architectural Interest and Aesthetic Quality:** the approach to architectural design, form and scale employed in this building; in particular in relation to the appearance of the principal elevation fronting onto Christian Street, is of sufficient quality to merit protection and recognition;
2. **Historic Interest:** the building has played an important part in the development of Methodism in the Isle of Man, with particular reference to the locality of Peel.
3. **Landmark qualities:** the building makes a striking contribution to the Conservation Area which focuses upon the historic townscape of Peel. The property can be clearly seen from various vantage points, both within and outwith the Conservation Area.



WESTERN SALES  
& STORAGE  
WAREHOUSE & STORAGE UNIT  
RENTALS - OFFICE - SHOW ROOM  
← SHOP ENTRANCE  
TEL. 01223 311111



WESTERN SALES LTD  
SHOP ENTRANCE







HOUSE  
CLEARANCES

IN

3000

OLD AND MODERN  
DISCOUNT FURNITURE  
RENTAL AND MORE

WESTERN SALES

1000 W. 10TH ST. CHICAGO, ILL.  
312.467.1234



WESTON SALES  
& STORAGE  
1000 S. 10th St.  
Wichita, Kansas 67202  
PHONE 274-1234