

Form RB1

Registered Building No. 147

TOWN AND COUNTRY PLANNING ACT 1991

THE REGISTERED BUILDINGS (GENERAL) REGULATIONS 1991

To: Dr. P. J. Astell-Burt
Point of Ayre Lighthouse,
Bride,
Isle of Man.

Northern Lighthouses Board,
84, George Street,
Edinburgh,
EH2 3DA.

NOTICE IS HEREBY GIVEN that at a meeting held on the 15th October 1993, the PLANNING COMMITTEE of the Department of Local Government and the Environment, in pursuance of its powers under the above Acts and Regulations REGISTERED various buildings including and associated with the Point of Ayre Lighthouse in the parish of Bride, as defined in red on the enclosed plan, in the PROTECTED BUILDINGS REGISTER by reason of architectural and historic interest.

THE EFFECT OF THIS REGISTRATION IS IMMEDIATE and prohibits the alteration or demolition of the structure or appearance of any part of the building except in compliance with an obligation imposed by or under any statutory provision or with the prior written consent of the Planning Committee.

Dated this 5th day of November, 1993

By Order of the Committee

D. Killip,
Secretary, Planning Committee.

3rd Floor, Murray House,
Mount Havelock,
Douglas,
Isle of Man.

NOTE: Rights to request de-registration of the building are provided under the Regulations and in summary are that:

Application in writing for de-registration may be made by the owner or occupier of, and any other person having an interest in the buildings within a period of 28 days of service of this notice. Such application should be sent to the Secretary, Planning Committee, 3rd Floor, Murray House, Mount Havelock, Douglas.

Continued

In the event that de-registration is not requested by any party within the 28 day period described above, then de-registration may not be requested within a period of 3 years.

- c.c. 1) Bride Parish Commissioners
2) Manx National Heritage
3) Advisory Council
4) R.B. File 147.

RB 147
POINT OF AYRE LIGHTHOUSE

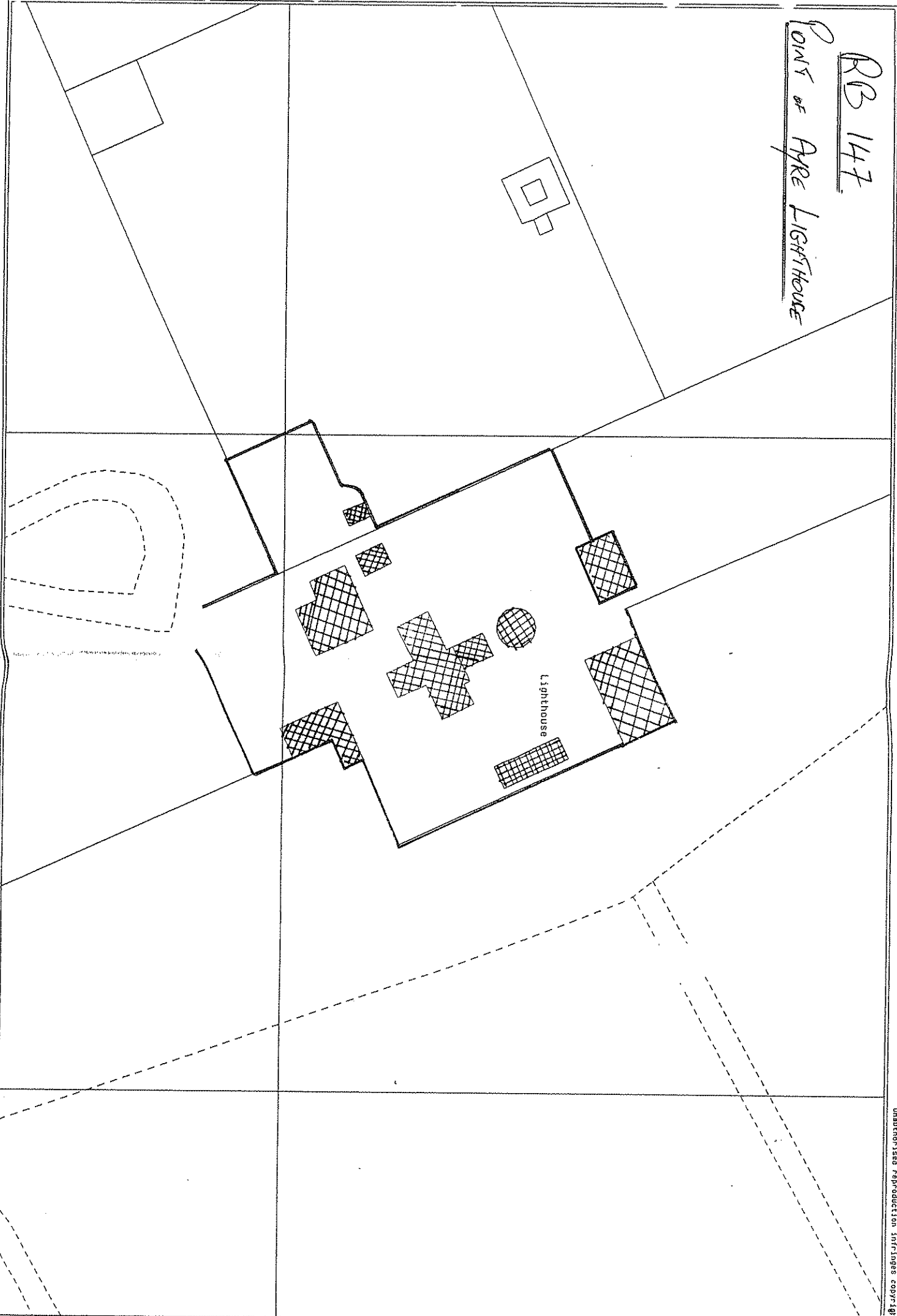

SCALE 1:200