



Isle of Man
Government

Reiltys Ellan Vannin

Isle of Man Labour Market Report January 2021

Economic Affairs

Cabinet Office

February 2021

ISLE OF MAN LABOUR MARKET

JANUARY 2021

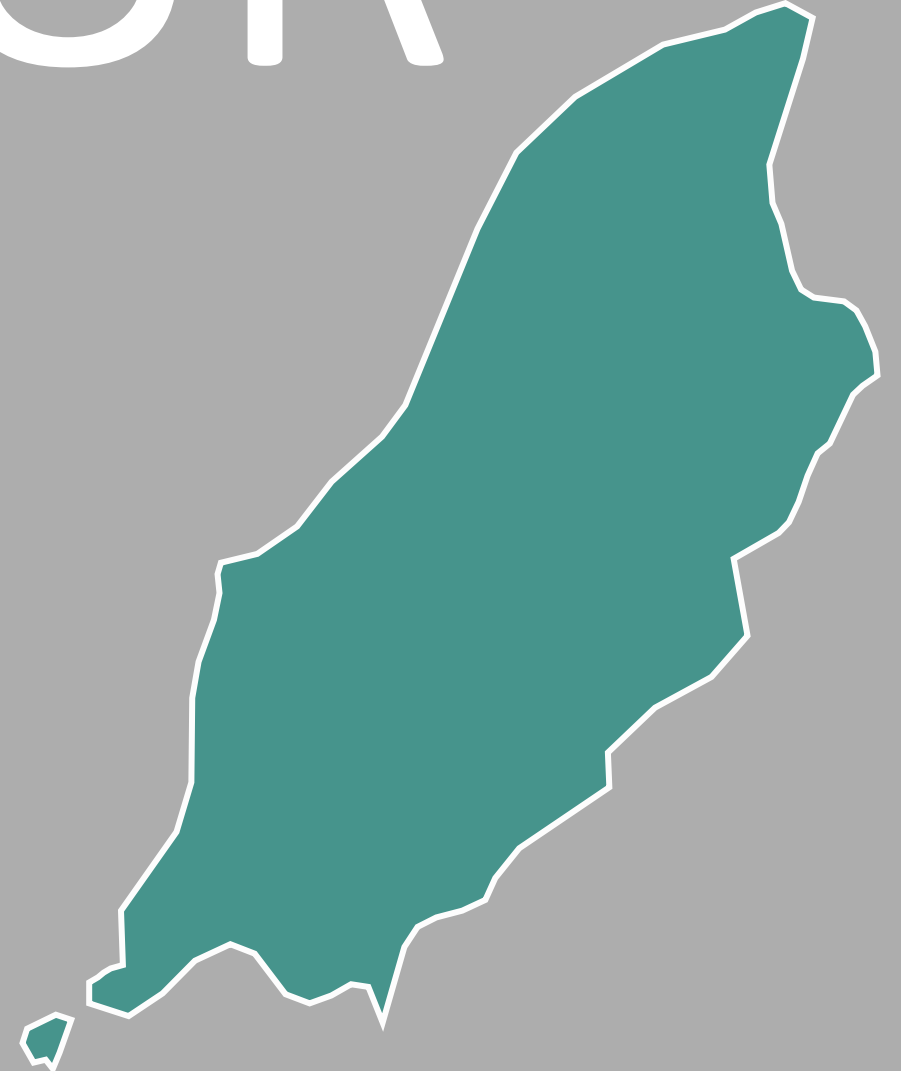

KEY POINTS AS AT THE END OF JANUARY 2021

REGISTERED UNEMPLOYED

1,034

INCREASE IN NUMBER OF REGISTERED UNEMPLOYED

Unemployment has increased by 278 persons from the previous month (December 2020), but has increased by 630 persons compared to the same month last year (January 2020).

UN-EMPLOYMENT RATE

2.4%

UNEMPLOYMENT % RATE

The unemployment rate for January 2021 is 2.4%, which is an increase of 0.6% on the previous month December 2020. The unemployment rate is the proportion of economically active population registered unemployed.

VACANCIES

400

DECREASE IN VACANCIES NOTIFIED TO THE JOB CENTRE

400 job vacancies were notified to the Job Centre in January 2021, a decrease of 125 compared to the last month (December 2020). At the end of the month, 344 remained. Of these, 66% (226) were full time positions and 34% (118) were part time.

ILO ESTIMATE

1,929

INTERNATIONAL LABOUR ORGANISATION ESTIMATE OF UNEMPLOYMENT

It is estimated that 1,929 individuals are unemployed and looking for work in January 2021 compared with 1,201 in December 2020. This amounts to an unemployment rate of 4.5%. See Methodology section for further details.

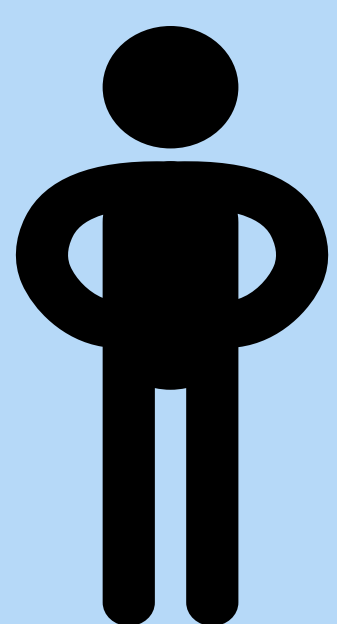

659 Unemployed Males
64%

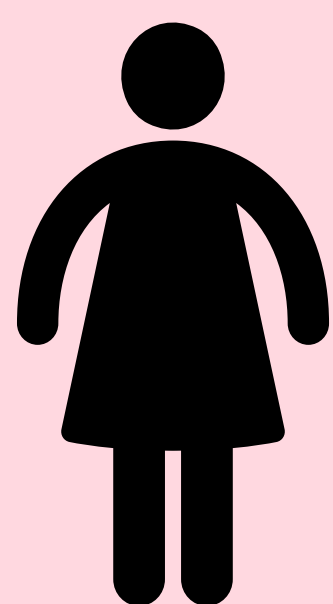

375 Unemployed Females
36%

ISLE OF MAN LABOUR MARKET MARKET JANUARY 2021



SECTORS WITH HIGHEST NUMBERS OF UNEMPLOYED PERSONS - JANUARY 2021

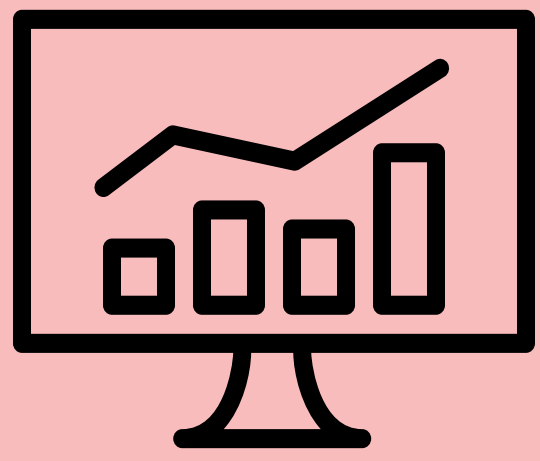

Other Business Services
141

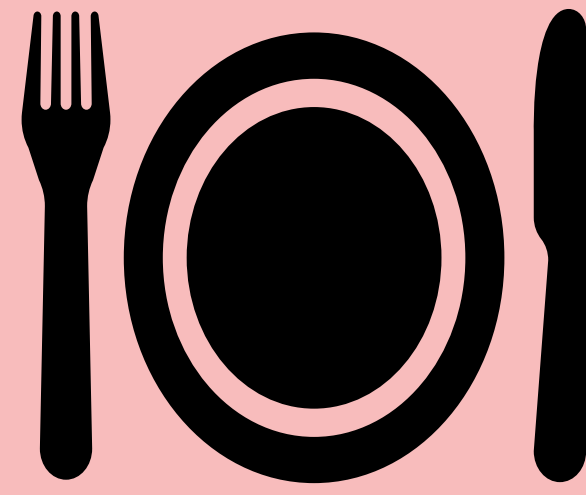

Catering and
Entertainment
88



Retail Distribution
88



Construction-Skilled
93

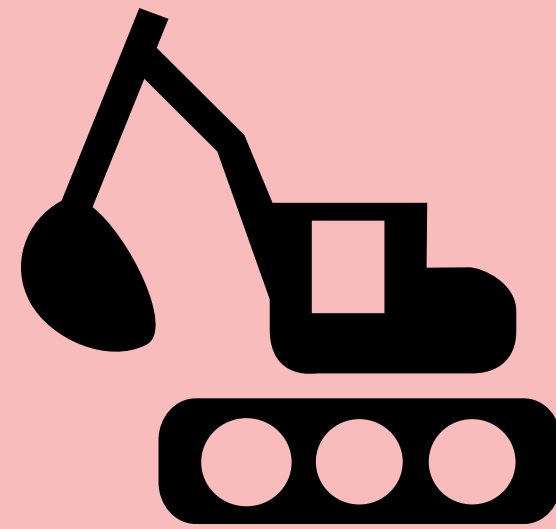

Construction-Unskilled
74

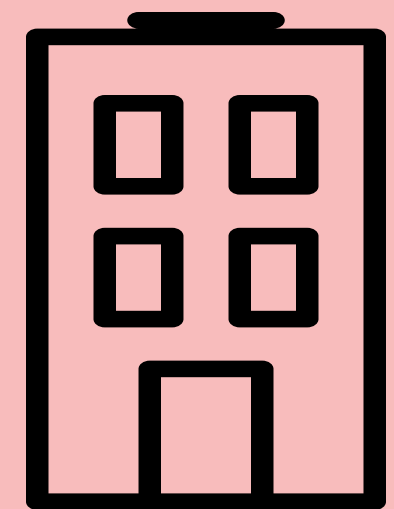

Miscellaneous services
56

SECTORS WITH HIGHEST NUMBERS OF JOB VACANCIES REMAINING - JANUARY 2021

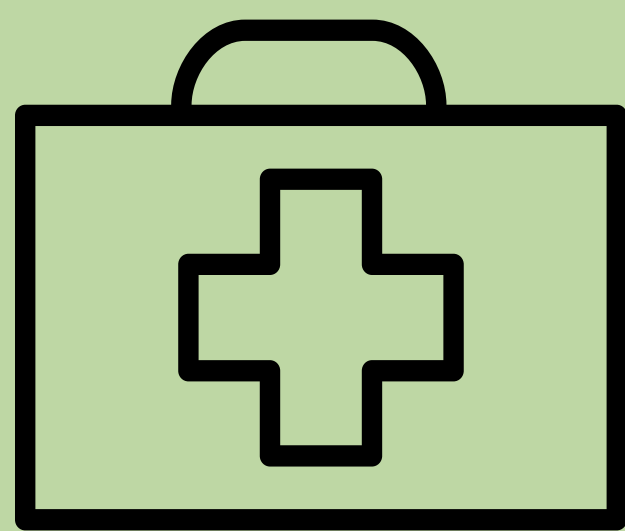

Medical and Health
Services
78



Other Business Services
30

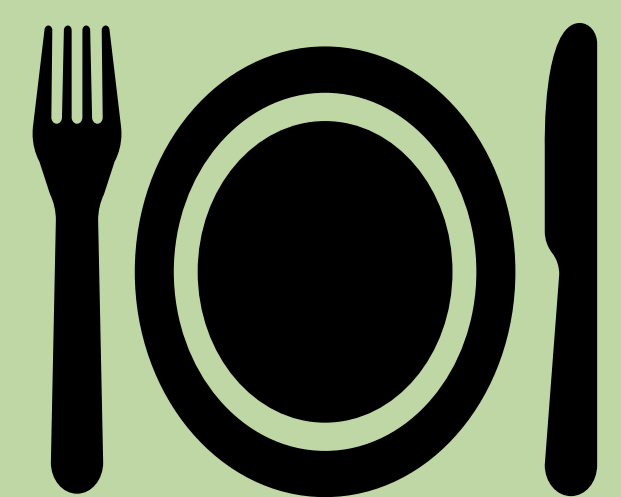

Catering and
Entertainment
35



Other Financial Institutions
32



Retail
21

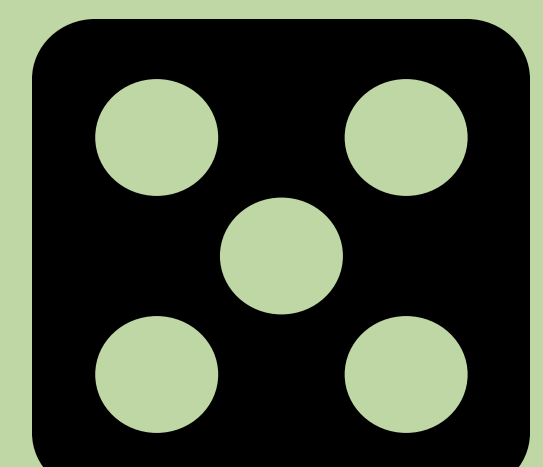

E-Gaming
29

Registered Unemployment January 2021: Detailed Breakdown

	Current Month Jan 21	Last Month Dec 20	Net Change over Month	Last Year Jan 20	Net Change over Year
Total Unemployment :-	1,034	756	278	404	630
Males	659	478	181	282	377
Females	375	278	97	122	253
Included amongst the Unemployed are:-					
Persons Requiring Work Permits	22	5	17	0	22
Persons aged under 18	17	16	1	7	10
Claimants signing for credits only	132	64	68	1	131
New Claimants	405				
Males	266				
Females	139				
Claimants leaving the register	127				
Males	85				
Females	42				

Historic Isle of Man Registered Unemployment

	Jan	Feb	Mar	Apr	May	Jun	Jul	Aug	Sep	Oct	Nov	Dec
1998	606	553	536	470	382	386	410	430	370	377	373	380
1999	406	390	330	271	249	223	268	234	235	231	228	258
2000	269	267	242	187	167	192	211	204	203	198	211	206
2001	255	229	192	173	154	157	178	182	149	165	187	211
2002	244	266	224	198	183	184	202	195	189	195	219	235
2003	263	284	293	249	236	273	332	369	301	329	334	327
2004	386	416	376	363	364	315	351	390	378	423	452	487
2005	543	552	542	561	556	517	582	569	577	563	589	591
2006	622	646	615	563	545	544	602	600	571	604	568	577
2007	586	616	552	624	569	594	614	633	593	611	562	571
2008	627	596	532	543	550	519	591	595	605	667	641	721
2009	926	980	947	925	915	922	967	981	901	888	885	878
2010	1,029	970	924	867	792	794	822	771	748	753	735	795
2011	856	867	891	843	806	846	890	830	890	910	971	979
2012	1,100	1,043	1,031	1,037	956	992	1,017	992	1,014	1,065	1,014	1,020
2013	1,176	1,181	1,208	1,108	1,072	1,056	1,055	1,028	1,022	1,064	1,117	1,159
2014	1,182	1,146	1,061	986	890	918	934	904	859	866	864	882
2015	973	930	865	834	768	768	790	776	765	774	786	861
2016	873	828	794	711	663	636	620	596	592	552	573	579
2017	601	574	507	462	440	407	420	393	338	336	319	335
2018	361	373	399	407	330	313	321	336	331	325	330	354
2019	368	371	349	314	305	302	334	337	320	332	337	376
2020	404	389	850	1,347	1,283	1,133	1,100	1,000	885	797	770	756
2021	1,034											

Source: Social Security, Treasury

Number of Registered Unemployed – January 2018 to January 2021

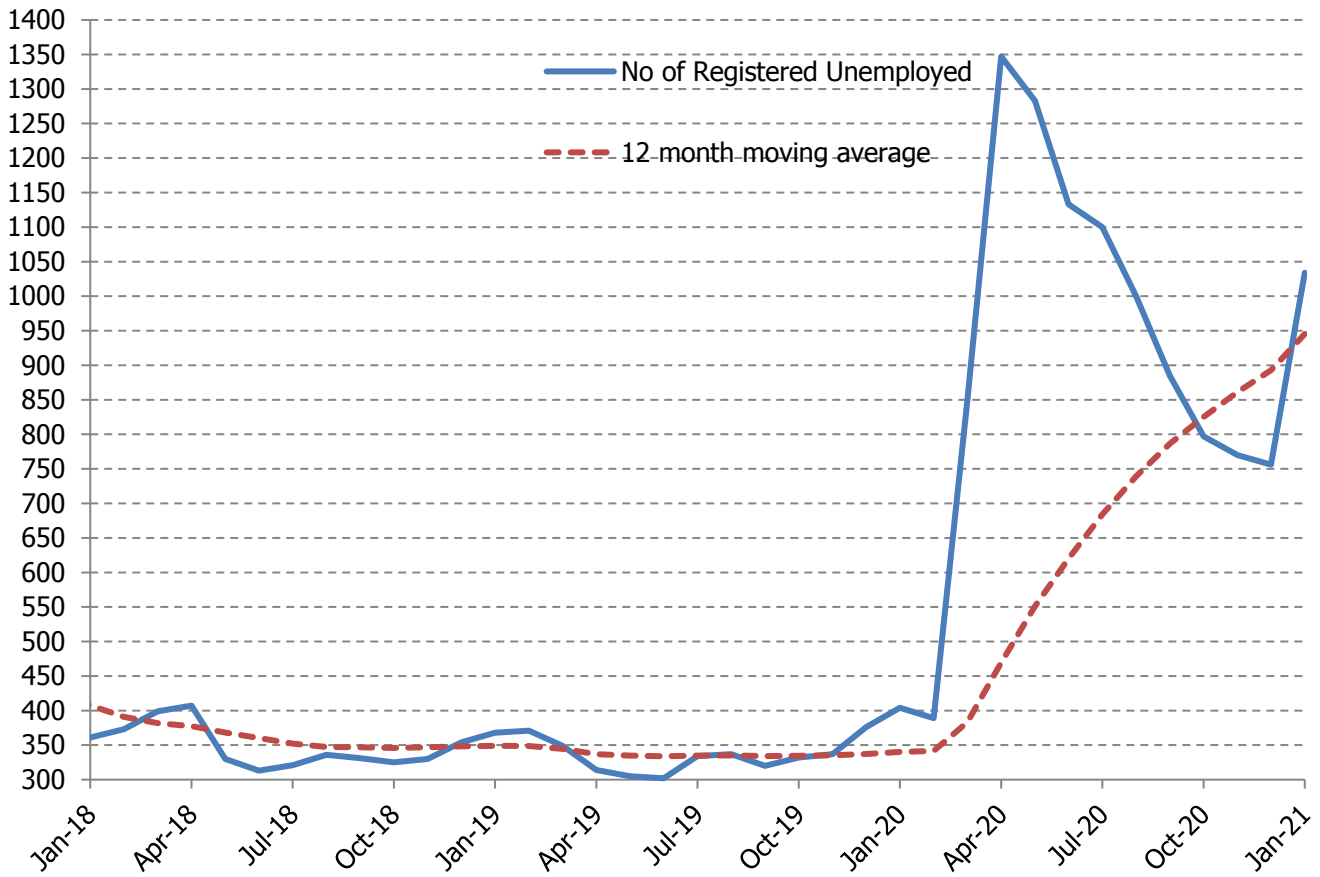

Source: Social Security, Treasury

Number of Vacancies Received During the Month – January 2018 to January 2021

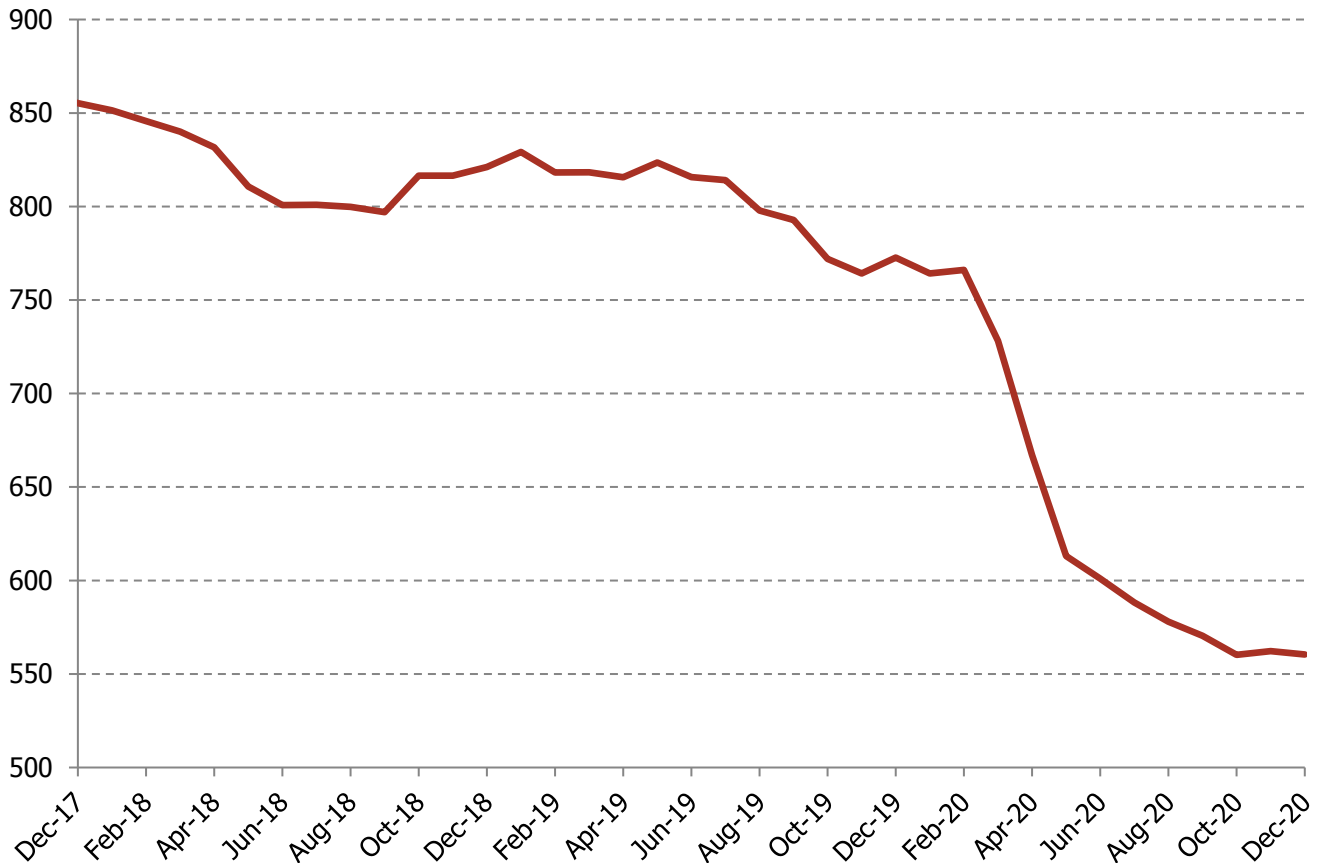

Note: 12 month moving average

Source: Job Centre, Social Security, Treasury

Unemployment and Vacancies by Industrial Sector

Industrial Sector	Unemployed Persons			Vacancies Remaining Jan 21
	Jan 21	Dec 20	Jan 20	
Agriculture, Forestry & Fishing	16	6	9	3
Manufacturing	26	25	22	7
Construction skilled	93	36	22	12
Construction unskilled	74	31	27	4
Utilities	2	1	3	1
Transport & Communication	28	28	11	11
Wholesale Distribution	3	3	0	2
Retail Distribution	88	62	38	21
Insurance	8	7	7	9
Banking	24	24	10	2
Other Financial Institutions	53	56	26	32
Property Owning & Managing	1	1	0	0
Other Business Services	141	99	44	30
Information Communication Technology	7	6	4	6
Legal and Accountancy Services	6	5	0	14
Education / Teaching	16	11	2	19
Medical & Health Services	43	37	20	78
Tourist Accommodation	39	37	31	11
Other Professional or Technical Services	1	1	3	4
Other Catering & Entertainment	88	44	7	35
Film Production	0	0	0	0
E-Gaming	8	7	0	29
Miscellaneous Services	56	19	3	4
Public Administration	13	6	4	10
Leaving From Or Arriving On Island	19	23	14	n/a
Other Benefits, Training Centre, Prison	115	122	68	n/a
School Leavers, Students etc.	23	25	10	n/a
Not identified	43	34	19	n/a
Total	1,034	756	404	344

Note: Vacancies relate to those open at the end of the month.

Sources: Job Centre, Social Security, Treasury

Vacancies by qualifications required

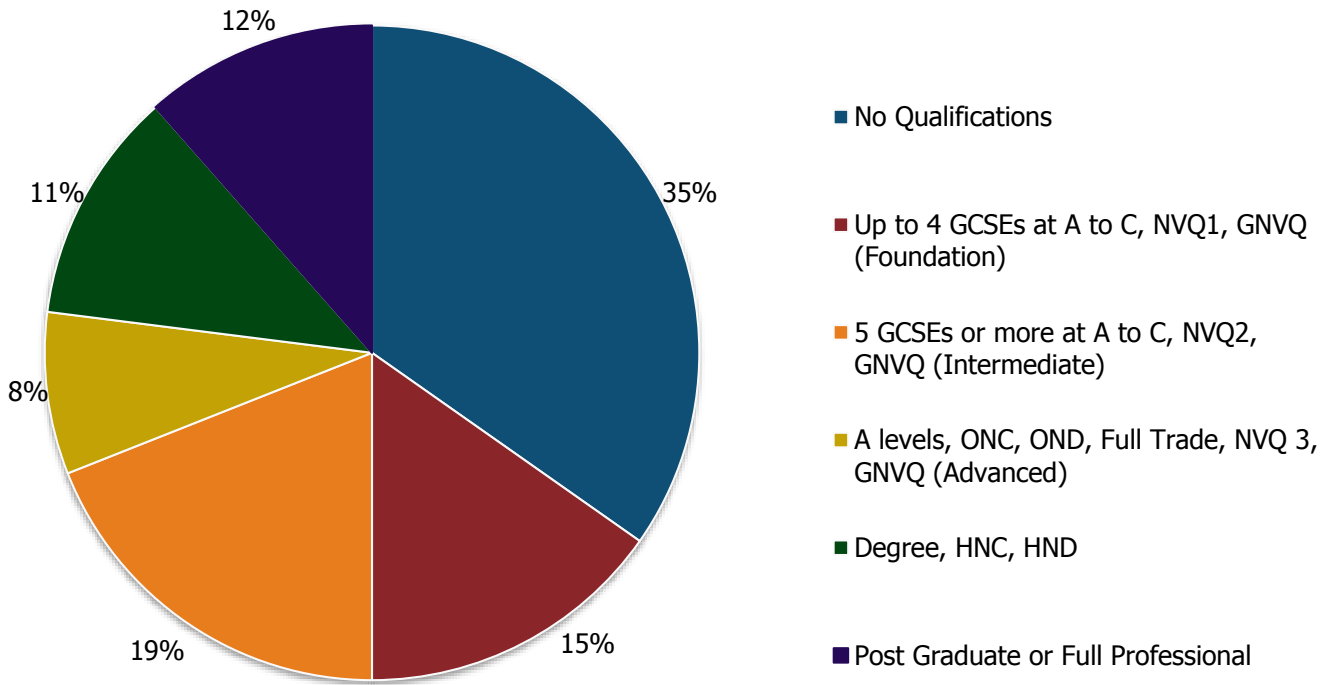

Vacancies by experience required

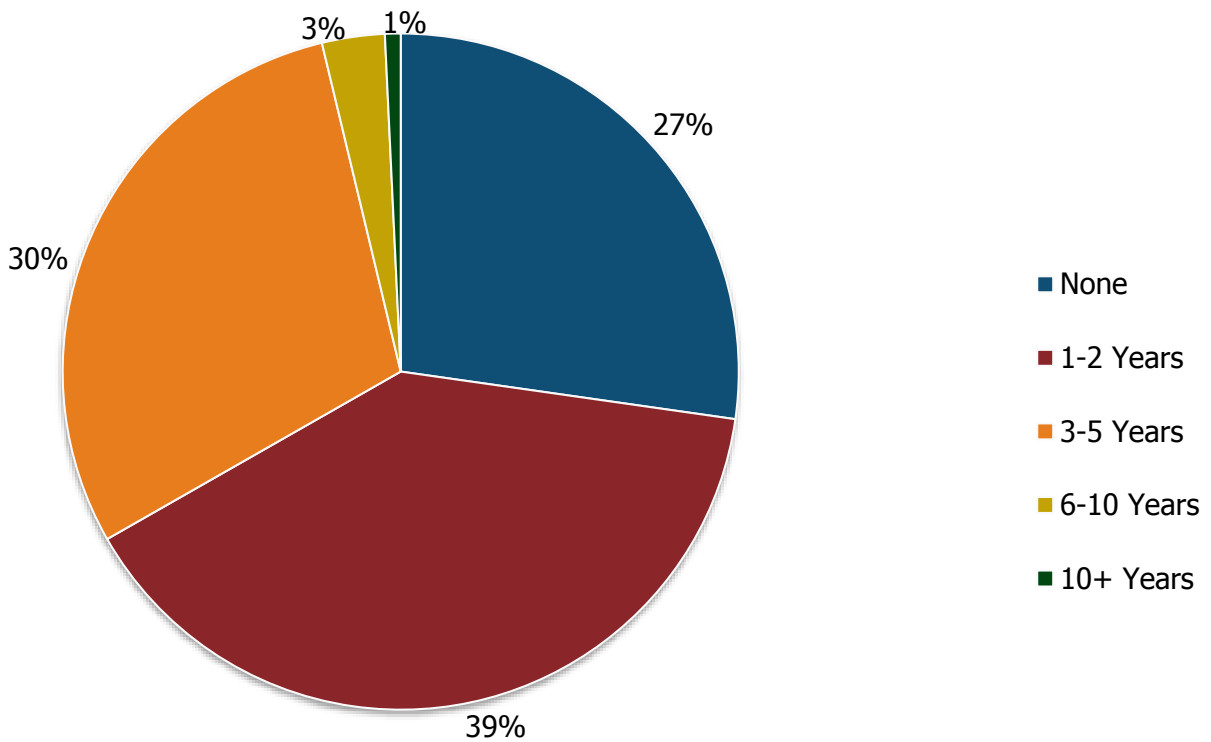

Source: Social Security, Treasury

Unemployment by duration and gender

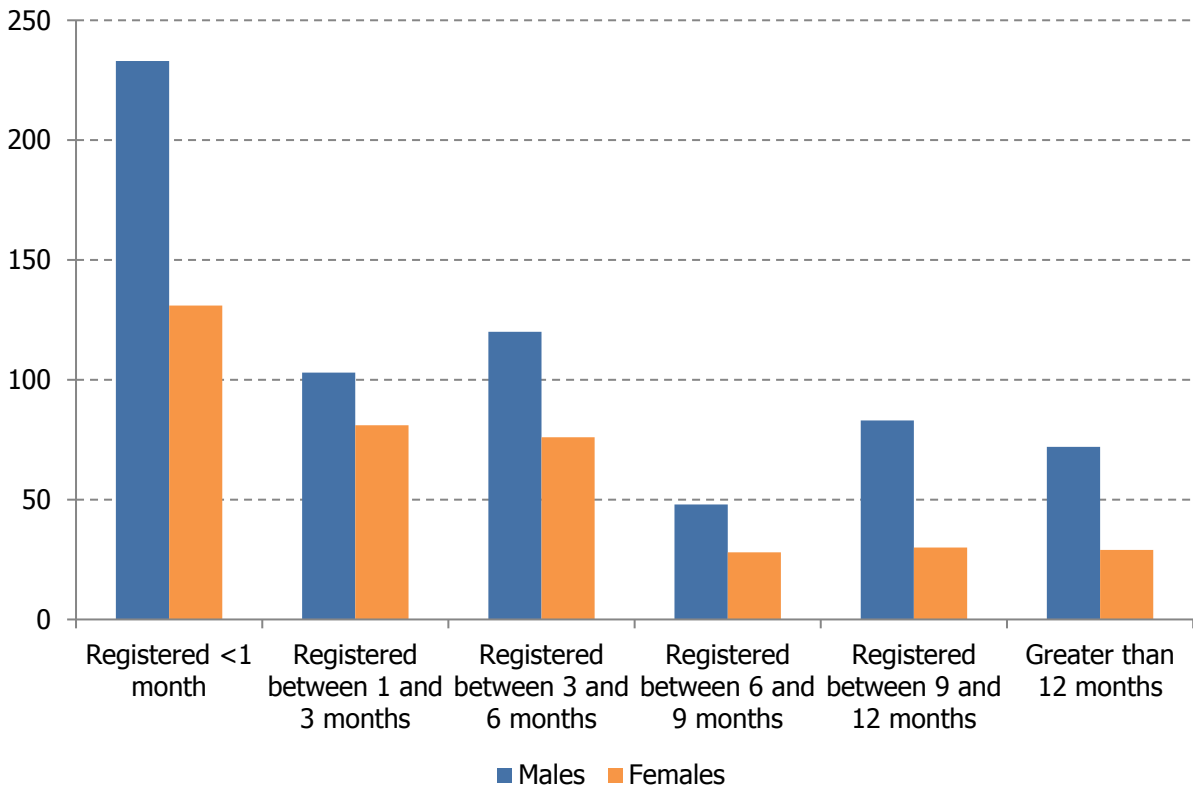

Long Term Unemployed by Age

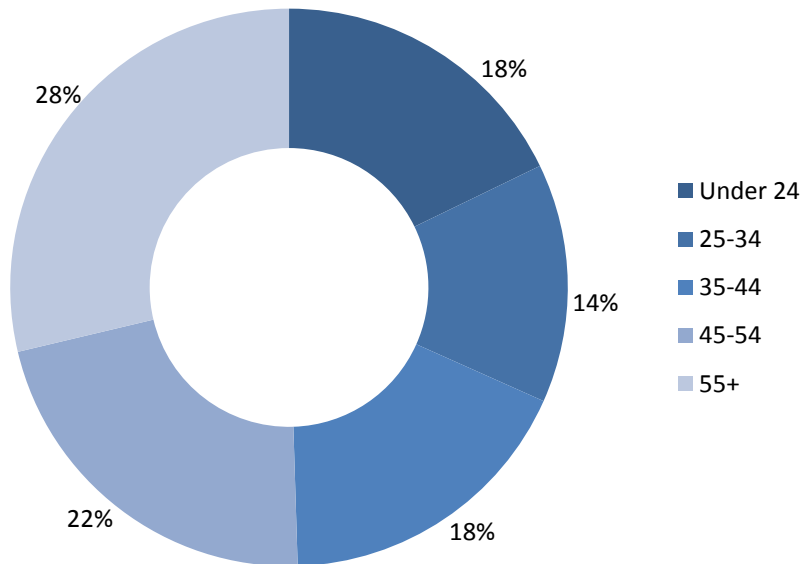

Note: Long term unemployed refers to those who have been unemployed for 12 months or longer.

Unemployment by Duration and Age of Claimant

	Under 20	20 - 29	30 - 39	40 - 49	50 - 59	60 and Over	Total
Less than 1 month	32	91	82	80	49	30	364
Over 1 and up to 3 months	20	48	32	29	40	15	184
Over 3 and up to 6 months	18	43	24	38	40	33	196
Over 6 and up to 1 year	16	34	19	35	51	34	189
Over 1 year and up to 2 years	4	17	12	15	13	11	72
Over 2 years and up to 4 years	0	7	1	1	8	8	25
Over 4 years	0	0	1	1	0	2	4
Total	90	240	171	199	201	133	1,034

Source: Job Centre, Social Security, Treasury

Vacancies per Region by Unemployment per Region

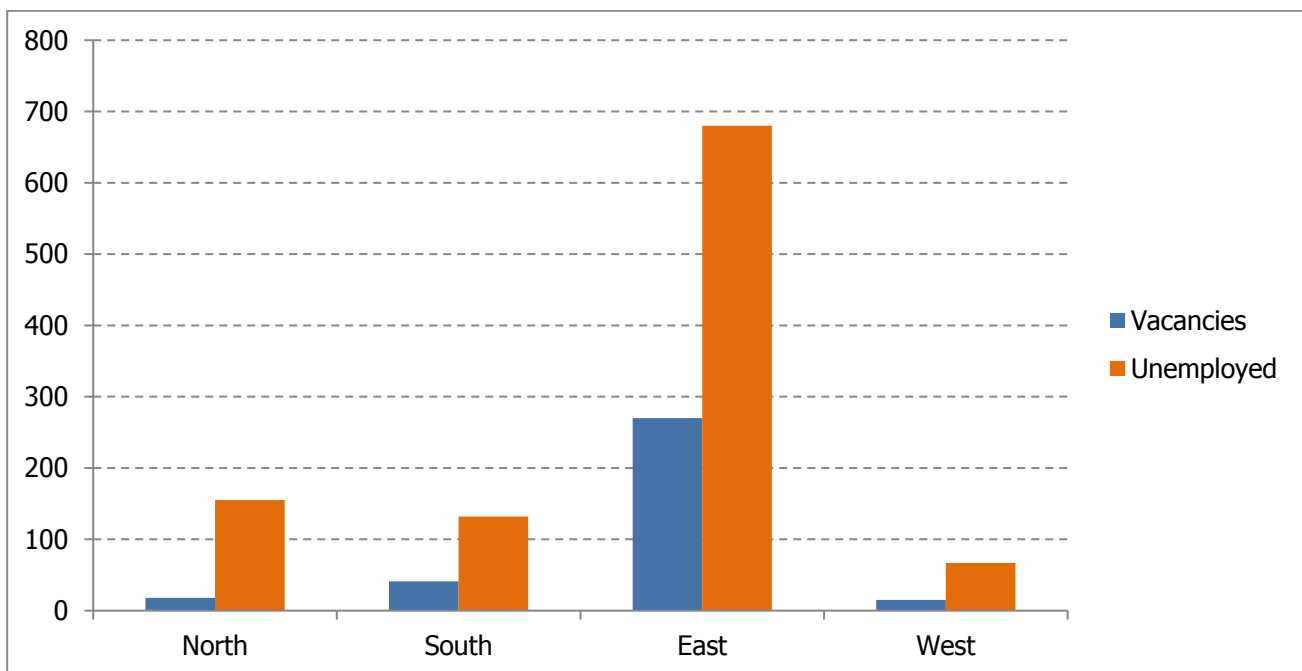

Unemployed Persons by Region

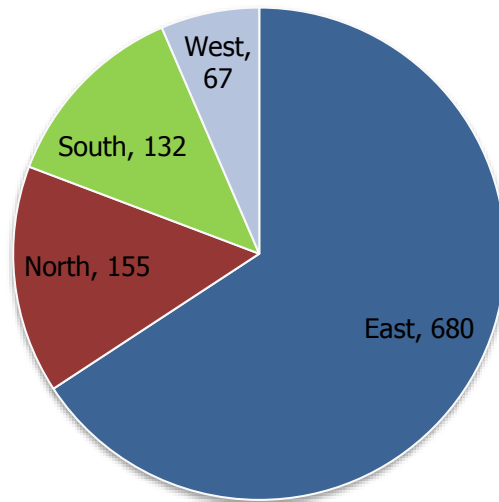

Regional Unemployment Rates

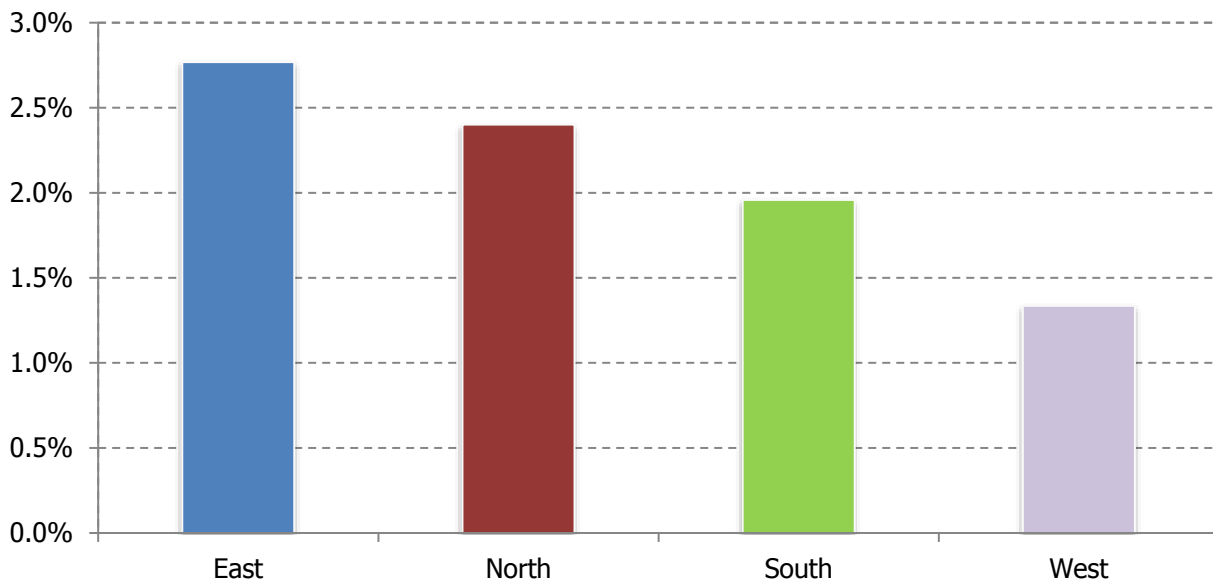

Source: Social Security, Treasury

Note: The regional unemployment rates are the number of unemployed in each region as a proportion of the economically active in that region, as determined by the 2016 Census.

East	North	South	West
Douglas	Ramsey	Castletown	Peel
Laxey	Andreas	Port Erin	German
Onchan	Ballaugh	Port St Mary	Michael
Braddan	Bride	Arbory	Patrick
Lonan	Jurby	Malew	
Marown	Lezayre	Rushen	
Santon	Maughold		

ISLE OF MAN LABOUR MARKET

METHODOLOGY AND CONTACTS



METHODOLOGICAL NOTES

Registered unemployment is measured as a claimant count of those persons registered for Job Seekers Allowance (JSA). There is no legal requirement to register to receive Job Seekers Allowance.

International Labour Organisation (ILO) definition

There are two common measures of unemployment: the claimant count (as detailed above), and that used by the ILO. The ILO measure includes not only those who are registered as unemployed (such as claiming JSA) but also those who are not registered but may still be looking for work.

Historically, the Island has only published the ILO definition of unemployment when census results have been made available. This report uses analysis of the ILO unemployment rate and the claimant count rate to generate an estimate of number of individuals that may be unemployed and actively seeking work but not registered as doing so.

In February 2017, the economically active population used in the calculation of the unemployment rate was updated to 42,777 to bring in line with the 2016 Isle of Man Census. The previous figure, based on the 2011 Census, was 44,607.

Additional information may be supplied on request.

CONTACT DETAILS

For further information please contact Economic Affairs using the contact details below:

Economic Affairs
Cabinet Office
3rd Floor Central Government Office
Bucks Road
Douglas
Isle of Man
IM1 3PN

Email: economics@gov.im

Telephone: (+44) 01624 685758



Isle of Man
Government

Reilrys Ellan Vannin



Isle of Man Government
Government Office
Bucks Road, Douglas
Isle of Man, IM1 3PN

Email: **economics@gov.im**

www.gov.im/