

23
PLAN AND SURVEY
BALLACHRINK,

In the Parish of St. Anne and St. John,
THE PROPERTY OF MR. W. GICK,
 October, 27th, 1859.

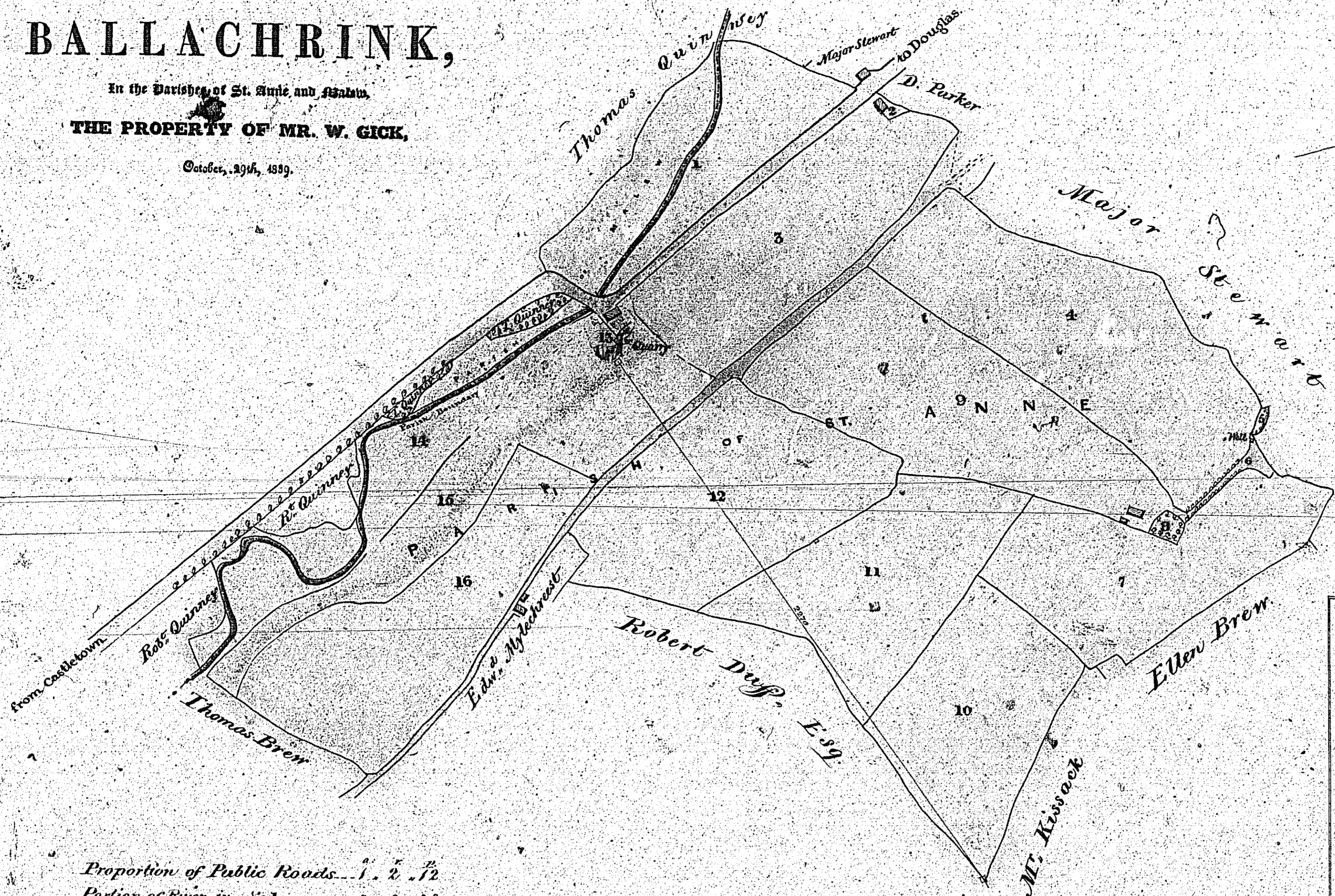

Proportion of Public Roads... 1. 2. 12
 Portion of River in No. 1... 0. 0. 33
 Ditto ditto... 14... 0. 2. 1

No.	Ac.	R.	P.
* 1 Portion in No. 1 (E.S.)	5	3	0
Ditto in No. 1 (S.W.)	0	0	9
2	4	3	23
3	6	2	9
4	0	0	4
5	0	0	26
6	2	2	5
7	0	0	15
8	5	0	39
9	4	1	13
10	4	2	9
11	5	2	0
12	0	1	4
13	3	1	2
* 14 Portion in No. 1 (S.W.)	4	1	5
Ditto in No. 1 (E.S.)	5	2	5
15	4	1	5
16	5	2	5
Total	53	0	6

*The Quantities for Nos. 1 and 14 are exclusive of the River.

10 Chains
 Jeffrey and Kayle Draughtsmen & Land Surveyors.

ISLE OF MAN GOVERNMENT: GENERAL REGISTRY
 TITHE PLANS: PARISH OF SANTON
 Original coloured 1:30

25

24

34

Plan and Survey

of Premises in the
Parish of Saint Anne;
the Property of
Mr. William Gick.

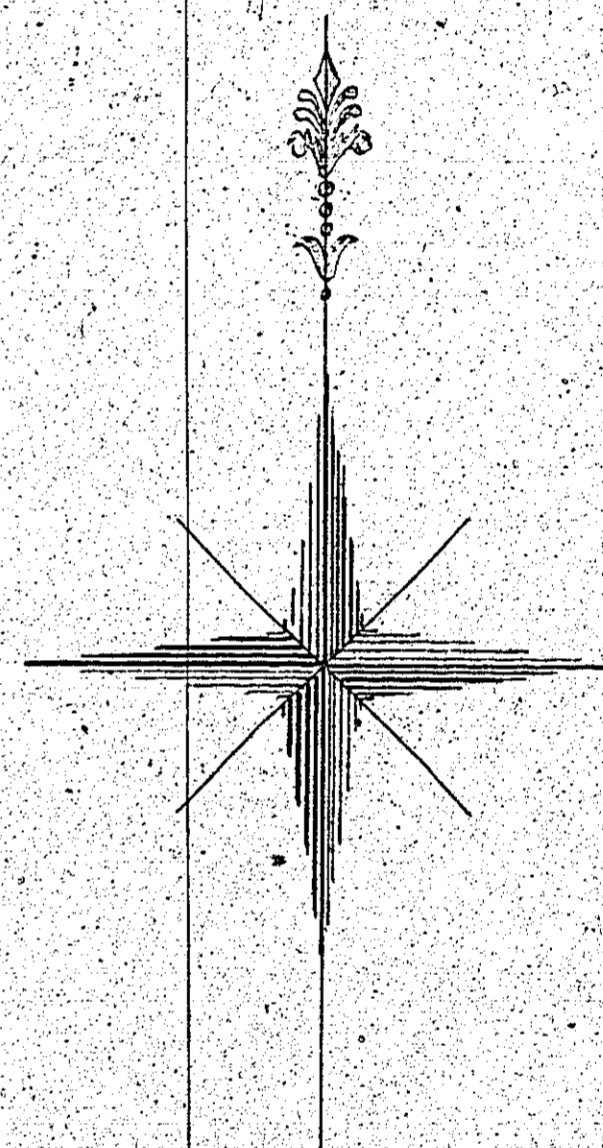
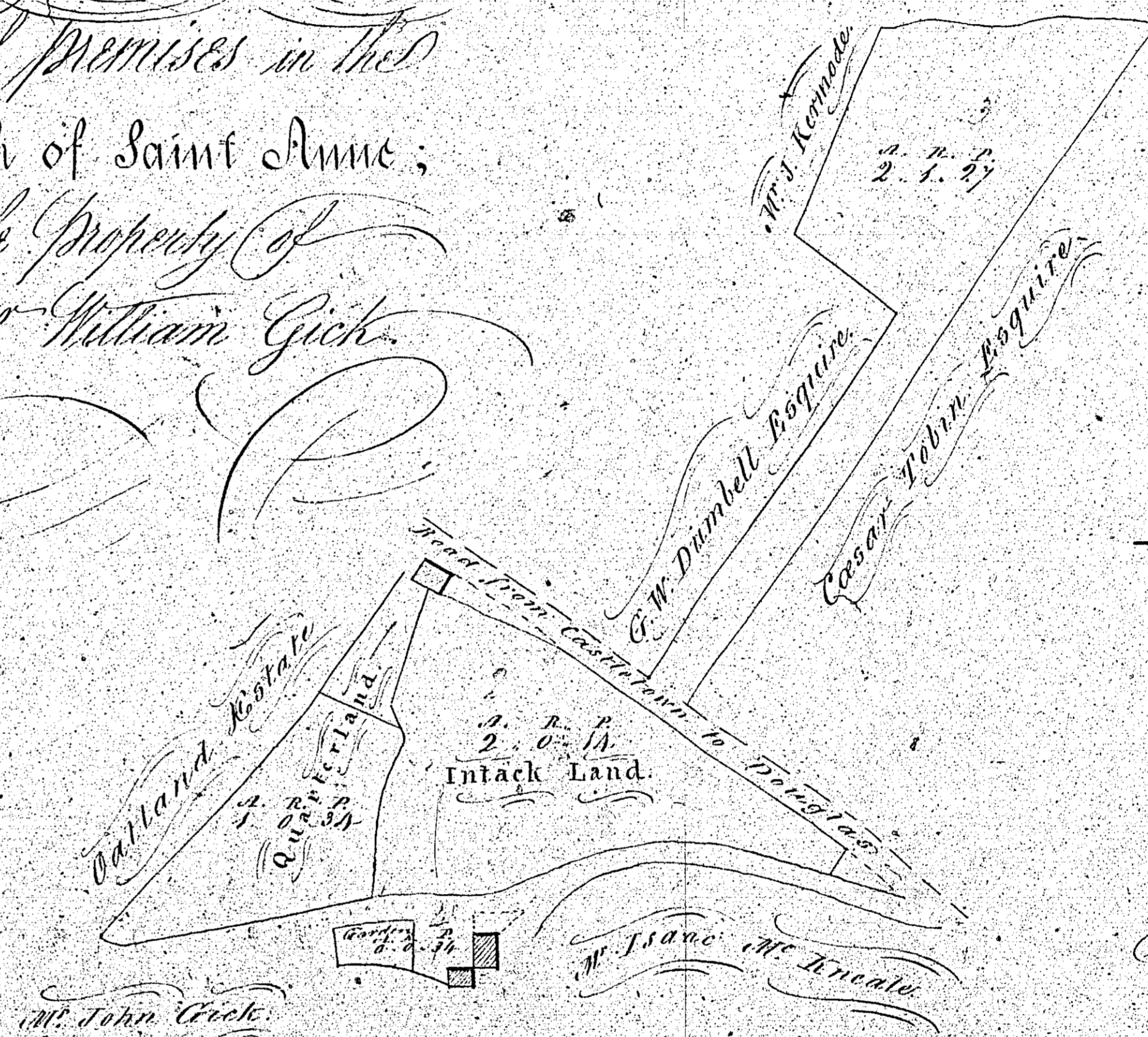

Scaled 2 Chains to an Inch.

Thomas Gick
Surveyor
1839.

Total Content
A. R. P.
3. 5. 29

25

Plan and Measurement
 of part of the Estate of
 Ballavartin

in the Parish of Saint Anne
 the Property of
 Mr. John Dick

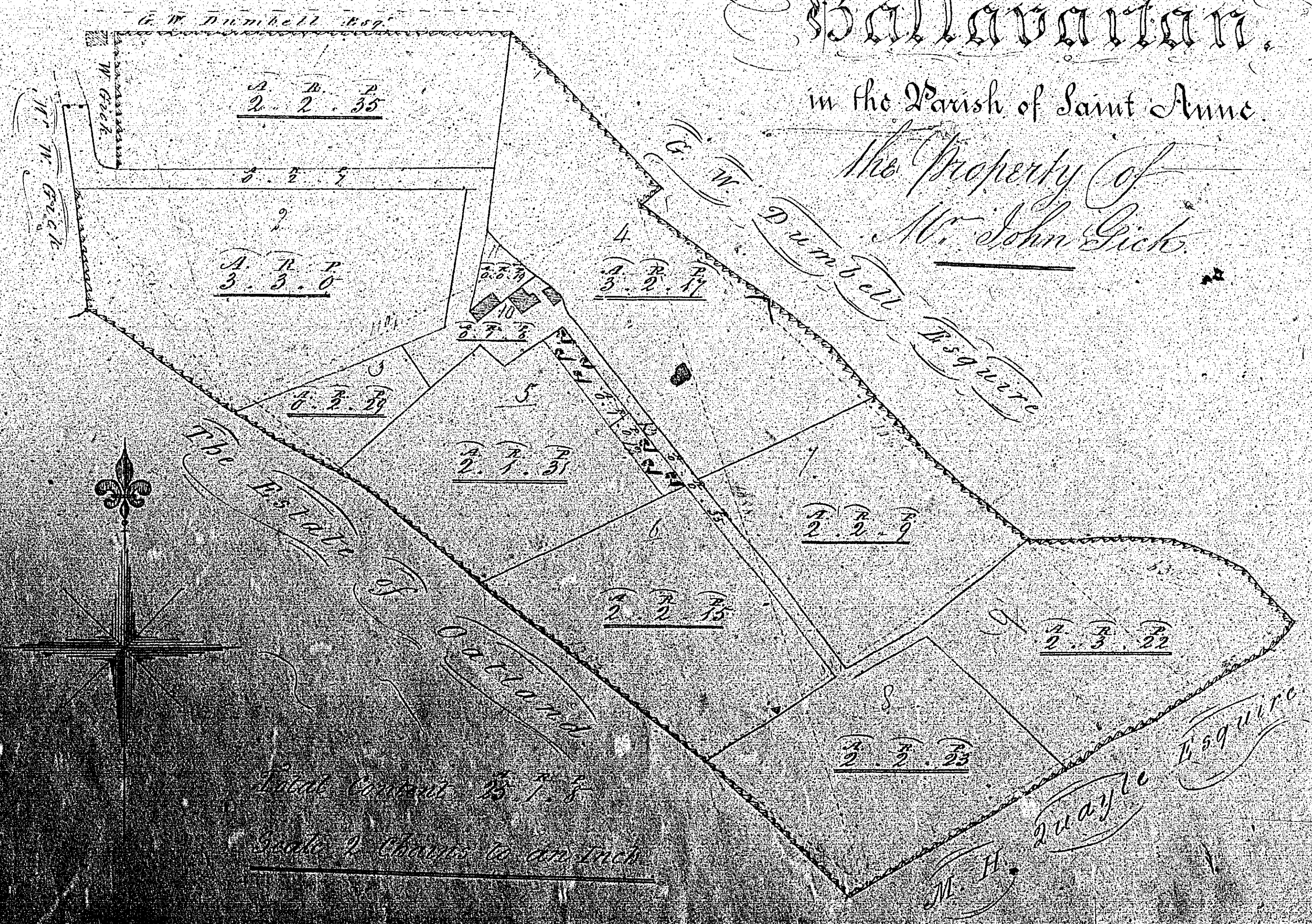

$\frac{A}{2} \frac{R}{2} \frac{P}{35}$

$\frac{A}{3} \frac{R}{3} \frac{P}{0}$

$\frac{A}{3} \frac{R}{2} \frac{P}{11}$

$\frac{A}{2} \frac{R}{1} \frac{P}{51}$

$\frac{A}{2} \frac{R}{3} \frac{P}{9}$

$\frac{A}{2} \frac{R}{2} \frac{P}{30}$

$\frac{A}{2} \frac{R}{3} \frac{P}{32}$

$\frac{A}{2} \frac{R}{3} \frac{P}{33}$

Subst. Content 15 1/2
 Equal 1/2 Acres to each

Surveyed 1859

By J. H. Dick

25

26

Plan
 of Part of the Quarterland
 OF
BALLACURRY
 in the Parish of S. Ann
 THE PROPERTY OF
 Mr. S. Dale

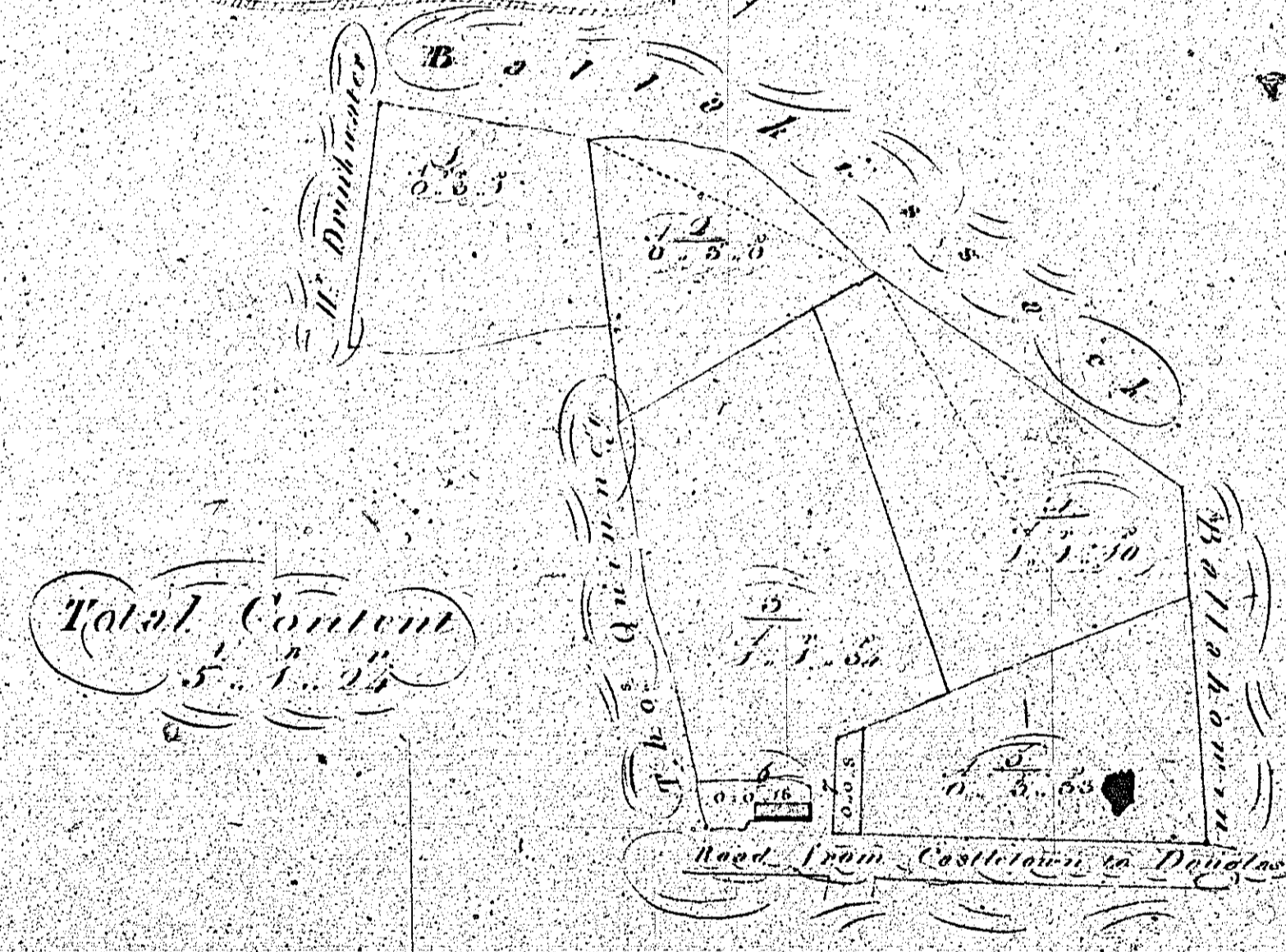
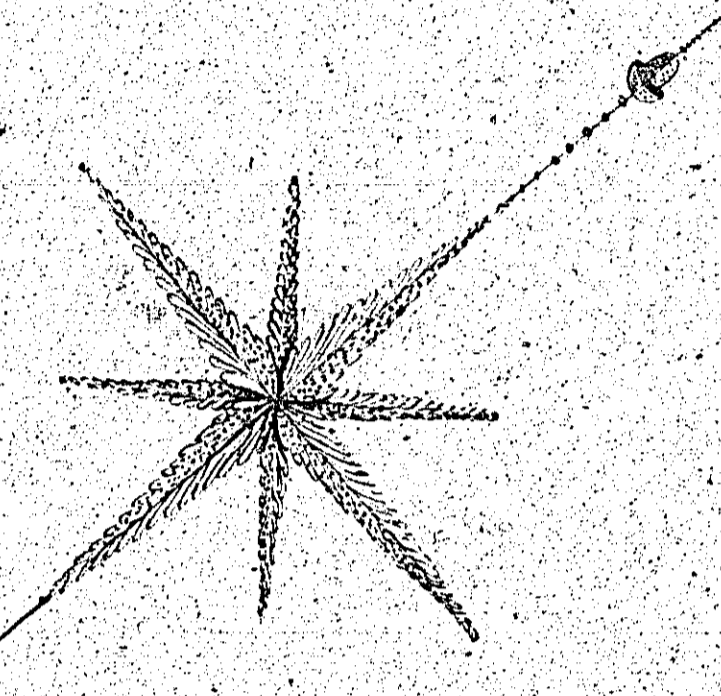

Total Content
 5. 1. 25

Scale two Chains to an Inch
 Tho. Cook Surveyor
 1840

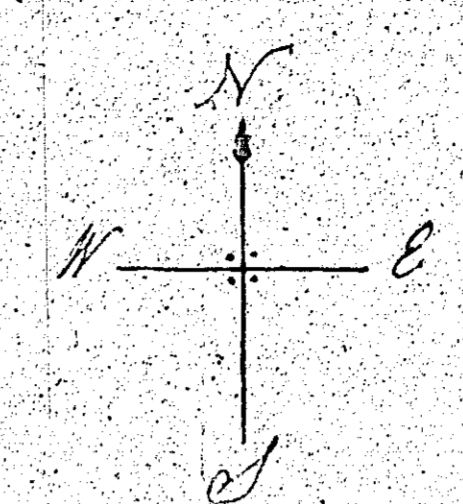

Mr. Moore's Subbrick

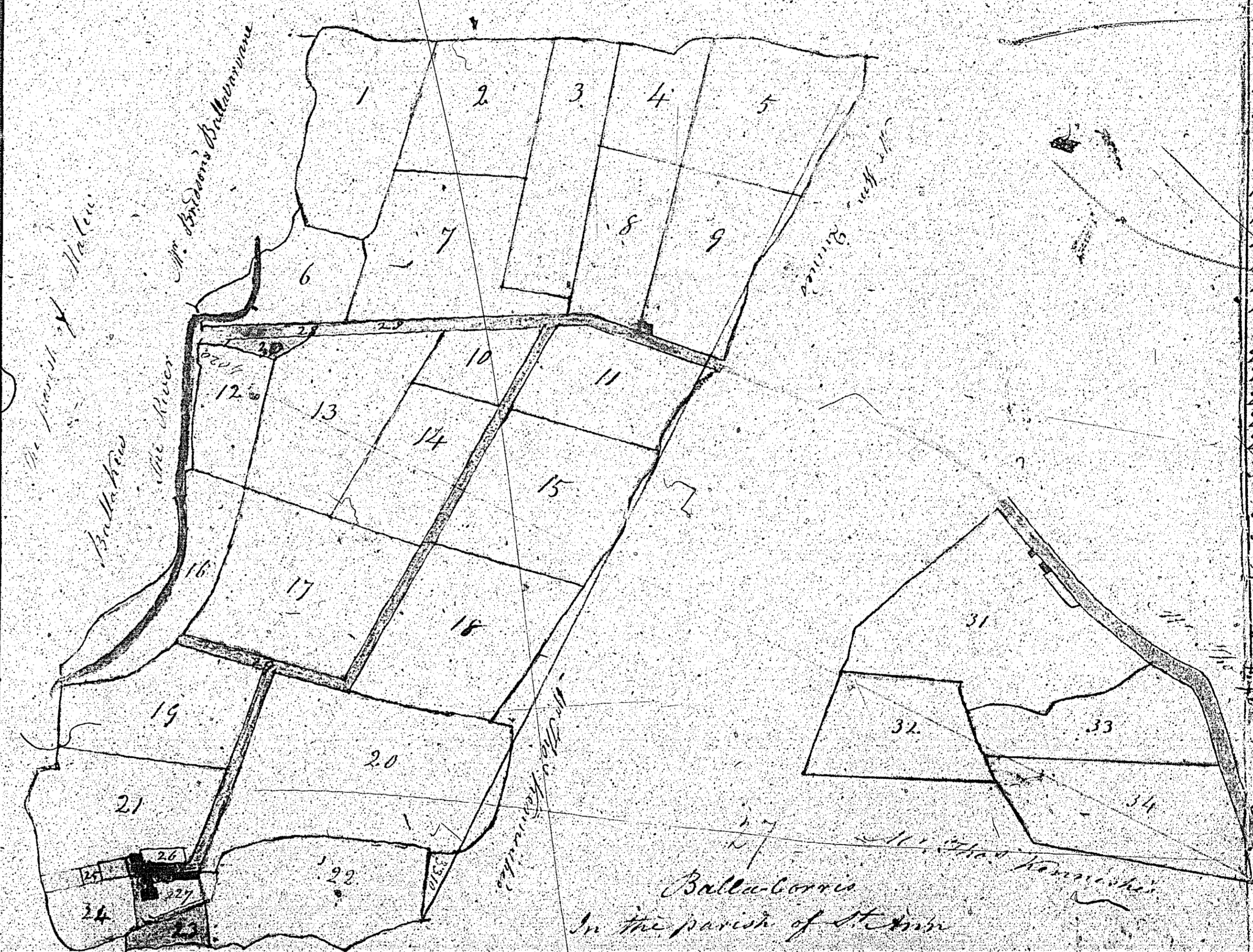

Balla-Carris
 In the parish of St. John
 The property of Mr.
 Morrison of Douglas
 Surveyed this 21st August 1839
 By Archibald Ogden

Scale three chains to an Inch

Contents	A. R. P.
1	2 2 8
2	2 0 1
3	2 0 14
4	1 0 30
5	2 1 9
6	1 7 12
7	2 2 22
8	1 2 18
9	2 0 25
10	3 4
11	2 0 16
12	3 36
13	2 2 2
14	1 2 36
15	2 2 30
16	1 2 23
17	2 3 38
18	2 3 30
19	2 0 31
20	4 1 30
21	2 0 35
22	2 1 31
23	1 4
24	2 16
48 1 21	
25	2 7
26	2 23
27	2 20
28	2 22
29	9
50 2 19	
30	3 3 15
31	1 3 15
32	1 3 20
33	2 2 20
60 3 36	
34	1 36
Total 60 1 13	

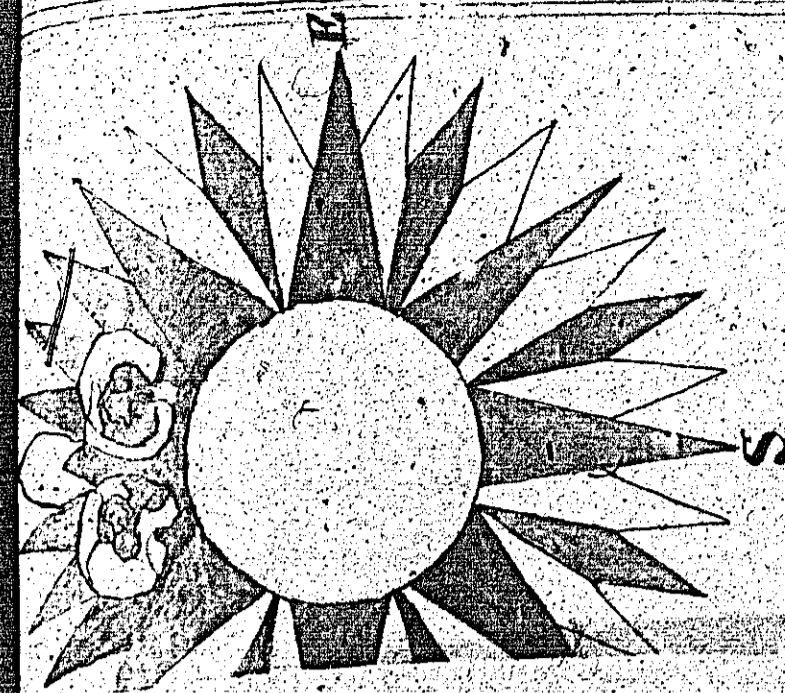

Mr. John Herwick

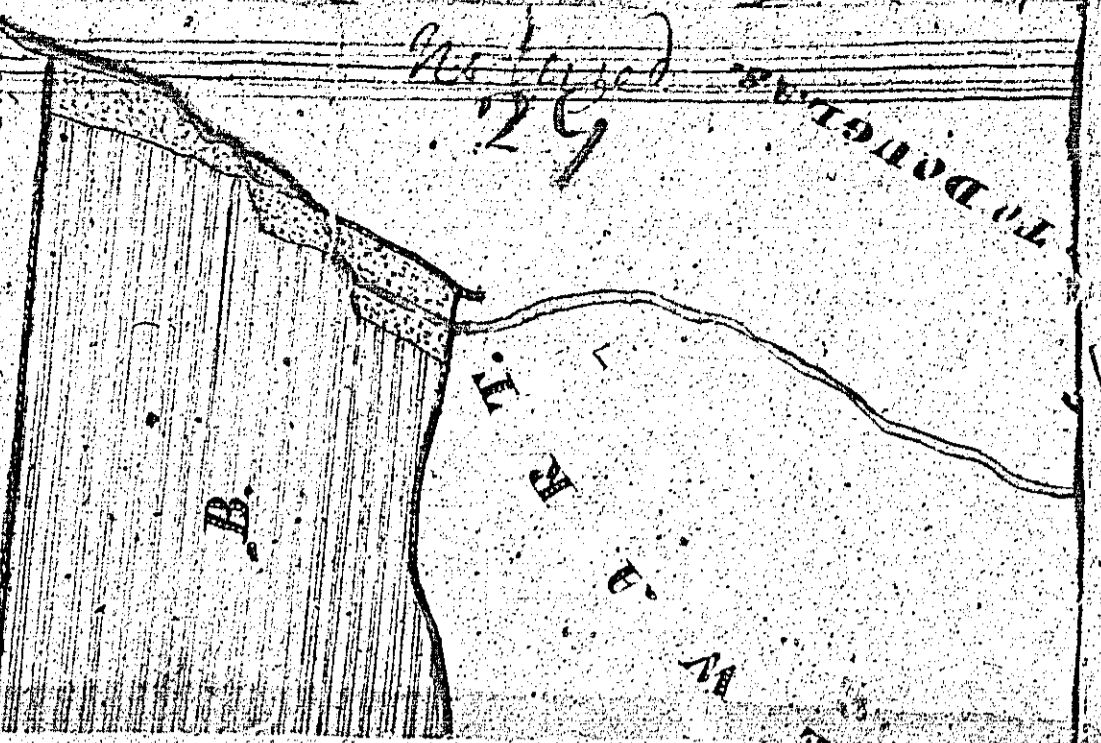

28

Plan
of
Kennis's Croft,
Intack Land,
the Parish of Saint Anne,
the Property of
Mr. Wm. Kennish.

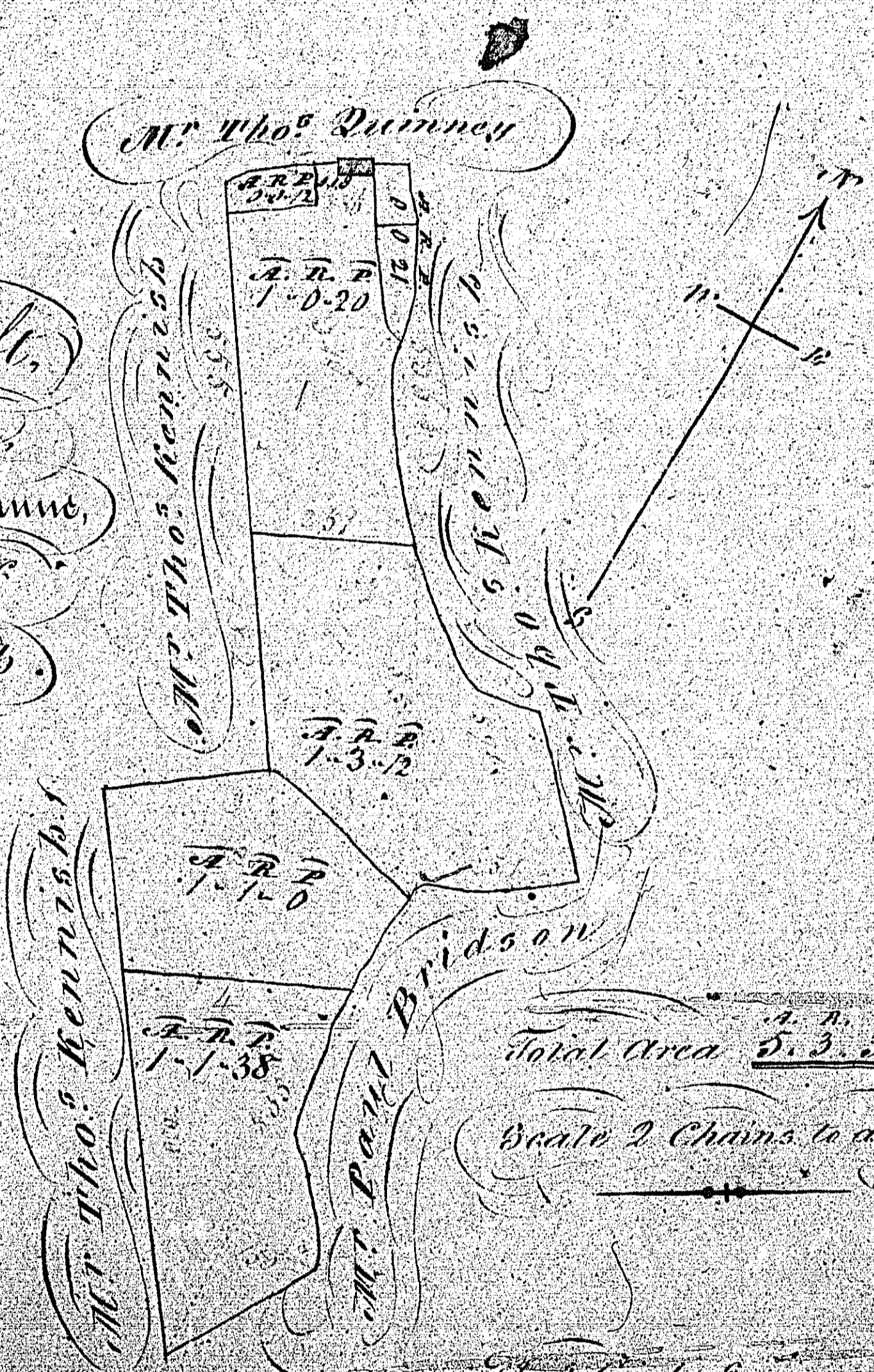

Mr. Tho's Quinn

Total Area $\frac{A. R. P.}{5. 3. 31}$

Scale 2 Chains to an Inch

Tho's Clerk Surveyor 1840.