

17
Ballavagher
in the Parish of S. Anne
The Property of R. Duff, Esq.
Oct. 1839.

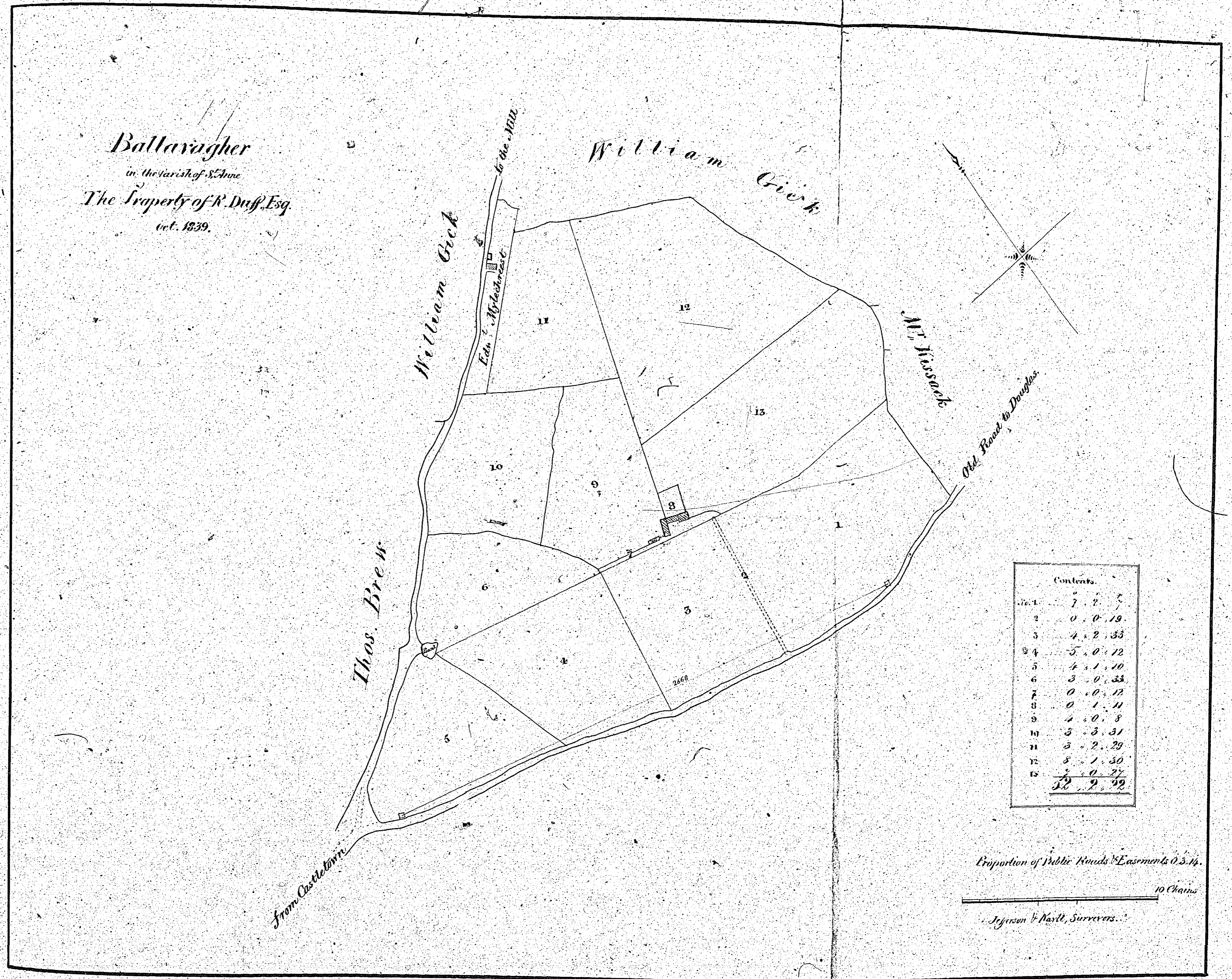

Contents.

No. 1	7	7	7
2	0	0	19
3	4	2	33
4	5	0	72
5	4	1	70
6	3	0	33
7	0	0	22
8	0	1	11
9	2	0	8
10	3	3	31
11	3	2	29
12	5	1	30
13	2	0	27
Total	29	9	99

Proportion of Public Roads & Easements 0.5.14.

10 Chains

J. & N. S. Surveyors.

St. Alan

Wm and Miss. Dundwater's

Part of
Ballacurry

in the

Parish of

SANTON.

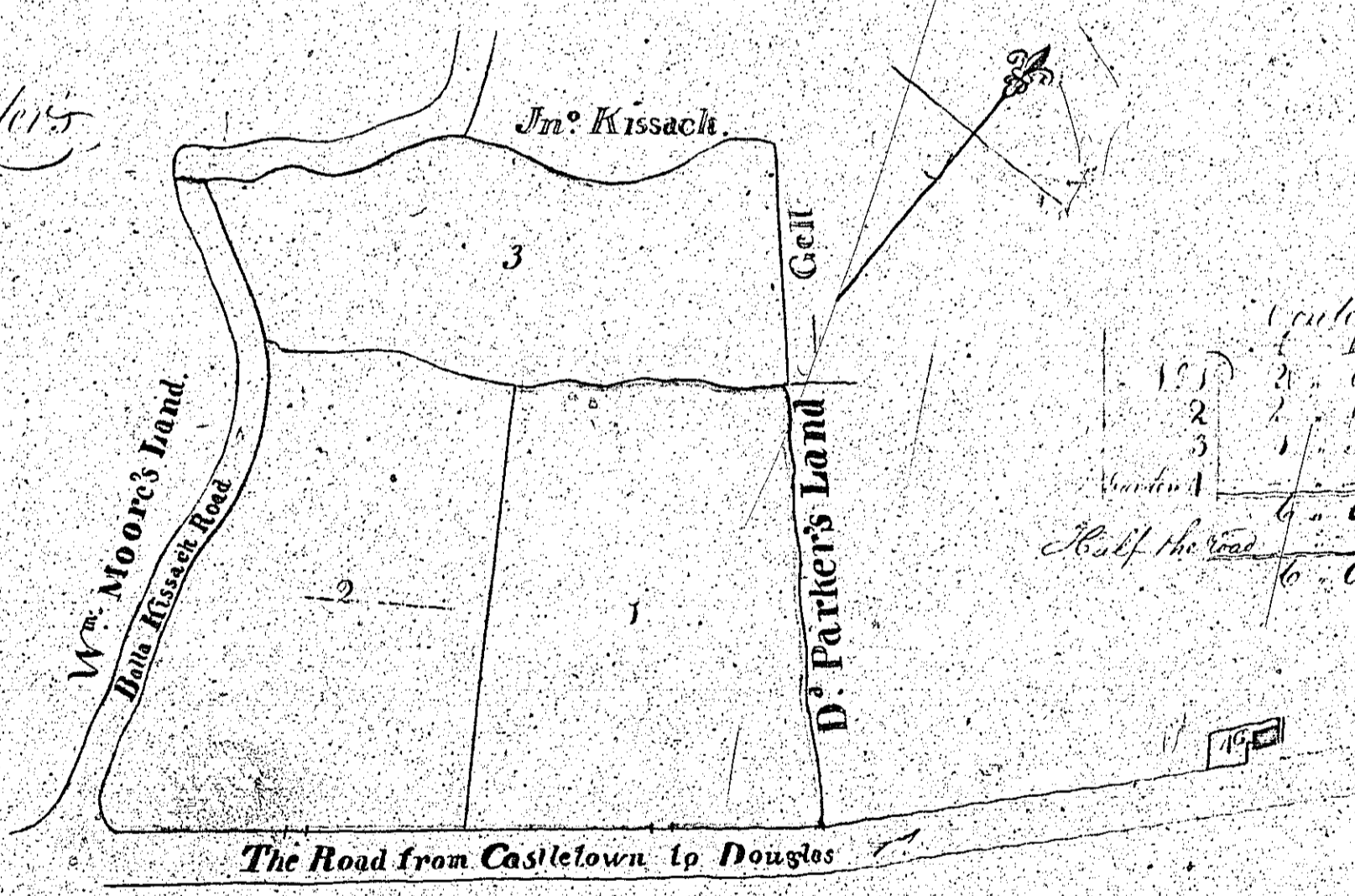

	Acres	Roods	Poles
1	2	0	3
2	2	0	21
3	1	7	10
Wm Moore's	6	0	5
Cell			2
Half the road	6	0	26

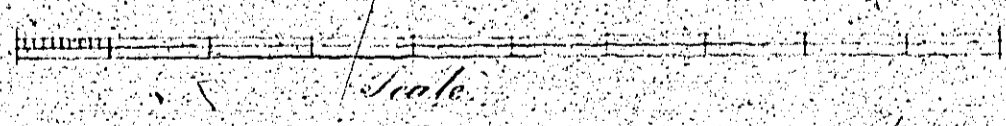

Surveyed by John Nicolson
March 20th 1810

19
Plan of Ballacartin the property of J. W. Dumbell Esq. situate in the parish of Scitlan

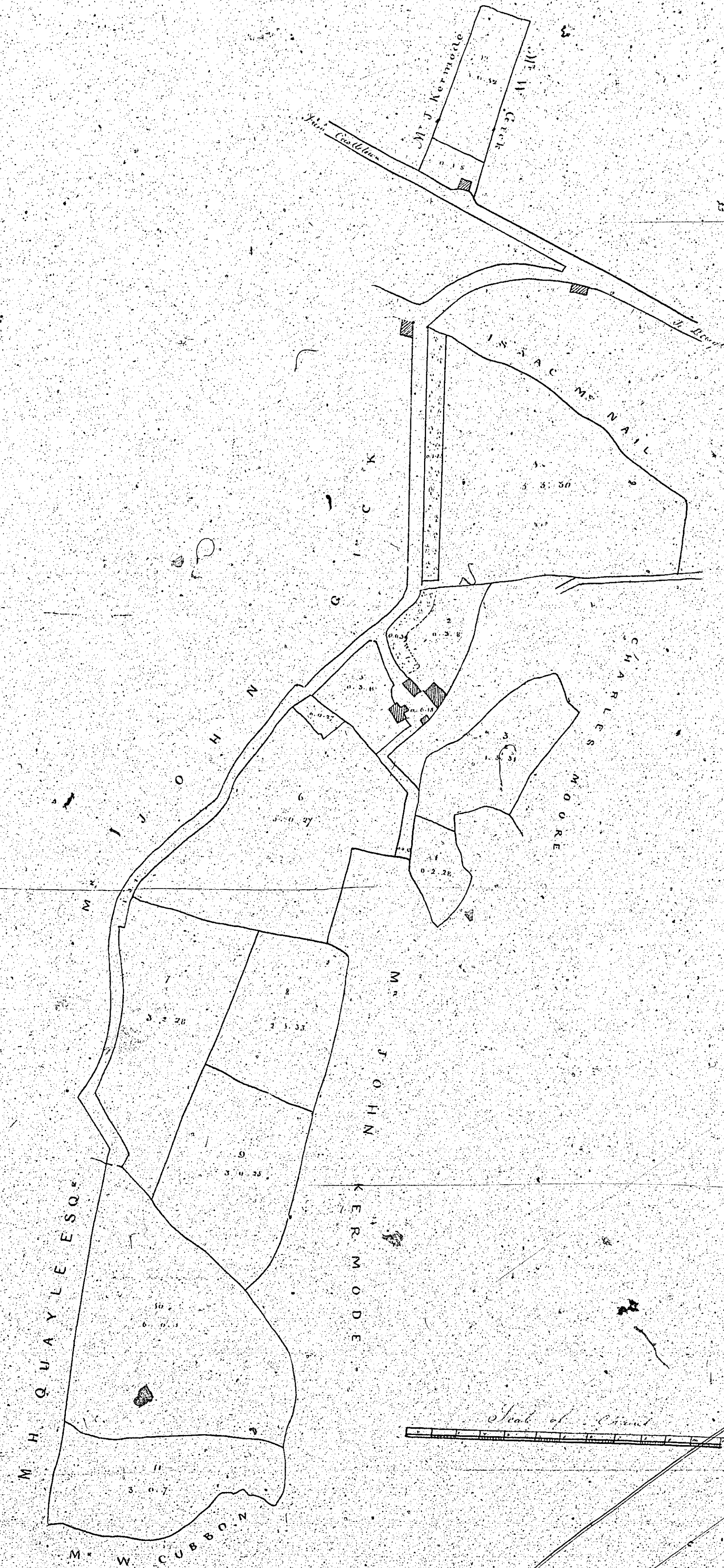

Copied by Mrs. James Moore
from a plan
by Joseph Baker

Plan and Survey

HUBBARD'S CROFT
In the Parish of St. Ann
THE PROPERTY
of
M^r Phillip Kargher

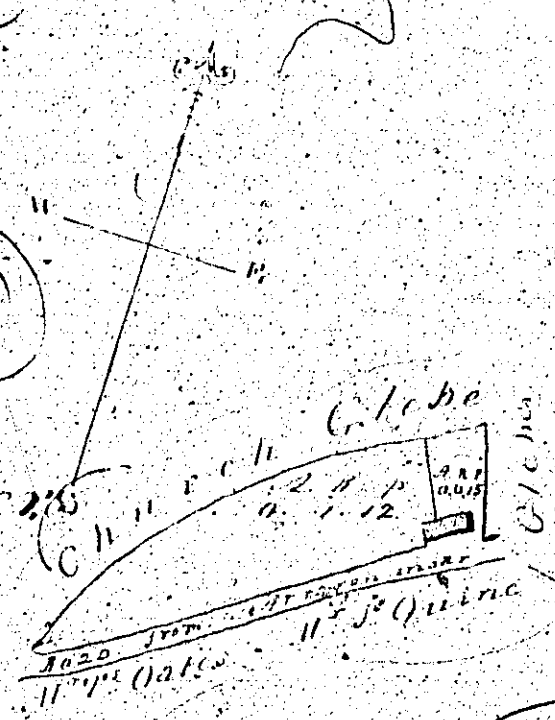

Total Contents
- 0.4.27 -
SCALE - TWO CHAINS TO AN INCH
THO. GICK SURVEYOR 1840

20

1840

1840
1840
1840

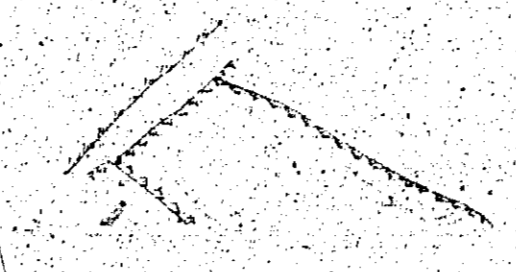

21

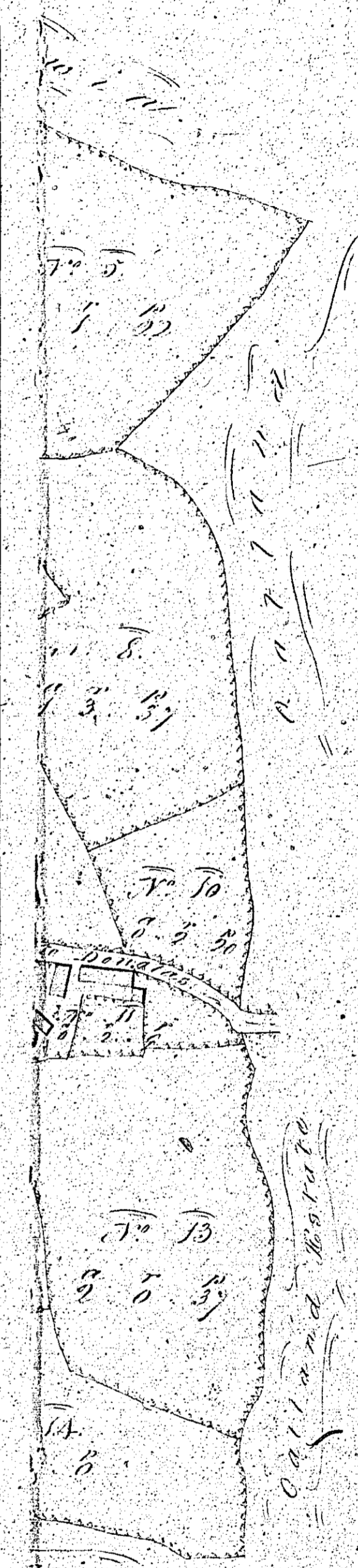
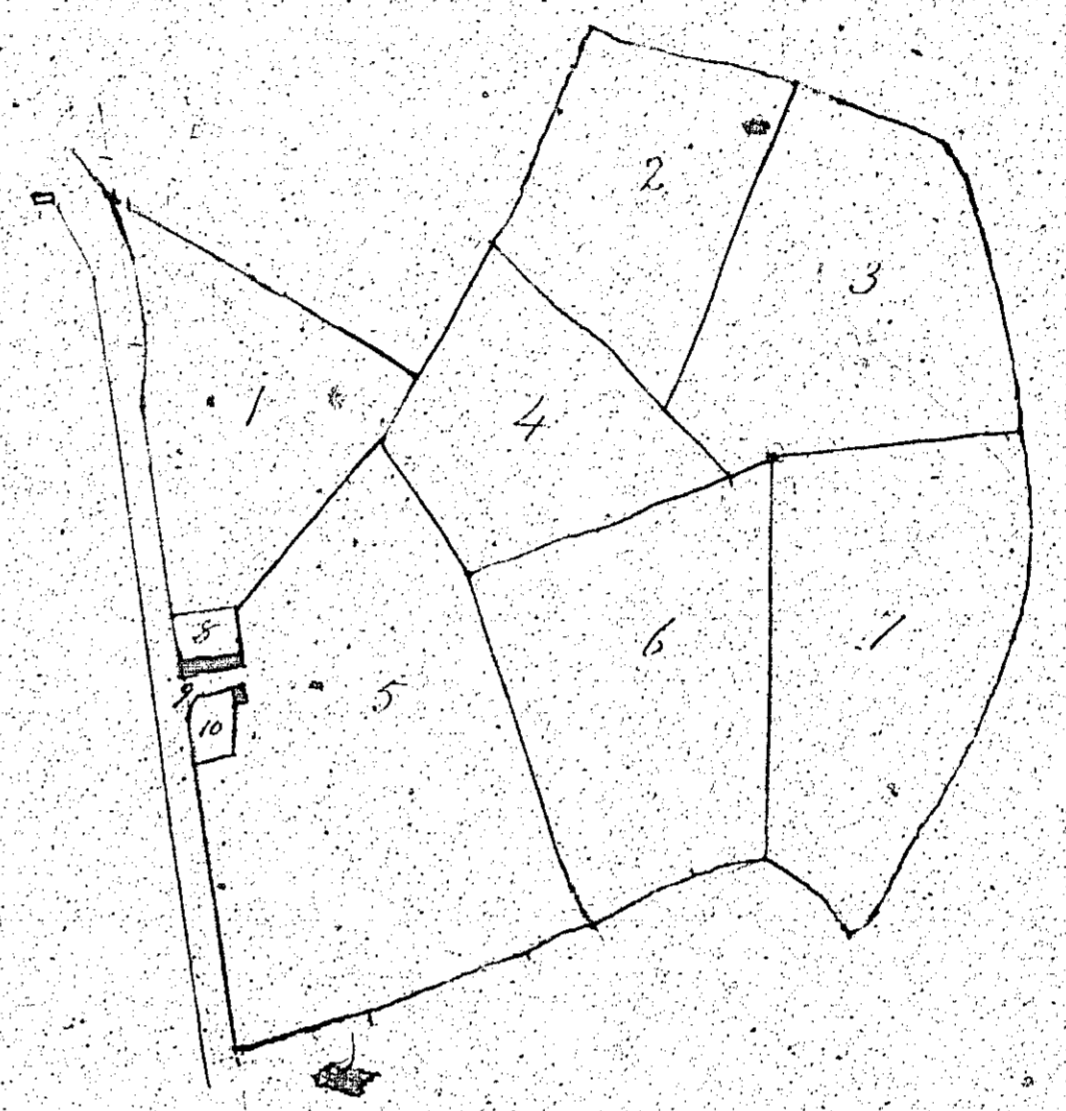

Plot	Contents
1	A.P.P.
2	1-2-2
3	1-2-10
4	1-3-21
5	1-1-30
6	3-2-17
7	2-1-20
8	2-2-2
9	10
10	11-2-10
11	Clanna gree 4-3-0
Total 17-3-11	

Three chains
 inch

The Clanna in the
 parish of St. Anne
 the property of
 J. Gelling
 bought this 11 August
 1797 by a conveyance

estate of
 detached
 of Santon
 by Samuel Esq.

Total 25-2-2

Scale 2 Chains to an Inch

W. Carrington
 Surveyor
 1840

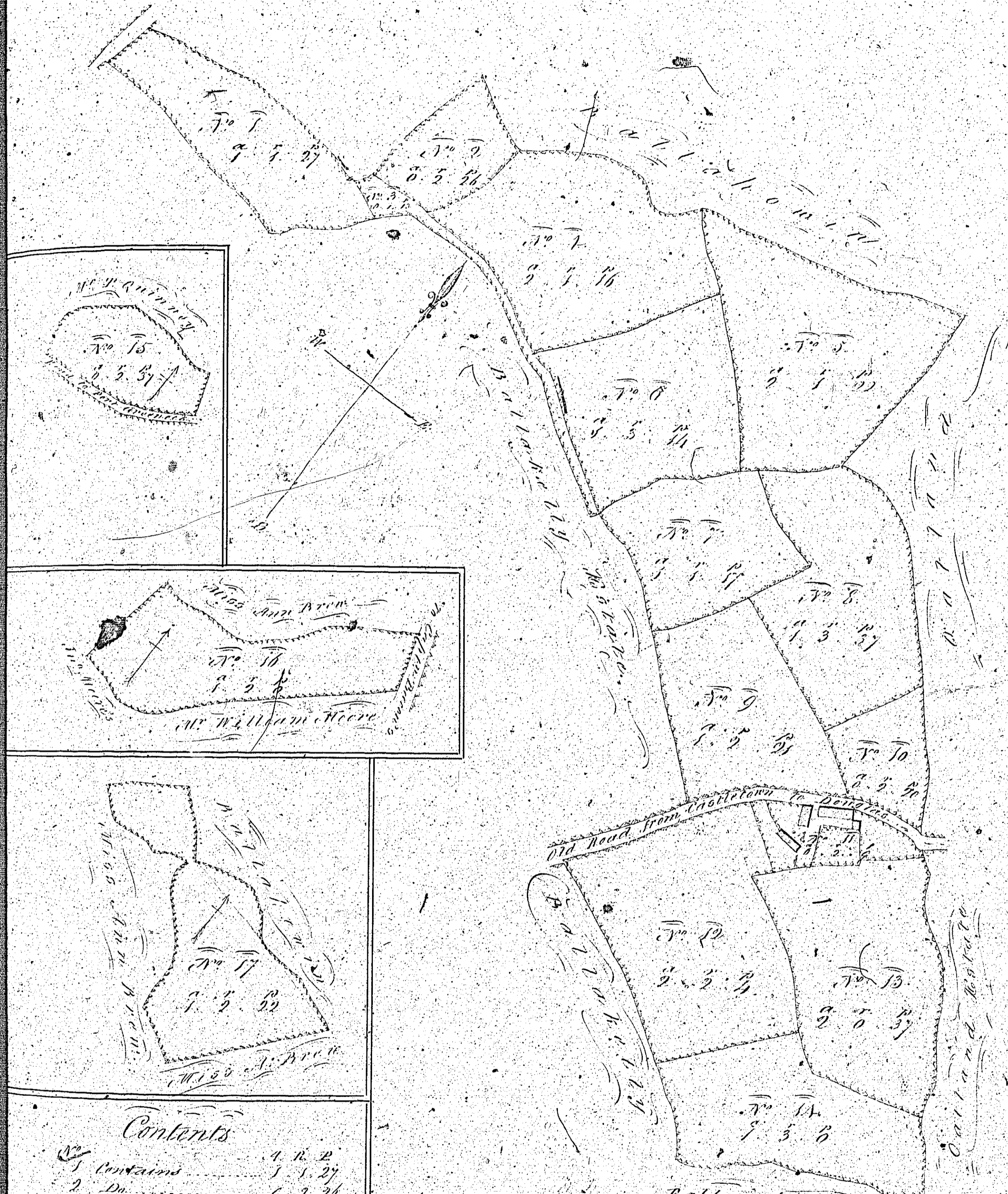

Contents

1 Contained	4. 11. 2
2 Do	1. 1. 27
3 Road & Enclosure	6. 2. 24
4 Contained	1. 1. 13
5 Do	2. 1. 14
6 Do	2. 1. 22
7 Do	1. 3. 14
8 Do	1. 4. 17
9 Do	1. 3. 37
10 Do	1. 2. 51
11 Road, Street, Garden	0. 2. 9
12 Contained	2. 2. 4
13 Do	2. 1. 31
14 Do	5. 3. 1
15 Detached	0. 2. 57
16 Do	1. 2. 6
17 Do	1. 2. 22
Total	24. 2. 2

*Plan of part of the Estate of
Ballakelly, and other detached
Premises in the Parish of Sauton
the property of Philip Garrett Esq.*

*Wm. Collins
Surveyor
1840*

Scale 2 Chains to an Inch