

Wolven

195.

PREVIOUS IMAGE REPEATED

M

Notes
105.

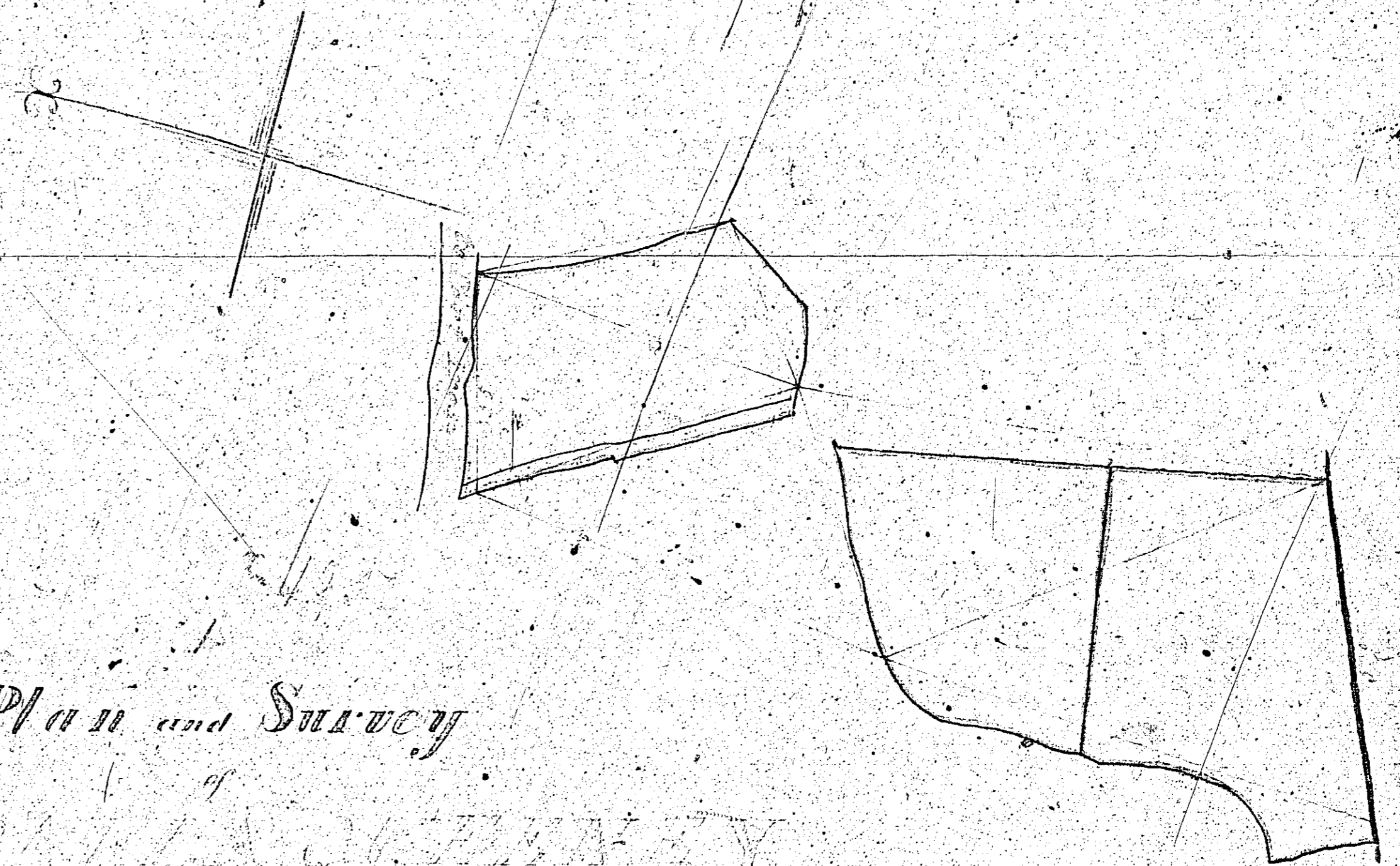

Plan and Survey
of
the
Estate

M^r Tho^s Taylor
1710

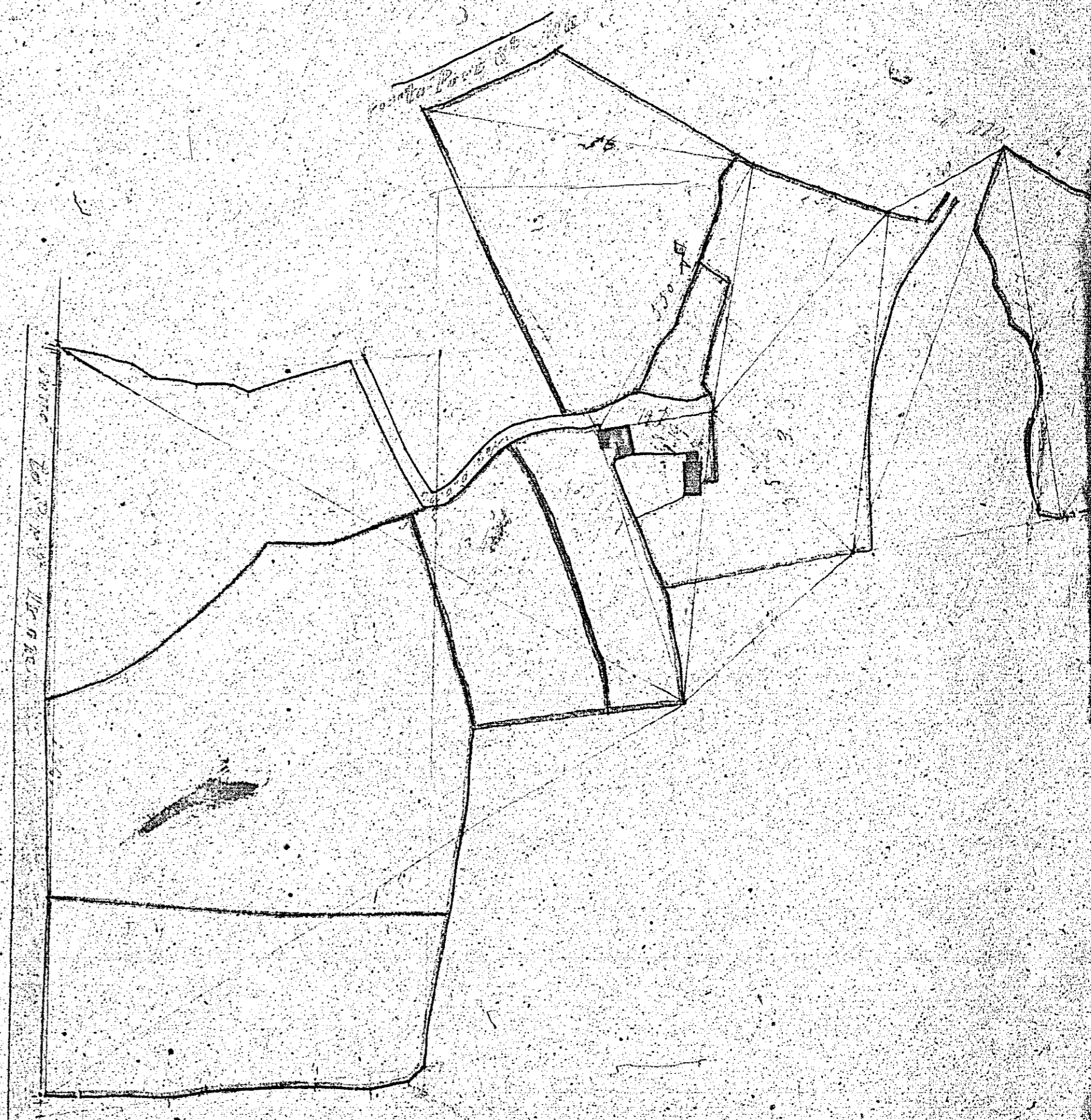

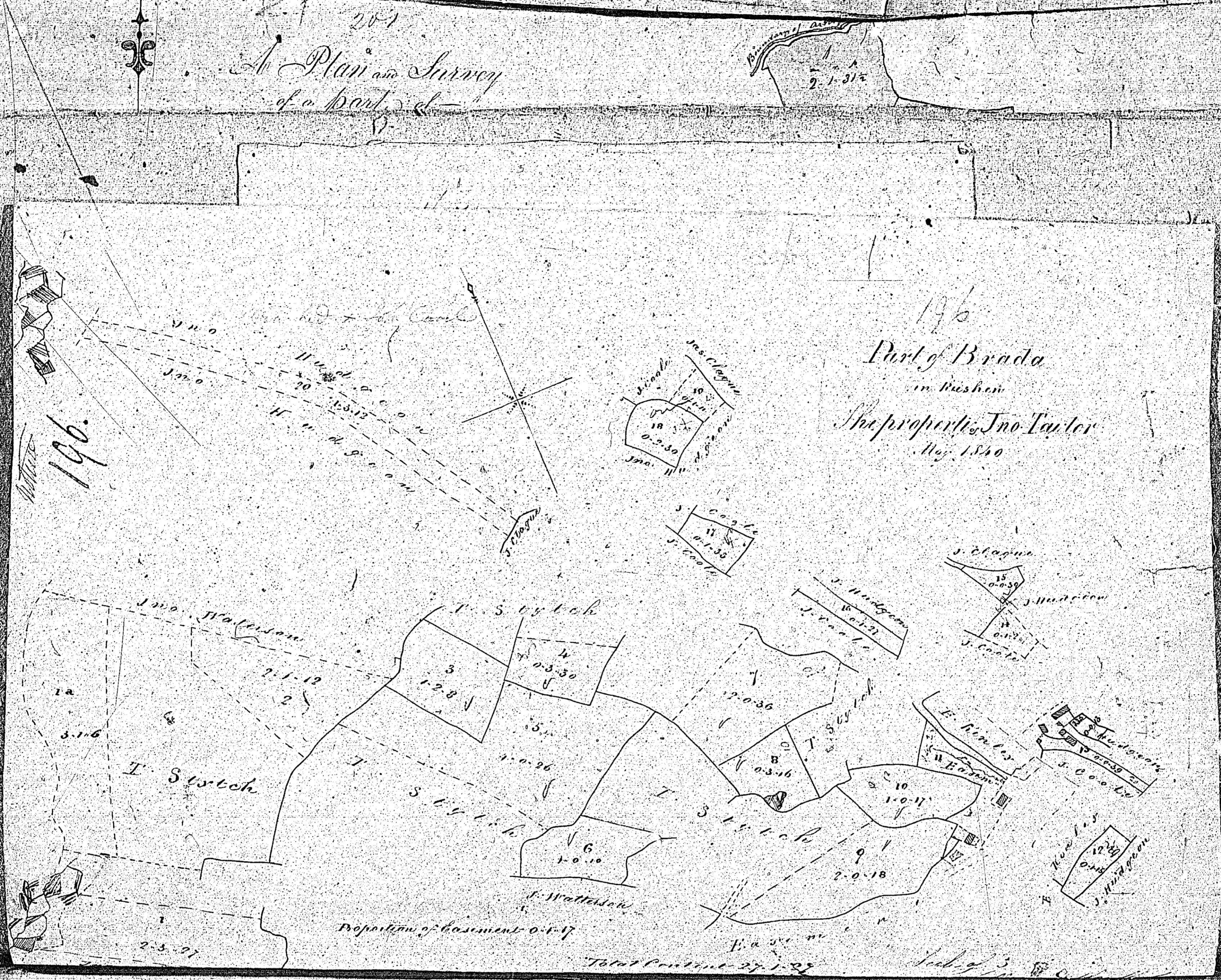

ISLE OF MAN GOVERNMENT: GENERAL REGISTRY

TITHE PLANS: PARISH OF RUSHEN

Original monotone

1:30

207
A Plan and Survey
of a part of the

1
2
3
4
5
6
7
8
9
10
11
12
13
14
15
16
17
18
19
20
21
22
23
24
25
26
27
28
29
30
31
32
33
34
35
36
37
38
39
40
41
42
43
44
45
46
47
48
49
50
51
52
53
54
55
56
57
58
59
60
61
62
63
64
65
66
67
68
69
70
71
72
73
74
75
76
77
78
79
80
81
82
83
84
85
86
87
88
89
90
91
92
93
94
95
96
97
98
99
100

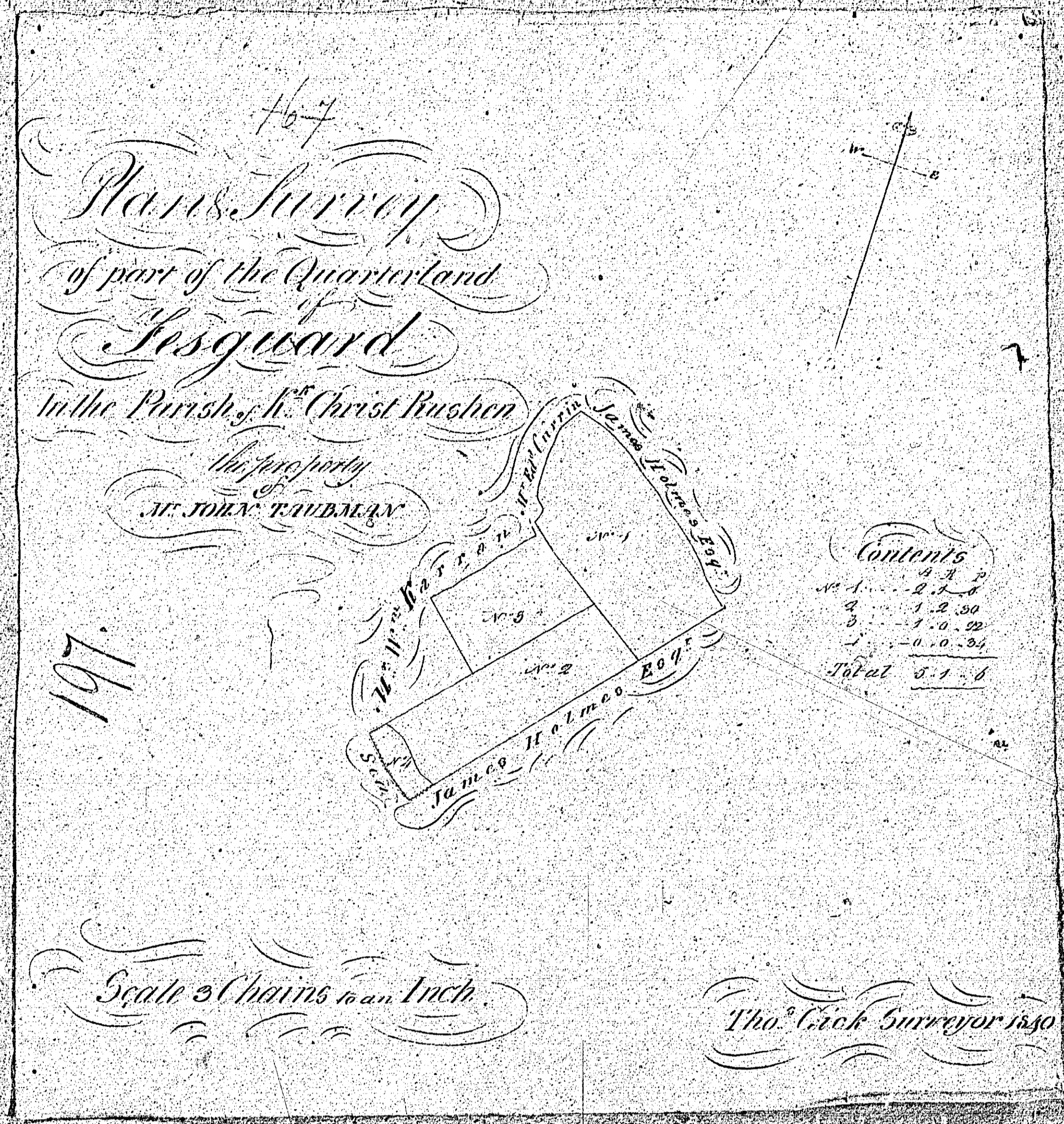

ISLE OF MAN GOVERNMENT: GENERAL REGISTRY
TITHE PLANS: PARISH OF RUSHEN
Original coloured (decorative), faint

198.

Plan
of part of the Quarterlands
of
Greegreash
in the Parish of
St. Christ Rushen
(the property)
M^r J. Gaultman

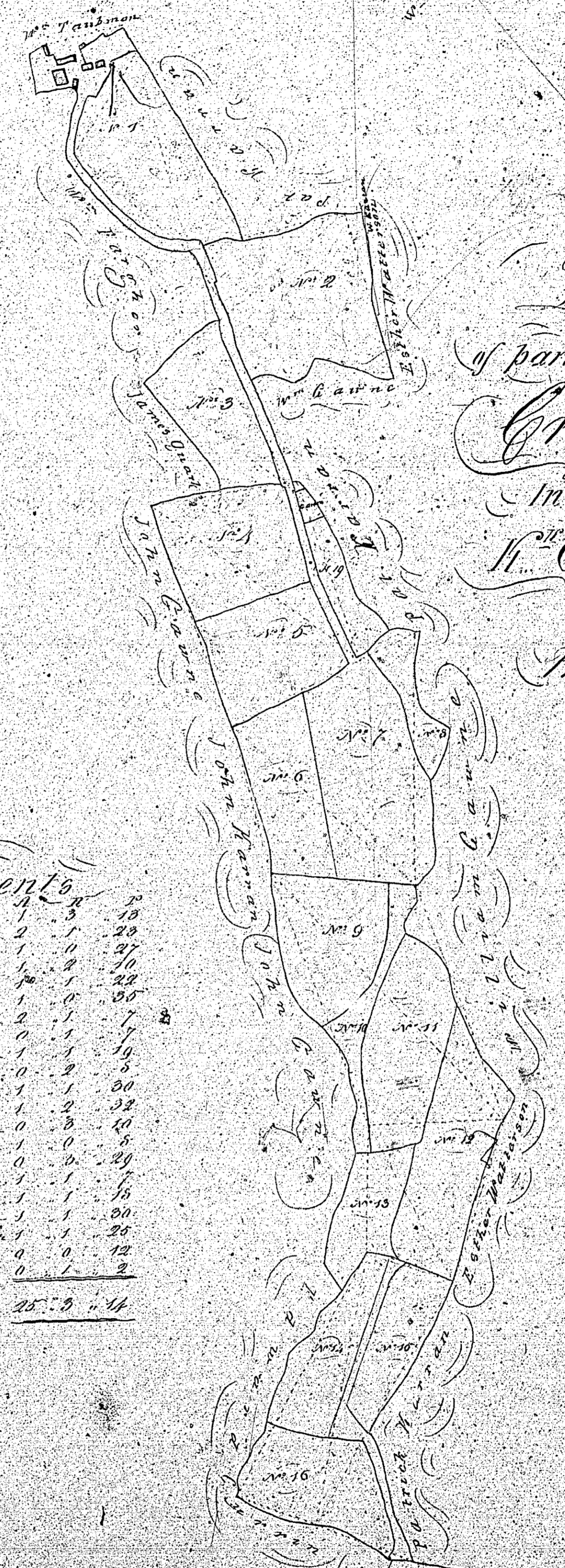

Contents

1	1	5	18
2	1	1	20
3	1	1	27
4	1	1	30
5	1	1	22
6	1	1	35
7	1	1	7
8	1	1	19
9	1	1	5
10	1	1	30
11	1	1	32
12	1	1	10
13	1	1	8
14	1	1	20
15	1	1	18
16	1	1	20
17	1	1	18
18	1	1	28
House & Roads	1	1	12
Garden	0	0	2
19	0	1	2
Total	25	5	14

Scale 5 Chains to an Inch

Mr. Gaultman's survey

The Clerk Surveyor



199.

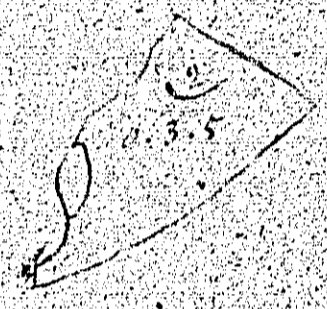

199

The Lands of Mrs Taylor (Carron)
 and wife in Ballachul parish
 in Kirk Christ Church
 surveyed May 1840
 by A. Cleeve

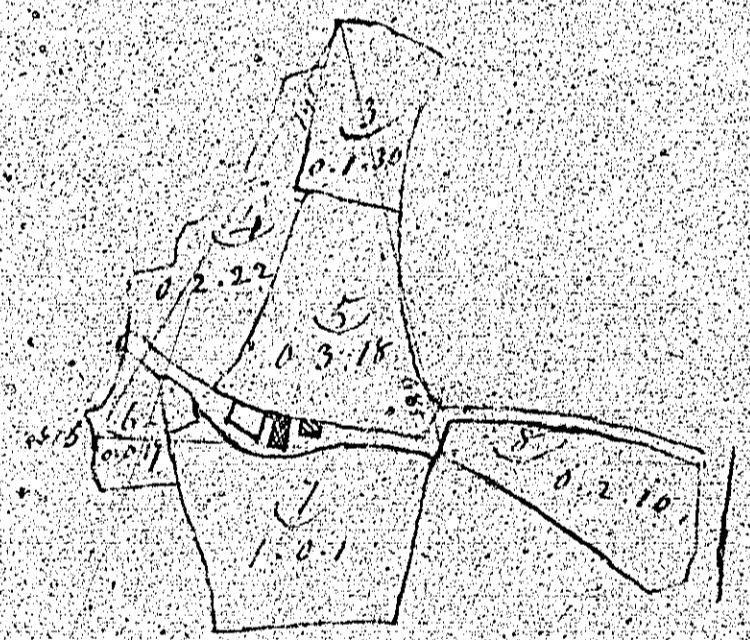

1	4-1-10
2	1-1-12
3	3-5
4	1-30
5	2-22
6	3-18
7	17
8	1-0-1
	2-20
North House	1-12
2 quarters	6-0-17
	6-0-17

1940
 A. Cleeve
 of the parish of

1940
 6-0-17