

ISLE OF MAN GOVERNMENT: GENERAL REGISTRY

TITHE PLANS: PARISH OF RUSHEN

Original monotone

1:30

158

Part of 158

Sirby Moor Quarterland
 Situate in Rushen
 The Property of Mr Peter Moore
 13th Dec^r 1771 (As given June 18th 1768)

1	2.3	26 1/2
2	1.2	38 1/2
Total		2.75 1/2

Scale of 2 chains to the inch

159

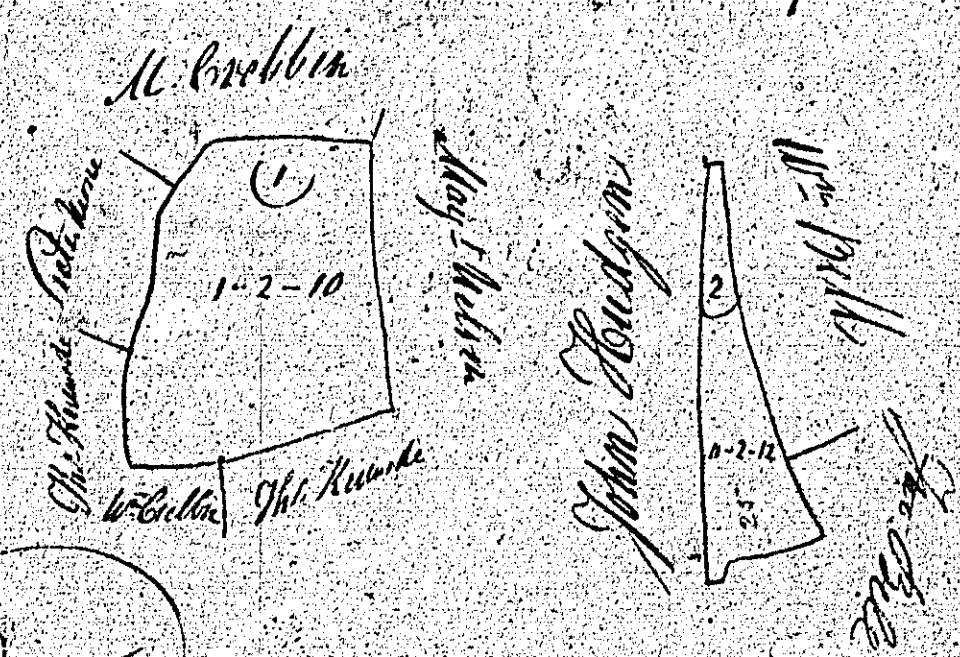

159

in part of the
Estate of Ballagheen
in the
Parish of Rushmore
the property of
Mr. John Crobbin
June 1840

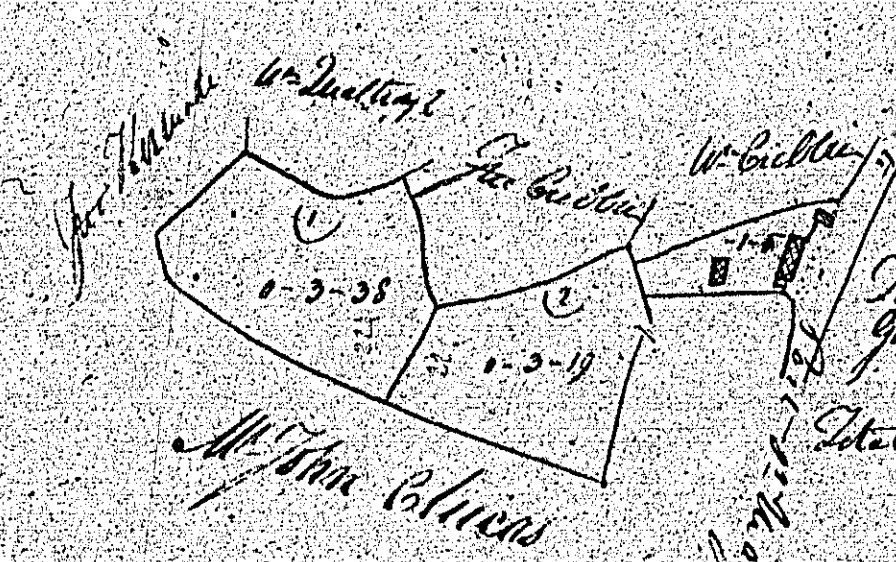

Reference
A.R.O.

1	1-2-11
2	2-12
3	1-0-22
4	0-3-38
5	3-14
6	The plot 1-3-19
7	1-3-14
8	2-0-32
9	1-0-32
10	1-1-14

Three Chats to be Tack

Joseph Blake Survey

Part of Shenualley in Rushen
belonging to Wm. Radcliffe May 1840.

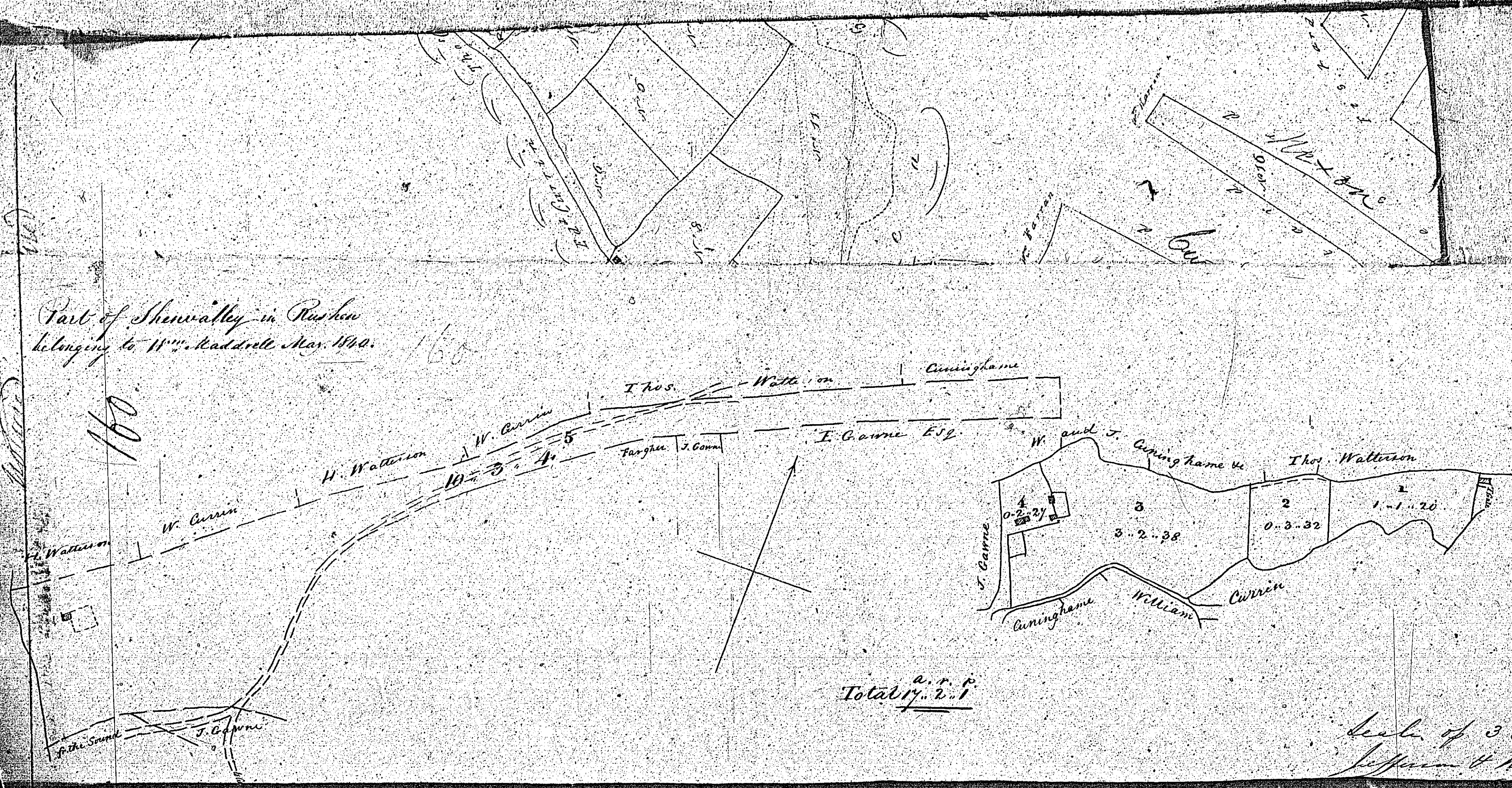

Leaf of 3 Sheets
Supplied to Mr. Radcliffe

ISLE OF MAN GOVERNMENT: GENERAL REGISTRY

TITHE PLANS: PARISH OF RUSHEN

Original monotone

1:30

Part of Ballinacrow, in Parishes
belonging to M^r. Talbot May. 1840.

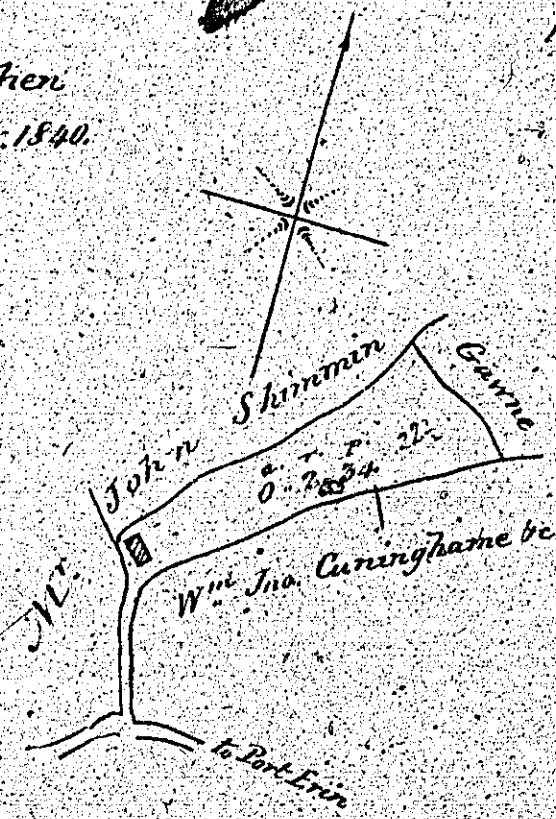

Scale of 3 Chains

J. J. Talbot & Co. Surveyors