

7/11/1840

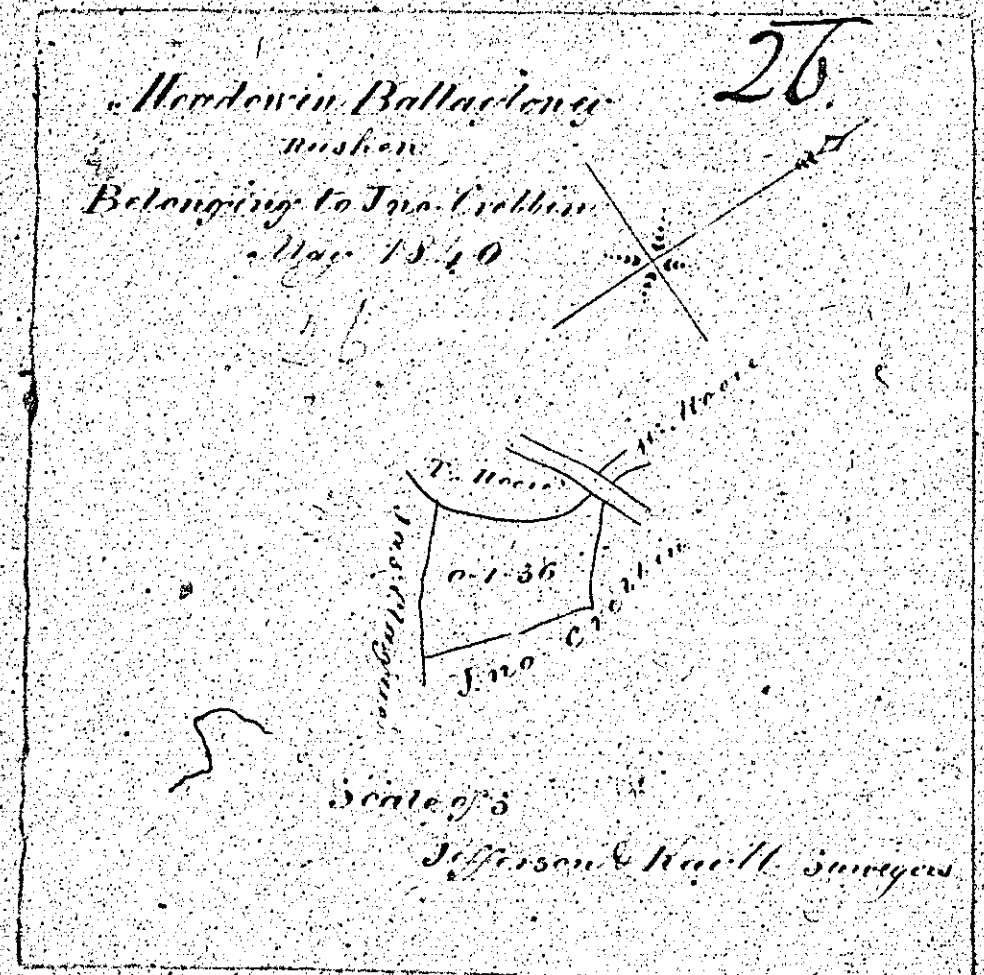

26

1
2
3
4
5
6
7
8
9
10
11
12
13
14
15
16
17
18
19
20
21
22
23
24
25
26
27
28
29
30
31
32
33
34
35
36
37
38
39
40
41
42
43
44
45
46
47
48
49
50
51
52
53
54
55
56
57
58
59
60
61
62
63
64
65
66
67
68
69
70
71
72
73
74
75
76
77
78
79
80
81
82
83
84
85
86
87
88
89
90
91
92
93
94
95
96
97
98
99
100

1
2
3
4
5
6
7
8
9
10
11
12
13
14
15
16
17
18
19
20
21
22
23
24
25
26
27
28
29
30
31
32
33
34
35
36
37
38
39
40
41
42
43
44
45
46
47
48
49
50
51
52
53
54
55
56
57
58
59
60
61
62
63
64
65
66
67
68
69
70
71
72
73
74
75
76
77
78
79
80
81
82
83
84
85
86
87
88
89
90
91
92
93
94
95
96
97
98
99
100

9A 1840

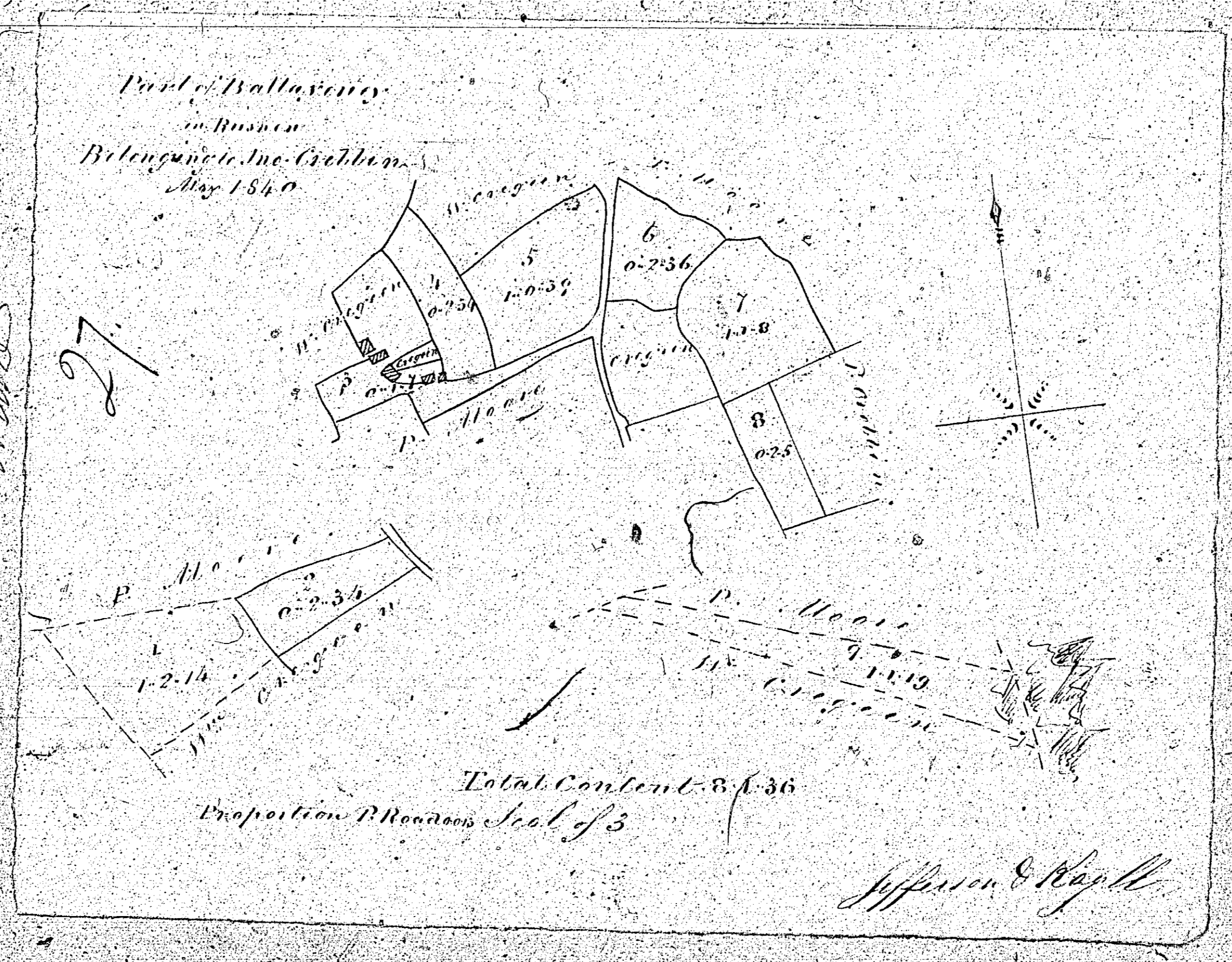

ISLE OF MAN GOVERNMENT: GENERAL REGISTRY
 TITHE PLANS: PARISH OF RUSHEN
 Original monotone 1:30

9 A. 1000

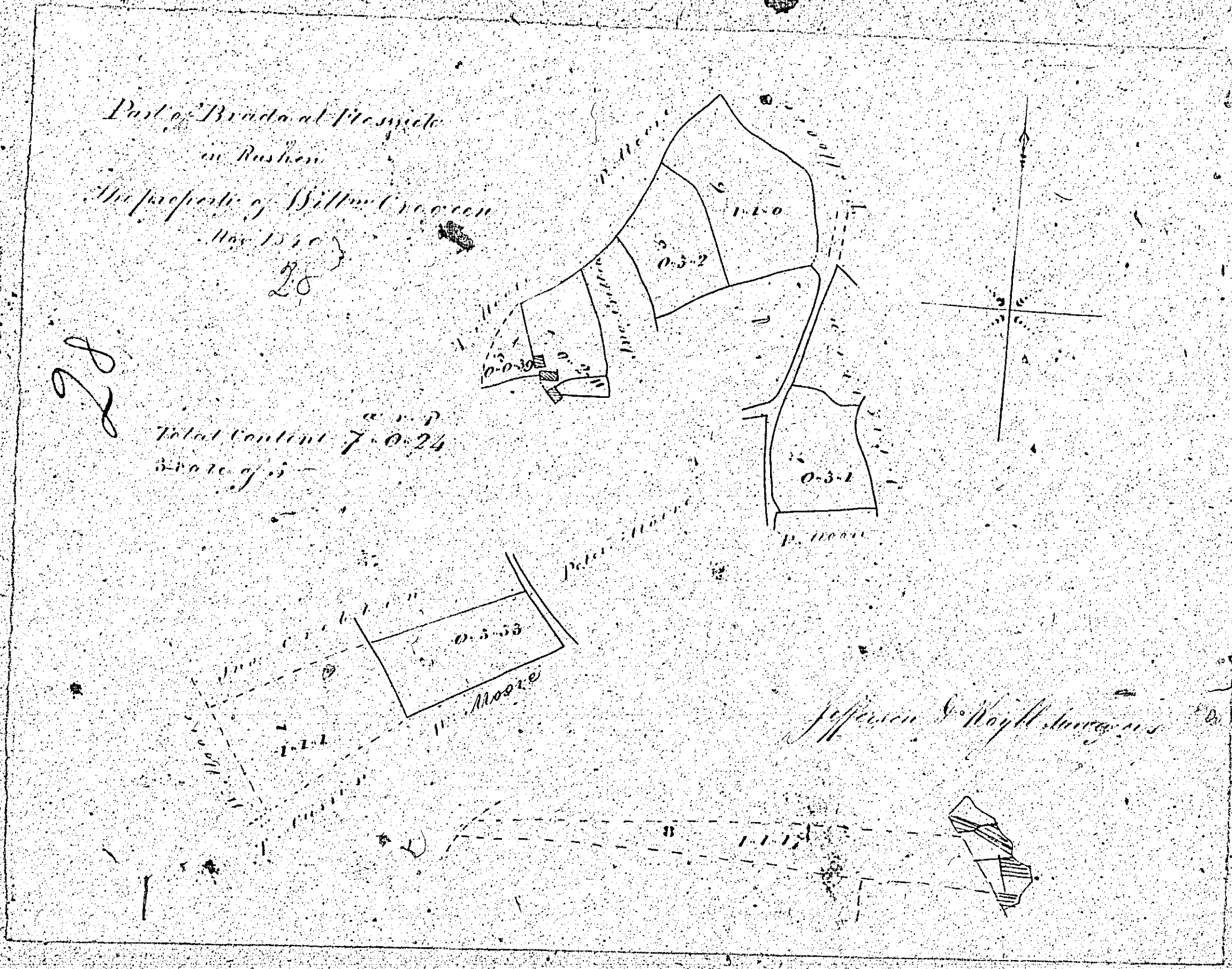

ISLE OF MAN GOVERNMENT: GENERAL REGISTRY
 TITHE PLANS: PARISH OF RUSHEN
 Original monotone 1:30

29 March

The Land of Mr. John Cairne
of Croft-Caley in Scotland
Surveyed 1836 by J. Craig

1	2-1-23
2	2-2-2
3	2-2-10
4	2-3-8
5	3-4
6	2-0-6
7	1-0-6
8	1-2-1
9	1-2-11
10	2-3-15
11	3-3-8
12	3-1-8
13	3-2-0
14	5-0-19
15	1-3-0
Total	24-8-79

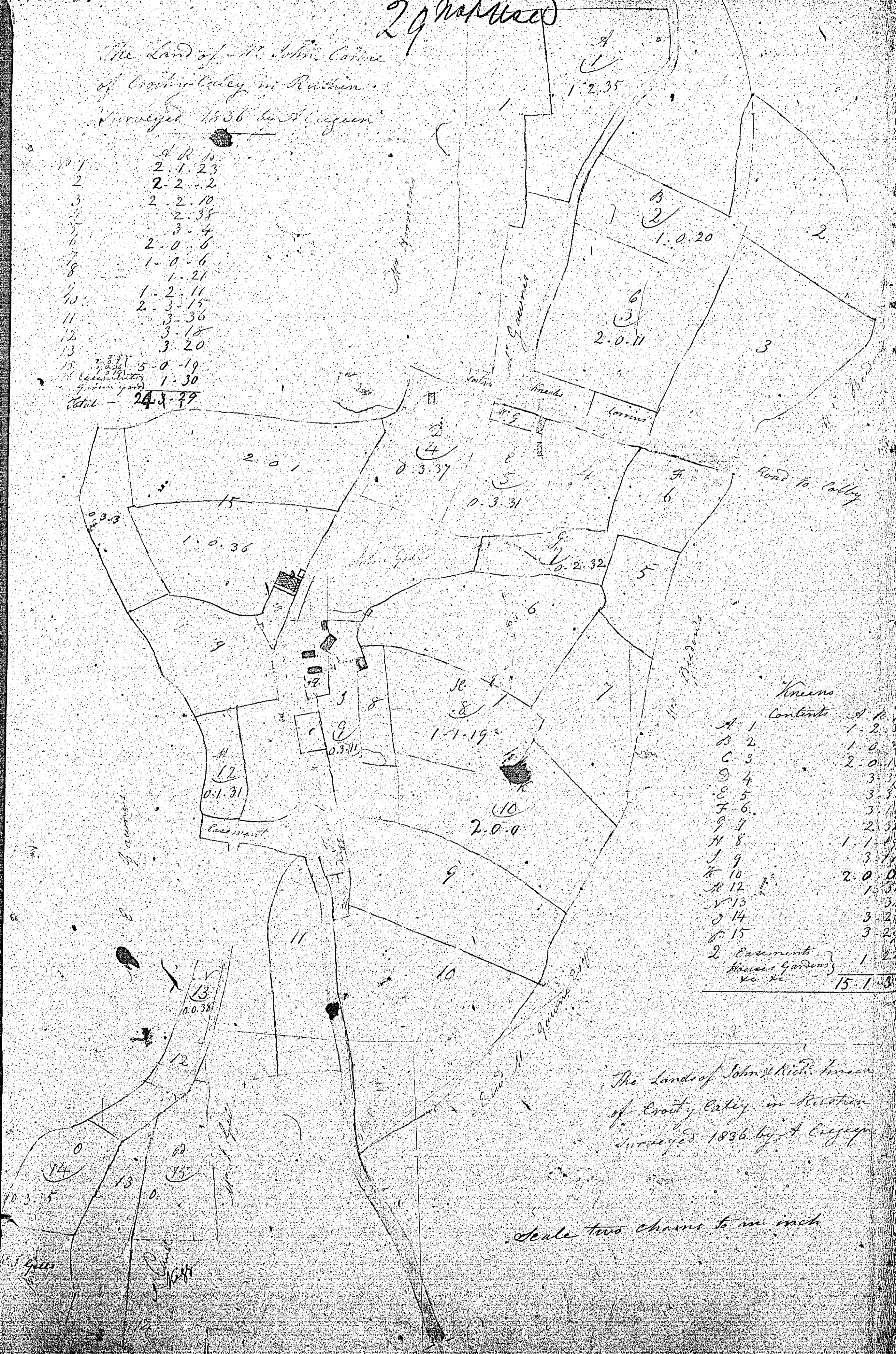

Contents	A. P.
A 1	1-2-35
B 2	1-0-20
C 3	2-0-10
D 4	3-3-8
E 5	3-3-8
F 6	3-3-8
G 7	2-3-2
H 8	1-1-15
I 9	3-1-17
K 10	2-0-0
L 12	1-3-8
M 13	3-3-8
N 14	3-3-8
O 15	3-2-4
2 Gardens	1-2-2
xc xi	15-1-33

The Land of John & Richard Cairne
of Croft-Caley in Scotland
Surveyed 1836 by J. Craig

Scale two chains to an inch

30

PLAN AND SURVEY
 Of Part Of
Ballinacorney Quarterland
 AND INTACK
in Presher
 The Property of
James & Henry Gawn
 1856

Contents
 Henry Gawn's Fields are marked red

1	R	1
1	0	0
0	3	9
0	1	20 1/2
1	1	33 1/2
0	3	
1	2	
1	0	5
1	0	32 1/2
0	0	7 1/4
10	0	28
0	2	2 1/4
Total		8 1 7 1/2

Contents of Enclosures which is undivided between both

N ^o	A	R	P
1	Meadow	0	0 20 1/2
2	Small Garden	0	0 9
3	House	0	1 10 1/2
4	Meadow	0	1 10 1/2
TOTAL		0	3 10 1/2

Wm Crebbins Contents

N ^o	A	R	P
1		0	2 2 1/2
2		0	3 10
3		0	1 2 1/2
4		0	1 10 1/2
5		0	3 20 1/2
6		0	3 10 1/2
7		0	1 10 1/2
8		0	1 10 1/2
9		1	0 7 1/2
10		0	1 10 1/2
11		0	2 20 1/2
12	Garden	0	0 30
Total		1	1 10

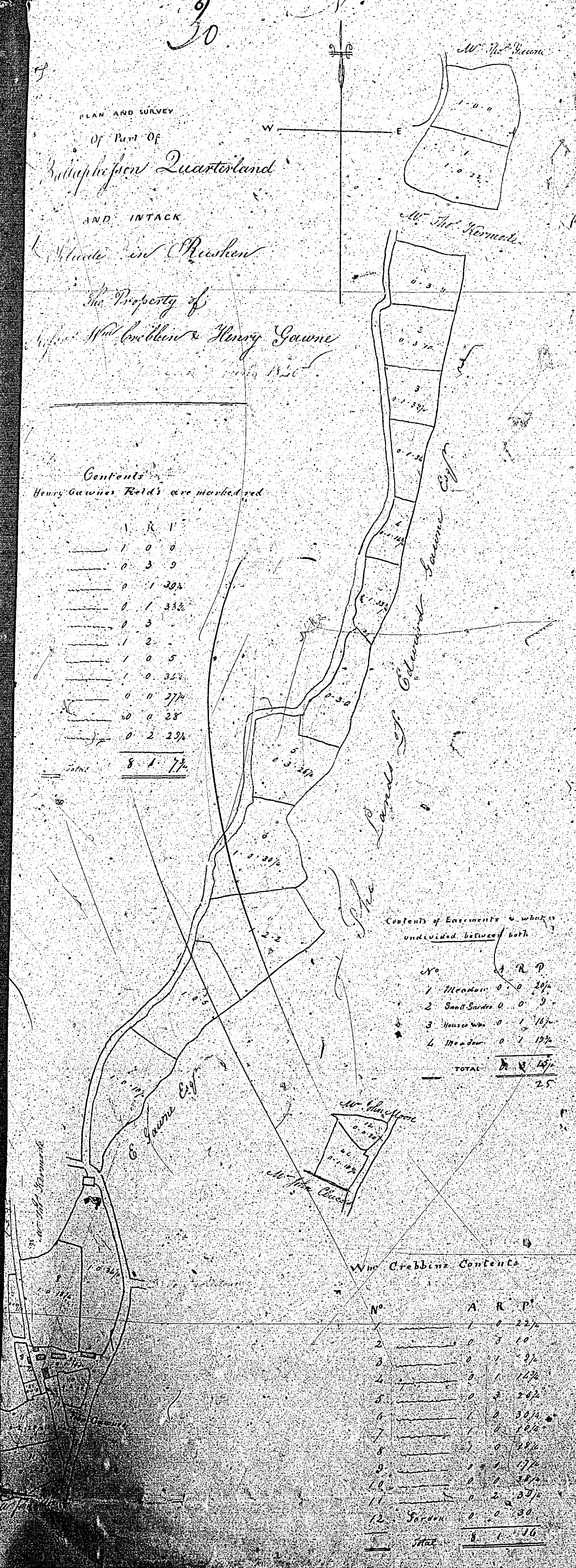

WELLS

Plan of the Property of John Coole
and Thomas Gawn (Balapherson)
in the Parish of Kesh
Quarterland except 2 fields No 14 & 15

The Black Ink numbers answers for John Coole
and the red Ink numbers answers for Thomas Gawn

31. 31.

Contents of John Coole's

No.	A.	R.	P.
1	0	3	30
2	0	0	34
3	1	0	20
4	0	3	35
5	0	2	15
6	1	2	5
7	1	0	37
8	1	1	14
9	0	3	5
10	0	3	37
11	1	0	10
12	0	2	20
13	0	2	10
14	0	2	28
	12	0	70

House garden and easements and private roads 0 2 20
Total 12 2 30

Contents of Thomas Gawn's

1	0	3	30
2	0	5	11
3	0	5	15
4	0	3	39
5	1	5	3
6	0	2	50
7	1	2	14
8	0	2	10
9	0	3	18
10	0	2	14
	1	0	10

House garden & easements and private roads 0 2 10
Total 1 0 10

