

**PLAN and Survey**  
 of part of the Quarterland of Ballanahy  
 in the parish of K.K. Patrick  
 the property of  
 Catherine, Margaret, and Isabella Quirk

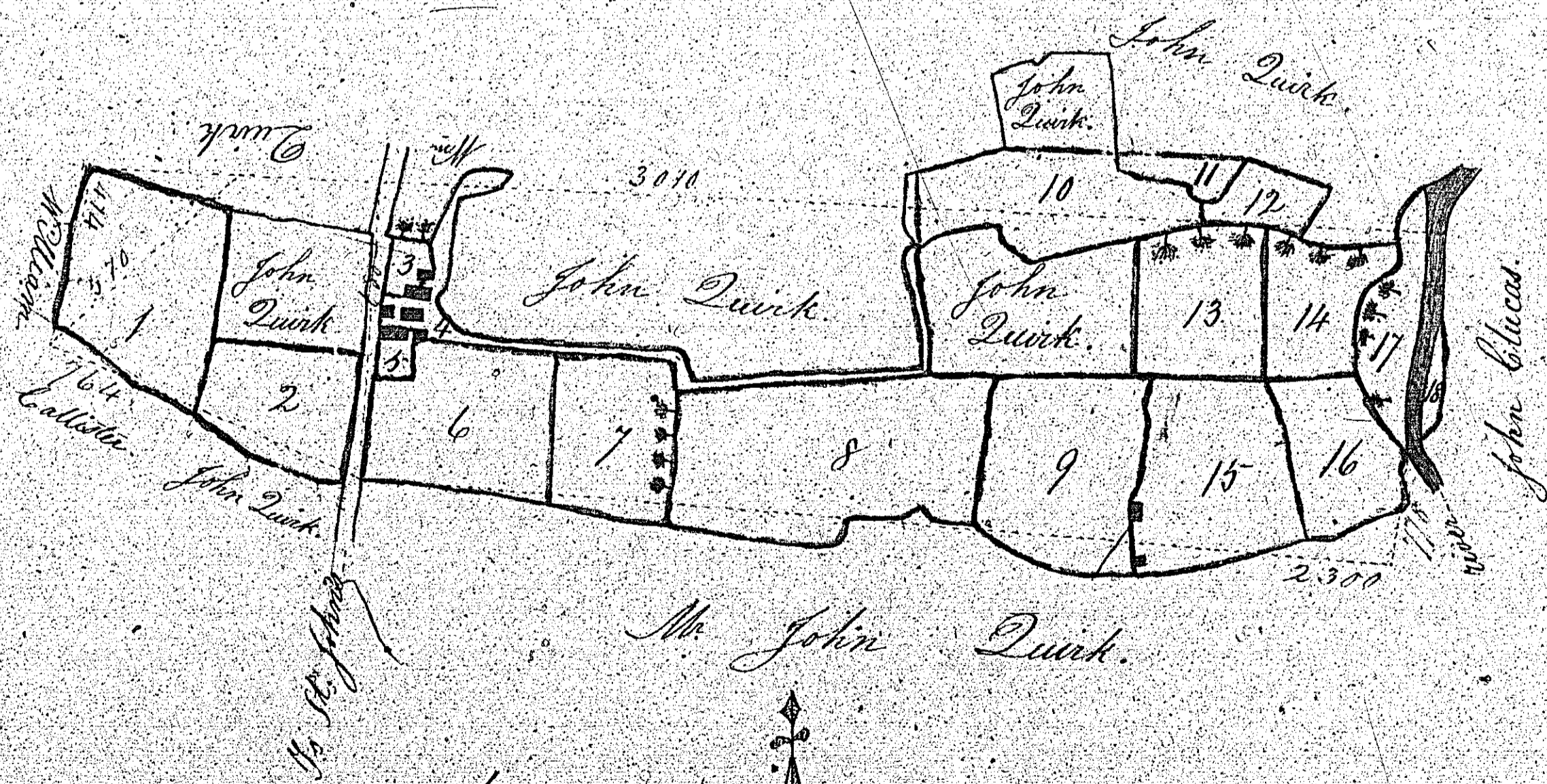

Reference.			
No.	a.	r.	p.
1	1	2	6
2	0	3	24
3	0	0	16
4	0	2	12
5	0	0	12
6	1	1	14
7	1	0	3
8	2	1	25
9	1	2	5
10	1	0	19
11	0	0	31
12	0	1	11
13	1	0	31
14	0	2	26
15	1	1	35
16	0	3	6
17	0	2	1
18	0	0	13
	15	3	10
Deduct	0	1	20
Total Content	15	1	30

*N.B. The one half of Numbers 3, 4 and 5  
 belongs to John Quirk which we deduct  
 as above to find the total Content of  
 this Estate.*

0 1 2 3 4 5 6 7 8 9 10 Chains

Surveyed May 1840.  
 By William Haighin  
 R.H. Geaman.

L 7

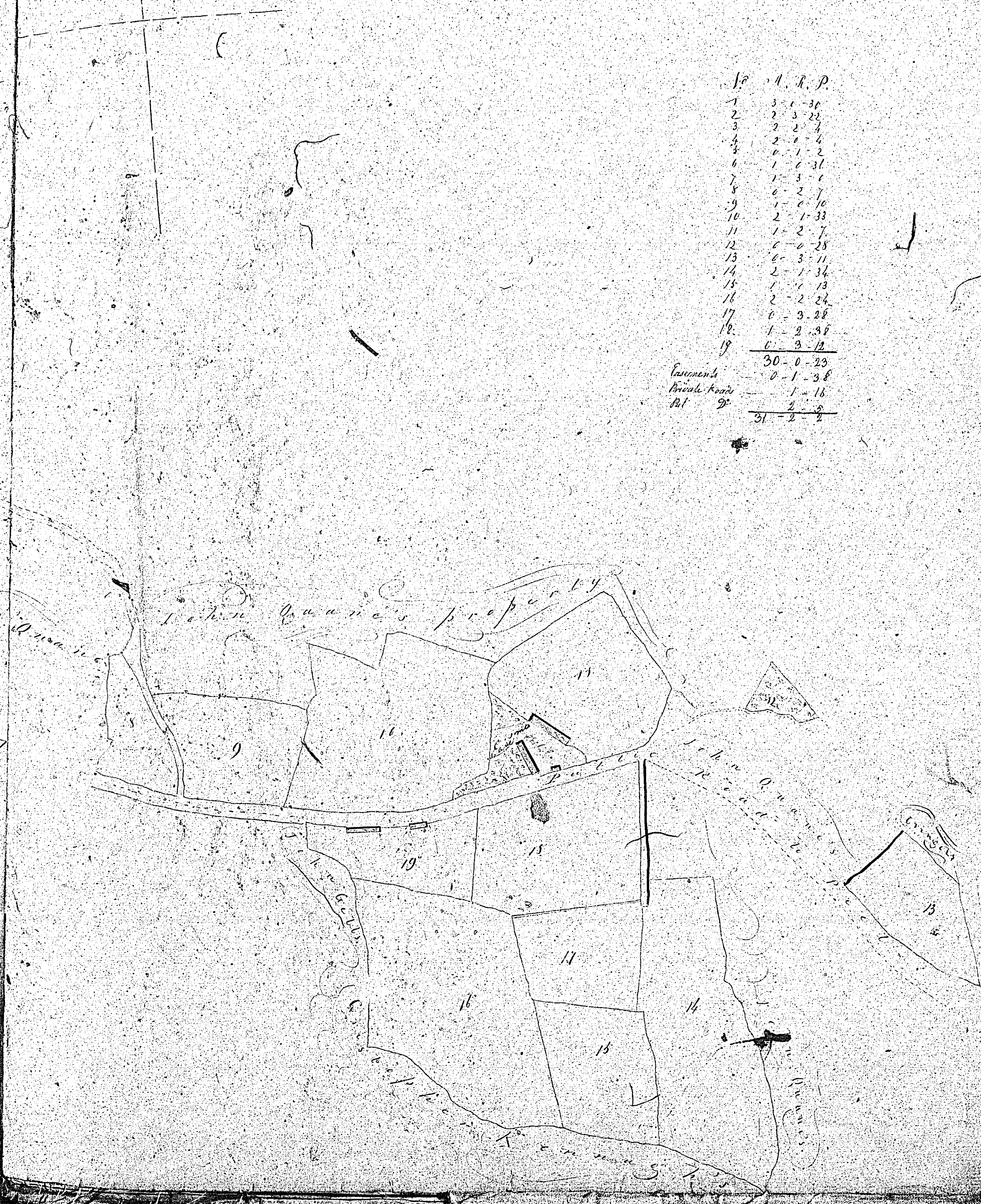
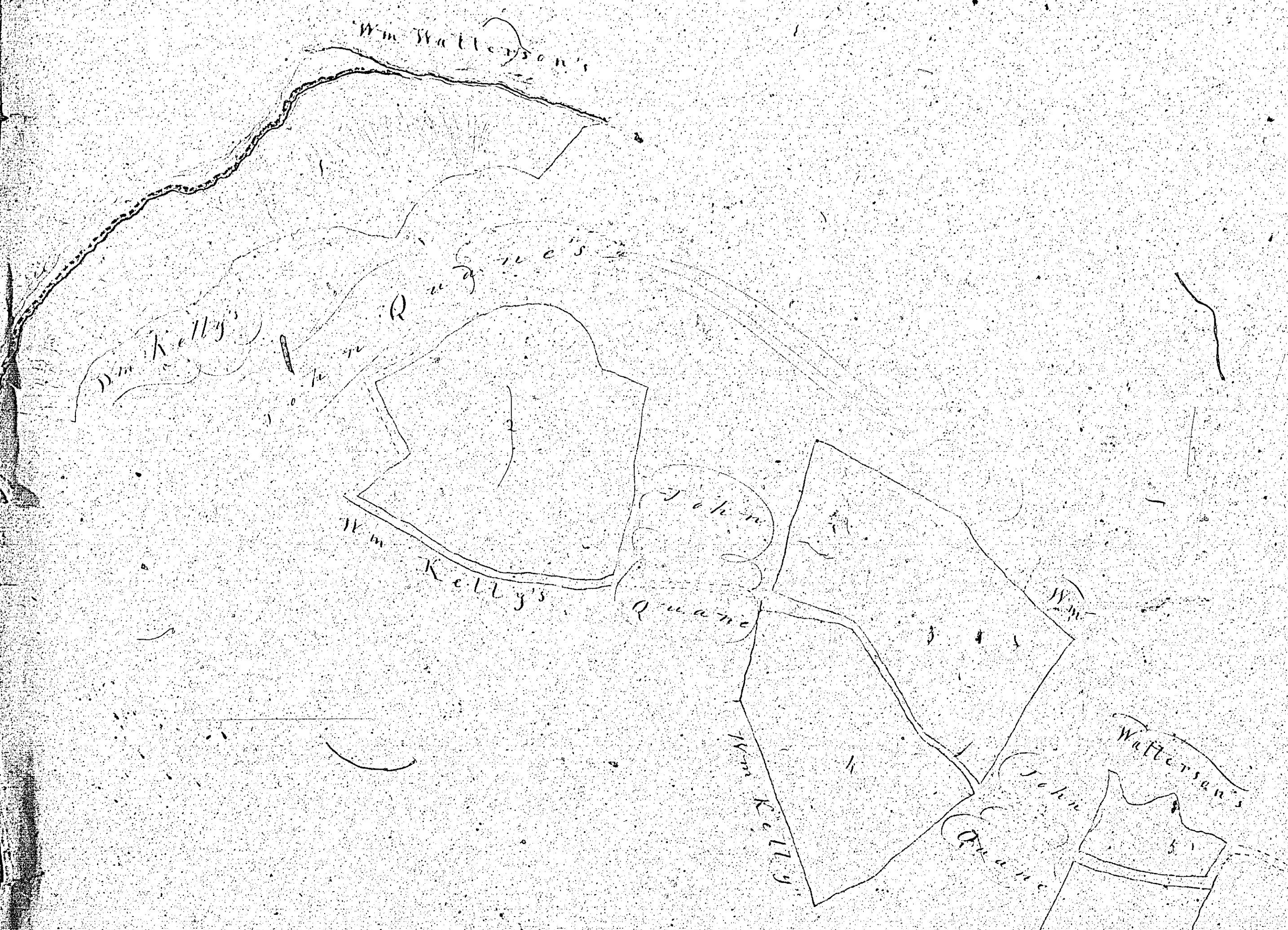
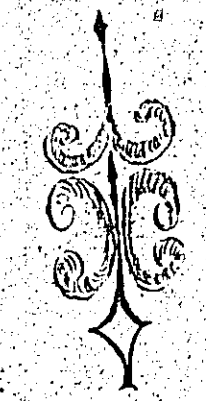

No	A.	R.	P.
1	3	1	36
2	2	3	22
3	2	2	4
4	2	1	4
5	0	1	2
6	1	6	31
7	1	3	1
8	6	2	7
9	1	6	10
10	2	1	33
11	1	2	7
12	6	0	28
13	6	3	11
14	2	1	34
15	1	1	13
16	2	2	24
17	6	3	28
18	1	2	39
19	6	3	12
Sum			30-0-23
Lands			0-1-38
Bills			1-16
Total			31-2-2

Plan of part of  
 Ballacrink  
 Quarterland  
 Parish of Patrick  
 Between Wm Quirk sen<sup>r</sup>  
 & Wm Quirk Jun<sup>r</sup>

Scale of Chains  
 Surveyed May 1840 by Thomas J. Dorr

PLAN and Survey  
of part of the Quarterland of Ballymash  
In the parish of St. Patrick  
The property of  
Mr. John Quirk

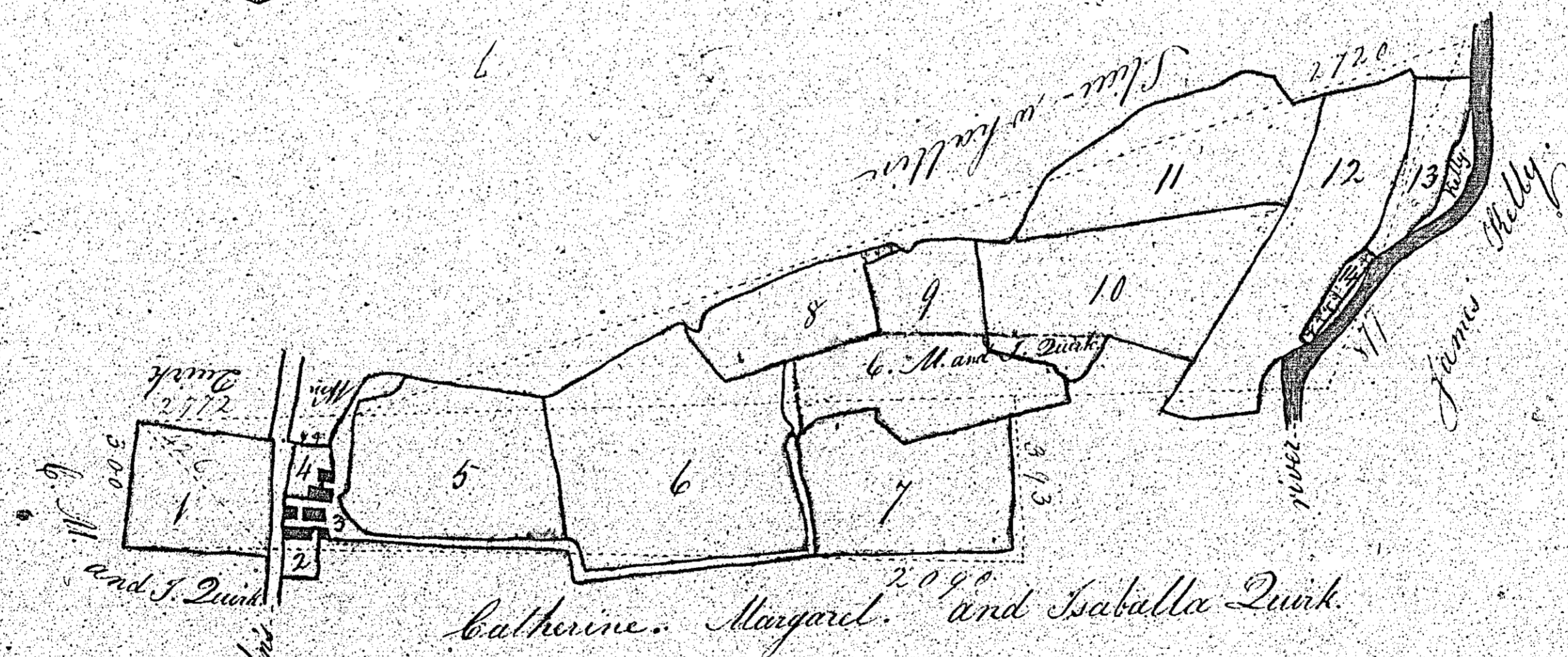

Reference			
No.	Ac.	R.	P.
1	0	3	33
2	0	0	12
3	0	2	12
4	0	0	16
5	1	2	35
6	2	2	27
7	1	1	31
8	0	3	30
9	0	2	33
10	1	2	37
11	1	2	29
12	1	2	31
13	0	1	31
14	0	0	13
14	3	10	
Deduct	0	1	20
Total Content	14	1	30

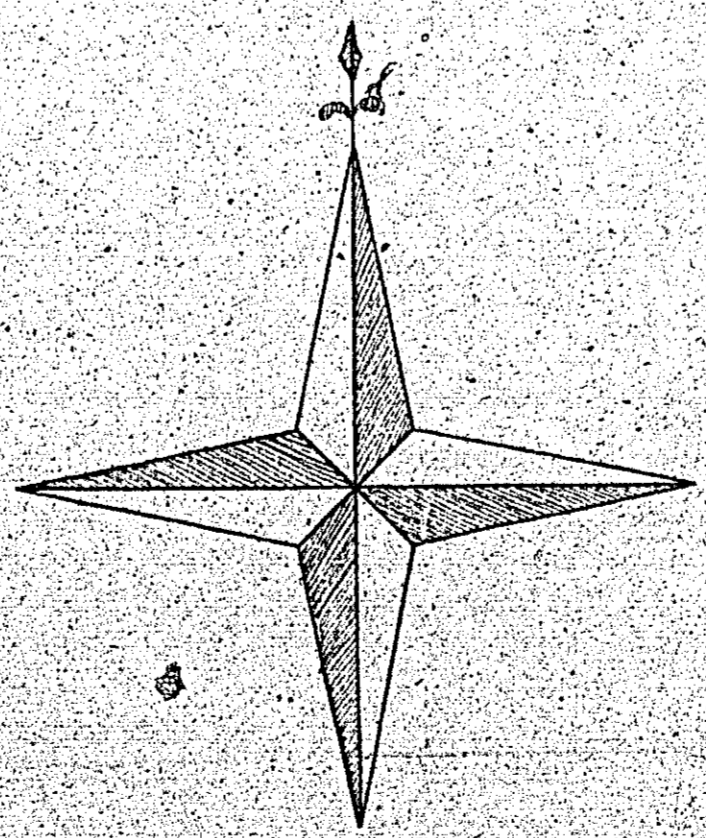

0 1 2 3 4 5 6 7 8 9 10 Chains.

N. B. - One half of Numbers 2, 3, and 4, belongs to Catherine, Margaret, and Isabella Quirk, which we deduct as above.

Surveyed May 1840.  
by William Haighin  
W. H. German

128

121

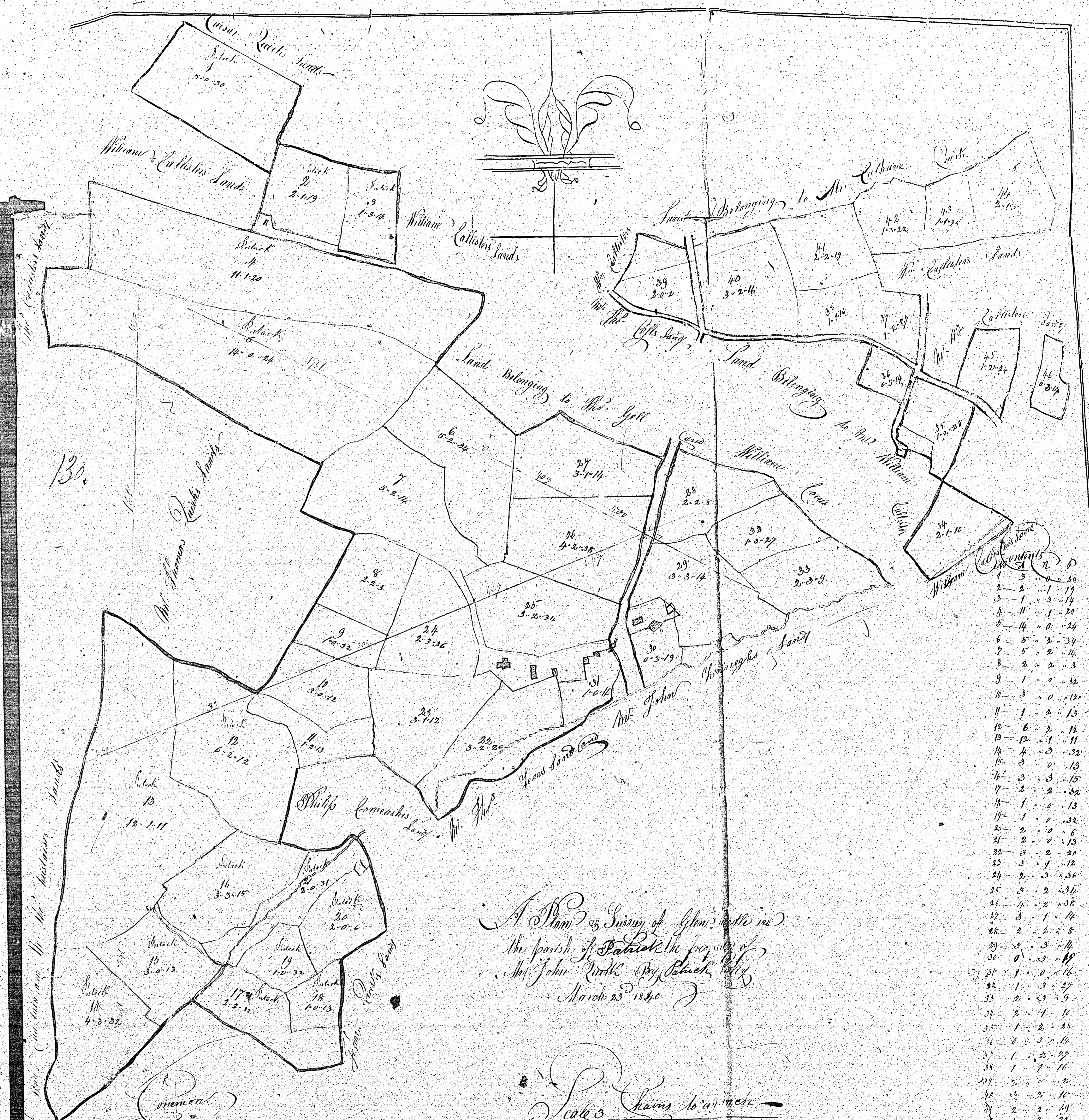

A Plan or Survey of Grounds in  
the Parish of Patrick the property of  
Mr. John White, By Robert White  
March 23. 1840

Scale 3 Chains to an inch

1	3	0	50
2	2	1	19
3	1	3	14
4	11	1	20
5	14	0	24
6	5	2	34
7	5	2	14
8	2	2	3
9	1	0	32
10	3	0	120
11	1	2	13
12	6	2	11
13	12	1	11
14	4	3	32
15	3	0	13
16	3	3	15
17	2	2	32
18	1	0	13
19	1	0	32
20	2	0	6
21	2	0	13
22	3	2	20
23	3	1	12
24	2	3	56
25	3	2	34
26	4	2	36
27	3	1	14
28	2	2	8
29	3	3	14
30	0	3	18
31	1	0	16
32	1	3	27
33	2	3	9
34	2	1	11
35	1	2	25
36	1	3	16
37	1	2	27
38	1	1	11
39	2	0	2
40	1	2	16
41	2	2	19
42	1	3	22
43	1	1	35
44	2	1	5
45	1	2	26
46	0	3	14
47	2	2	38
48	1	3	16
49	2	3	39
50	2	3	33

130

Comstock

Stearns & Comstock 5  
White Road 0  
Houses 2  
Total 160

PLAN and Survey  
 of part of the Quarterland of the  
 Barrow doo Foxdale in the parish of  
 H. H. Patrick; the property of  
 Mr. William Quilliam.

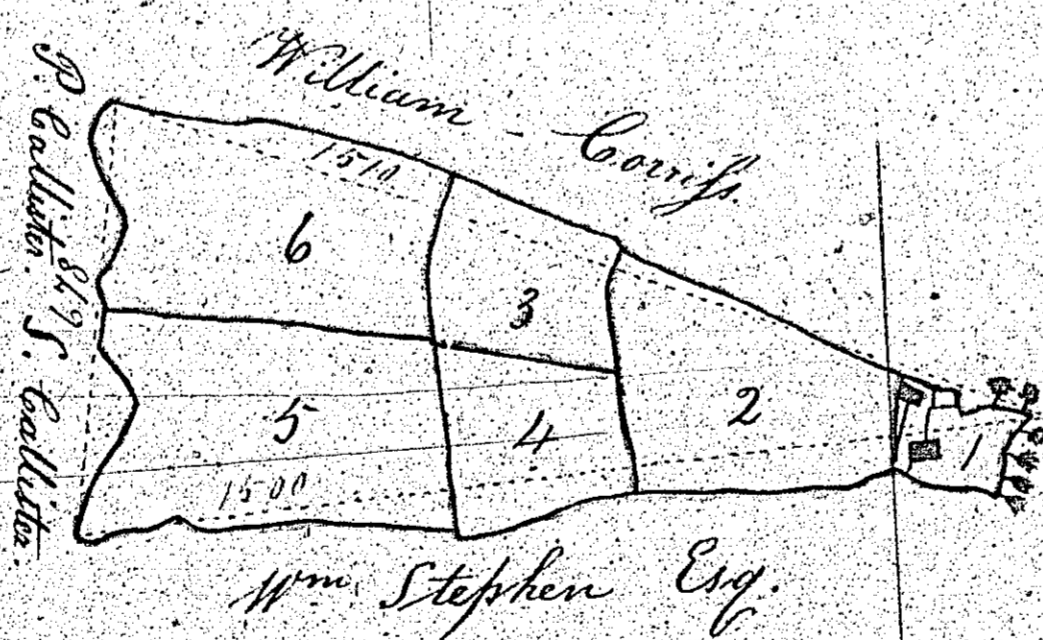

Reference.			
No.	a.	r.	p.
1	0	1	2
2	1	0	23
3	0	2	28
4	0	2	28
5	1	2	24
6	1	2	4
Total	5	3	29

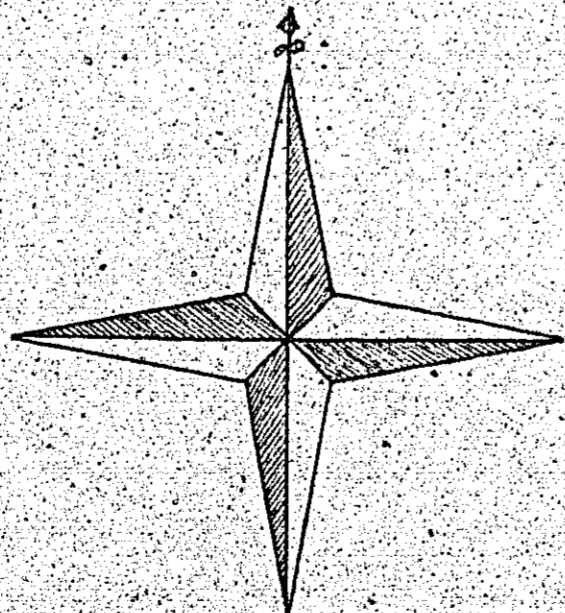

0 1 2 3 4 5 6 7 8 9 10 chains

Surveyed June 1840  
 by William Raighin  
 H. H. German

