

Isle of Man Government: General Registry

PLANS DEPOSITED IN THE  
ROLLS OFFICE  
UNDER THE  
TITHE COMMUTATION ACT  
1839

PARISH OF PATRICK

Volume **2**

**(101 - 180)**

Microfilm Data (IOM) Ltd., Alpine Mews,  
Strathallan Lane, Onchan, Isle of Man, IM3 1NL

May 1997



## NOTES

The plans have been filmed in their bound state

This will have caused some image distortion particularly where large plans go into the binding gutter and/or have been folded

Many of the larger plans are damaged

Where plans are coloured this has been noted; 'monochrome' indicates a single ink colour which may be black, brown or blue



START OF VOLUME



102.

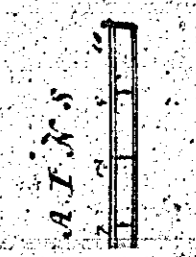
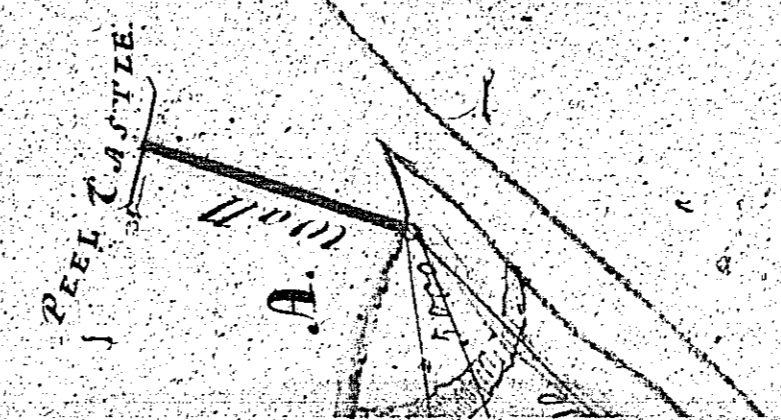

Plan no 101 is in the previous  
 volume on same plan  
 as 55 & 56

PLAN

Peel Will

In vol I of

No

g



6  
**PLAN**  
*Peel Hill*  
Belonging to  
*Lyon Esq*  
Formerly the property of the late  
*Archdeacon's Nylia*  
Horizontal Quantity 72.0.25

*Not his*

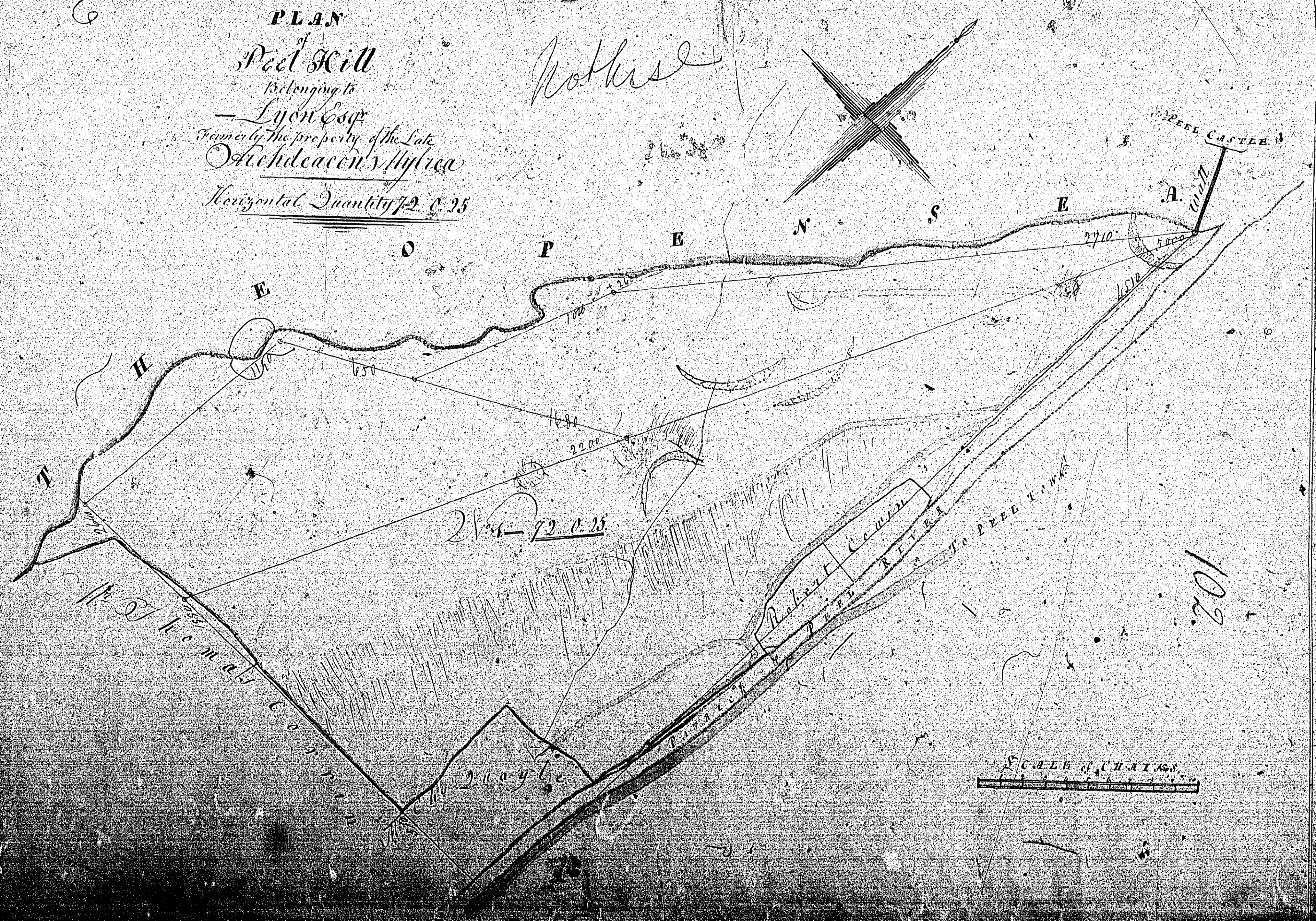

102

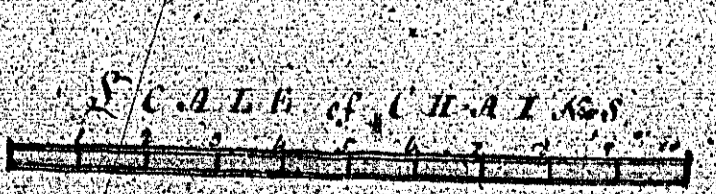



PLAN and Survey  
 of Inlath Land  
 In the Parish of St. Patrick  
 the property of  
 Mr. John Morrison

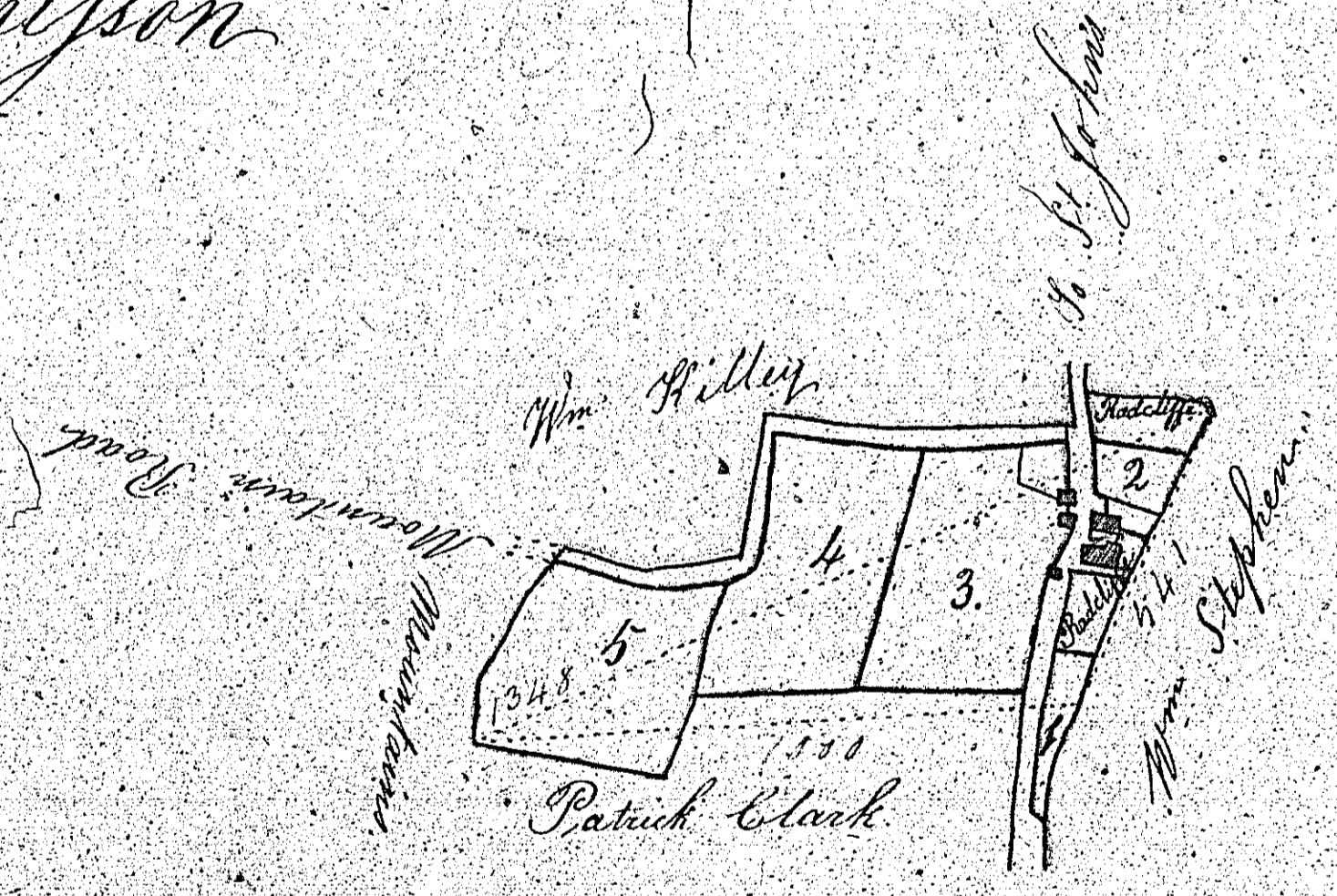
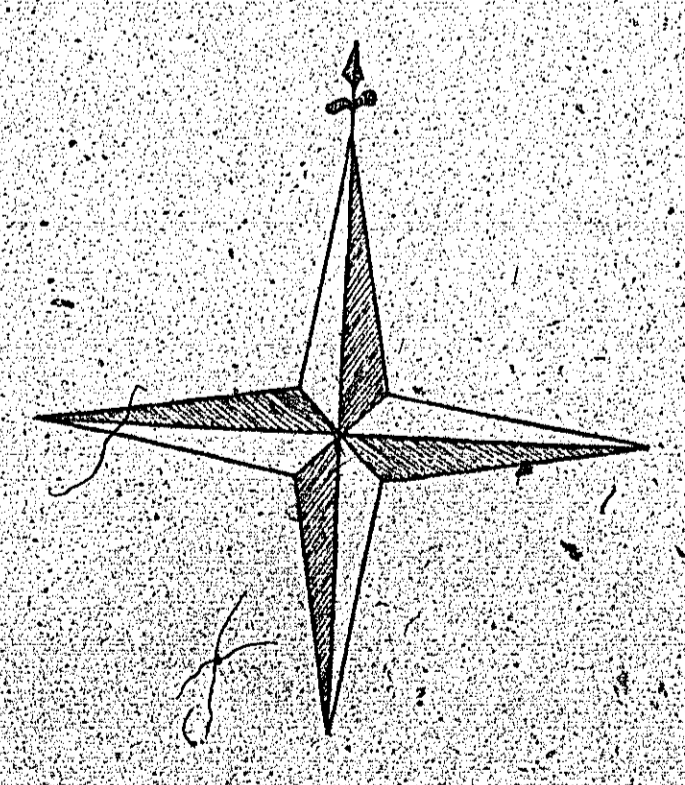

Reference.			
No.	Ac.	R.	P.
1	0	0	21
2	0	0	32
3	1	0	5
4	1	0	6
5	1	0	7
6	2	0	21
Total	5	2	12

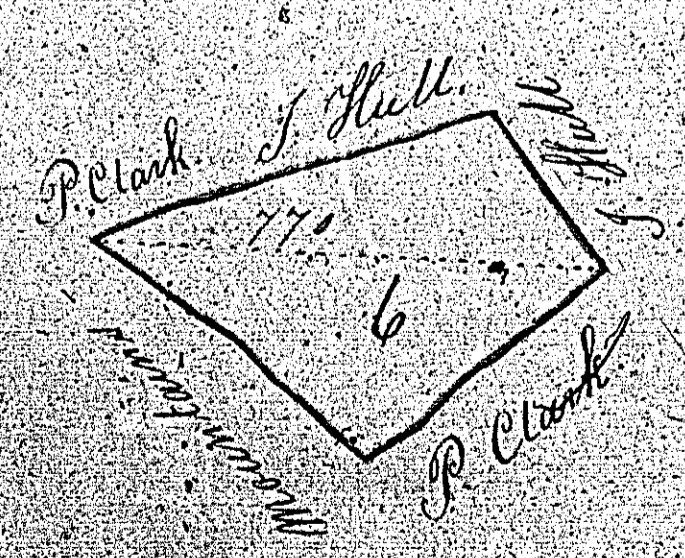

103

Surveyed June 1841  
 by William Hagler  
 H. G. Freeman