

ISLE OF MAN GOVERNMENT: GENERAL REGISTRY

TITHE PLANS: PARISH OF PATRICK

- 52 Original monotone 1.30
- 54 Original coloured
- 55, 56, 101 Original monotone (1 map)

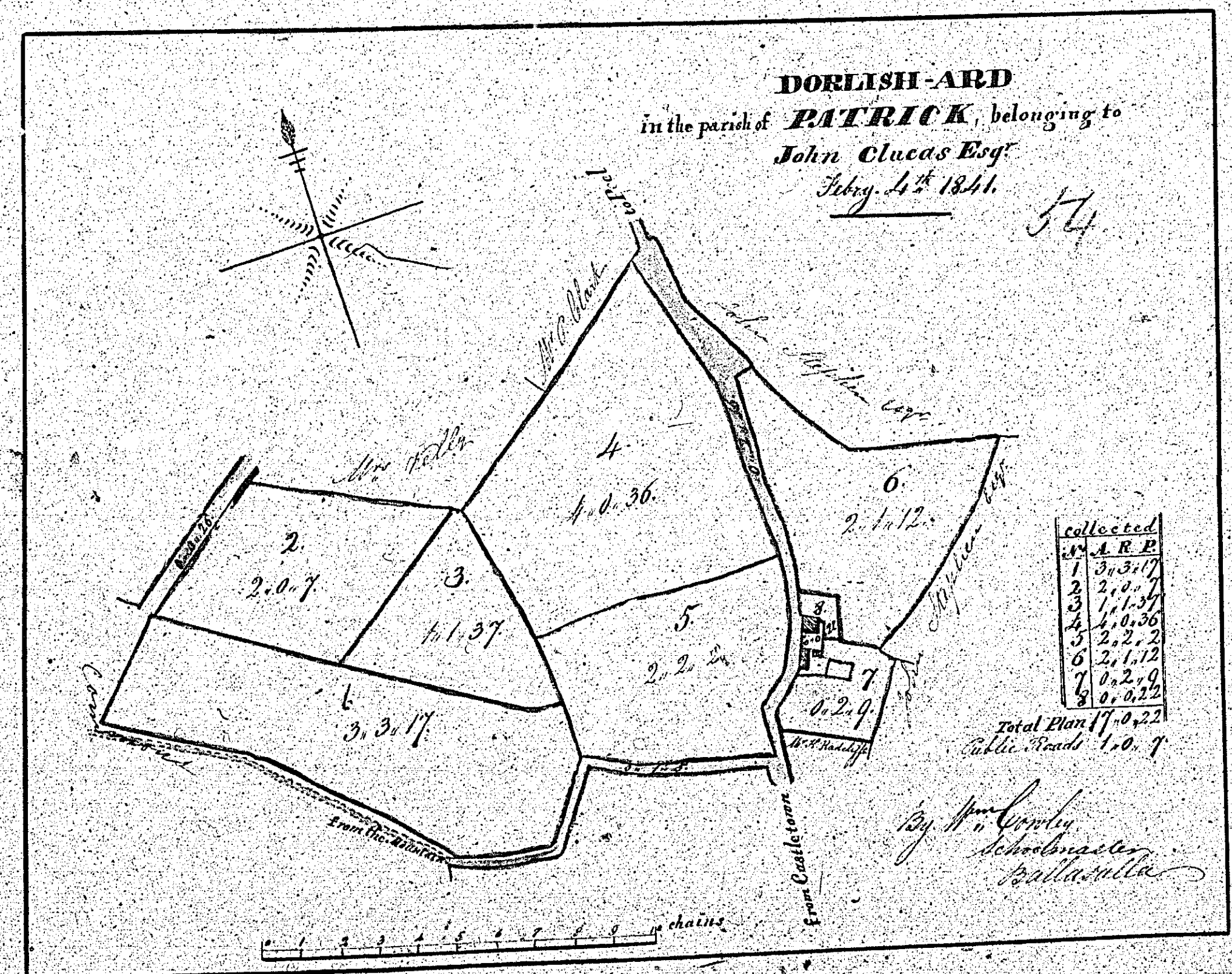
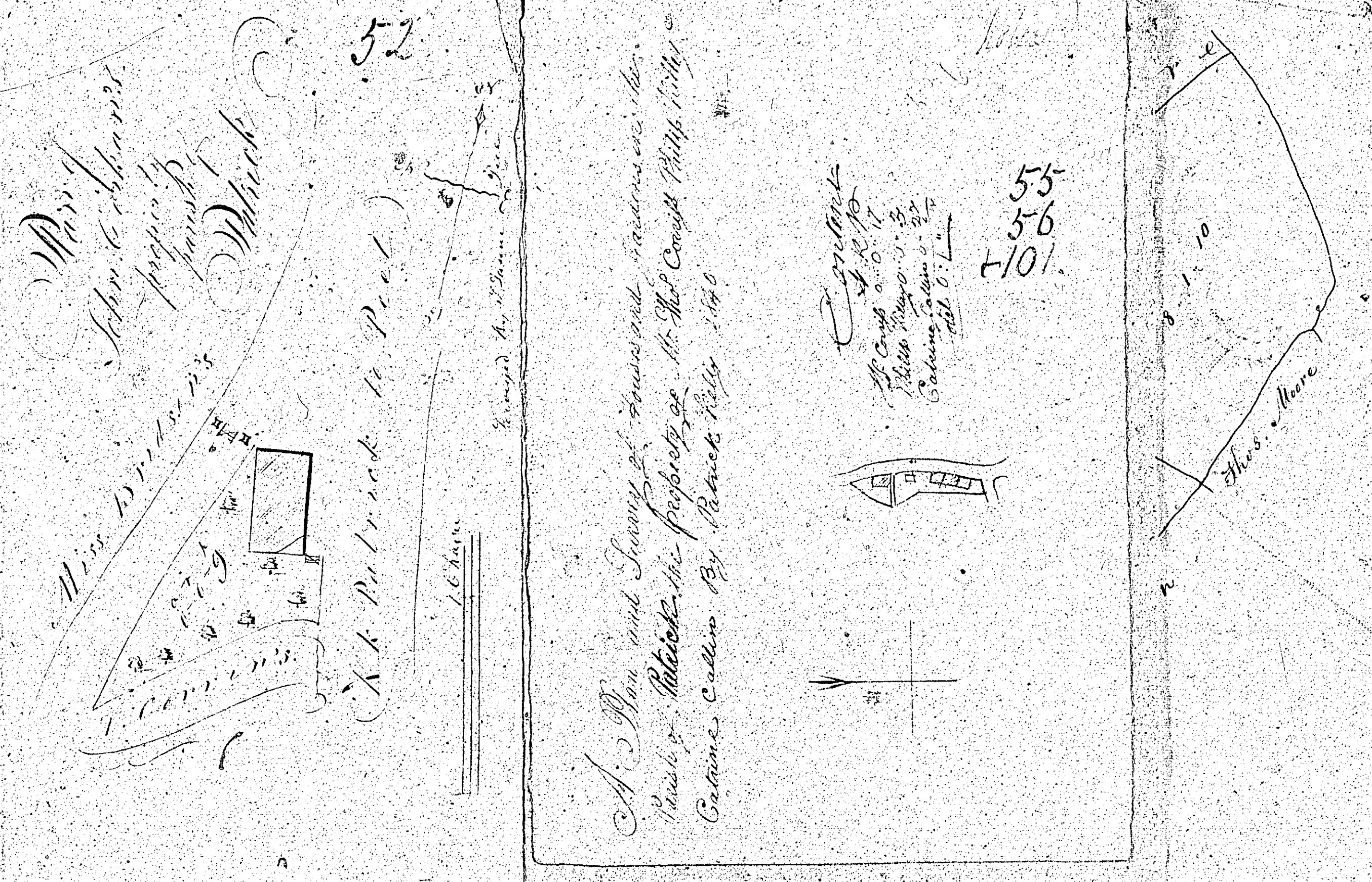

sheet of 3 chains  
 Jefferson & Hoyle Surveyors

Glenmoij Estate  
 (Part of Trejia) in Parvick  
 belonging to W. H. Davis  
 June 1840.

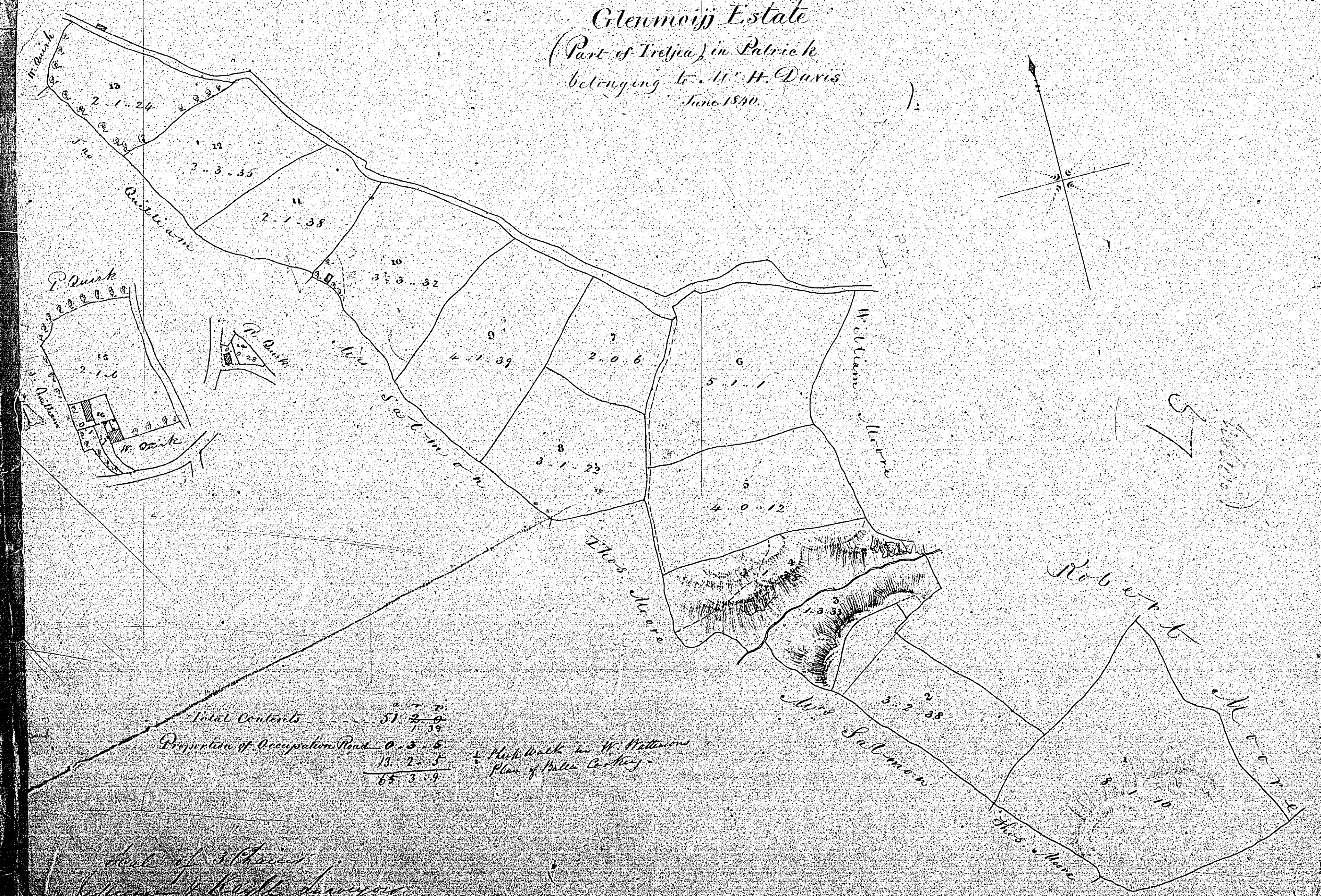
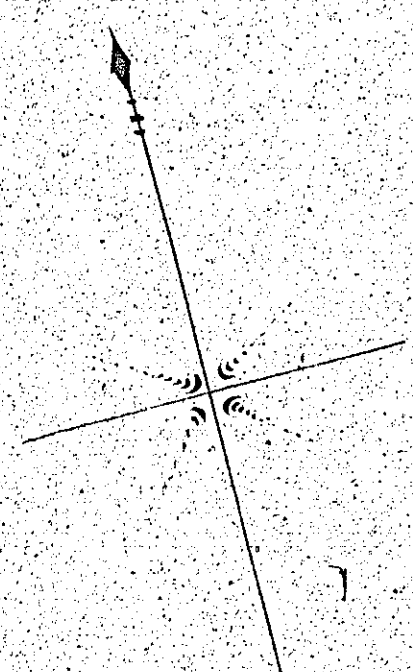

Total Contents	51. 4. 0	
Proportion of Occupation Road	0. 3. 5	
	13. 2. 5	
	65. 3. 9	

Sketch made by W. Patterson  
 Plan of Public Authority

Scale of 3 Chains  
 by James W. Keight Surveyor

57  
 (W. H. Davis)

ISLE OF MAN GOVERNMENT GENERAL REGISTRY

TITHE PLANS: PARISH OF PATRICK

- |    |                                |      |
|----|--------------------------------|------|
| 58 | Original coloured              | 1.30 |
| 59 | Original coloured (decorative) |      |

