

Noted

A Plan & Survey of part of
 the Parish of 46
 Patrick the property of
 Wm. Patrick Esq.
 by P. Sully, Esq. Decr. 8. 1799

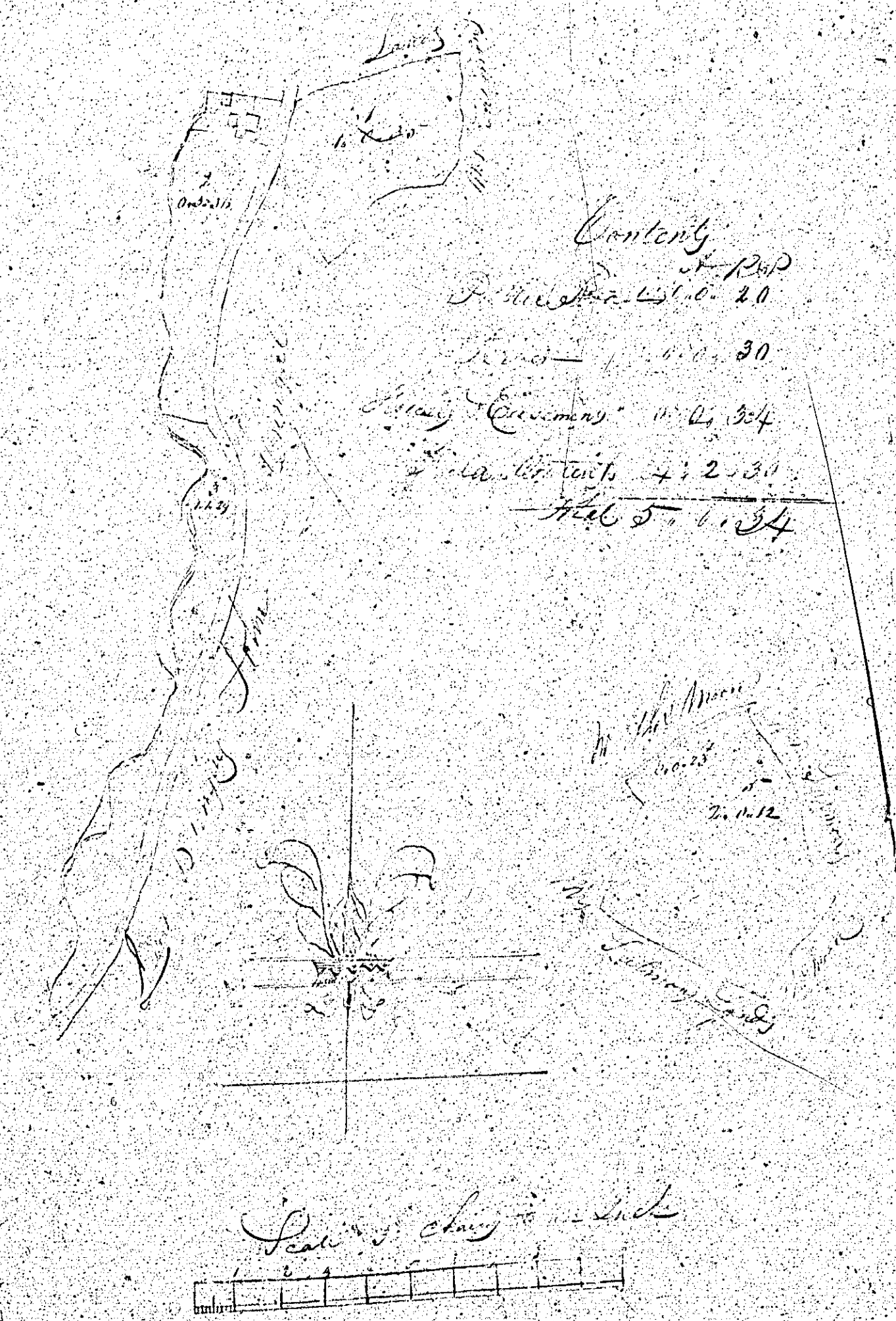

1840.
 Haighin
 man.

PLAN

Of Intack land
In the Parish of St. Patrick
The property of
M^r. William Cain.

47

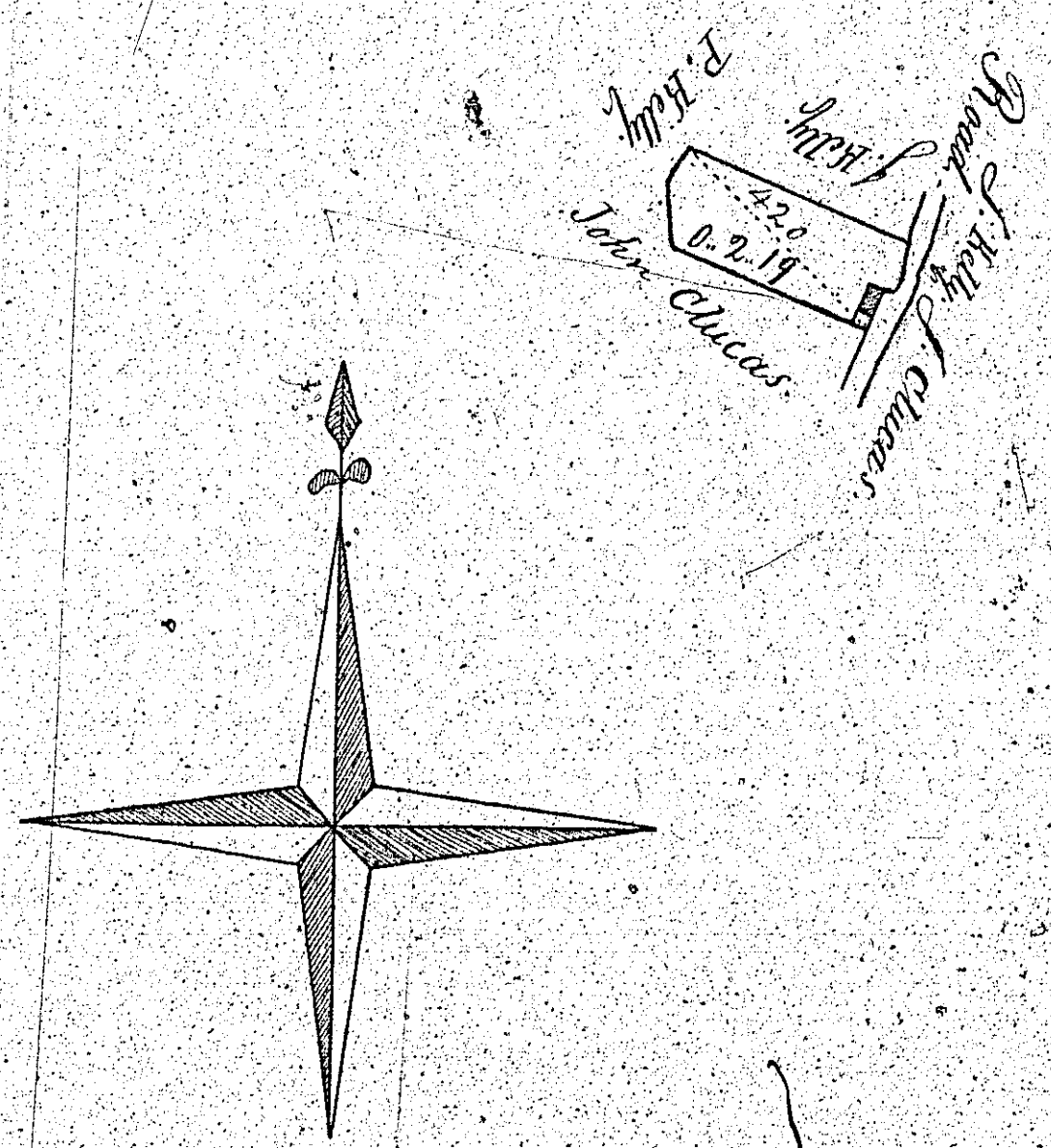

Total Content ^{0. 1. 1.} 0. 2. 19

0 1 2 3 4 5 6 7 8 9 Chains

Surveyed July 1840.
By William Haigher
R.H. German.

ISLE OF MAN GOVERNMENT: GENERAL REGISTRY

TITHE PLANS: PARISH OF PATRICK

1.30

50 Original monotone

51 Original monotone, marked

Plan of Crook Willin
Parish of Patrick
property of
Mrs. Curson } 50

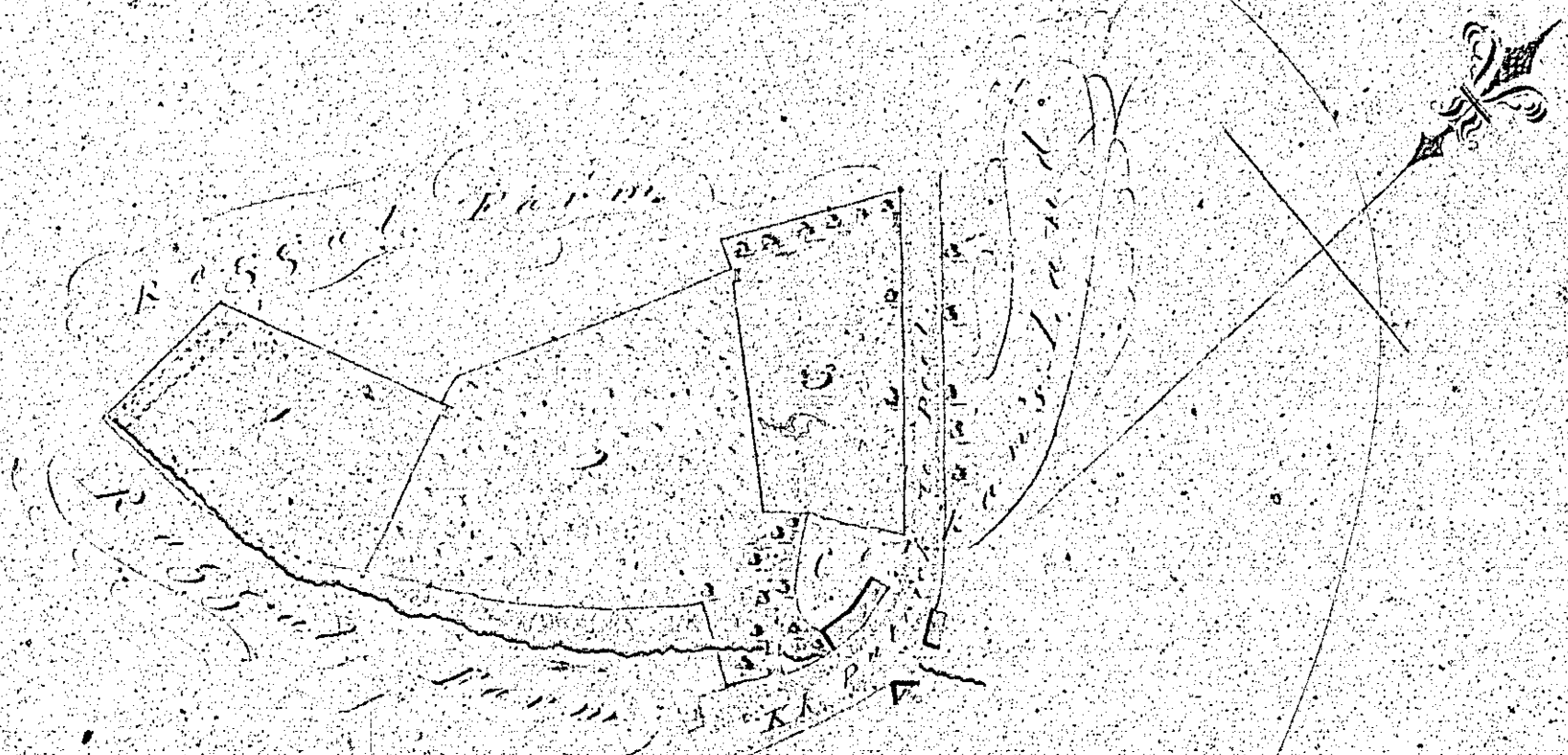

Contents

1	6-2-13
2	1-4-29
3	6-2-11
	2-1-12
4	6-6-18
Total	2-1-27

Surveyed by J. G. G. 1847



Surveyed by
William Curson
Parish of Patrick

Remd. to Mrs. Curson

10 St. John's

Surveyed by J. G. G. 1847

Plan numbered 52
is bound out of sequence,
found with plans numbered 54
and 55/56/101

REGISTRY

1:30



*A Plan & Survey of part of Beldwood in
the Parish of Pateley the property
of Mr Robert Waller
by P. Kelly Michael Jones 1840*

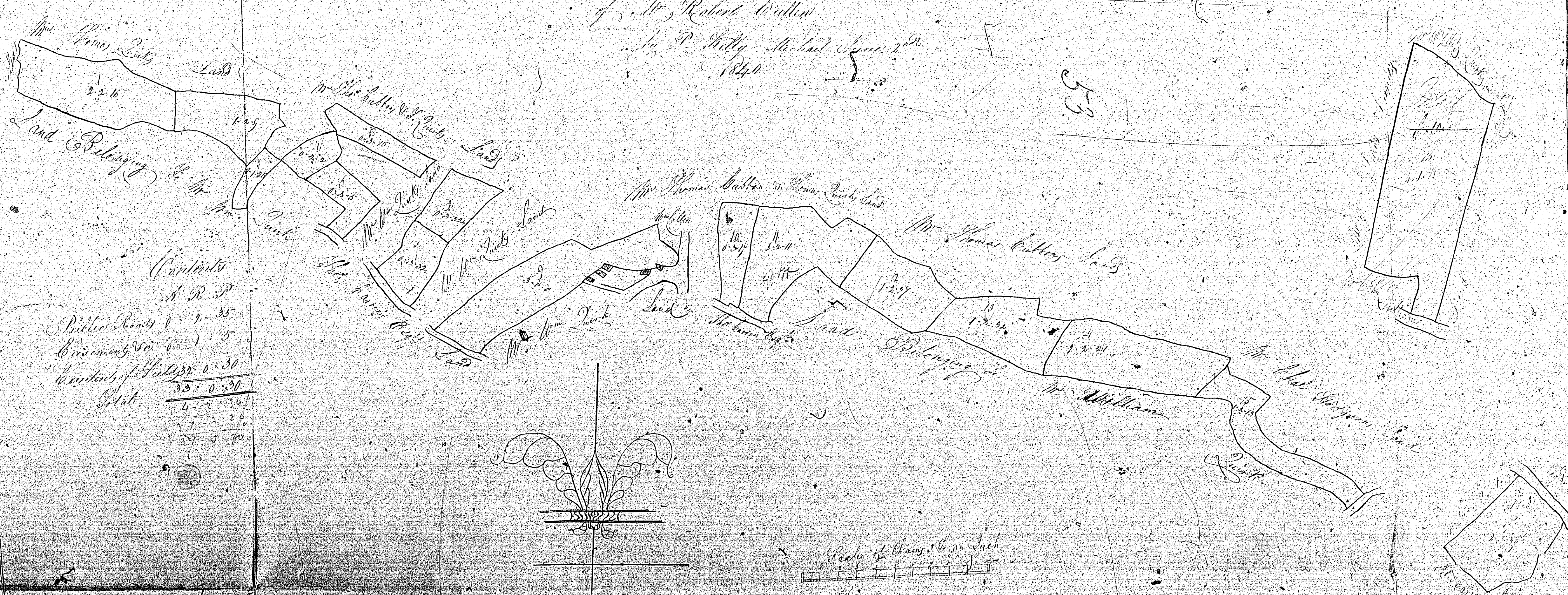

Contents

Public Roads	0 2 35
Enclosures	0 1 5
Acres of Soil	0 30
Total	33 0 30

Scale of Chains & so on such