

PLAN and Survey
 of part of the **Dunshelton** of
Ballyshelton, in the parish of **St. Patrick**
 the property of

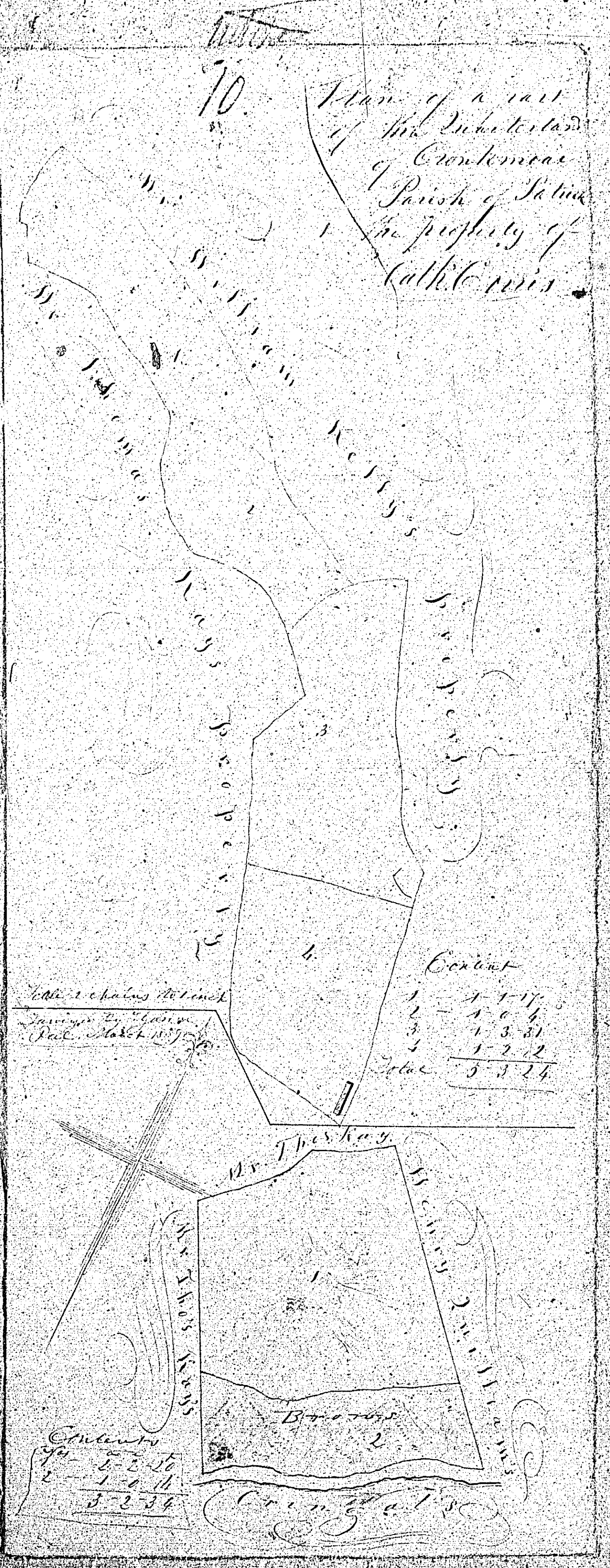

*Plan of Survey of a part of
 Dutch land in the Parish of St. Andrew the
 Property of the Marquis de Montcalm
 by Charles H. Smith of the 18th 1849*

Reference

<i>S.</i>	<i>A.</i>	<i>R.</i>	<i>P.</i>
1	1	3	11
2	9	1	39
3	1	0	9
4	0	2	38
5	1	1	23
6	1	2	16
7	2	3	28
8	2	1	23
9	2	0	24
10	0	1	39
<i>Reference containing 0 0 23 23</i>			
<i>Public Body 0 0 19</i>			
<i>Total 24 1 9</i>			

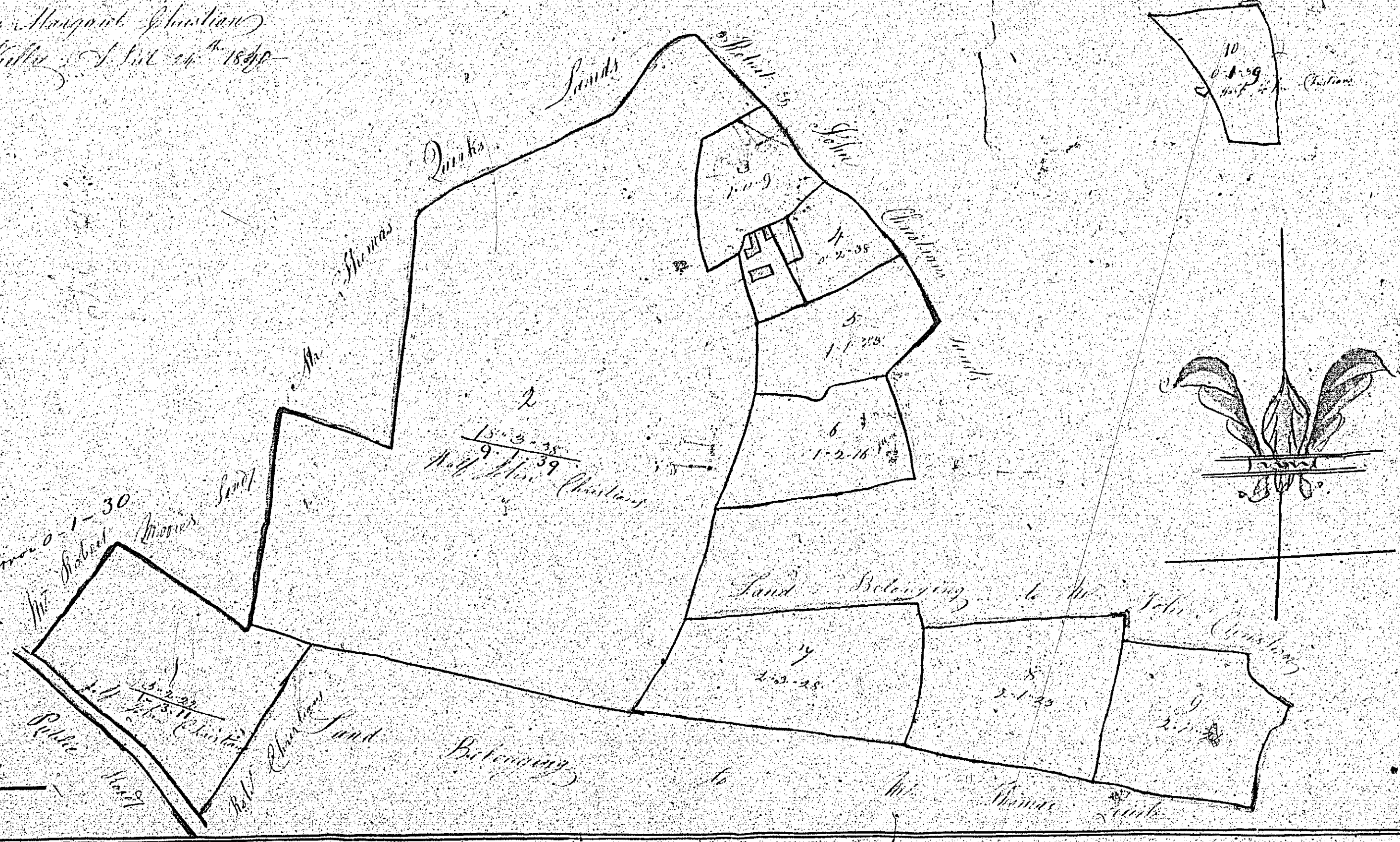

*PLAN and Survey
 of part of the Dutch land of
 the Marquis de Montcalm in the Parish of
 St. Andrew the property of*

A Plan & Survey of a parcel of Black Lands in the parish of Patrick the property of Mr John Christian By Daniel Wells Esq
24th 1841

Reference	Acres	Roods	Poles	Sq
1	1	3	11	
2	9	1	39	
3	2	1	11	
4	3	1	24	
5	2	0	24	
6	1	1	25	
7	1	1	15	
8	2	1	16	
9	2	1	33	
10	0	1	39	
Area of ground	1	6	38	
Area of house	0	6	23	
Area of other	0	0	13	
Total	1	13	104	

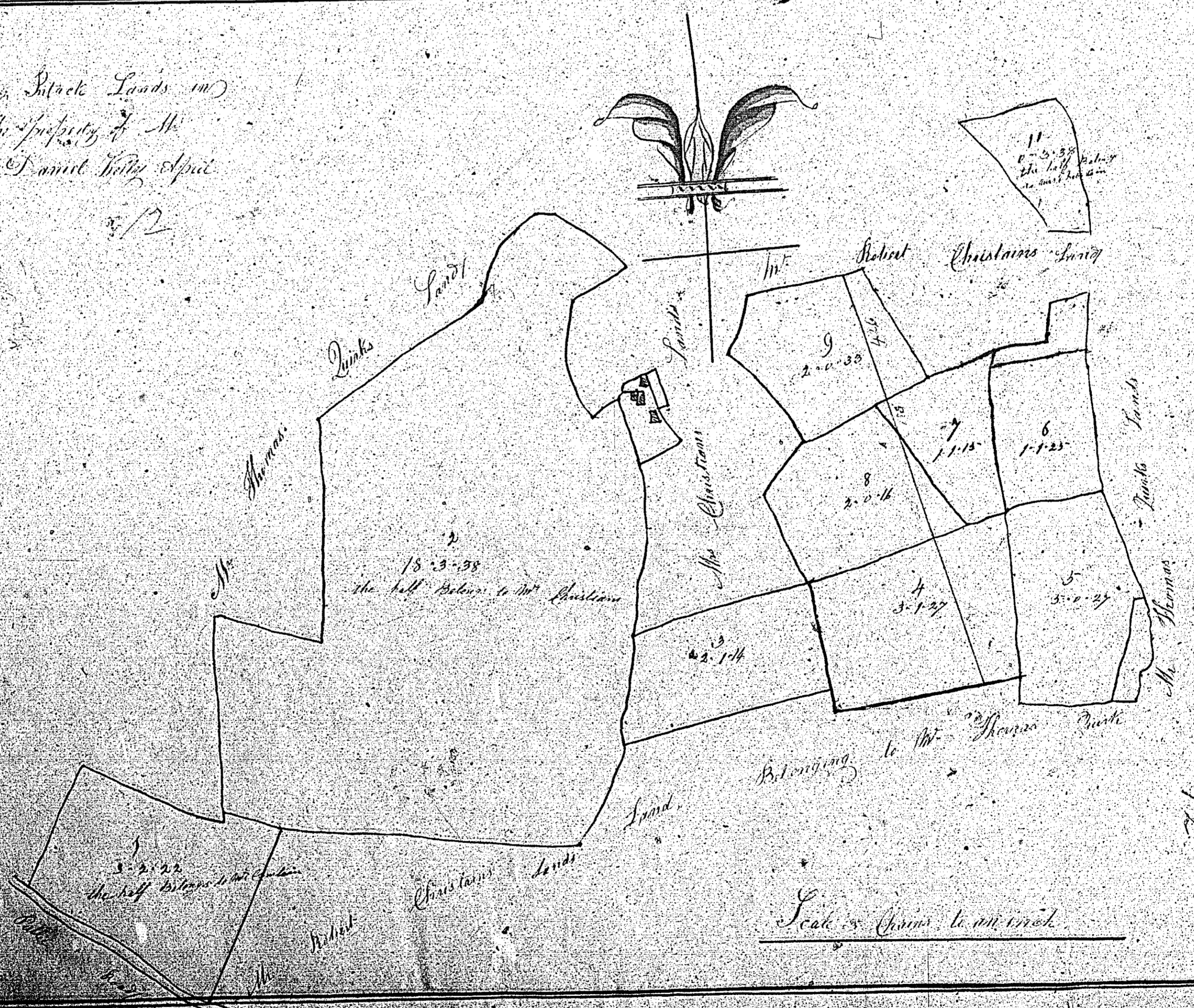

PLAN and Survey of part of the Blackland of Ballypattin in the parish of Patrick the property of Mr John Christian

New Bedford
 13

A Plan or Survey of Dutch Lands
 in the Town of Dutch the Property
 of Mr. Robert Cushman By Survey
 Taken April 25th 1649

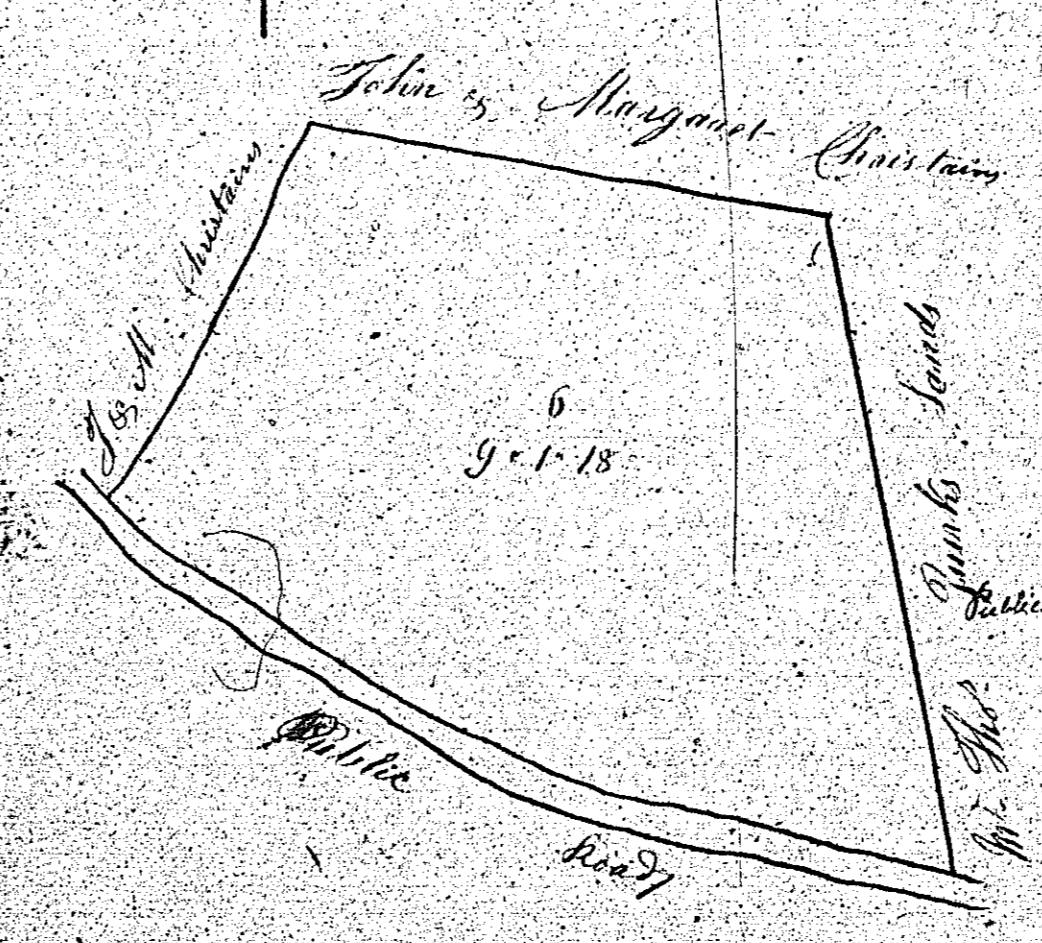
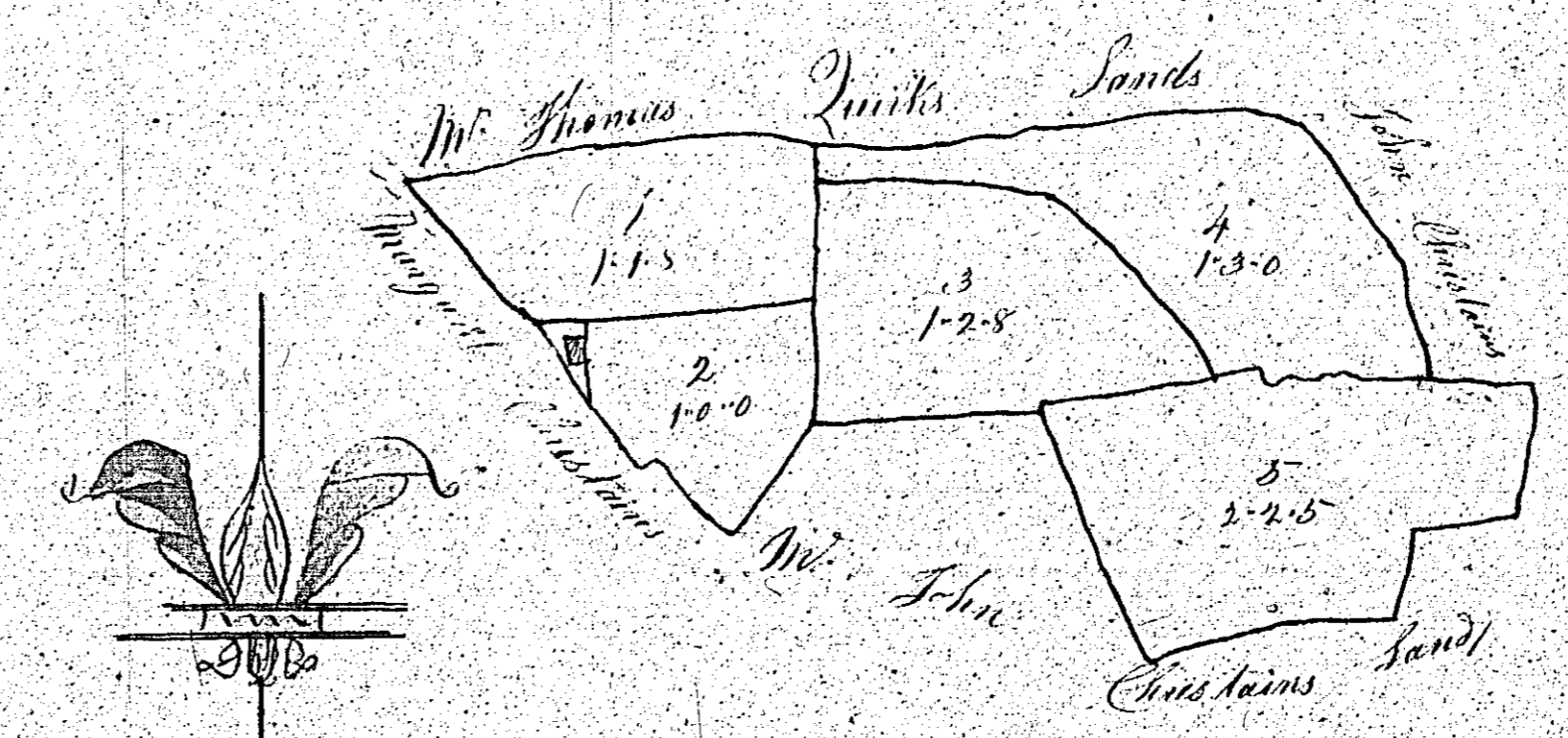

The Contents of this Plan

No.	Ac.	R.	S.
1	1	1	5
2	1	0	0
3	1	2	8
4	1	3	0
5	2	2	5
6	9	1	18
Public Road			
Total 12-0-8			

Scale shows 1000 feet

PLAN and Survey
 of part of the Dutchland of
 New Bedford in the Town of 1649
 the Property of

PLAN and Survey
of part of the Quarterland of
Ballaspit, in the parish of St. Patrick
the property of
Mr. Robert Lubbock.



Total Content - 0 1 13

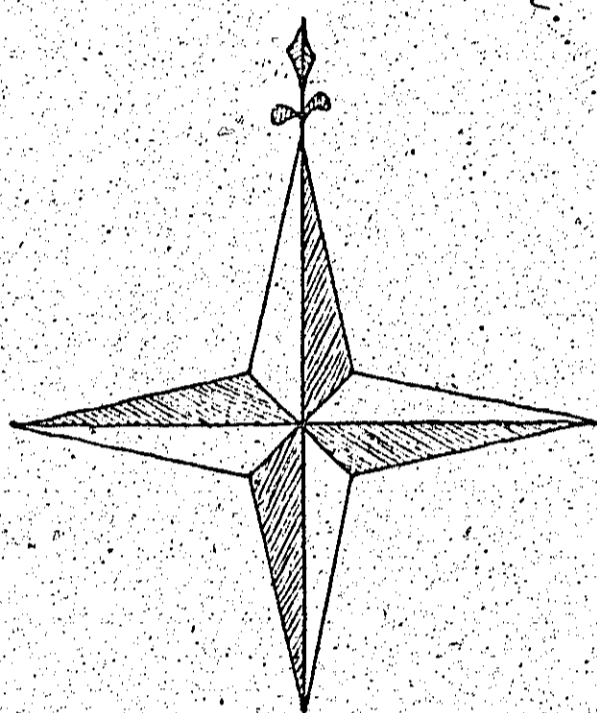

1 2 3 4 5 6 7 8 9 10 Chains.

Surveyed June 1840.
By William Keightley
R. W. Gorman

ISLE OF MAN GOVERNMENT: GENERAL REGISTRY

TITHE PLANS: PARISH OF PATRICK

Original coloured

1:30

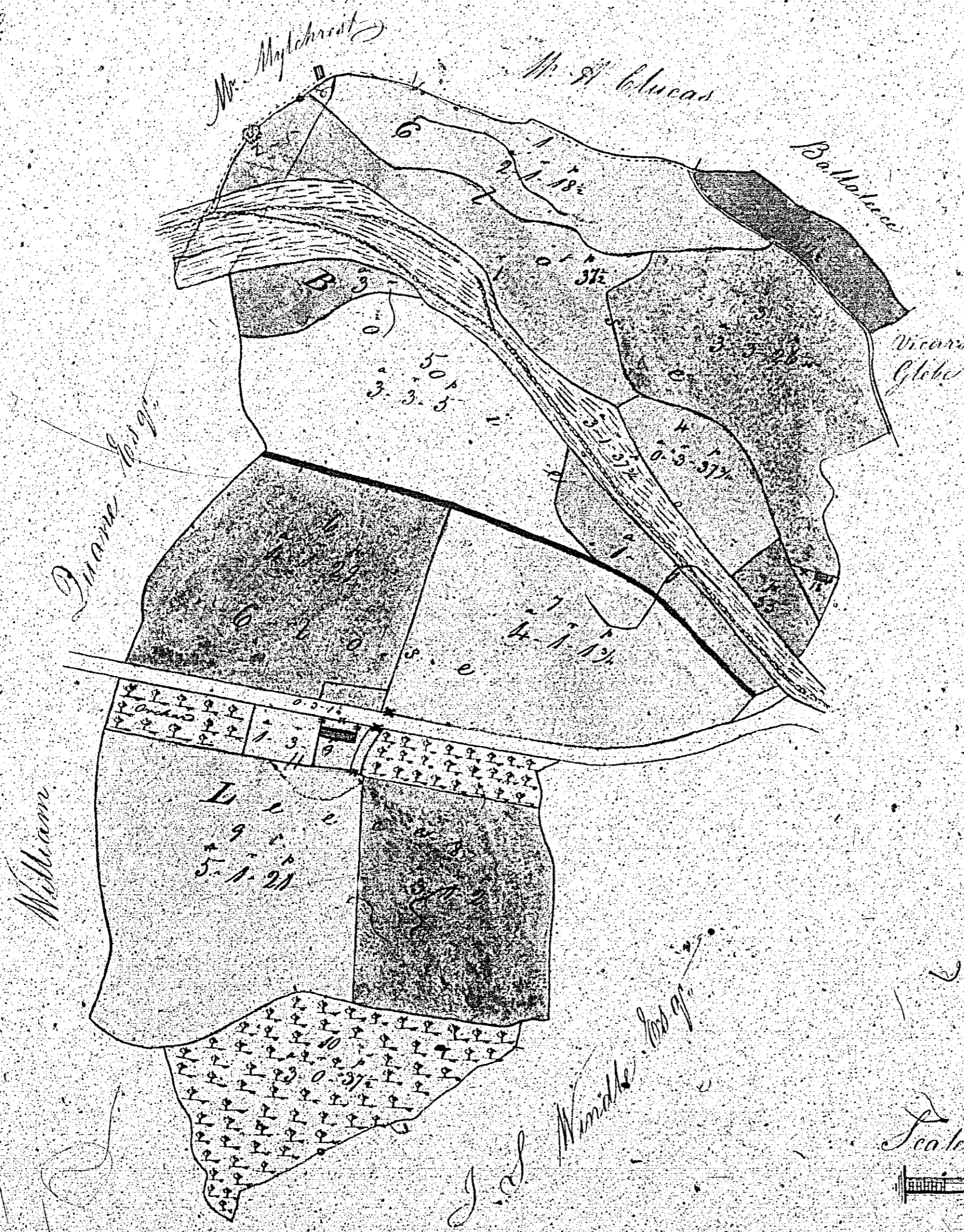
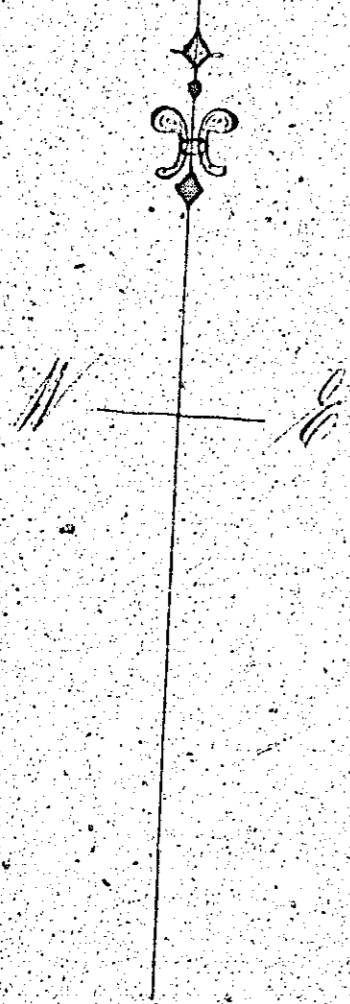

Plan & Survey
 of
 CLOSE-BOOIN
 and
 CLOSE-LEECH
 in the Parish of
 Patrick
 the County of
 Wick
 and others

Acre		Roods		Perches	
1	1	1	1	1	1
2	2	2	2	2	2
3	3	3	3	3	3
4	4	4	4	4	4
5	5	5	5	5	5
6	6	6	6	6	6
7	7	7	7	7	7
8	8	8	8	8	8
9	9	9	9	9	9
10	10	10	10	10	10
11	11	11	11	11	11
12	12	12	12	12	12
13	13	13	13	13	13
14	14	14	14	14	14
15	15	15	15	15	15
16	16	16	16	16	16
17	17	17	17	17	17
18	18	18	18	18	18
19	19	19	19	19	19
20	20	20	20	20	20
21	21	21	21	21	21
22	22	22	22	22	22
23	23	23	23	23	23
24	24	24	24	24	24
25	25	25	25	25	25
26	26	26	26	26	26
27	27	27	27	27	27
28	28	28	28	28	28
29	29	29	29	29	29
30	30	30	30	30	30
31	31	31	31	31	31
32	32	32	32	32	32
33	33	33	33	33	33
34	34	34	34	34	34
35	35	35	35	35	35
36	36	36	36	36	36
37	37	37	37	37	37
38	38	38	38	38	38
39	39	39	39	39	39
40	40	40	40	40	40
41	41	41	41	41	41
42	42	42	42	42	42
43	43	43	43	43	43
44	44	44	44	44	44
45	45	45	45	45	45
46	46	46	46	46	46
47	47	47	47	47	47
48	48	48	48	48	48
49	49	49	49	49	49
50	50	50	50	50	50

Scale of 3 Chains to One Inch

Black Boon, 10, 11, 12
 Chaddagh, 13, 14, 15
 and 16, 17, 18
 Total of these Boons

Plantation
 New Lease, 19, 20, 21
 Roads, 22, 23, 24, 25
 Total of these Boons
 New Boon, 26, 27, 28, 29, 30, 31, 32, 33, 34, 35, 36, 37, 38, 39, 40, 41, 42, 43, 44, 45, 46, 47, 48, 49, 50

J. Crowell of Wick
 Surveyor, June 1840