

Plan
of
Ballinord bog
in the
parish of Crockan
County Wick
1837

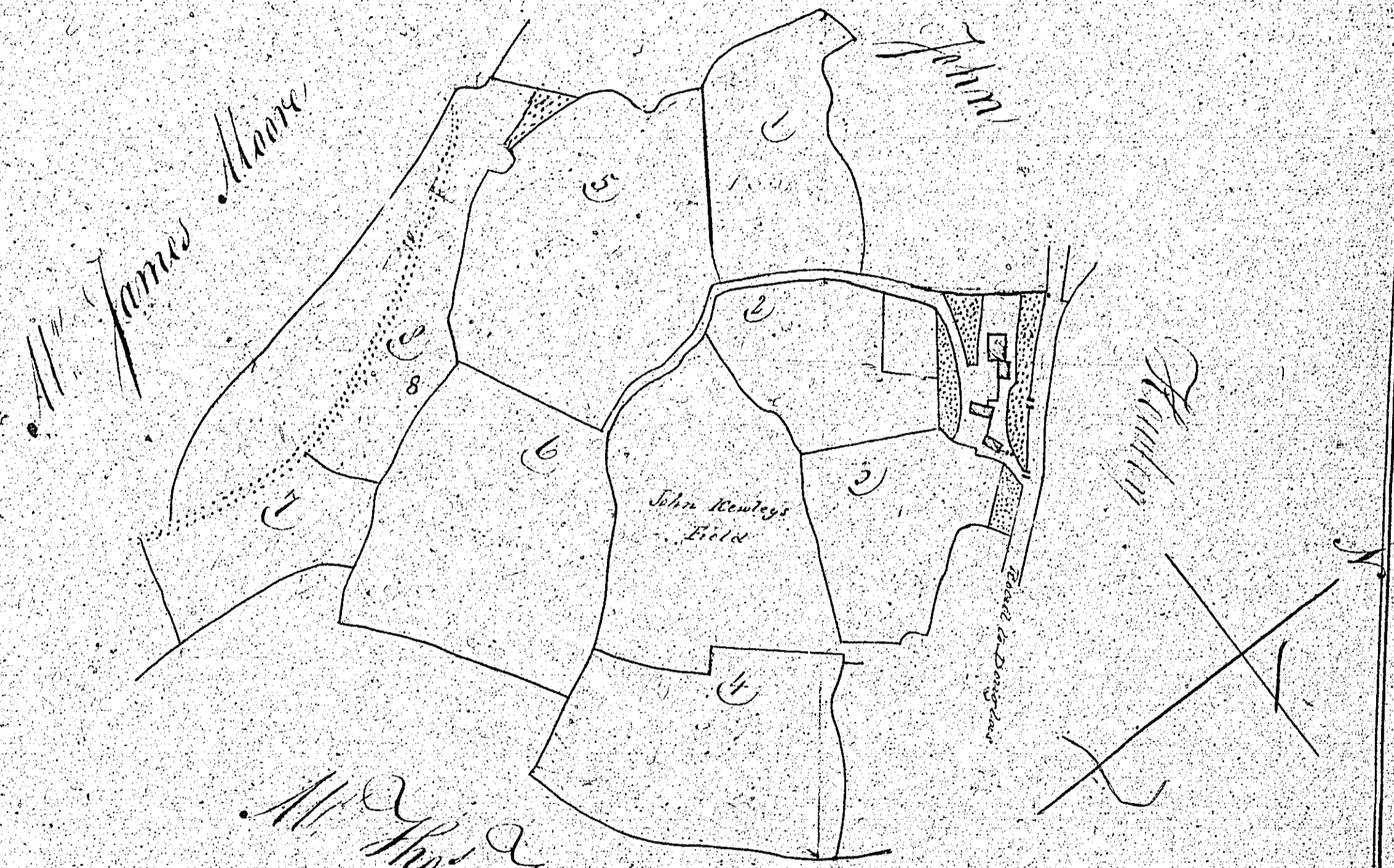

Reference	
N ^o	A.R.P.
1	1.3.34
2	1.1.45
3	1.2.1
4	3.5.27
5	3.2.26
6	5.1.37
7	1.7.4
8	3.0.0
9	1.1.37
10	3.4.4
Carroll's	1.1.37
Peenacross	3.4
S. Wood T. Sand &	1.13
Road	1.5
Mill Race	1.5
Total 30.3.27	

Scale of Chains



Joseph Blake Surveyor

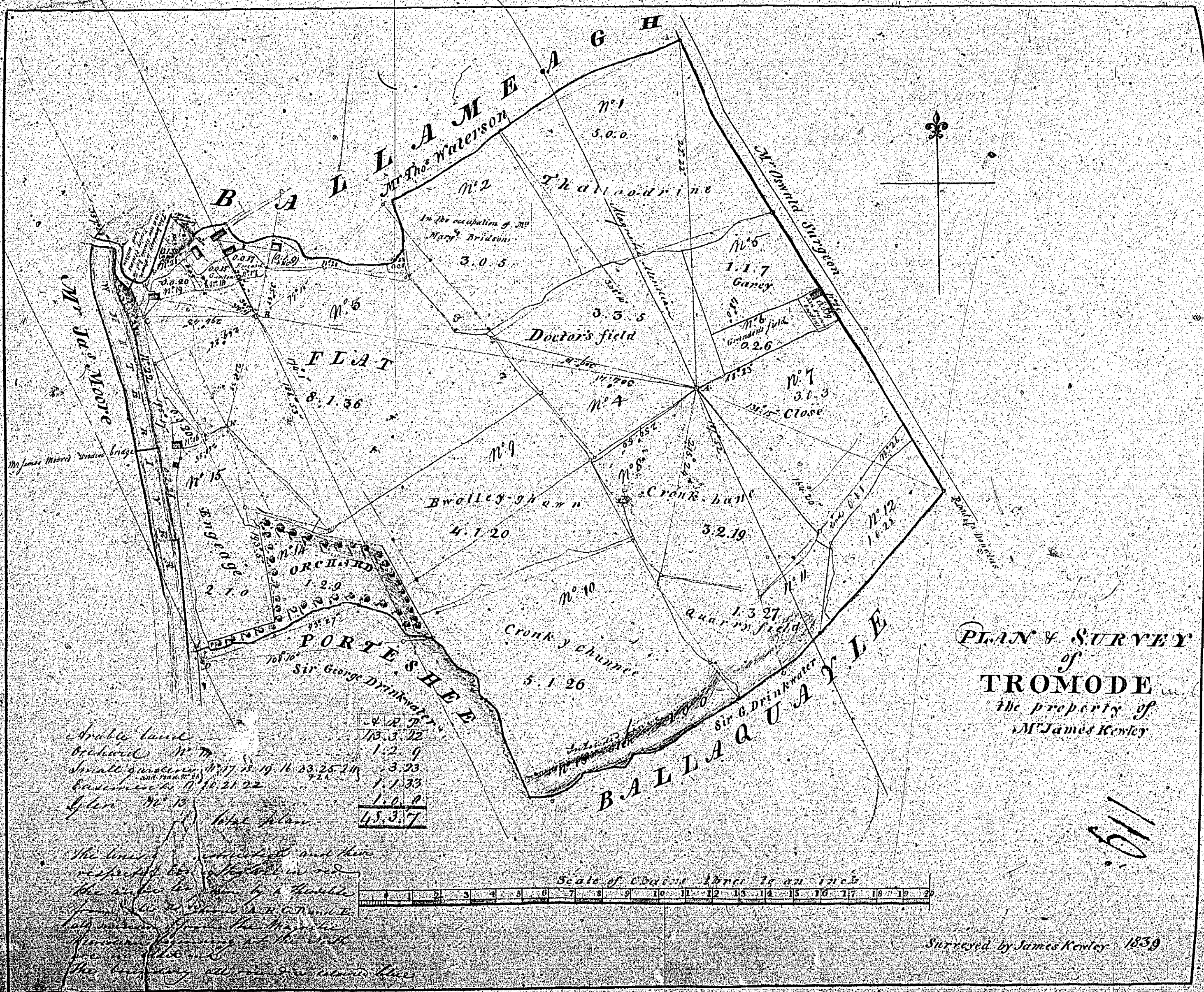

PLAN & SURVEY
of
TROMODE
the property of
M^r James Kenney

Arable land
No. 1 1.20
No. 2 1.20
No. 3 1.20
No. 4 1.20
No. 5 1.20
No. 6 1.20
No. 7 1.20
No. 8 1.20
No. 9 1.20
No. 10 1.20
No. 11 1.20
No. 12 1.20
No. 13 1.20
No. 14 1.20
No. 15 1.20
Total 15.00

Orchard
No. 1 1.20
No. 2 1.20
No. 3 1.20
No. 4 1.20
No. 5 1.20
No. 6 1.20
No. 7 1.20
No. 8 1.20
No. 9 1.20
No. 10 1.20
No. 11 1.20
No. 12 1.20
No. 13 1.20
No. 14 1.20
No. 15 1.20
Total 15.00

Water
No. 1 1.20
No. 2 1.20
No. 3 1.20
No. 4 1.20
No. 5 1.20
No. 6 1.20
No. 7 1.20
No. 8 1.20
No. 9 1.20
No. 10 1.20
No. 11 1.20
No. 12 1.20
No. 13 1.20
No. 14 1.20
No. 15 1.20
Total 15.00

Waste
No. 1 1.20
No. 2 1.20
No. 3 1.20
No. 4 1.20
No. 5 1.20
No. 6 1.20
No. 7 1.20
No. 8 1.20
No. 9 1.20
No. 10 1.20
No. 11 1.20
No. 12 1.20
No. 13 1.20
No. 14 1.20
No. 15 1.20
Total 15.00

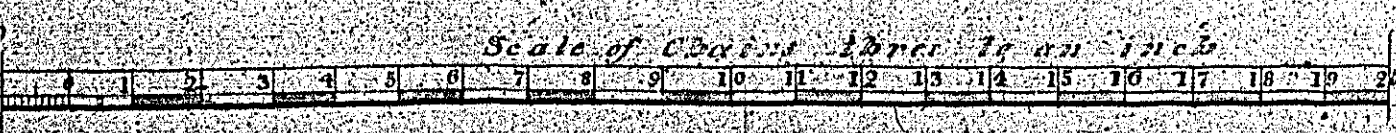

Surveyed by James Kenney 1839

110

Returned

Plan of Houses & Garden 121.
Situate in the
Village of Anchar
the property of
Mr. Philip Ryback
Jan 4 - 1881

W. Spittall Esq.

From Douglas to Ranby

One Chain to
Joseph Blake Surveyor

Scale of Feet

Scale of Feet

Plan of Dwelling House & Garden
 Situate in the
 Parish of Buchan
 The Property of
 Mr. Wm. King
 July 15th 1722.
 (Trinch Road, Bayle)

Trinch Road
 Road
 Mr. Bradburn
 Mr. Jones
 A.R.D. 1-0-10
 One Chain to the Trinch
 Joseph Blake Survey

Wm. King

Scale of 100 Yards
 by J. Blake
 Surveyor and Carter Surgeon