

Isle of Man Government: General Registry

PLANS DEPOSITED IN THE  
ROLLS OFFICE  
UNDER THE  
TITHE COMMUTATION ACT  
1839

PARISH OF ONCHAN

Volume 1

(1 - 100)

Microfilm Data (IOM) Ltd., Alpine Mews,  
Strathallan Lane, Onchan, Isle of Man, IM3 1NL

April 1997

## NOTES

The plans have been filmed in their bound state

This will have caused some image distortion particularly where large plans go into the binding gutter and/or have been folded

Many of the larger plans are damaged

Where plans are coloured this has been noted; 'monochrome' indicates a single ink colour which may be black, brown or blue

START OF VOLUME

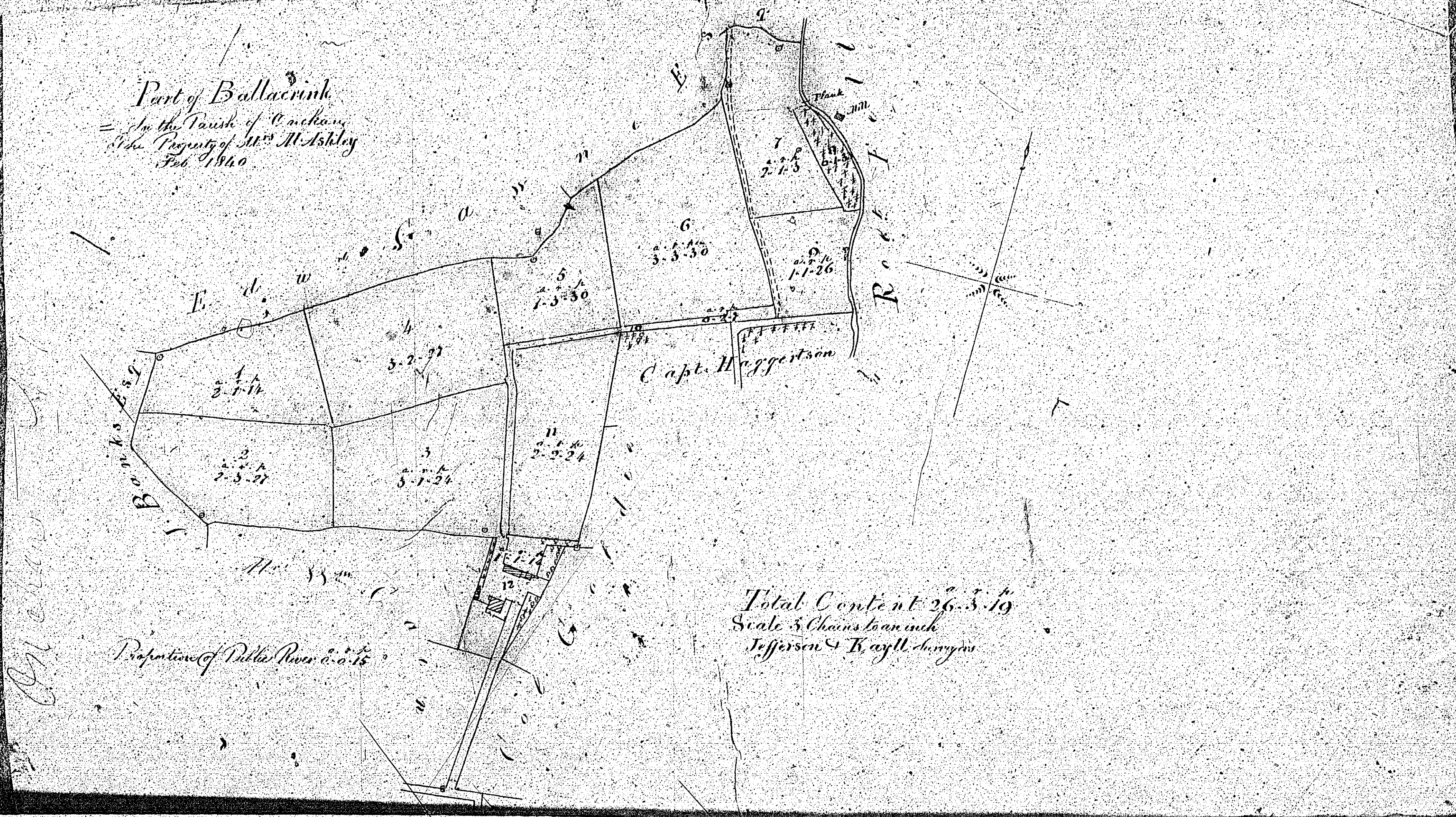

ISLE OF MAN GOVERNMENT: GENERAL REGISTRY  
 TITHE PLANS: PARISH OF ONCHAN

Original monotone

1:30



18

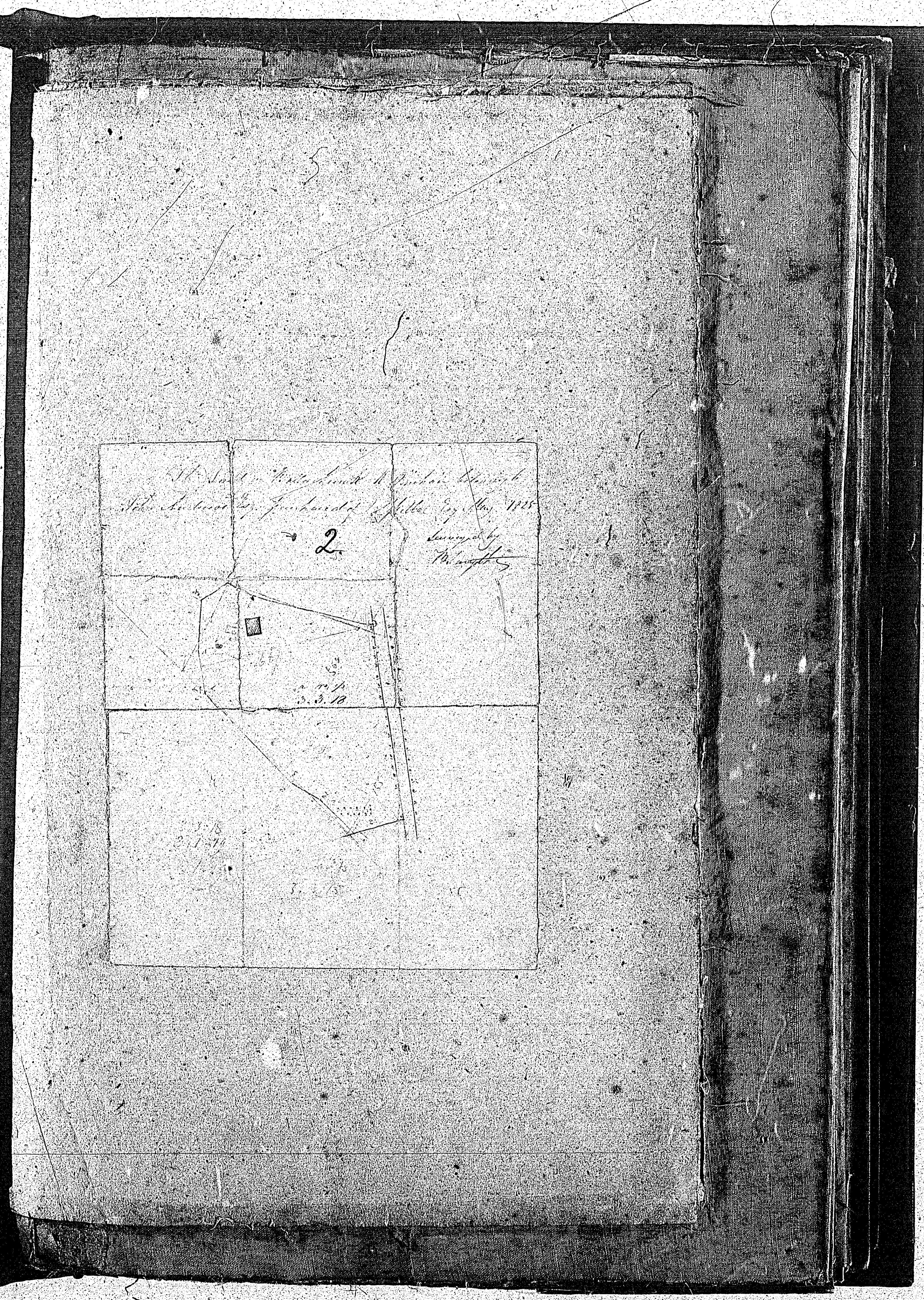

St. Paul in Philadelphia & ...  
St. Paul in Philadelphia & ...

2

Surveyed by ...

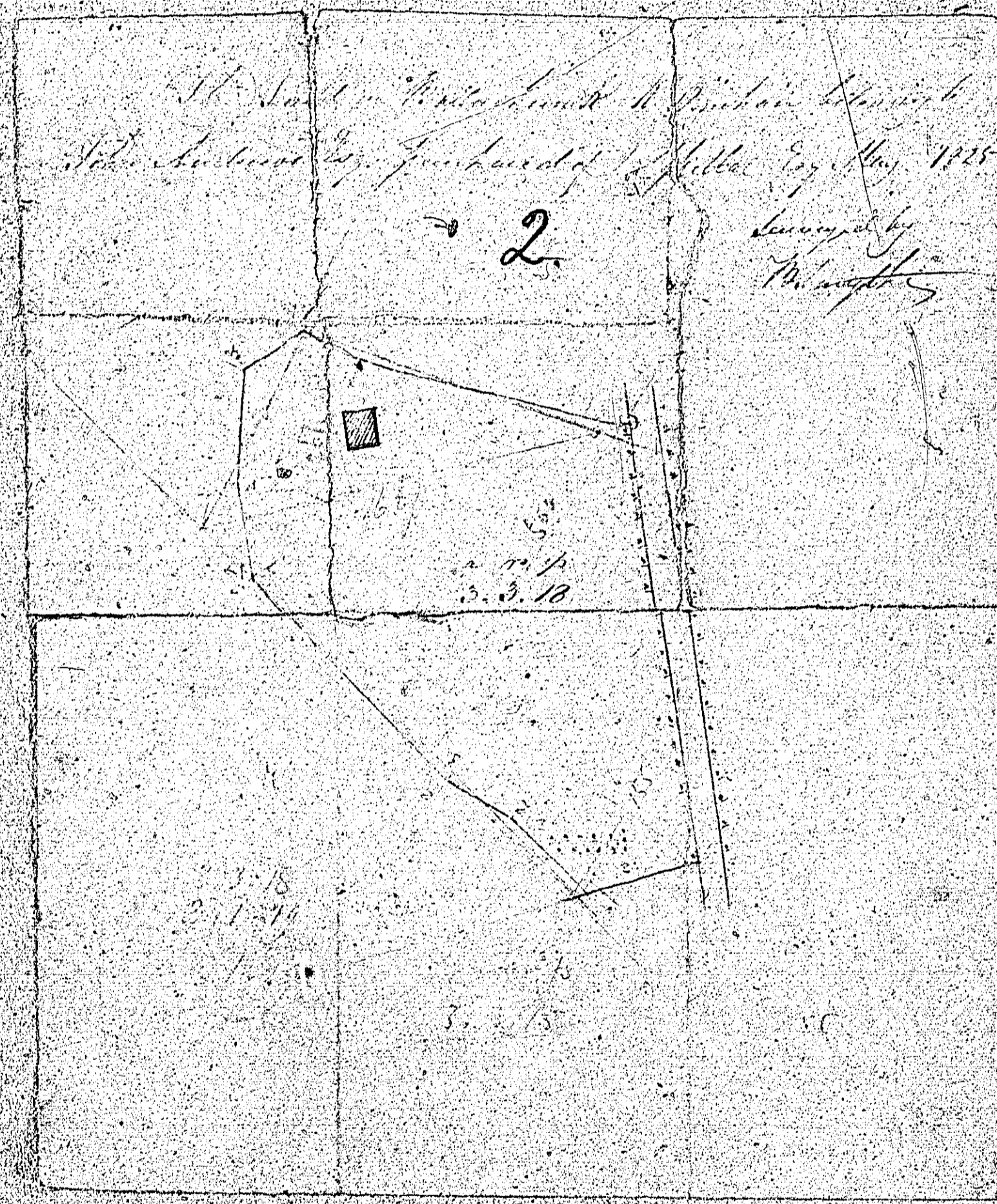

174  
3.3.10

not used

Ground plan 3. N.  
part of the land of  
William Laguerre  
(No. 12 1/2 lot in place)  
situate in the  
Parish of Brehan  
in the County of  
St. John Andrew  
Nov 25 1860

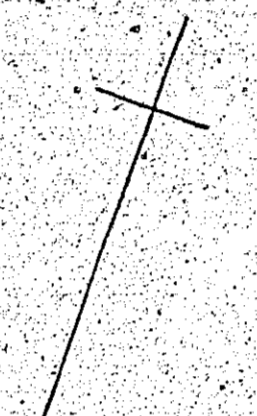

N 2  
12 1/2 13  
Anterior place

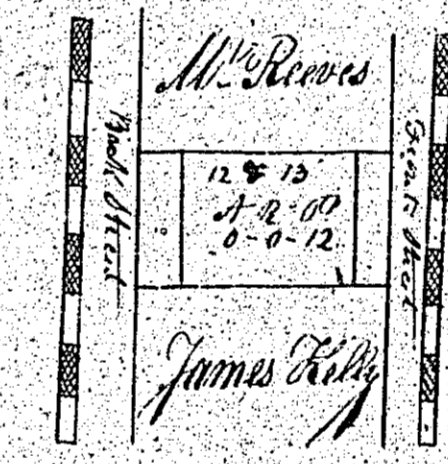

1860  
Total 1/2 0-0-12

One Chain to an Inch  
Joseph Blake Survey

in town