

A 19  
**P L A N**  
 OF THE ESTATE OF  
**B R A D,**  
 INTACK LAND,  
 IN THE PARISH OF MAROWN,  
 The Property of Mr. Robert Century.

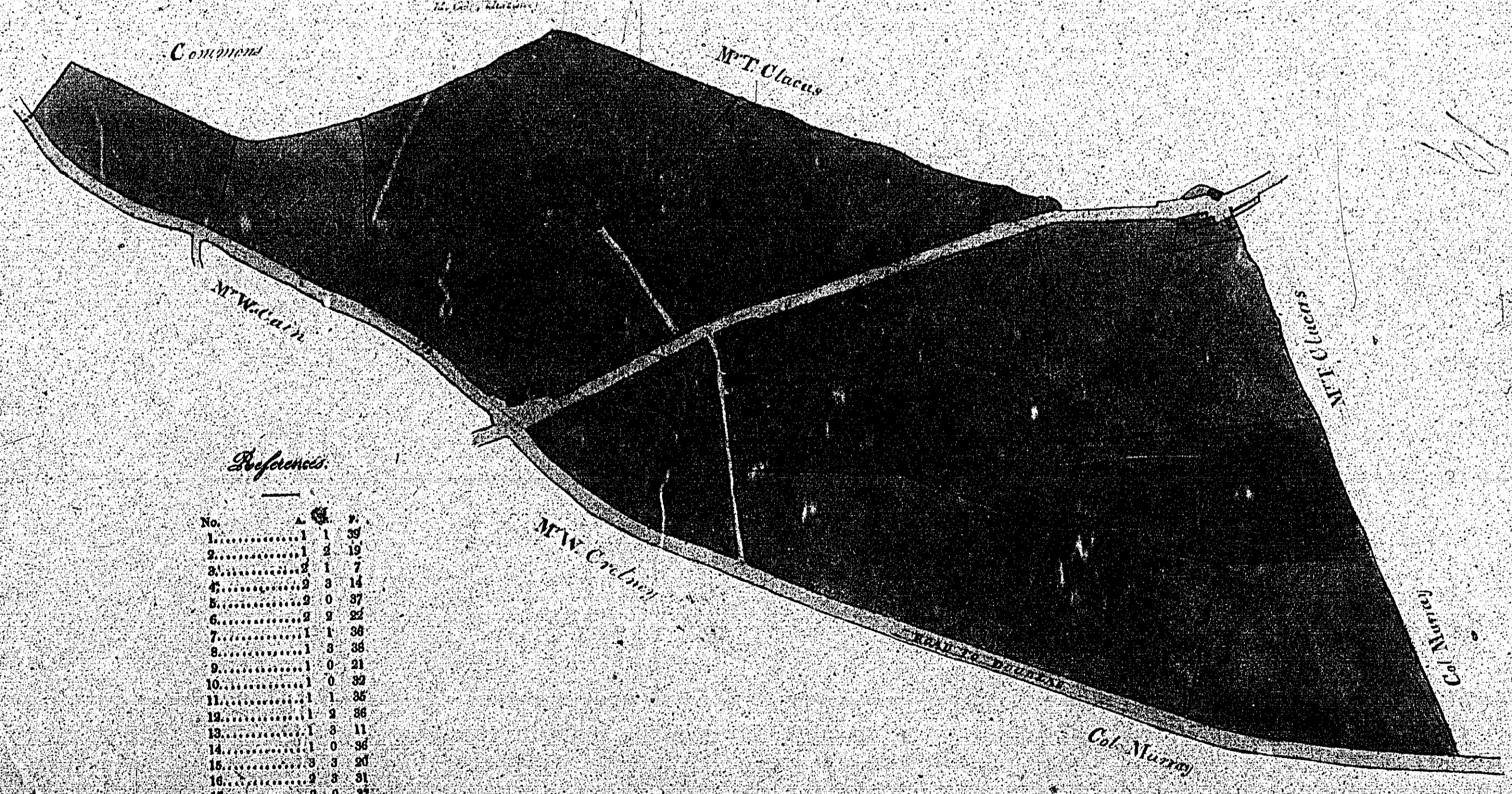

*References*

No.	A.	S.
1	1	35
2	1	10
3	1	7
4	2	14
5	2	37
6	2	22
7	1	38
8	1	34
9	1	21
10	1	32
11	1	35
12	1	36
13	1	11
14	1	36
15	3	20
16	3	31
17	3	37
18	1	9
19	1	5
House, Garden, &c.	1	1
Road	1	14
<b>Total</b>	<b>40</b>	<b>0 16</b>

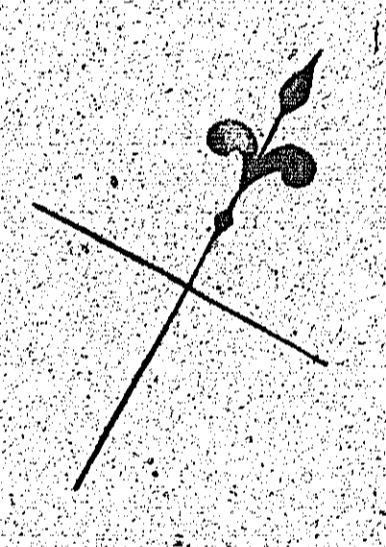
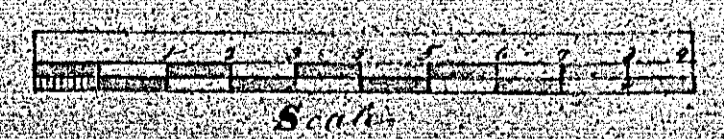

*By Matthias Cairn Harris*

No. 25  
Plan

of Stone Chain  
In Luck

In the Parish of Murrumbidgee

Belonging to

Mr John Corbett

April 1840

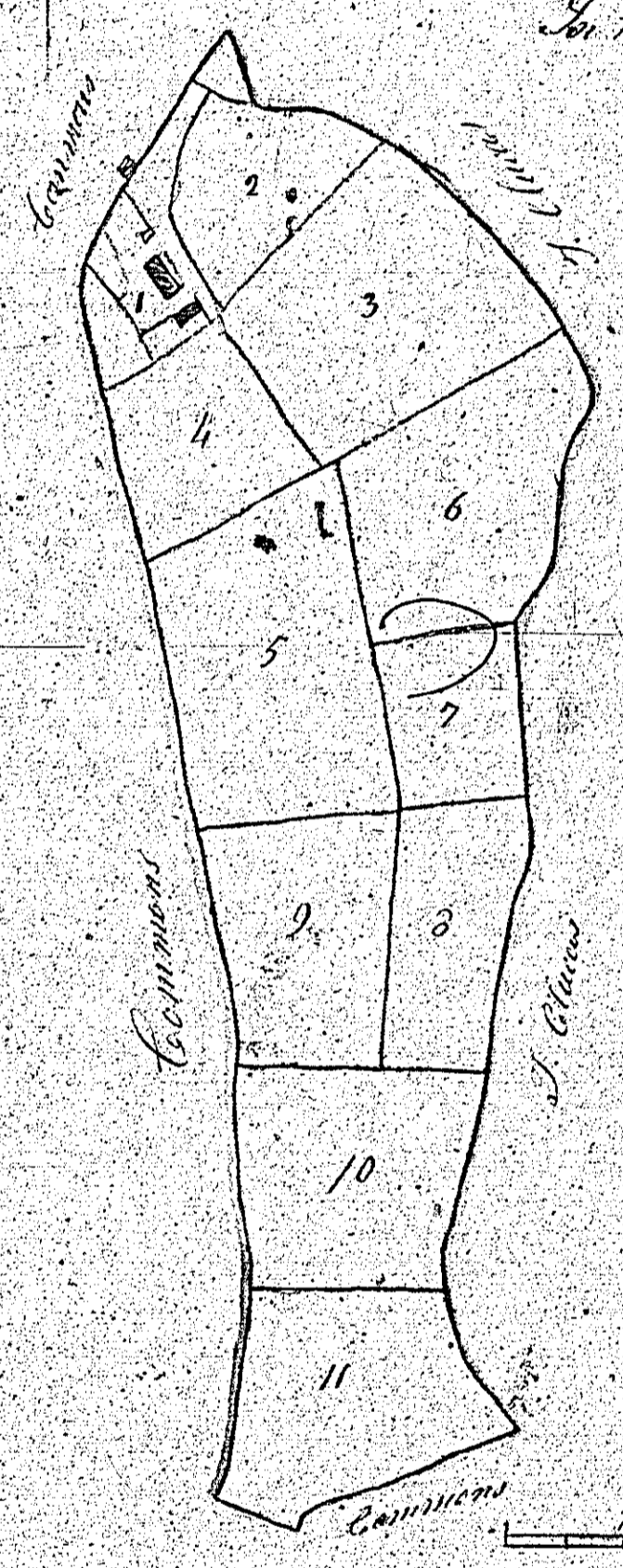

References		
No.	Ac.	P.
1	1	33
2	3	12
3	1	2 06
4	3	05
5	1	2 32
6	1	1 12
7	2	16
8	3	07
9	1	0 19
10	1	1 06
11	1	1 12
Total	11	3 03

By H. C. Murrumbidgee

Mr Robert

Plan  
of the Estate of  
Cornwall  
In the Parish of Marazion  
Belonging to  
Mr Thomas Colvins

21.

References

1 <sup>st</sup>	A	R	P	2 <sup>d</sup>	A	R	P	
1	2	3	29					
2	3	2	15					
3	2	2	32					
4	2	2	31					
5	2	1	33	37				
6	1	21	38		4	8		
7	1	26	39		1	1	25	
8	3	2	40		1	3	6	
9	1	3	24	41		1	1	18
10	1	0	27	42		1	2	22
11	1	3	13	43		2	1	
12	1	1	8	44		1	2	25
13	1	1	1	45		2	3	
14	1	1	22	46		1	1	12
15	2	2	4	47		1	3	31
16	1	1	30	48		2	0	27
17	1	1	5	49		2	3	33
18	2	1	29	50		2	3	33
19	1	1	26	51		2	1	7
20	6	3	3	52		2	1	11
21	4	1	30	53		3	1	20
22	4	1	18	54		3	3	5
23	1	3	22					
24	3	2	17					
25	3	3	4					
26	2	2	22					
27	2	2	32					
28	2	2	32					
29	3	3	12					
30	3	3	3					
31	6	1	35					
32	2	3	17					
33	2	3	17					
34	2	1	12					
35	2	1	12					
36	3	1	26					

Total 147-3-34

Other Areas 1-3-3

Mr Thomas Colvins

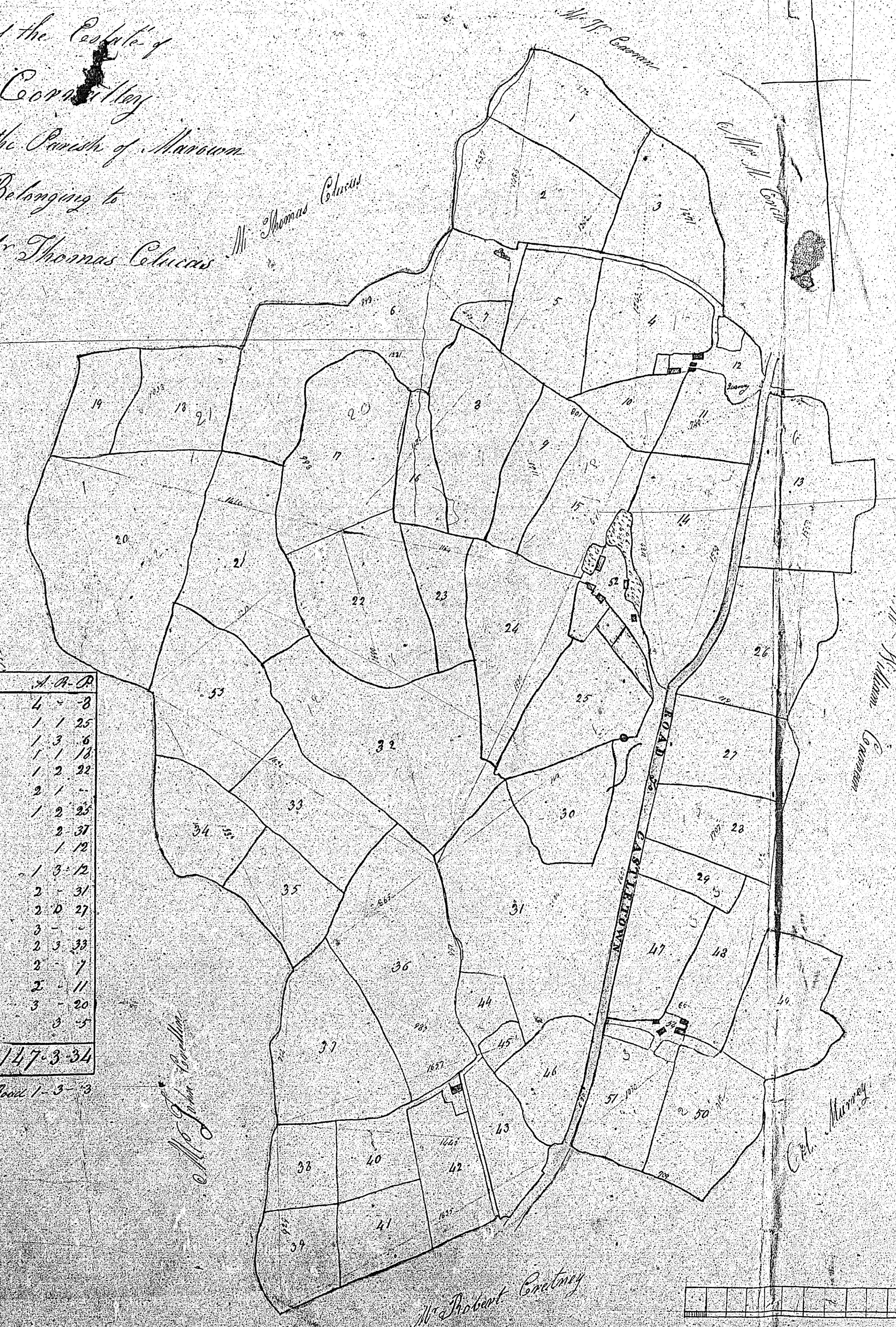

Scale  
By M. Colvins Marazion June 1840

G. Turnbull. Esq.

# Plan

22.

Of part of the *Quarantantland*  
or  
**BALLACOTCH**  
in the Parish of *Macown*  
THE PROPERTY OF  
*M<sup>r</sup> Rob<sup>t</sup> Glaque*

Contents

1	5.0.35
2	3.3.26
3	3.3.25
4	3.5.0
5	1.1.3
6	3.0.3
7	0.0.30
Total	19.5.20

Scale 2 Chains  
to an Inch

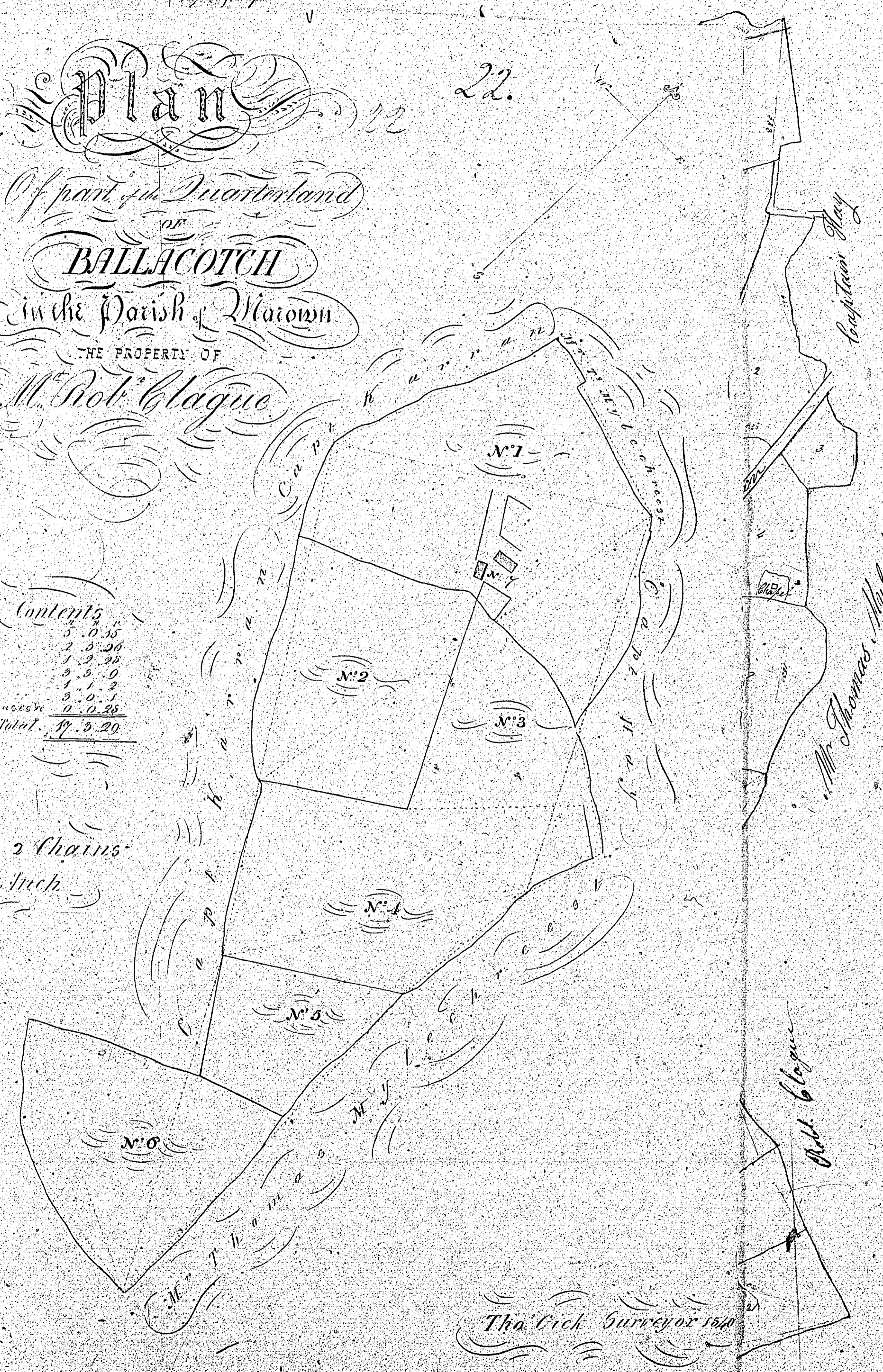

*Robert Glaque*

*Mr Thomas Mylchreest*

*Robt Glaque*

The Clerk Surveyor 1840

Robt Murray

By M. Cecil Mason June 1840

J. Turnbull Esq

Plan of the Estate of Ballinagan

in the Parish of Miraven

Belonging to

Mr W. Mann-Carson C.P.

23.

References

N <sup>o</sup>	A	R	P
1	3	2	22
2	2	3	27
3	2	1	18
4	2	-	8
5	2	-	14
6	1	3	4
7	2	1	8
8	1	-	7
9	-	2	30
10	-	2	31
11	3	-	8
12	2	-	10
13	2	2	6
14	2	-	7
15	1	2	15
16	2	-	37
17	1	3	23
18	1	1	15
19	1	2	30
20	1	2	29
21	2	1	5
Scamard Garden	-	-	20
Total	41	1	13

Proportion of Public Road  
2 31

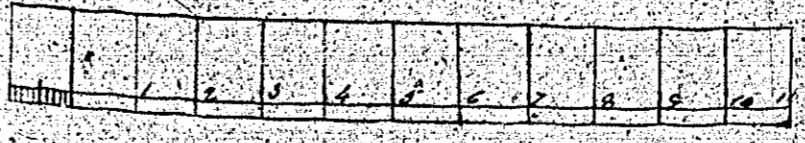

Scale

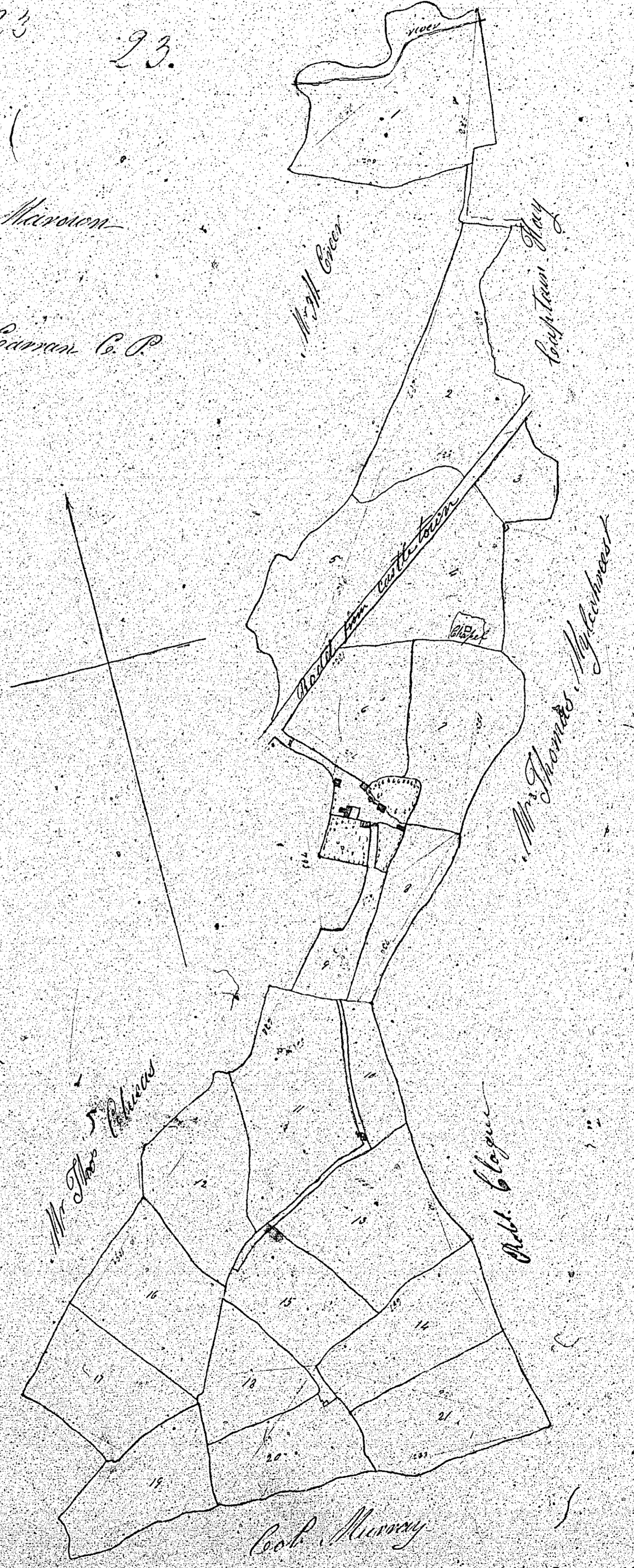

By M. Connors Junr 1844

Plan of the Town of Bullquinn, situated in the parish of  
MARRAVIN

The Property of Mr. John Bull



Total Contents 98.8.10  
177-3-25

24.

Drawn by J. Bull  
1847