

Commons

13

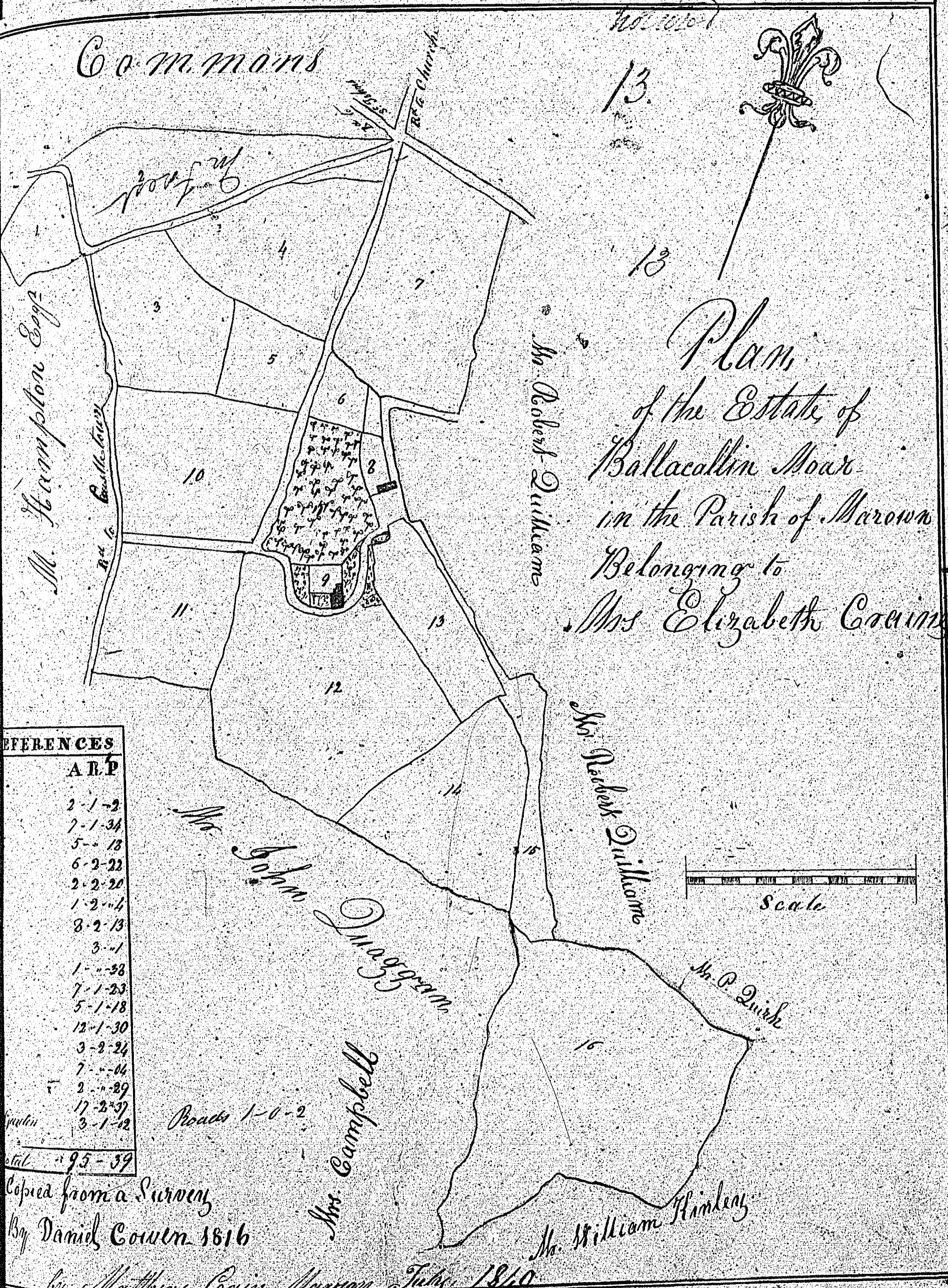

Plan  
of the Estate of  
Ballacallyn Moor  
in the Parish of Marown  
Belonging to  
Mrs Elizabeth Corring

REFERENCES

AR.P
2-1-2
7-1-34
5-1-18
6-2-22
2-2-20
1-2-14
8-2-13
3-1
1-1-38
7-1-23
5-1-18
12-1-30
3-2-24
7-1-14
2-1-29
17-2-29
3-1-12
19-1-39

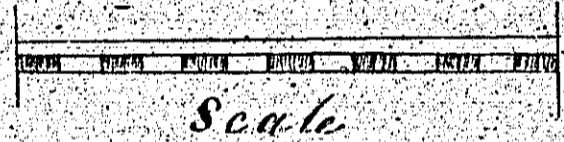

Copied from a Survey  
By Daniel Corring 1816  
By Matthias Corring Marown July 1810

1-1-3	61
1-1-3	62
1-1-3	63
1-1-3	64
1-1-3	65
1-1-3	66
1-1-3	67
1-1-3	68
1-1-3	69
1-1-3	70
1-1-3	71
1-1-3	72
1-1-3	73
1-1-3	74
1-1-3	75
1-1-3	76
1-1-3	77
1-1-3	78
1-1-3	79
1-1-3	80
1-1-3	81
1-1-3	82
1-1-3	83
1-1-3	84
1-1-3	85
1-1-3	86
1-1-3	87
1-1-3	88
1-1-3	89
1-1-3	90
1-1-3	91
1-1-3	92
1-1-3	93
1-1-3	94
1-1-3	95
1-1-3	96
1-1-3	97
1-1-3	98
1-1-3	99
1-1-3	100

Plan  
of part of 14  
Ballachrish  
parish of Marazion.  
The property of  
Mr. John Cree.

Reference		
No.	A.	B.
1	6	35
2	1	37
3	2	0 20
4	1	16
5	2	1 25
6	2	2 37
7	1	7 20
8	1	1 39
9	1	3 8
Sum of	0	0 17
Total	16	3 0

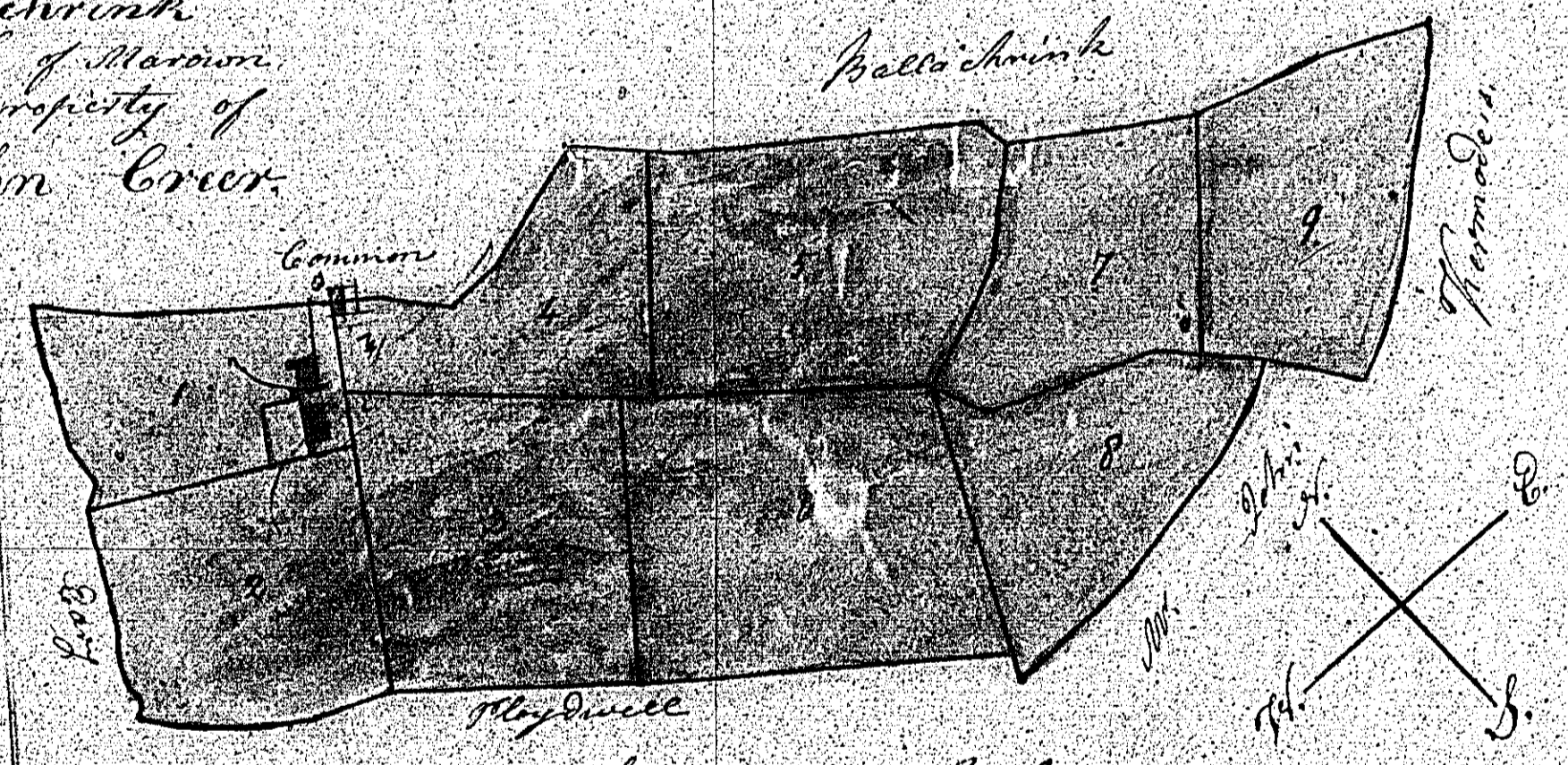

Scale of chains three to an Inch  
J. Cree & A. Bradburn 1840.

*[Faint handwritten notes and a small table in the bottom left corner, partially obscured by a piece of tape.]*

15.

A  
P L A N  
OF  
CHIBNACH,  
INTACK LAND,  
IN THE PARISH OF MAROWN,  
The Property of Mr. W. Cain.

June 16, 1835. 15 M. Cain, Marown.

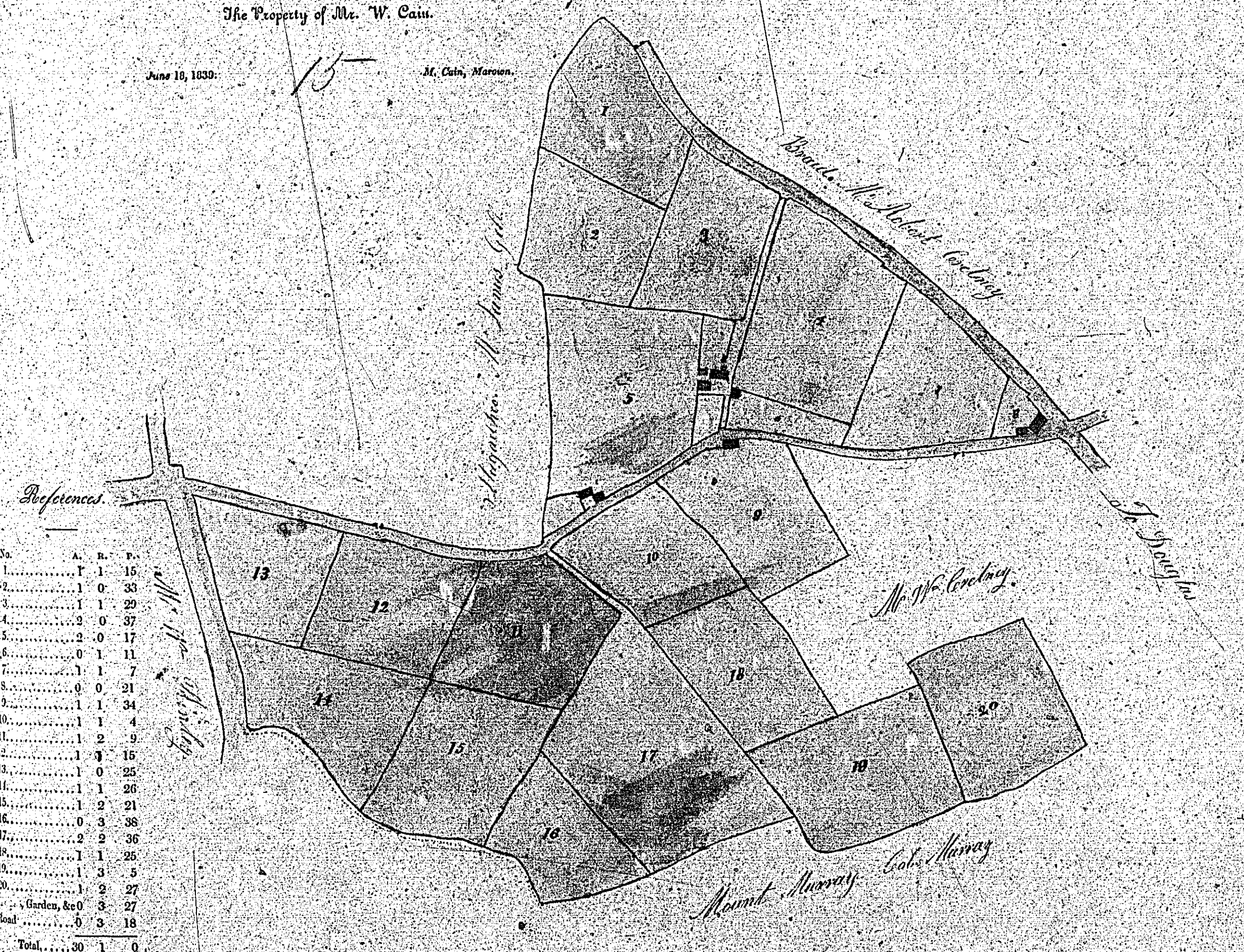

References.

No.	A.	R.	P.
1	1	15	
2	1	35	
3	1	29	
4	2	37	
5	2	17	
6	0	11	
7	1	7	
8	0	21	
9	1	34	
10	1	4	
11	1	3	
12	1	15	
13	1	25	
14	1	26	
15	1	21	
16	0	38	
17	2	36	
18	1	25	
19	1	5	
20	1	27	
21	1	27	
22	5	18	
Total	30	1	0



Surveyed by me  
Matthew Cain

1	15	15	15	15	15
2	35	35	35	35	35
3	29	29	29	29	29
4	37	37	37	37	37
5	17	17	17	17	17
6	11	11	11	11	11
7	7	7	7	7	7
8	21	21	21	21	21
9	34	34	34	34	34
10	4	4	4	4	4
11	3	3	3	3	3
12	15	15	15	15	15
13	25	25	25	25	25
14	26	26	26	26	26
15	21	21	21	21	21
16	38	38	38	38	38
17	36	36	36	36	36
18	25	25	25	25	25
19	5	5	5	5	5
20	27	27	27	27	27
21	27	27	27	27	27
22	18	18	18	18	18
Total	30	1	0		

16.

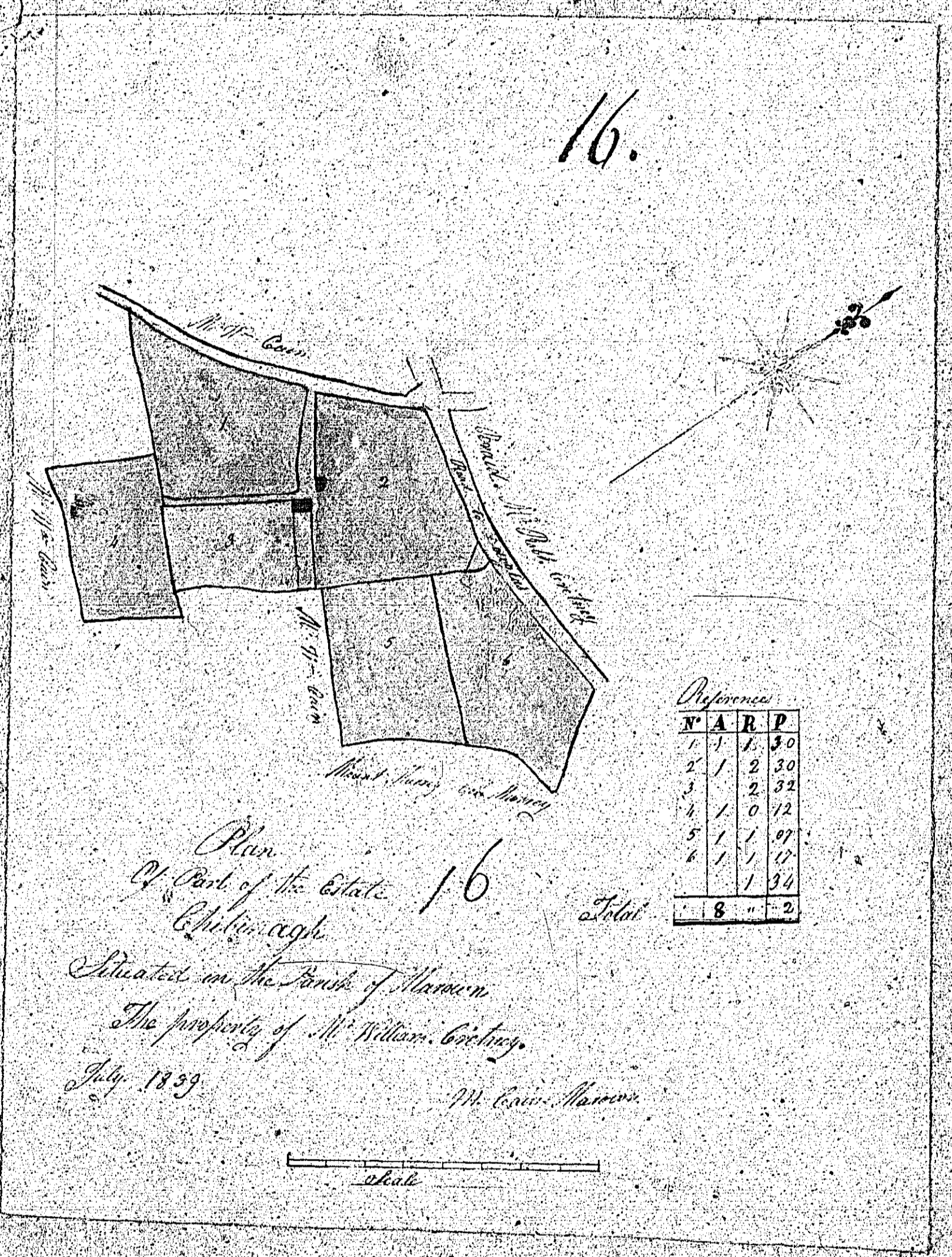

1839

ARP	N	A	P
1	1	1	30
2	1	2	30
3	1	2	32
4	1	0	12
5	1	1	07
6	1	1	07
7	1	1	32
8	1	2	30
9	1	2	30
10	1	2	32
11	1	0	12
12	1	1	07
13	1	1	07
14	1	1	32
15	1	2	30
16	1	2	30
17	1	2	32
18	1	0	12
19	1	1	07
20	1	1	07
21	1	1	32
22	1	2	30
23	1	2	30
24	1	2	32
25	1	0	12
26	1	1	07
27	1	1	07
28	1	1	32
29	1	2	30
30	1	2	30
31	1	2	32
32	1	0	12
33	1	1	07
34	1	1	07
35	1	1	32
36	1	2	30
37	1	2	30
38	1	2	32
39	1	0	12
40	1	1	07
41	1	1	07
42	1	1	32
43	1	2	30
44	1	2	30
45	1	2	32
46	1	0	12
47	1	1	07
48	1	1	07
49	1	1	32
50	1	2	30
51	1	2	30
52	1	2	32
53	1	0	12
54	1	1	07
55	1	1	07
56	1	1	32
57	1	2	30
58	1	2	30
59	1	2	32
60	1	0	12
61	1	1	07
62	1	1	07
63	1	1	32
64	1	2	30
65	1	2	30
66	1	2	32
67	1	0	12
68	1	1	07
69	1	1	07
70	1	1	32
71	1	2	30
72	1	2	30
73	1	2	32
74	1	0	12
75	1	1	07
76	1	1	07
77	1	1	32
78	1	2	30
79	1	2	30
80	1	2	32
81	1	0	12
82	1	1	07
83	1	1	07
84	1	1	32
85	1	2	30
86	1	2	30
87	1	2	32
88	1	0	12
89	1	1	07
90	1	1	07
91	1	1	32
92	1	2	30
93	1	2	30
94	1	2	32
95	1	0	12
96	1	1	07
97	1	1	07
98	1	1	32
99	1	2	30
100	1	2	30
101	1	2	32
102	1	0	12
103	1	1	07
104	1	1	07
105	1	1	32
106	1	2	30
107	1	2	30
108	1	2	32
109	1	0	12
110	1	1	07
111	1	1	07
112	1	1	32
113	1	2	30
114	1	2	30
115	1	2	32
116	1	0	12
117	1	1	07
118	1	1	07
119	1	1	32
120	1	2	30
121	1	2	30
122	1	2	32
123	1	0	12
124	1	1	07
125	1	1	07
126	1	1	32
127	1	2	30
128	1	2	30
129	1	2	32
130	1	0	12
131	1	1	07
132	1	1	07
133	1	1	32
134	1	2	30
135	1	2	30
136	1	2	32
137	1	0	12
138	1	1	07
139	1	1	07
140	1	1	32
141	1	2	30
142	1	2	30
143	1	2	32
144	1	0	12
145	1	1	07
146	1	1	07
147	1	1	32
148	1	2	30
149	1	2	30
150	1	2	32
151	1	0	12
152	1	1	07
153	1	1	07
154	1	1	32
155	1	2	30
156	1	2	30
157	1	2	32
158	1	0	12
159	1	1	07
160	1	1	07
161	1	1	32
162	1	2	30
163	1	2	30
164	1	2	32
165	1	0	12
166	1	1	07
167	1	1	07
168	1	1	32
169	1	2	30
170	1	2	30
171	1	2	32
172	1	0	12
173	1	1	07
174	1	1	07
175	1	1	32
176	1	2	30
177	1	2	30
178	1	2	32
179	1	0	12
180	1	1	07
181	1	1	07
182	1	1	32
183	1	2	30
184	1	2	30
185	1	2	32
186	1	0	12
187	1	1	07
188	1	1	07
189	1	1	32
190	1	2	30
191	1	2	30
192	1	2	32
193	1	0	12
194	1	1	07
195	1	1	07
196	1	1	32
197	1	2	30
198	1	2	30
199	1	2	32
200	1	0	12



Plan  
of the  
Garth  
In the Parish of Maxton  
Belonging to  
M<sup>r</sup> Thomas Collias  
1840

18.

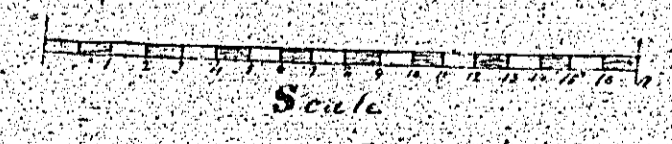

References

N	ARP	N	ARP	N	ARP	N	ARP
1	3 28 1/2	11	6 51	21	3 10	31	2 5 3/4
2	0 2 1/2	12	8 0 1/2	22	1 3 3/8	32	1 2 1/2
3	4 1 2/3	13	7 2 2/3	23	2 2 1/8	33	2 1 1/2
4	1 2 3/4	14	7 2 8/9	24	4 0 2 7/8	34	2 1 1/2
5	7 3 7/8	15	3 0 1 1/2	25	2 3 1/2	35	3 1 1/2
6	2 1 3/4	16	5 1 1/2	26	1 2 6 1/2	36	3 2 1/2
7	2 2 1/4	17	4 1 1/2	27	1 3 1 1/2	37	3 3 1/2
8	1 1 1/2	18	3 2 2 1/2	28	5 3 2 1/2	38	3 3 1/2
9	3 3 1/2	19	3 2 1/2	29	7 3 1 1/2	39	2 0 3/4
10	3 1 1/2	20	3 0 1 1/2	30	2 3 1 1/2	40	10 1 1/2
11	2 1 2 1/2	21	3 2 1/2	31	4 3 1 1/2	41	1 3 1/2
12	1 1 3 1/2	22	15 1 2 1/2	32	4 3 1 1/2	42	8 3 1/2
13	1 1 1 1/2	23	6 1 1 1/2	33	3 2 1 1/2	43	3 3 1/2
14	1 1 1 1/2	24	6 1 1 1/2	34	2 0 1 1/2	44	2 0 1 1/2
15	1 2 0 1/2	25	4 3 3 1/2	35	0 3 3 1/2	45	2 6 1/2
16	1 2 2 1/2	26	3 1 2 1/2	36	3 1 2 1/2	46	3 1 2 1/2
17	3 1 3 1/2	27	10 3 3 1/2	37	3 1 2 1/2	47	3 1 2 1/2
18	1 1 3 1/2	28	8 3 3 1/2	38	3 1 2 1/2	48	3 1 2 1/2

Copyed from a survey by Daniel Collias 1811  
By Thomas Collias Maxton 1840

Total 266 0 28