

124

Plan of Property of  
The Westman of Wales  
List of Buildings  
and other structures  
of value

W. Westman

1	1-0-8
2	5-3-28
3	0-3-8
4	1-0-8
Chimney	4-0-22
Stables	4
Wash-house	2
W.C.	2
Street	2
Total	4-0-32

Scale of 3 chains is marked

Drawn by Geo. Weston  
April 27<sup>th</sup> 1860

1	25
2	26
3	27
4	28
5	29
6	30
7	31
8	32
9	33
10	34
11	35
12	36
13	37
14	38
15	39
16	40
17	41
18	42
19	43
20	44
21	45
22	46
23	47
24	48
25	49
26	50
27	51
28	52
29	53
30	54
31	55
32	56
33	57
34	58
35	59
36	60
37	61
38	62
39	63
40	64
41	65
42	66
43	67
44	68
45	69
46	70
47	71
48	72
49	73
50	74
51	75
52	76
53	77
54	78
55	79
56	80
57	81
58	82
59	83
60	84
61	85
62	86
63	87
64	88
65	89
66	90
67	91
68	92
69	93
70	94
71	95
72	96
73	97
74	98
75	99
76	100

PLAN AND SURVEY  
 OF PART OF  
**AR FIELD**  
 QUARTERLAND  
 THE PROPERTY OF  
*Wm. Hollister*  
**ARBORY**  
 BY DANIEL CREGEEN MAY 1840

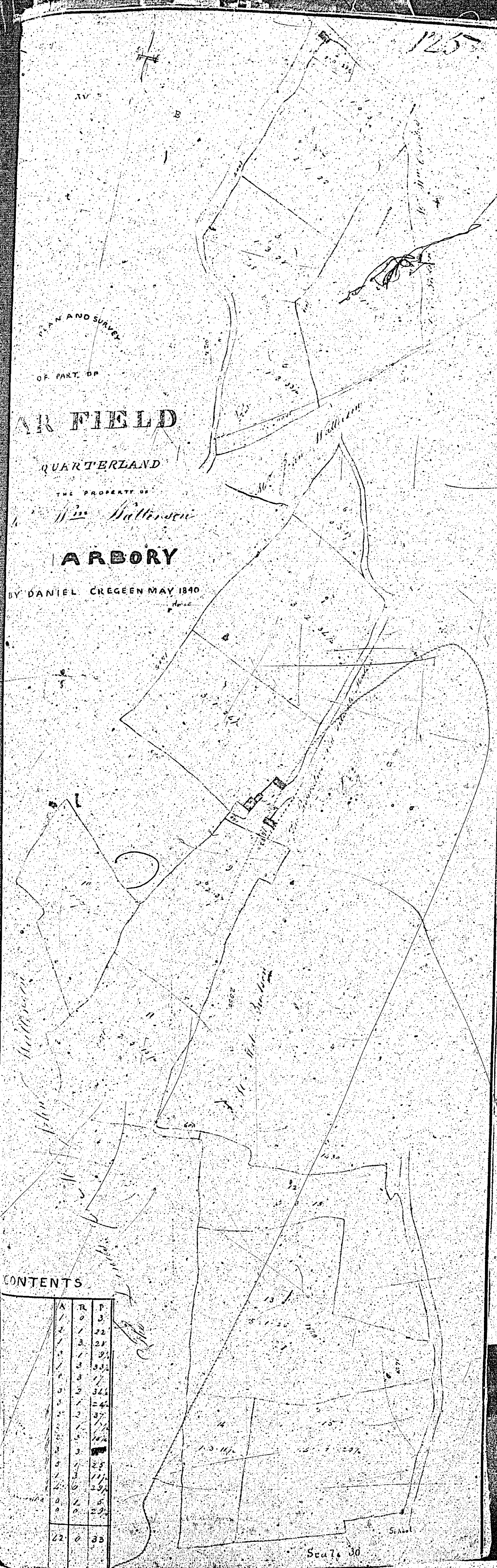

**CONTENTS**

1	1	0	05			
2	2	2	21			
3	3	2	24			
4	1	8	20			
5	2	1	0			
6	1	2	1			
7	Garden	0	0	33		
8	Botany Hall	1	0	22		
<b>Total</b>				<b>11</b>	<b>2</b>	<b>8</b>

**CONTENTS**

A	R	P
1	0	3
2	1	28
3	2	27
4	3	30
5	4	33
6	5	34
7	6	34
8	7	34
9	8	34
10	9	34
11	10	34
12	11	34
13	12	34
14	13	34
15	14	34
16	15	34
17	16	34
18	17	34
19	18	34
20	19	34
21	20	34
22	21	34
23	22	34
24	23	34
25	24	34
26	25	34
27	26	34
28	27	34
29	28	34
30	29	34
31	30	34
32	31	34
33	32	34
34	33	34
35	34	34
36	35	34
37	36	34
38	37	34
39	38	34
40	39	34
41	40	34
42	41	34
43	42	34
44	43	34
45	44	34
46	45	34
47	46	34
48	47	34
49	48	34
50	49	34
51	50	34
52	51	34
53	52	34
54	53	34
55	54	34
56	55	34
57	56	34
58	57	34
59	58	34
60	59	34
61	60	34
62	61	34
63	62	34
64	63	34
65	64	34
66	65	34
67	66	34
68	67	34
69	68	34
70	69	34
71	70	34
72	71	34
73	72	34
74	73	34
75	74	34
76	75	34
77	76	34
78	77	34
79	78	34
80	79	34
81	80	34
82	81	34
83	82	34
84	83	34
85	84	34
86	85	34
87	86	34
88	87	34
89	88	34
90	89	34
91	90	34
92	91	34
93	92	34
94	93	34
95	94	34
96	95	34
97	96	34
98	97	34
99	98	34
100	99	34
101	100	34
102	101	34
103	102	34
104	103	34
105	104	34
106	105	34
107	106	34
108	107	34
109	108	34
110	109	34
111	110	34
112	111	34
113	112	34
114	113	34
115	114	34
116	115	34
117	116	34
118	117	34
119	118	34
120	119	34
121	120	34
122	121	34
123	122	34
124	123	34
125	124	34

Plan  
 of Part of the Estate of  
**BALLOWIN** in the  
 Parish of *Maclan*  
 THE PROPERTY  
 of *W. Shearn & Co.*

SCALE 3 CHAINS to an INCH.  
 THE GREAT SURVEYOR 1810



CONTENTS

1	1	R	15
2	2	4	25
3	3	3	24
4	1	8	20
5	2	1	0
6	1	2	1
7	Garden	0	15
8	Eastward of Plot	1	24
Total		10	2 8

Year	1780	1781	1782	1783	1784	1785	1786	1787	1788	1789	1790	1791	1792	1793	1794	1795	1796	1797	1798	1799
Barley	3	3	3	3	3	3	3	3	3	3	3	3	3	3	3	3	3	3	3	3
Wheat	3	3	3	3	3	3	3	3	3	3	3	3	3	3	3	3	3	3	3	3
Peas	3	3	3	3	3	3	3	3	3	3	3	3	3	3	3	3	3	3	3	3
Other	3	3	3	3	3	3	3	3	3	3	3	3	3	3	3	3	3	3	3	3

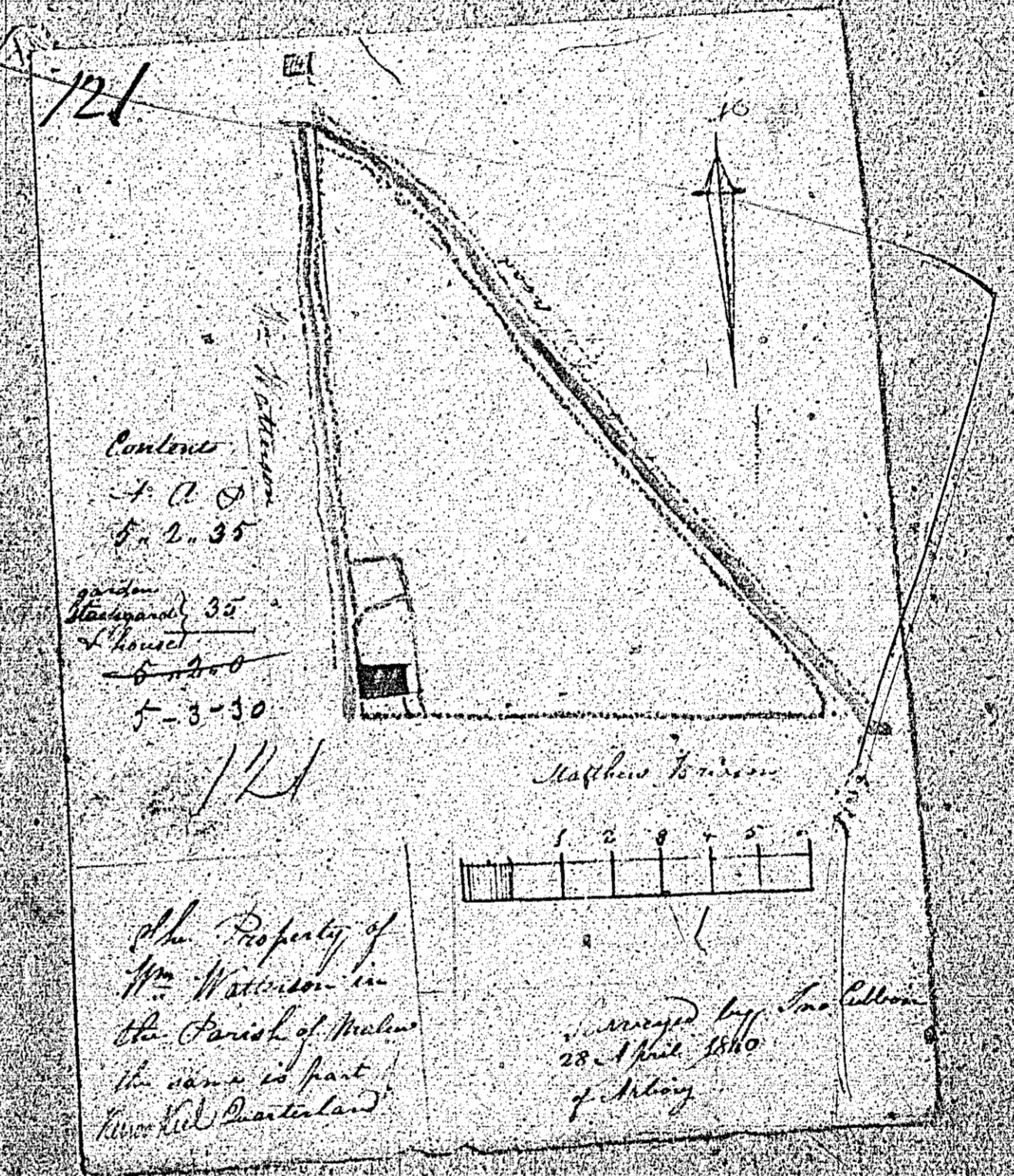

Contours  
 1. 0. 0  
 2. 0. 35  
 3. 0. 70  
 4. 1. 05  
 5. 1. 40

All Property of  
 The Warden in  
 the Parish of M...  
 the same as part  
 of the Charter...



Surveyed by Mr. L...  
 28th April 1800  
 J. King

122  
 122

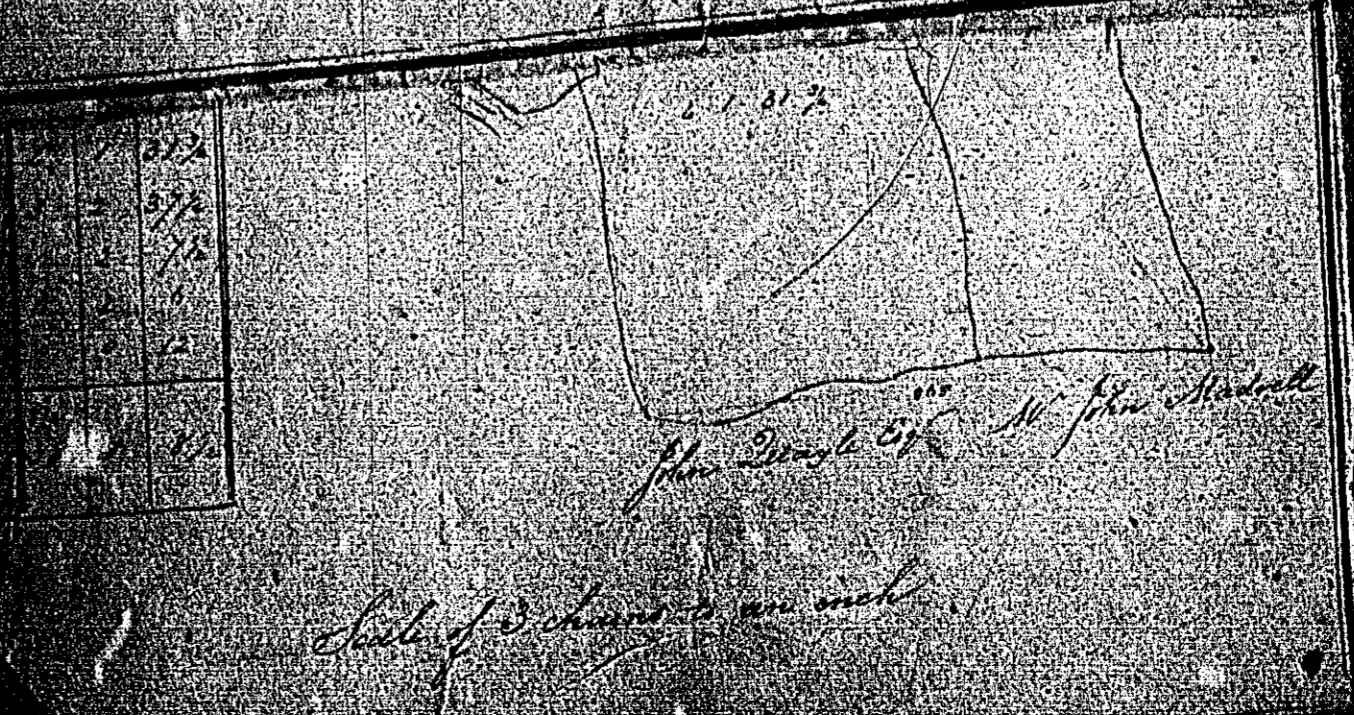

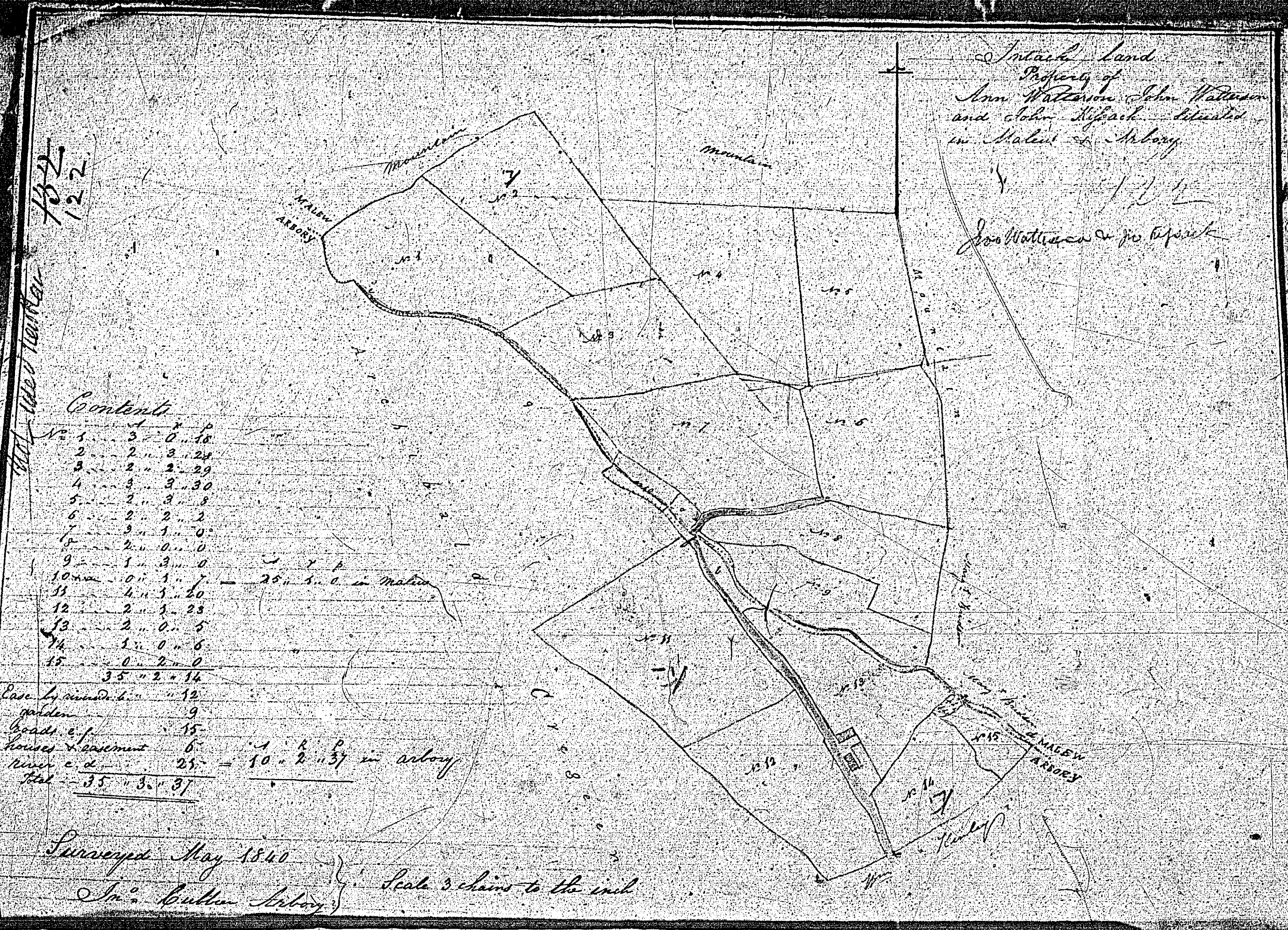

ISLE OF MAN GOVERNMENT: GENERAL REGISTRY  
 TITHE PLANS: PARISH OF MALEW  
 Original coloured (decorative) 1:30

DUNVOY  
 PART OF  
**BALLAROBBIN QUARTERLAND**  
 SITUATE IN  
 the Parish of  
**JOHN WATTERSON**  
 BY DANIEL CRESGEE MAY 1830

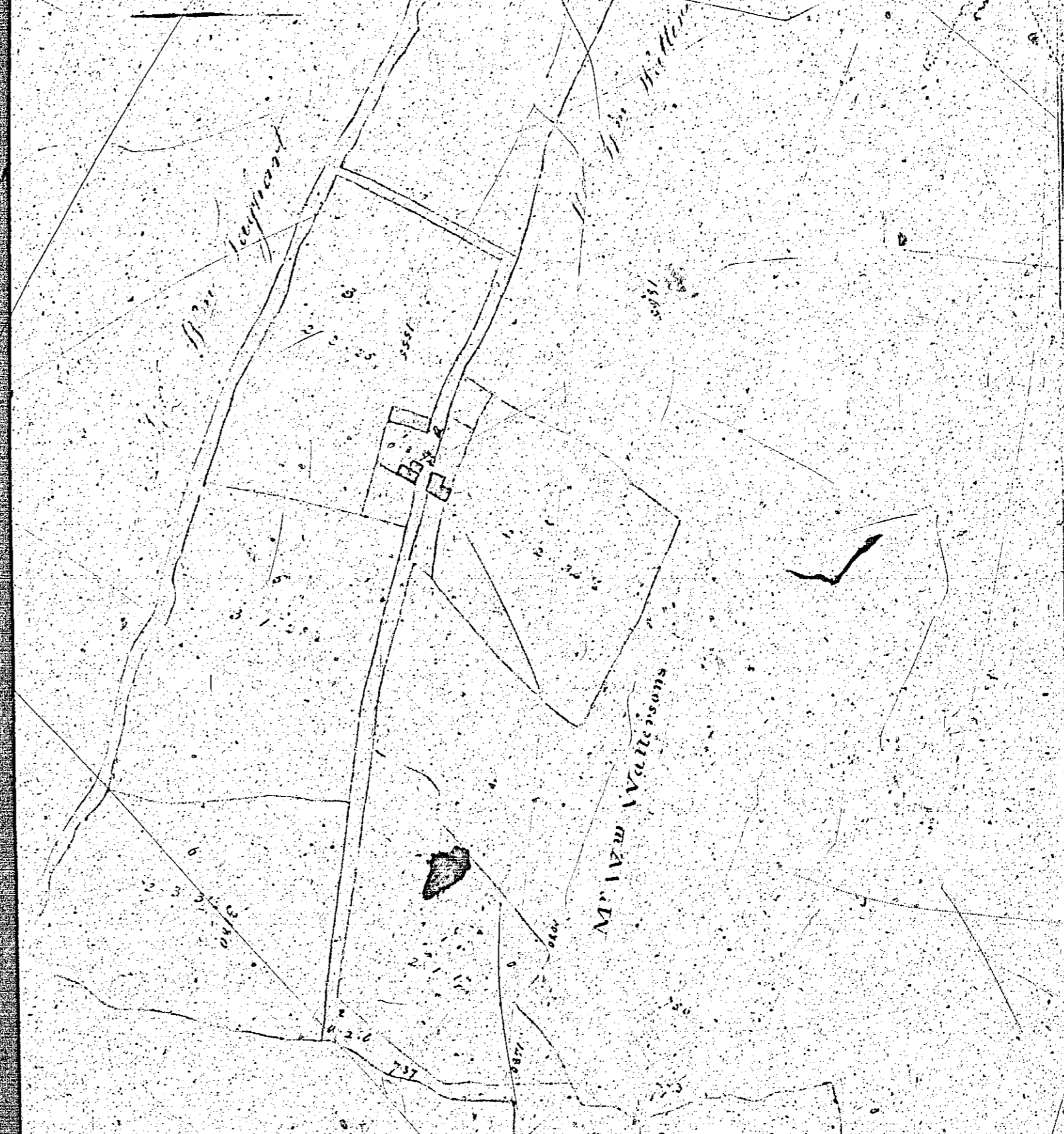

CONTENTS

No.	A.	R.	P.
1	0	0	0
2	2	3	3
3	2	3	3
4	1	3	3
5	3	3	3
6	1	1	1
7	1	1	1
8	1	1	1
9	1	1	1
10	1	1	1
11	1	1	1
12	1	1	1
13	1	1	1
14	1	1	1
15	1	1	1
16	1	1	1
17	1	1	1
18	1	1	1
19	1	1	1
20	1	1	1
21	1	1	1
22	1	1	1
23	1	1	1
24	1	1	1
25	1	1	1
26	1	1	1
27	1	1	1
28	1	1	1
29	1	1	1
30	1	1	1
31	1	1	1
32	1	1	1
33	1	1	1
34	1	1	1
35	1	1	1
36	1	1	1
37	1	1	1
38	1	1	1
39	1	1	1
40	1	1	1
41	1	1	1
42	1	1	1
43	1	1	1
44	1	1	1
45	1	1	1
46	1	1	1
47	1	1	1
48	1	1	1
49	1	1	1
50	1	1	1
51	1	1	1
52	1	1	1
53	1	1	1
54	1	1	1
55	1	1	1
56	1	1	1
57	1	1	1
58	1	1	1
59	1	1	1
60	1	1	1
61	1	1	1
62	1	1	1
63	1	1	1
64	1	1	1
65	1	1	1
66	1	1	1
67	1	1	1
68	1	1	1
69	1	1	1
70	1	1	1
71	1	1	1
72	1	1	1
73	1	1	1
74	1	1	1
75	1	1	1
76	1	1	1
77	1	1	1
78	1	1	1
79	1	1	1
80	1	1	1
81	1	1	1
82	1	1	1
83	1	1	1
84	1	1	1
85	1	1	1
86	1	1	1
87	1	1	1
88	1	1	1
89	1	1	1
90	1	1	1
91	1	1	1
92	1	1	1
93	1	1	1
94	1	1	1
95	1	1	1
96	1	1	1
97	1	1	1
98	1	1	1
99	1	1	1
100	1	1	1

Daniel Cresgee  
 Scale of 3 chains to an inch