

Contents

meas	1. 3. 14
"	2. 2. 20
"	2. 1. 9
"	2. 2. 0
"	2. 3. 21
meas	0. 1. 0
meas	0. 0. 0
total	19. 3. 39 1/2

3 man work

ich

The two following plans are
numbered 15

15
 Plan of a parcel of
 Antack
 in the Parish of Malen
 the property of
 Mr. W. B. Biddison

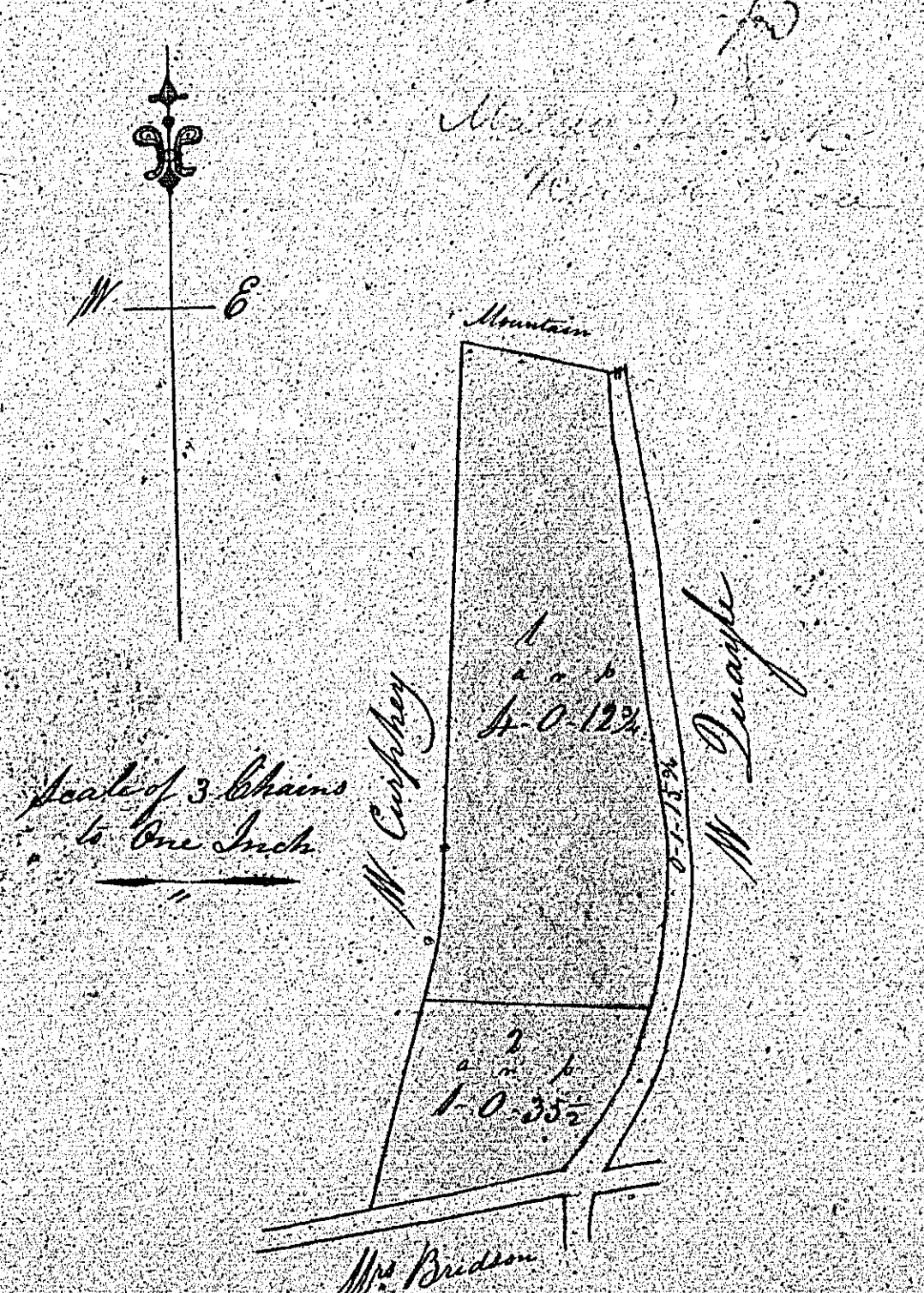

J. Cowell of Bide
 Surveyor 1840

Contents
 5-2-24
 1-0-33 1/2

Contents

Contents	1-3-24
do	2-2-20
do	2-1-9
do	2-2-0
do	2-3-21
Wassho	0-2-0
Garden	0-0-24
Total	13-2-18

13 to 24 1/2 CH

1ch

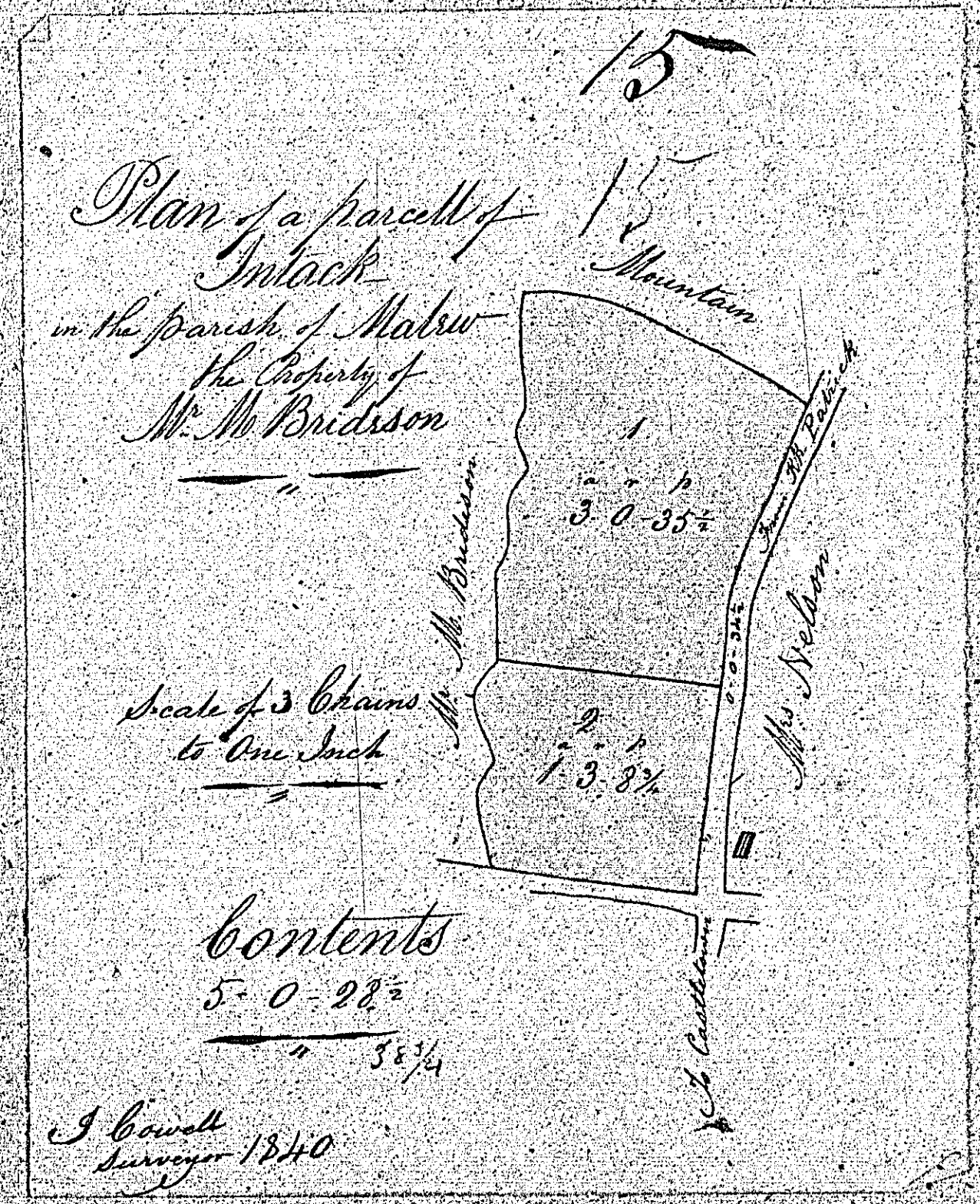

CONTENTS

acres	5.3.44
"	2.2.20
"	2.1.9
"	2.2.0
"	2.5.21
roods	0.7.0
perches	0.0.24
Total	13.2.18

PLAN

rch

17
16

Plan
part of the Estate of
Ballaquarun
Parish of Malahy

THE PROPERTY
of
Messrs Roper & Co



Contents

No. 1 Contains	1.8.2
2	2.2.20
3	2.1.9
4	2.2.0
5	2.3.21
rick Yard	0.1.0
Garden	0.0.26
Total	12.2.18

SCALE 2 CHAINS to an INCH

THOMAS GICK SURVEYOR 1840

THOMAS GICK SURVEYOR

1840

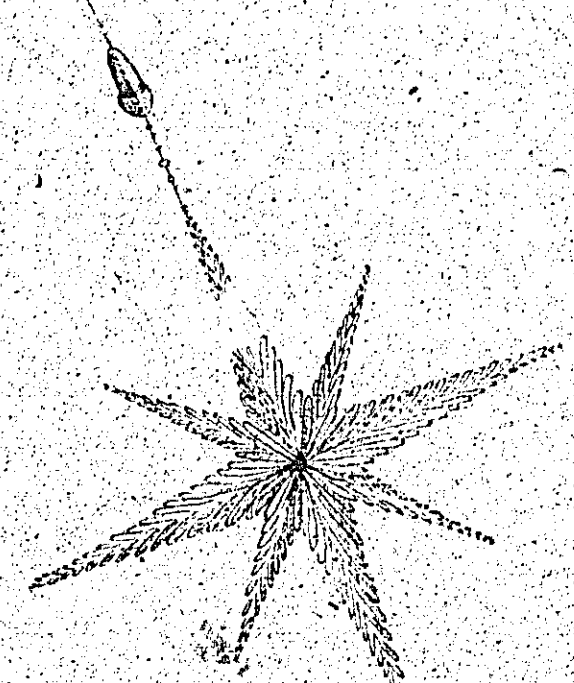

Plan Survey

Part of the Estate of
(BALLAGARAI)

In the Parish of Malew

The property
of
M. THOMAS CALV.

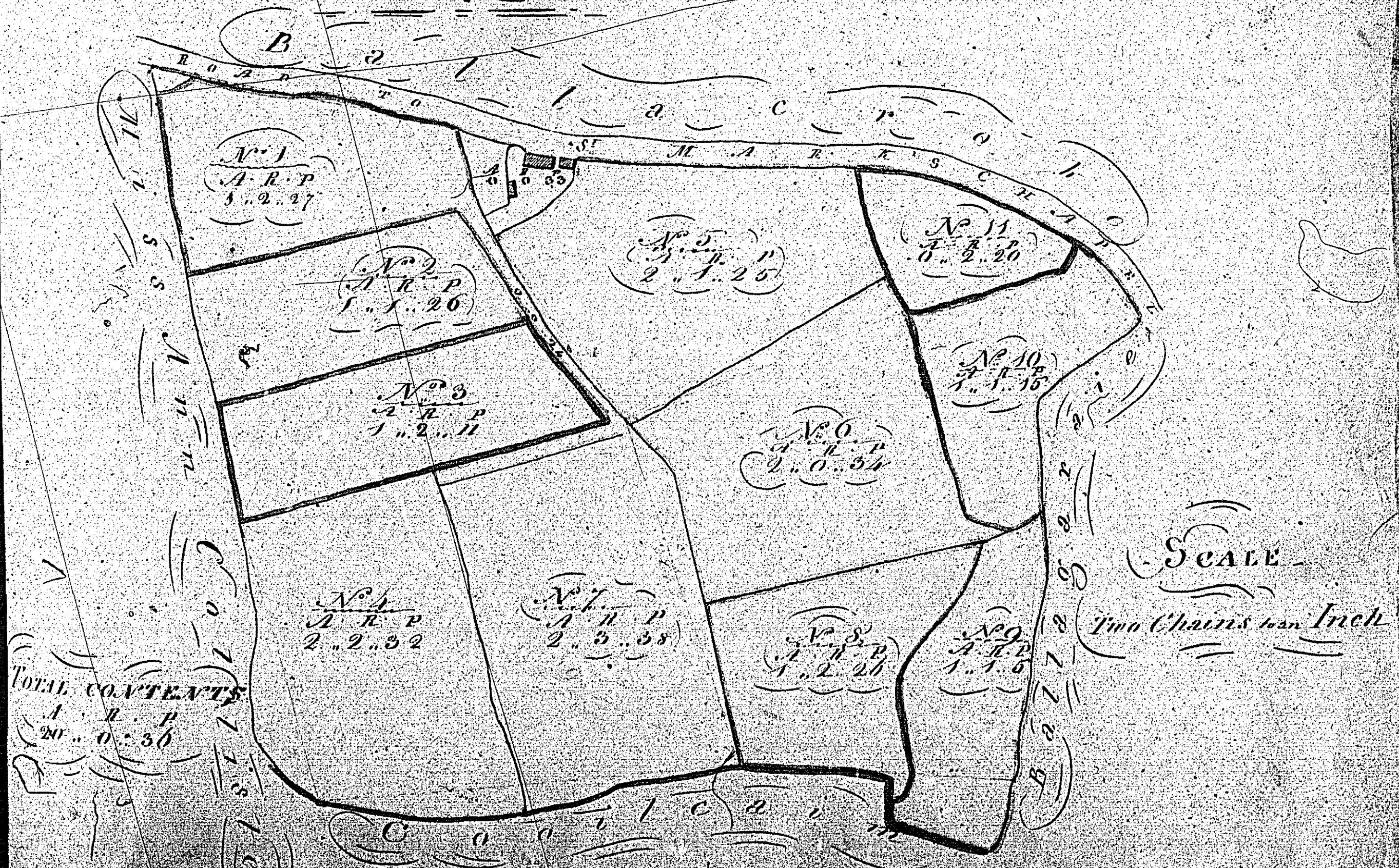

THOMAS CALV. SURVEYOR

1840