

214.

A Plan & Survey of Land  
 being Black Land with part of the  
 Land of Godalman in the  
 Parish of Linn the property of  
 the John Thibbom by  
 Patrick Kelly June 22 1854

1854

No.	A.	R.	I.
1	5	3	36
2	2	2	13
3	2	2	36
4	4	1	37
5	4	0	16
6	2	1	3
7	2	1	39
8	2	0	11
9	2	2	33
10	2	0	33
11	0	1	26
12	0	3	22
13	2	1	4
14	1	0	13
15	3	3	26
16	3	0	7
17	3	2	1
18	3	1	31
19	0	0	35
20	3	3	32
21	2	12	

Scale 5 Chains to one inch



*Not used*  
**PLAN and ADMEASUREMENT of GRATCH-VOOAR**

*in the Lonnan the Property of Mr. John Skilleen June 1825*

215

*References*

No.	Acres	Roods	Poles
1	2	2	25
2	2	1	25
3	1	3	6
4	2	1	10
5	1	2	26
6	2	1	22
7	1	1	23
8	2	0	4
9	1	3	6
10	2	0	27
11	2	1	29
12	2	2	27
13	1	3	7
14	1	1	14
15	1	3	8
16	5	2	16
17	2	2	28
18	1	1	13
19	1	1	4
20	2	0	10
21	2	2	34
22	1	0	10
23	3	0	12
<i>Total</i>	<i>47</i>	<i>3</i>	<i>29</i>



ISLE OF MAN GOVERNMENT: GENERAL REGISTRY

TITHE PLANS: PARISH OF LONAN

Original coloured, marked

1:30







A Plan & Survey of Wingham  
Infect land in the parish of Tonon  
the Property of Mr. James Littleton  
by Patrick Littleton Esq. Decemr 21 1789

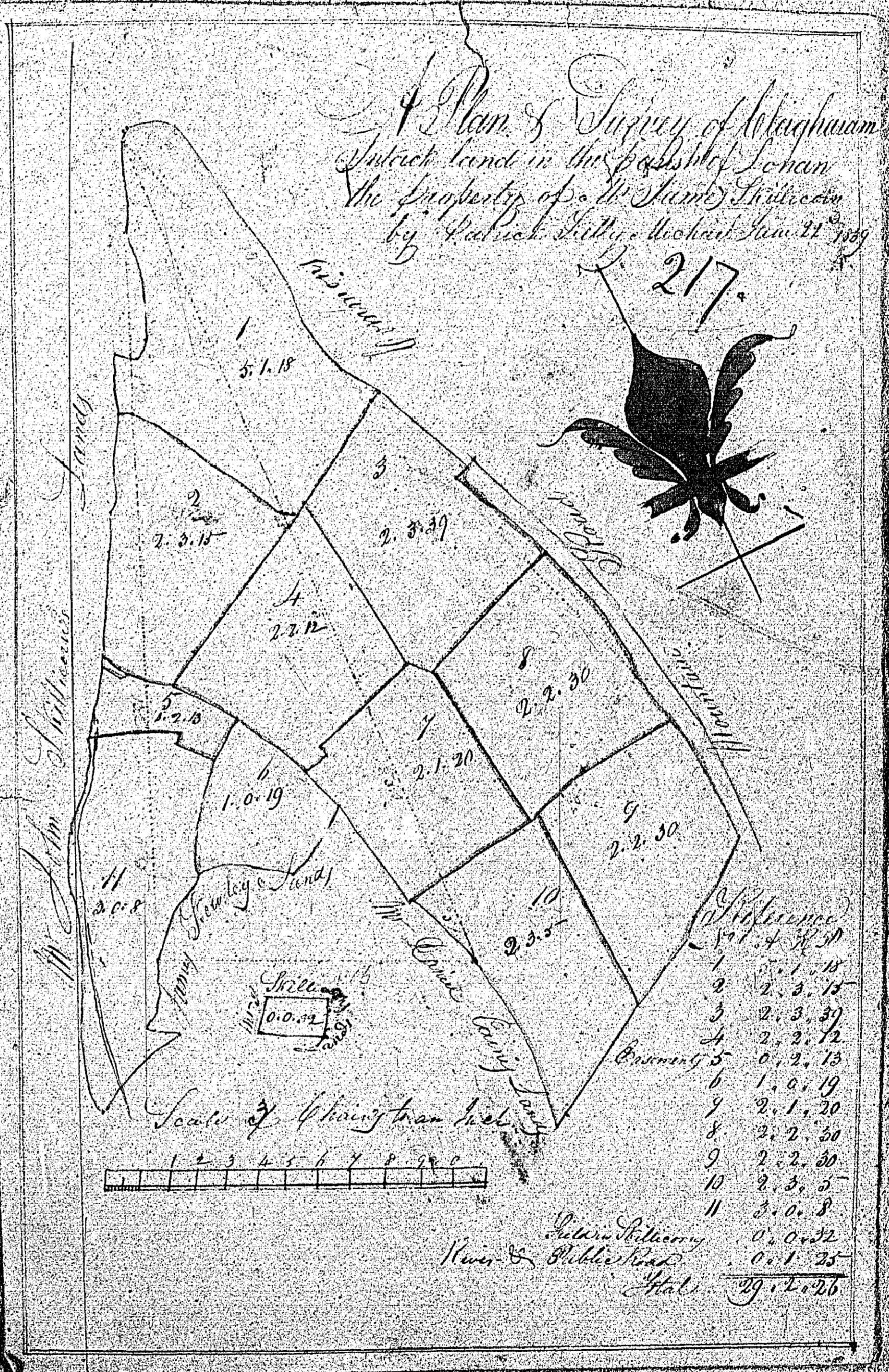



218

218

Noticed

A Plan & Survey of a  
 piece of College Land in 218.  
 in the Parish of Senan the  
 property of Mr. Philip Sullivan  
 by Robert Coley Muckel  
 July 10 1839

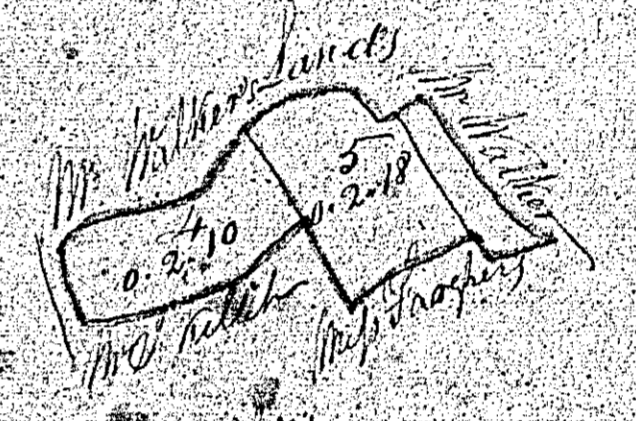
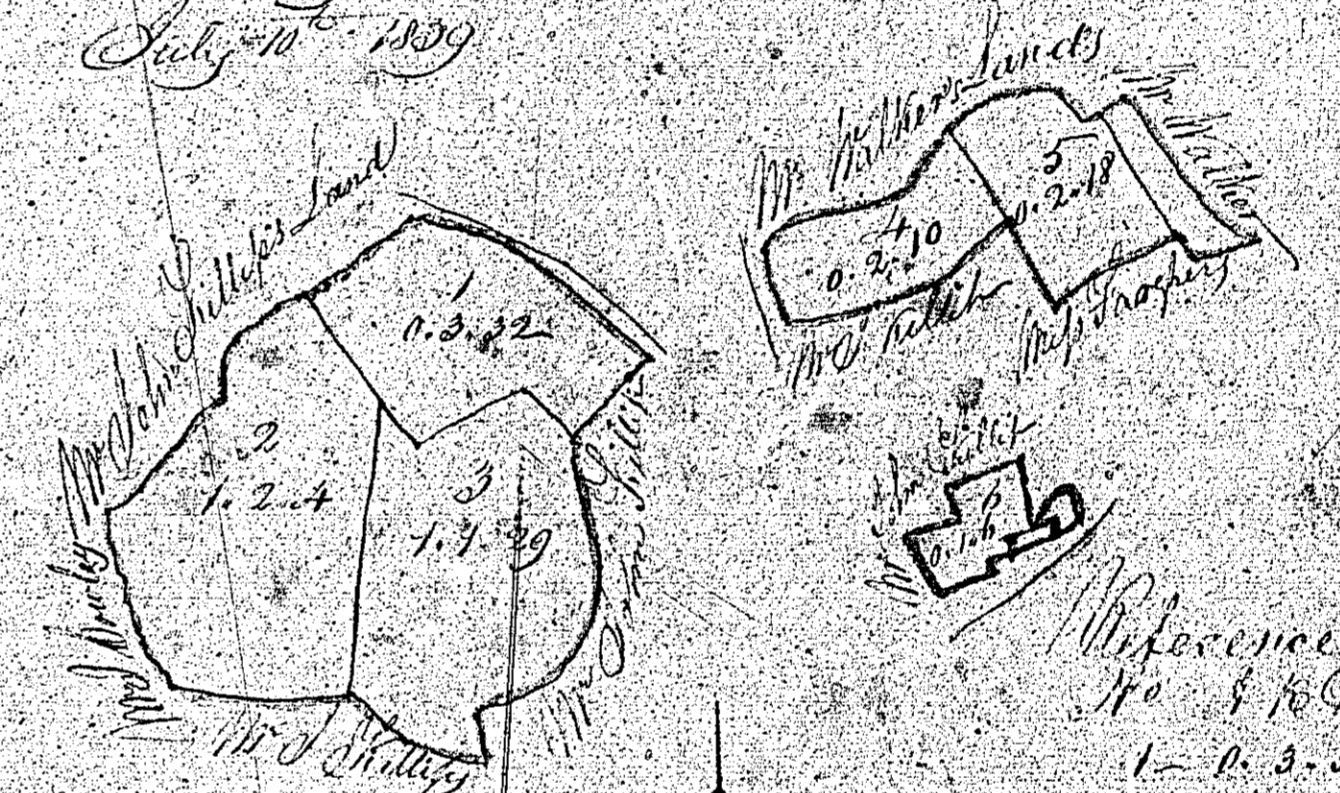

- Reference  
 No. 8 1839
- 1- 0.3.32
  - 2- 1.2.4
  - 3- 1.1.29
  - 4- 0.2.10
  - 5- 0.2.18
  - 6- 0.1.1
  - House & Enclosure 0-0.0
  - Public Road 0-0.0
  - Place Garden 5.2.10



Scale of Spring





The two following plans are  
numbered 219