

185
185

Notice
A Plan and survey of a
part of Close Bayle in the
parish of Llangrove the pro-
perty of Thomas S. Williams
Myllecharaine taken
July 25th 1859 274.
By Abel Merris

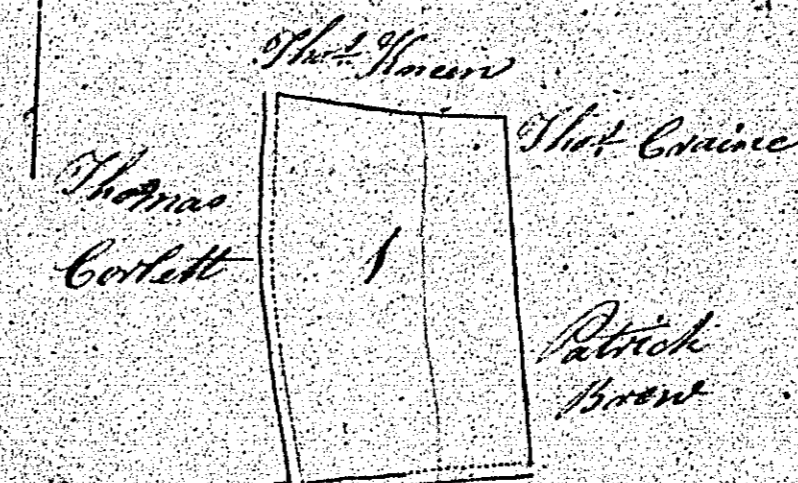

R² Contents
1-1-3-28
10-0-0-27
total 2-1-15

A scale of 6 Chains to an Inch

Notice
A Plan and survey of a
part of Close Bayle in the
parish of Llangrove the pro-
perty of Thomas S. Williams
Myllecharaine taken
July 25th 1859 274.
By Abel Merris

16
17

A Plan and Survey
 of a part of Cambridge
 in the parish of St. Andrew
 the property of Thomas
 Mylchreave taken
 June 26th 1859
 by Albert Herriest

275.

W. P. Lawrence

Constant
 88. 4. 1. 1. P
 1. 0. 0. 4
 2. 0. 1. 34
 52. 0. 0. 58

A Scale of 1000 feet

1859

1	10
2	15
3	19
4	23
5	28
6	33
7	38
8	43
9	48
10	53
11	58
12	63
13	68
14	73
15	78
16	83
17	88
18	93
19	98
20	103
21	108
22	113
23	118
24	123
25	128
26	133
27	138
28	143
29	148
30	153
31	158
32	163
33	168
34	173
35	178
36	183
37	188
38	193
39	198
40	203
41	208
42	213
43	218
44	223
45	228
46	233
47	238
48	243
49	248
50	253
51	258
52	263
53	268
54	273
55	278
56	283
57	288
58	293
59	298
60	303
61	308
62	313
63	318
64	323
65	328
66	333
67	338
68	343
69	348
70	353
71	358
72	363
73	368
74	373
75	378
76	383
77	388
78	393
79	398
80	403
81	408
82	413
83	418
84	423
85	428
86	433
87	438
88	443
89	448
90	453
91	458
92	463
93	468
94	473
95	478
96	483
97	488
98	493
99	498
100	503

A Plan and survey of a part
of the Shippin Tract the pro-
perty of William M. Chapman
situated in the parish of Legerre
taken May 1. 1839 by A. Merrick
276.

John Hunt W. Chapman
William Chapman
4.14.10
4.5.3
W. Chapman
John Hunt
William Chapman
John Hunt
A scale of 3 chains
to an inch

Acres

1	2.16
2	0.19
3	3.13
4	0.28
5	0.29
6	0.0
7	5.2
8	2.18
9	0.18
10	5.58
11	5.14
12	3.26
13	1.36
14	2.21
15	1.18
16	1.16
17	1.22
18	1.16
19	1.16
20	1.16
21	1.16
22	1.16
23	1.16
24	1.16
25	1.16
26	1.16
27	1.16
28	1.16
29	1.16
30	1.16

277

Just used

277.

St. Ann's

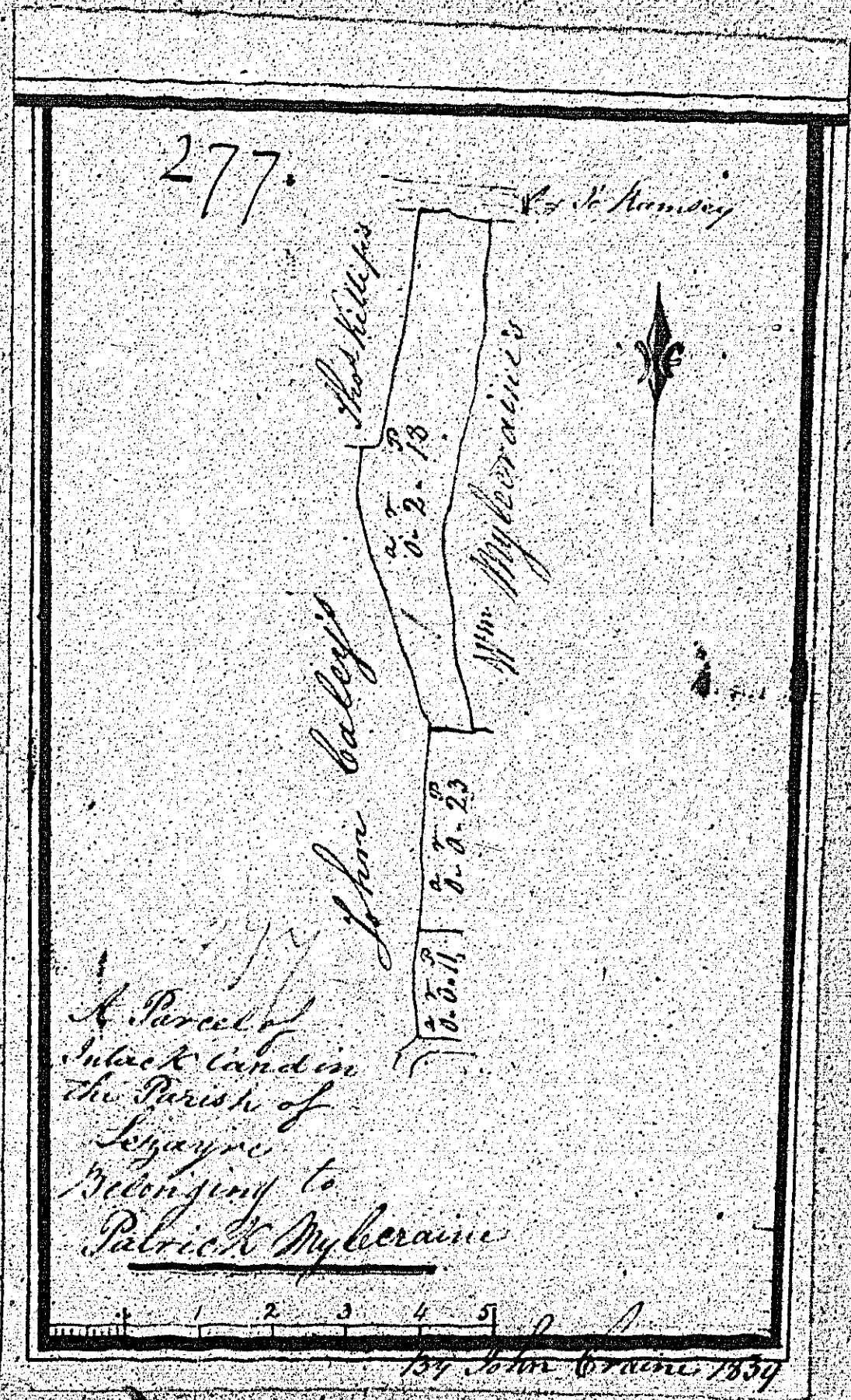

A Parcel of
land in
the Parish of
Loughrea
belonging to
Patrick McKeown

John Calley 1837

Notes

1	10
2	15
3	15
4	15
5	15
6	15
7	15
8	15
9	15
10	15
11	15
12	15
13	15
14	15
15	15
16	15
17	15
18	15
19	15
20	15
21	15
22	15
23	15
24	15
25	15
26	15
27	15
28	15
29	15
30	15
31	15
32	15
33	15
34	15
35	15
36	15
37	15
38	15
39	15
40	15
41	15
42	15
43	15
44	15
45	15
46	15
47	15
48	15
49	15
50	15

Plan numbered 278 is bound
out of sequence, after 279

15
16
17
18
19
20
21
22
23
24
25
26
27
28
29
30
31
32
33
34
35
36
37
38
39
40
41
42
43
44
45
46
47
48
49
50

279

A
Plan & Survey
of a Small Garden
the property of
Wm. Mulbreest
Barnsey

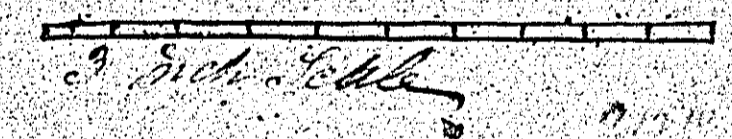
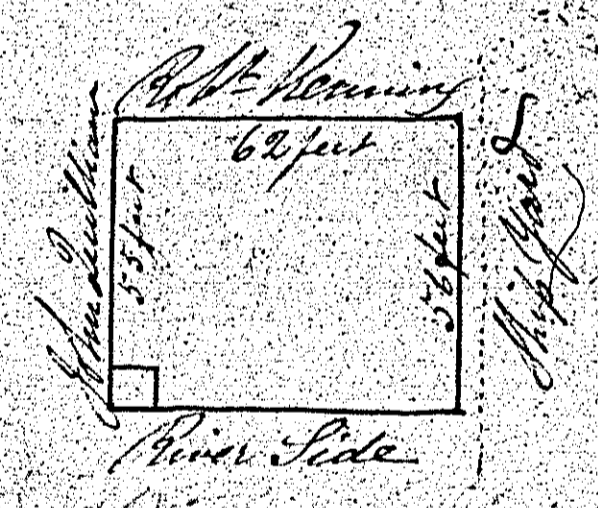

Contents 764 feet

Ards

1	10
2	10
3	10
4	10
5	28
6	39
7	0
8	0
9	2
10	15
11	10
12	10
13	10
14	10
15	10
16	10
17	10
18	10
19	10
20	10
21	10
22	10
23	10
24	10
25	10
26	10
27	10
28	10
29	10
30	10