

Parcel 1
A parcel of land
with the built up
Loggia
belonging to
Wm. Corbett
Hallough

Parcel 2
A parcel of
land in the Parish
of Loggia
belonging to
John Corbett
Hallough

Not used

118. A Plan and Survey of A part of Bontack
Called Clivernock &c situated in the
parish of Lerrayre the property of
John Corley taken June 20th 1859
By Albert Thomas
Per Myllhammet. A scale of 3 Chains to an Inch.

John Corley
John Corley

Wm. Hillis

Wm. Collett

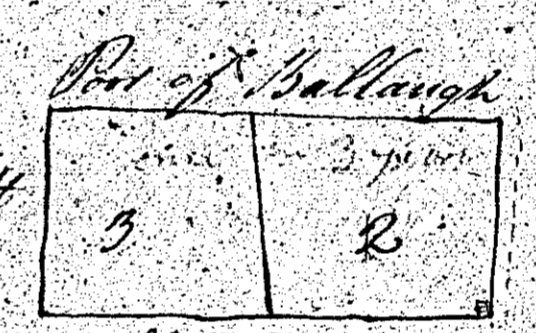

Thomas Collett

Contents

- 1 - 0. 5. 5
- 2 - 1. 0. 1
- 3 - 0. 5. 5
- 4 - 0. 3. 2
- Total 3. 2. 2

John Casement

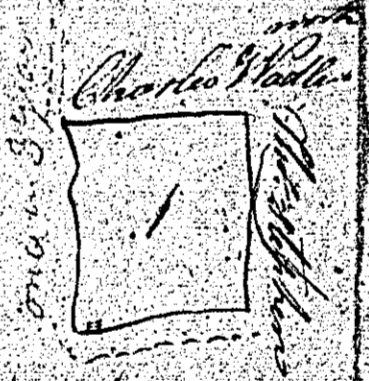

119.
Purchased

A PLAN
of SURVEYING
the
The Property of T. Conner
M. T. EARLE
Dated 1837

119.
Stonewall
367
333

TCOWLE
NIMODI

1	2	3	4	5	6	7	8	9	10
---	---	---	---	---	---	---	---	---	----

W.M. No. 1
Scale of 1/2 inch

Historical

120.

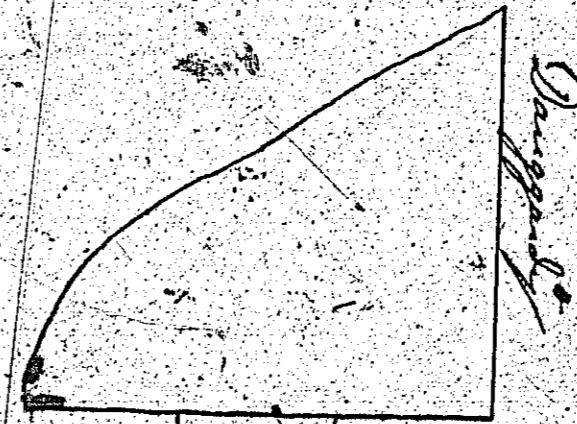

*Plan and Survey
of two fields
in Clonmough, Duane's
belonging to
Mrs. Sarah Cowley in Leinster
by John Brown June 5th 1789*

The Honble. War Office

121.

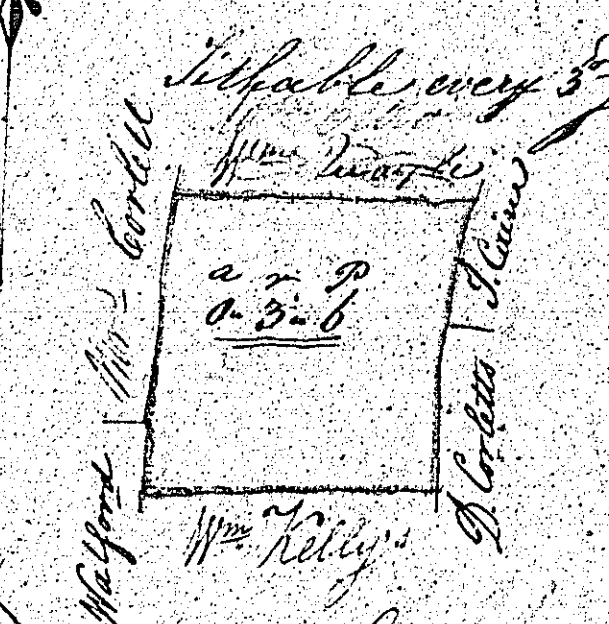

*A Plan & Survey
 of a Parcel of Arable Land
 in the Parish of
 Loxapine
 Belonging to
 Mr. Thomas Cowley*

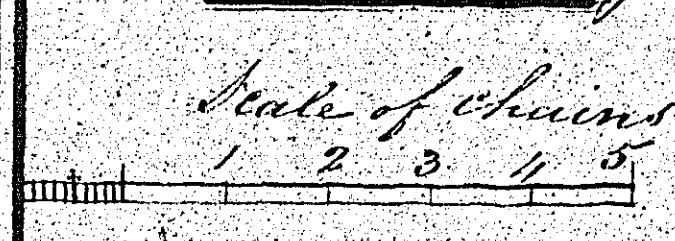

By John Gwynne 1839

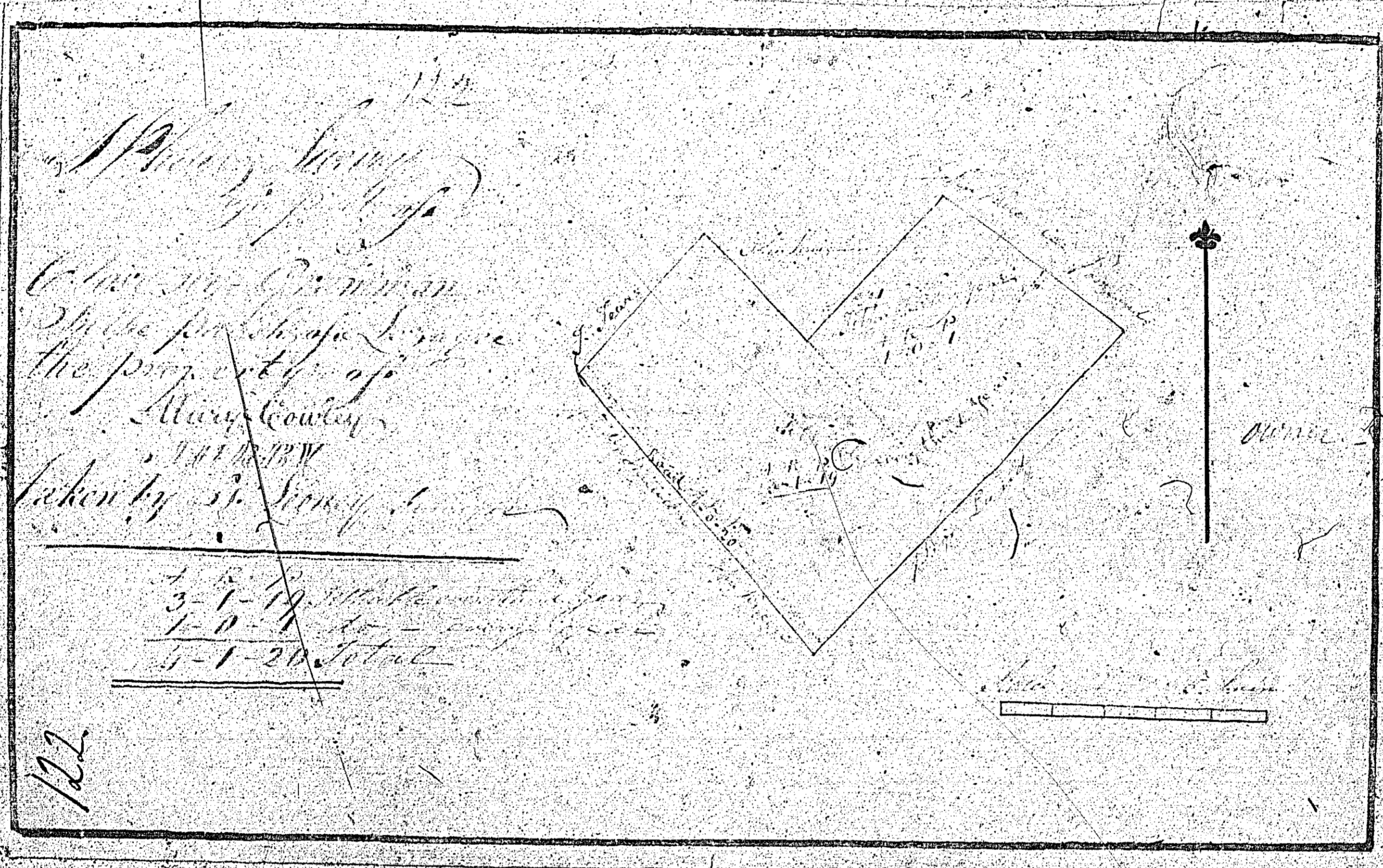

ISLE OF MAN GOVERNMENT: GENERAL REGISTRY

TITHE PLANS: PARISH OF LEZAYRE

Original monotone, faint

1:30