

No. 1000

Plan of John Corhill's Property Survey 28.

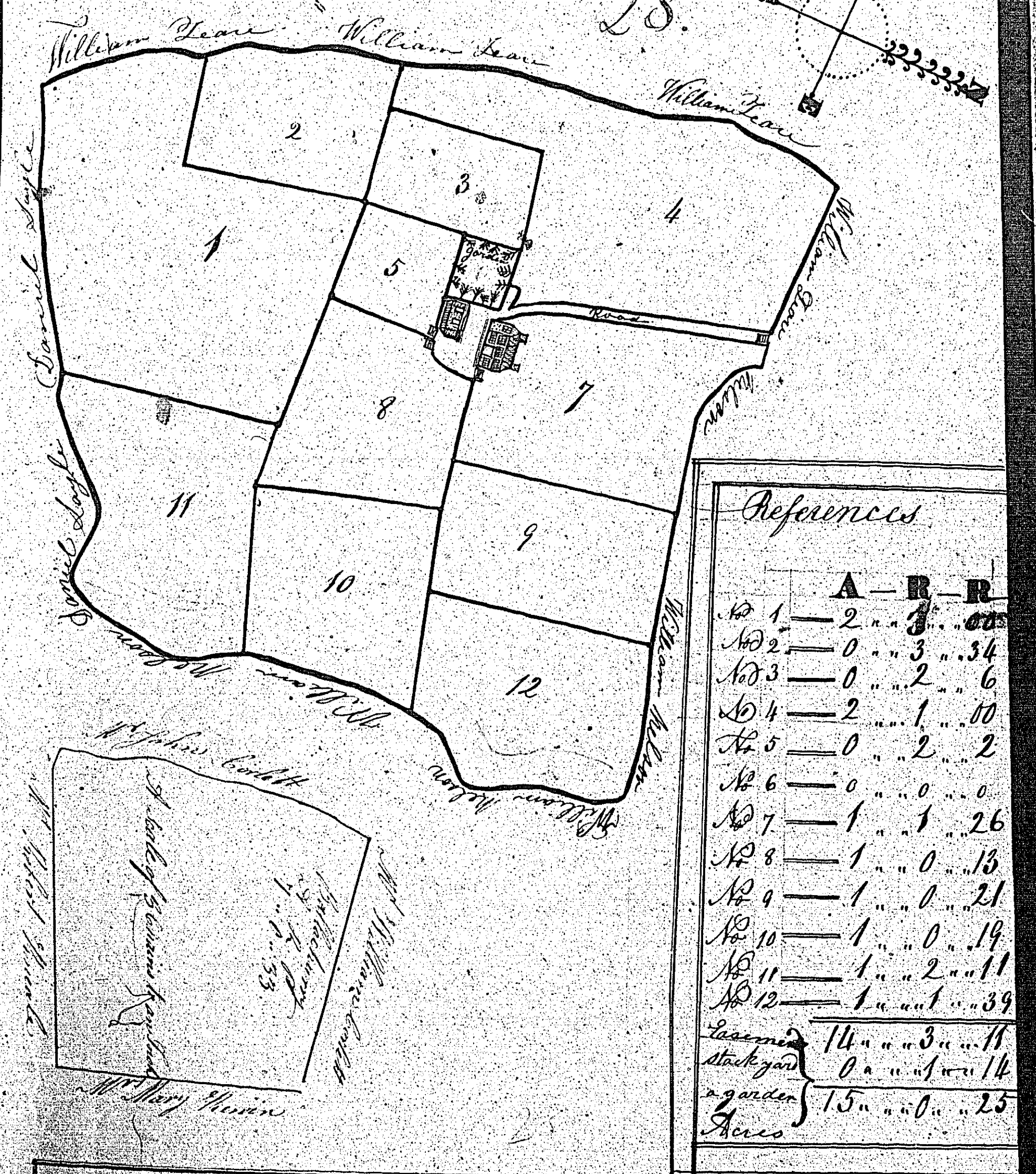

*A Plan and Survey being part of the
 Swartland but all black. The
 houses is called Plan and another
 land of land being part of a Swartland
 called Ballacurry in the Parish of
 by the proprietor John Corhill.*

*Surveyed by
 Samuel Galy
 October 5-1840*

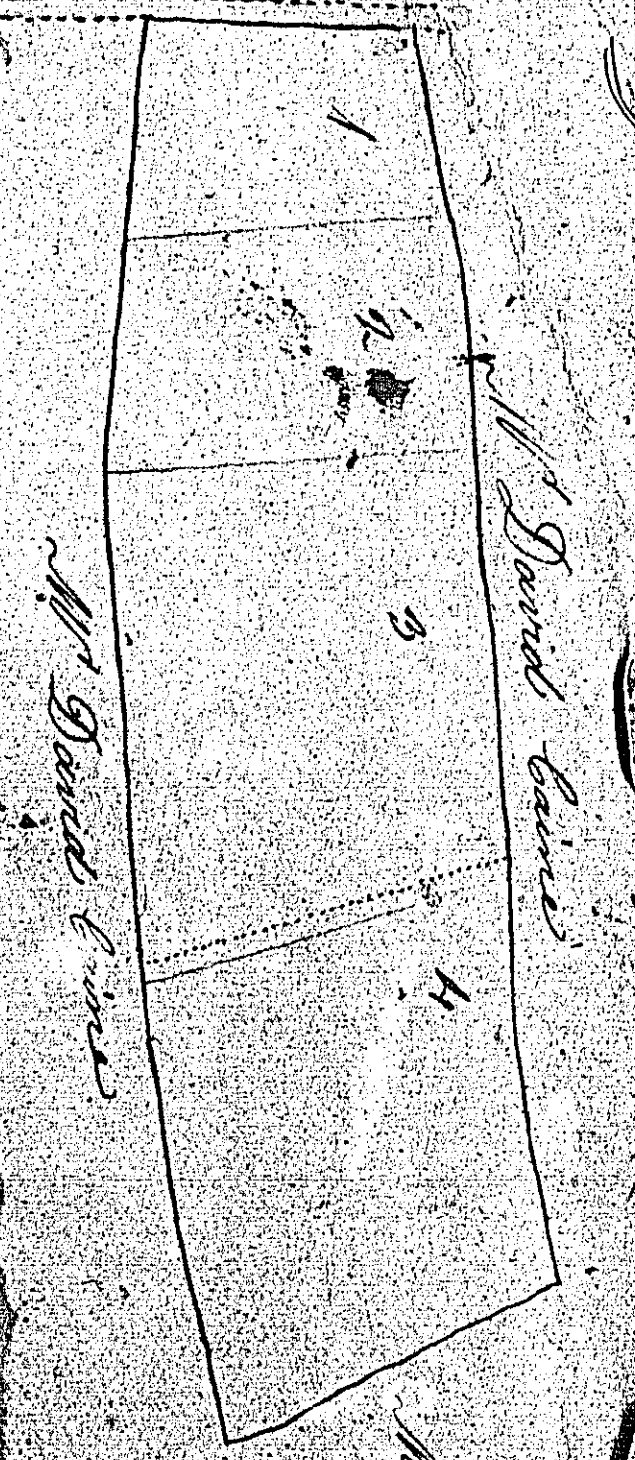

29.
 A Plan and survey of a
 parcel of Sinter in the parish
 of Jersey the property of
 Thomas Corlett
 taken May 20th 1840
 by Alfred Merrish
 Civil Engineer to the Survey

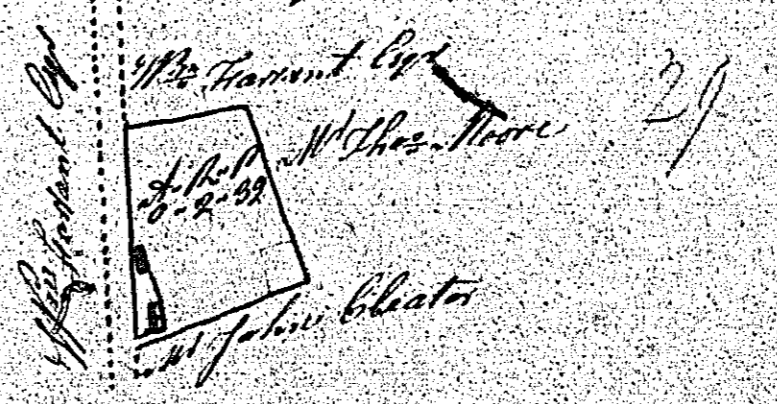

A scale of 5 chains to an Inch

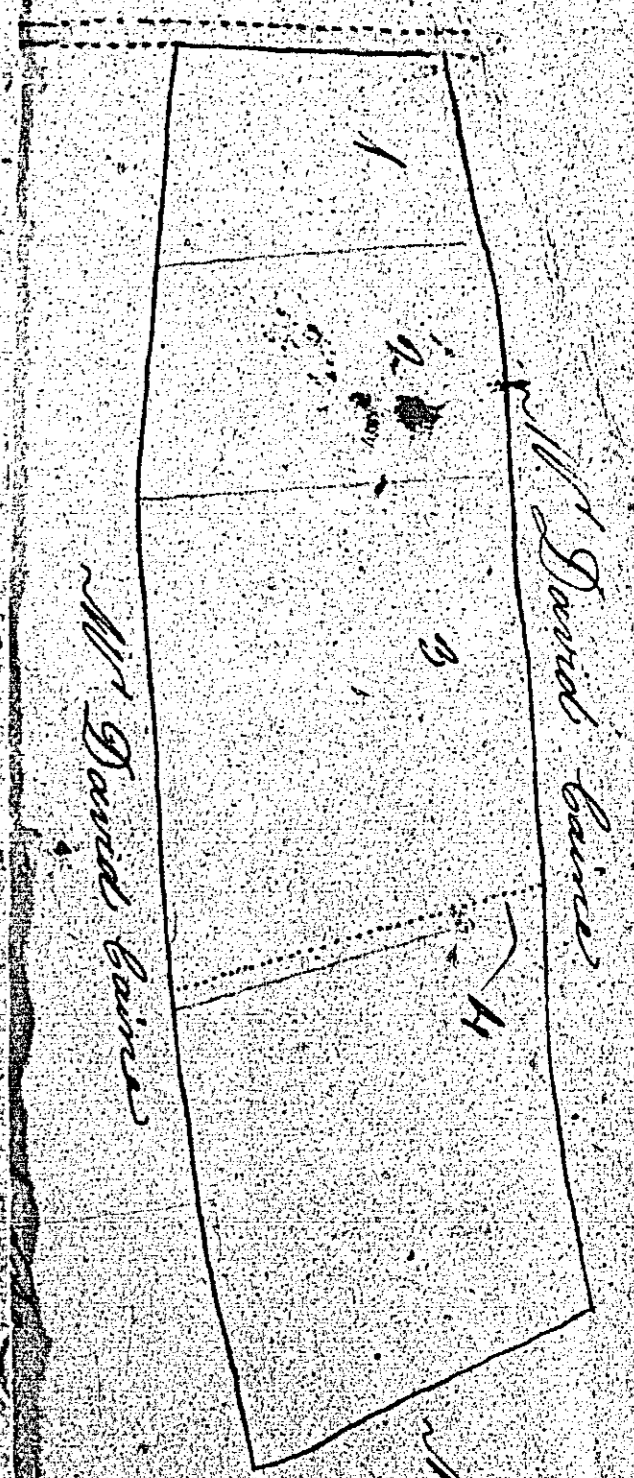

Mr David Corlett

Mr David Corlett

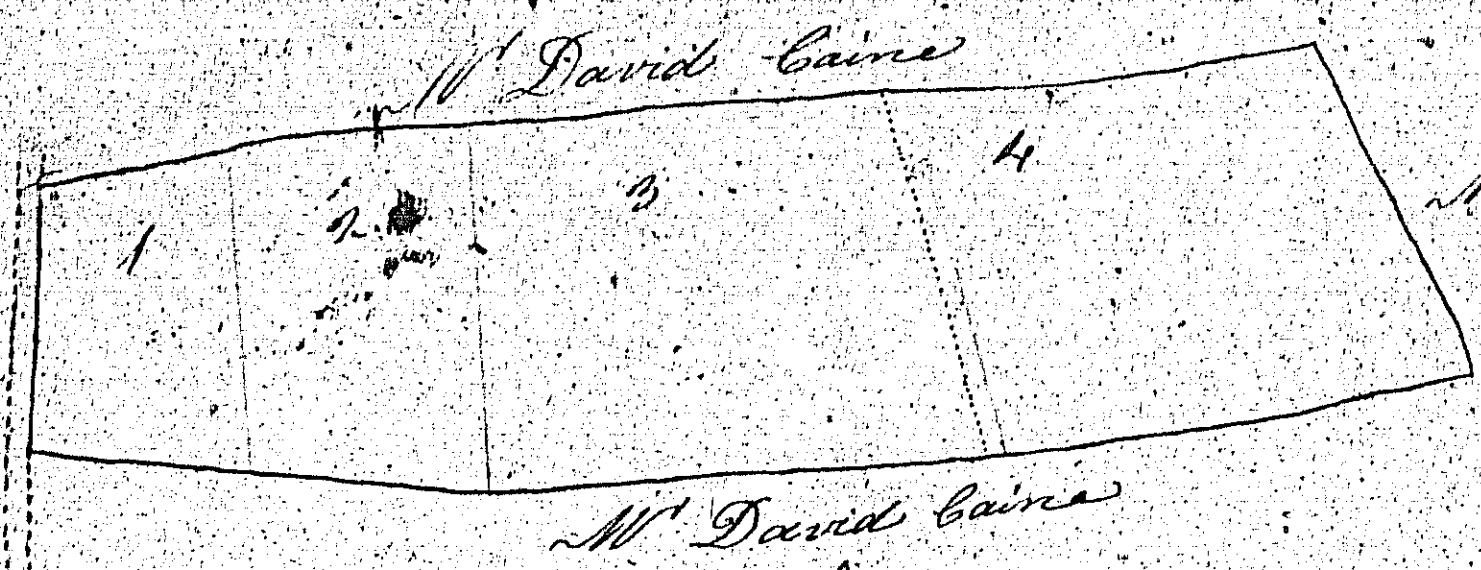

M^r David Cairns
 M^r David Cairns

A Plan and survey of a parcel of Patches called the *Three Bars* situated in the parishes of *Sturby and Ballough* the property of *Richard Corlett* taken April the 20th 1840 by *Abner Herrick*

30.

Contents

No.	A.	R.	P.
1	1	1	22
2	1	3	24
3	1	0	6
4	3	2	24
5	5	2	17
6	1	0	34
7	1	0	4
8	0	2	13
9	1	0	21
10	0	1	23
11	0	0	27
12	0	0	38
13	0	3	13
14	1	1	20
15	1	3	3
Road & Enclosure	2		6
16	1	1	2
17	1	3	16
Total	30	6	6

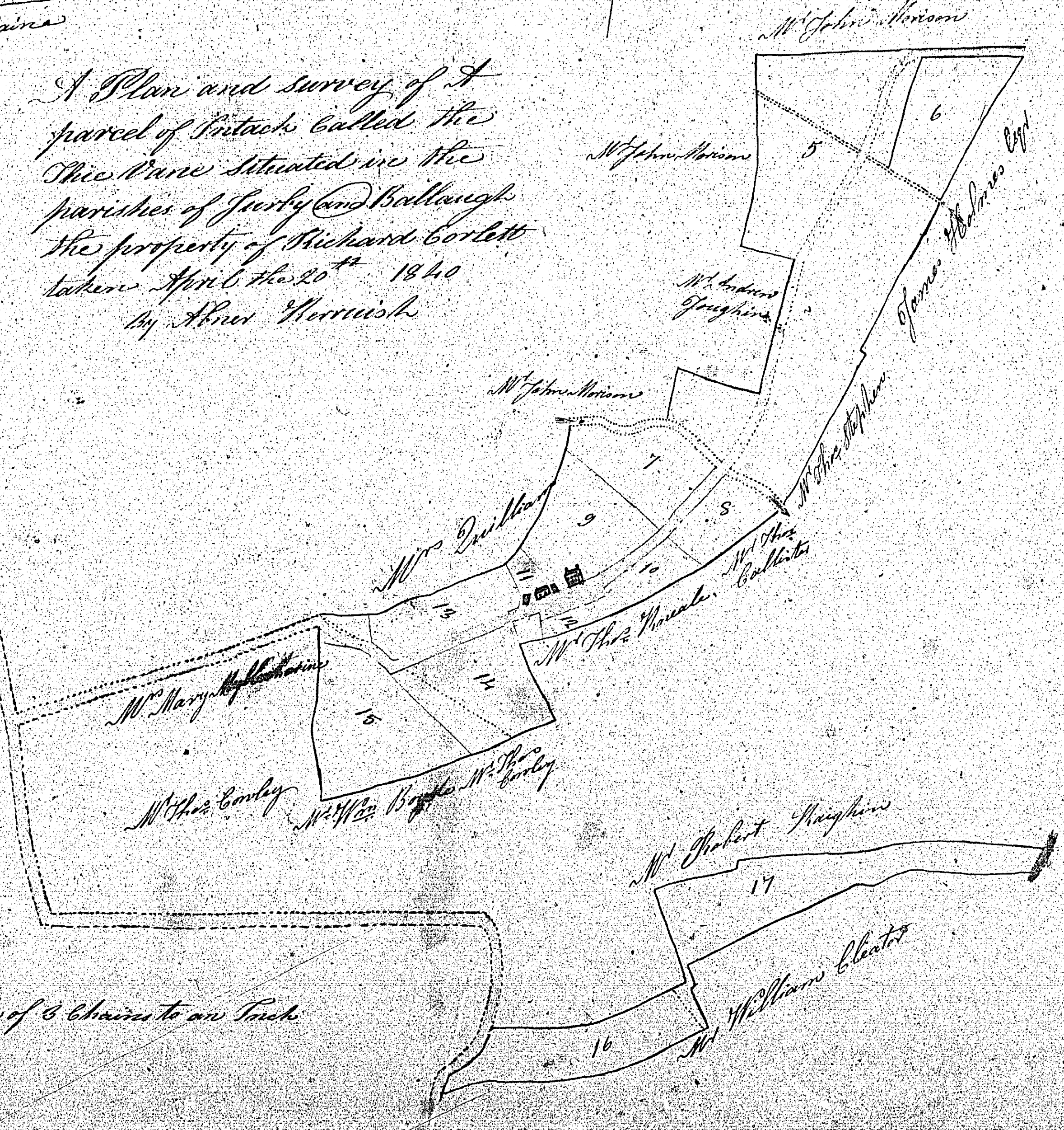

A scale of 8 chains to an Inch

M^r John Harrison

M^r John Harrison

M^r Andrew Goughers

M^r John Harrison

M^r David Cairns

M^r Mary Goughers

M^r John Corlett

M^r John Corlett

M^r Robert Goughers

M^r William Corlett

James Harrison Esq

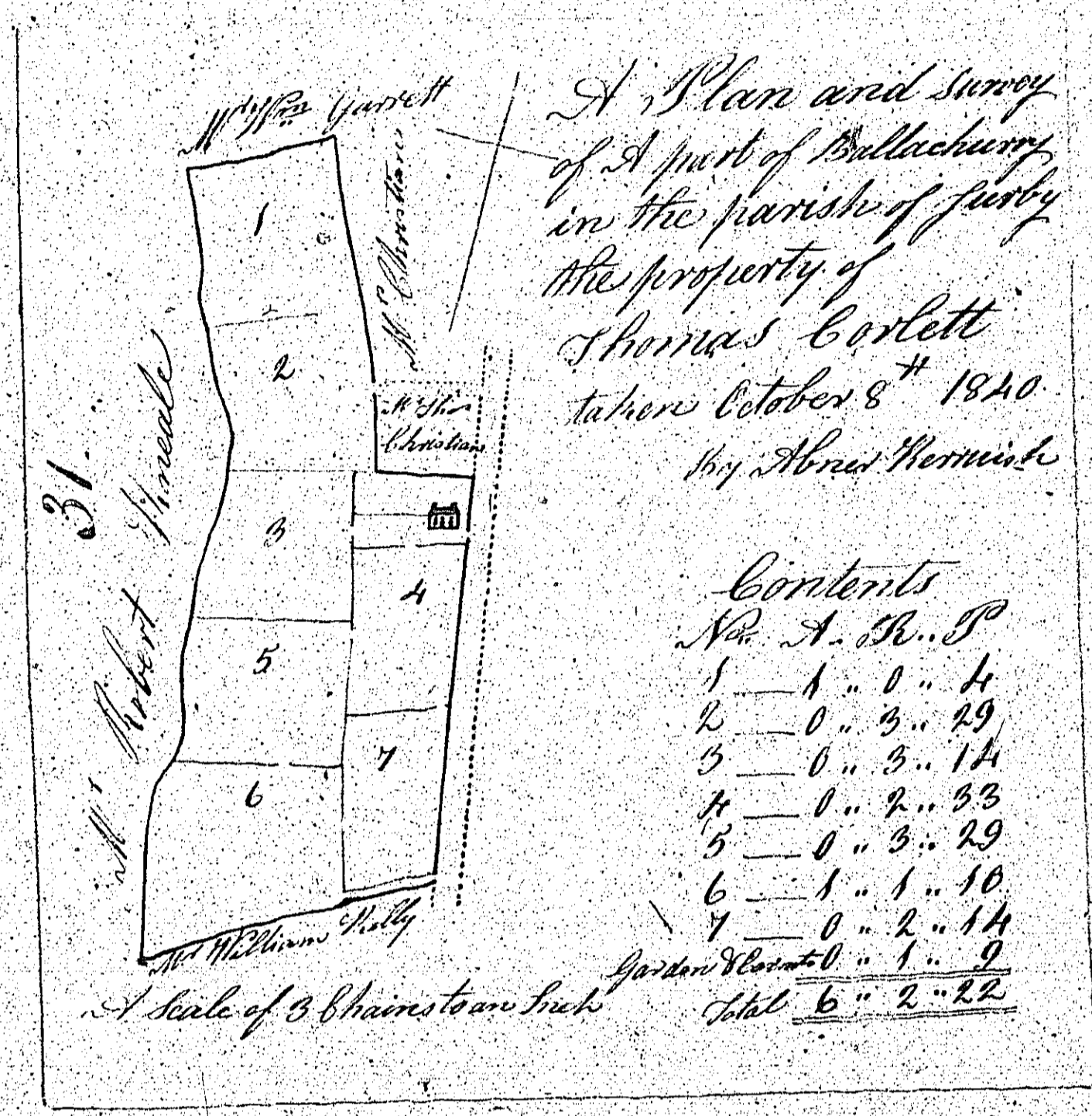

Not used

Not used

A Plan and Survey of A part
of the Quarterlands of Bullagarragh
of Bullacherry and of Bullurrim
and parcels of tithes called close
chippyle and the galene the
property of Thomas Corlett
situated in the parish of Jurby
and Lonagor on the 16th May 1840
By John Herwick

Contents

N ^o .	A.	R.	P.
1	1	2	39
2	2	3	36
3	2	1	2
4	2	3	24
5	4	3	52
6	6	3	12
7	7	2	10
8	4	2	55
9	3	2	57
10	5	1	7
11	3	3	34
12	3	0	33
13	7	0	15
14	0	1	58
15	0	1	4
16	0	2	29
17	1	1	20
18	1	3	12
19	2	3	20
20	2	0	14
Enclosure 2	0	2	5
Gardens 1	0	5	5
21	1	2	35
22	2	0	18
23	2	0	27
24	3	1	34
25	1	3	30
Total 80	0	11	

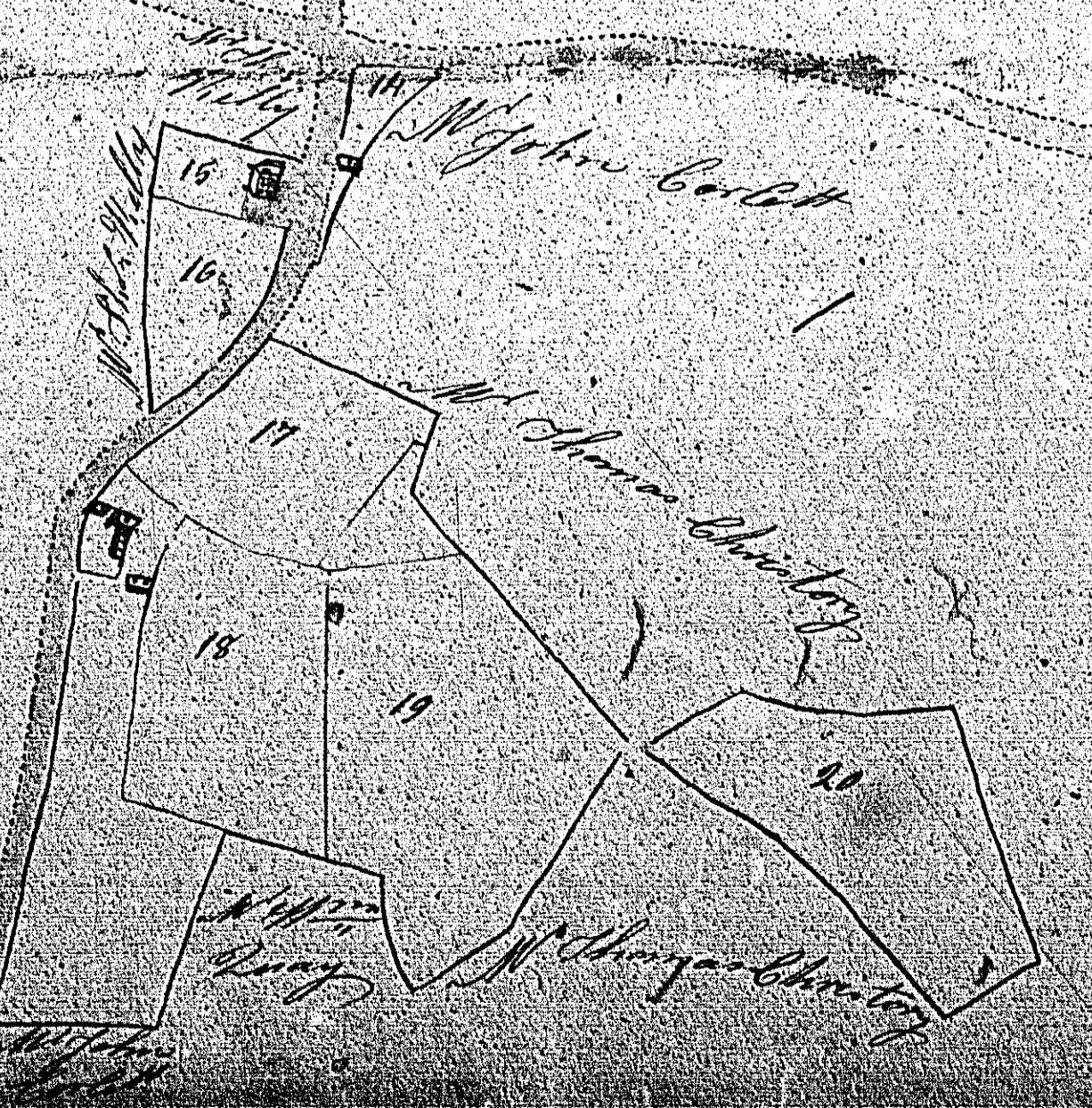
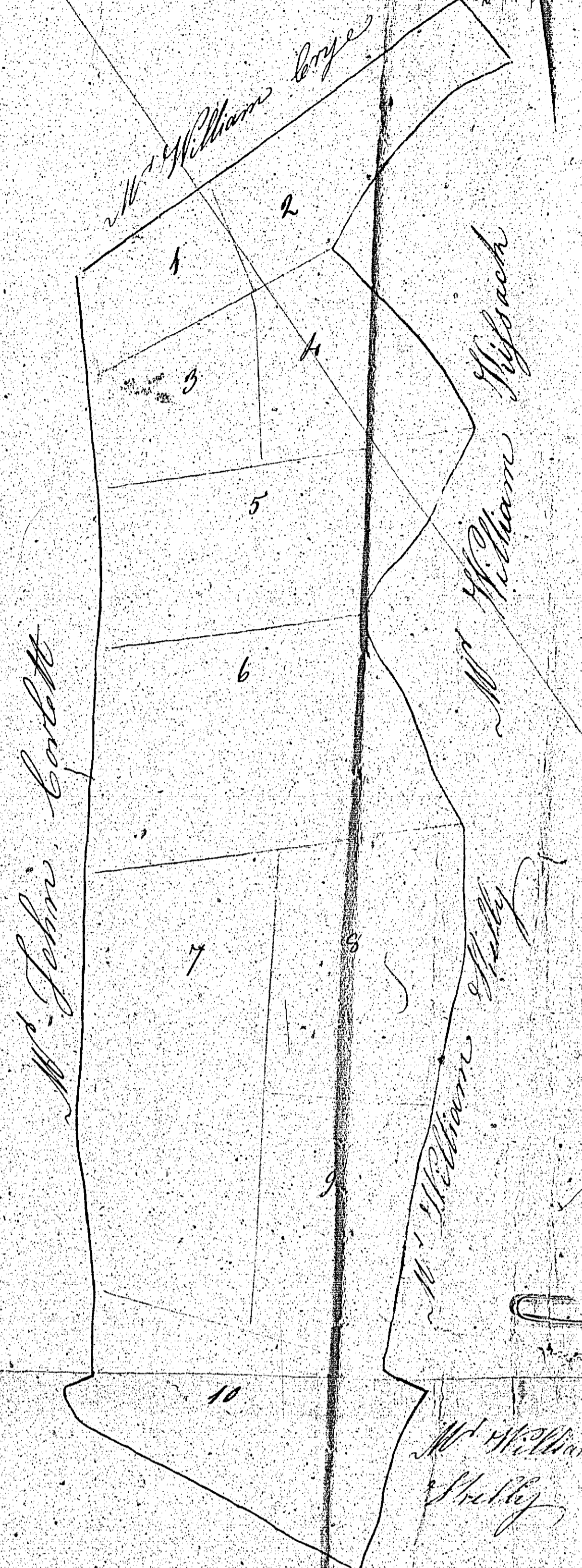
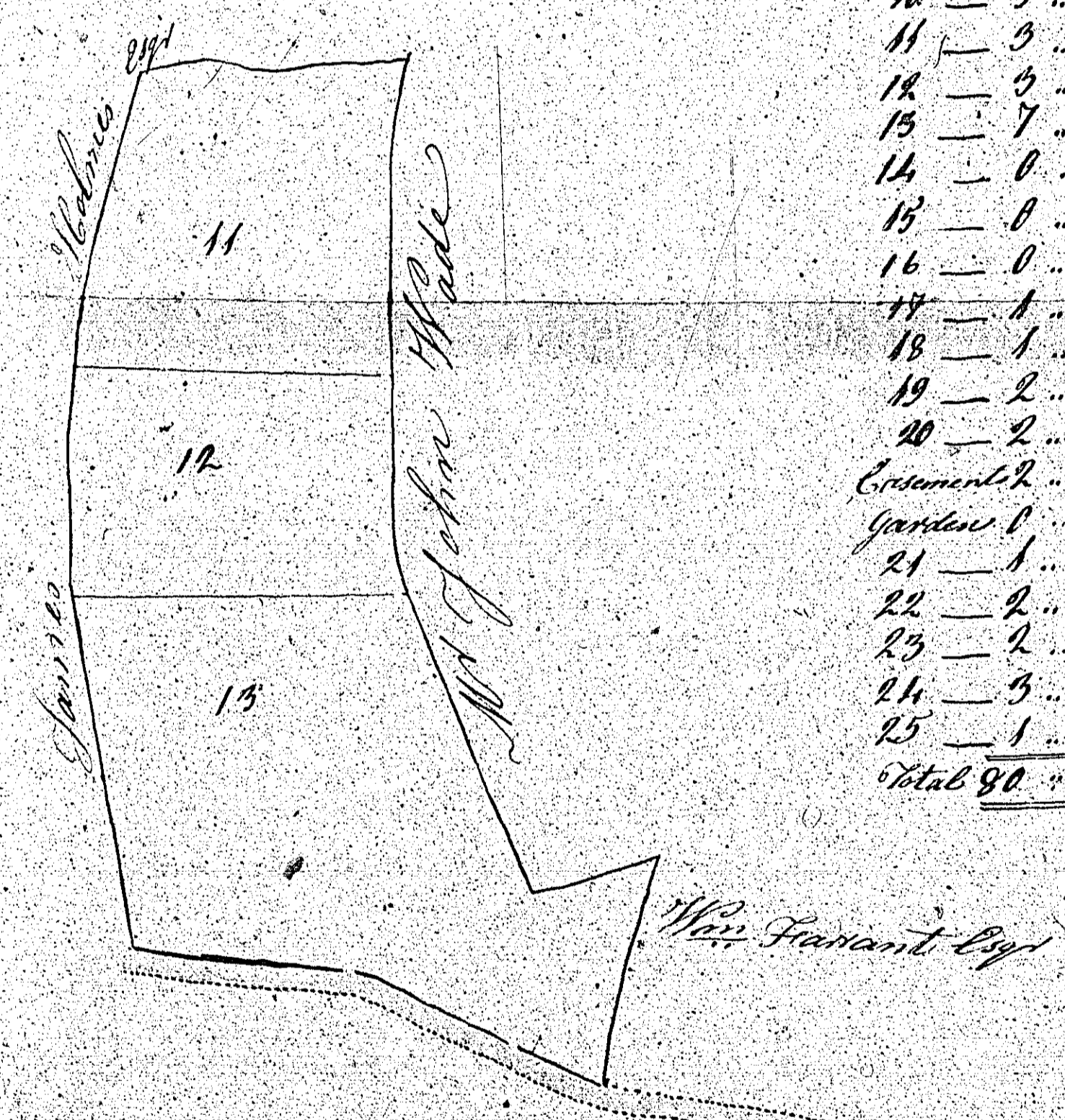

frame 1 of 2

ISLE OF MAN GOVERNMENT: GENERAL REGISTRY
TITHE PLANS: PARISH OF JURBY

Original coloured.

1:30

A/1

A/2

A/3

A/4

A/5

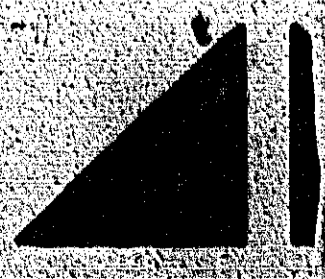

A Plan and Survey of a part
of the parishes of Ballyvaughan
of Ballyvaughan and of Ballyvaughan
and parishes of Tithes called Clav
chynnye and the yelene the
property of Thomas Corlett
Situated in the parish of Jurby
and Scaup: taken Aug 16th 1820
By James Warrick

Contents

No.	A.	R.	P.
1	1	2	30
2	2	3	36
3	2	1	2
4	2	3	24
5	4	3	31
6	6	3	12
7	7	2	16
8	1	2	35
9	3	2	17
10	5	1	7
11	3	3	34
12	3	0	33
13	7	0	15
14	0	1	38
15	0	1	4
16	0	2	29
17	1	1	20
18	1	3	12
19	2	3	20
20	2	0	14
21	2	0	25
22	1	2	35
23	2	0	14
24	2	0	27
25	3	1	34
26	1	3	30
Total	80	0	11

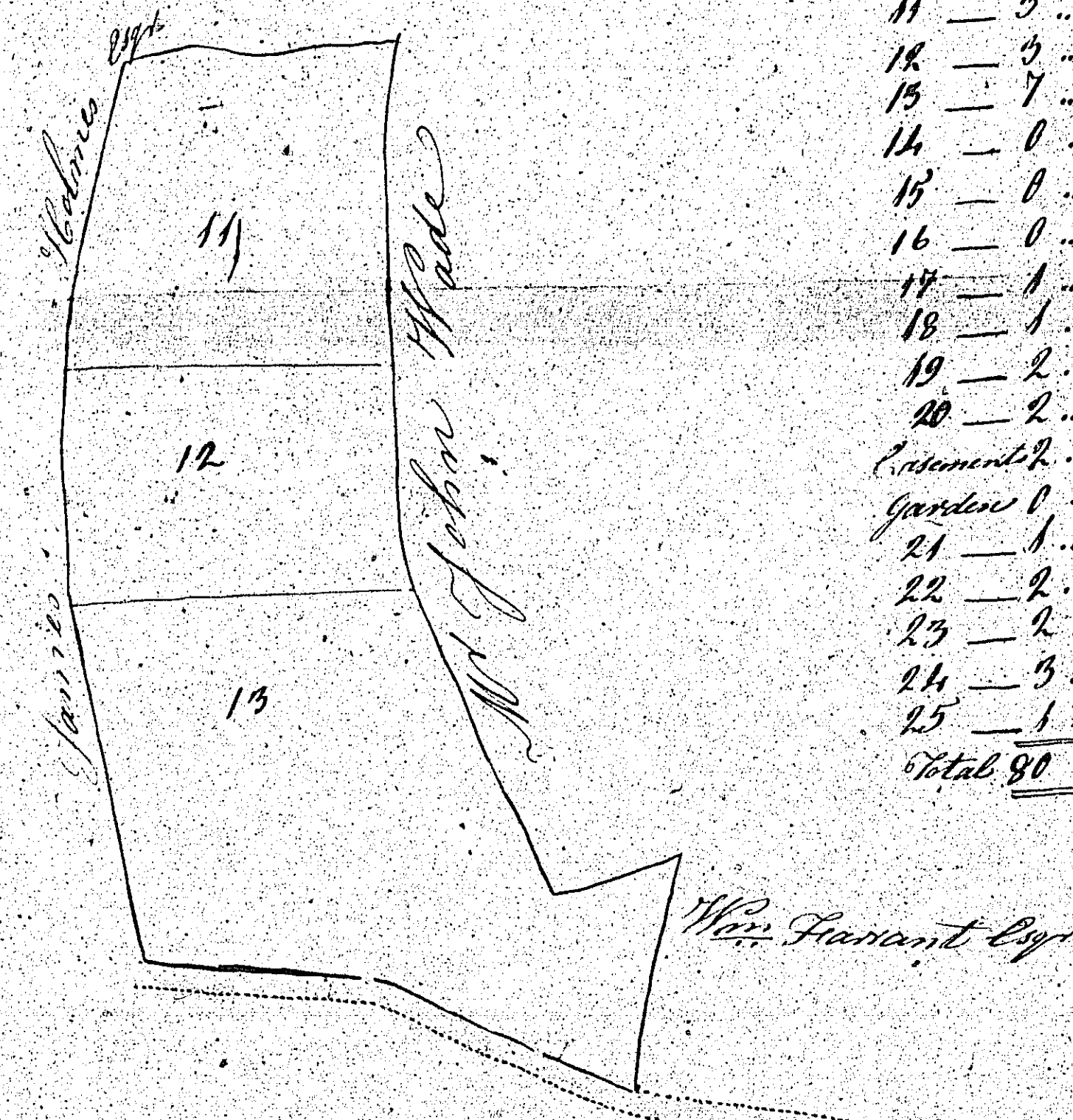

A scale of 3 chains to an Inch

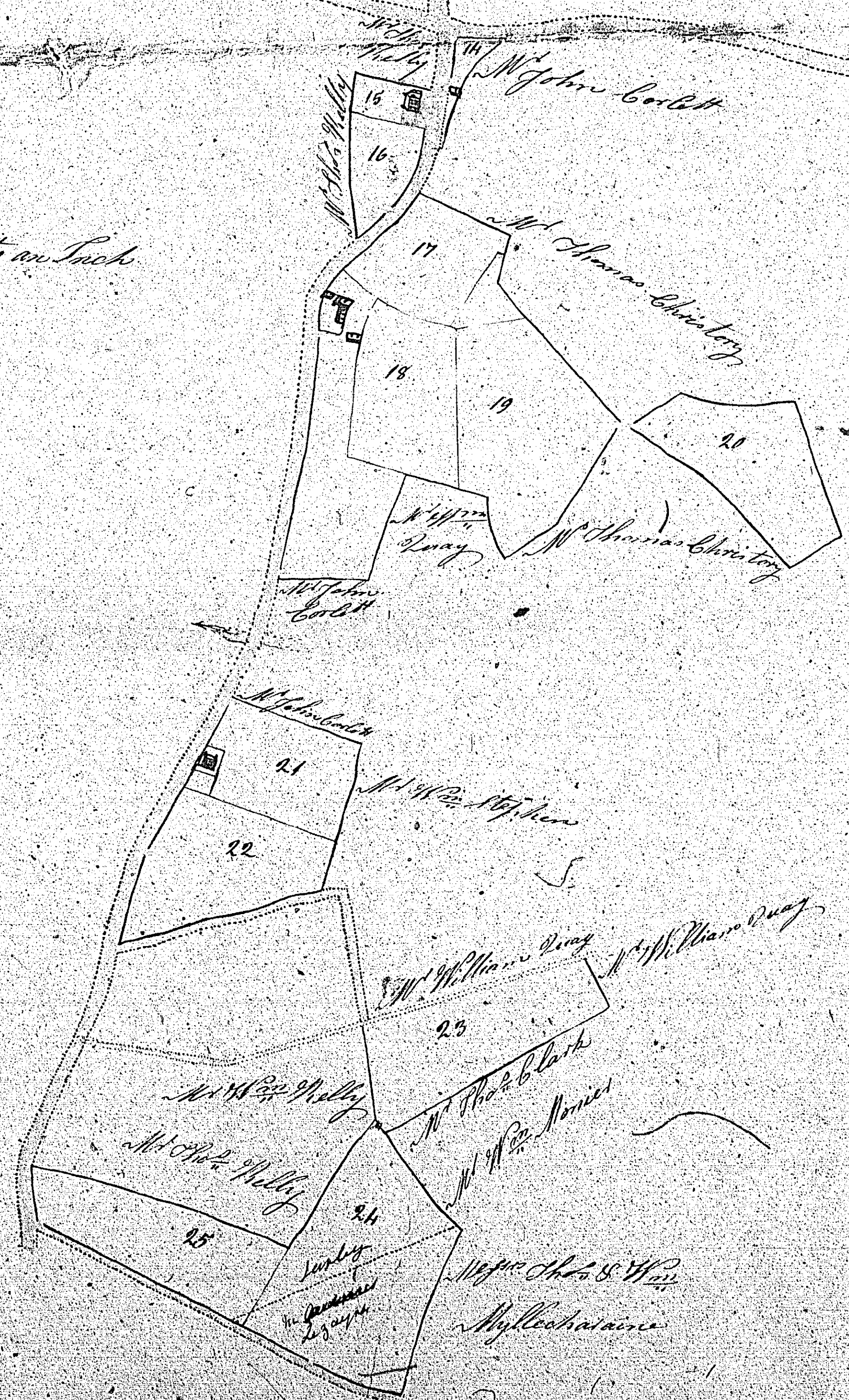

frame 2 of 2

ISLE OF MAN GOVERNMENT: GENERAL REGISTRY

TITHE PLANS: PARISH OF JURBY

Original coloured

1:30