

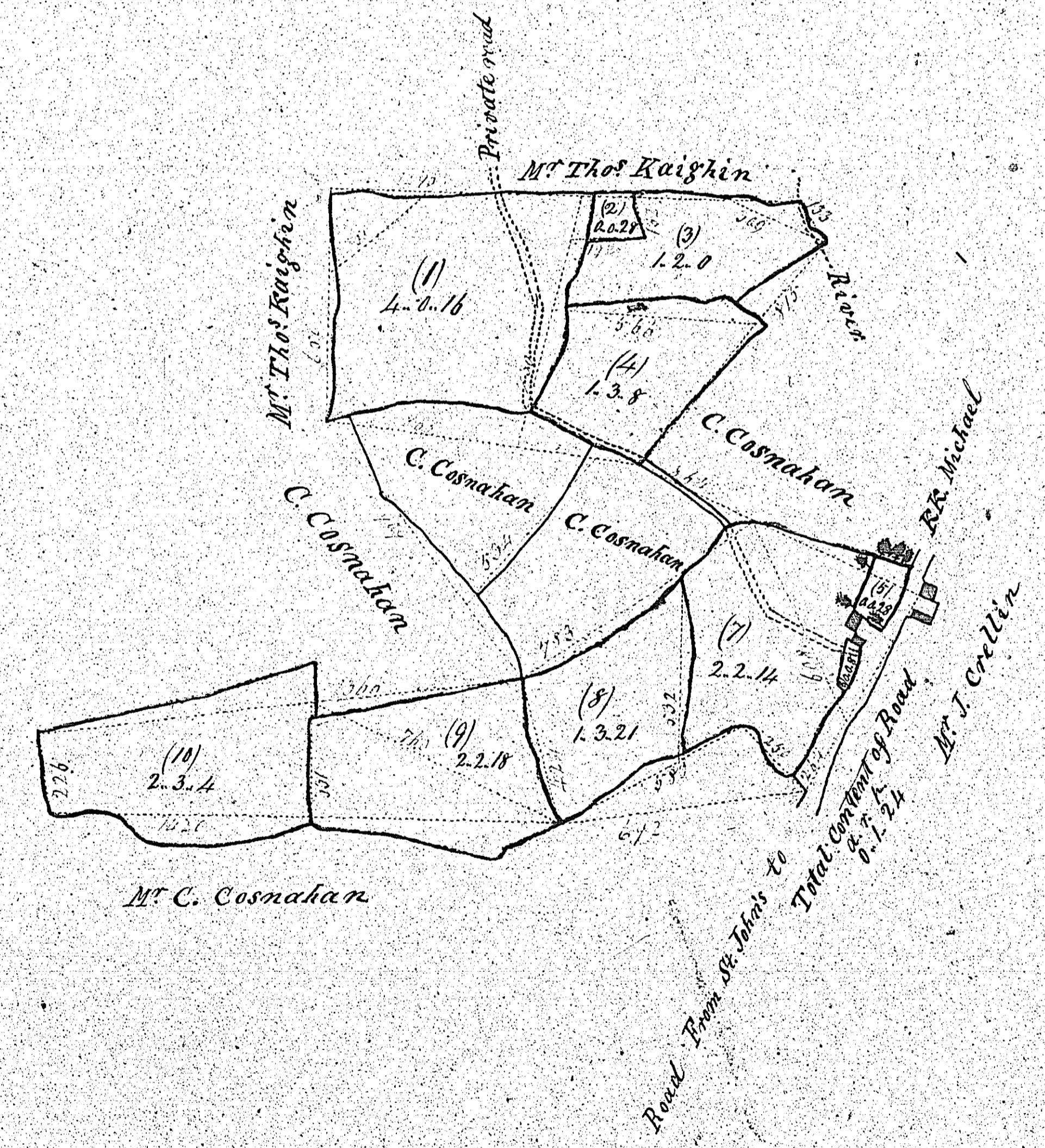

172

172

PLAN and SURVEY of PART of THE QUARTERLAND of BALLAKILMORREY KK. GERMAN the property of M^{rs} ANN LACE

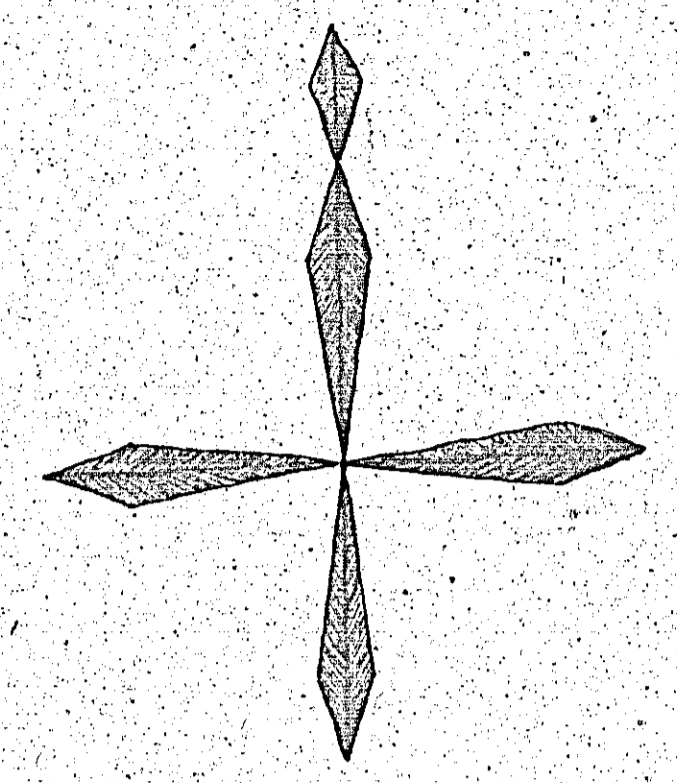

Collected			
Rs	a	r	p
1	4	0	16
2	0	0	28
3	1	2	0
4	1	3	8
5	0	0	28
6	0	0	8
7	2	2	14
8	1	3	21
9	2	2	18
10	2	3	4
Total 17 2 25			

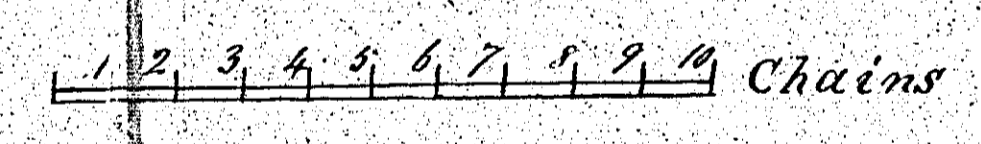

Surveyed August 1839 by William Saighin Saw A.K. German

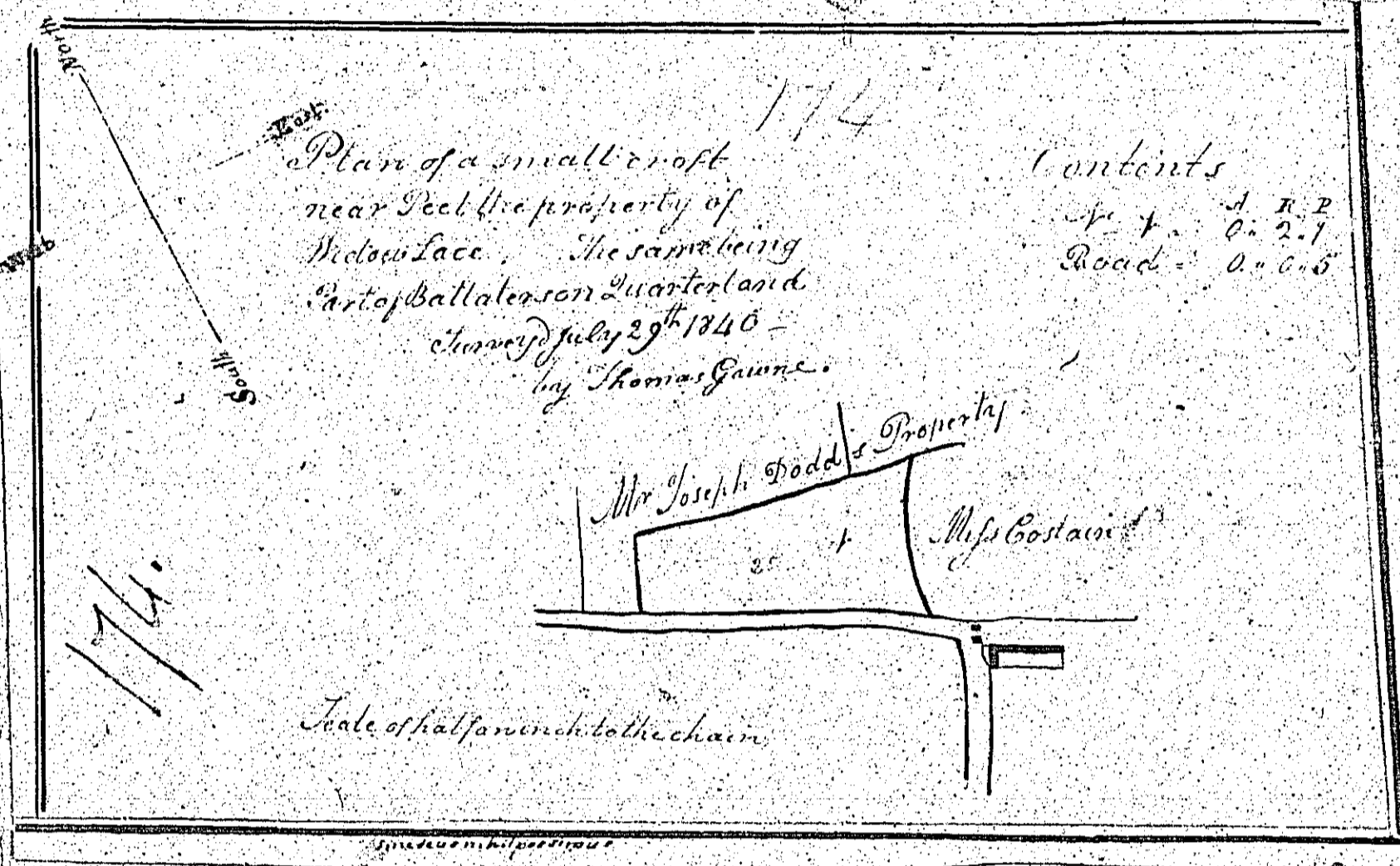
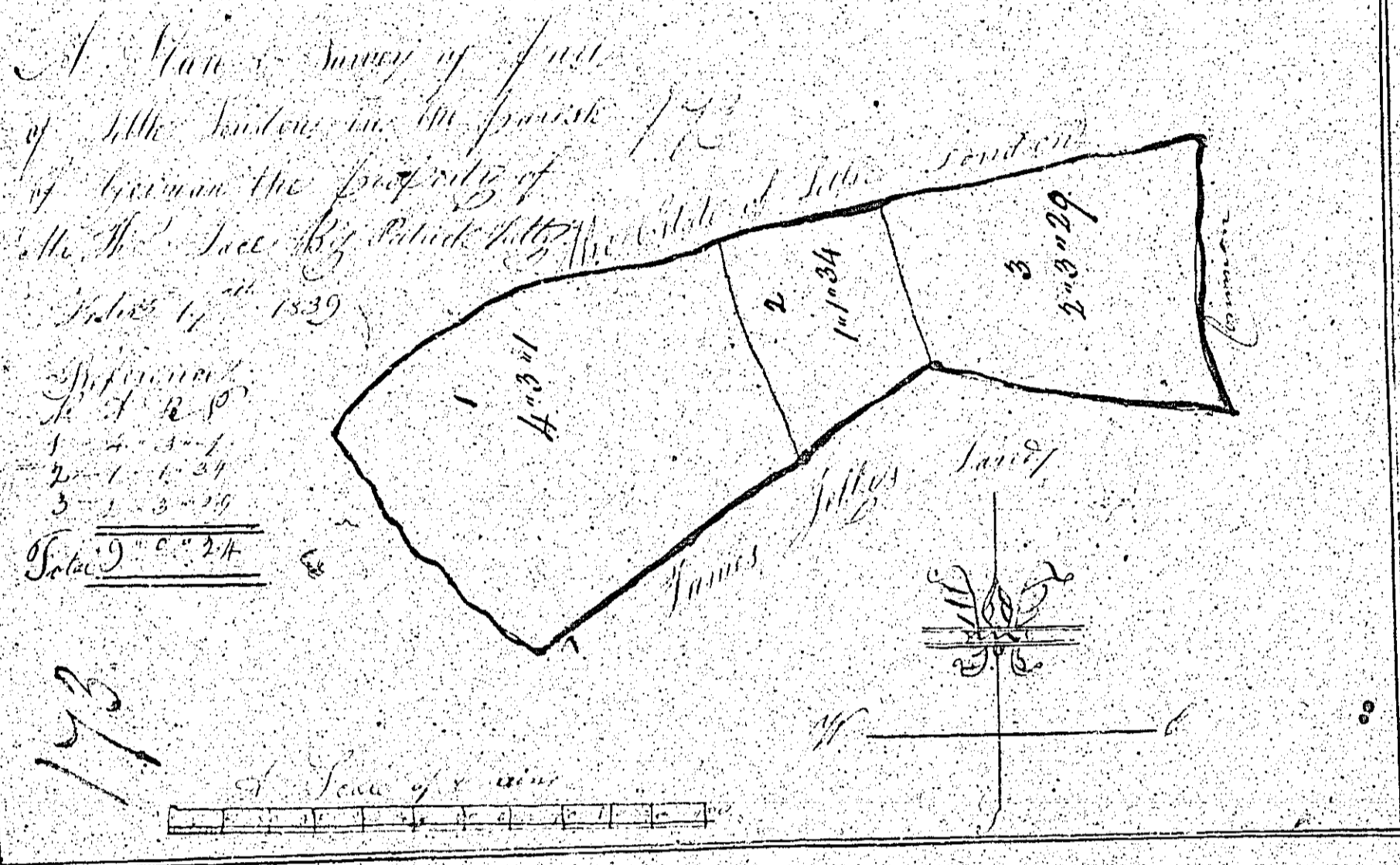

Contents

<i>Plot 1</i>	<i>4.3.4</i>
<i>Plot 2</i>	<i>1.1.34</i>
<i>Plot 3</i>	<i>2.3.29</i>

PLAN

Of part of the Quarterland of Harrograves
 In the parish of St. German
 The property of
 Mr. John Mylechreest.

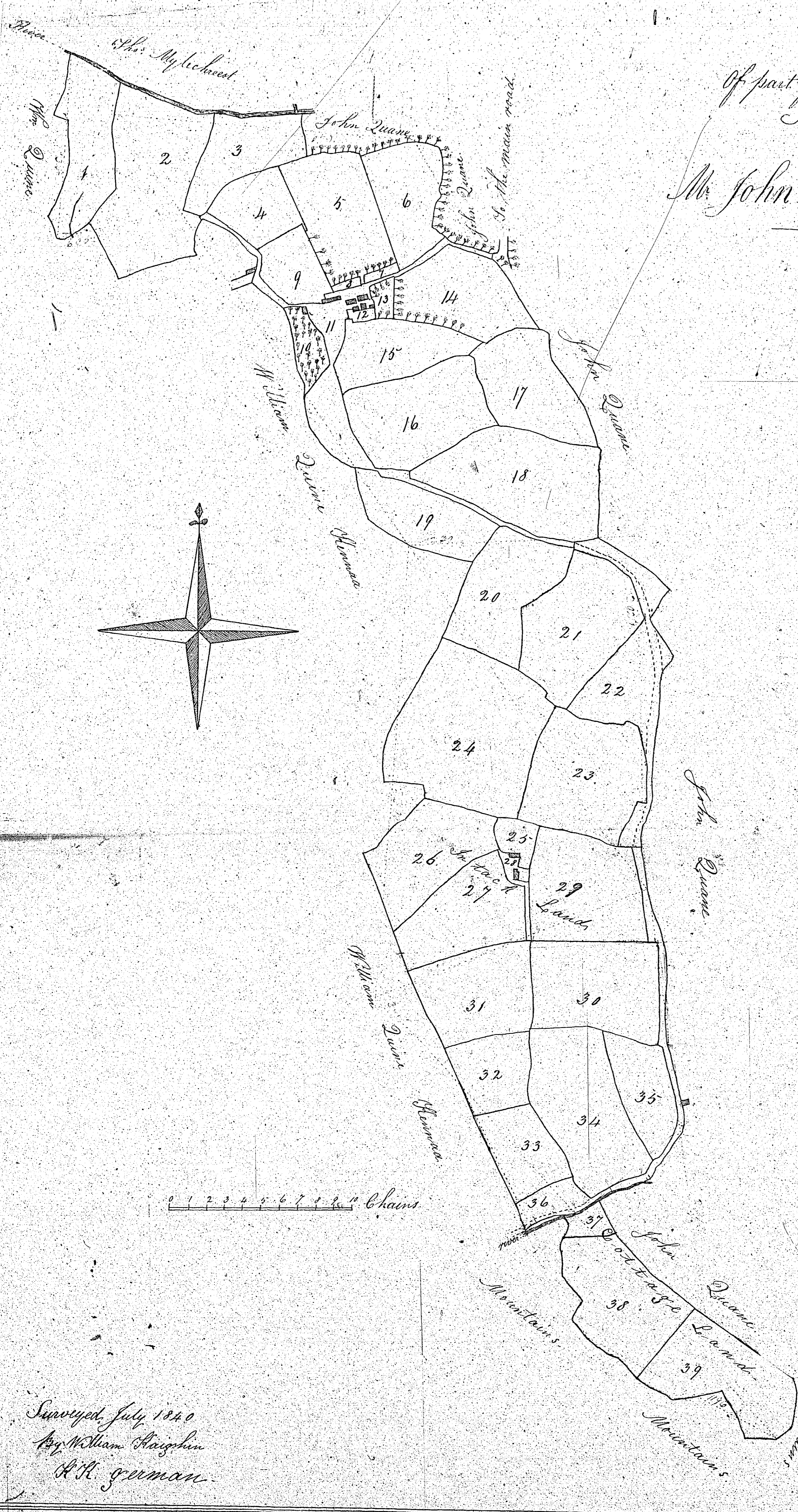

Reference.

No.	R.	h.	f.
1	2	2	17
2	4	1	38
3	1	3	32
4	1	1	27
5	2	3	33
6	2	0	9
7	0	0	13
8	0	0	10
9	1	0	24
10	0	2	21
11	2	2	19
12	0	0	14
13	0	1	0
14	2	2	38
15	2	0	16
16	3	1	31
17	2	3	4
18	4	1	16
19	2	1	1
20	3	0	6
21	3	2	15
22	3	0	24
23	4	0	4
24	6	0	34
25	0	2	11
26	3	1	2
27	2	3	16
28	0	1	10
29	3	2	37
30	3	2	32
31	3	0	19
32	1	2	32
33	1	3	5
34	4	0	26
35	1	2	38
36	1	2	19
37	0	1	14
38	3	1	20
39	3	1	1

Total Content - 93 2 8

0 1 2 3 4 5 6 7 8 9 10 Chains

Surveyed July 1840
 by William Haigh
 A. H. German

Plan of the Property of Mr. Mica McCullado
 in the vicinity of Tel. The same being
 Abba land and part of B. Quarterland

Content

No.	a.	b.	c.
1	0	2	30
2	0	1	16
3	0	0	17
Public road	0	0	26
Private	0	0	16
			<u>7</u>

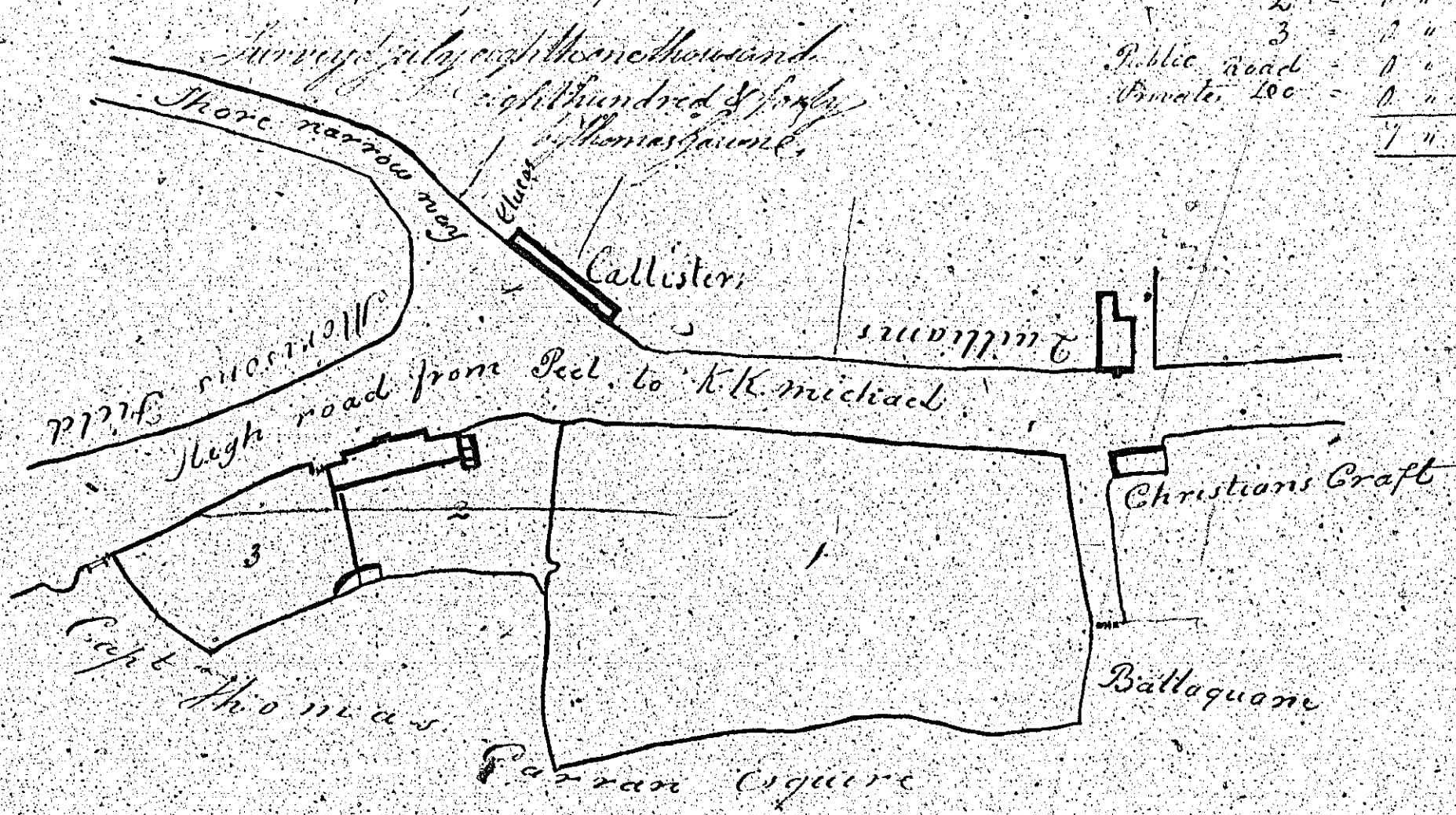

A scale of one inch to the chain

