

62  
PLAN

Of part of the Quarterland of Ballavaish  
In the parish of A.H. Gorman  
The property of  
Mr. William Cairn.

0 1 2 3 4 5 6 7 8 9 10 Chains.

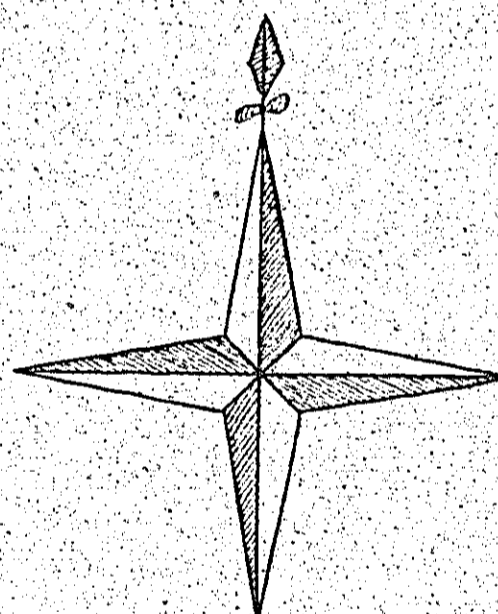
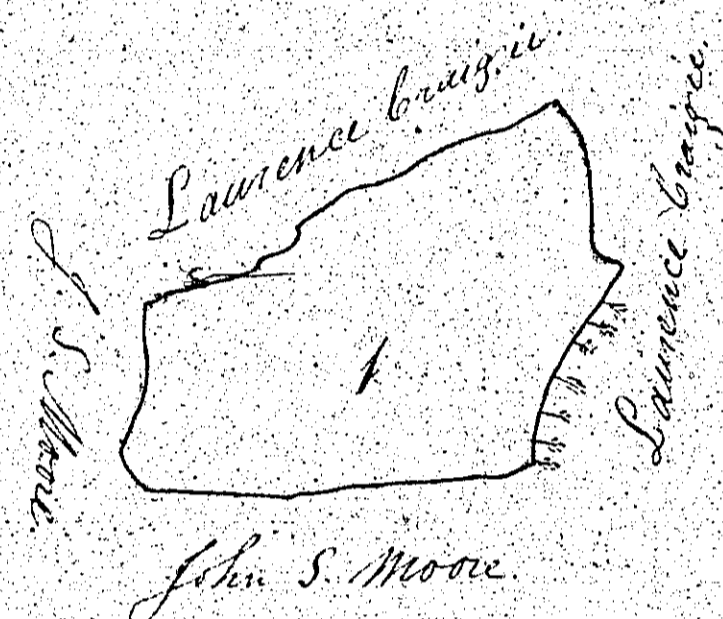

Reference.

No.	Ac.	r.	p.
1	2	3	35
2	3	2	6
3	3	0	15
4	2	1	31
5	1	2	6
6	0	2	20
7	2	2	32
Total Content			16 3 25

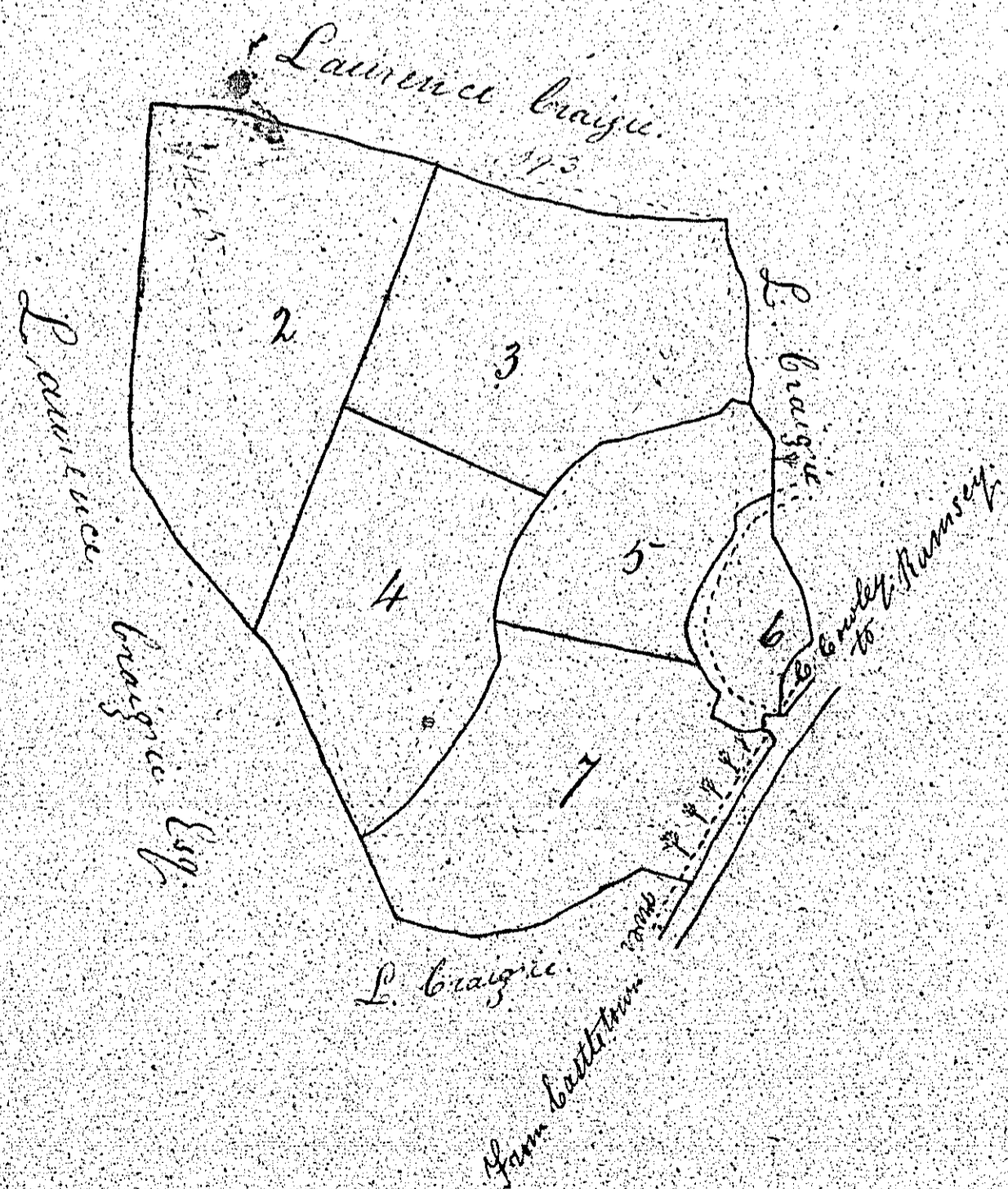

Surveyed July 1840  
by William Kingdon  
A.H. Gorman

63.

*S. Maracanih, in German*  
*The property of L. Freggie Esq. June 1840*

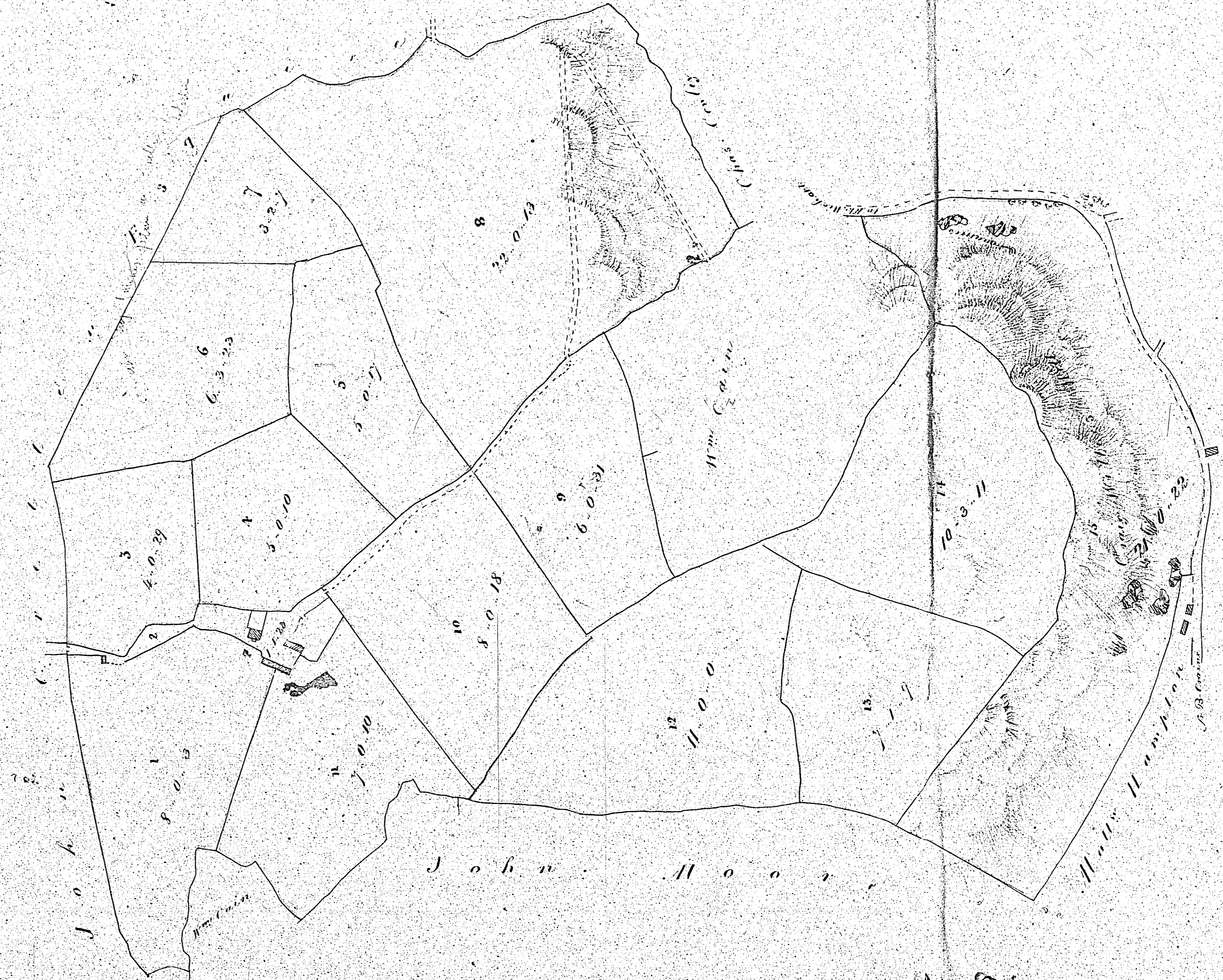

Total Cont.  $\frac{177.5}{100}$   
Acres of Hill.  $\frac{10.0}{100}$

*John Moore Esq.*  
*Surveyor*

64.

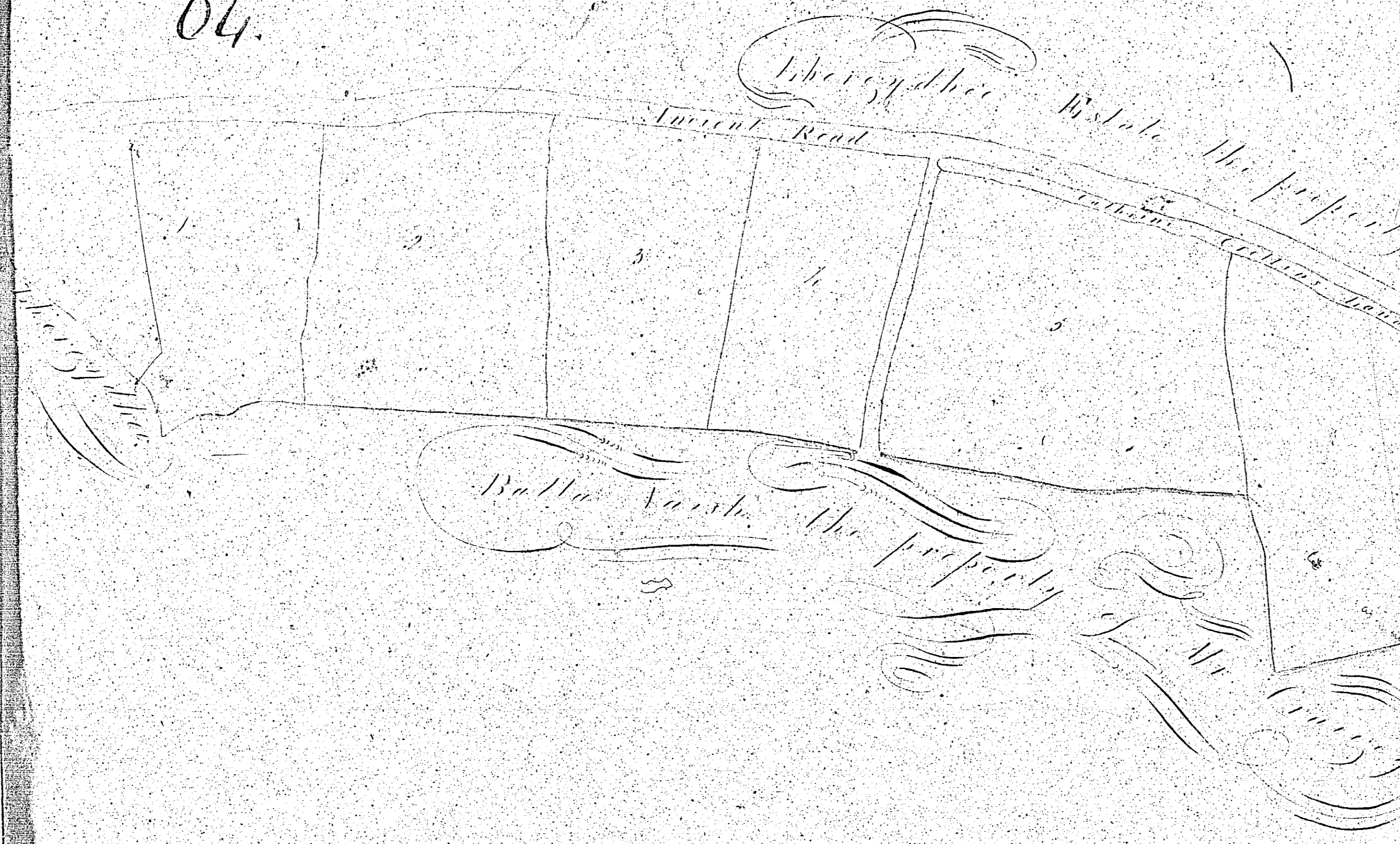

**Contents**

1	2	3	4	5	6	7	8	9	10	11	12	13	14	15	16	17	18	19	20	21	22	23	24	25	26	27	28	29	30	31	32	33	34	35	36	37	38	39	40	41	42	43	44	45	46	47	48	49	50	51	52	53	54	55	56	57	58	59	60	61	62	63	64	65	66	67	68	69	70	71	72	73	74	75	76	77	78	79	80	81	82	83	84	85	86	87	88	89	90	91	92	93	94	95	96	97	98	99	100
---	---	---	---	---	---	---	---	---	----	----	----	----	----	----	----	----	----	----	----	----	----	----	----	----	----	----	----	----	----	----	----	----	----	----	----	----	----	----	----	----	----	----	----	----	----	----	----	----	----	----	----	----	----	----	----	----	----	----	----	----	----	----	----	----	----	----	----	----	----	----	----	----	----	----	----	----	----	----	----	----	----	----	----	----	----	----	----	----	----	----	----	----	----	----	----	----	----	----	-----

Garden 20  
Private roads 3  
Town Dills 3  
Total rent 61.3

Plan of  
the fourth part of  
QUARTER  
of  
Balla Varsh  
PARISH of GERMAN  
the property of  
Mr. J. Cullen  
By John ...

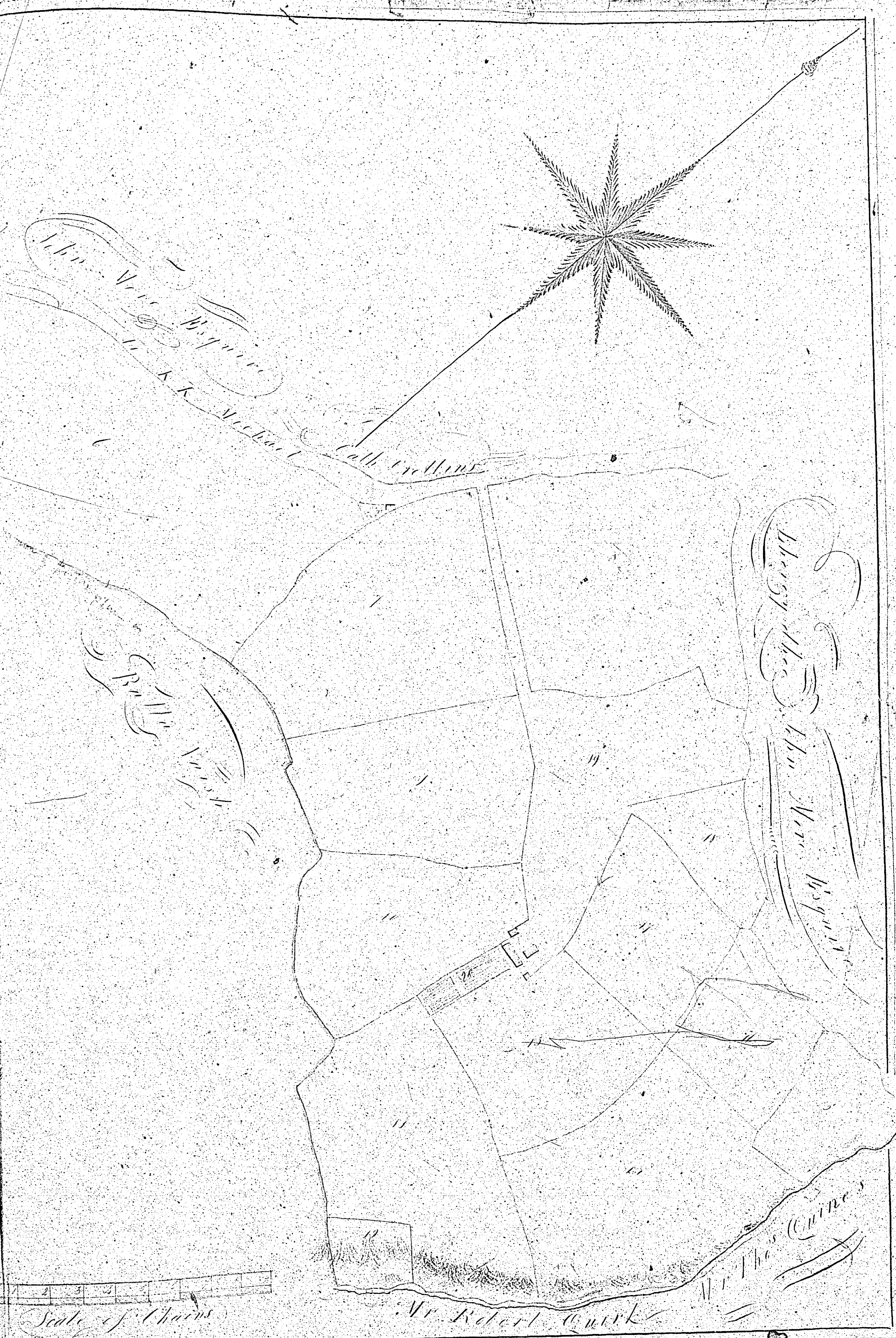
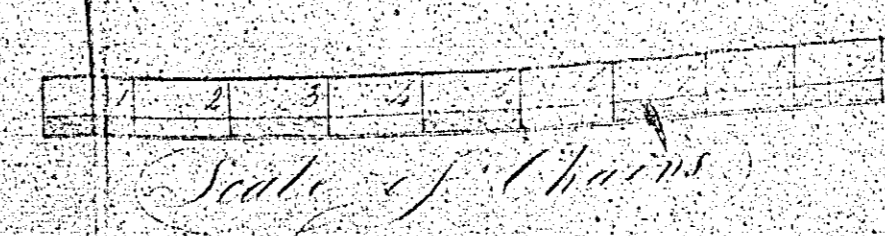

65.

— A —  
 PLAN and SURVEY of EARY-GLASS in the  
 Parish of GERMAN Belonging to  
 Mr. MATTHIAS COWLEY.

20<sup>th</sup> May 1830.

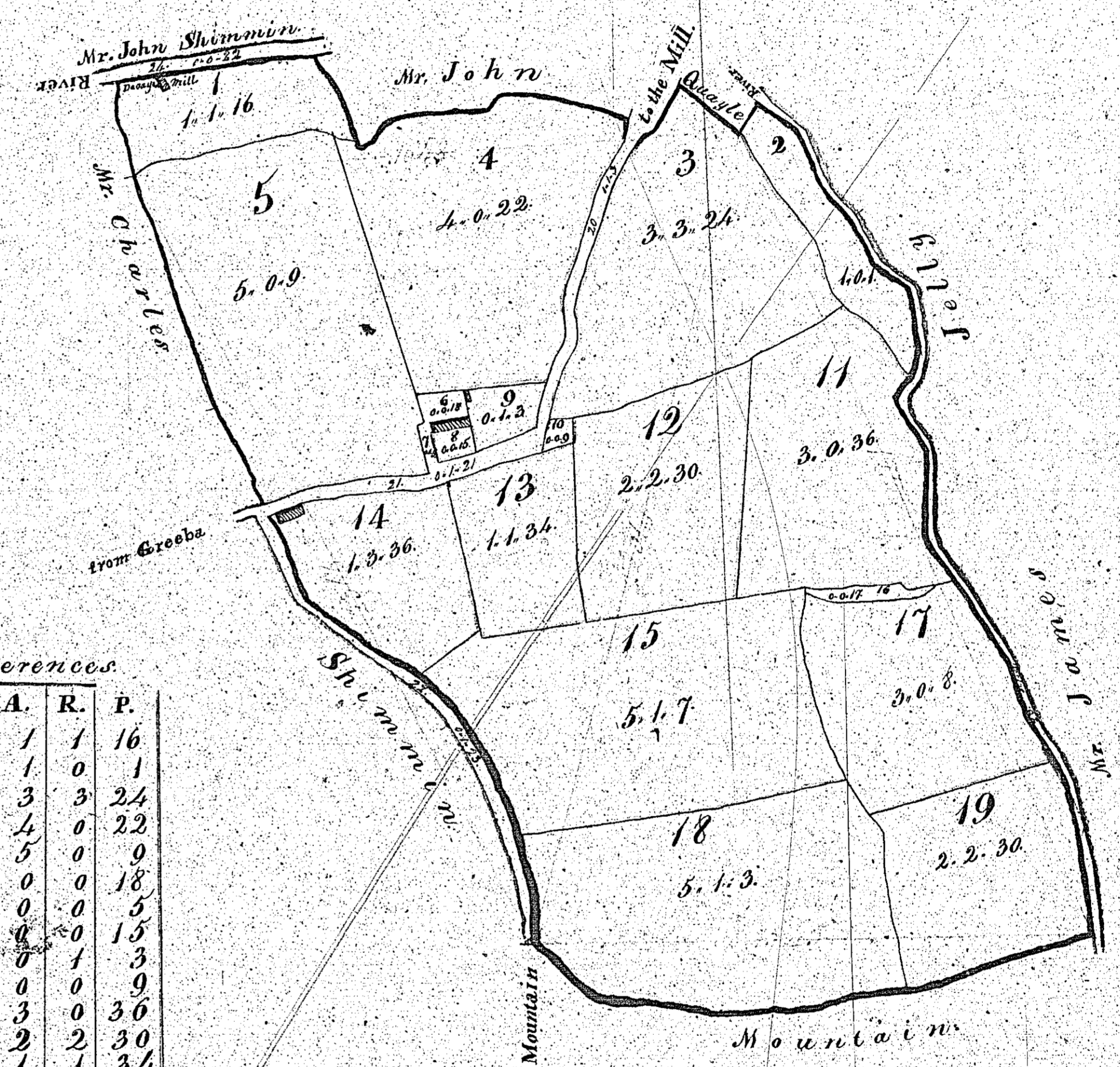
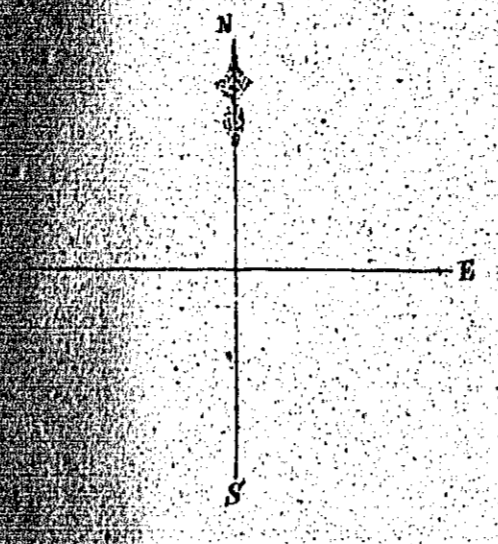

References

No	A.	R.	P.
1	1	1	16
2	1	0	1
3	3	3	24
4	4	0	22
5	5	0	9
6	0	0	18
7	0	0	5
8	0	0	15
9	0	1	3
10	0	0	9
11	3	0	36
12	2	2	30
13	1	1	34
14	1	3	36
15	5	1	7
16	0	0	17
17	3	0	8
18	5	1	3
19	2	2	30
Total PLAN	41	3	3

Road & Rivers.

No	A.	R.	P.
20	0	1	3
21	6	1	21
22	0	1	23
23	1	1	2
24	0	0	22
Total	7	4	31

By *Matthias Cowley*  
 Schoolmaster  
 Ballasalla.

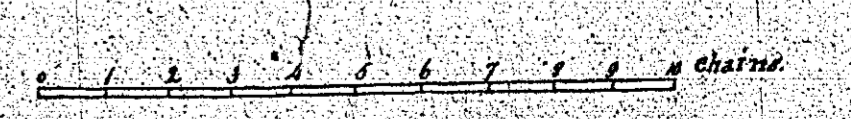

67.

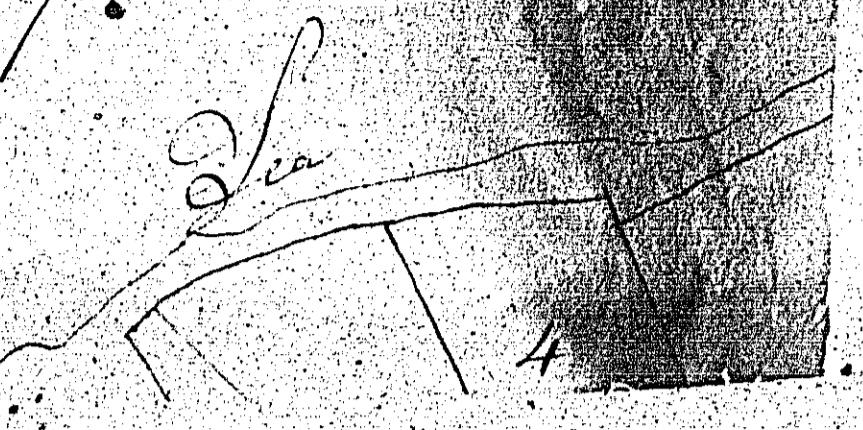

66

66.

PLAN

of BALLAGYRR  
late belonging to

J. J. WATTLEWORTH  
Surveyor of His Majesty's Ordnance, London.

REFERENCE

No.	Description	Quantity
1	Acres	3
2	"	2 1/2
3	"	2 1/2
4	"	2 1/2
5	"	2 1/2
6	"	2 1/2
7	"	2 1/2
8	"	2 1/2
9	"	2 1/2
10	"	2 1/2
11	"	2 1/2
12	"	2 1/2
13	"	2 1/2
14	"	2 1/2
15	"	2 1/2
16	"	2 1/2
17	"	2 1/2
18	"	2 1/2
19	"	2 1/2
20	"	2 1/2
21	"	2 1/2
22	"	2 1/2
23	"	2 1/2
24	"	2 1/2
25	"	2 1/2
26	"	2 1/2
27	"	2 1/2
28	"	2 1/2
29	"	2 1/2
30	"	2 1/2
31	"	2 1/2
32	"	2 1/2
33	"	2 1/2
34	"	2 1/2
35	"	2 1/2
36	"	2 1/2
37	"	2 1/2
38	"	2 1/2
39	"	2 1/2
40	"	2 1/2
41	"	2 1/2
42	"	2 1/2
43	"	2 1/2
44	"	2 1/2
45	"	2 1/2
46	"	2 1/2
47	"	2 1/2
48	"	2 1/2
49	"	2 1/2
50	"	2 1/2
51	"	2 1/2
52	"	2 1/2
53	"	2 1/2
54	"	2 1/2
55	"	2 1/2
56	"	2 1/2
57	"	2 1/2
58	"	2 1/2
59	"	2 1/2
60	"	2 1/2
61	"	2 1/2
62	"	2 1/2
63	"	2 1/2
64	"	2 1/2
65	"	2 1/2
66	"	2 1/2
67	"	2 1/2
68	"	2 1/2
69	"	2 1/2
70	"	2 1/2
71	"	2 1/2
72	"	2 1/2
73	"	2 1/2
74	"	2 1/2
75	"	2 1/2
76	"	2 1/2
77	"	2 1/2
78	"	2 1/2
79	"	2 1/2
80	"	2 1/2
81	"	2 1/2
82	"	2 1/2
83	"	2 1/2
84	"	2 1/2
85	"	2 1/2
86	"	2 1/2
87	"	2 1/2
88	"	2 1/2
89	"	2 1/2
90	"	2 1/2
91	"	2 1/2
92	"	2 1/2
93	"	2 1/2
94	"	2 1/2
95	"	2 1/2
96	"	2 1/2
97	"	2 1/2
98	"	2 1/2
99	"	2 1/2
100	"	2 1/2
Total		66 0 7

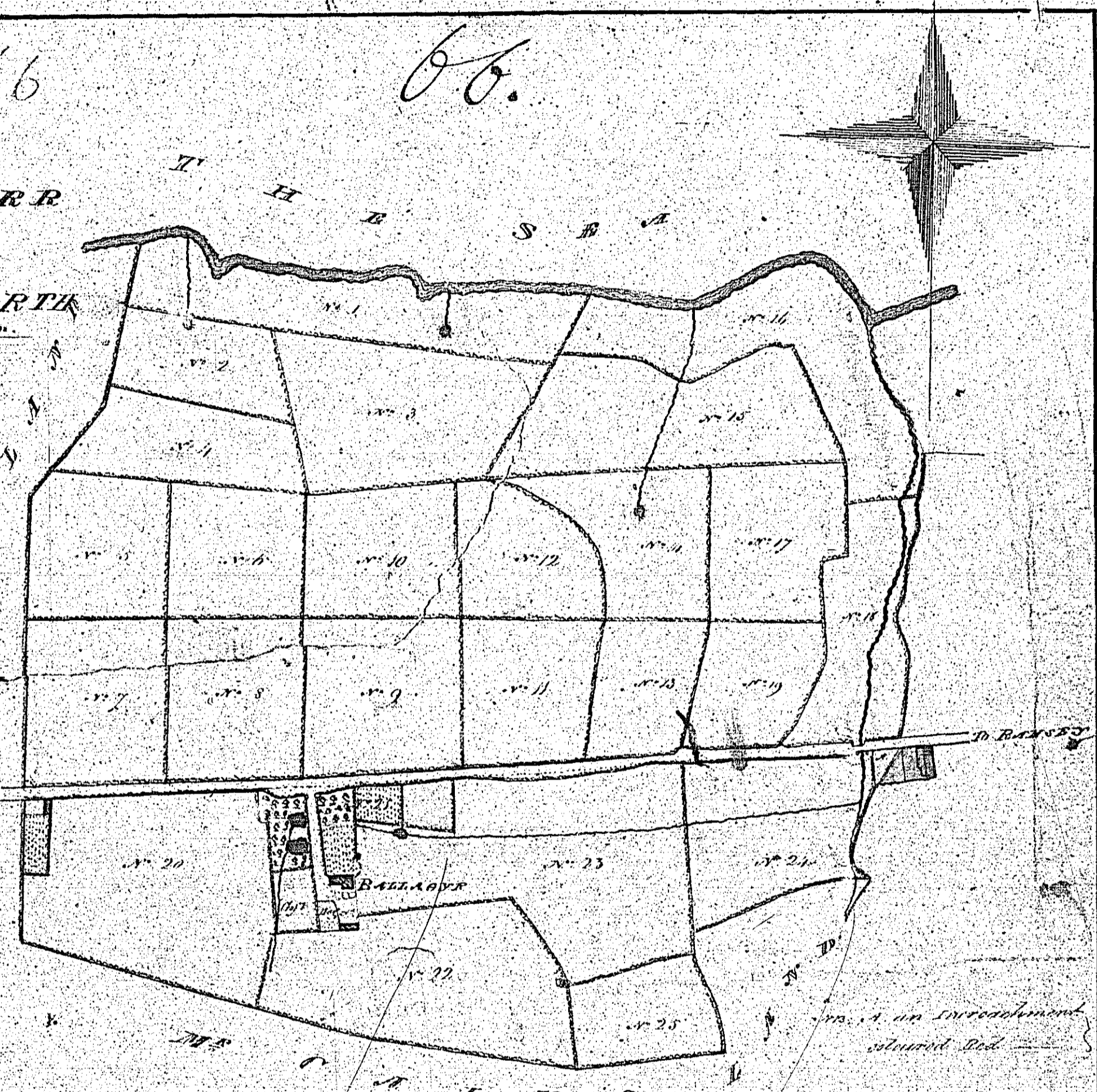

SCALES of STAINLESS CHAINS

W. B. GILLES 1812

Plats Chains to the Inch

No 22 to 32 inclusive parts  
Ballagyr

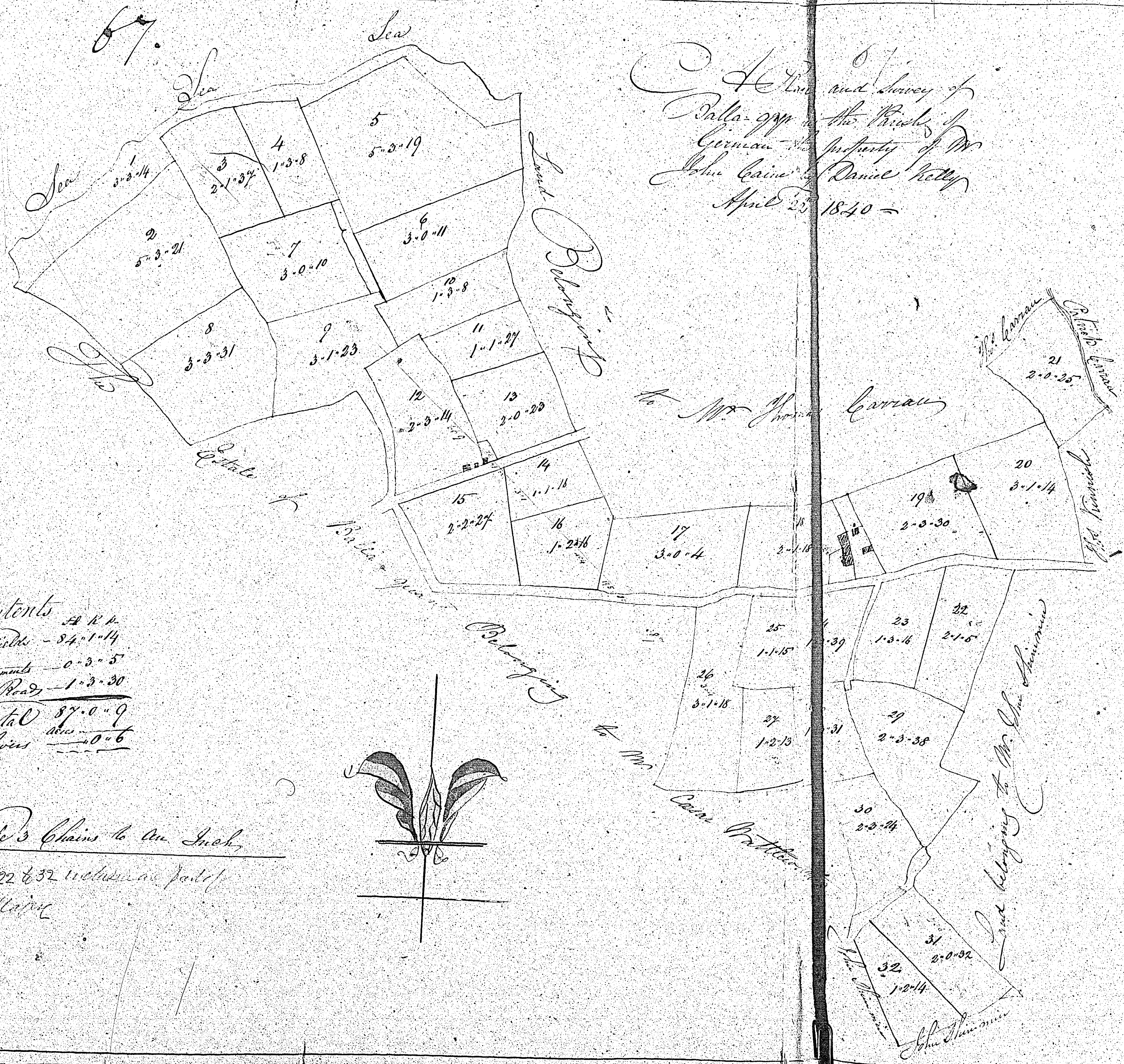

A Survey and Survey of  
 Palla-gga in the Parish of  
 Carran the property of Mr  
 John Cairn & Daniel Kelly  
 April 25 1840

Contents  
 The fields - 84-1-14  
 House & Barns - 0-3-5  
 Public Road - 1-3-30  
 Total 87-0-9  
 Acres 1-0-6

Scale's Chains to an Inch  
 Nos 22 & 32 included in part  
 Palla-gga

