

13

42

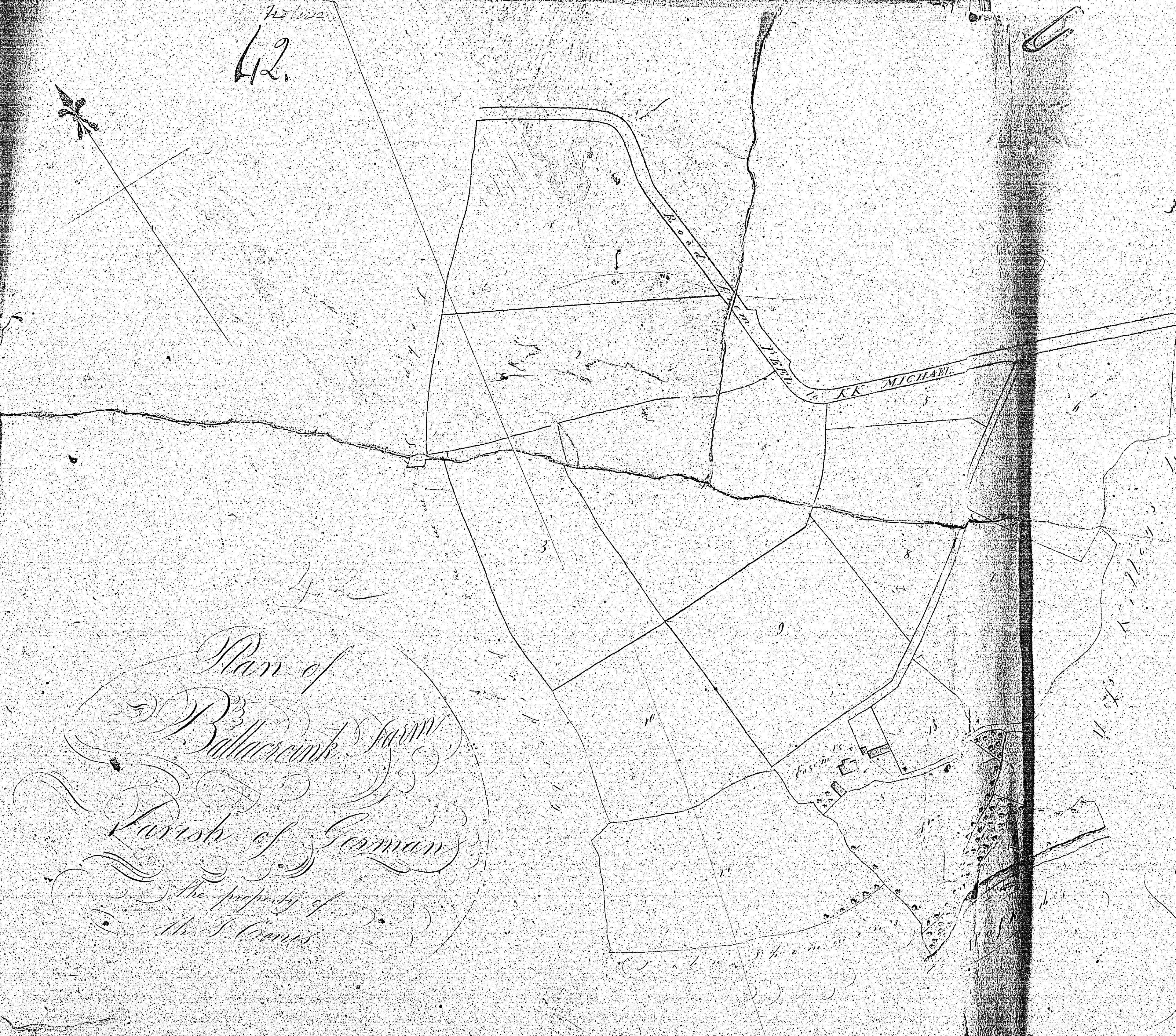

Plan of
Ballacreeb Farm
Parish of German
the property of
Mr. J. Lewis

Surveyed By J. Lewis July 1840



acres

1	1
2	1
3	1
4	1
5	1
6	1
7	1
8	1
9	1
10	1
11	1
12	1
13	1
14	1
15	1
16	1
17	1
18	1
19	1
20	1
21	1
22	1
23	1
24	1
25	1
26	1
27	1
28	1
29	1
30	1
31	1
32	1
33	1
34	1
35	1
36	1
37	1
38	1
39	1
40	1
41	1
42	1
43	1
44	1
45	1
46	1
47	1
48	1
49	1
50	1

63

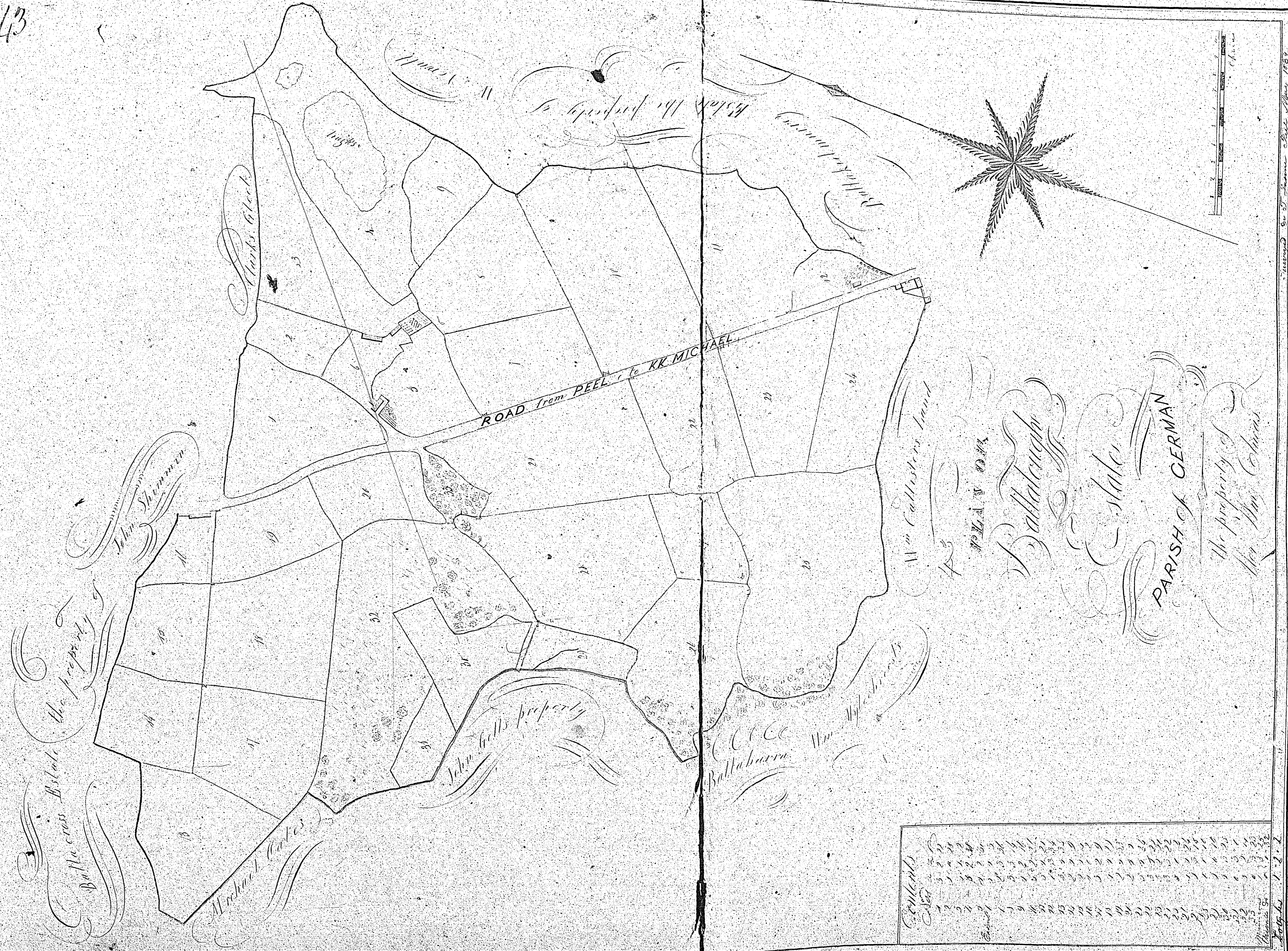

Contents	
Plot 1	1
Plot 2	2
Plot 3	3
Plot 4	4
Plot 5	5
Plot 6	6
Plot 7	7
Plot 8	8
Plot 9	9
Plot 10	10
Plot 11	11
Plot 12	12
Plot 13	13
Plot 14	14
Plot 15	15
Plot 16	16
Plot 17	17
Plot 18	18
Plot 19	19
Plot 20	20
Plot 21	21
Plot 22	22
Plot 23	23
Plot 24	24
Plot 25	25
Plot 26	26
Plot 27	27
Plot 28	28
Plot 29	29
Plot 30	30
Plot 31	31
Plot 32	32
Plot 33	33
Plot 34	34
Plot 35	35
Plot 36	36
Plot 37	37
Plot 38	38
Plot 39	39
Plot 40	40
Plot 41	41
Plot 42	42
Plot 43	43
Plot 44	44
Plot 45	45
Plot 46	46
Plot 47	47
Plot 48	48
Plot 49	49
Plot 50	50
Plot 51	51
Plot 52	52
Plot 53	53
Plot 54	54
Plot 55	55
Plot 56	56
Plot 57	57
Plot 58	58
Plot 59	59
Plot 60	60
Plot 61	61
Plot 62	62
Plot 63	63
Plot 64	64
Plot 65	65
Plot 66	66
Plot 67	67
Plot 68	68
Plot 69	69
Plot 70	70
Plot 71	71
Plot 72	72
Plot 73	73
Plot 74	74
Plot 75	75
Plot 76	76
Plot 77	77
Plot 78	78
Plot 79	79
Plot 80	80
Plot 81	81
Plot 82	82
Plot 83	83
Plot 84	84
Plot 85	85
Plot 86	86
Plot 87	87
Plot 88	88
Plot 89	89
Plot 90	90
Plot 91	91
Plot 92	92
Plot 93	93
Plot 94	94
Plot 95	95
Plot 96	96
Plot 97	97
Plot 98	98
Plot 99	99
Plot 100	100

1897

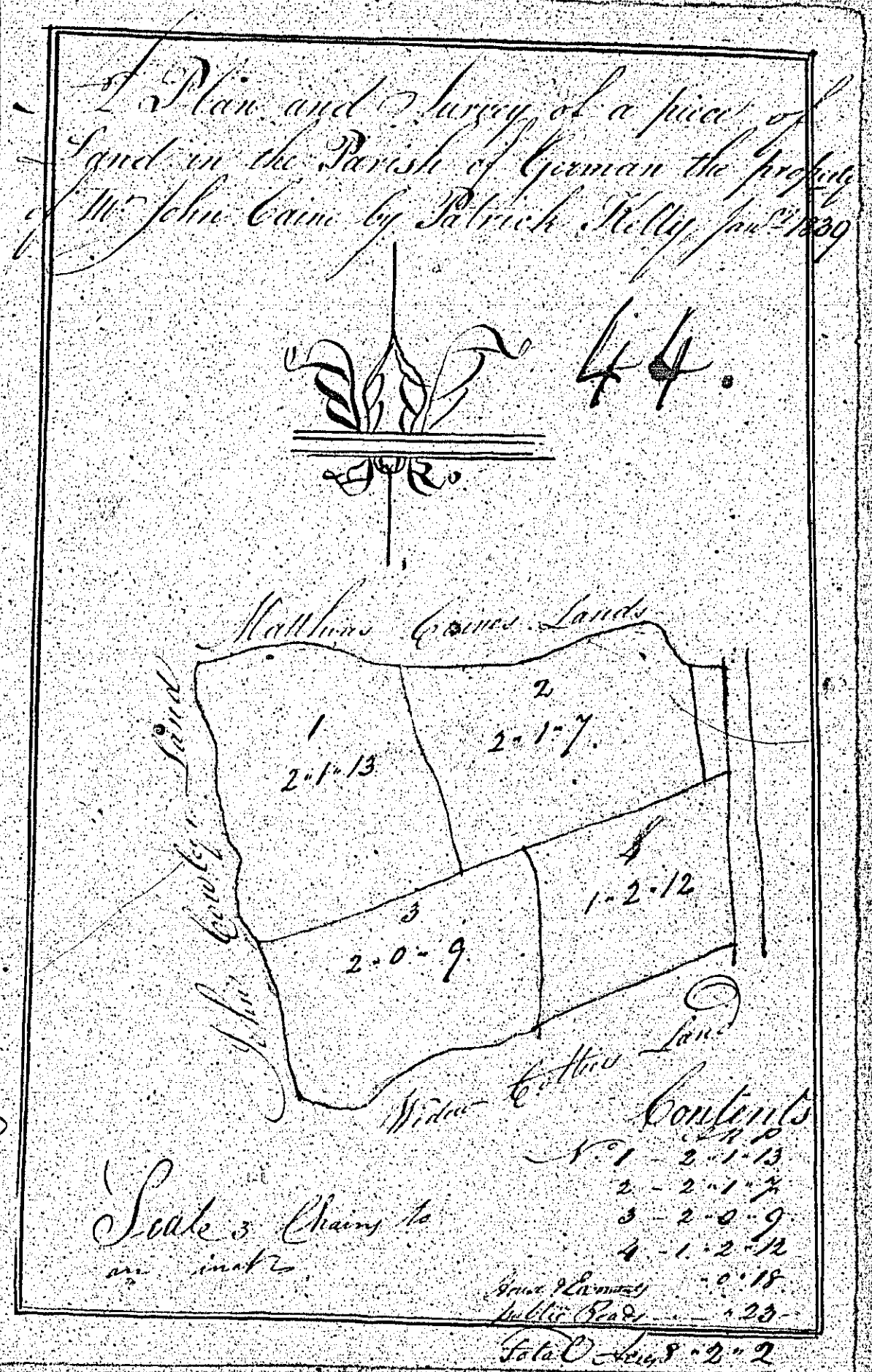

Total content 21 3 23

0 1 2 3 4 5 6 7 8 9 10 chains

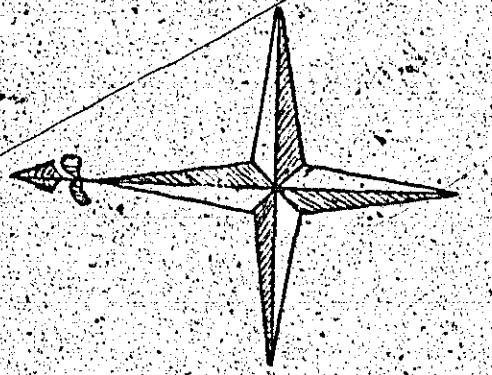

Surveyed June 1849
By William Magdon
W. M. Jun^r

Plan of
 the
 Property of
 Mr. John Cairns
 belonging to
 Bull-hoggs

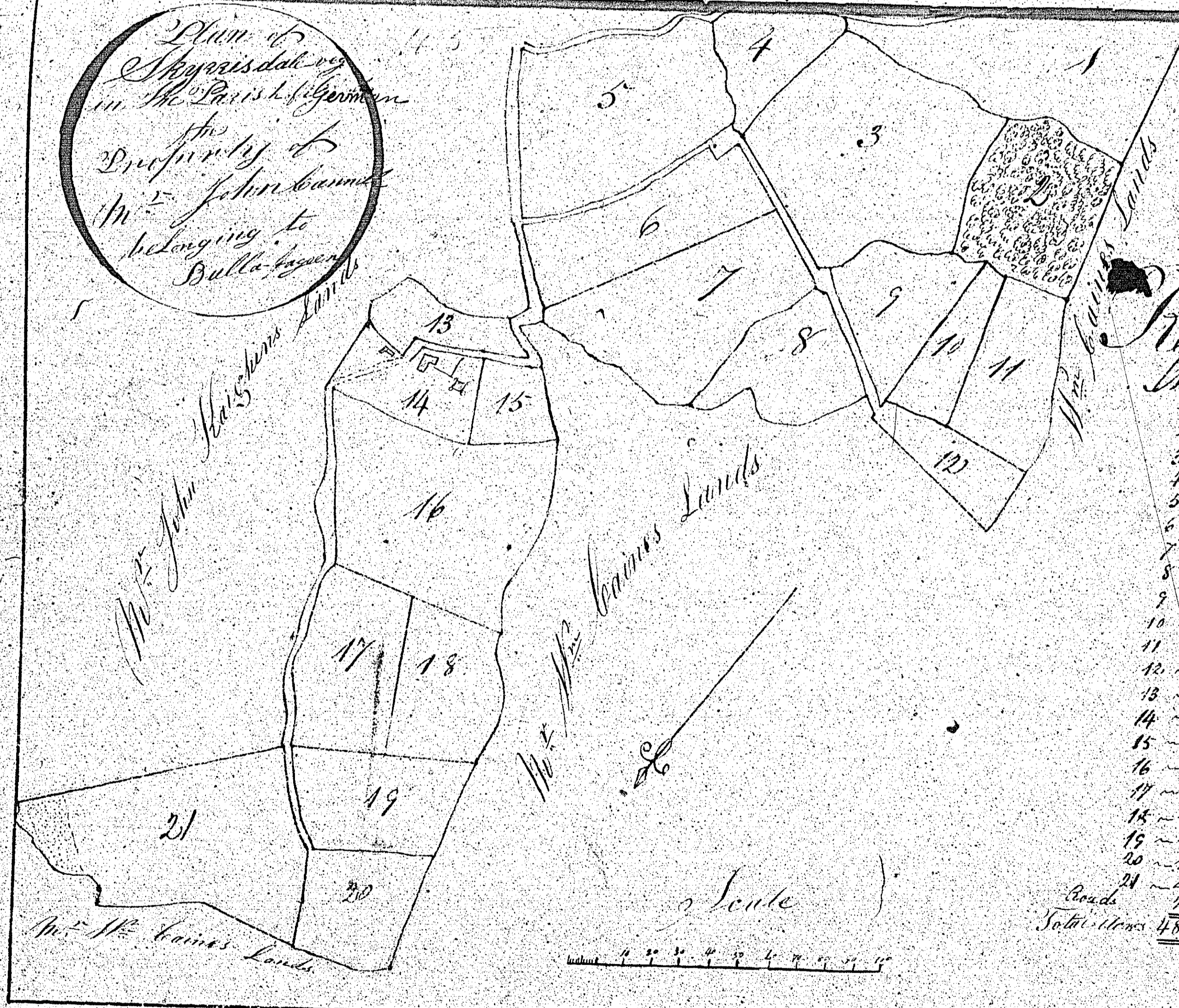

Reference

No.	A	B
1	5	35
2	2	11
3	4	11
4	1	6
5	3	24
6	2	11
7	3	6
8	1	13
9	1	24
10	2	17
11	1	21
12	1	15
13	1	11
14	1	8
15	0	1
16	4	4
17	2	1
18	1	36
19	1	16
20	1	0
21	4	28
Roads	2	7
Total Area	48	180

1
2
3
4
5
6
7
8
9
10
11
12
13
14
15
16
17
18
19
20
21
22
23
24
25
26
27
28
29
30
31
32
33
34
35
36
37
38
39
40
41
42
43
44
45
46
47
48
49
50
51
52
53
54
55
56
57
58
59
60
61
62
63
64
65
66
67
68
69
70
71
72
73
74
75
76
77
78
79
80
81
82
83
84
85
86
87
88
89
90
91
92
93
94
95
96
97
98
99
100

From St. James

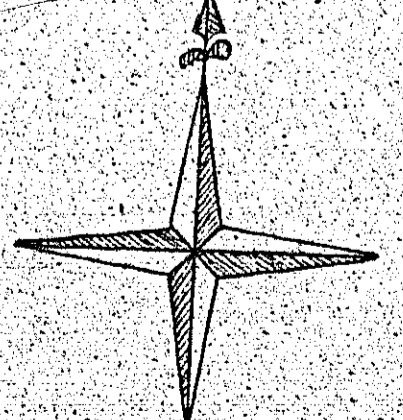

Scale



0 1 2 3 4 5 6 7 8 9 10 chains

16	2	1	5
17	1	3	34
Total Content	21	3	23

Surveyed June 1840
 by William Haigham

47

PLAN
 Of part of the Quarterland of Ballagucine
 In the Parish of RR. German
 The property of
 M^r John Cannell

46

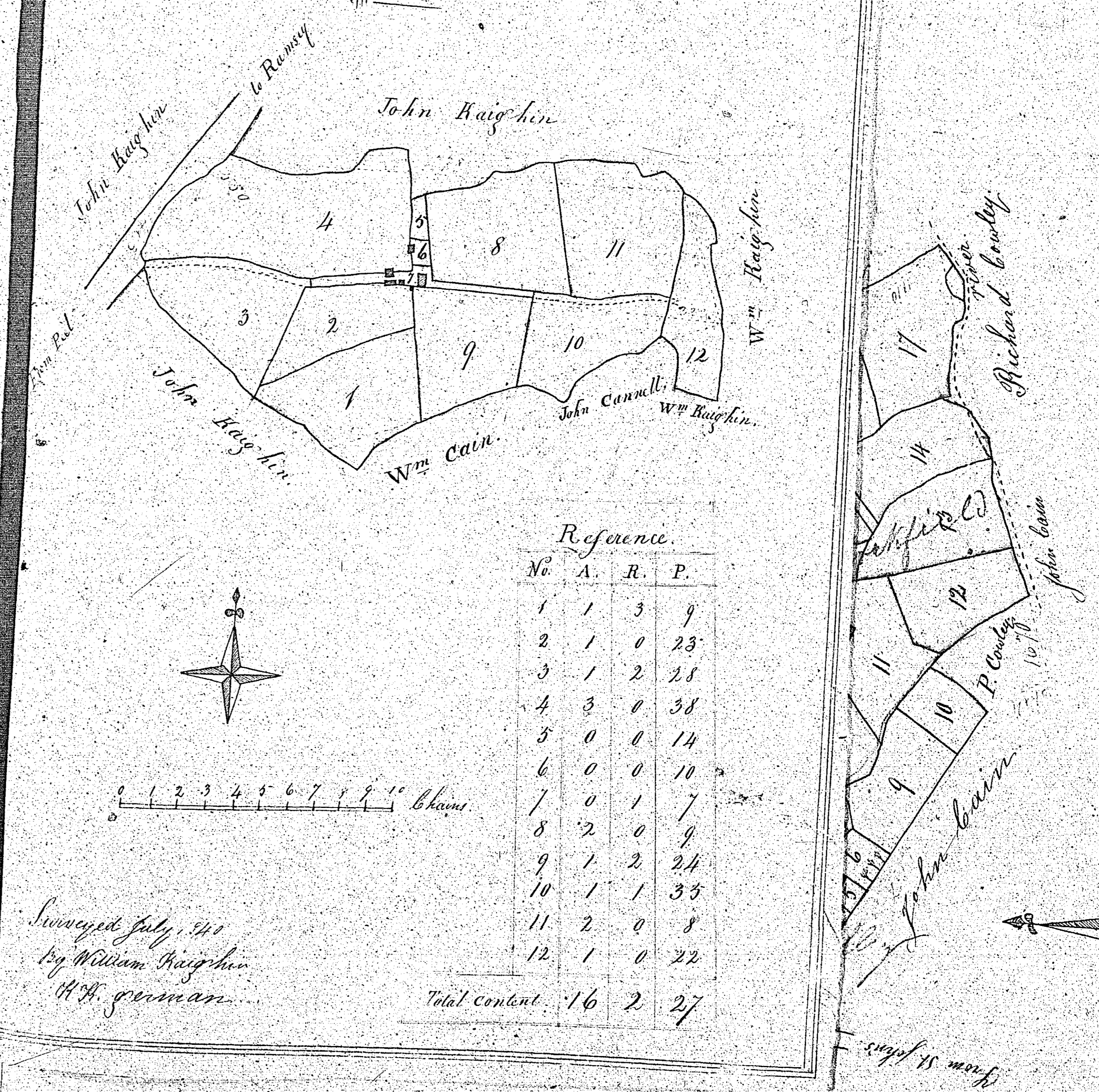

Reference			
No.	A.	R.	P.
1	1	3	9
2	1	0	23
3	1	2	28
4	3	0	38
5	0	0	14
6	0	0	10
7	0	1	7
8	2	0	9
9	1	2	24
10	1	1	33
11	2	0	8
12	1	0	22
Total content			16 2 27

14	1	2	3
15	1	2	35
16	2	1	5
17	1	3	34
Total content			21 3 23

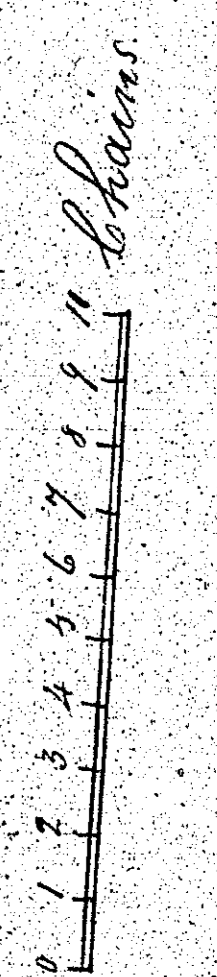

Surveyed June 1810
 By William Haigher
 H. H. German

Surveyed July 1810
 By William Haigher
 H. H. German

PLAN

Of part of the Quarterlands of the County and Stockfields
 In the parish of H. H. German
 The property of
 M^r. Philip Crellin

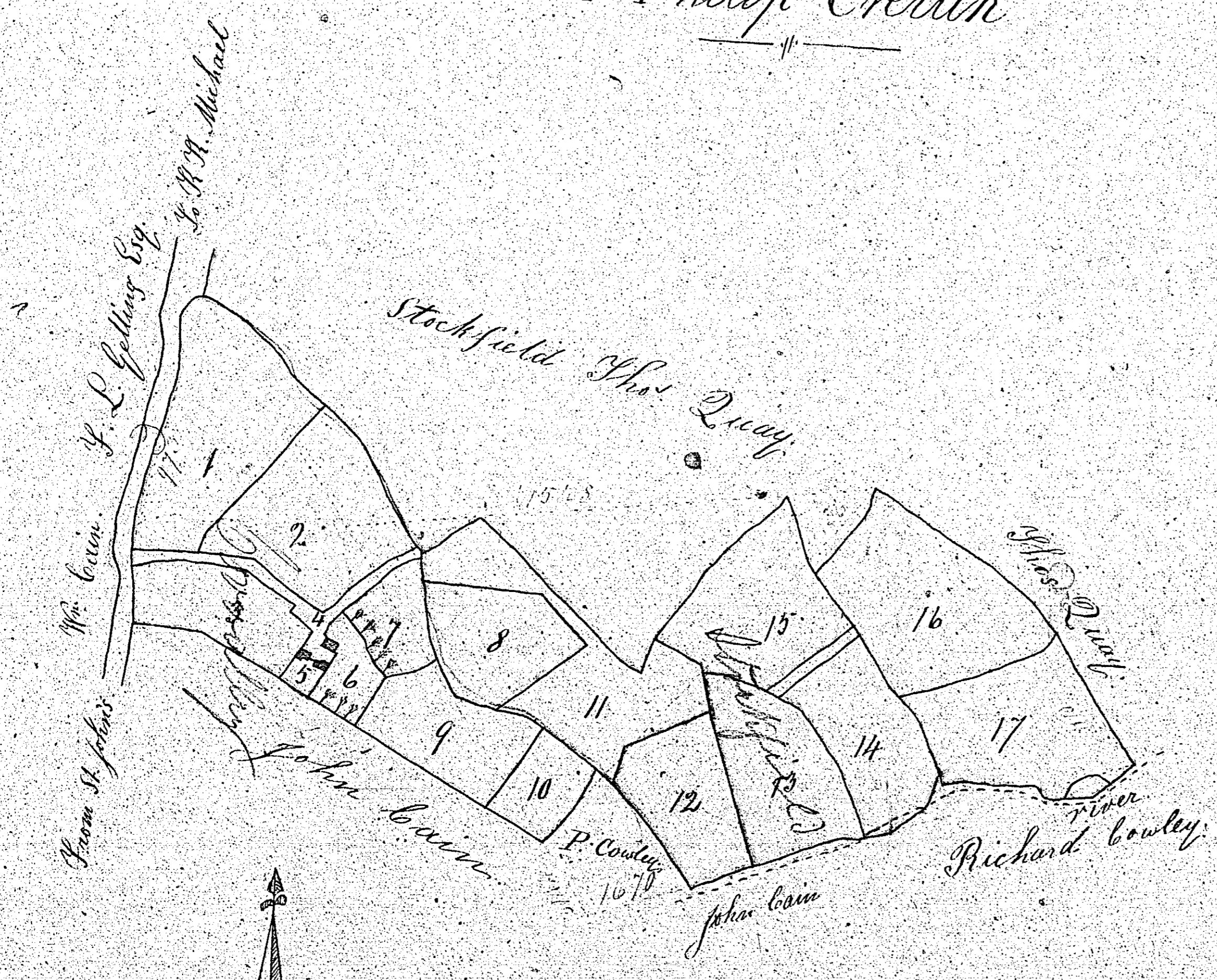

Reference			
No.	a.	r.	p.
1	2	1	4
2	2	0	0
3	1	0	9
4	0	2	0
5	0	0	15
6	0	1	25
7	0	2	10
8	1	0	26
9	1	0	31
10	0	2	10
11	1	3	30
12	1	0	34
13	1	1	32
14	1	2	3
15	1	2	35
16	2	1	5
17	1	3	34
Total Contd.	21	3	23

Surveyed June 1840
 By William Haigh
 H. H. German