

97
Plan AND Survey 97

of the Estate of
Balla-mona,
in the Parish of Braddan
the Property of John Seave Esq.

Contents.

N ^o	Contains	A. R. P.
1	2.0.9	
2	8.2.30	
3	5.1.38	
4	0.0.21	
5	3.4.34	
6	3.0.7	
7	0.0.5	
8	5.2.39	
9	0.2.16	
10	3.1.31	
11	2.1.29	
12	0.1.8	
13	0.1.23	
14	6.3.21	
15	1.1.38	
16	0.1.18	
17	0.0.22	
18	0.1.3	
19	8.1.18	
20	0.1.8	
21	0.0.27	
22	5.2.24	
23	1.0.2	
24	3.3.11	
25	5.2.39	
26	5.2.17	
27	5.0.15	
28	2.2.23	
29	3.3.16	
30	5.1.13	
31	2.2.3	
32	4.0.18	
33	3.2.35	
34	3.0.10	
35	4.2.0	
36	0.3.35	
37	1.0.16	
38	2.2.10	
39	4.2.2	
40	0.1.24	
41	0.0.26	
Total	118.0.21	
42	See Map	3.1.27
		122.0.48

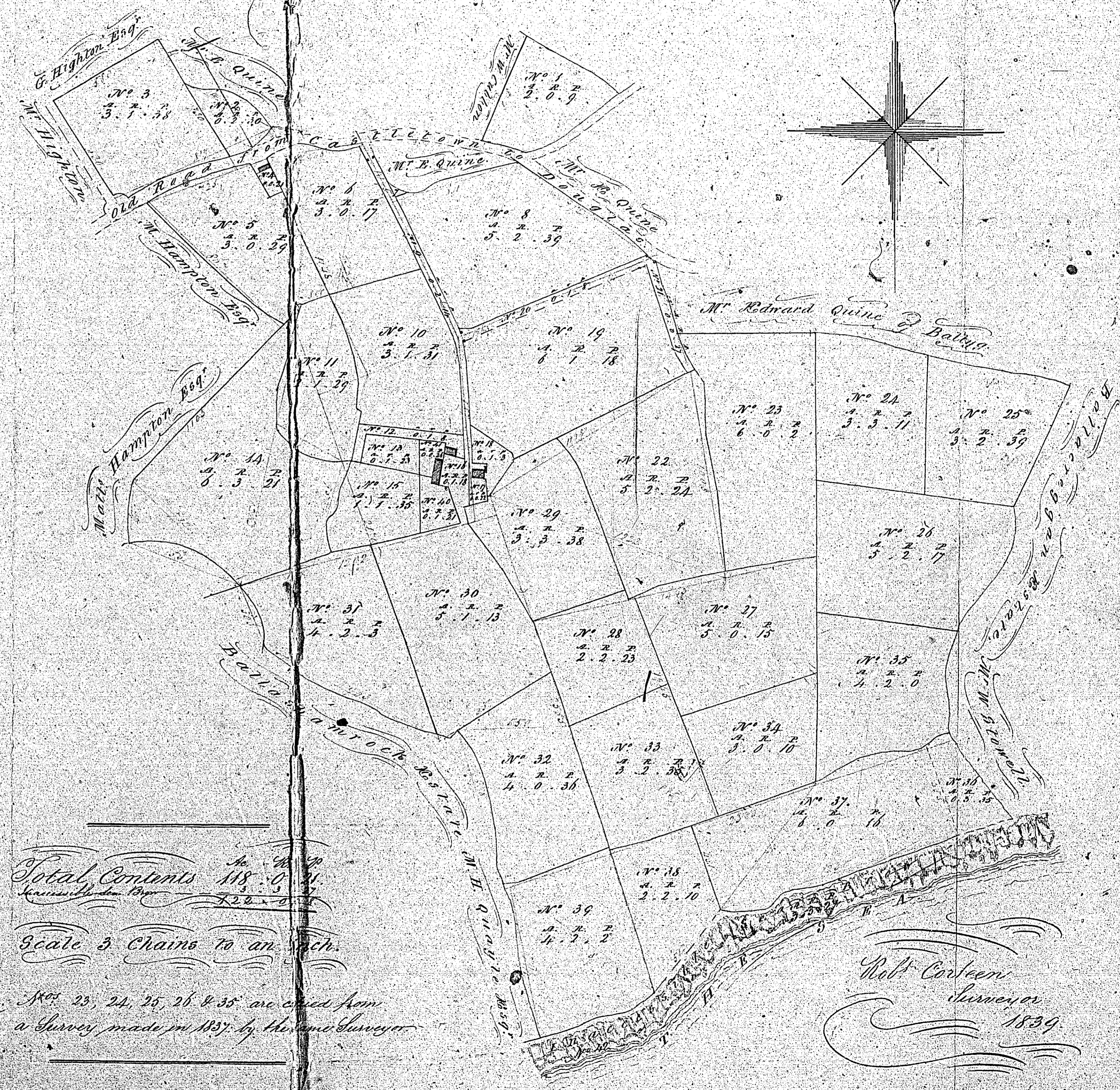

Total Contents 118.0.21

Scale 3 Chains to an Inch.

Note. Nos. 23, 24, 25, 26 & 35 are copied from a Survey made in 1837 by the same Surveyor.

Wm. Corbett
Surveyor
1839

PLAN
of Part of
CLYBANE
Parish of Boddan 98
The Property of
MR JOHN LABOURN.

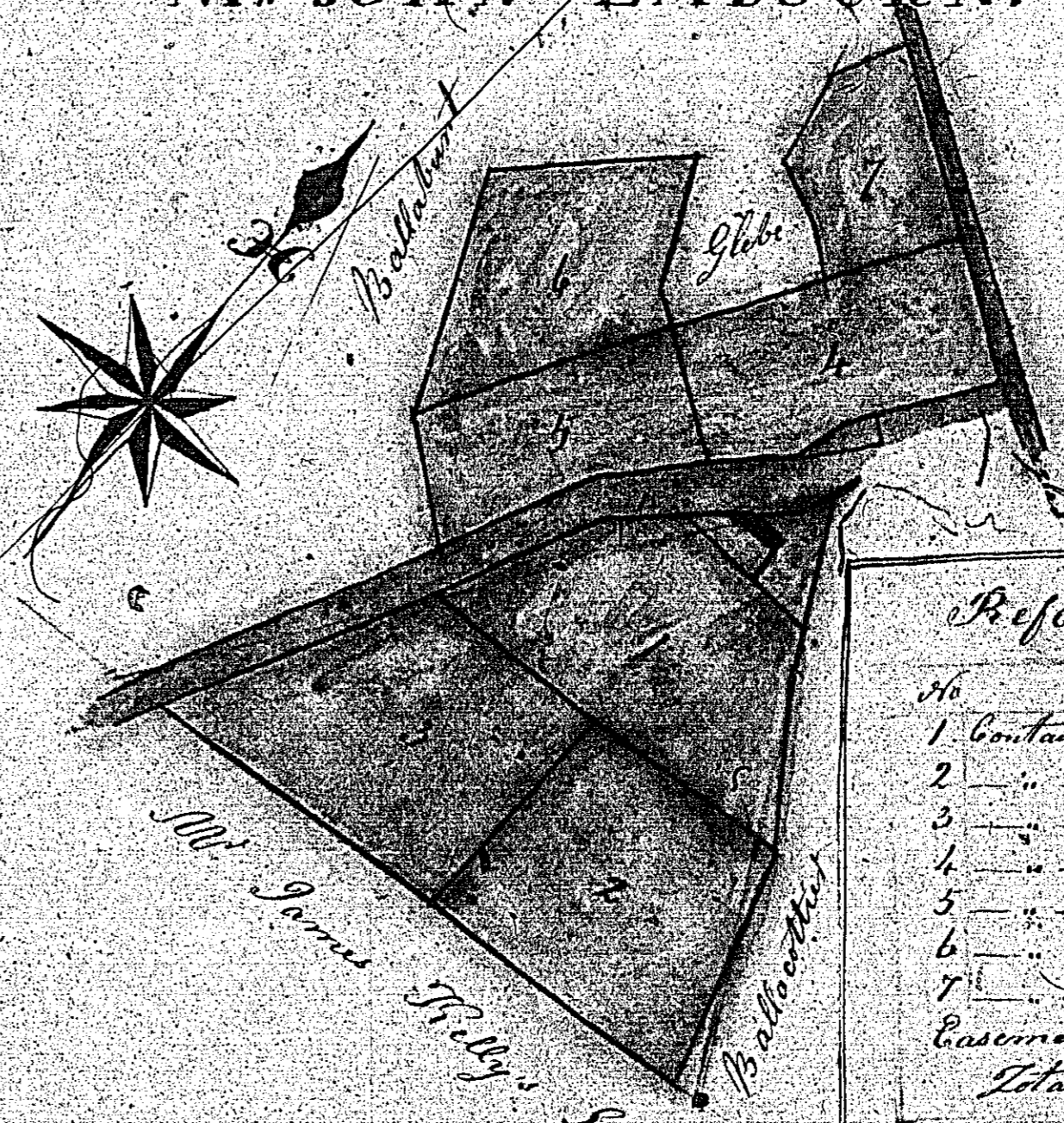

Reference	
No	A. R. P.
1	contains 0 3 7
2	— 0 3 7
3	— 0 3 20
4	— 0 2 11
5	— 0 1 34
6	— 0 2 10
7	— 0 1 19
Easement 0 0 14	
Total 4 1 36	

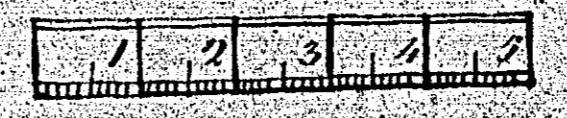

John Great Surveyor A. Boddan 1839.

Plan 99
 of part of
 Ballabunt
 Parish of Boddan
 The Property of
 Mr. C. Lewis



Reference		
1	contains	0 3 39
2	"	0 3 32
3	"	2 0 1
4	"	1 0 33
5	"	0 3 37
6	"	0 2 58
7	"	0 3 28
8	contains	0 0 32
Total		0 0 0

Scale of Chains three to an Inch.
 John Green Surveyor for Boddan 1840.

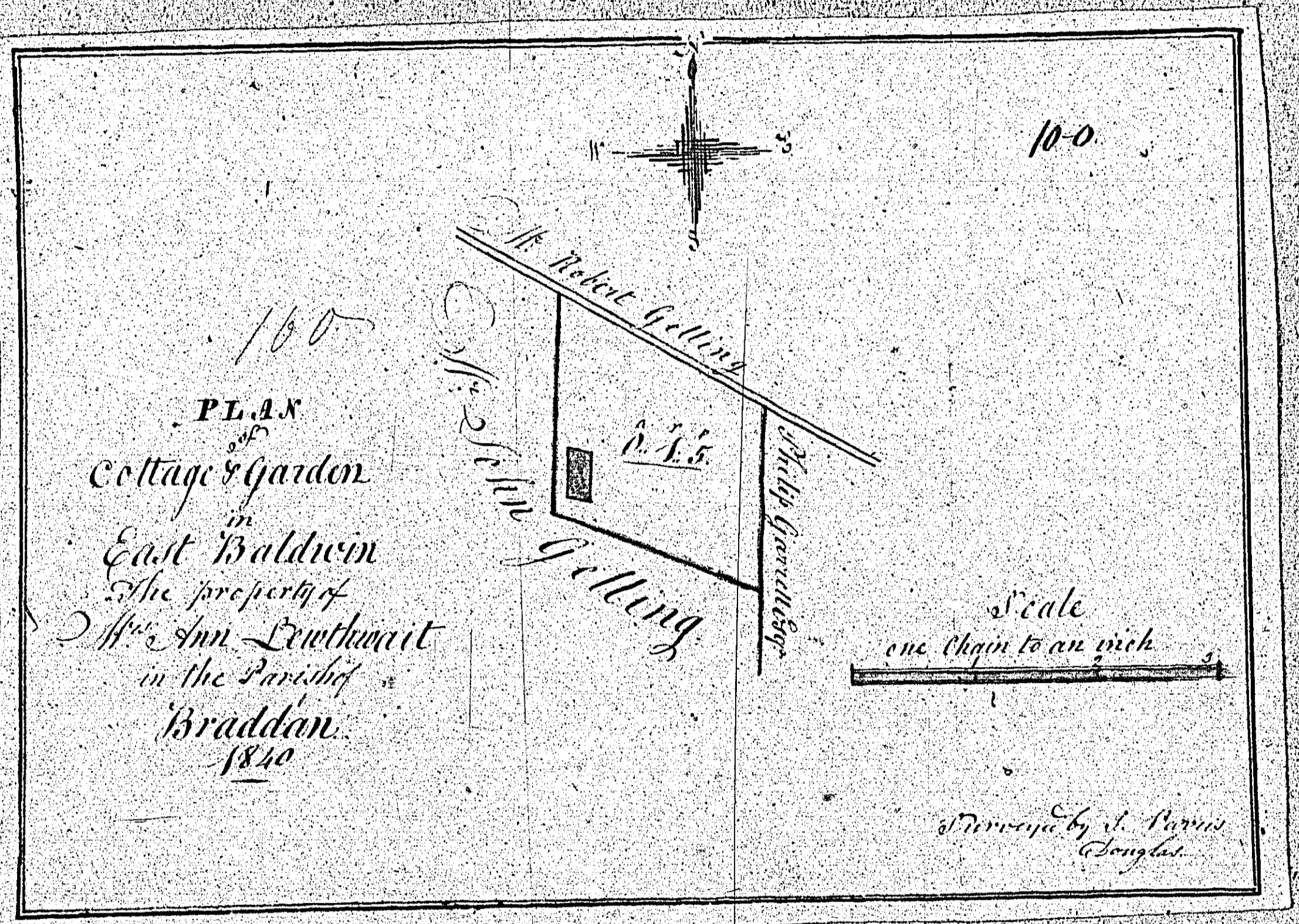

160
PLAN
of
Cottage & Garden
in
East Baldwin
The property of
M^{rs} Ann Leitchman
in the Parish
of Braddon.
1840

Scale
one chain to an inch

Surveyed by J. Harris
J. Tomlin

PLAN
 Of part of Montrale 101 101
 Quarterland

THE PROPERTY OF
 George Moore Esq.
 IN THE PARISH OF

Braddan
 July 25th 1739

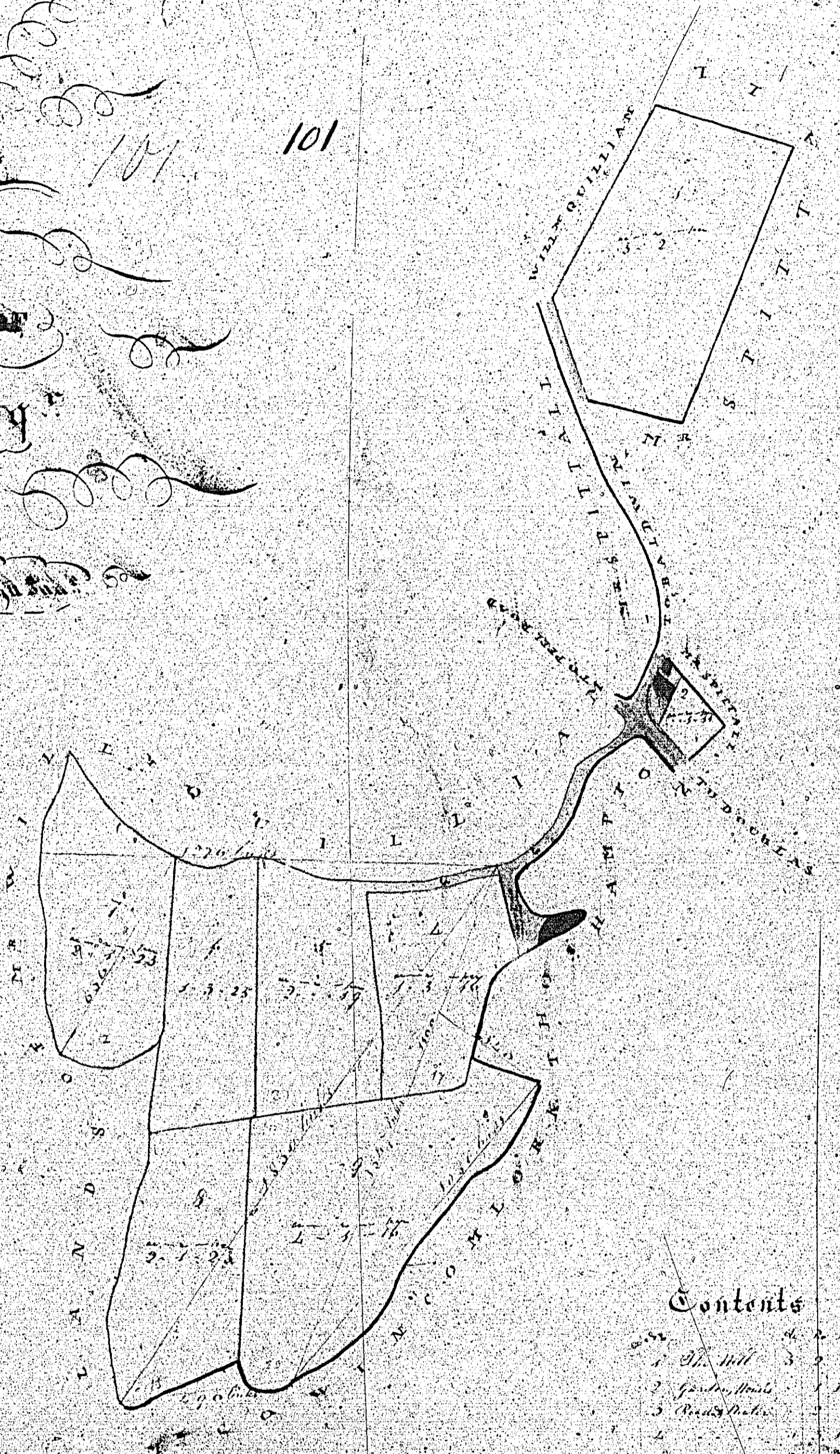

Contents

1	4	20
2	3	2
3	11	
4	16	
5	25	
6	25	
7	25	
8	16	
9	15	
Total	130	

Total Content 130 Acres
 Scale Three chains to an Inch

ROSE HILL

Plan 102
of Part of *Mauk's* *Isle*
Lewis *Island*
In the Parish of *Oranmore*
Belonging to *M. Philip Moore*
March 1840. By *M. Sam. Moore*

No.	A.	R.	P.
1.	1	0	36
2.		3	65
3.	1	1	29
Total	3	1	28

Proportion of Acres 26 Bolls

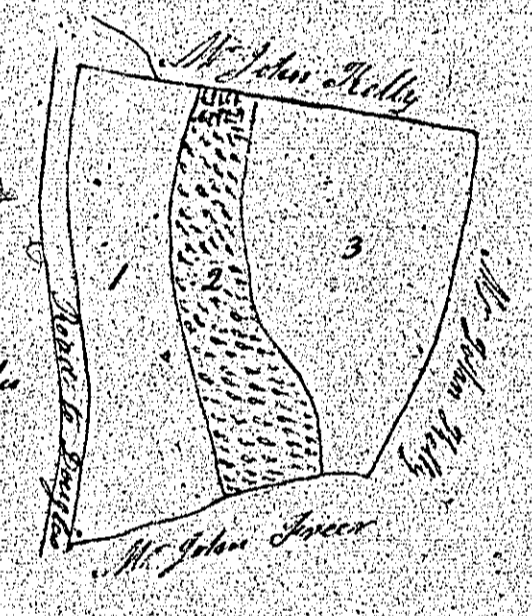

Scale

to Douglas