

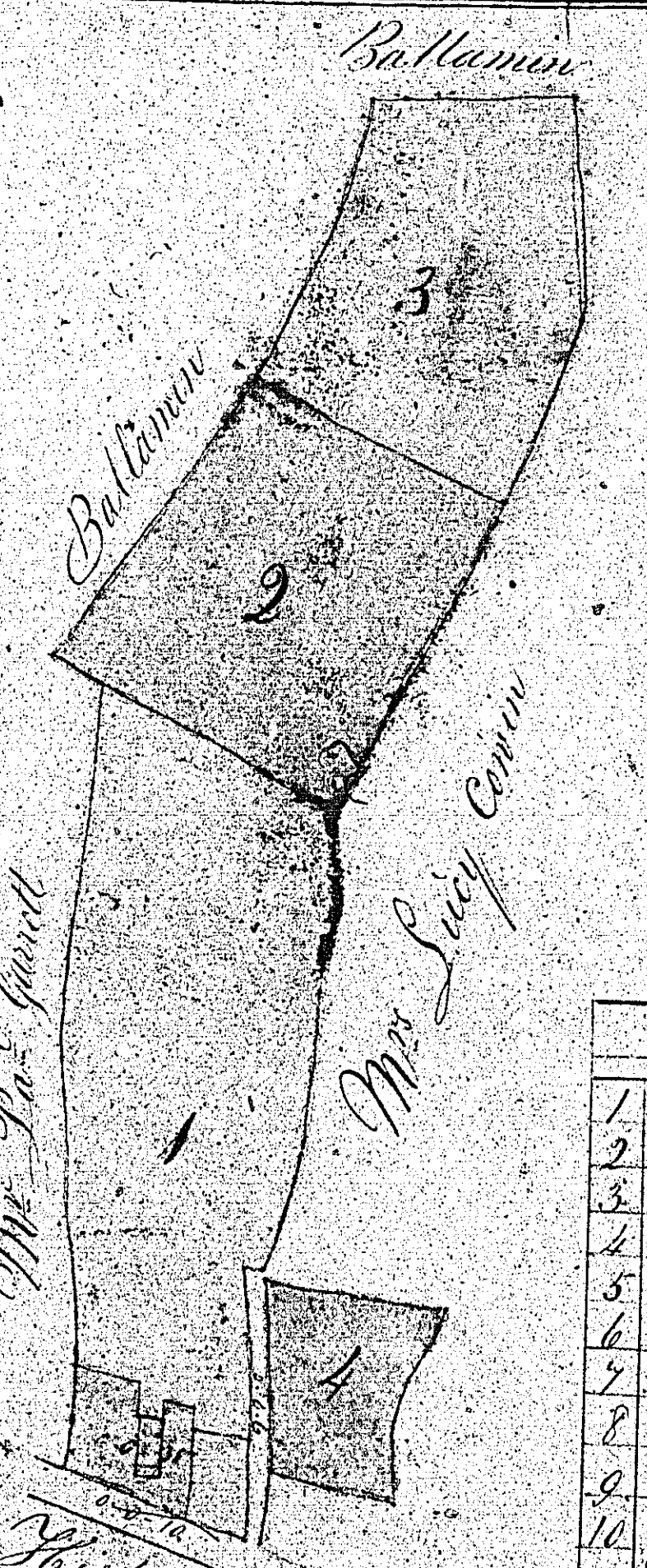

MAP
and Survey of
Part of
Glentruan and Ballahes
in the Parish of Breda
belonging to Mr John Ganne
by Tho Craine May 1739

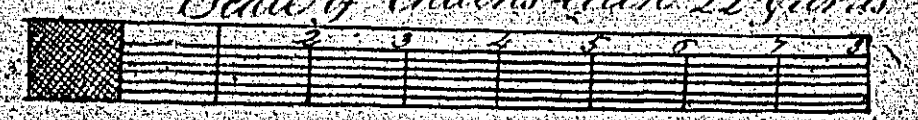

Contents	ARP
1	2 1/4
2	1 2/11
3	1 1/12
4	0 1 3/6
5	2 2/11
6	0 2 3/4
7	1 1 3/4
8	2 0 3/33
9	1 0 2/3
10	2 2 4
Walls & garden grounds & woods 1766	18 2 20

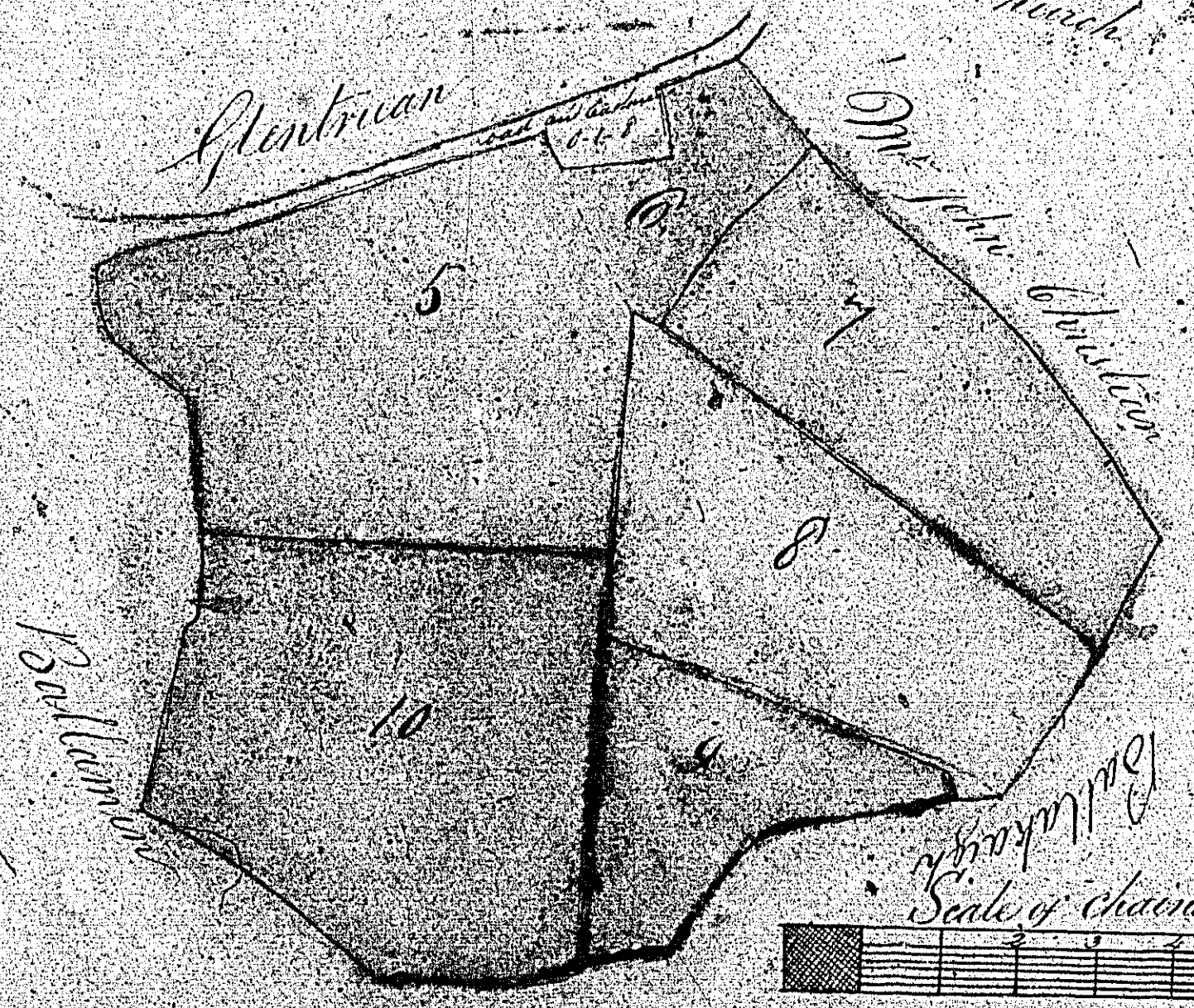

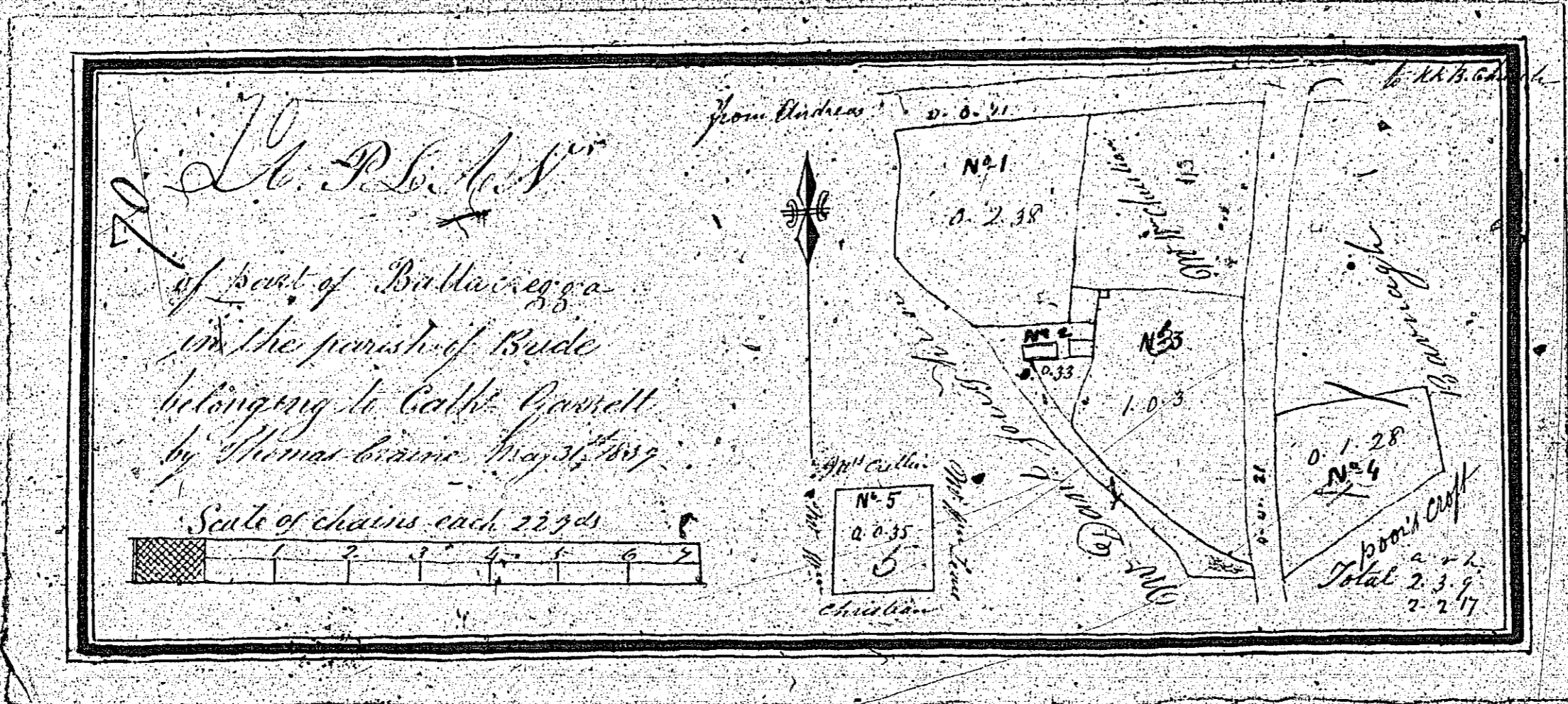

ISLE OF MAN GOVERNMENT: GENERAL REGISTRY

TITHE PLANS: PARISH OF BRIDE

Original monotone

1:30

71.
Plan of a part of Ballinacree
in the Parish of Bride
the property of
Mr. Wm. G. G. Smith

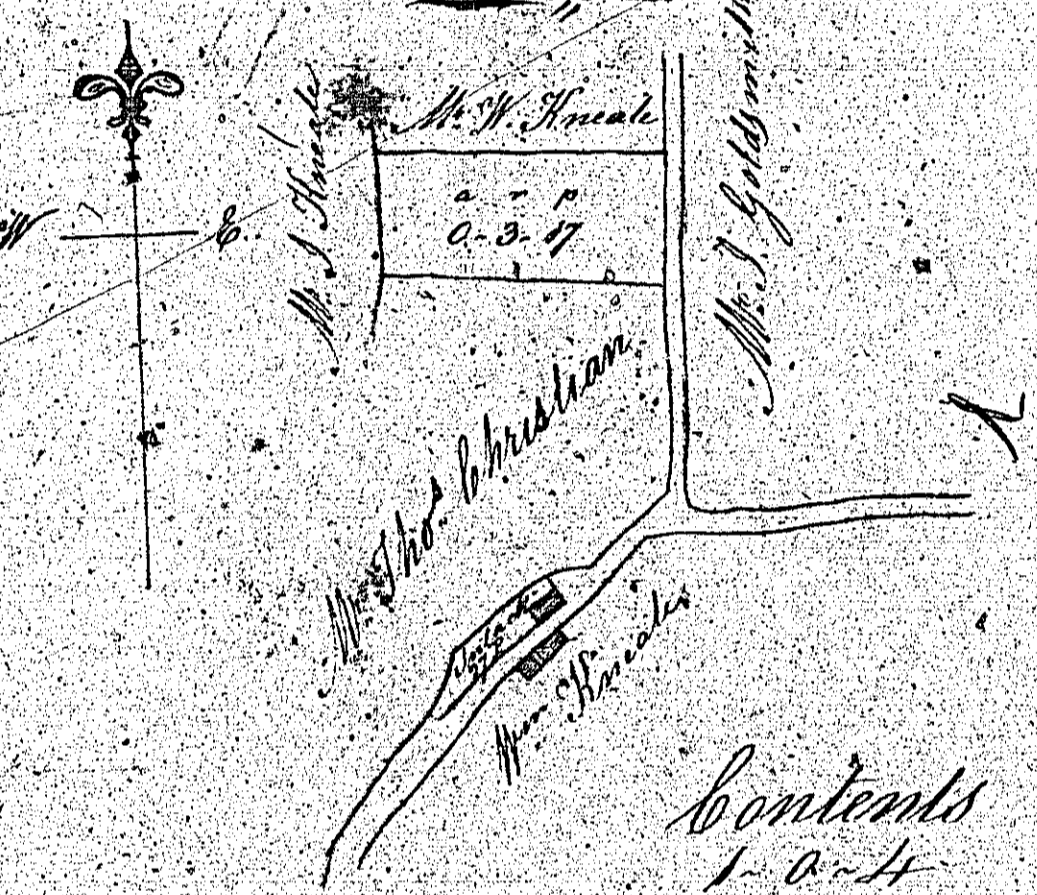

Scale of 3 Chains
to One Inch

Contents
1-0-4

By J. G. G. Smith
Surveyor 1839

J. G. G. Smith

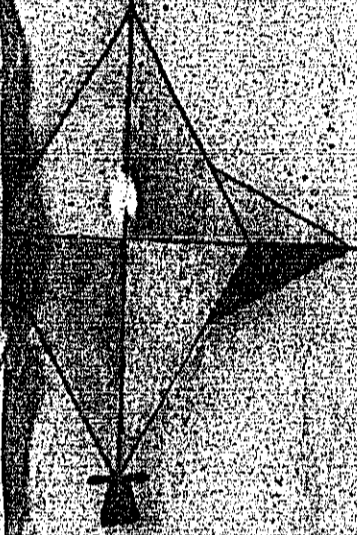

1	0	4
2	0	4
3	0	4
4	0	4
5	0	4
6	0	4
7	0	4
8	0	4
9	0	4
10	0	4
11	0	4
12	0	4
13	0	4
14	0	4
15	0	4
16	0	4
17	0	4
18	0	4
19	0	4
20	0	4
21	0	4
22	0	4
23	0	4
24	0	4
25	0	4
26	0	4
27	0	4
28	0	4
29	0	4
30	0	4
31	0	4
32	0	4
33	0	4
34	0	4
35	0	4
36	0	4
37	0	4
38	0	4
39	0	4
40	0	4
41	0	4
42	0	4
43	0	4
44	0	4
45	0	4
46	0	4
47	0	4
48	0	4
49	0	4
50	0	4

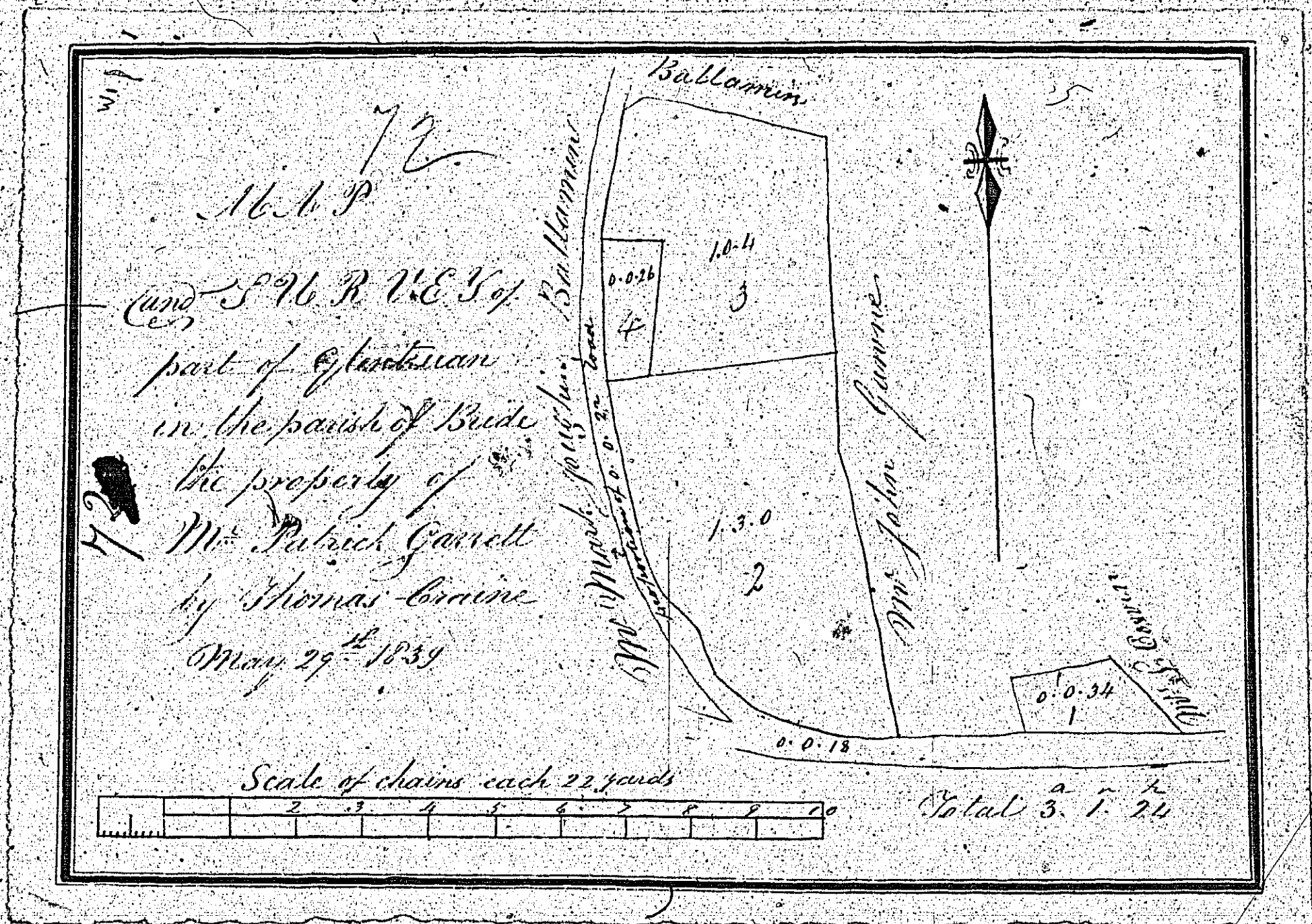

ISLE OF MAN GOVERNMENT: GENERAL REGISTRY
 TITHE PLANS: PARISH OF BRIDE.

Original monotone

1:30

ISLE OF MAN GOVERNMENT: GENERAL REGISTRY

TITHE PLANS: PARISH OF BRIDE

Original coloured (decorative)

1:30

A1

A2

A3

A4

A5

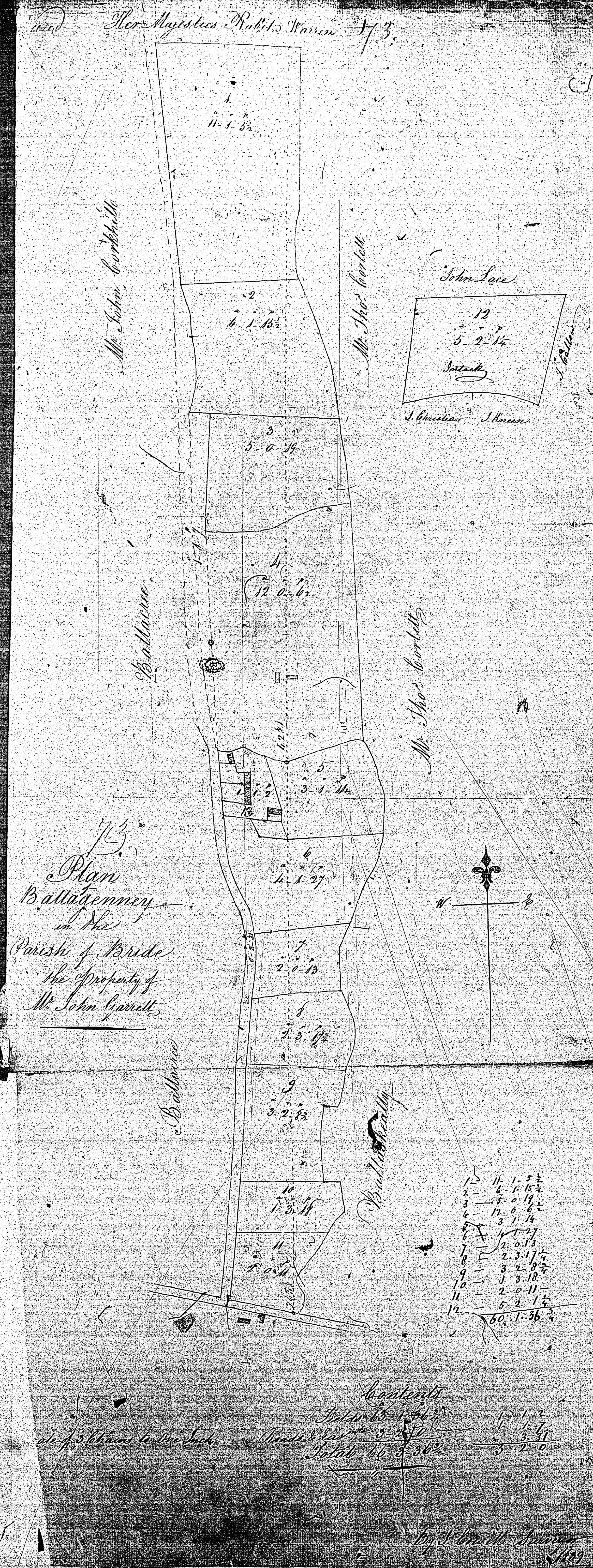

74
 Plan and Survey of
 a Part of
 Ballacrowl Beg
 in the Parish of
 Bride.
 the Property of
 Mr. T. Goldsmith.

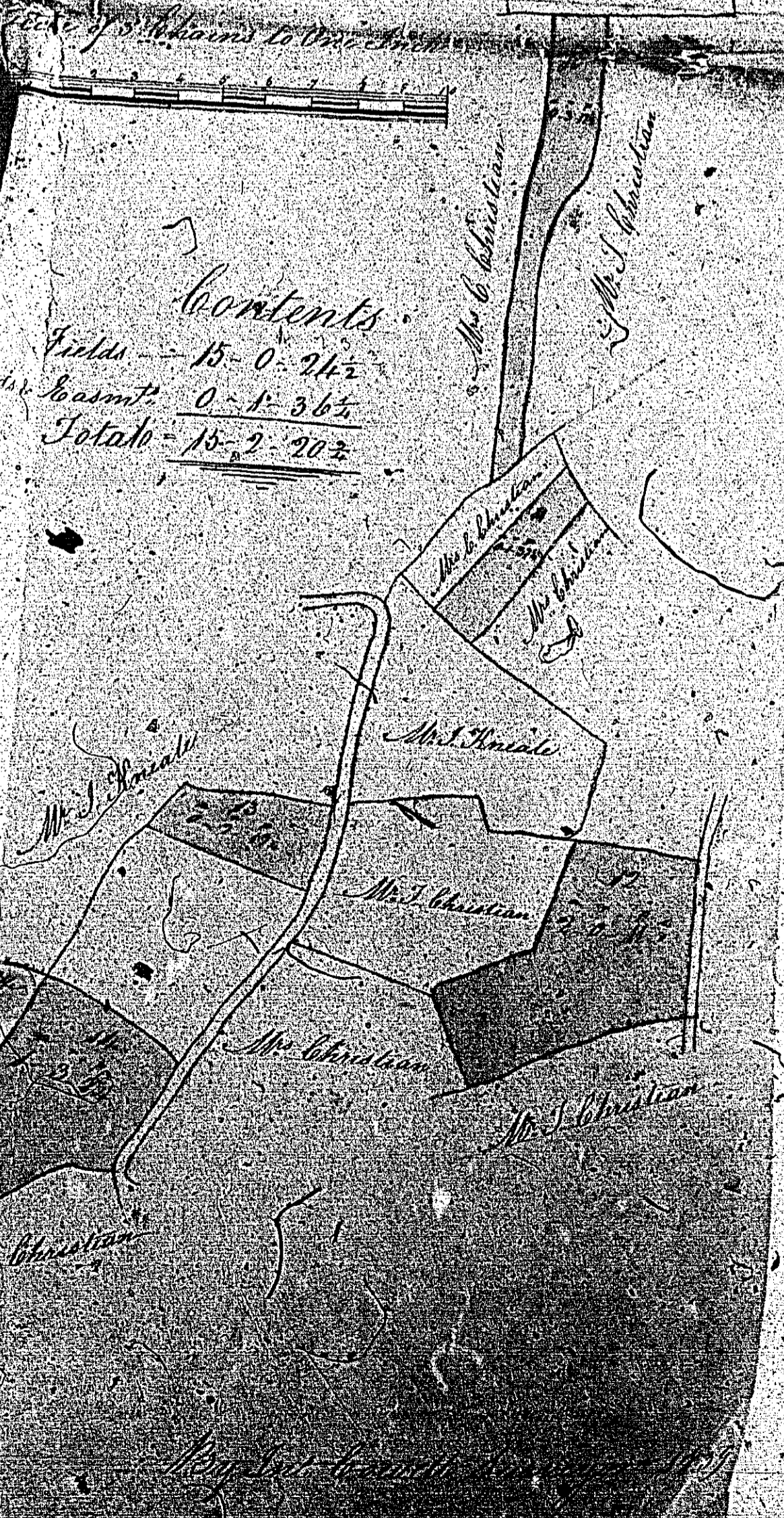
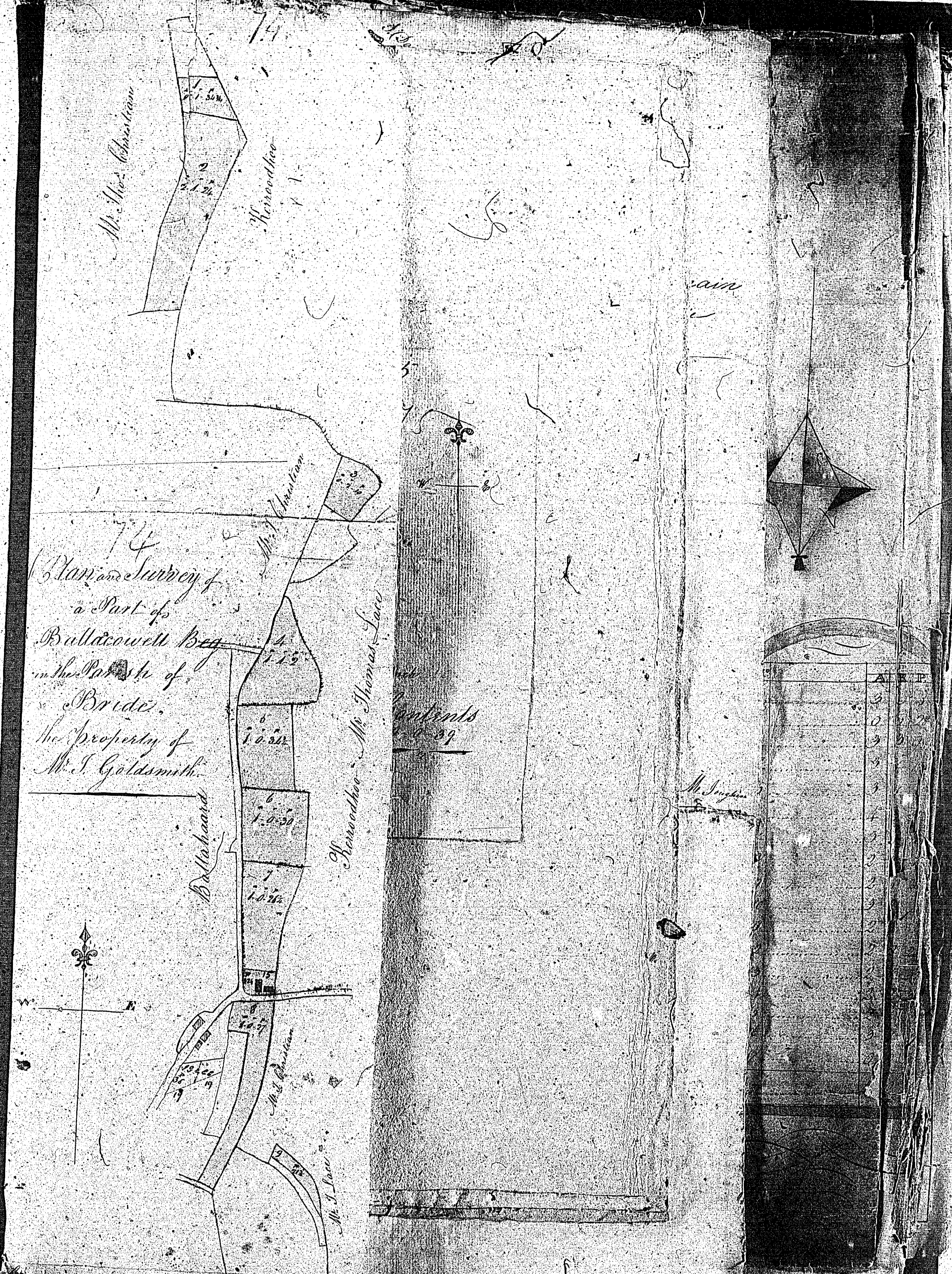

ISLE OF MAN GOVERNMENT: GENERAL REGISTRY
 TITHE PLANS: PARISH OF BRIDE

Original coloured

1:30

A/1 A/2 A/3 A/4