

MAP
 of
 Survey of
 Glebe land
 in the parish of
 B. R. I. D. E.
 the property of
 Mr John Small
 by Thomas Braine May 1839

Contents of	
1	4 2 20
2	4 1 28
3	3 1 9
4	0 3 18
5	1 1 13
6	2 2 10
7	1 1 21
8	2 0 28
9	0 2 39
10	2 0 30
Proprietary High Road	0 6 32
Total	23 5 3

Contents

1	
2	
3	
4	
5	
6	
7	
8	
9	
10	
11	
12	
13	
14	
15	
16	

Proportional
Roads

Thomas Braine

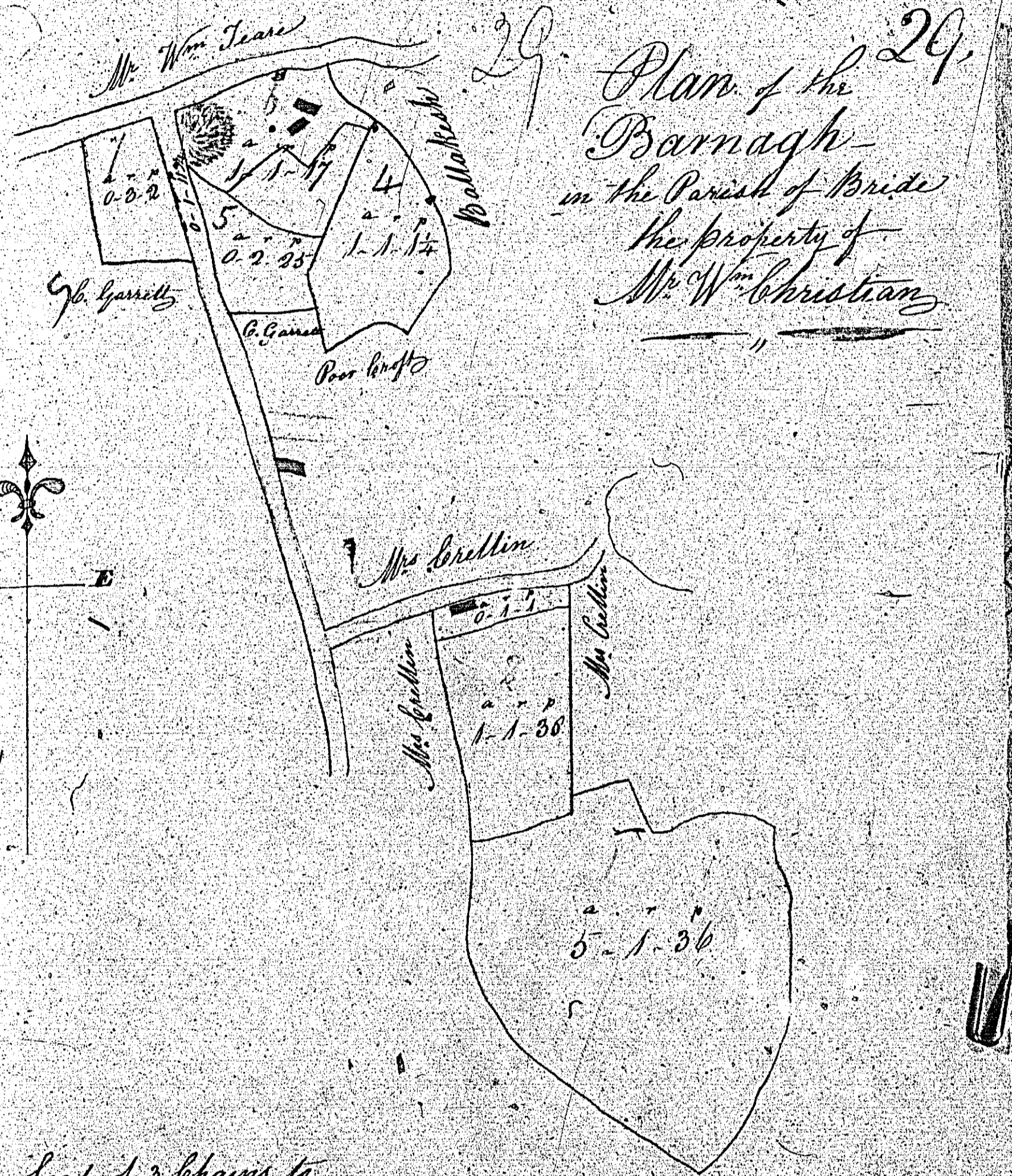

29. Plan of the Barnagh in the Parish of Bride the property of Mr. W. Christian

Scale of 3 Chains to One Inch

Contents
M. 2. 10

John Cowell
Surveyor 1839

Contents

1	
2	
3	
4	
5	
6	
7	
8	
9	
10	
11	
12	
13	
14	
15	
16	
A	

Proportion of Acres
Total 10

66

ISLE OF MAN GOVERNMENT: GENERAL REGISTRY
 TITHE PLANS: PARISH OF BRIDE
 Original coloured (decorative) 1:30

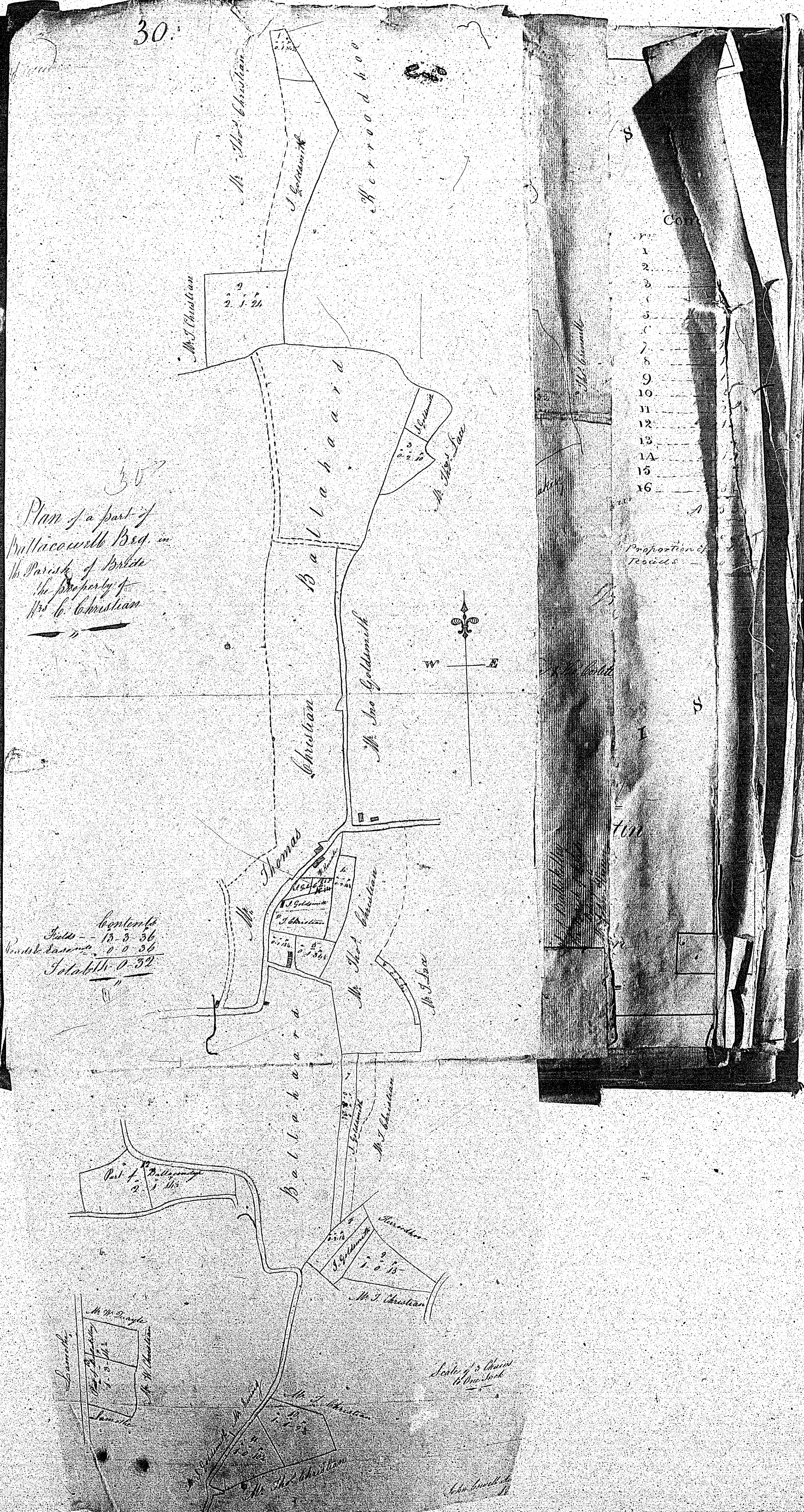

Plan of a part of
 Ballacowll Beg
 in the parish of Biddle
 the Property of
 Mr. Tho. Christian

31.

31



Scale of 3 Chains
 to One Inch

Contents
 A 2 1/2

By Jas. Bewell
 Surveyor 1839

Cont

1	
2	
3	
4	
5	
6	
7	
8	
9	
10	
11	
12	
13	
14	
15	
16	

Proportion of
 Roads

The Parish of Biddle
 the Property of
 Mr. Tho. Christian

32.

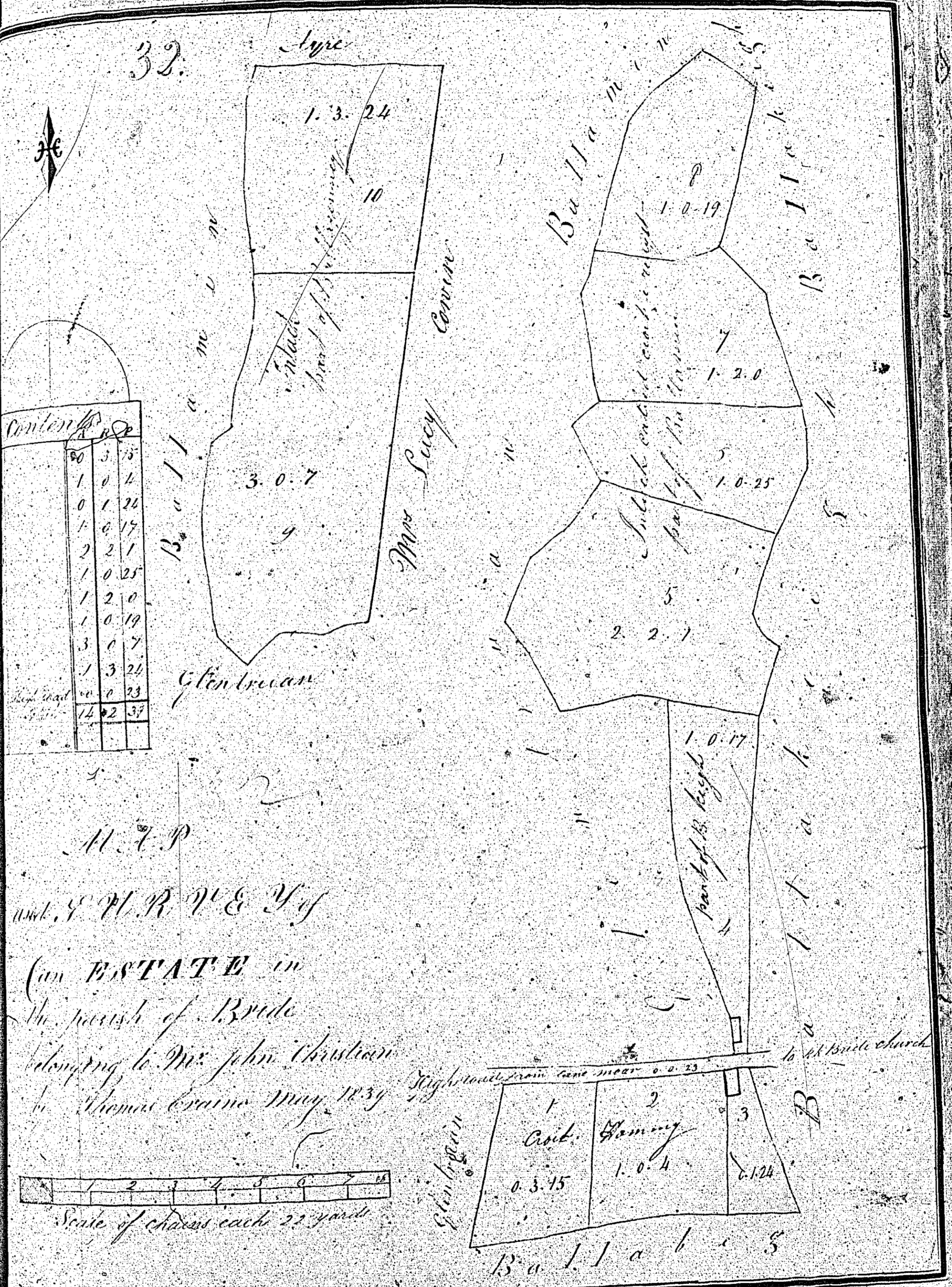

Content	
50	3.75
1	0.4
0	1.22
1	0.15
2	2.1
1	0.25
1	2.0
1	0.19
3	0.7
1	3.24
0	0.23
12	2.37

H. V. P.
 and J. H. R. V. & J. of
 (an ESTATE in
 the parish of Bride
 belonging to Mr. John Christian
 to Thomas Conwin May 1834

Scale of chains each 22 yards

Cont

1	
2	
3	
4	
5	
6	
7	
8	
9	
10	
11	
12	
13	
14	
15	
16	

Proportion of
 Roads

The Parish of Bride
 to the Survey
 of the Conwin

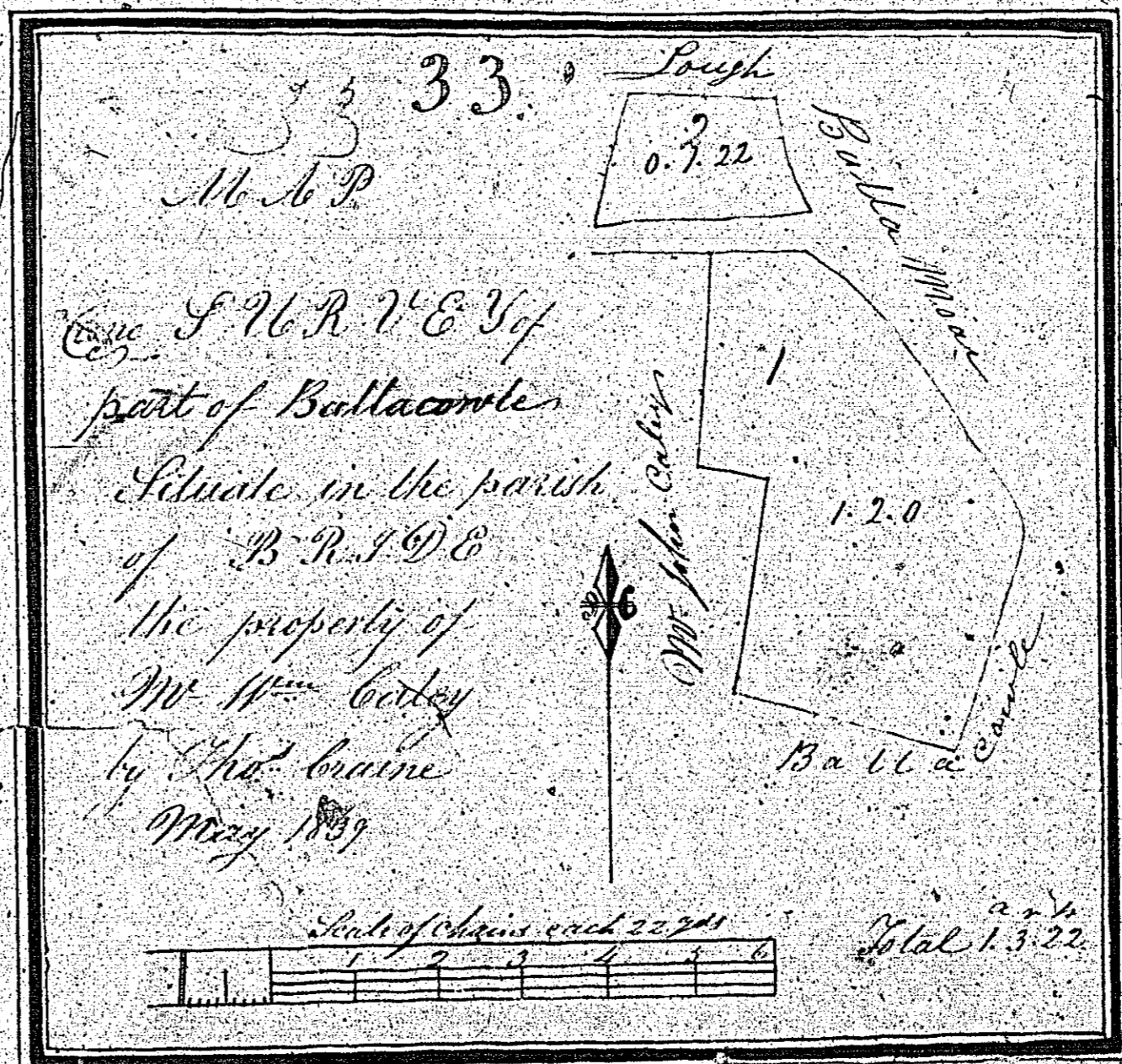

33.
M.A.P.

Case F.W.R. V. E. V. of
part of Ballacoolie
Situate in the parish
of B.R.S.O.C.
the property of
Mr. Wm. Gordon
by Chas. Crane
May 1859

Scale of chains each 20 paces
Total 1.3.22

Cont.

1	
2	
3	
4	
5	
6	
7	
8	
9	
10	
11	
12	
13	
14	
15	
16	

Proportion of
Records

1

111

