

A
 PLAN & SURVEY
 of
BALLA-CALLOW
 in the Parish
 of
BRIDE
 Belonging to
MR. CHRISTIAN

BALLA-CALLOW

D H O O D H O O K E R R O S



Scale

REFERENCES		
N	A	P
1	21	0 7
2	21	0 7
3	21	0 7
4	21	0 7
5	8	2 27
6	8	2 27
7	5	0 39
8	5	1 23
9	5	4 3
10	4	3 16
11	3	1 38
12	6	1 2
13	6	1 6
14	10	2 50
15	4	1 21
16	1	1 1
17	1	1 1
18	1	1 1
19	1	1 1
20	1	1 1

By J. Conolly del.

Wm. Johnston

11.8. 6xder.

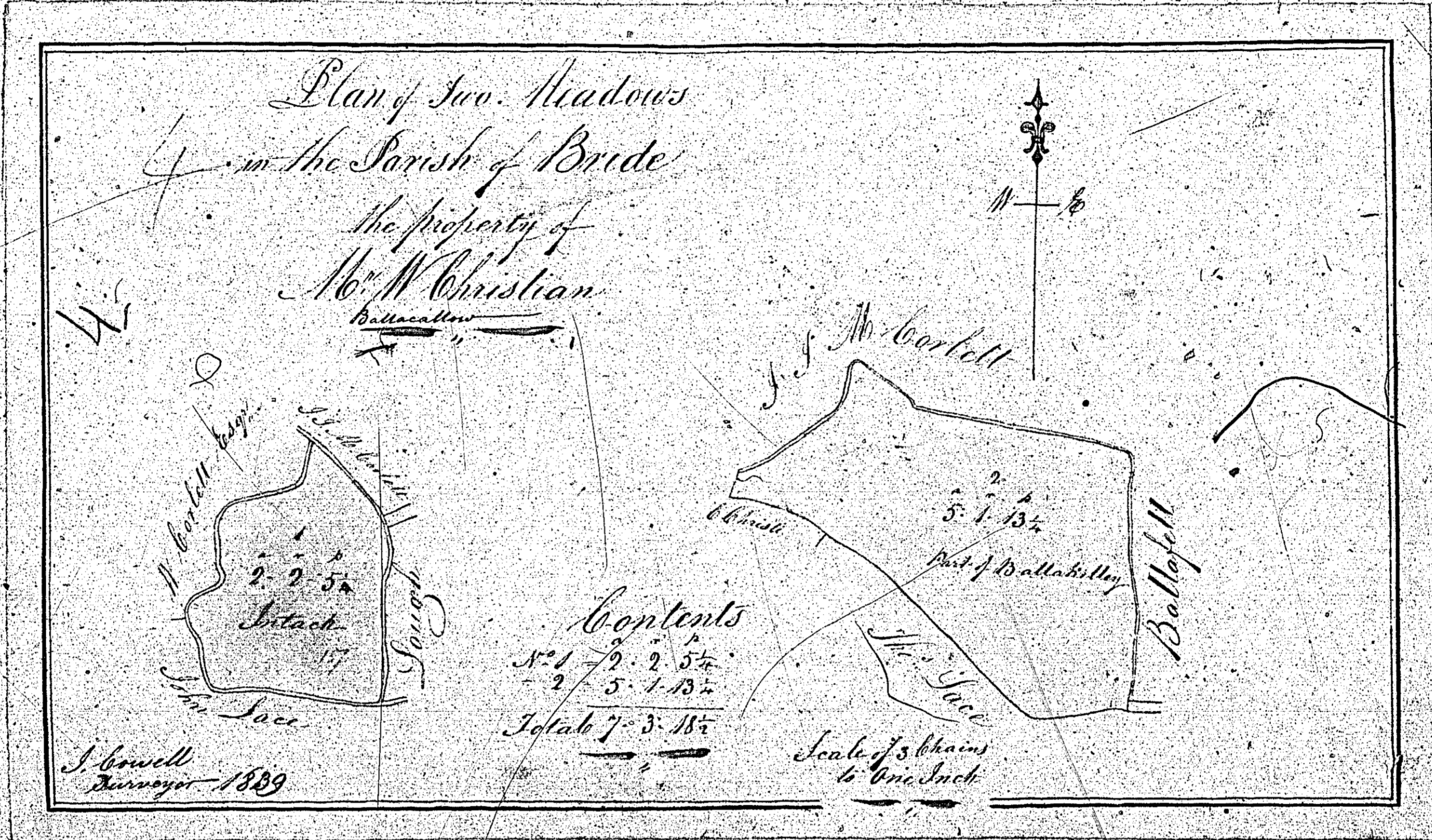

1	0	0
2	0	0
3	0	0
4	0	0
5	0	0
6	0	0
7	0	0
8	0	0
9	0	0
10	0	0
11	0	0
12	0	0
13	0	0
14	0	0
15	0	0
16	0	0
17	0	0
18	0	0
19	0	0
20	0	0
TOTAL	0	0

ISLE OF MAN GOVERNMENT: GENERAL REGISTRY

TITHE PLANS: PARISH OF BRIDE

Original coloured (decorative)

1:30



8
5



5

PLAN
Belle-Isle, Plan N° 62
Est Property of
Monsieur de
L'Equipe, 1712. L'Equipe Plan

Monsieur de L'Equipe

This plan is in the possession of Monsieur de L'Equipe

19	6	23
20	2	9
21	0	2
22	0	15
23	0	15
24	0	15
TOTAL	23	210

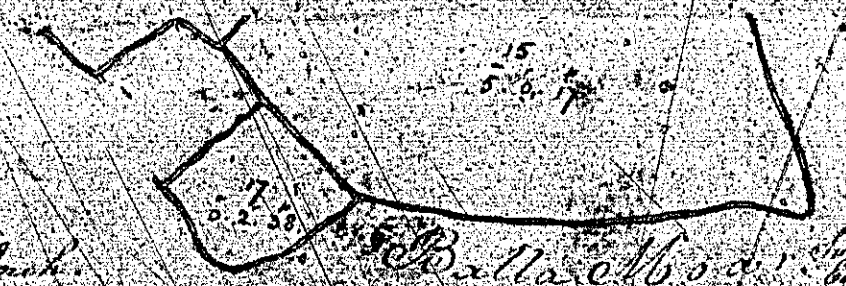

Belle-Isle, Plan N° 62

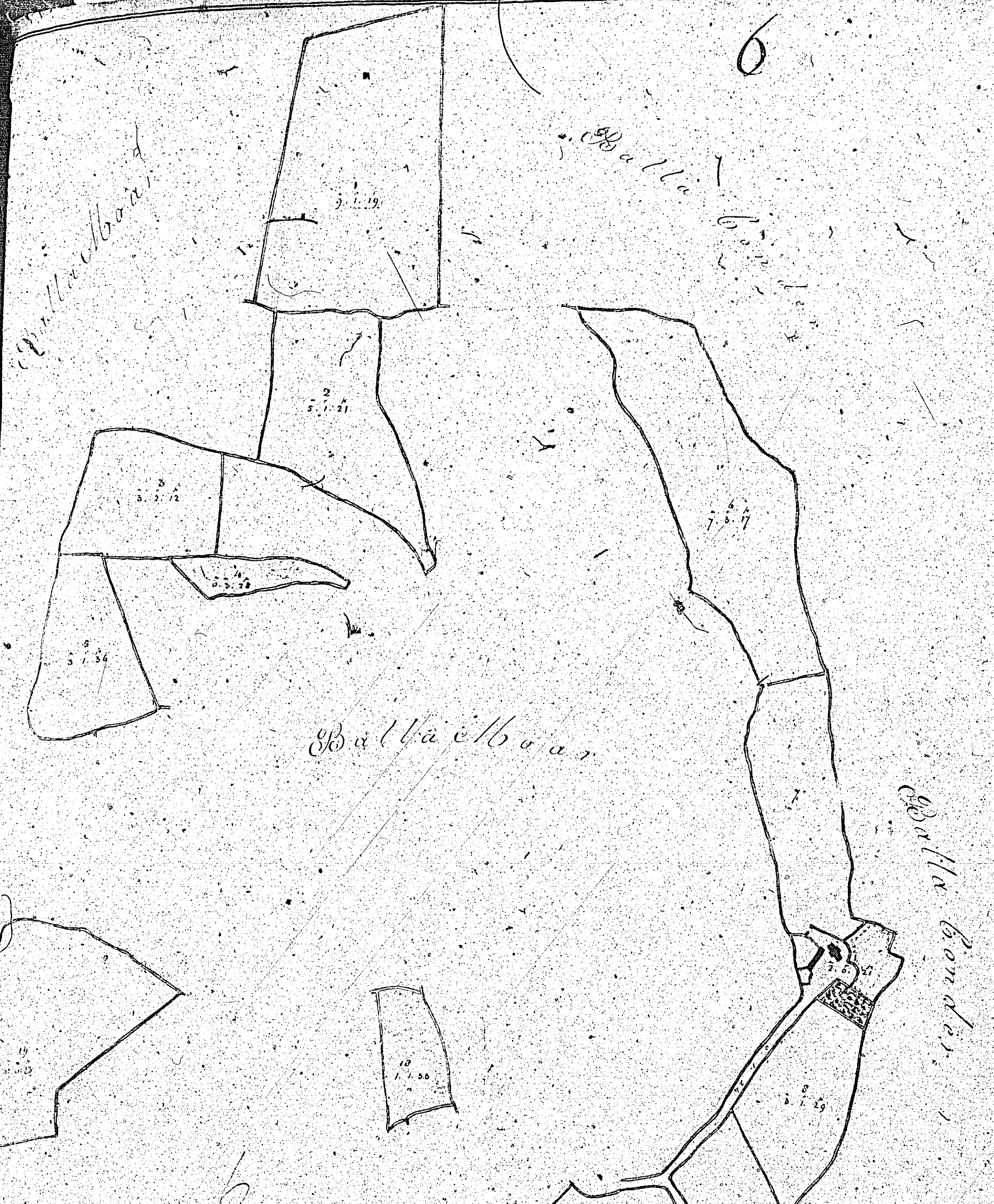

PLAN
OF
BALLA FAILLE
in the Parish of
BRIDE
the property of
William Christian

REFERENCE		
N ^o .	A	R P
1	9	1 19
2	5	1 21
3	3	2 12
4	0	3 20
5	3	1 36
6	7	3 17
7	4	0 27
8	3	1 29
9	3	2 26
10	3	1 0
11	6	0 4
12	4	2 26
13	2	2 31
14	4	3 9
15	3	0 7
16	1	1 5
17	0	2 30
18	1	1 38
19	6	0 23
20	2	1 9
21	2	0 21
22	1	1 10
23	0	2 4
24	2	1 10
TOTAL	83	2 10

Balla Gonaiguan

Balla Gonaiguan

Scale of One Inch to a Rod

Wm Christian

PLAN
of
Balla-Kilmain
The Property of
Alfred Green
1849
Copied from Charles Kelly's Plan

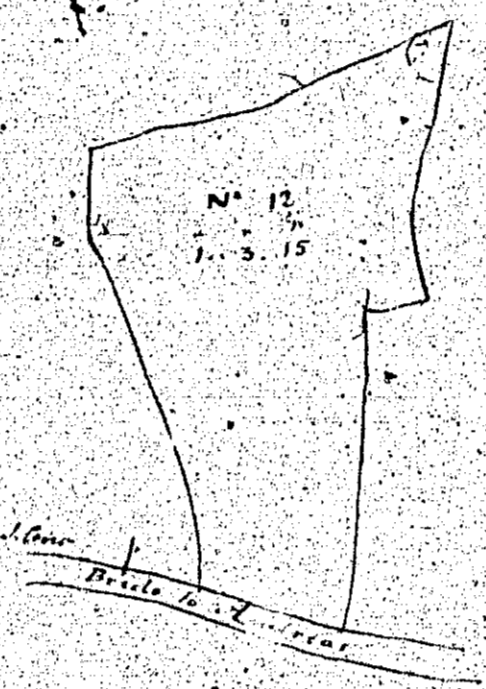

ISLE OF MAN GOVERNMENT: GENERAL REGISTRY

TITHE PLANS: PARISH OF BRIDE

Original monotone

1:30

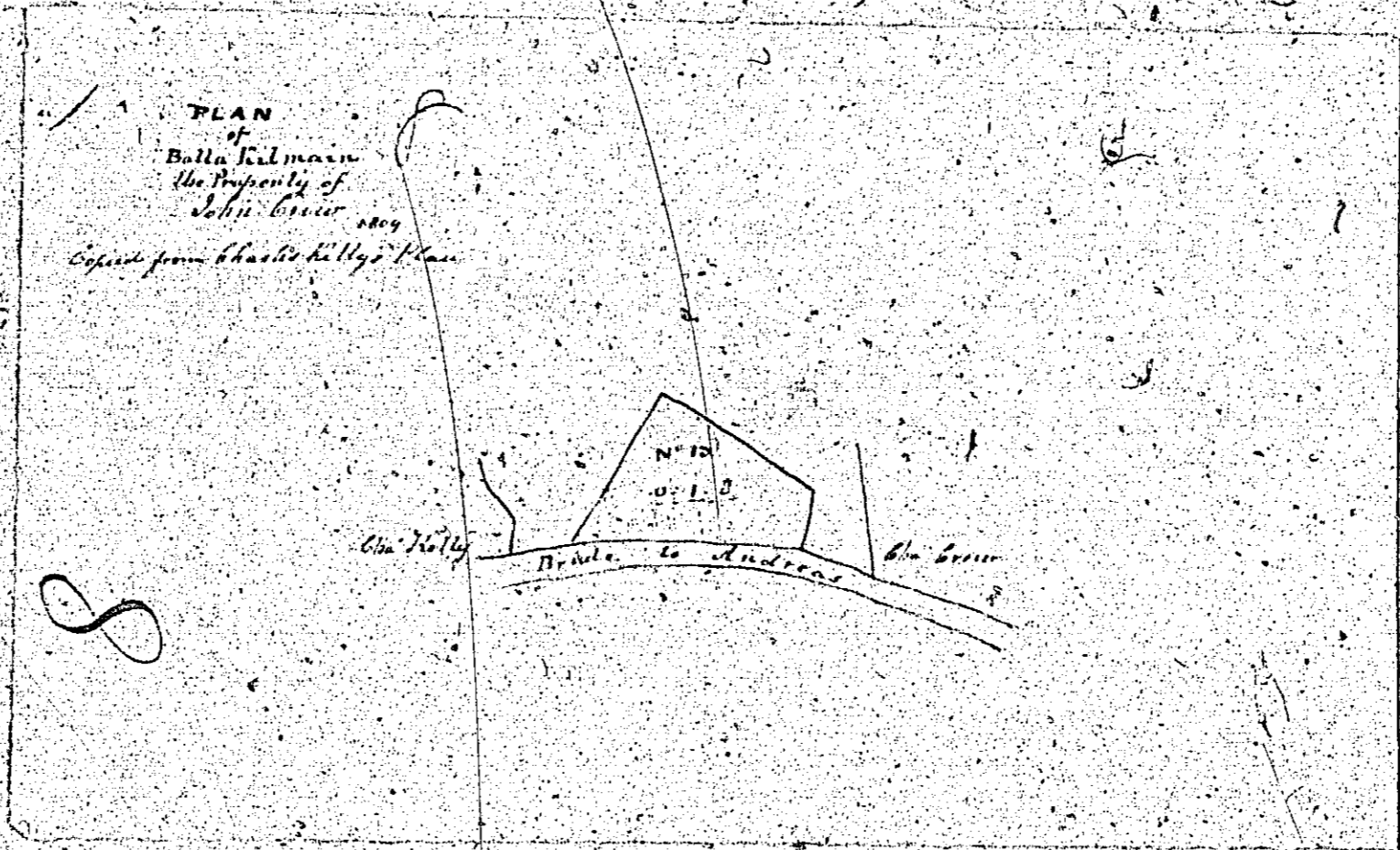

ISLE OF MAN GOVERNMENT: GENERAL REGISTRY

TITHE PLANS: PARISH OF BRIDE

Original monotone

1:30