

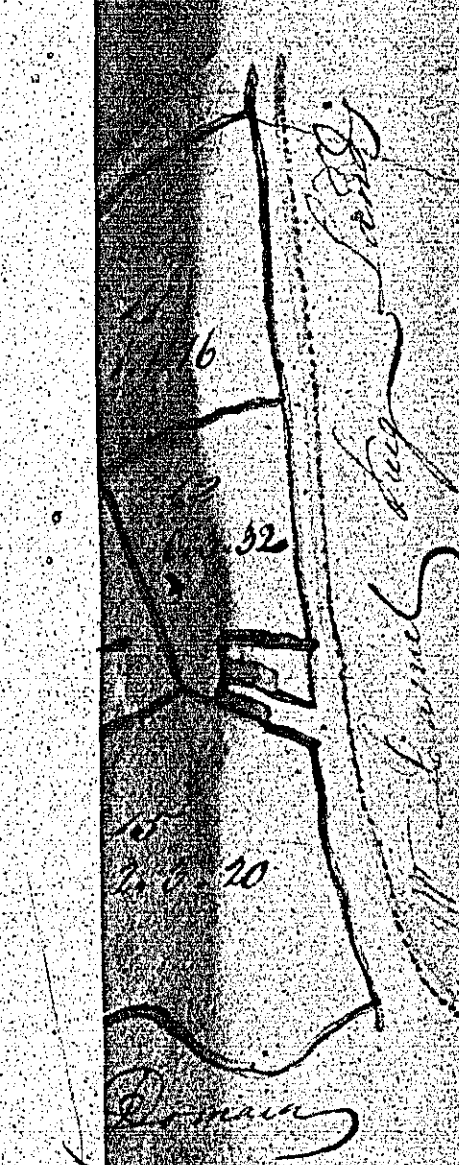

*Handwritten scribbles*

The two following plans are  
both numbered 187





PLAN  
 and  
**BALLAMOORE QUARTER LAND**  
 AND INTACKS, THE PROPERTY OF  
**MR WM STEPHEN**  
 BALLAUGH

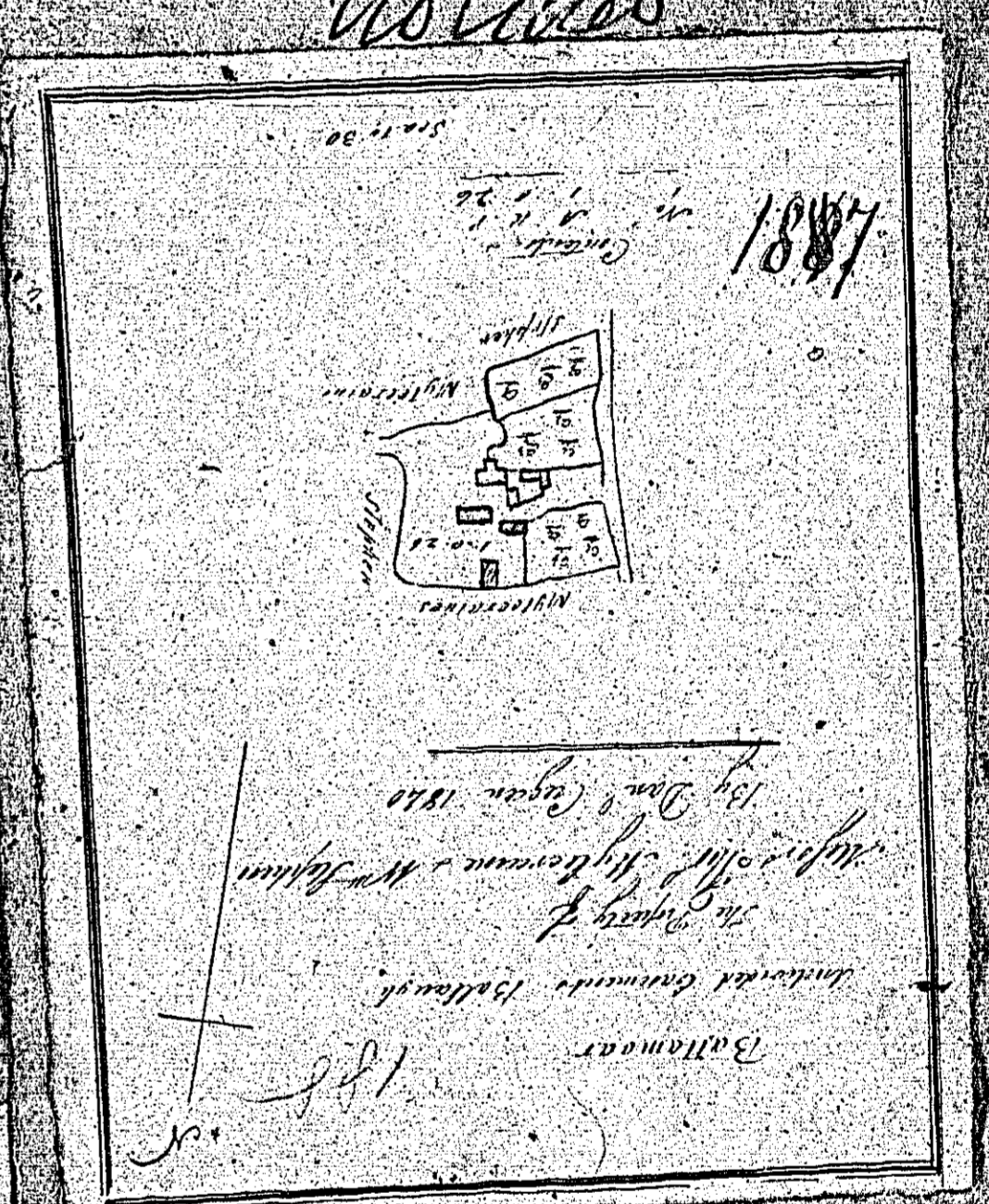
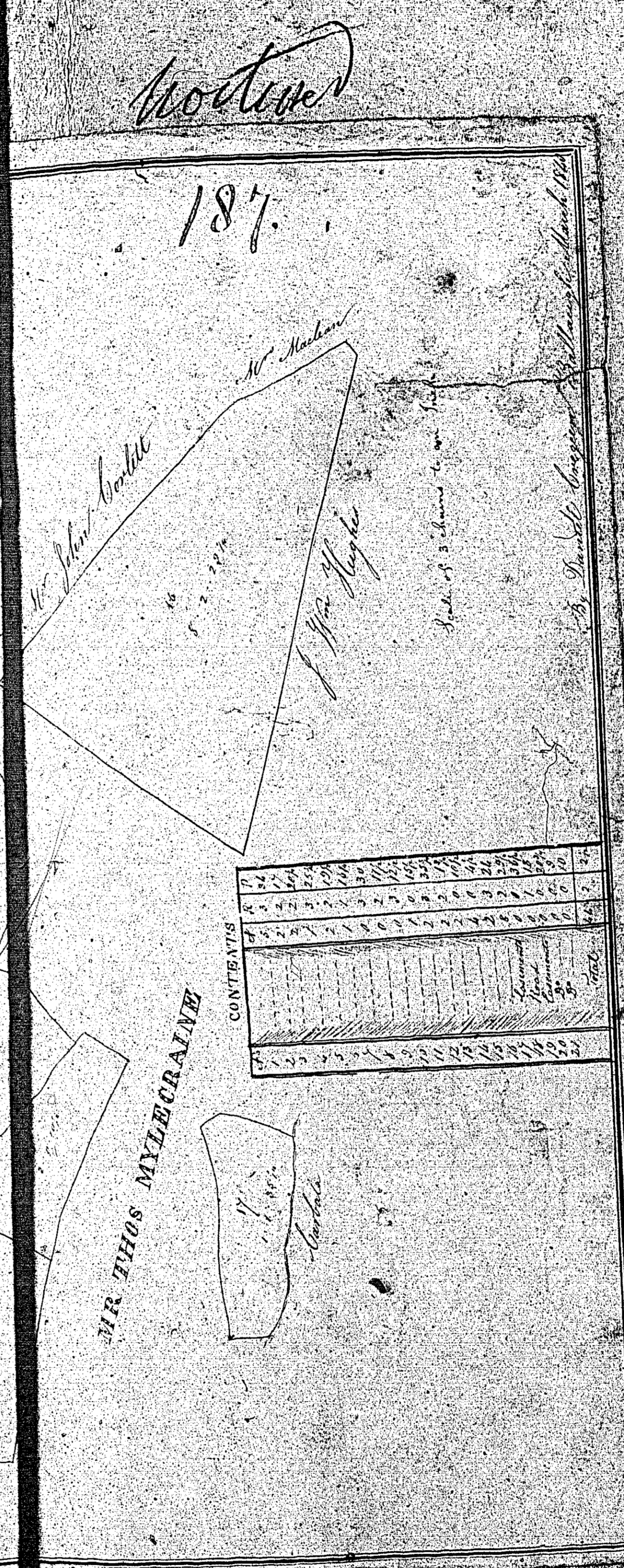



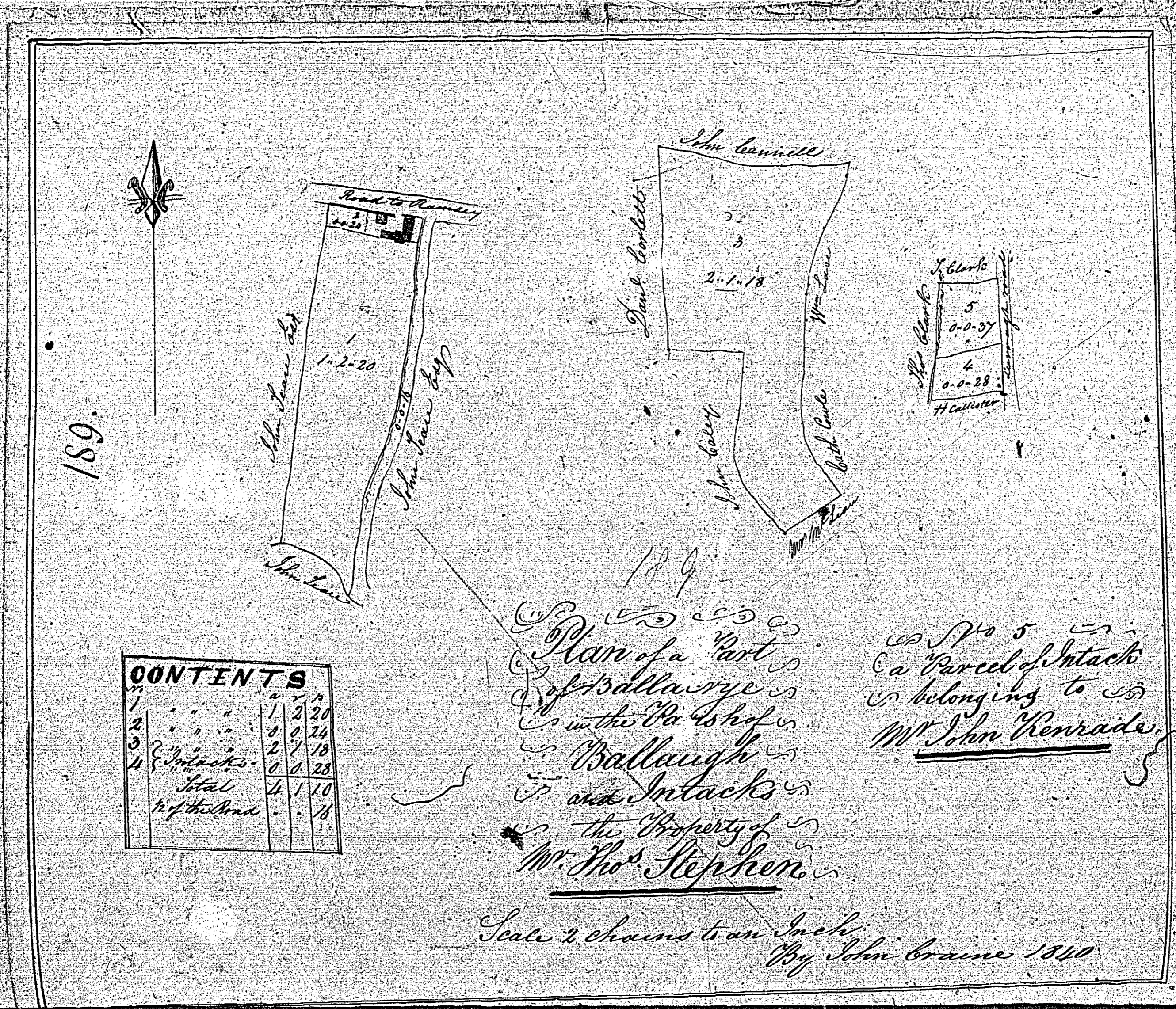
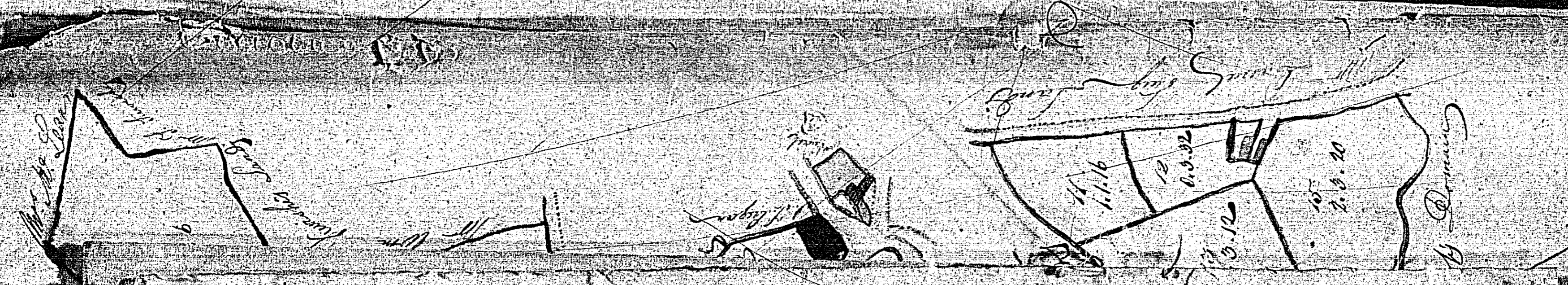

ISLE OF MAN GOVERNMENT: GENERAL REGISTRY  
 TITHE PLANS: PARISH OF BALLAUGH  
 Original monotone 1:30

190.



Mr. St. Lawrence Land

13.3.2  
1.2.34.2  
13.31

A Plan and Survey of

a part of  
Dollaghbeg and Carradillbeg 1870  
Situate in the parish of

B. A. L. S. A. 26. G. 36

the property of  
Mr. John Stephen  
by Mr. Curran June 1879

138  
13  
13.3.39

12  
11  
11.1.16  
12  
13.3.32

Mr. John Curran Land

11.2.0.32

11.2.1.12

11.2.2.26

11.2.2.26

11.2.2.26

11.2.2.26

11.2.2.26

11.2.2.26

11.2.2.26

11.2.2.26

11.2.2.26

11.2.2.26

11.2.2.26

11.2.2.26

11.2.2.26

Mr. Wm. D. ...

13.3.2

13.31

13.3.2

13.3.2

13.3.2

13.3.2

13.3.2

13.3.2

13.3.2