

A Plan and Survey
of Close Taggart in the
parish of Ballaugh
the property of
John Mullanaraine
taken April 21st 1840
by Robert Hornish

Contents

164.

No.	A.	R.	P.
1	5	3	53
2	2	1	25
3	1	1	12
4	2	5	8
5	1	3	9
6	1	0	14
7	1	0	21
8	1	2	24
Garden & Enclosure	0	2	14
9	1	1	30
Total	18	0	27

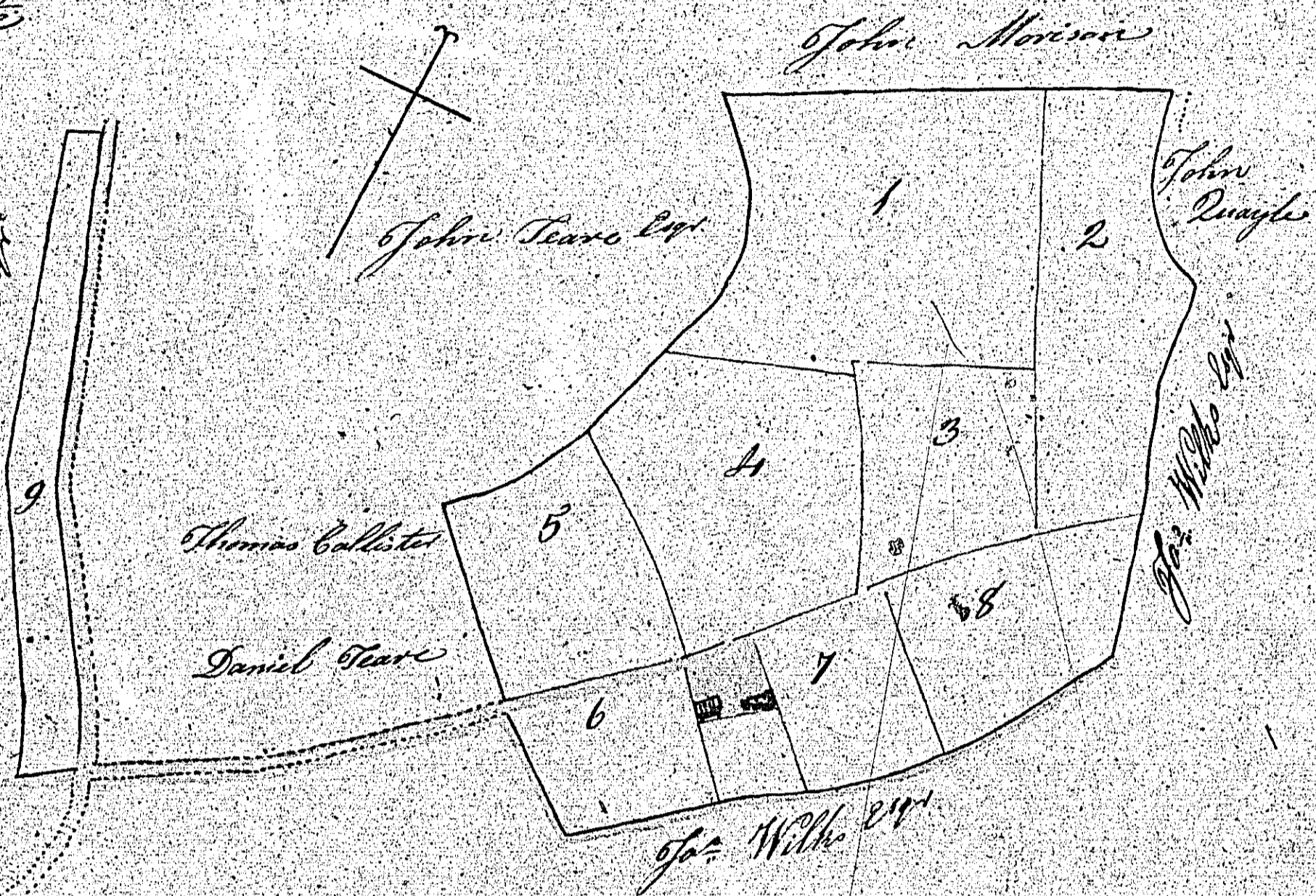

Examined
at the Parish
A. H. L.
1840

A Scale of 3 Chains to an Inch

ISLE OF MAN GOVERNMENT: GENERAL REGISTRY

TITHE PLANS: PARISH OF BALLAUGH

Original coloured

1:30

163

BALLACOOLEY QUARTERLAND and an INTACK

SITUATE IN BALLAUGH

THE PROPERTY OF

M^r JOHN MYLREA

D. Crockett and J. Cairns 1840.

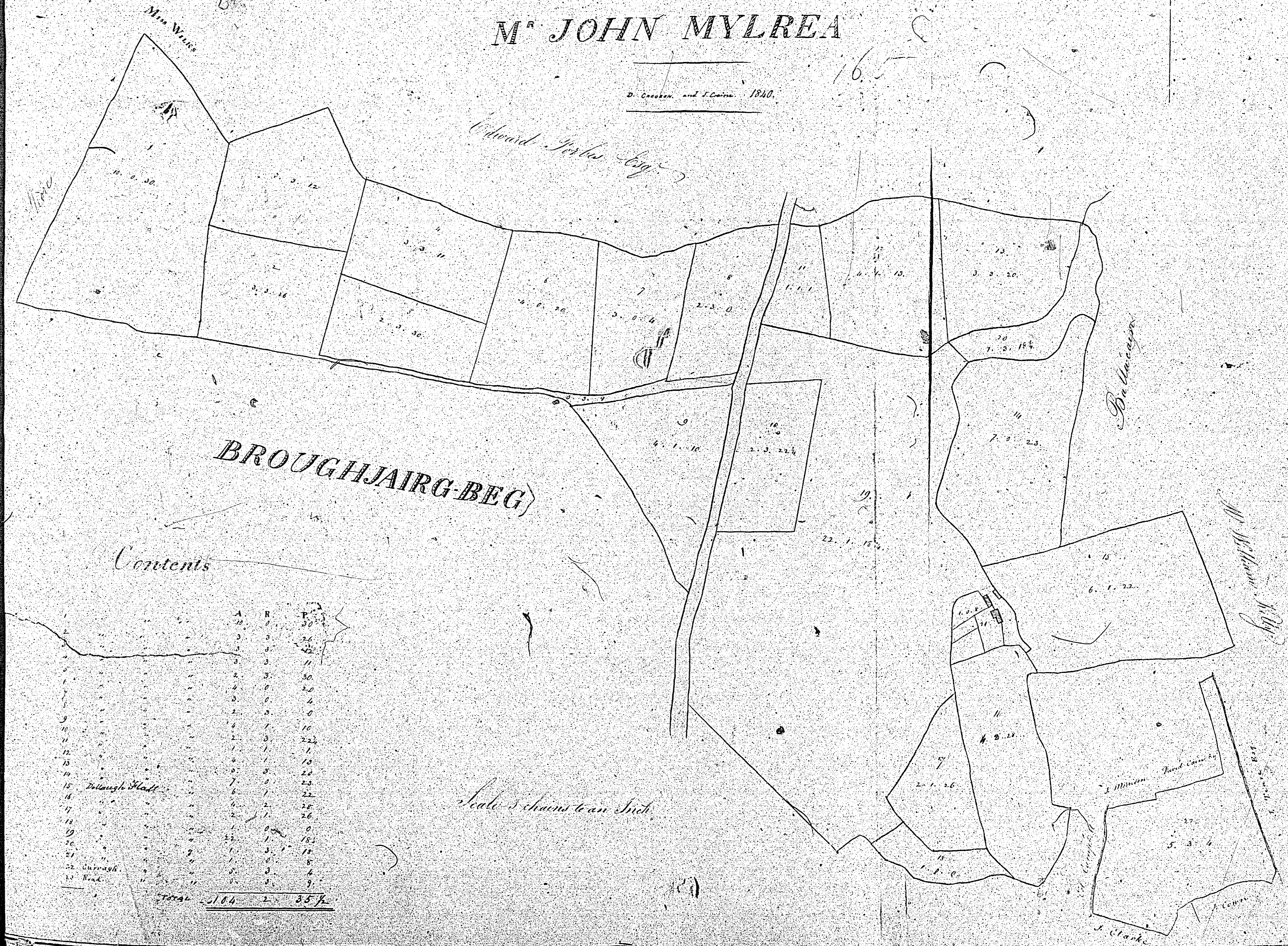

BROUGHJAIRG-BEG

Contents

	A	R	P
1	1	0	0
2	1	0	0
3	1	0	0
4	1	0	0
5	1	0	0
6	1	0	0
7	1	0	0
8	1	0	0
9	1	0	0
10	1	0	0
11	1	0	0
12	1	0	0
13	1	0	0
14	1	0	0
15	1	0	0
16	1	0	0
17	1	0	0
18	1	0	0
19	1	0	0
20	1	0	0
21	1	0	0
22	1	0	0
23	1	0	0
24	1	0	0
25	1	0	0
26	1	0	0
27	1	0	0
28	1	0	0
29	1	0	0
30	1	0	0
31	1	0	0
32	1	0	0
33	1	0	0
34	1	0	0
35	1	0	0
36	1	0	0
37	1	0	0
38	1	0	0
39	1	0	0
40	1	0	0
41	1	0	0
42	1	0	0
43	1	0	0
44	1	0	0
45	1	0	0
46	1	0	0
47	1	0	0
48	1	0	0
49	1	0	0
50	1	0	0
51	1	0	0
52	1	0	0
53	1	0	0
54	1	0	0
55	1	0	0
56	1	0	0
57	1	0	0
58	1	0	0
59	1	0	0
60	1	0	0
61	1	0	0
62	1	0	0
63	1	0	0
64	1	0	0
65	1	0	0
66	1	0	0
67	1	0	0
68	1	0	0
69	1	0	0
70	1	0	0
71	1	0	0
72	1	0	0
73	1	0	0
74	1	0	0
75	1	0	0
76	1	0	0
77	1	0	0
78	1	0	0
79	1	0	0
80	1	0	0
81	1	0	0
82	1	0	0
83	1	0	0
84	1	0	0
85	1	0	0
86	1	0	0
87	1	0	0
88	1	0	0
89	1	0	0
90	1	0	0
91	1	0	0
92	1	0	0
93	1	0	0
94	1	0	0
95	1	0	0
96	1	0	0
97	1	0	0
98	1	0	0
99	1	0	0
100	1	0	0
Total	100	0	0

Scale 5 chains to an Inch.

A
 Plan of Mr. John Nelson's
 Working Courtyard in
 Ballinagh
 Containing 14 1/2 A.

166

At public Auction 6 Feb'y 1853 -
 Between James Keefe Plaintiff and
 James Nelson - Defendant
 Exhibited to John Lowell a
 Witness produced and referred to
 in his Deposition
 Before me -
 J. W. [Signature]

North
 Robert Corbett

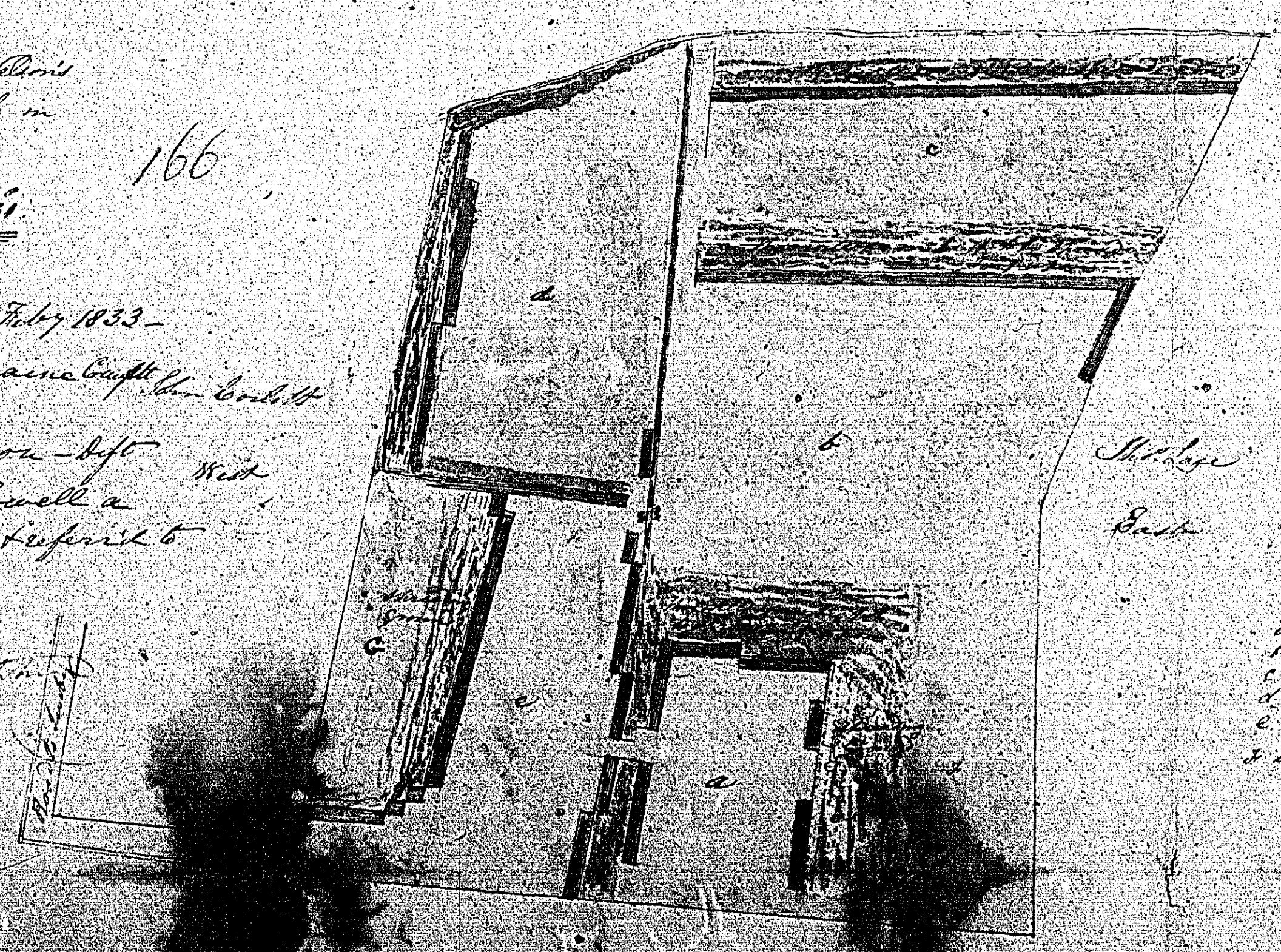

North
 East

Remarks
 a 46 by 28
 b 30 by 50
 c 50 by 22
 d 66 by 37
 e 74 by 24
 & william be for with of [unclear]

166

By John Lowell Surveyor
 14 1/2 1853

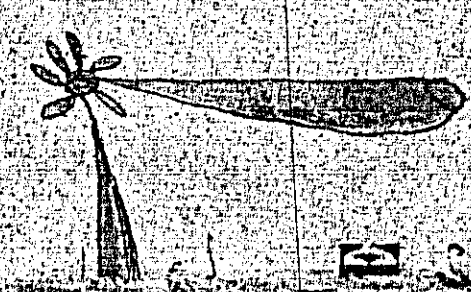

1839

A Plan & Survey of a Piece of Uncultivated Land in the Parish of Ballaugh, the Property of Mr. Patrick Nelson

167.

Scale 3 chains to an Inch

168.

INTACK LANDS

Ballaugh

BELONGING TO

MR WM QUAYLE

By Daniel Crockett 1842

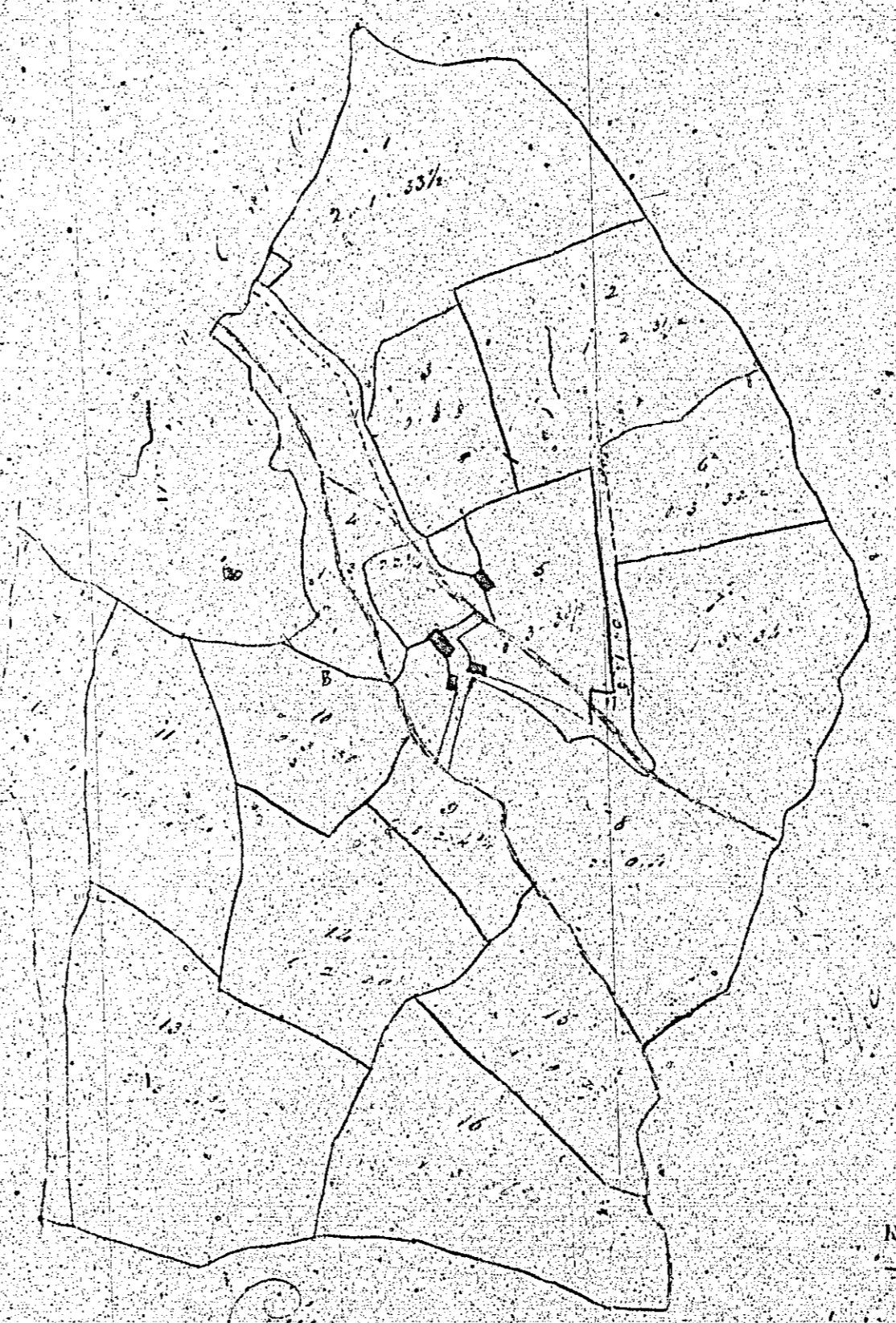

Reference

No.	Acres	sq. Rds.	sq. Poles
1	2	7	25 1/2
2	2	1	54 1/2
3	0	4	8
4	5	1	22 1/2
5	0	3	30 1/2
6	0	3	32 1/2
7	1	3	34
8	2	1	1
9	3	2	46
10	0	3	32
11	1	2	7 1/2
12	1	2	27
13	8	3	31
14	1	2	20
15	1	4	27
16	1	3	36
17	2	1	5
18	2	7	33

Scale 30

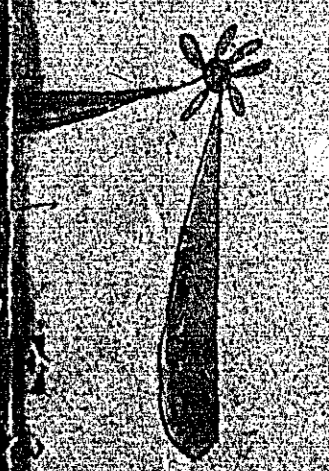
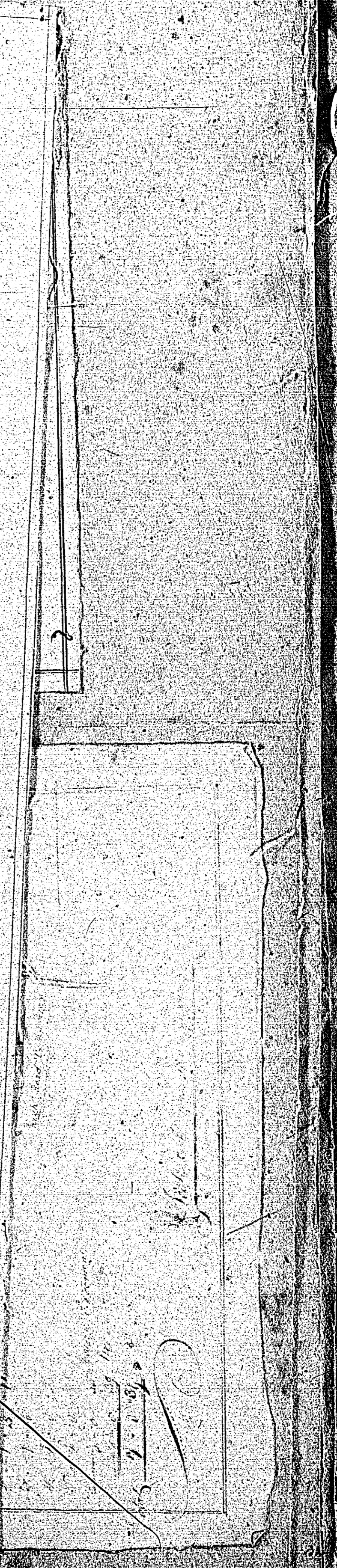

ISLE OF MAN GOVERNMENT: GENERAL REGISTRY

TITHE PLANS: PARISH OF BALLAUGH

1.30

169 Original coloured (decorative), faint

170 Original coloured (decorative)

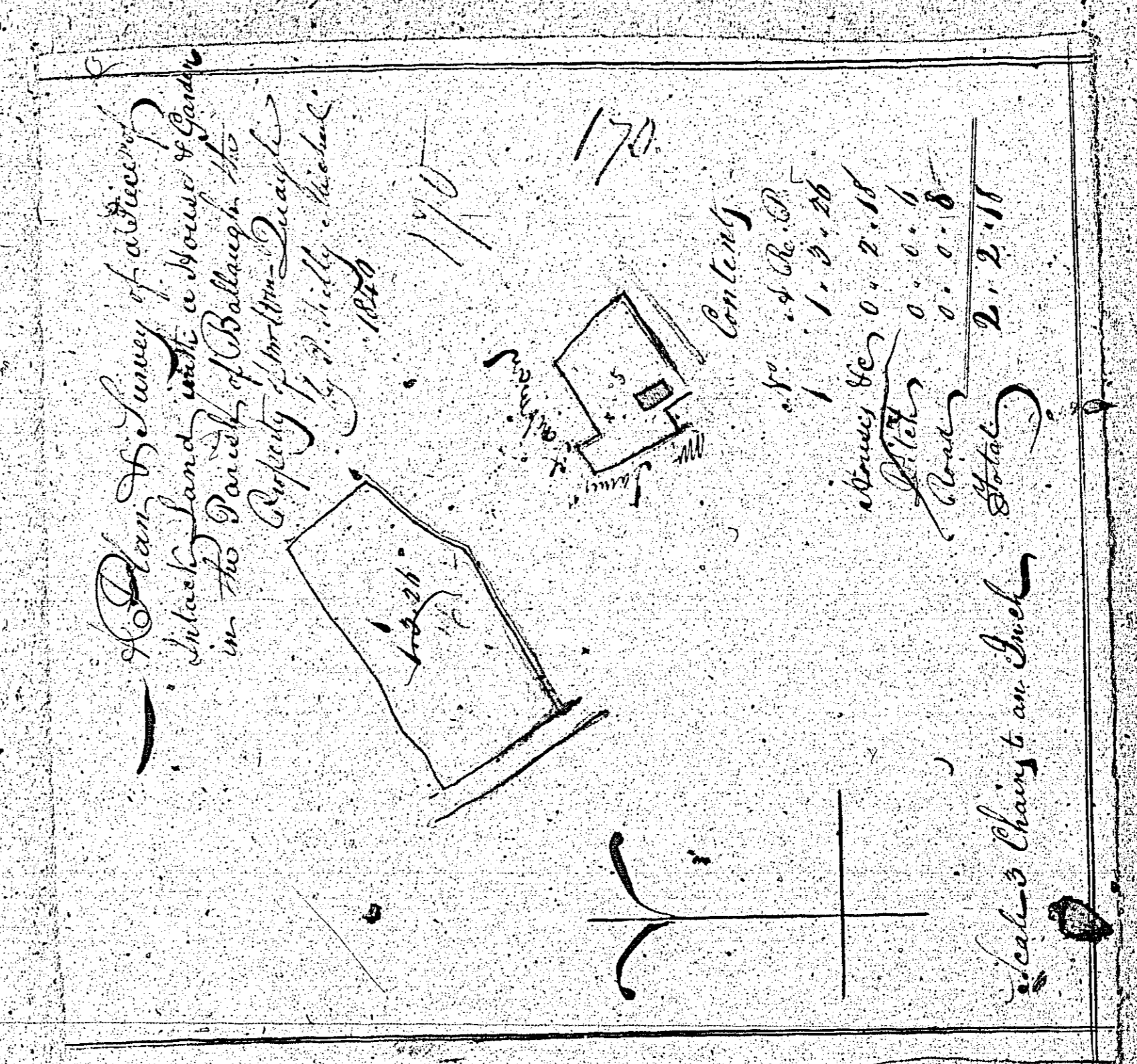

1856