

Not used

Plan of a parcel of Land
in the Parish of Ballough
the property of
Mr. J. Morrison

156

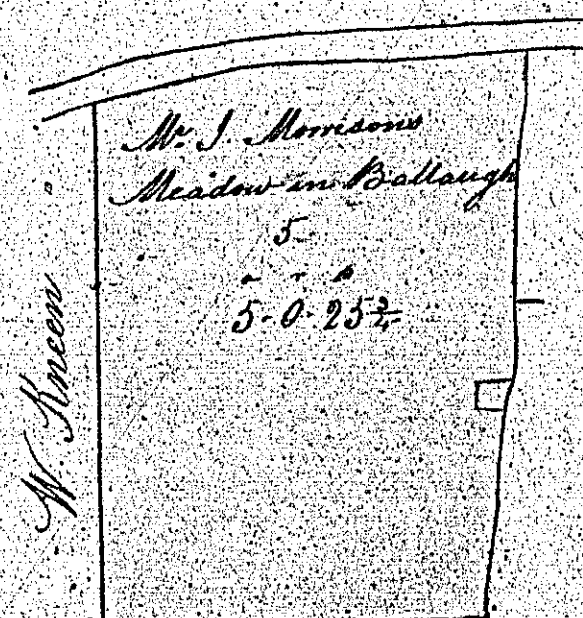
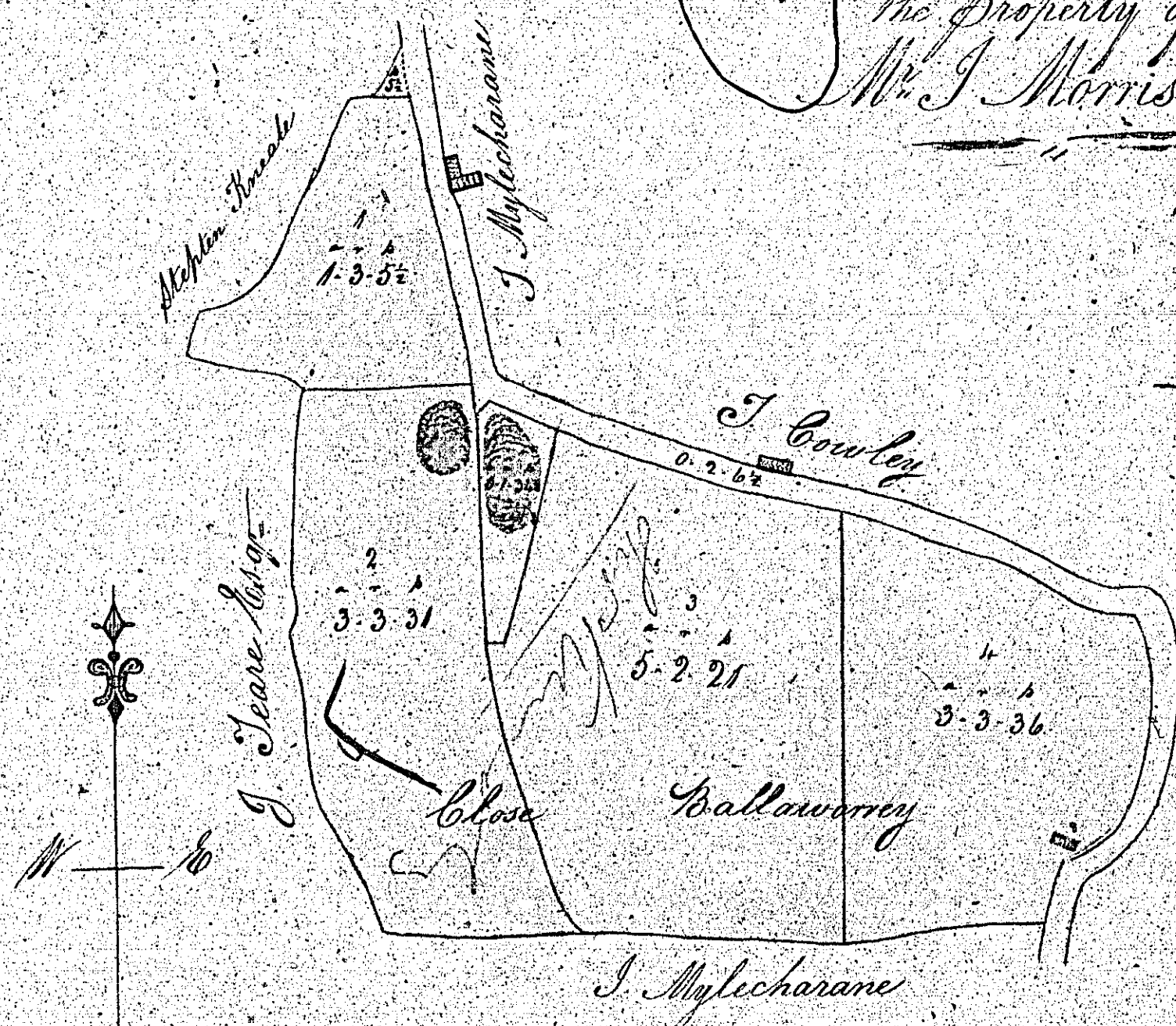

Scale of 3 chains
to One Inch

Contents

	A	R	P
1	1	3	51
2	3	3	31
3	5	2	21
4	3	3	36
5	5	0	25 1/2
Fields	20	1	39
basements	0	2	0
Road	0	2	6 1/2
Total	21	2	53 1/2

J. Cowell
Surveyor 1840

St. John's
18th Dec 1841

ISLE OF MAN GOVERNMENT: GENERAL REGISTRY
TITHE PLANS: PARISH OF BALLAUGH

1.30

- 157 Original coloured (decorative)
- 158 Original monotone
- 159 Original monotone

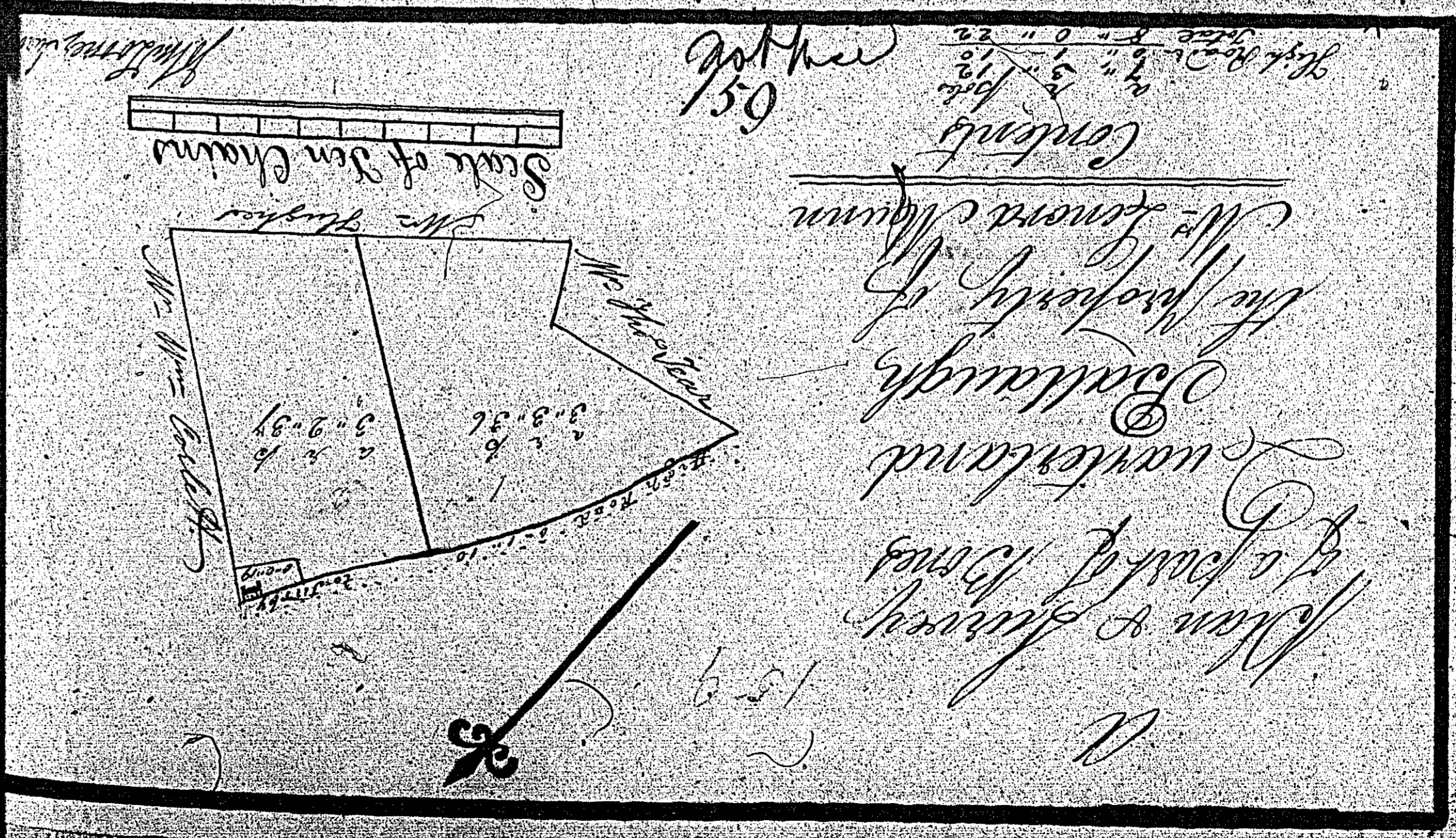
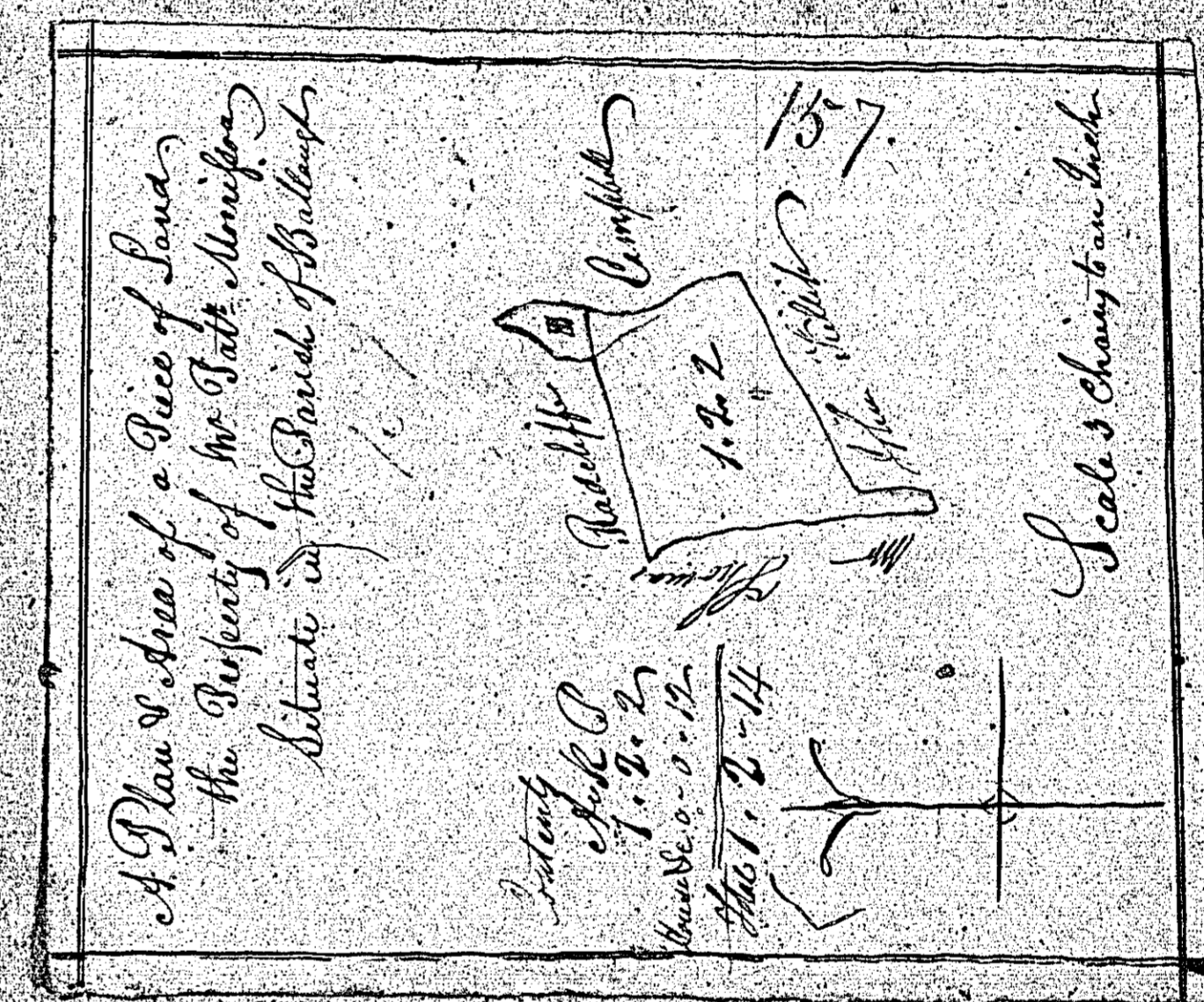
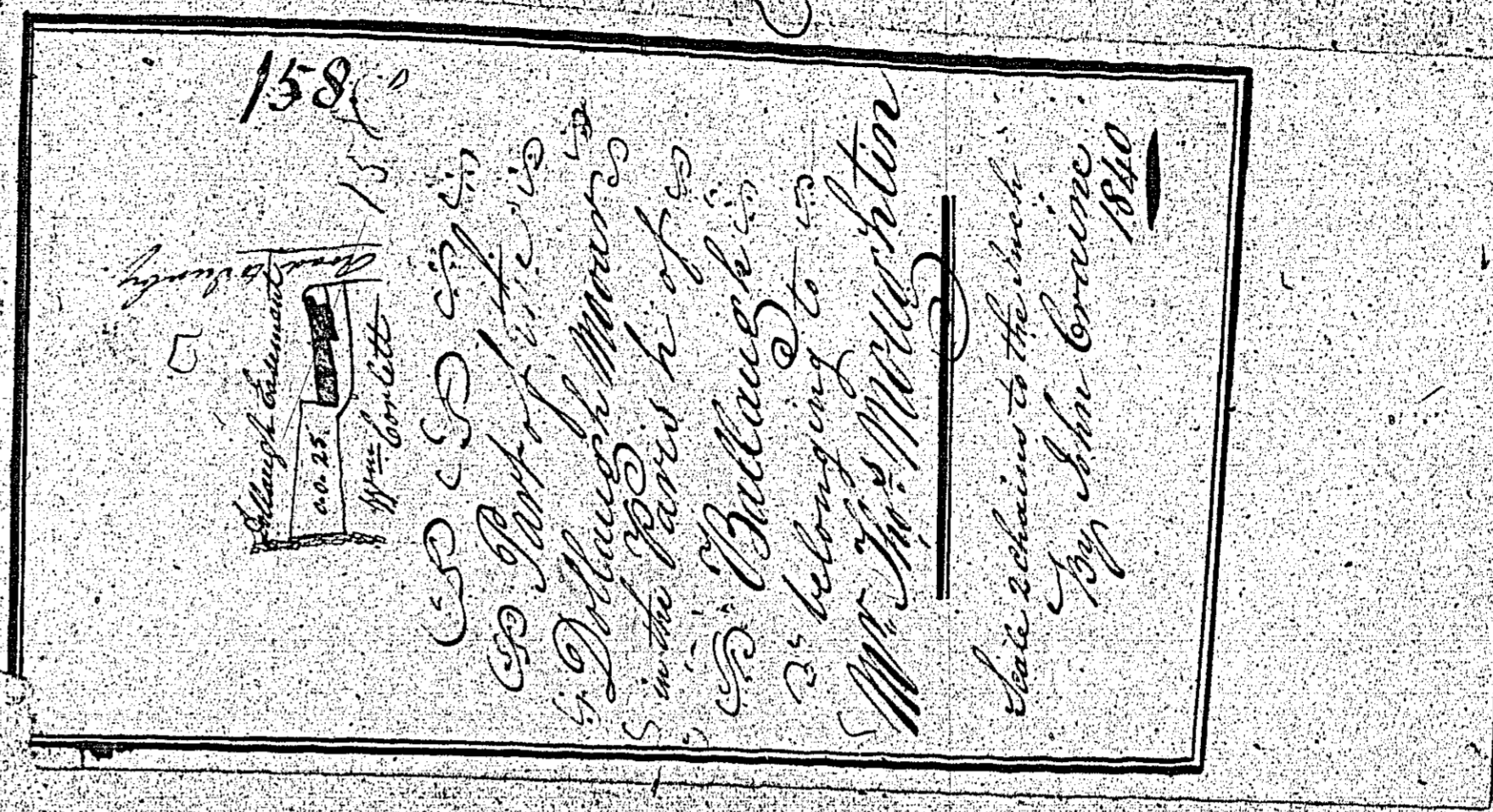

160.

SURVEY OF PART OF

Garmodill

Situate in Ballisish. The Property of

Mr Patrick McKeown - Quaterland - Antick

160

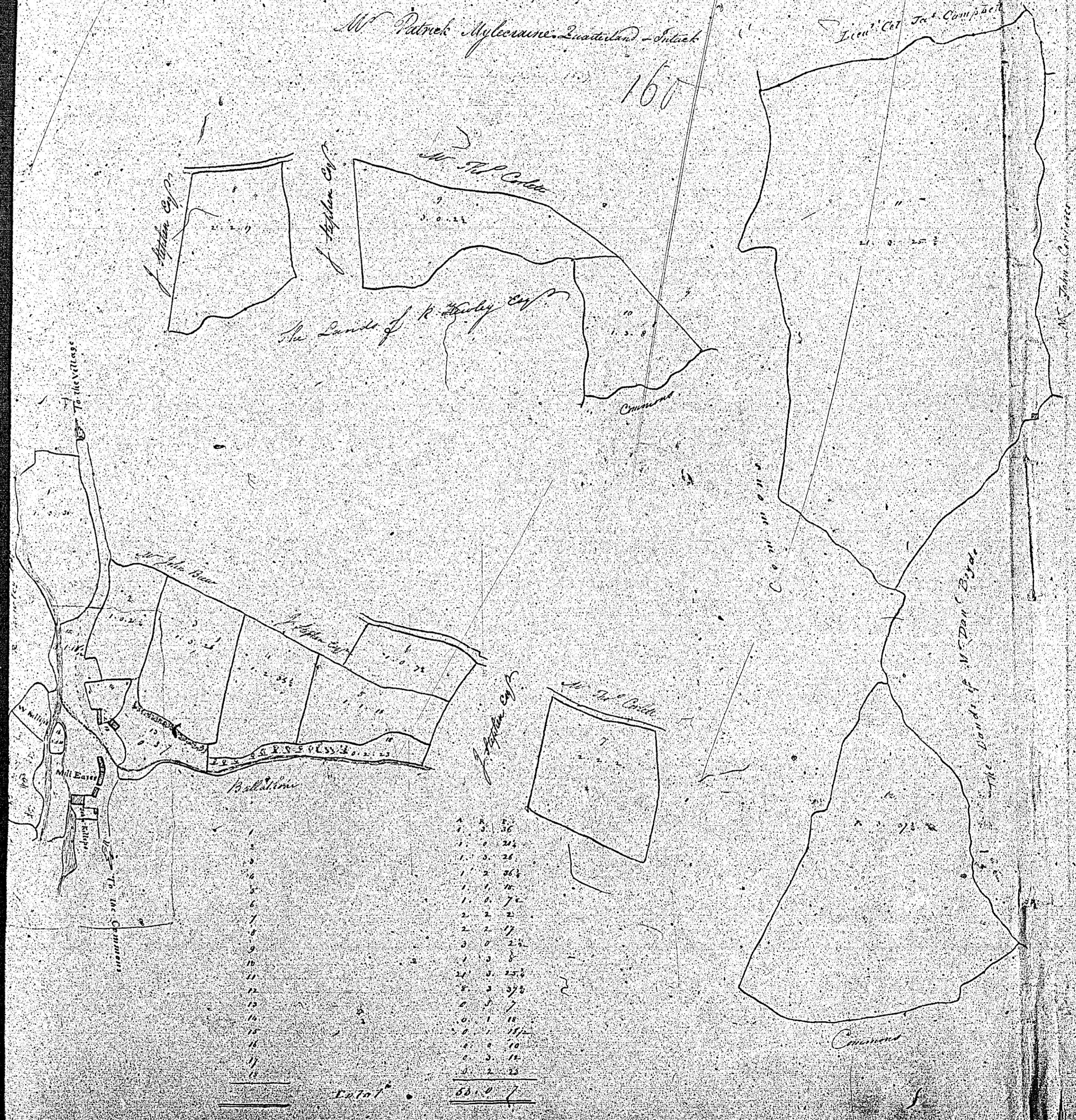

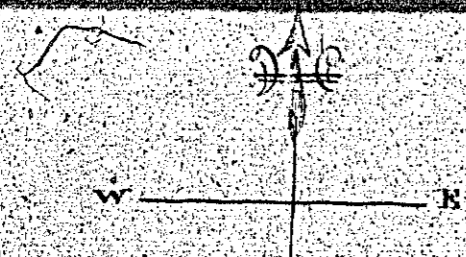

PLAN AND SURVEY OF
 PART OF BALLAMOR BALLAUGH
 Quarterland & Inland
 The Property of
 Mr. Thomas Myloraine

Mr John Corlett

161

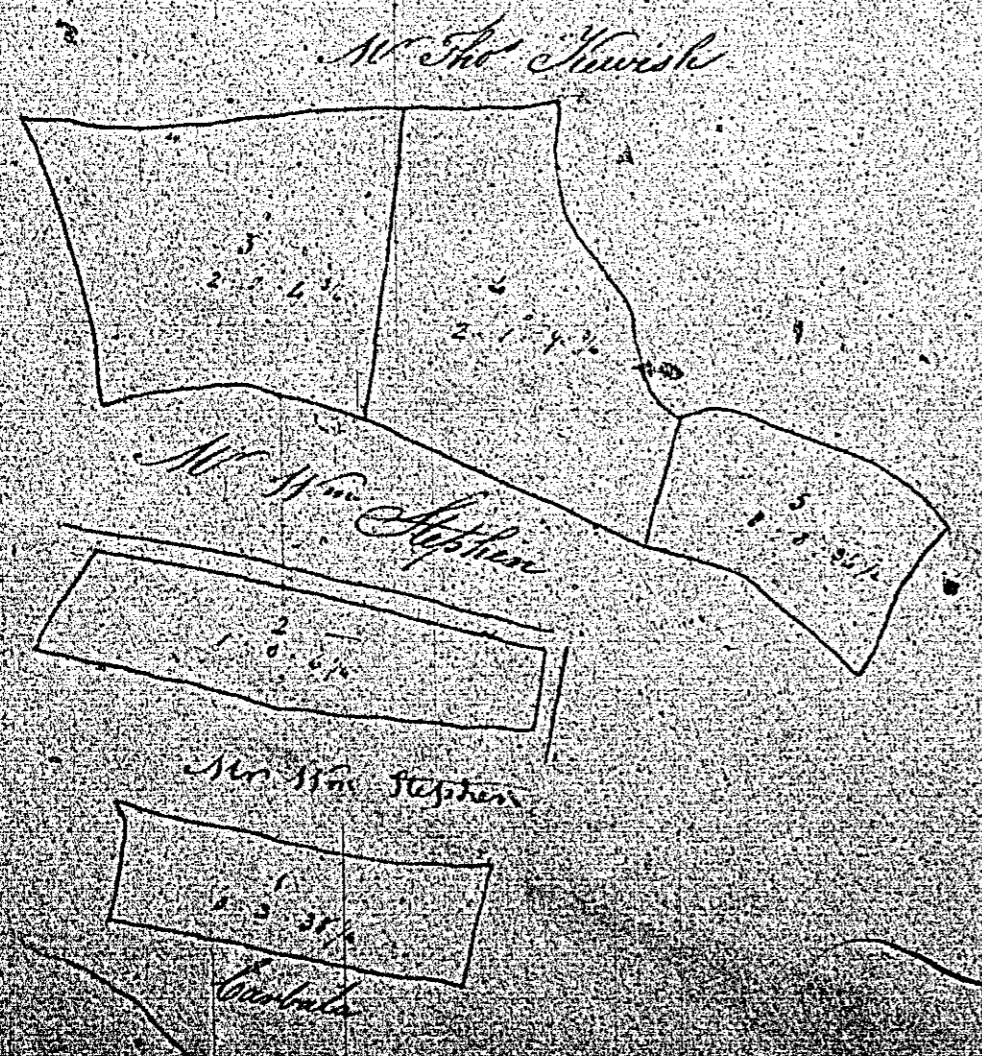
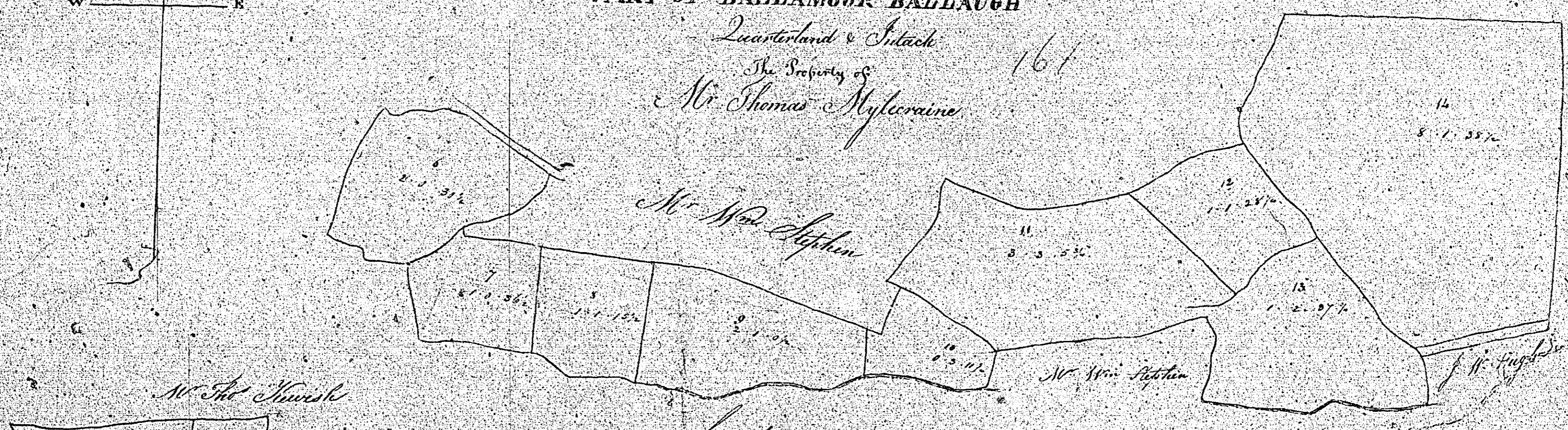

Scale of 3 chains to an inch

CONTENTS

No.	Acres	R.	P.
1	5	5	5
2	1	1	1
3	1	1	1
4	1	1	1
5	1	1	1
6	1	1	1
7	1	1	1
8	1	1	1
9	1	1	1
10	1	1	1
11	1	1	1
12	1	1	1
13	1	1	1
14	1	1	1
Total	50	2	1

161

By Daniel Croghan, Ballamoor, March 1850

No. 102

A Plan and survey of A part of
Court chaddagh in the parish of
Ballaugh the property of M^r Mary
Mullecharrine taken April 22nd 1840
By James Harrisk

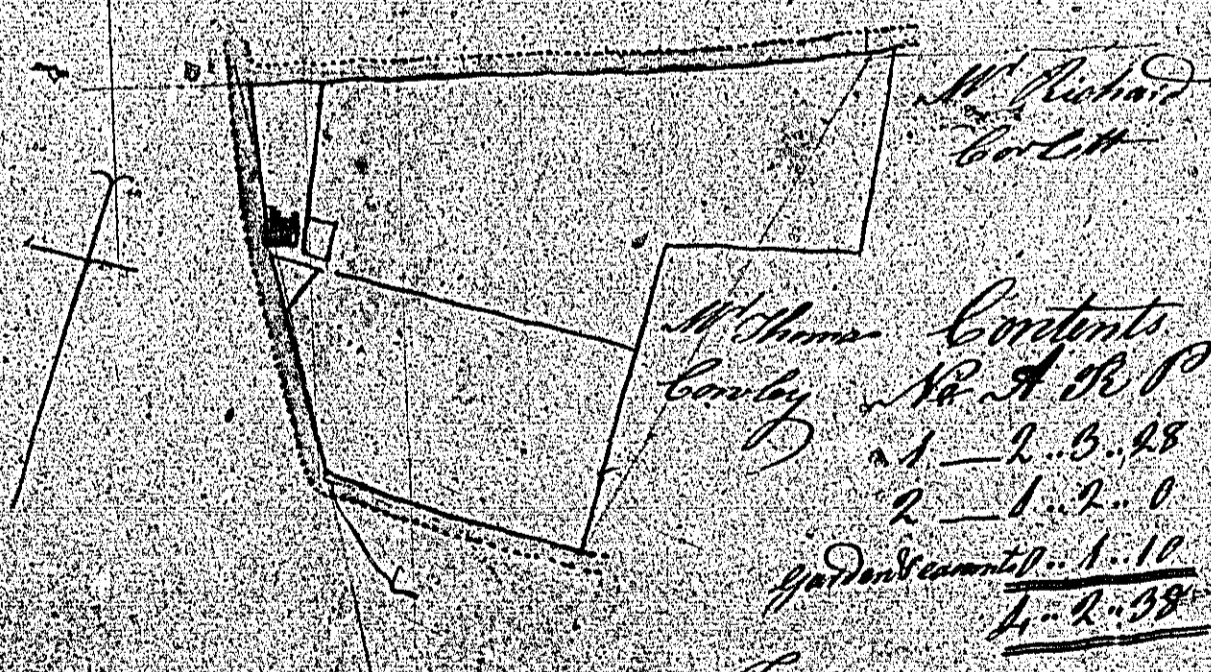

A scale of 1 chain to an Inch

Contents

1	1.3.31
2	1.2.27
3	2.3.23
4	1.3.1
5	0.3.11
6	3.1.9
7	0.2.31
	12.2.17
8 Casements	0.2.11
Total	13.3.28

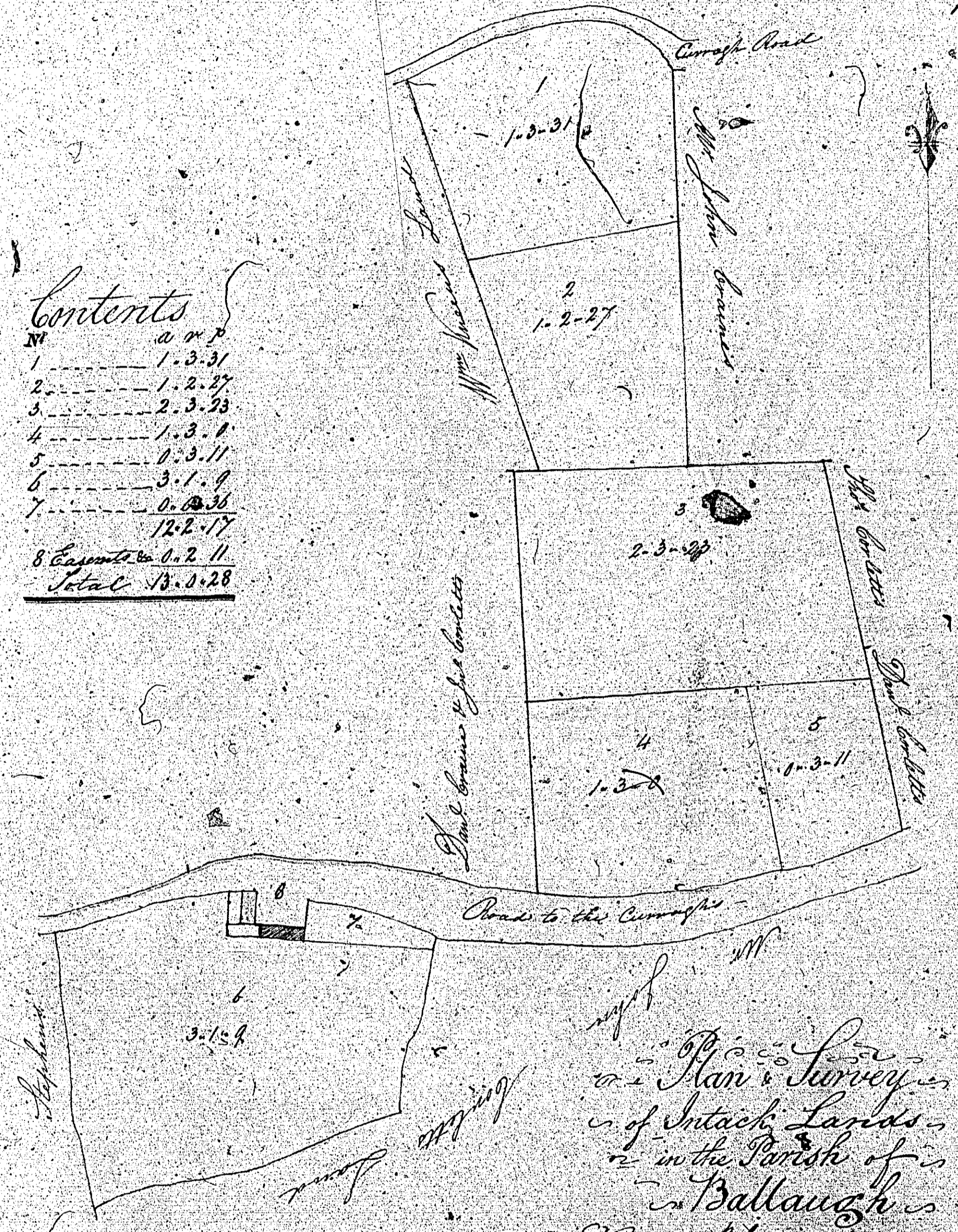

*Plan & Survey
of Intack Lands
in the Parish of
Ballaugh 16th
Belonging to
Mr John Myleram Cooper*

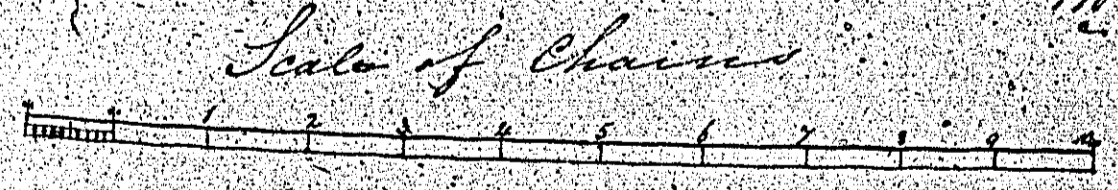

By John Graines 1840