

265

Map and Survey
of part of the Quarterland of
the Parishes in the Parish of Andreas
the Property of Mr. Tho. Seare

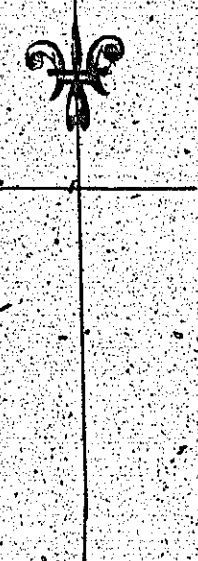

265

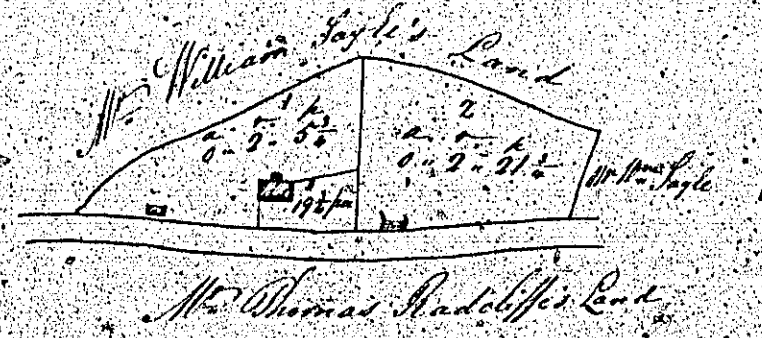

1	0. 5. 1/2
2	0. 9. 3/4
3	1. 2. 2 1/2
	4. 0. 19 1/2
	<u>7. 1. 7 1/2</u>



Surveyed by John Linnell, Surveyor
Ad. Andreas 15th Oct. 1840

Half of the highest of paces

ISLE OF MAN GOVERNMENT: GENERAL REGISTRY
TITHE PLANS: PARISH OF ANDREAS

Original monotone

1:30

A12

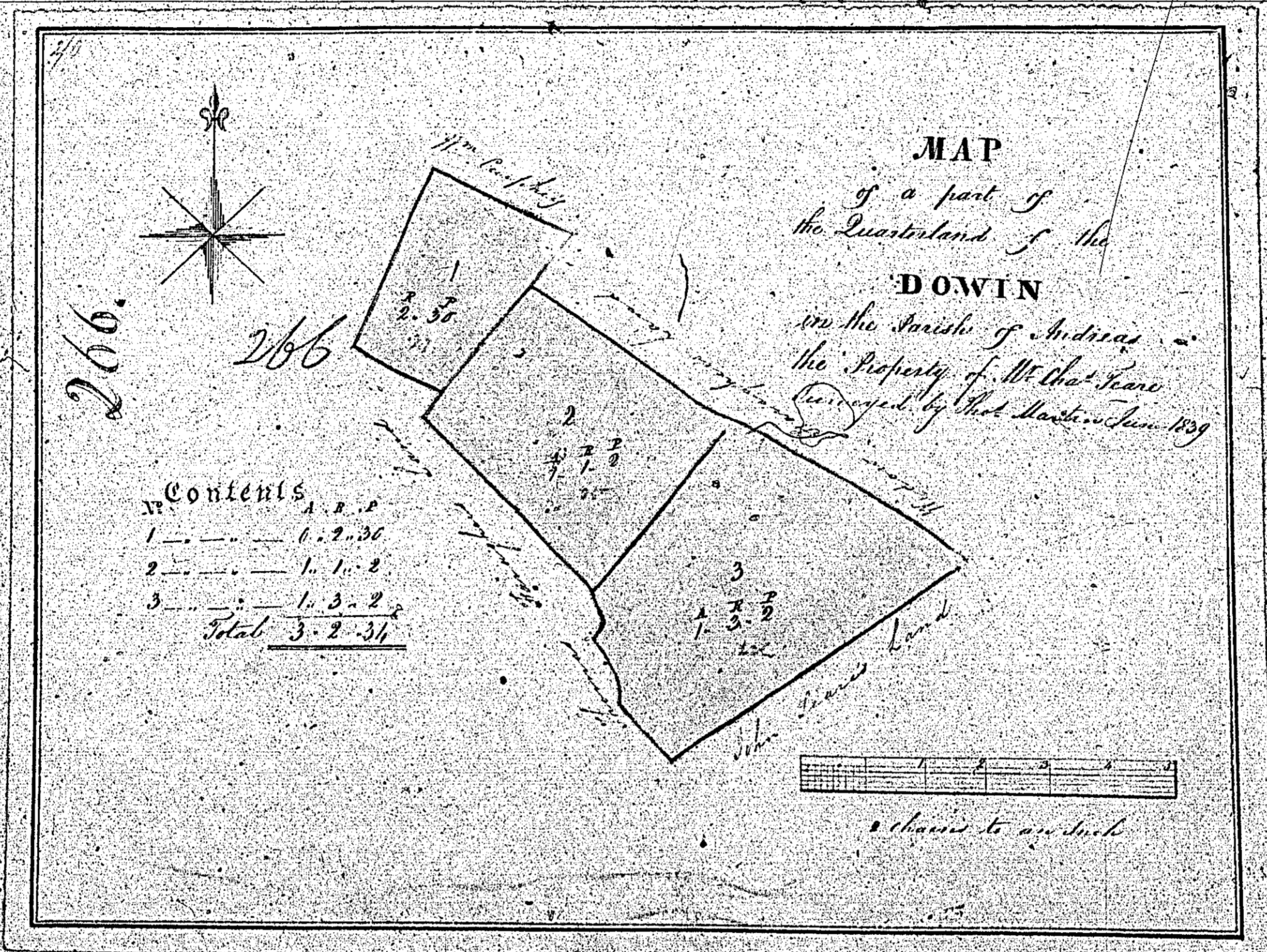

ISLE OF MAN GOVERNMENT: GENERAL REGISTRY

TITHE PLANS: PARISH OF ANDREAS

Original coloured (decorative)

1:30

Noticed

S

Noticed

267.

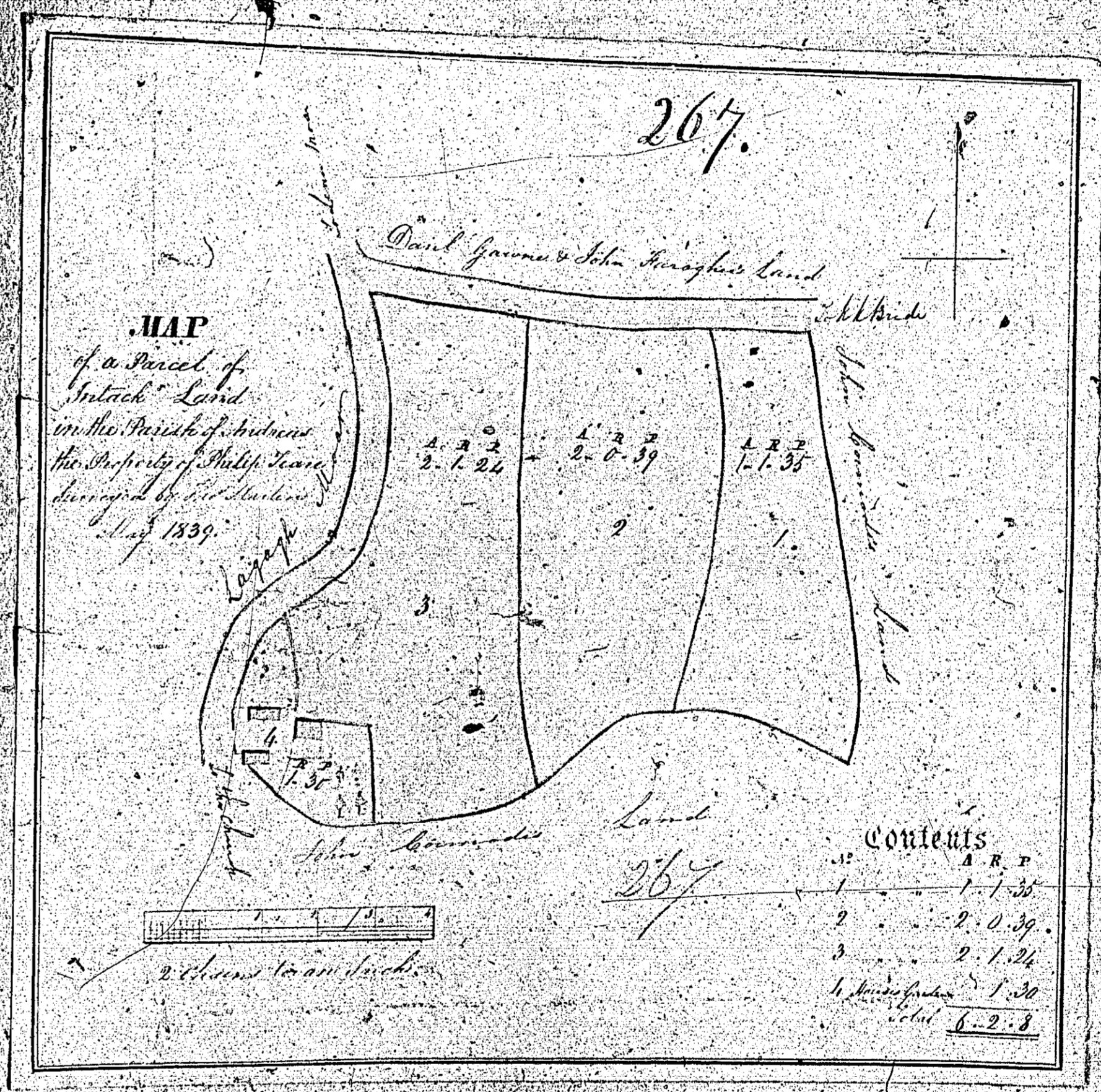

Not used

MAP *268.*

of a Piece of
Sutack Land
in the Parish of Andross
the Property of the Leases
Surveyed by Mr. Boston
Nov: 1846



Content 18 Perches

