

ISLE OF MAN GOVERNMENT: GENERAL REGISTRY

TITHE PLANS: PARISH OF ANDREAS

Original coloured (decorative)

1:30

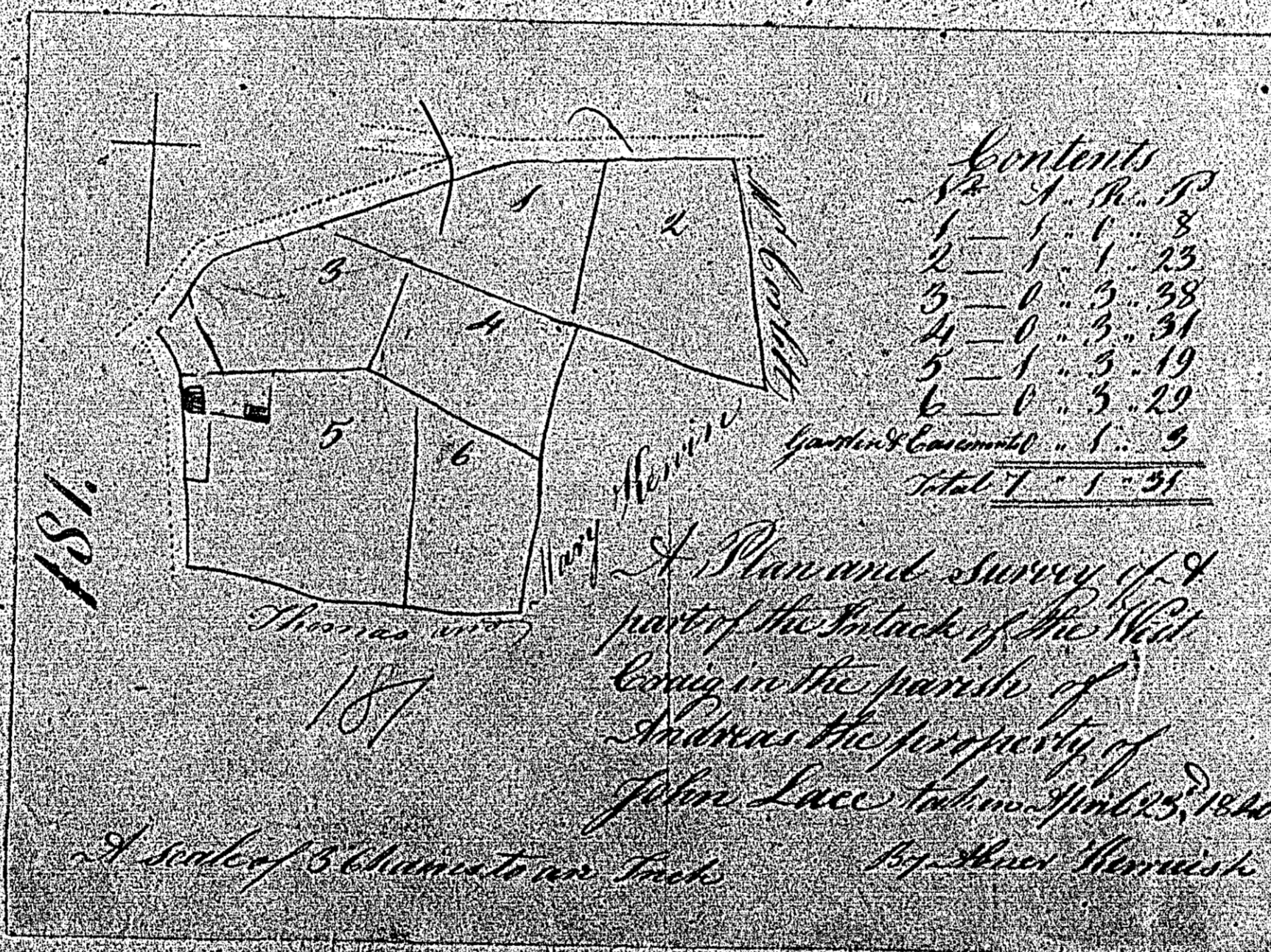

ISLE OF MAN GOVERNMENT: GENERAL REGISTRY

TITHE PLANS: PARISH OF ANDREAS

Original coloured (decorative)

1:30

~~1824~~
1824/183

and Survey of
B R I T
in the Parish of Andreas
the Town of the North
Andreas

190-

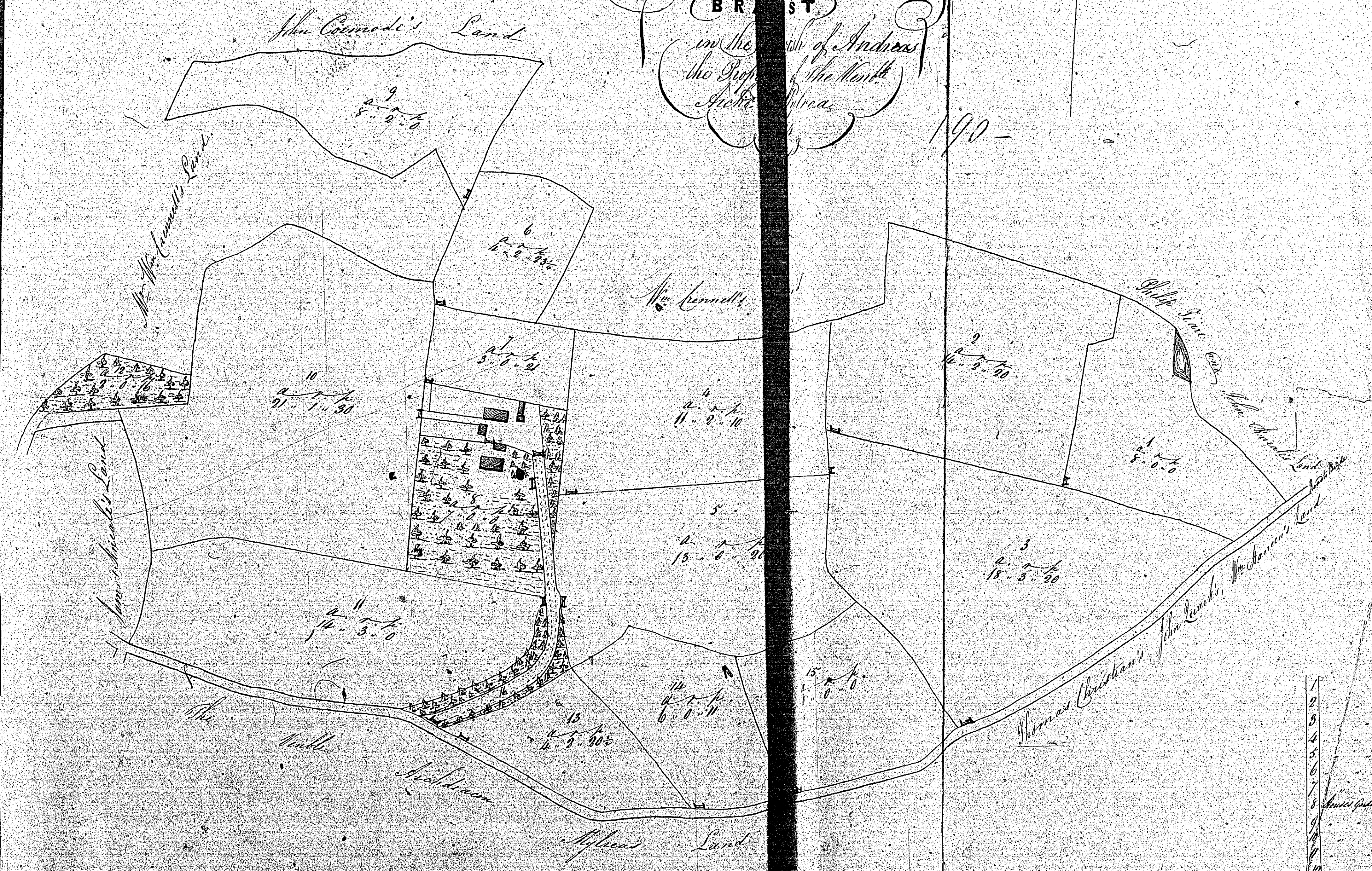

Surveyed by John Coomodi, Schoolmaster
Andreas 1824

1	1
2	0
3	20
4	20
5	20
6	20
7	20
8	20
9	20
10	20
11	20
12	20
13	20
14	20
15	20
16	20
17	20
18	20
19	20
20	20
21	20
22	20
23	20
24	20
25	20
26	20
27	20
28	20
29	20
30	20
31	20
32	20
33	20
34	20
35	20
36	20
37	20
38	20
39	20
40	20
41	20
42	20
43	20
44	20
45	20
46	20
47	20
48	20
49	20
50	20
51	20
52	20
53	20
54	20
55	20
56	20
57	20
58	20
59	20
60	20
61	20
62	20
63	20
64	20
65	20
66	20
67	20
68	20
69	20
70	20
71	20
72	20
73	20
74	20
75	20
76	20
77	20
78	20
79	20
80	20
81	20
82	20
83	20
84	20
85	20
86	20
87	20
88	20
89	20
90	20
91	20
92	20
93	20
94	20
95	20
96	20
97	20
98	20
99	20
100	20

184

Plan and Survey

BALLACREBBIN

ANDREAS

the property of
Mr. John Lee

184

Scale of Ten Chains

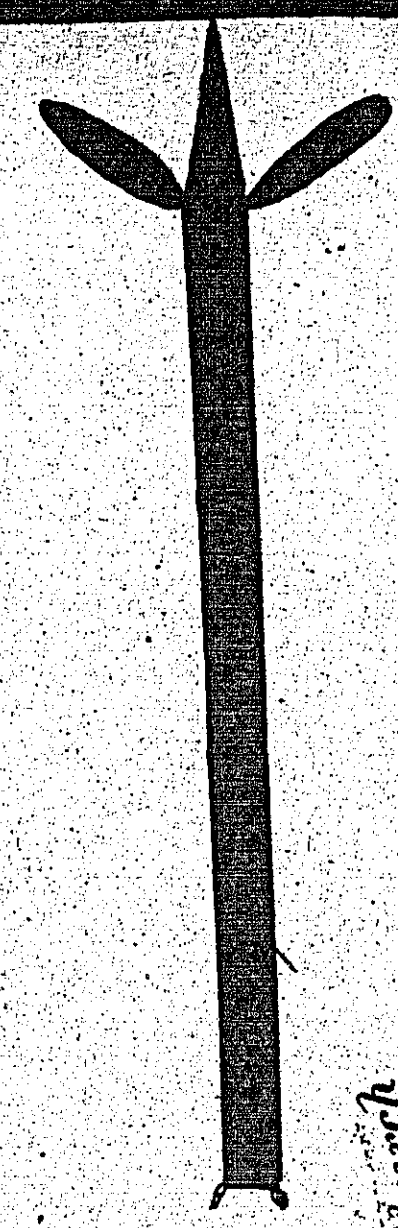

Plot	Acres	Rods	Faths
1	1	2	19
2	2	2	29
3	3	1	36
4	4	2	26
5	5	3	31
6	6	1	28
7	7	2	27
8	8	3	27
9	9	1	28
10	10	2	28
11	11	3	30
12	12	1	29
13	13	0	12
14	14	3	31
Roads			
High Road			
Total			

[Handwritten signature]

185-

Map and Survey
 of part of the Quarterland of
 Balla-Radloff
 in the Parish of Andreas
 the Property of Victor Lyons

Content
 2. 0. 99 1/2 perches
 half of the Acre and 24 perches

185-

Surveyed by John Cannell, schoolmaster
 Parish of Andreas, 14th October 1840

10	10	10	10	10	10	10	10	10	10
10	10	10	10	10	10	10	10	10	10
10	10	10	10	10	10	10	10	10	10
10	10	10	10	10	10	10	10	10	10
10	10	10	10	10	10	10	10	10	10
10	10	10	10	10	10	10	10	10	10
10	10	10	10	10	10	10	10	10	10
10	10	10	10	10	10	10	10	10	10
10	10	10	10	10	10	10	10	10	10
10	10	10	10	10	10	10	10	10	10

183-

Surveyed by John Cannell, schoolmaster
 Parish of Andreas, October 1840

