

MAP
and Survey of
PART OF
GAT-E-WHING,
in the Parish of Ardara,
the Property of Mr. Daniel O'Keefe
Surveyed by Thomas Martin
October 1845.

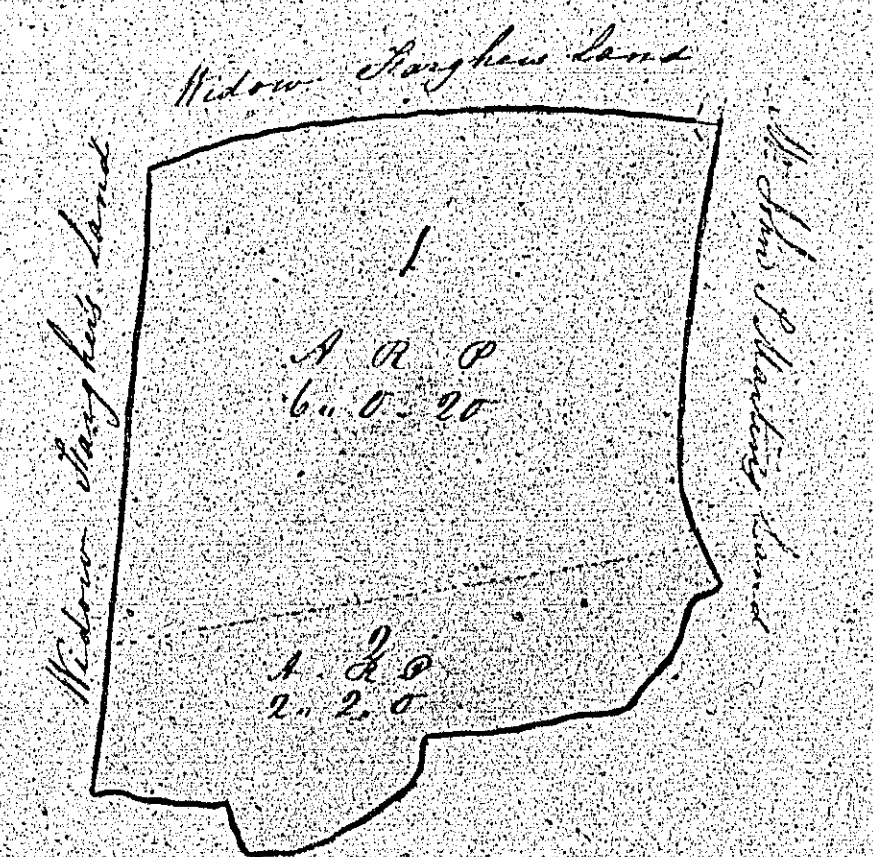

Mr. John O'Keefe's Land

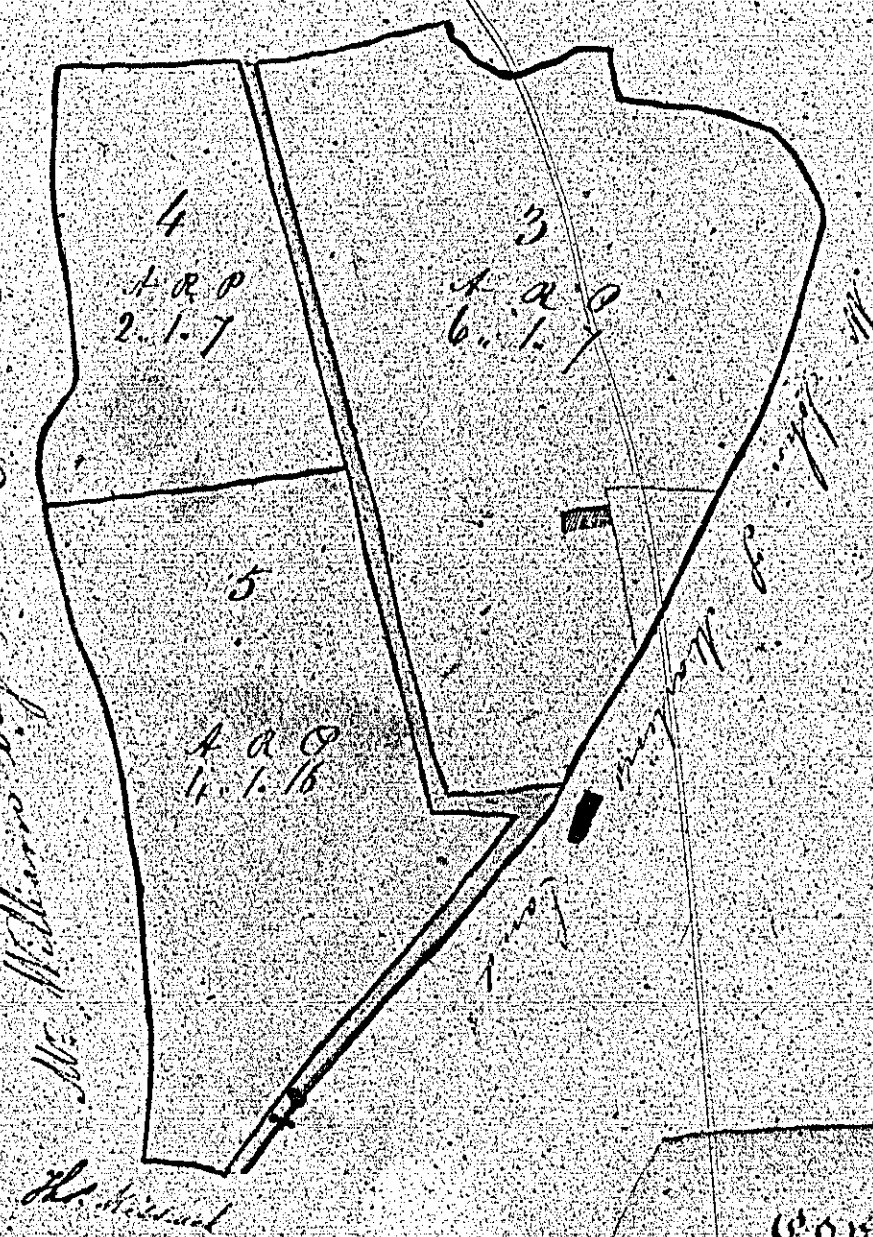

Mr. William Douglas's Land

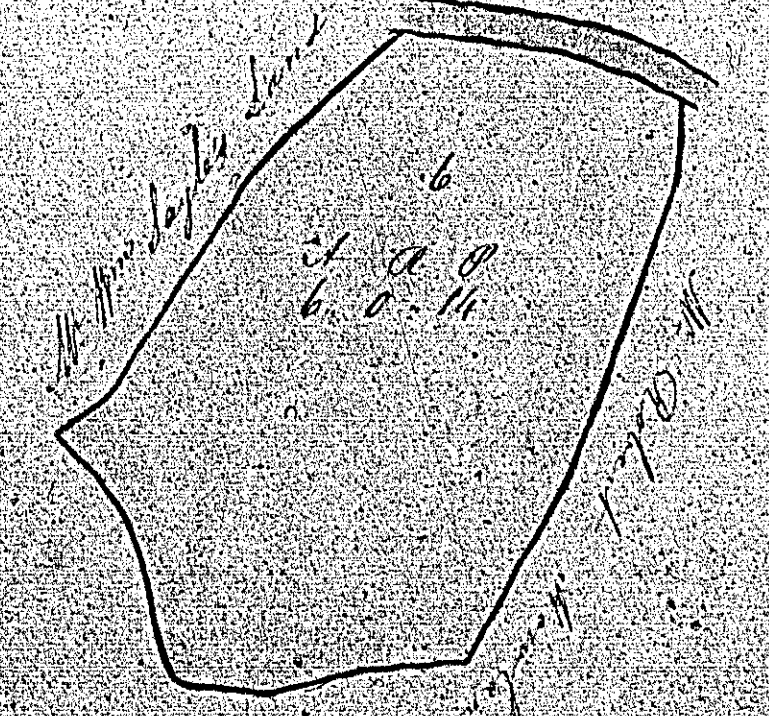
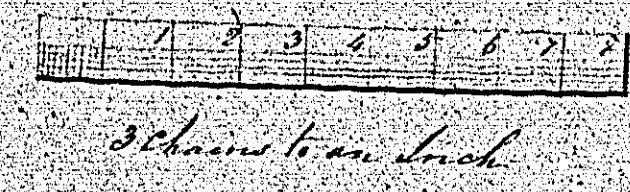

Mr. Daniel O'Keefe's Land

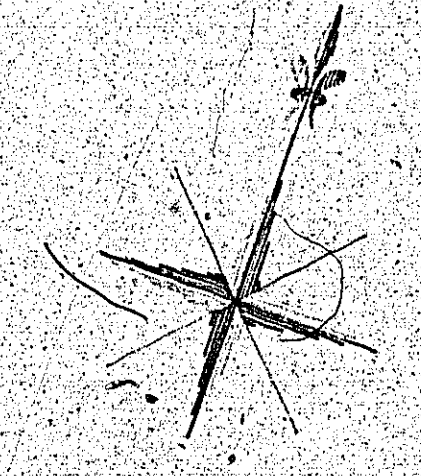

136

No.	Contents	ARP
1		6 5 20
2	Doogh	2 2 1
3		6 1 7
4		2 1 7
5		4 1 1 6
6		6 6 11
		27 2 36
	Road	2 4
		29 6 28

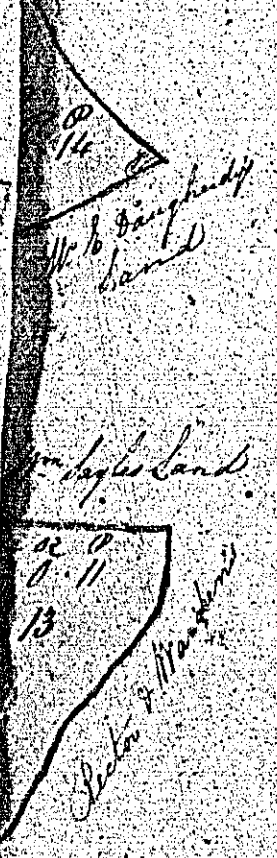

Mr. Daniel O'Keefe's Land

Not used

MAP
and Survey of

137.

LOUDAS

in the Parish of Andover
The Property of Mr. General Pitt
surveyed by John Radcliffe 1739

137

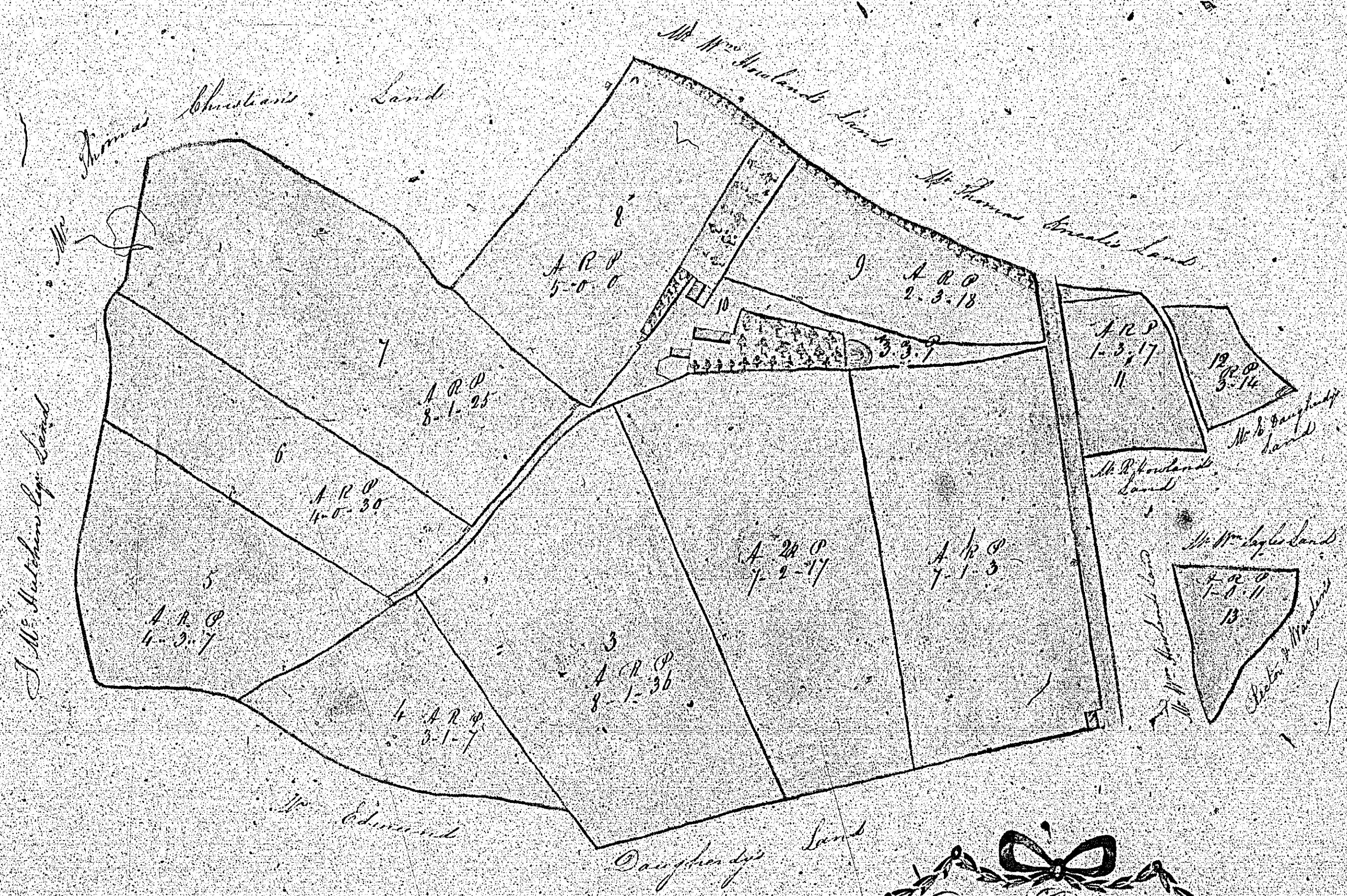
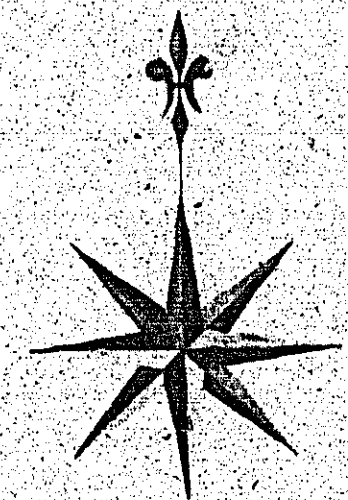

3 chains to an Inch

NOTE The small numbers placed the
end of the plots, &c. all contains 12 perches
which is included in the contents of the plots &c.
The small road between the fields 11 and 12
contains 6 perches which is included in
the contents of the field No. 12.

Contents	
1	1 1 3
2	2 0 11
3	2 1 30
4	3 1 7
5	4 3 7
6	4 0 30
7	8 1 20
8	0 1 1
9	0 3 11
10	3 3 1
11	1 3 17
12	5 3 14
13	1 6 11
14	5 7 23

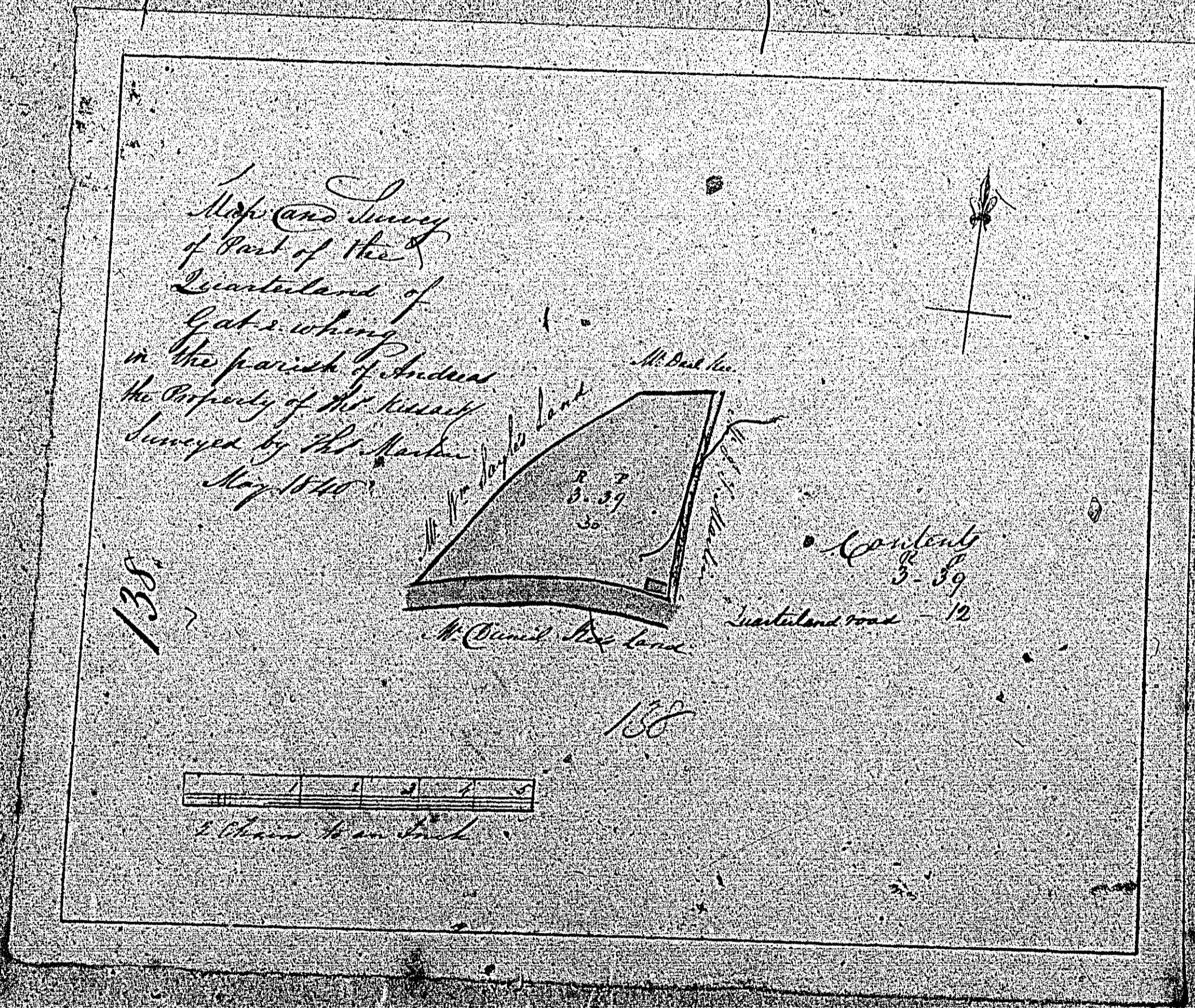

ISLE OF MAN GOVERNMENT: GENERAL REGISTRY

TITHE PLANS: PARISH OF ANDREAS

Original coloured (decorative)

1:30

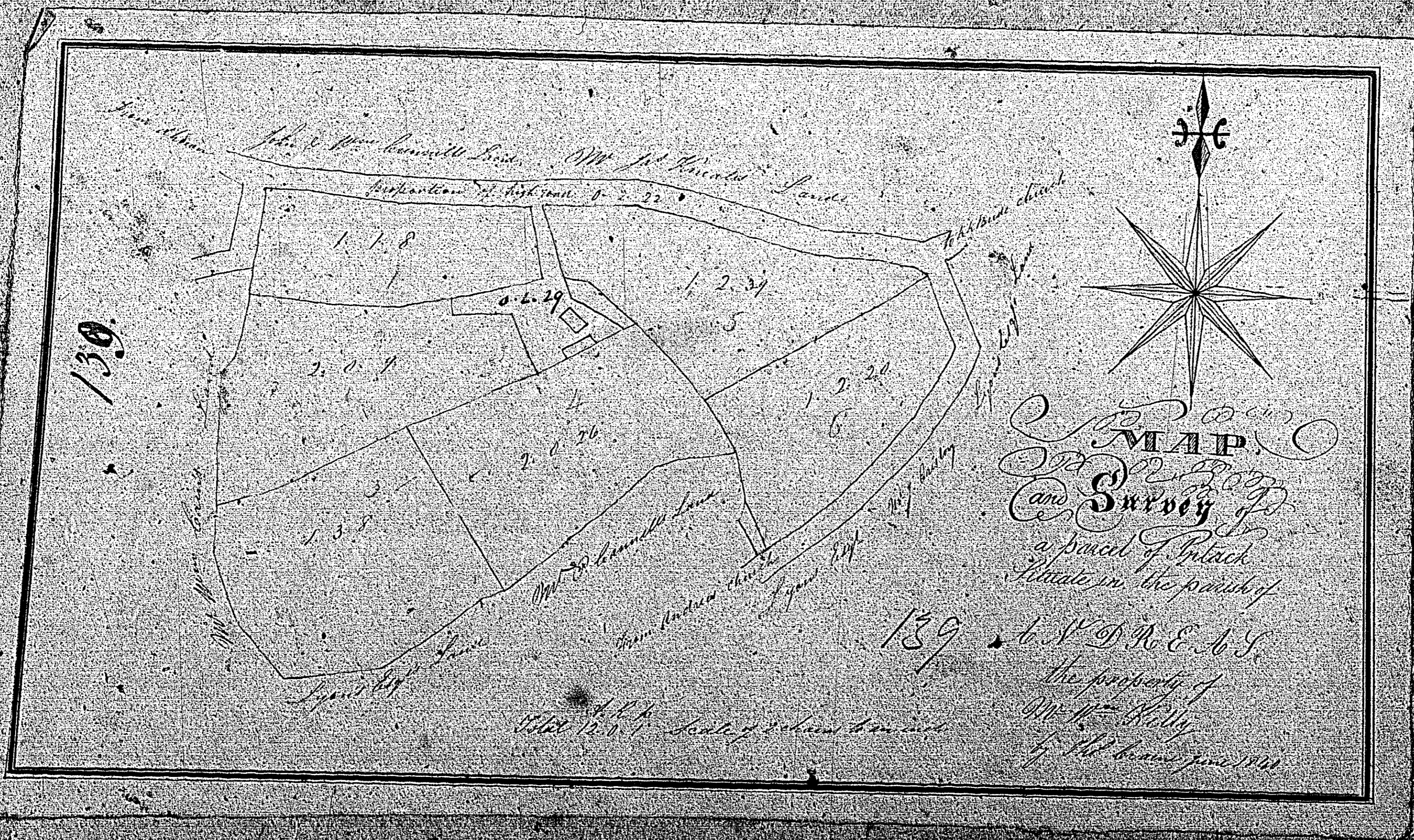

ISLE OF MAN GOVERNMENT: GENERAL REGISTRY

TITHE PLANS: PARISH OF ANDREAS

Original coloured (decorative)

1:30

END OF VOLUME