

ISLE OF MAN GOVERNMENT: GENERAL REGISTRY

ASYLUM PLANS: PARISH OF RUSHEN

Originals monotone

1:23

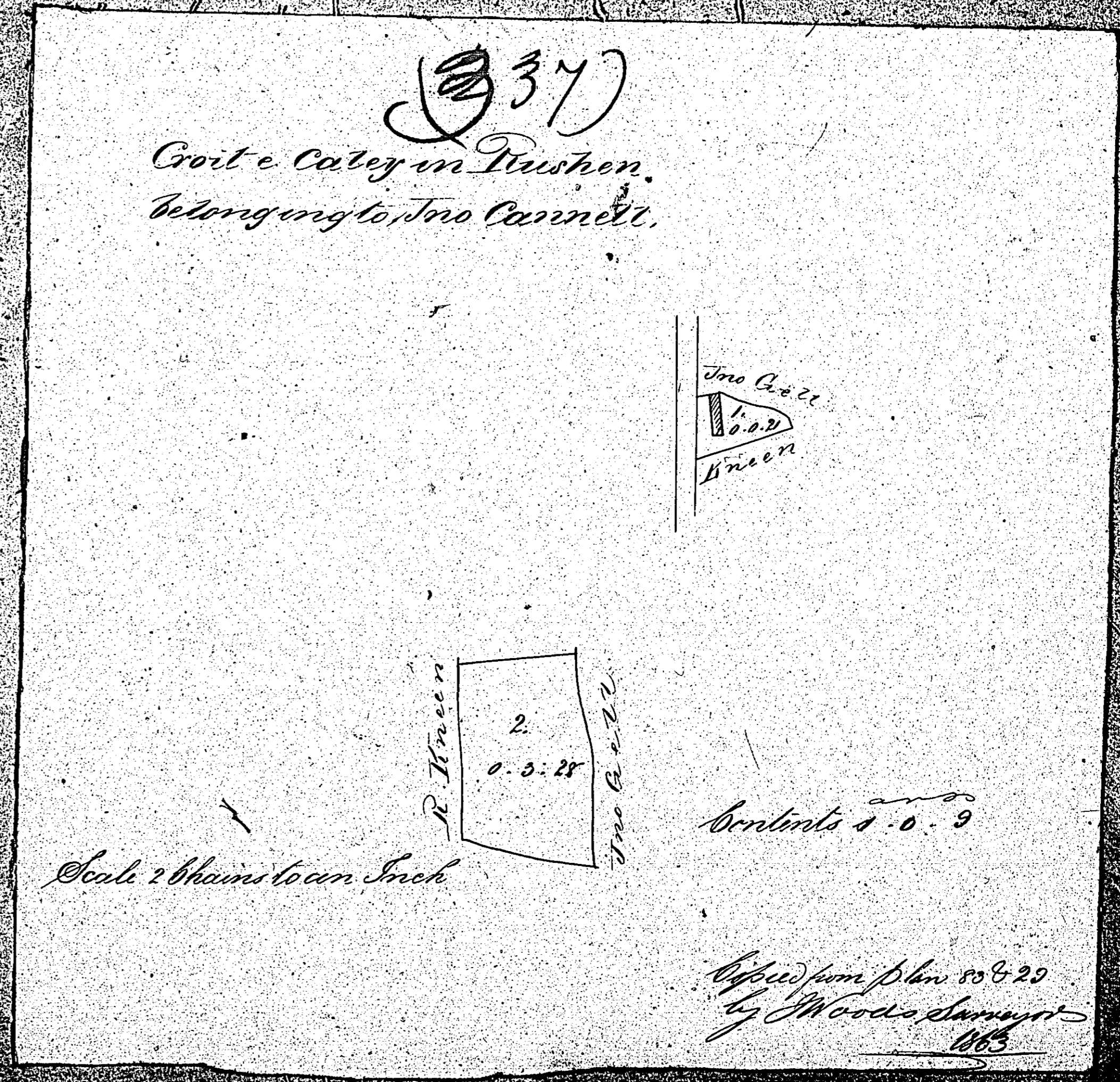
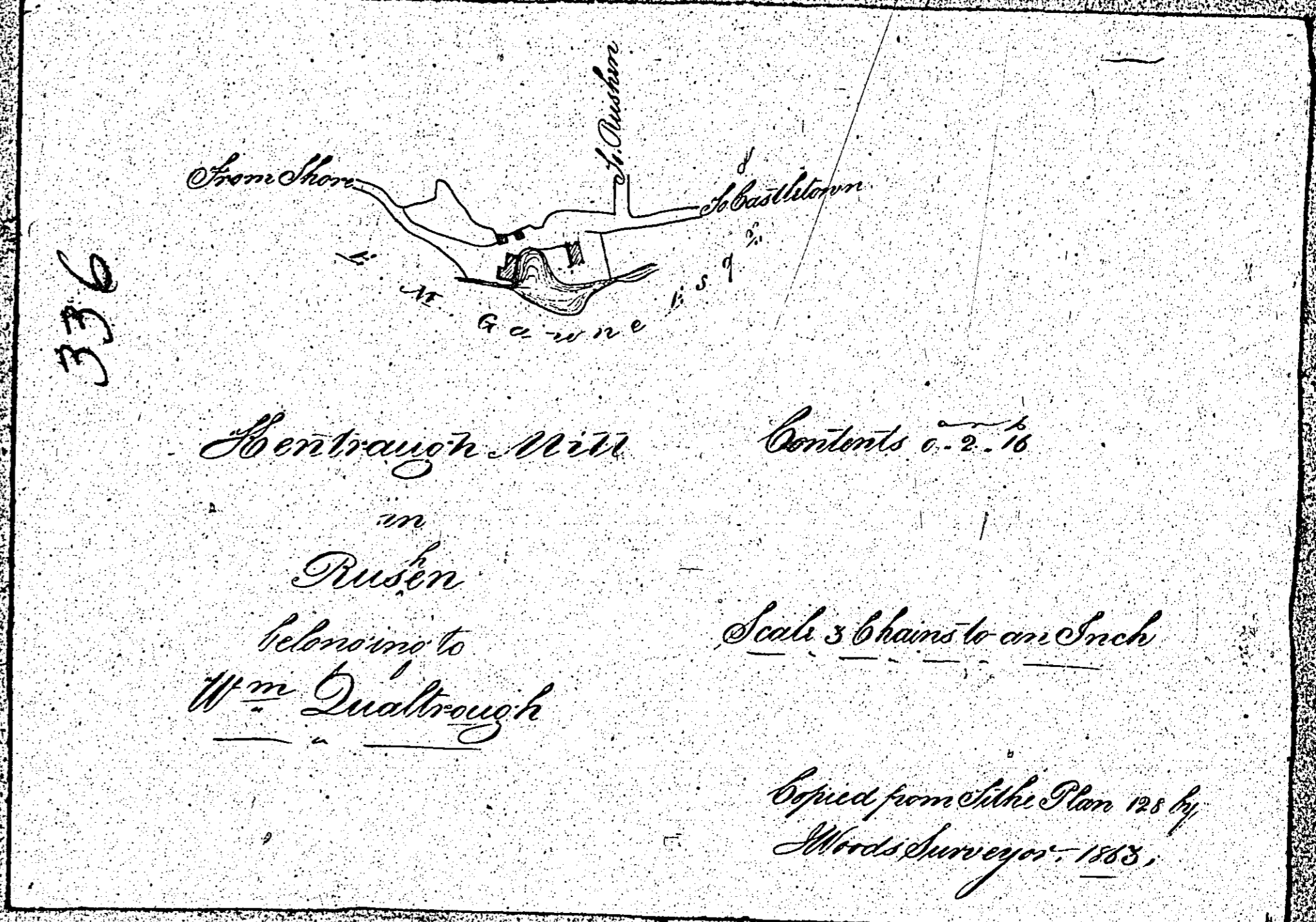

ISLE OF MAN GOVERNMENT: GENERAL REGISTRY
 ASYLUM PLANS: PARISH OF RUSHEN

Original monotone

1:23

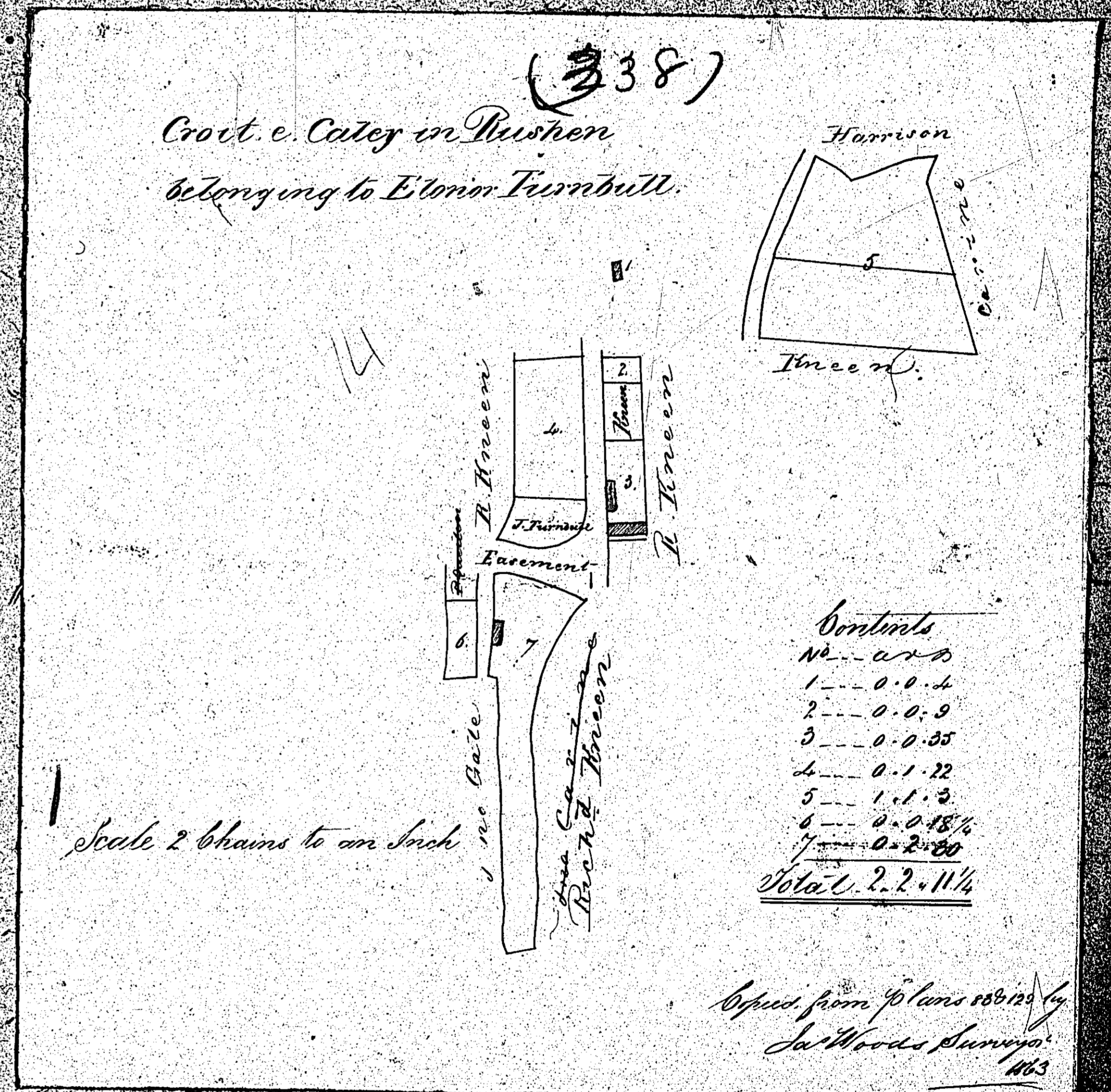

ISLE OF MAN GOVERNMENT: GENERAL REGISTRY
 ASYLUM PLANS: PARISH OF RUSHEN

Original monotone

1:23

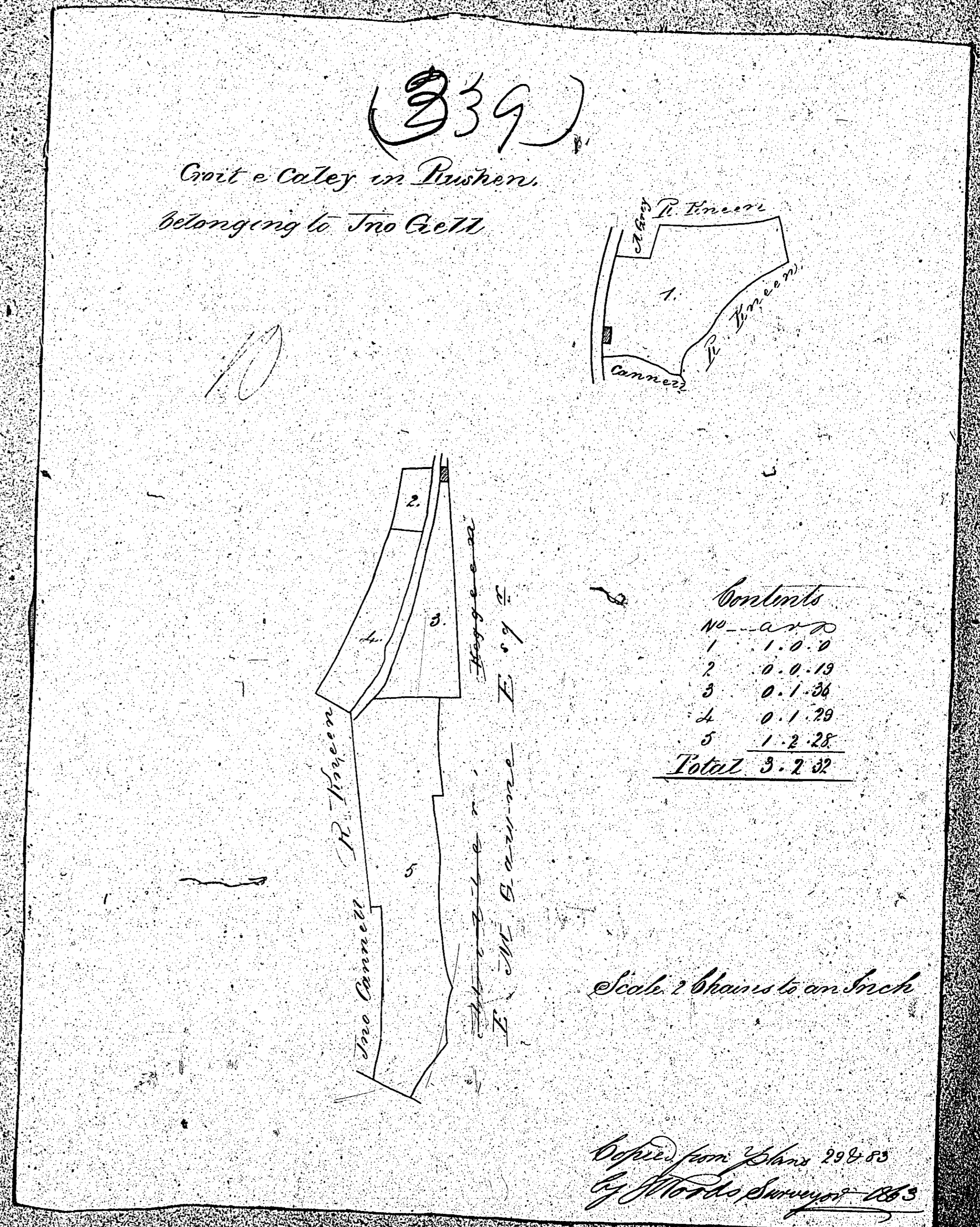

ISLE OF MAN GOVERNMENT: GENERAL REGISTRY

ASYLUM PLANS: PARISH OF RUSHEN

Original monotone

1:23

*Croft & Caley in Rushen
belonging to Richard Hineen.
April 1863.*

340

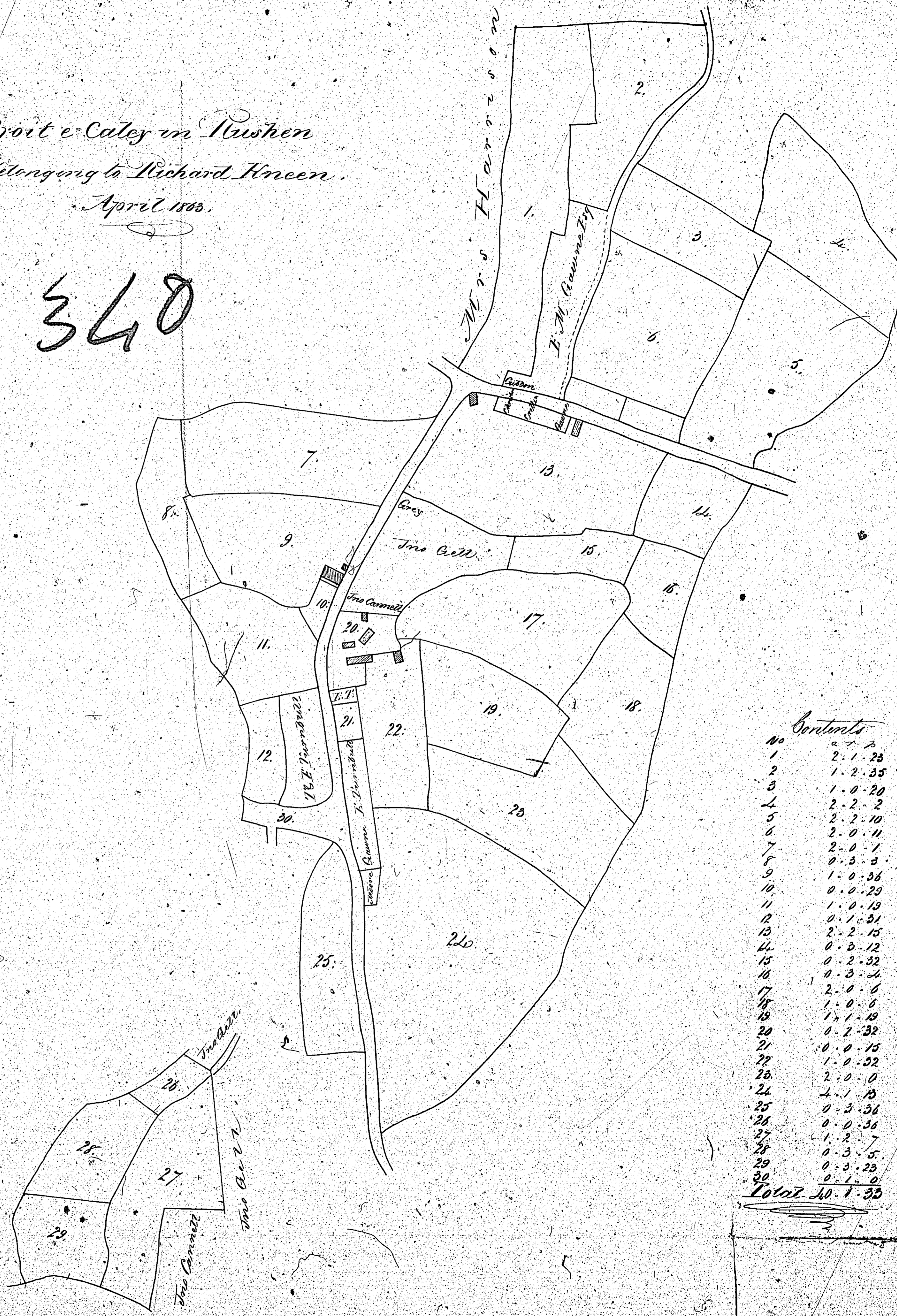

Contents

No	Contents
1	2.1.25
2	1.2.35
3	1.0.20
4	2.2.2
5	2.2.10
6	2.0.11
7	2.0.1
8	0.3.3
9	1.0.36
10	0.0.20
11	1.0.19
12	0.1.31
13	2.2.15
14	0.3.12
15	0.2.32
16	0.3.2
17	2.0.6
18	1.0.6
19	1.1.19
20	0.2.32
21	0.0.15
22	1.0.32
23	2.0.0
24	2.1.13
25	0.3.36
26	0.0.36
27	1.2.7
28	0.3.5
29	0.3.23
30	0.1.0
<i>Total 10.1.35</i>	

Scale 2 Chains to an Inch

*Copied from Plan 25 by
James Woods Surveyor 1863*

340

ISLE OF MAN GOVERNMENT: GENERAL REGISTRY

ASYLUM PLANS: PARISH OF RUSHEN

Originals monotone

1:23

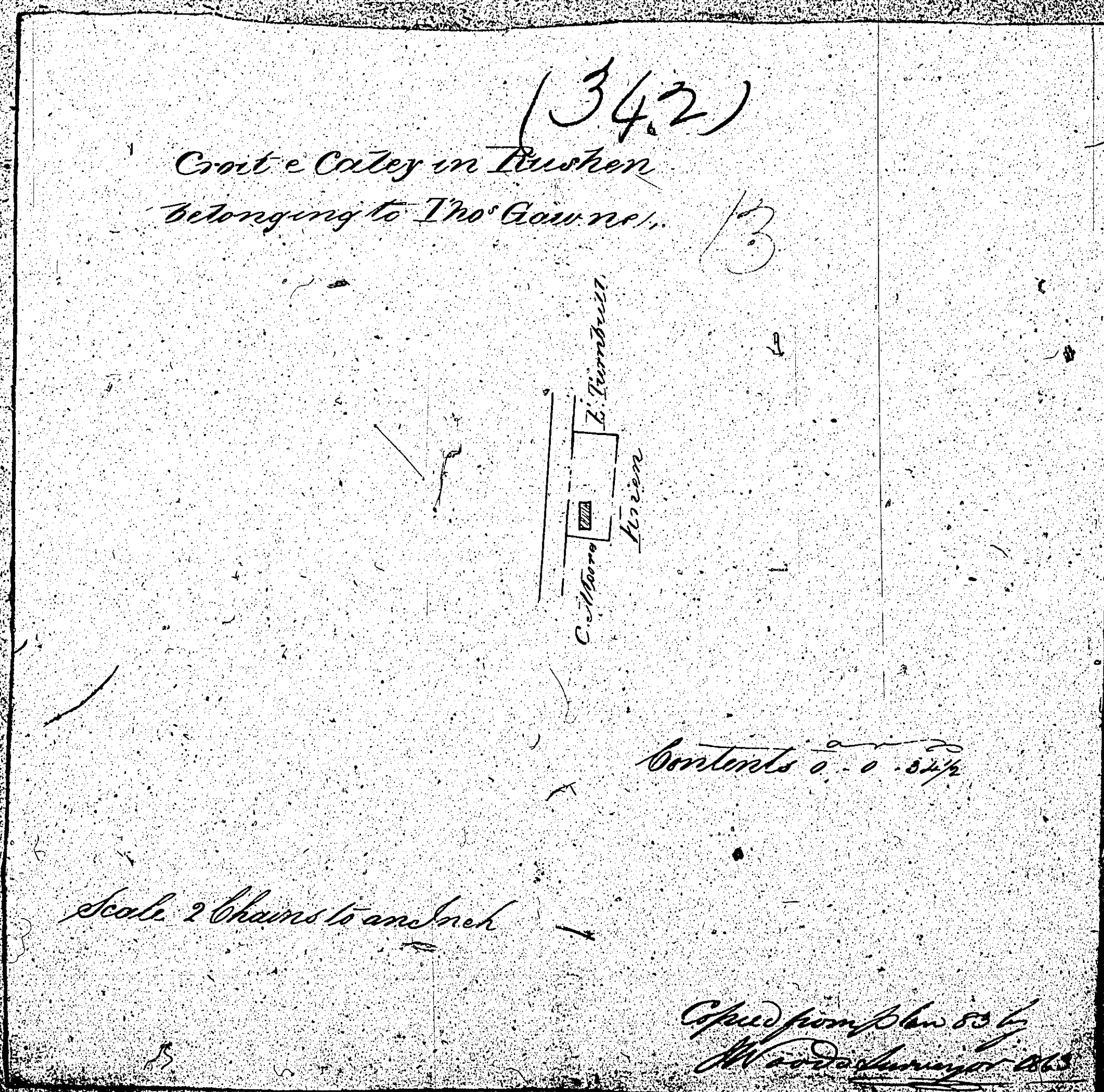
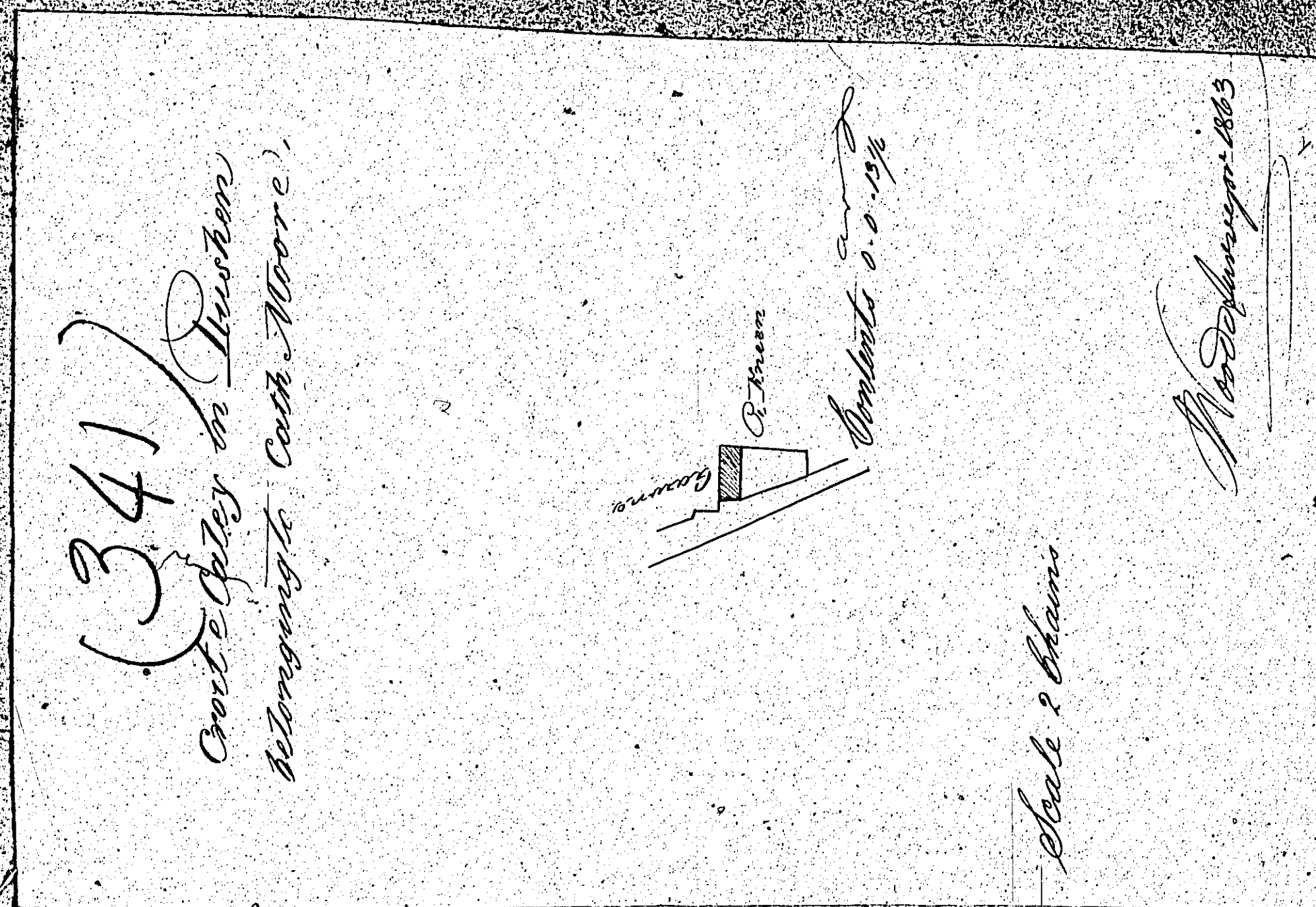

ISLE OF MAN GOVERNMENT: GENERAL REGISTRY

ASYLUM PLANS: PARISH OF RUSHEN

Originals monotone

1:23

