

ISLE OF MAN GOVERNMENT: GENERAL REGISTRY

ASYLUM PLANS: PARISH OF RUSHEN

Originals monotone

1:23

(282)

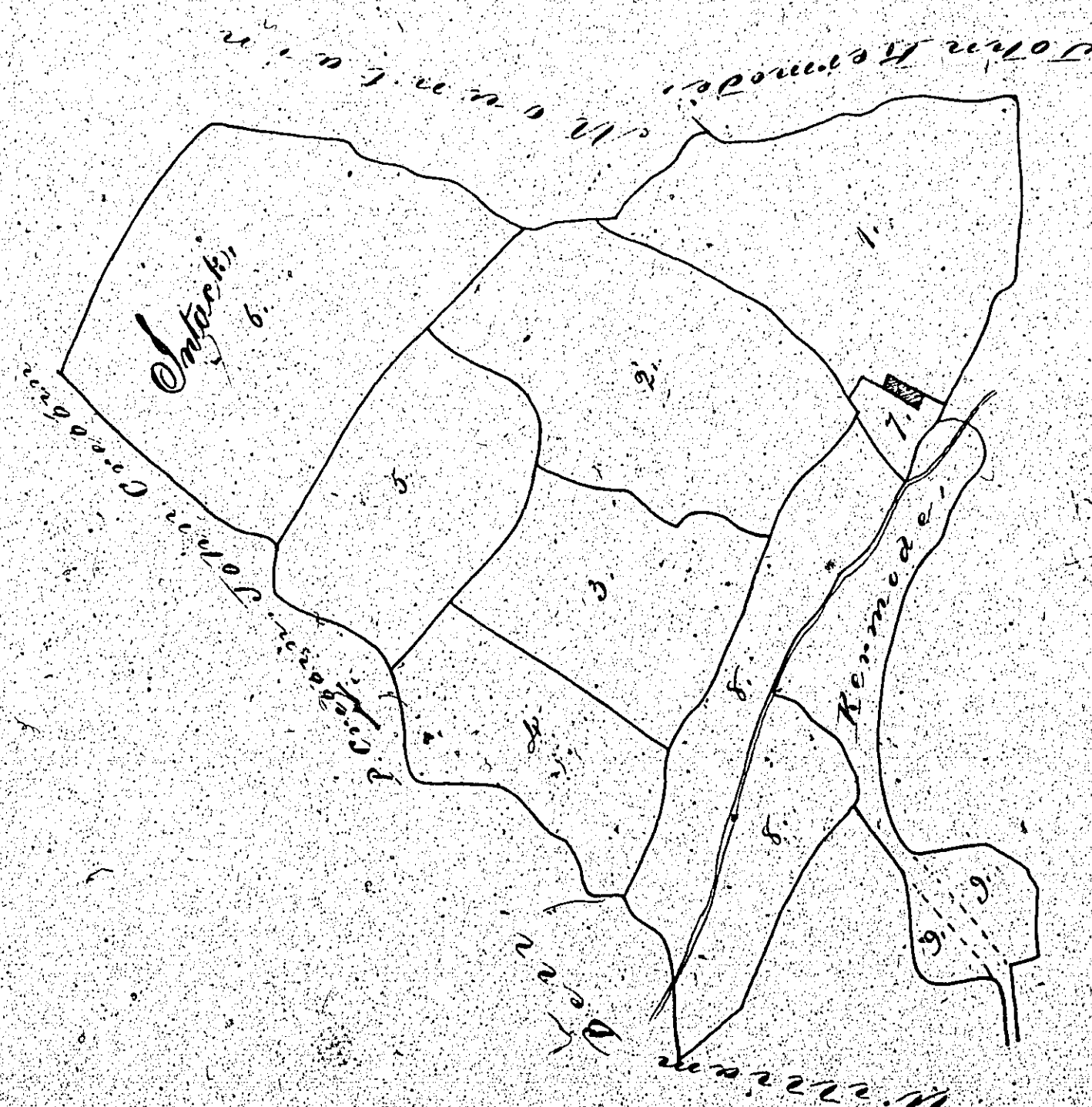

no	acres
1	3.1.0
2	3.0.32
3	2.0.25
4	1.2.28
5	2.0.2
6	4.1.5
7	0.0.22
8	3.0.5
9	0.0.12
Total 19.5.13	

Survey  
of  
Rushen  
taken to  
C. M. Harris Esq.

Scale is shown to one inch

Copied from Plans by  
Messrs. Curry & Co.

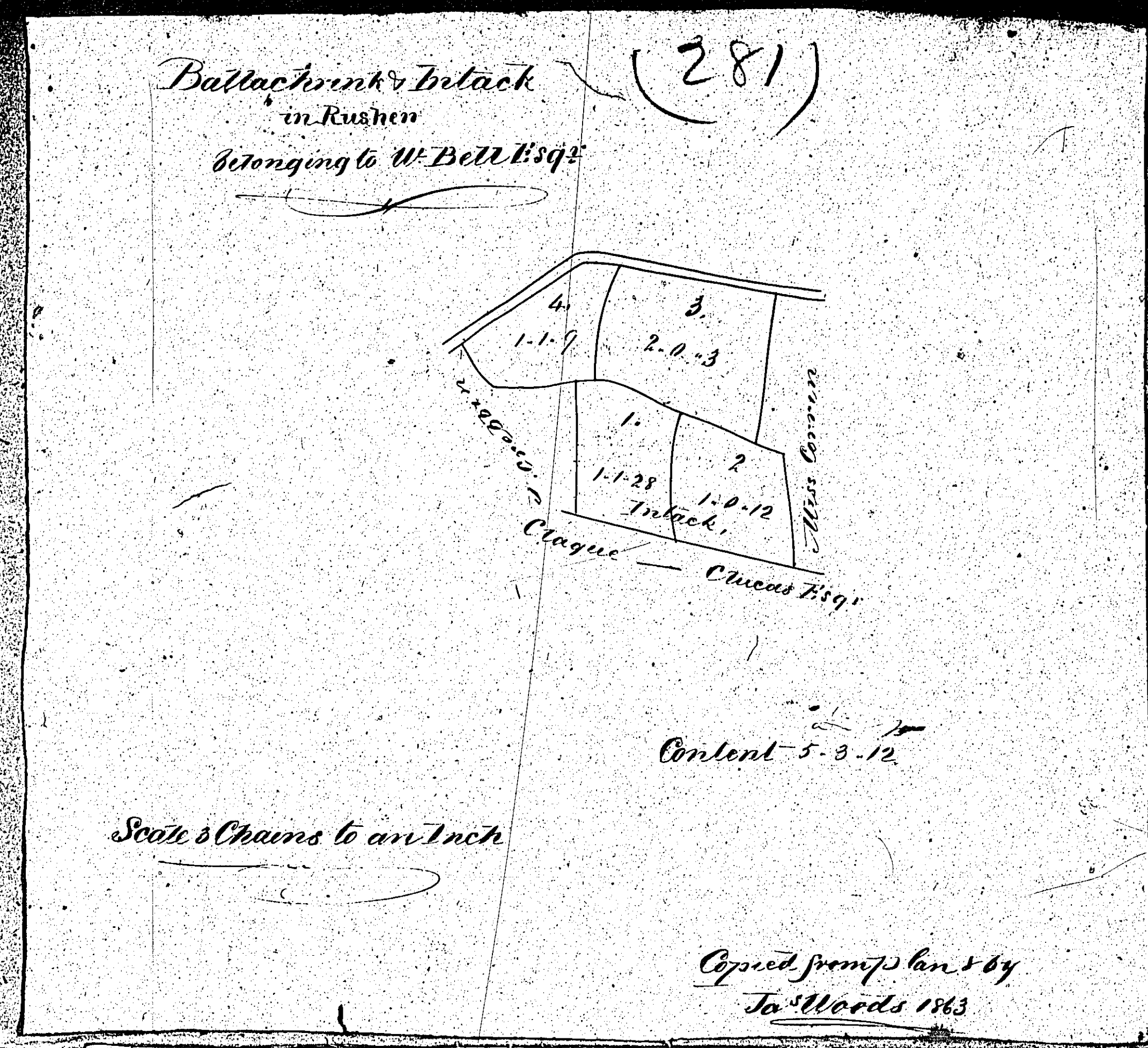

Ballachrink & Tintack  
in Rushen  
belonging to W. Bell Esq.

(281)

Content 5.3.12

Scale & Chains to an Inch

Copied from plan & by  
J. A. Woods 1863

ISLE OF MAN GOVERNMENT: GENERAL REGISTRY

ASYLUM PLANS: PARISH OF RUSHEN

Original monotone

1:23

frame 1 of 2

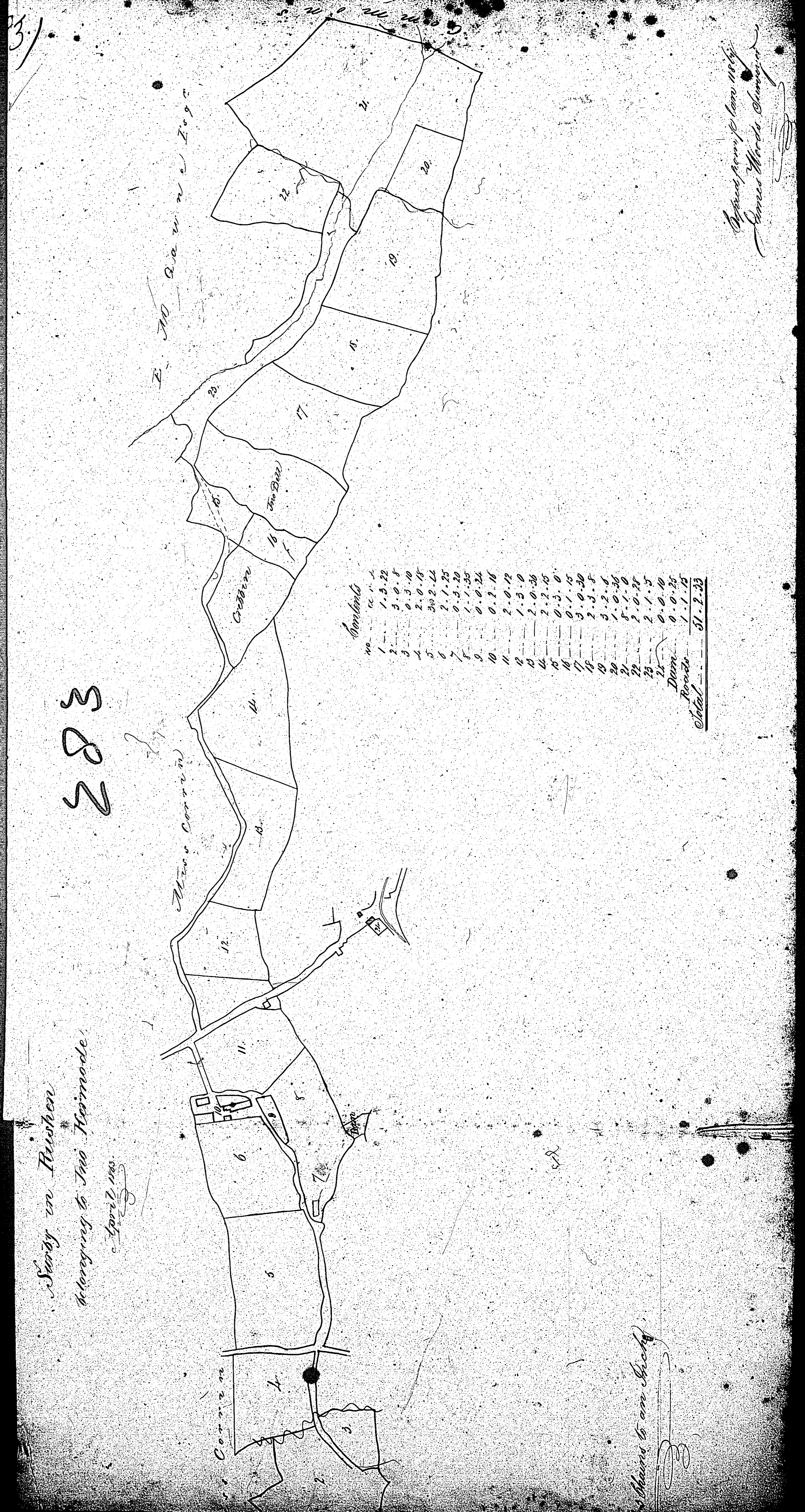

ISLE OF MAN GOVERNMENT: GENERAL REGISTRY

ASYLUM PLANS: PARISH OF RUSHEN

Original monotone

1:23

frame 2 of 2

*Survey in Rushen  
belonging to Mrs. Heermode.  
April 1882*

282

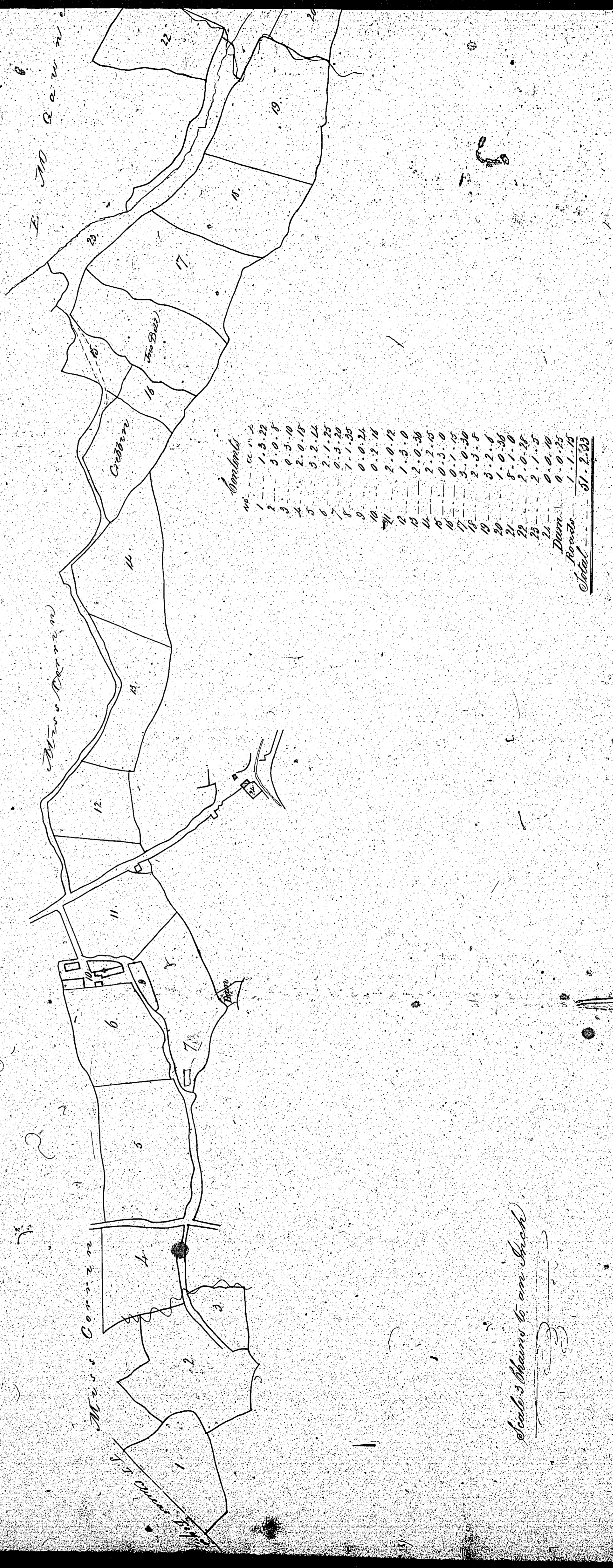

*John's Plans to an Inch*

*John's Plans to an Inch*

ISLE OF MAN GOVERNMENT: GENERAL REGISTRY

ASYLUM PLANS: PARISH OF RUSHEN

Original monotone

1:23

(284)

Inland to be dem'd

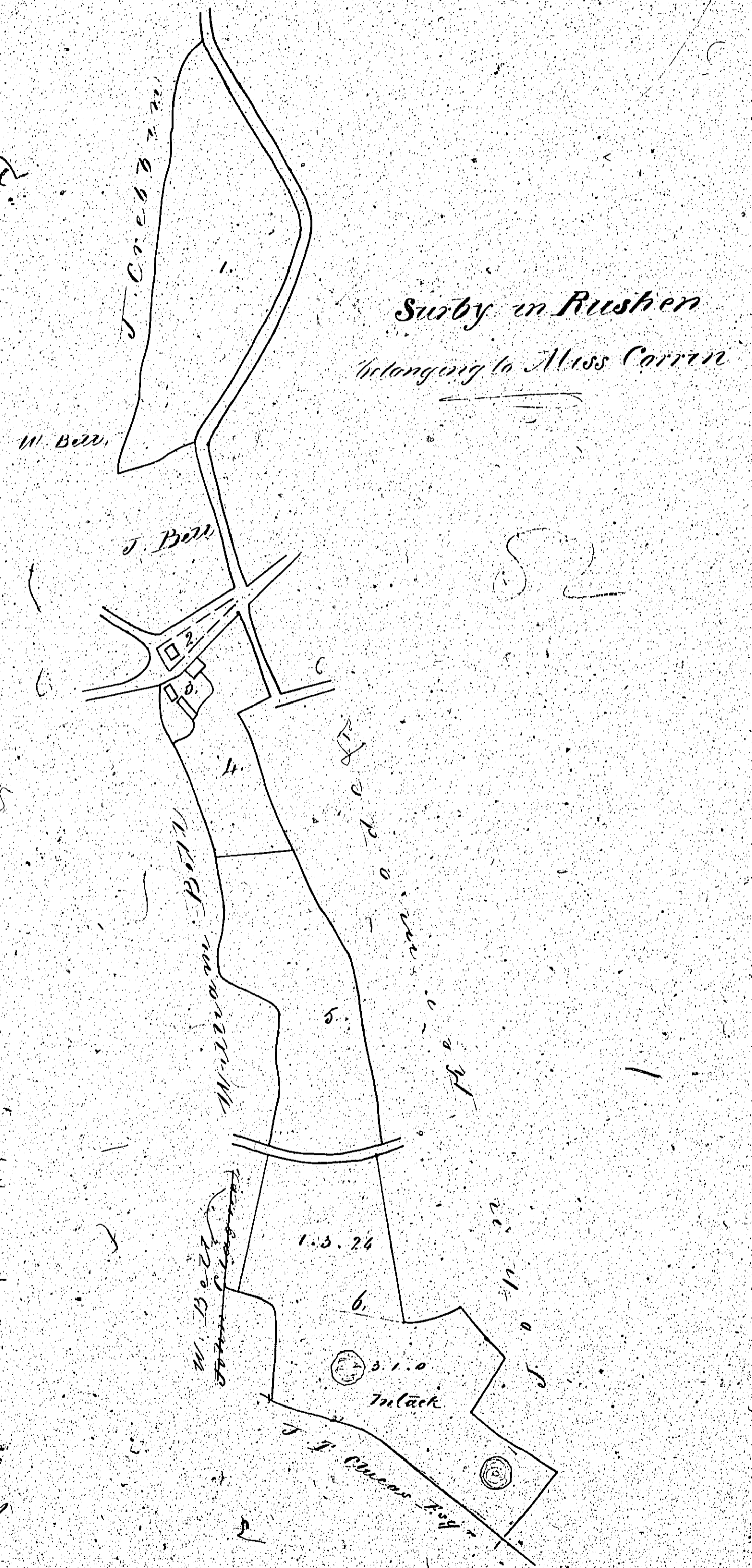

Acreage	
No.	Ac. R. P.
1	3.5.0
2	0.0.15
3	0.1.5
4	1.1.26
5	2.3.0
6	5.0.24
<u>Total</u>	<u>13.1.30</u>

Scale 3 Chains to an Inch

Surveyed from plan by  
Messrs. Curwen & Co. 1863

ISLE OF MAN GOVERNMENT: GENERAL REGISTRY  
 ASYLUM PLANS: PARISH OF RUSHEN

Original monotone

1:23

(285)

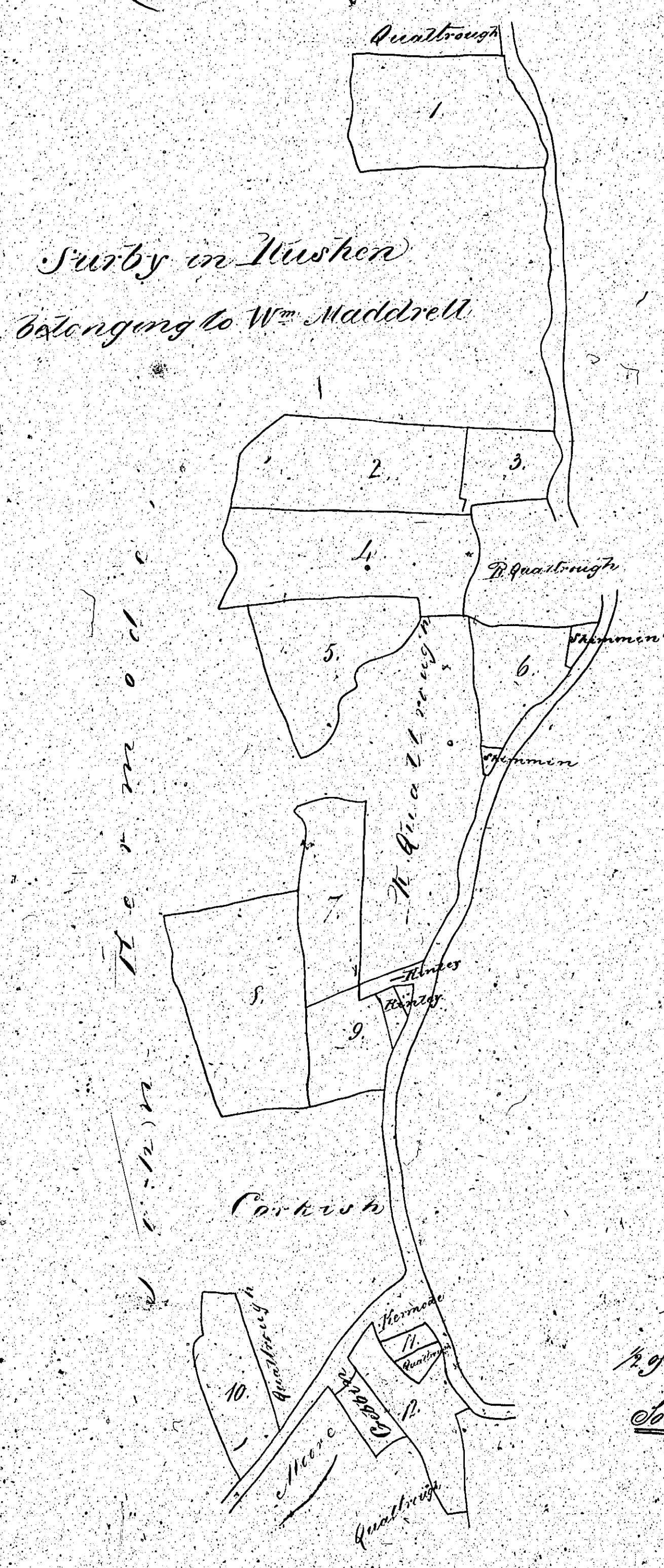

*Contracts*

No.	Acres
1	1.3.14
2	1.3.16 1/2
3	0.2.11 1/2
4	2.0.21 1/2
5	1.1.14 1/2
6	0.2.2
7	1.0.24
8	2.0.31 1/2
9	0.2.26
10	0.3.2
11	0.0.15 1/2
12	0.3.27 1/2
% of 13	1.0.27 1/2
14	0.2.12 1/2
<u>Total</u>	<u>16.0.19 1/2</u>

*Scale - 5 chains to an Inch*

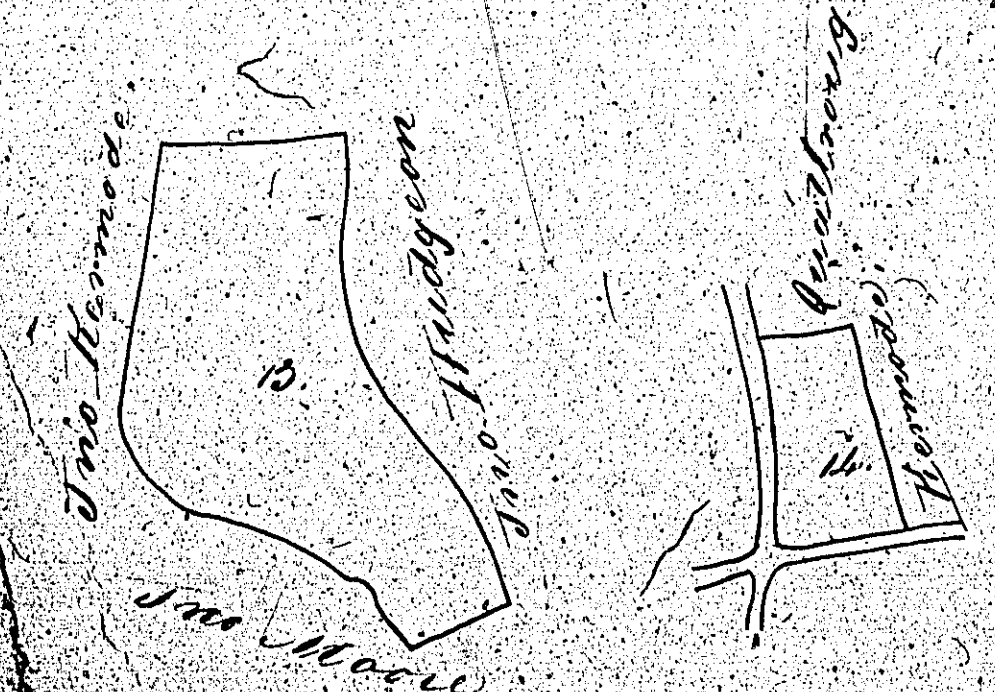

*Copied from plans 176 by  
 J. S. Woods Surveyor  
 1863*

ISLE OF MAN GOVERNMENT: GENERAL REGISTRY

ASYLUM PLANS: PARISH OF RUSHEN

Originals monotone

1:23

*Surby Moor in Rushen. (286)  
belonging to R. Quiltraugh  
Wm. Madrell & Wm. Corkish.*

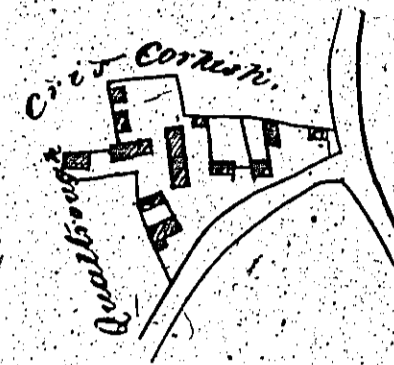

*Contents 0.2.3/4*

*Scale 3 Chains to an Inch*

*Copied from Post Office Survey  
by James Woods Surveyor.*

*(287)*

*Surby in Rushen  
belonging to John Cudbon.  
1863.*

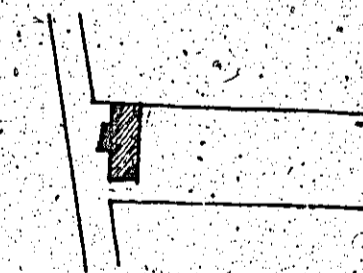

*Contents 0.1.4*

*Scale 2 Chains to an Inch.*

*James Woods Surveyor 1863.*