

ISLE OF MAN GOVERNMENT: GENERAL REGISTRY

ASYLUM PLANS: PARISH OF MICHAEL

Originals coloured

1:23

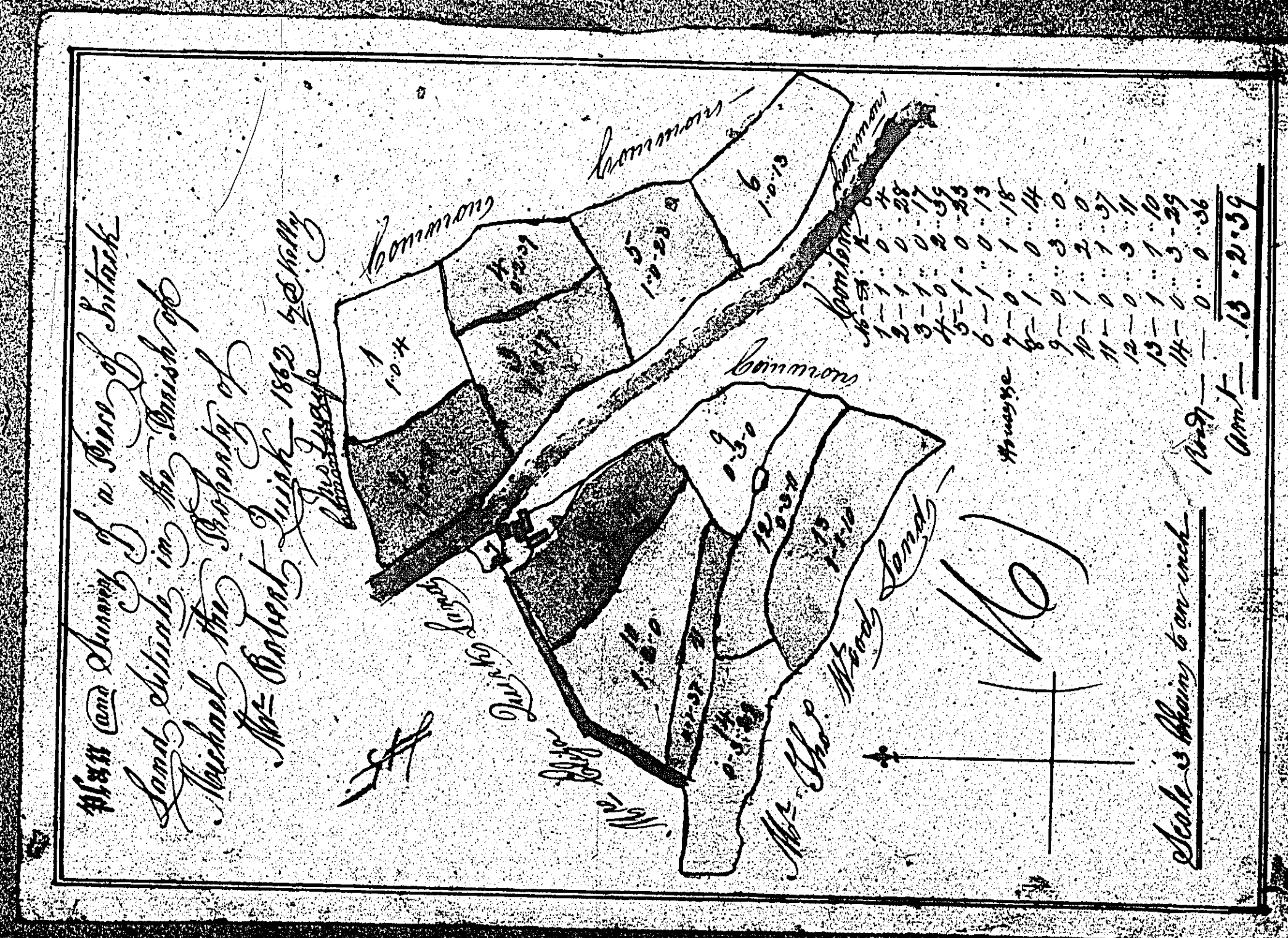
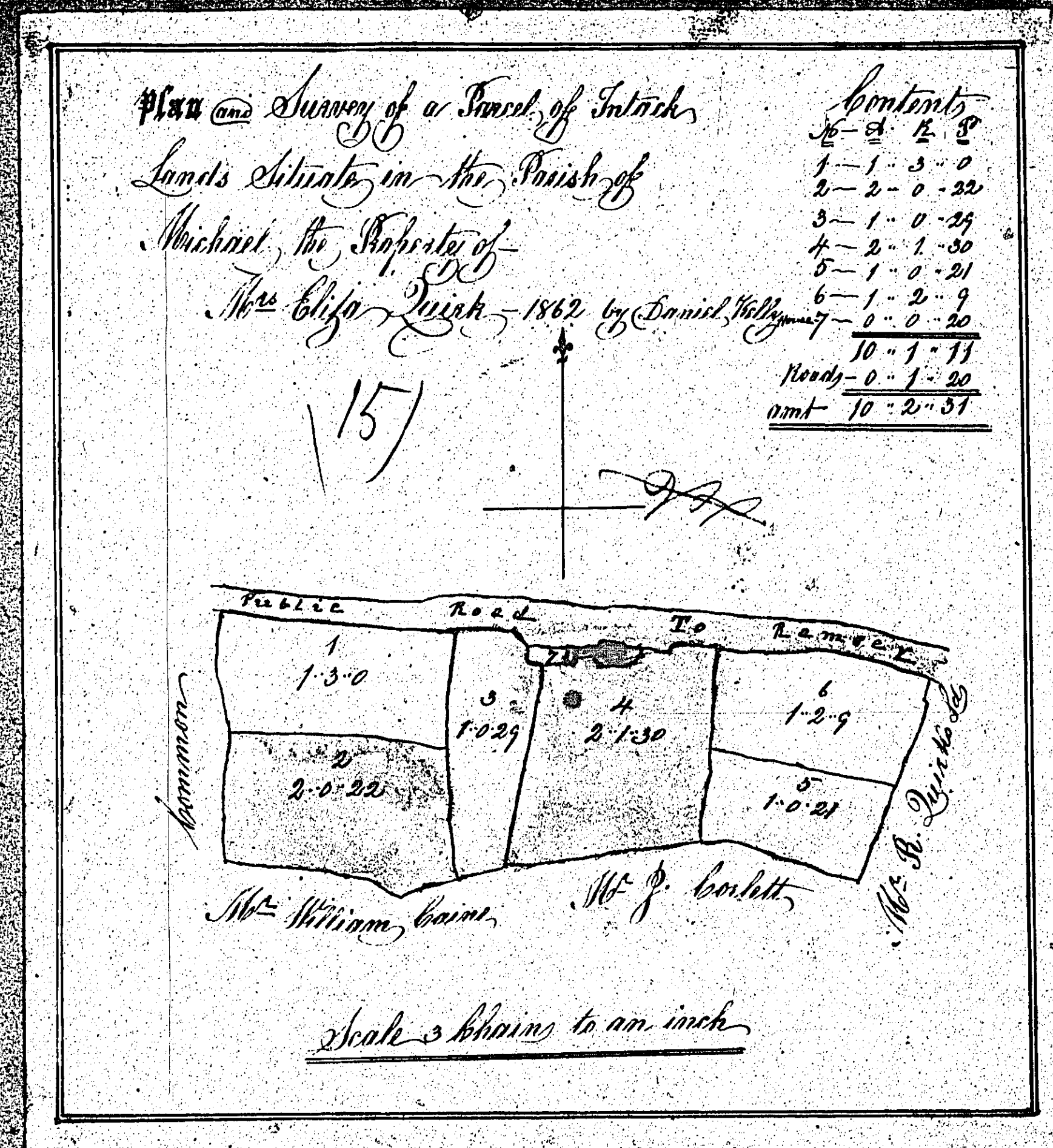

ISLE OF MAN GOVERNMENT: GENERAL REGISTRY

ASYLUM PLANS: PARISH OF MICHAEL

Original coloured (decorative)

1:23

Number	Area
1	4-1-24
2	7-5-30
3	6-0-21
4	0-5-30
5	5-1-20
6	1-0-18
7	1-0-7
8	1-5-51
9	1-3-19
Total	37-0-0

17)

*John and Anne (Widow) of Little London
 of Little London in the Parish of Michael
 the Property of the said John and Anne his Wife
 and John Bennett Clerk a Witness 1862 by David Kelly*

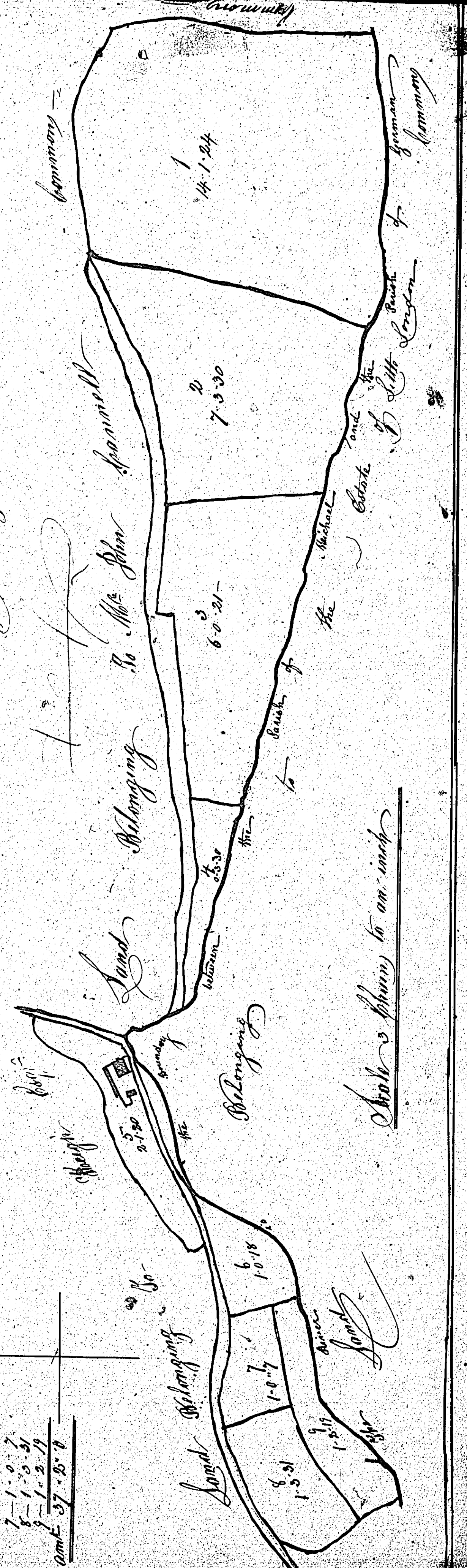

Scale of 1 inch to 100 feet

ISLE OF MAN GOVERNMENT: GENERAL REGISTRY

ASYLUM PLANS: PARISH OF MICHAEL

Originals coloured

1:23

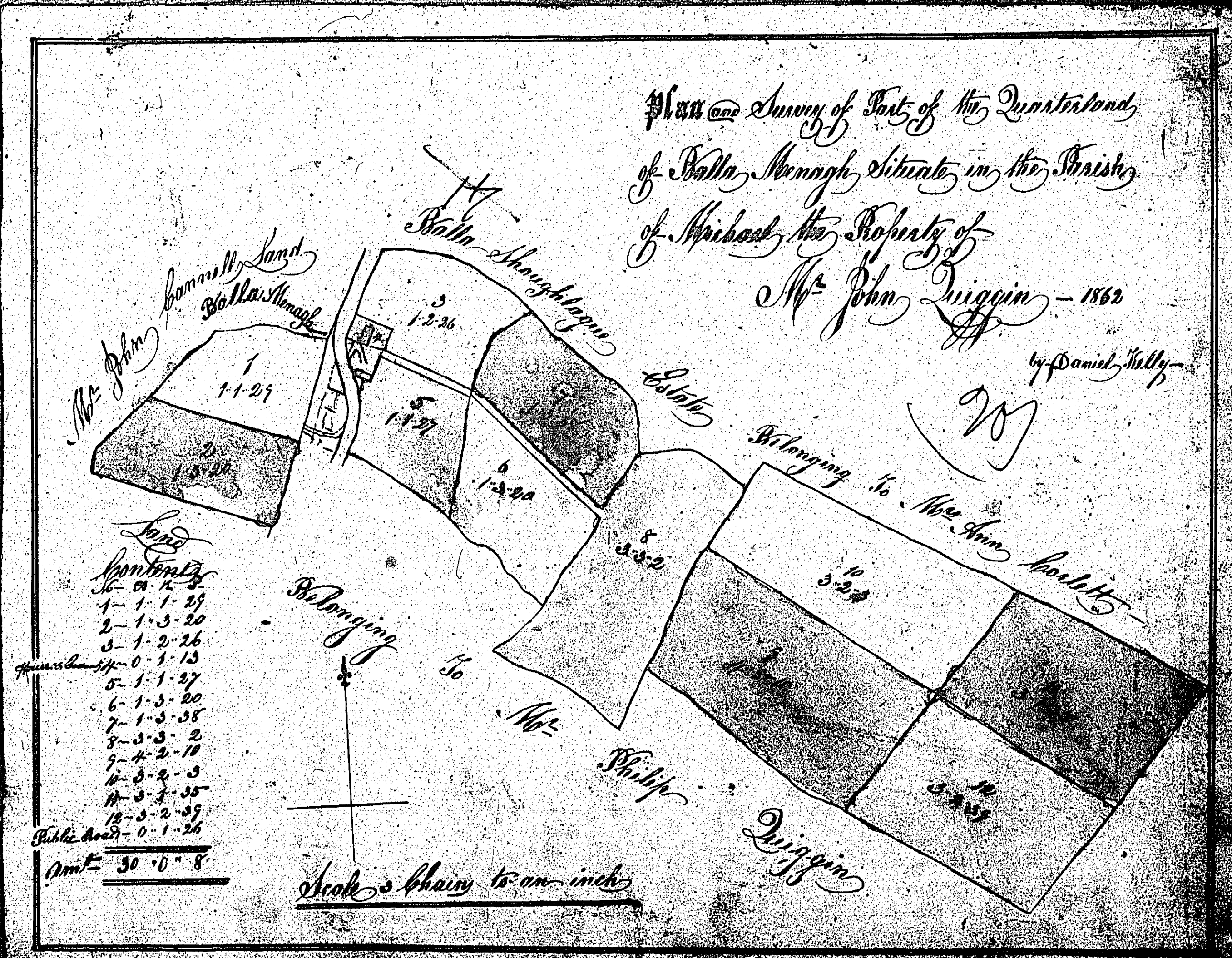
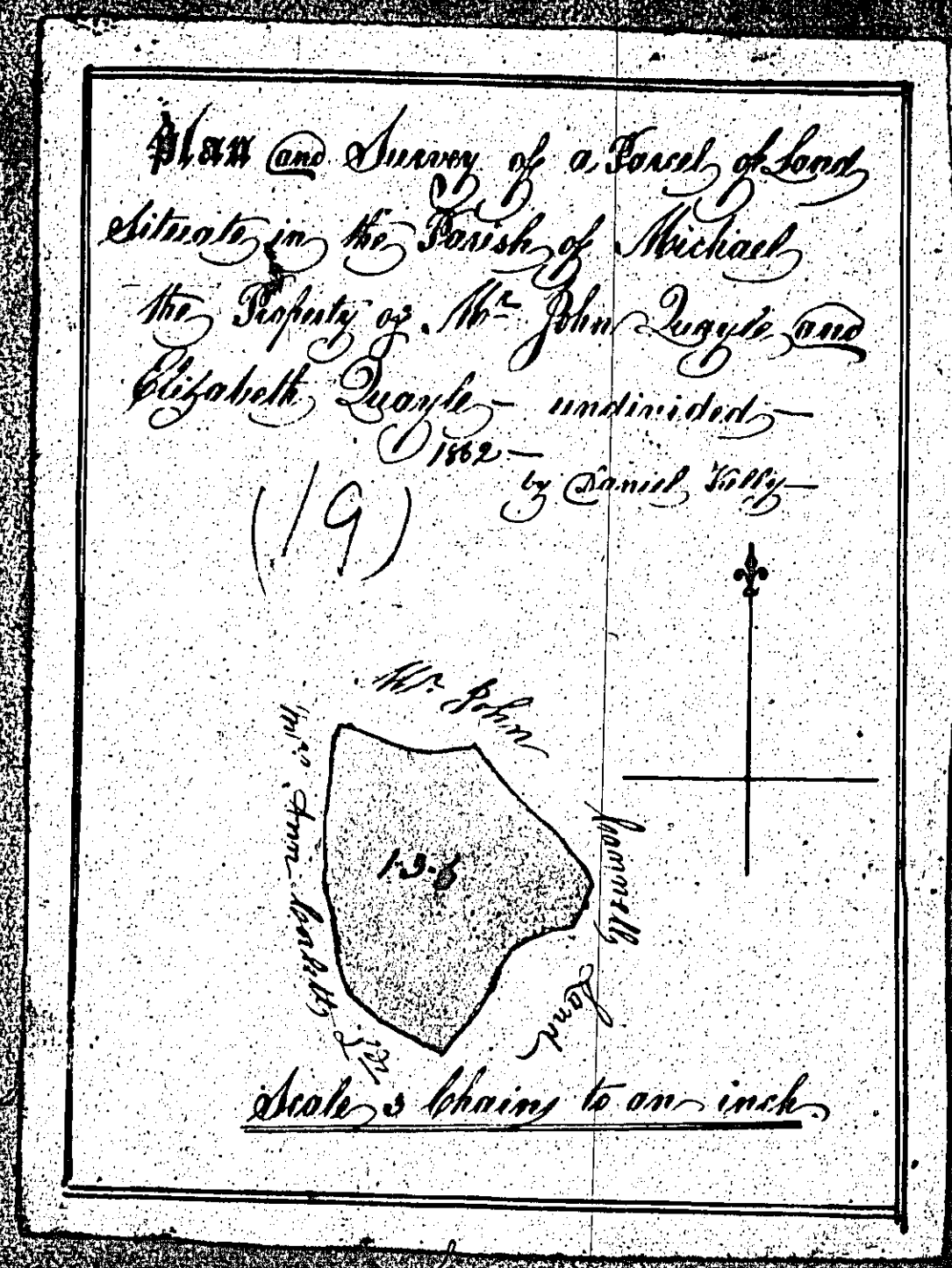
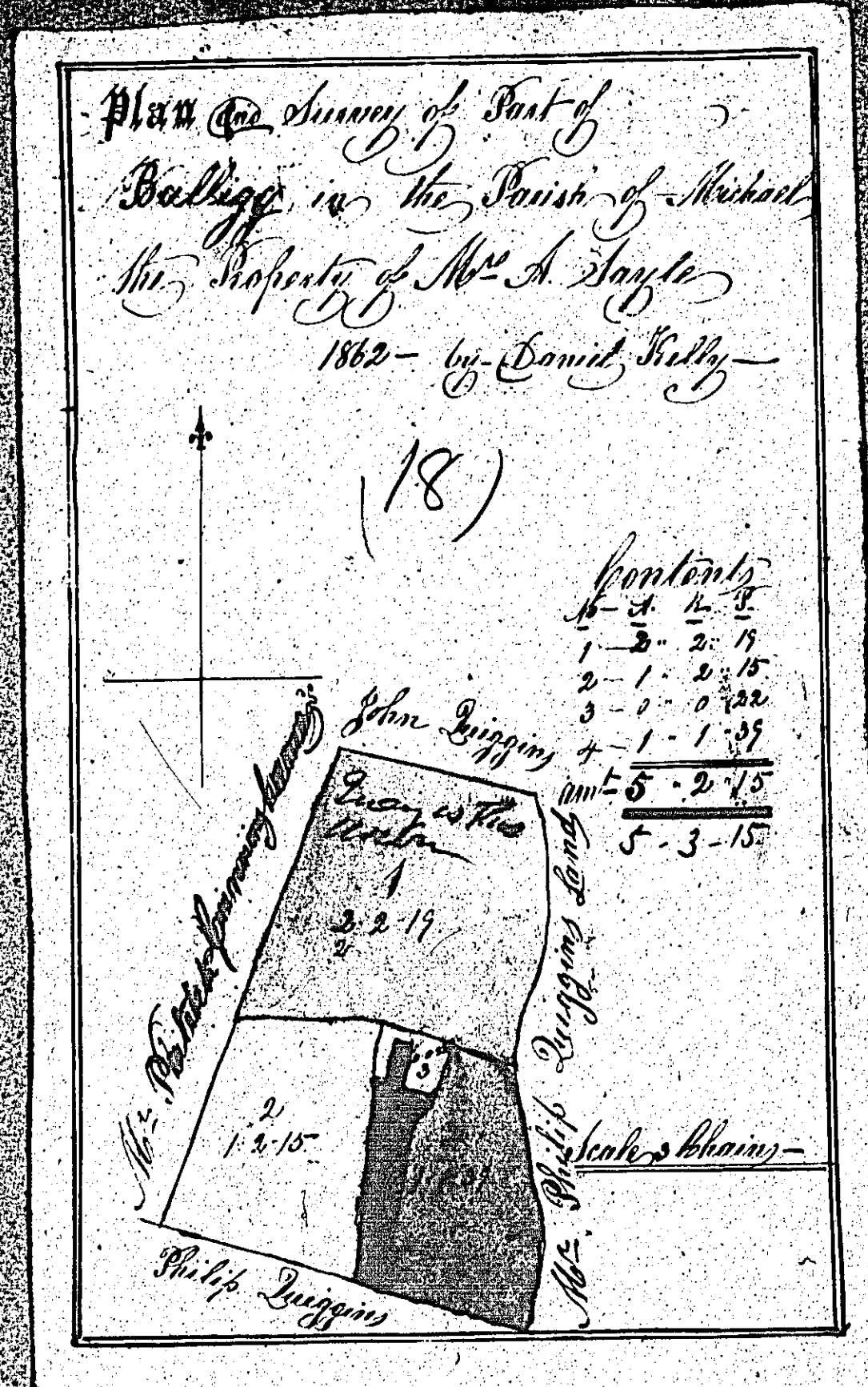

ISLE OF MAN GOVERNMENT: GENERAL REGISTRY

ASYLUM PLANS: PARISH OF MICHAEL

Original coloured

1:23

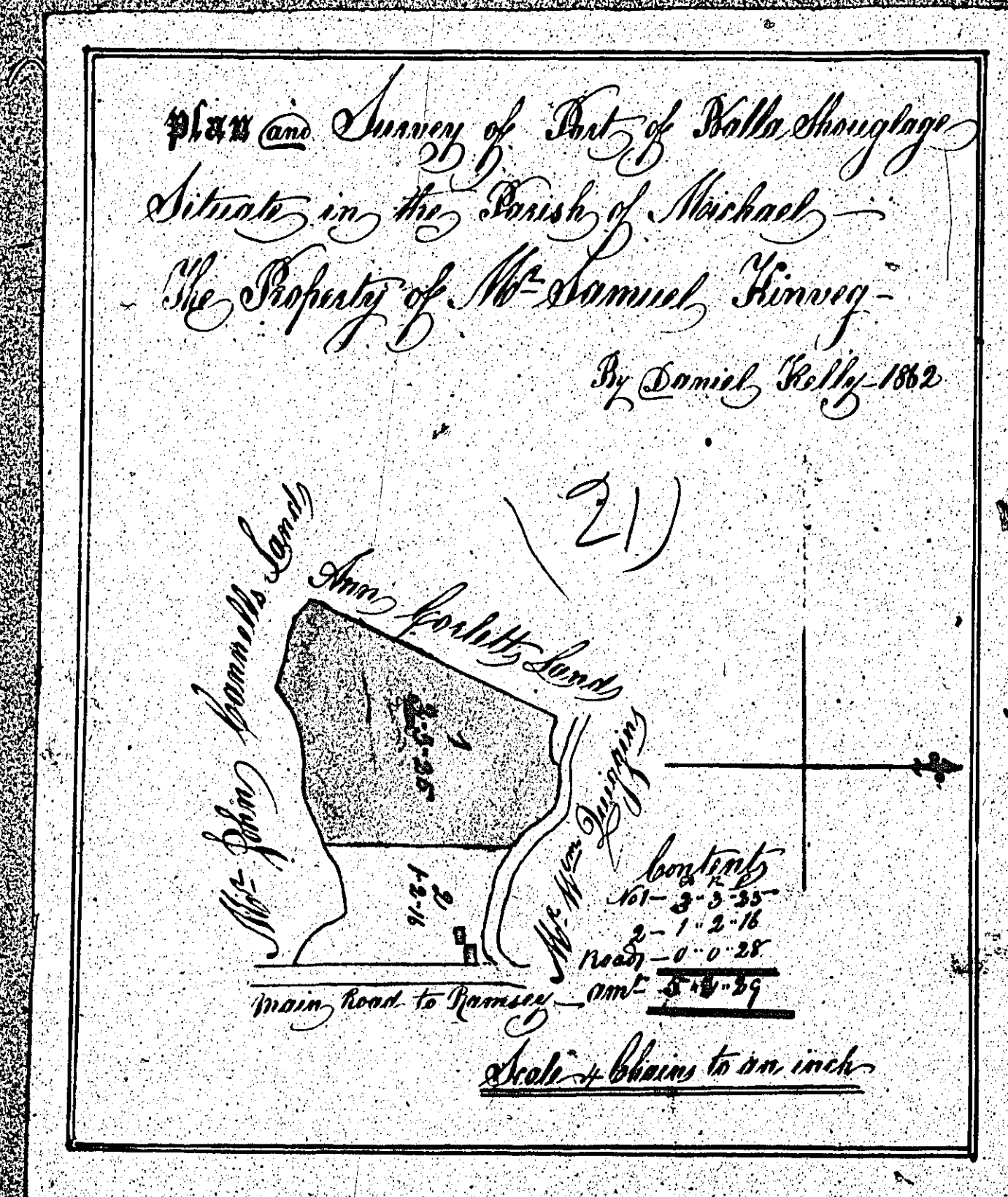

ISLE OF MAN GOVERNMENT: GENERAL REGISTRY

ASYLUM PLANS: PARISH OF MICHAEL

Original coloured

1:23

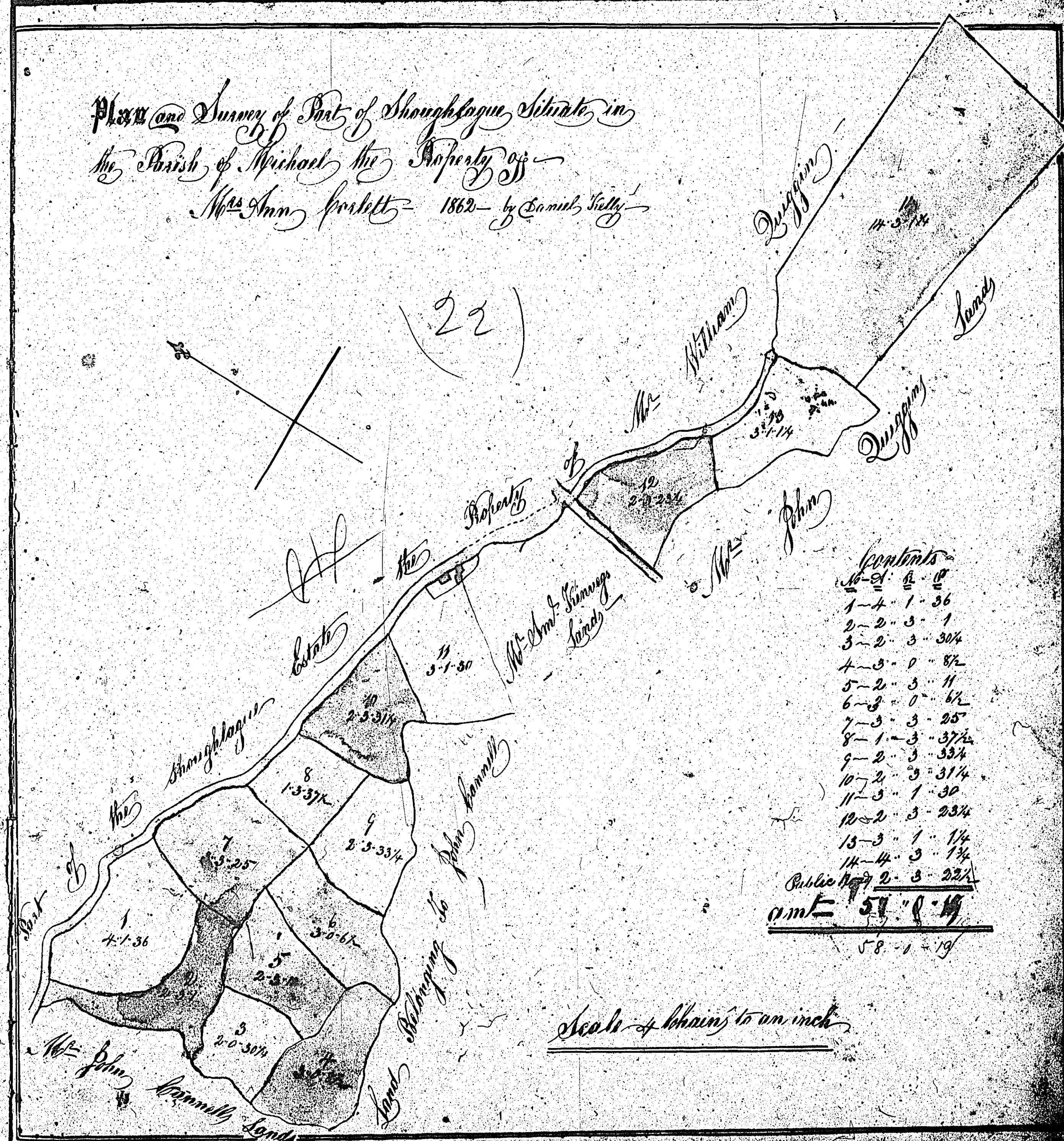

ISLE OF MAN GOVERNMENT: GENERAL REGISTRY

ASYLUM PLANS: PARISH OF MICHAEL

Original coloured

1:23

