

ISLE OF MAN GOVERNMENT: GENERAL REGISTRY

ASYLUM PLANS: PARISH OF MALEW

Originals coloured

1:23

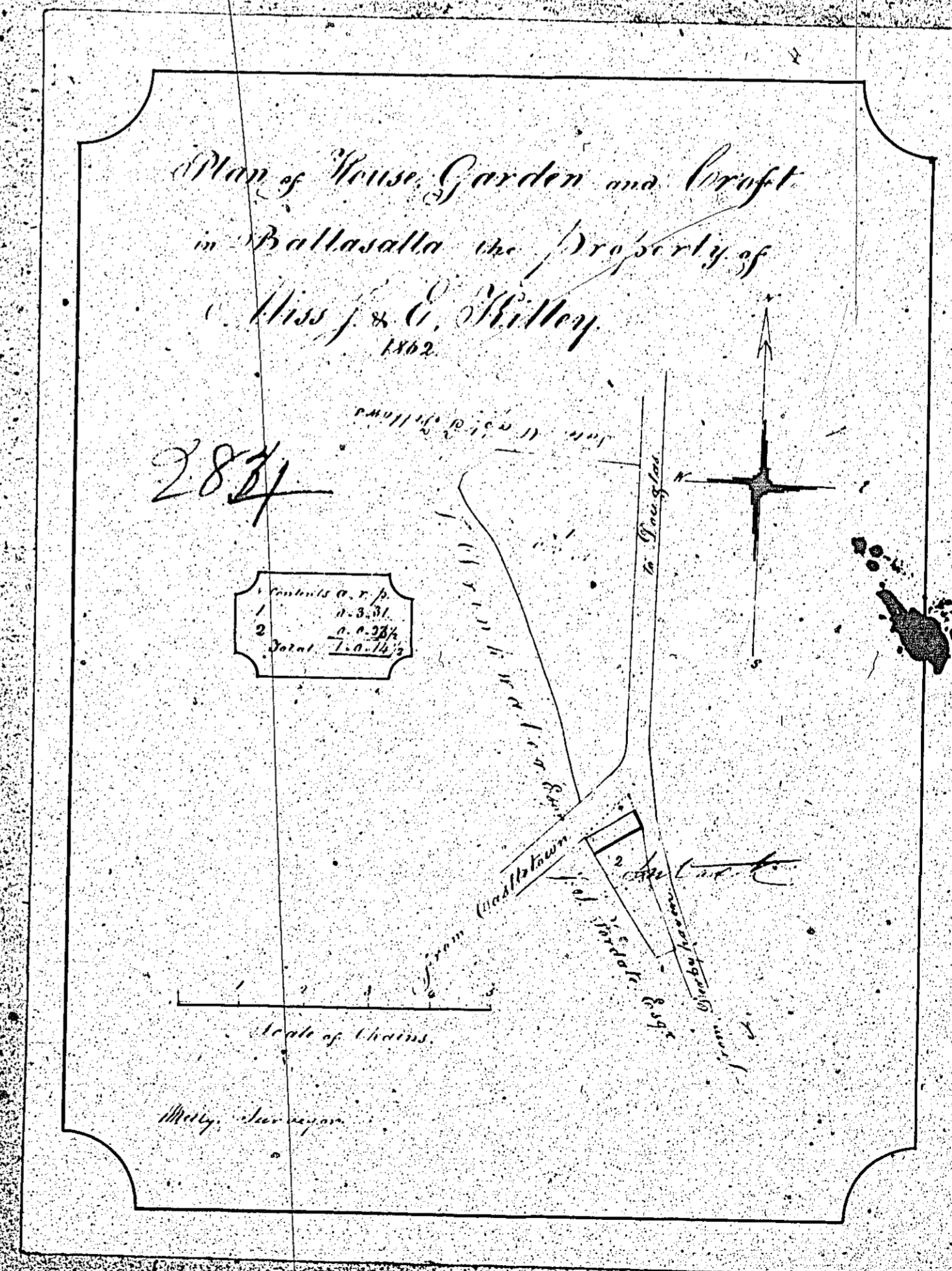
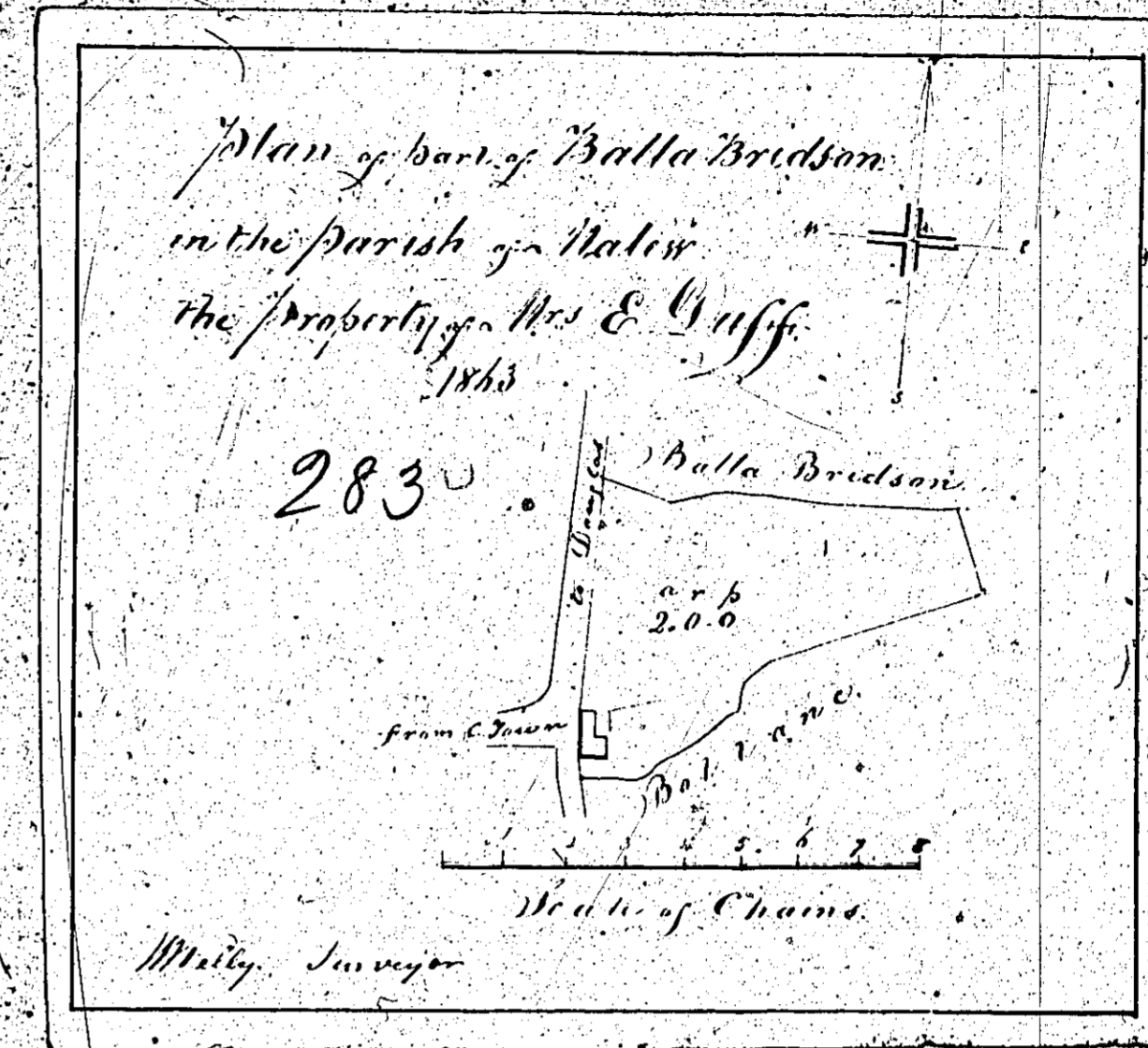

ISLE OF MAN GOVERNMENT: GENERAL REGISTRY

ASYLUM PLANS: PARISH OF MALEW

Original coloured

1:23

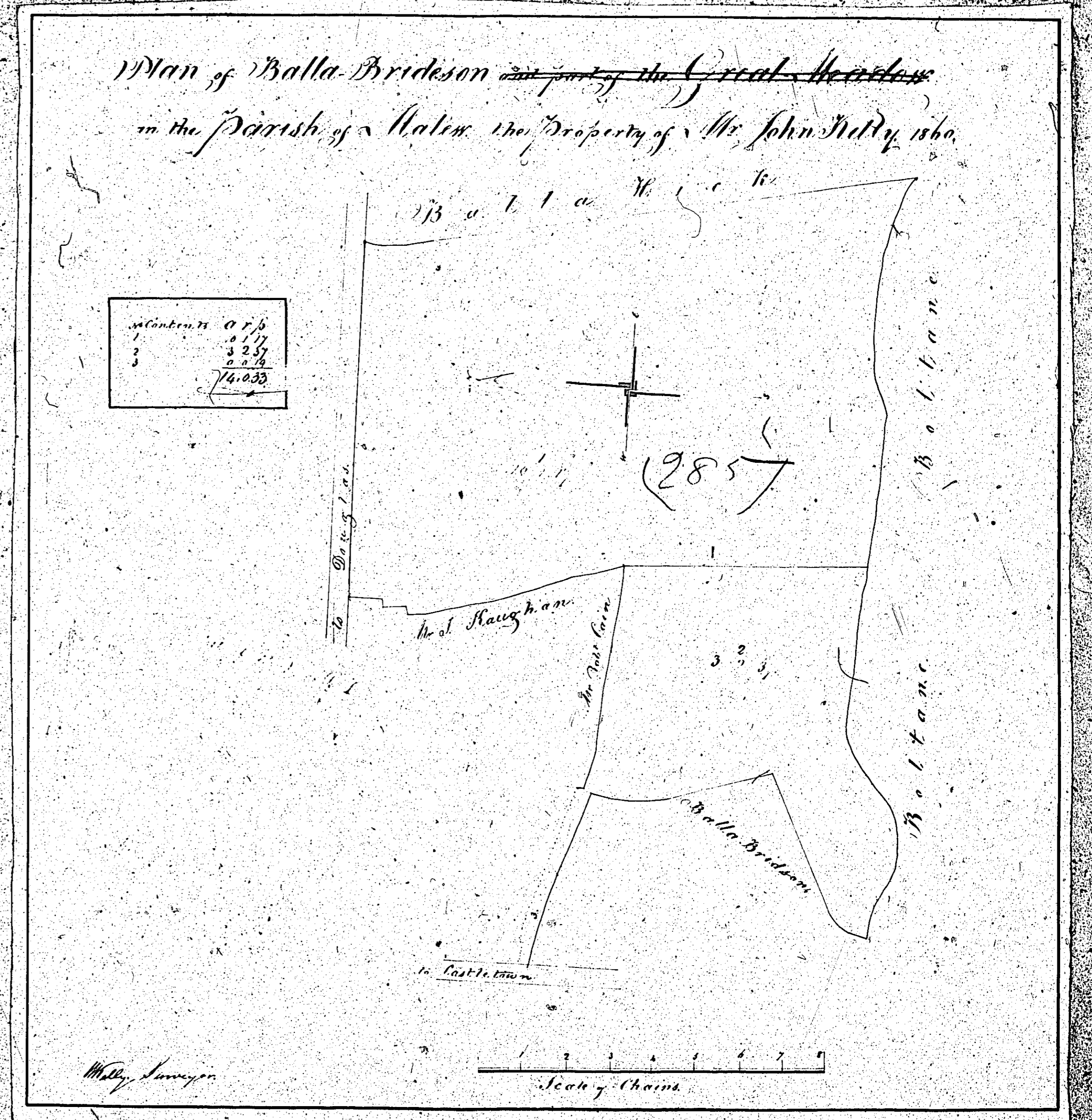

ISLE OF MAN GOVERNMENT: GENERAL REGISTRY

ASYLUM PLANS: PARISH OF MALEW

Original monotone

1:23

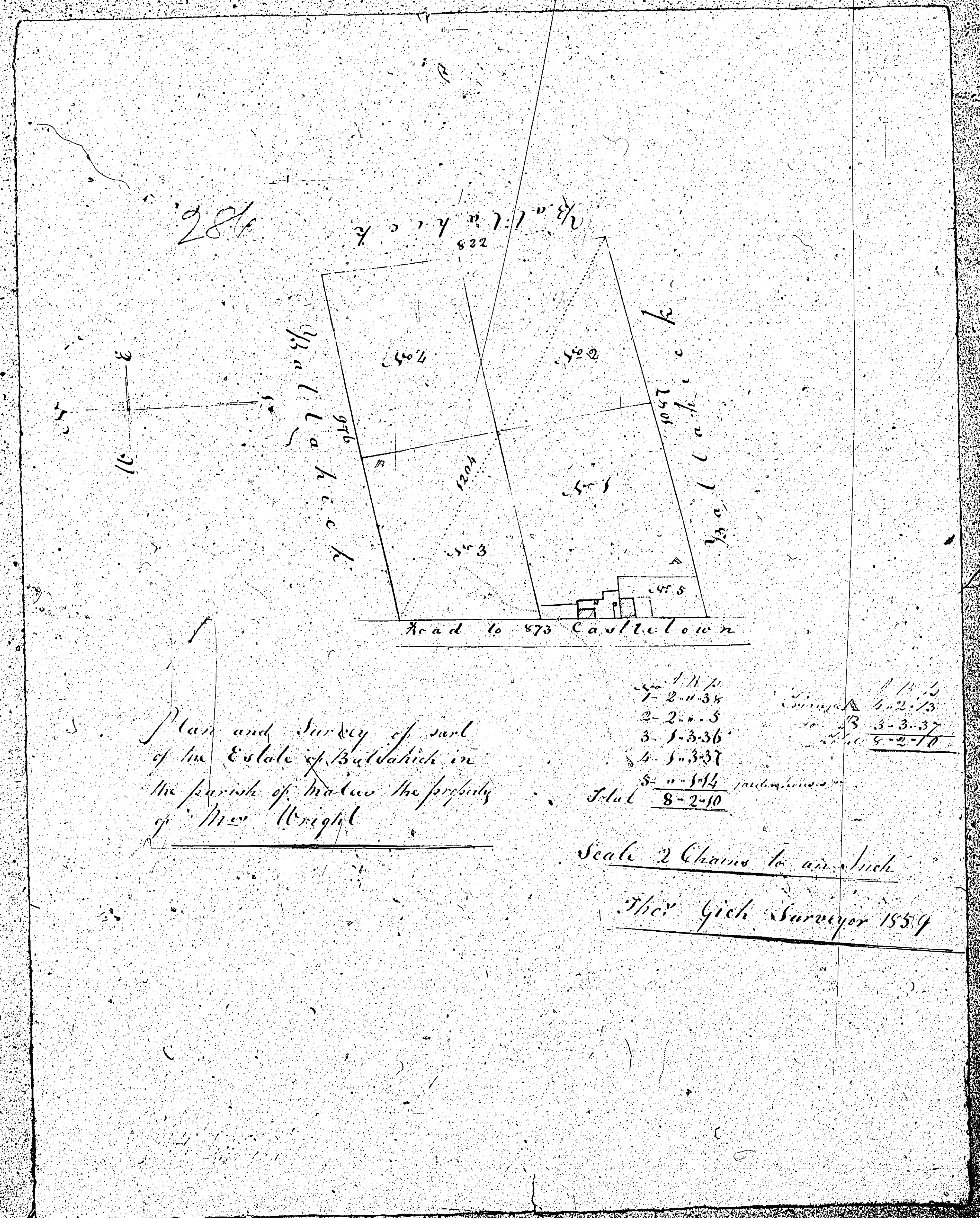



Contents.

No.	BALLAHICK.	A.	R.	P.	A.	R.	P.
1	5.0.18						
2	2.0.13						
3	2.1.0						
4	2.0.10						
B. Budson	5	3.8.35					
6	3.2.0						
7	2.1.30						
8	3.0.10						
9	4.3.20						
10	4.3.32						
11	5.3.12						
12	5.3.30						
13	3.0.35						
B. Dick	14	3.0.6					
15	0.1.17						
16	7.2.12						
17	8.0.30						
18	0.2.10						
19	4.0.33						
20	4.3.27						
21	5.0.0						
22	1.0.5						
B. Budson	23	2.1.24					
24	2.0.12						
25	3.0.30						
26	3.0.30						
27	1.3.28						
28	3.0.4						
B. Dick	29	4.1.30					
30	2.3.30						
31	2.0.10						
Proportion of Public Road		0.3.6	110.0.30				
BOLTHANE.							
A	0.2.30						
B	0.2.6						
C	16.2.20						
D	9.0.30						
E	7.2.26						
F	3.2.10						
G	6.1.22						
Proportion of Public Road		0.2.4	45.0.30				
Total			155.1.20				

BALLAHICK and BULTMANE
 in the Parish of
Malew
 THE PROPERTY OF

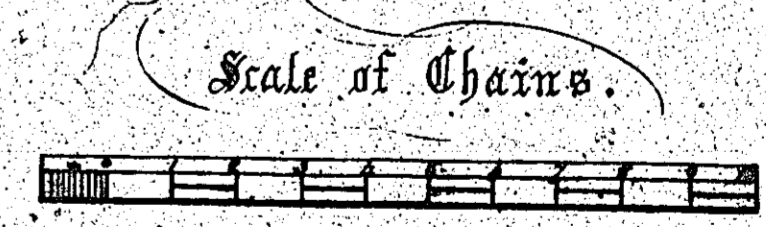

ISLE OF MAN GOVERNMENT: GENERAL REGISTRY
ASYLUM PLANS: PARISH OF MALEW

Original coloured 1:23

Copied from J. Parris Survey in 1850, for Valuers of Towns under Lunatic Asylum Act. By James Woods, Surveyor, 1863.

ISLE OF MAN GOVERNMENT: GENERAL REGISTRY

ASYLUM PLANS: PARISH OF MALEW

1:23

288 Original coloured

289 Original monotone

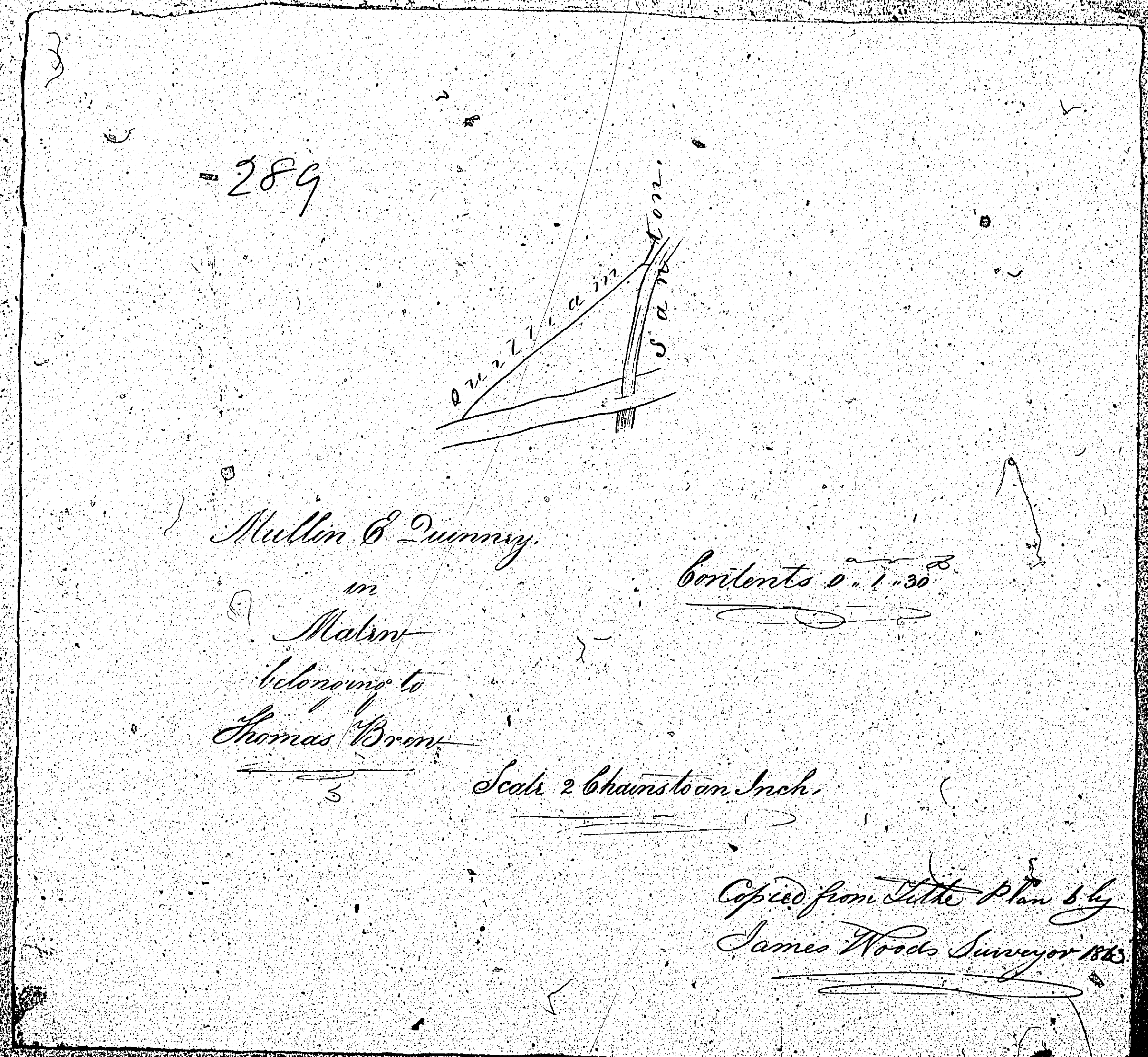
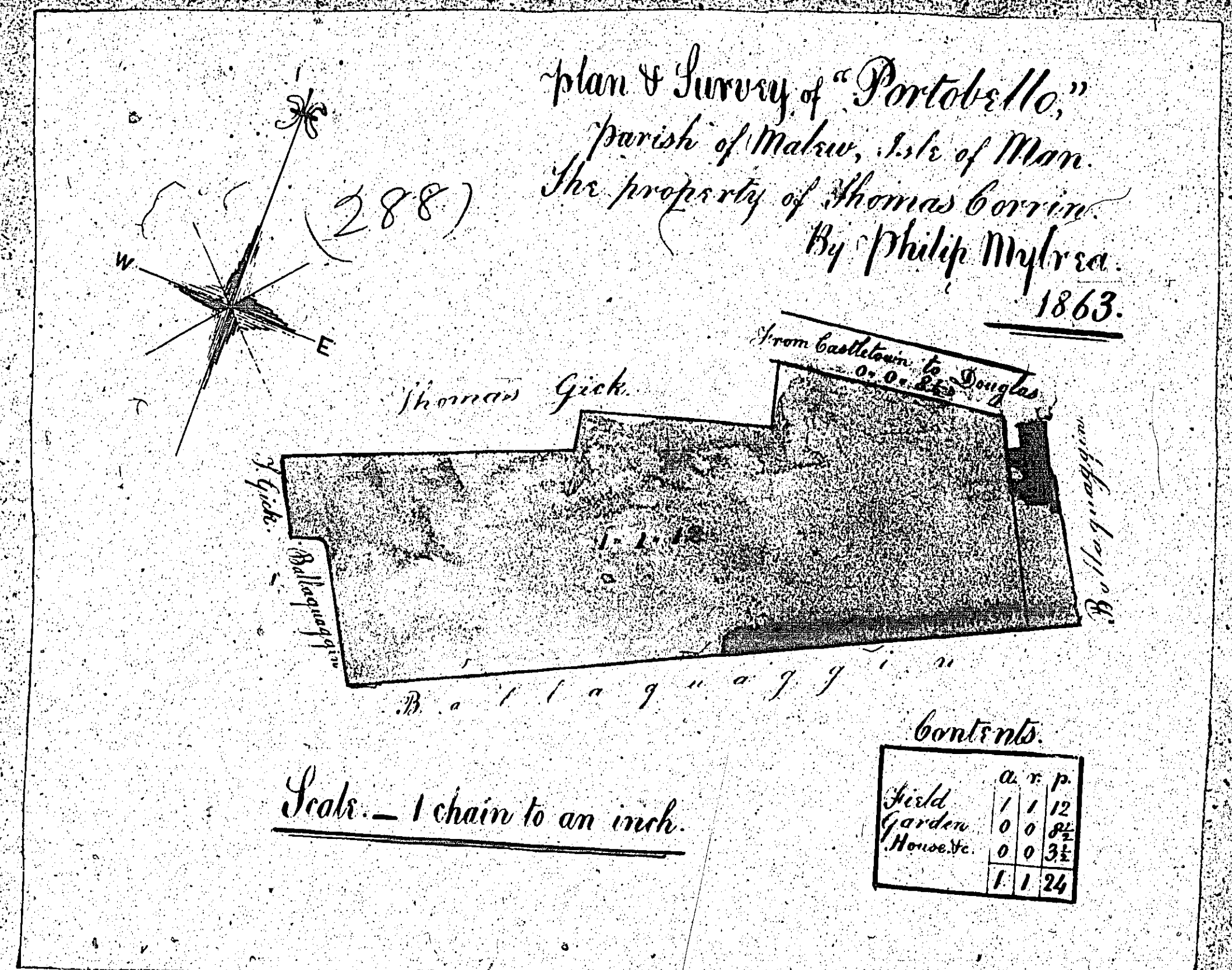

Plan of Ballaquaggin
 in the Parish of Malew the property of
 Mr. William Gish
 1862



Scale of Chains

Contents	
1	0 5 6
2	15 1 3
3	15 1 3
4	15 1 3
5	15 1 3
6	15 1 3
7	15 1 3
8	15 1 3
9	15 1 3
10	15 1 3
11	15 1 3
12	15 1 3
13	15 1 3
14	15 1 3
15	15 1 3
16	15 1 3
17	15 1 3
18	15 1 3
19	15 1 3
20	15 1 3
21	15 1 3
22	15 1 3
23	15 1 3
24	15 1 3
25	15 1 3
26	15 1 3
27	15 1 3
28	15 1 3
29	15 1 3
30	15 1 3
31	15 1 3
32	15 1 3
33	15 1 3
34	15 1 3
35	15 1 3
36	15 1 3
37	15 1 3
38	15 1 3
39	15 1 3
40	15 1 3
41	15 1 3
42	15 1 3
43	15 1 3
44	15 1 3
45	15 1 3
46	15 1 3
47	15 1 3
48	15 1 3
49	15 1 3
50	15 1 3
51	15 1 3
52	15 1 3
53	15 1 3
54	15 1 3
55	15 1 3
56	15 1 3
57	15 1 3
58	15 1 3
59	15 1 3
60	15 1 3
61	15 1 3
62	15 1 3
63	15 1 3
64	15 1 3
65	15 1 3
66	15 1 3
67	15 1 3
68	15 1 3
69	15 1 3
70	15 1 3
71	15 1 3
72	15 1 3
73	15 1 3
74	15 1 3
75	15 1 3
76	15 1 3
77	15 1 3
78	15 1 3
79	15 1 3
80	15 1 3
81	15 1 3
82	15 1 3
83	15 1 3
84	15 1 3
85	15 1 3
86	15 1 3
87	15 1 3
88	15 1 3
89	15 1 3
90	15 1 3
91	15 1 3
92	15 1 3
93	15 1 3
94	15 1 3
95	15 1 3
96	15 1 3
97	15 1 3
98	15 1 3
99	15 1 3
100	15 1 3
Area	96 3 32

Malew Surveyor

ISLE OF MAN GOVERNMENT: GENERAL REGISTRY

ASYLUM PLANS: PARISH OF MALEW

Original coloured

1:23