

ISLE OF MAN GOVERNMENT: GENERAL REGISTRY

ASYLUM PLANS: PARISH OF MALEW

Original coloured

1:23

(180)

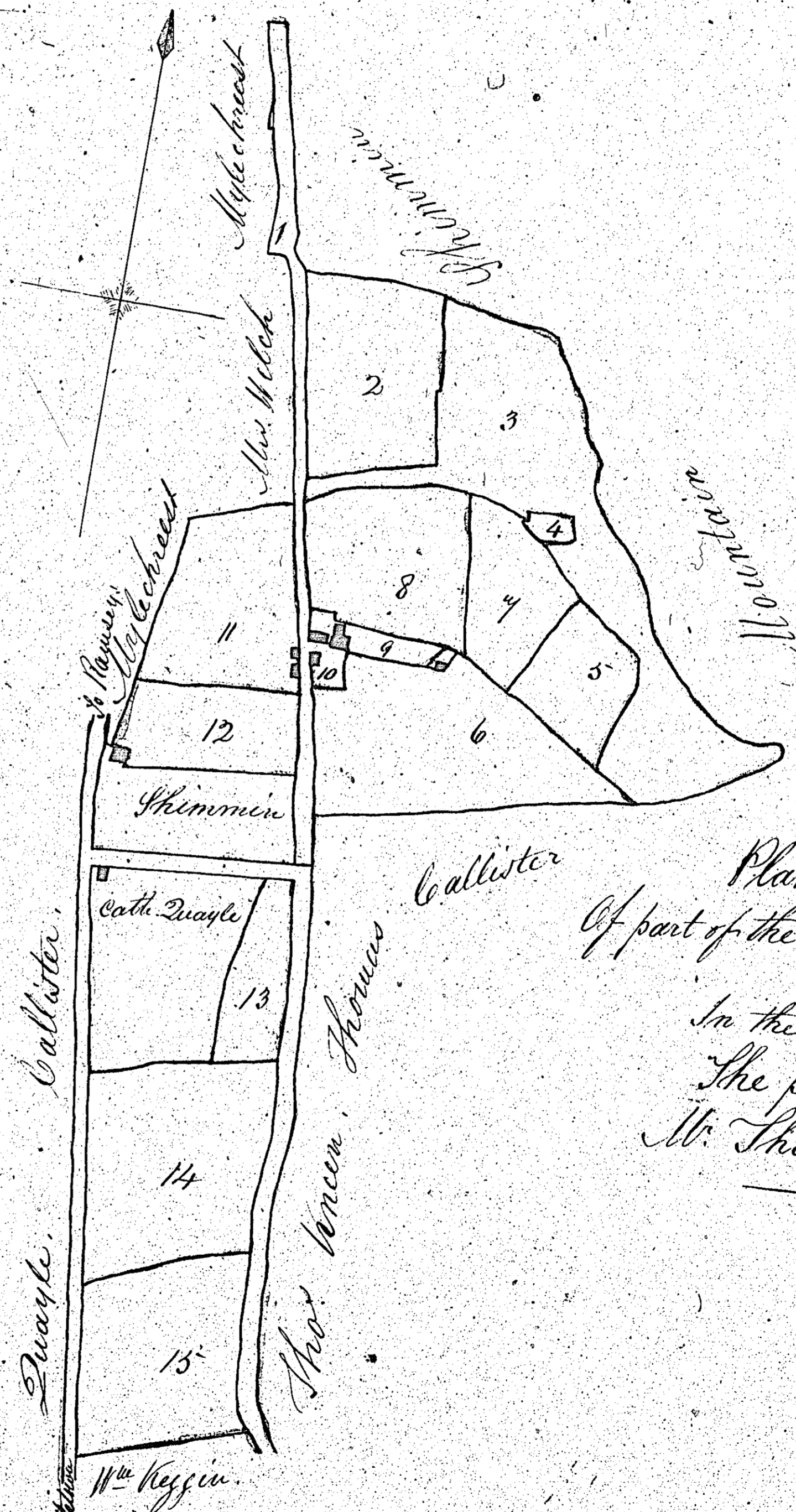

No.	Contains	a. r. p.
1		0.3.30
2		2.0.6
3		4.1.28
4		0.0.18
5		6.3.25
6		2.5.15
7		1.0.20
8		0.1.4
9		0.0.35
10		1.3.32
11		1.1.0
12		1.0.20
13		2.3.24
14		2.1.16
15		
Total		24.0.37

Plan and Survey  
Of part of the Estate of Glass Park  
Situate in  
In the Parish of Malew  
The property of  
Mr. Tho<sup>s</sup> Keegan  
— " —

0 1 2 3 4 5 6 7 8 9 10

3 inches or 66 yards to an Inch  
From a plan by Tho<sup>s</sup> Keegan in 1840. Copied and altered by W<sup>m</sup> Keegan 1861.

ISLE OF MAN GOVERNMENT: GENERAL REGISTRY

ASYLUM PLANS: PARISH OF MALEW

Originals coloured, marked

1:23

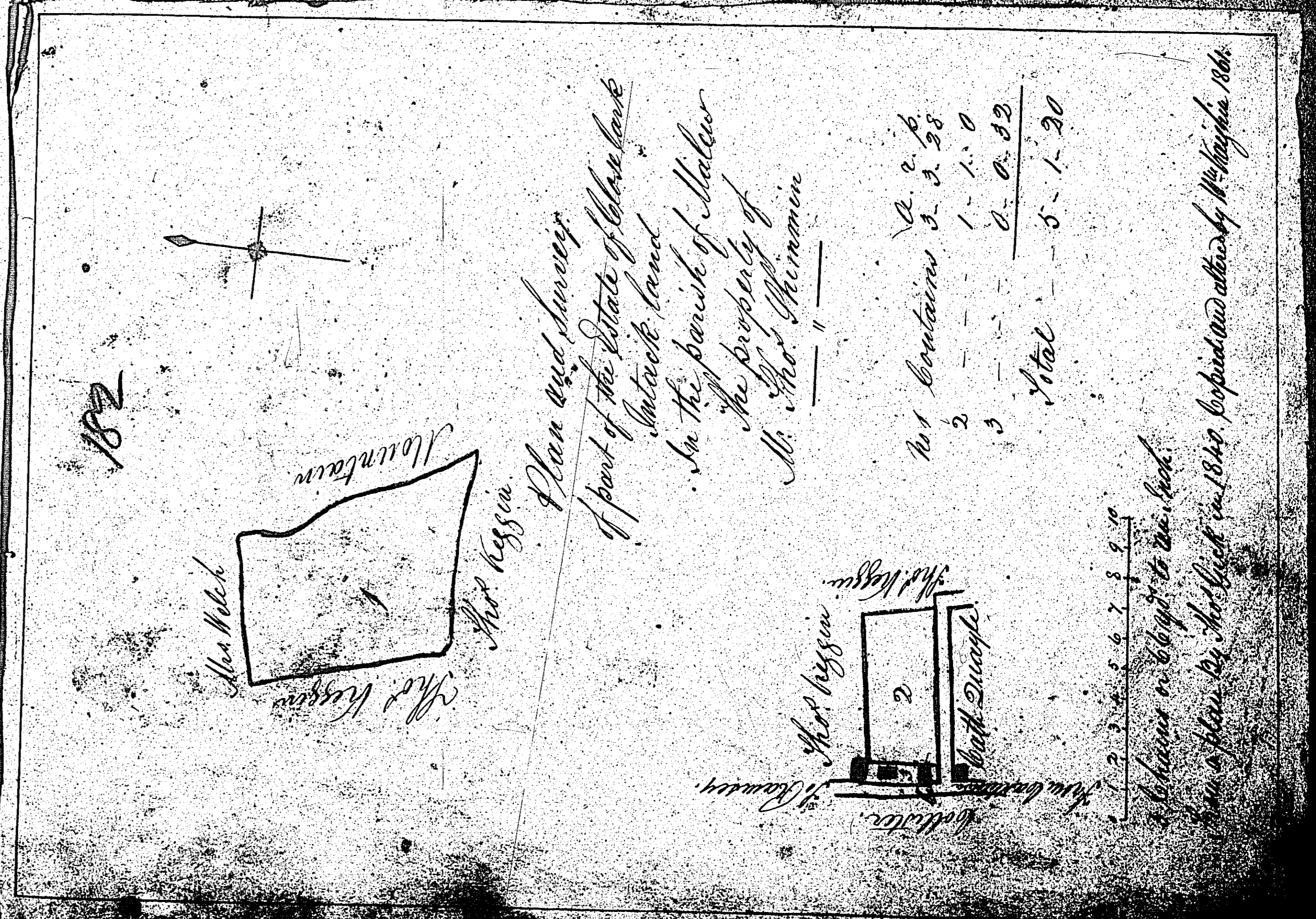
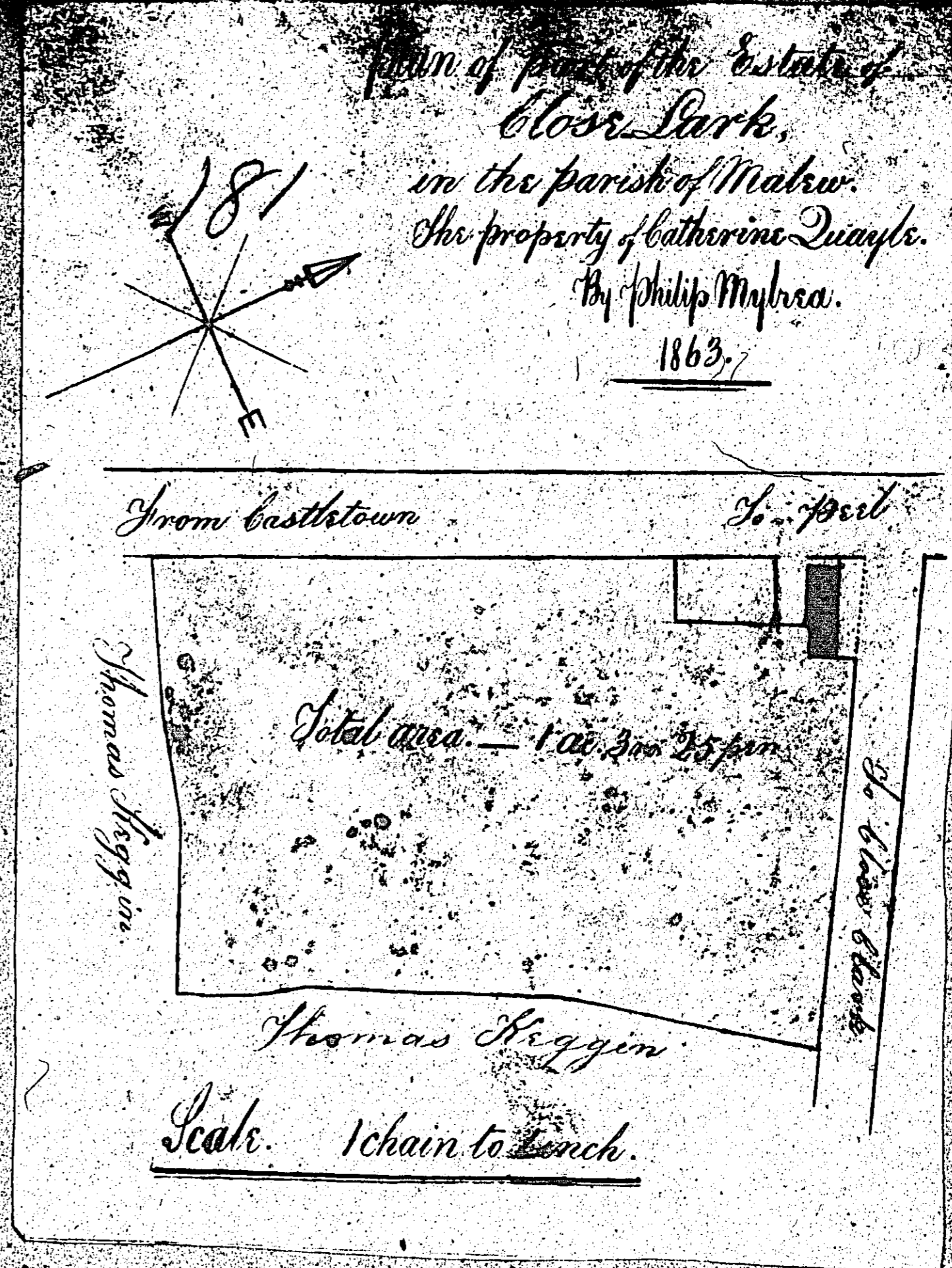

ISLE OF MAN GOVERNMENT: GENERAL REGISTRY

ASYLUM PLANS: PARISH OF MALEW

Originals coloured

1:23

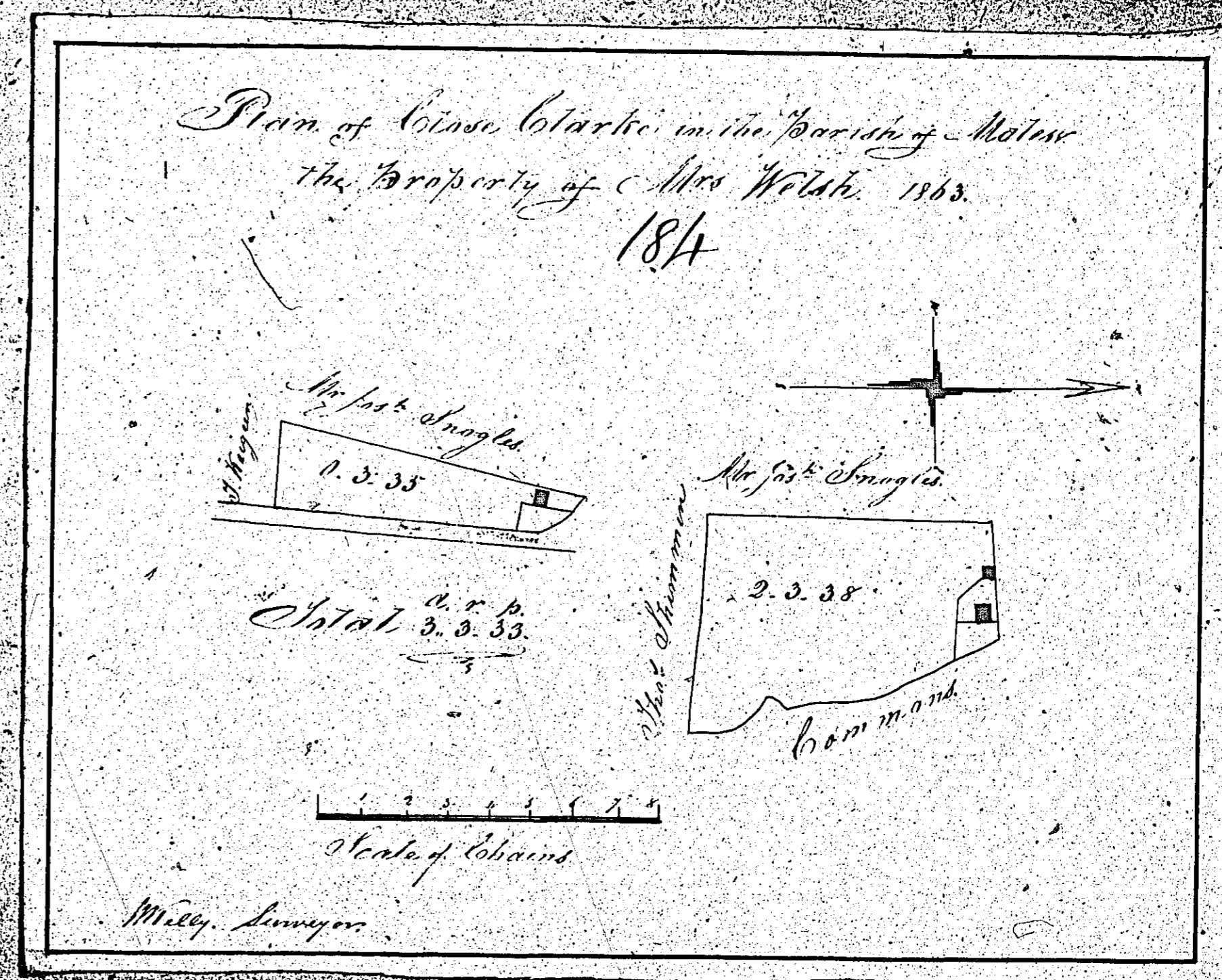
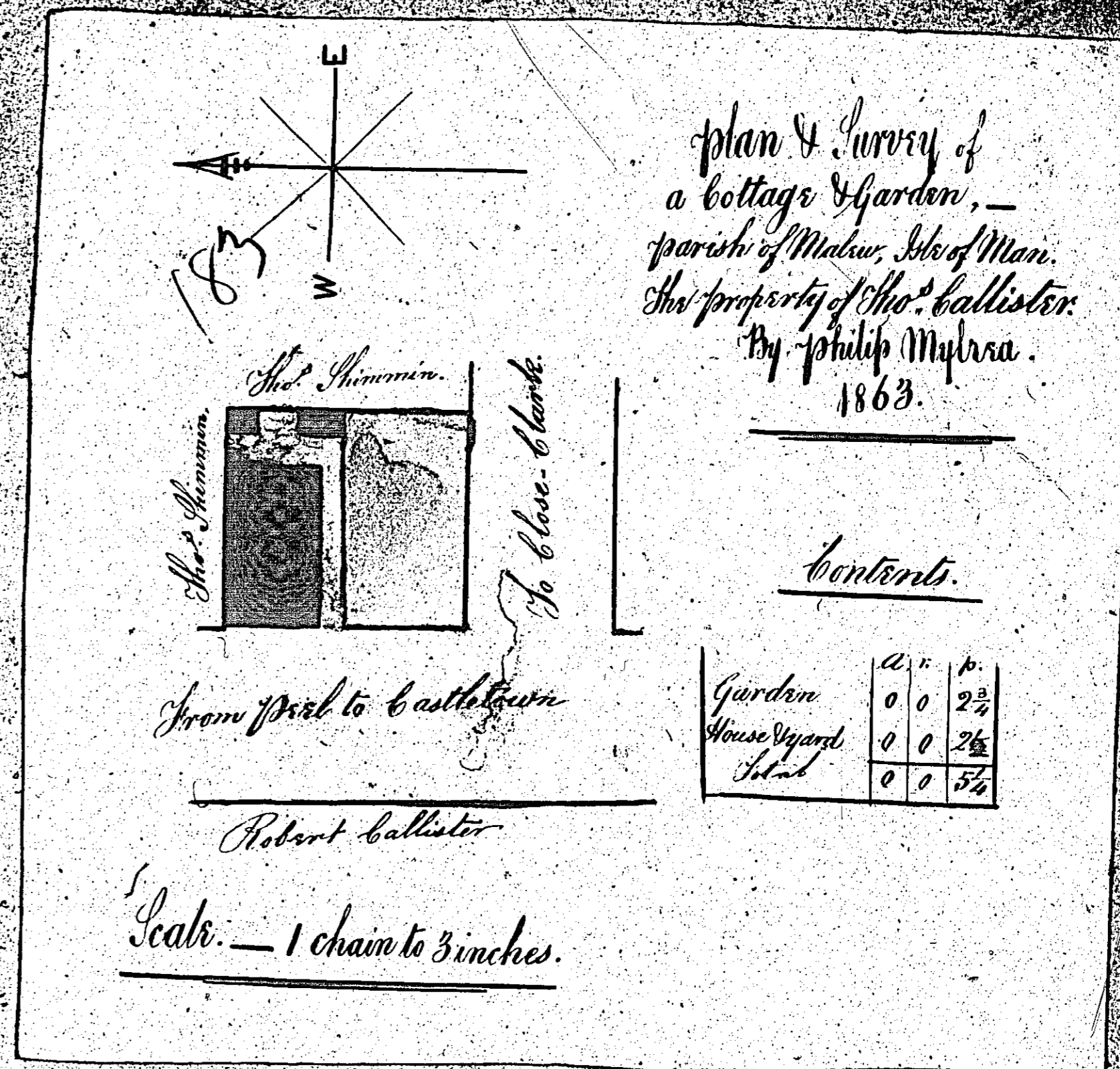

ISLE OF MAN GOVERNMENT: GENERAL REGISTRY

ASYLUM PLANS: PARISH OF MALEW

Originals coloured

1:23

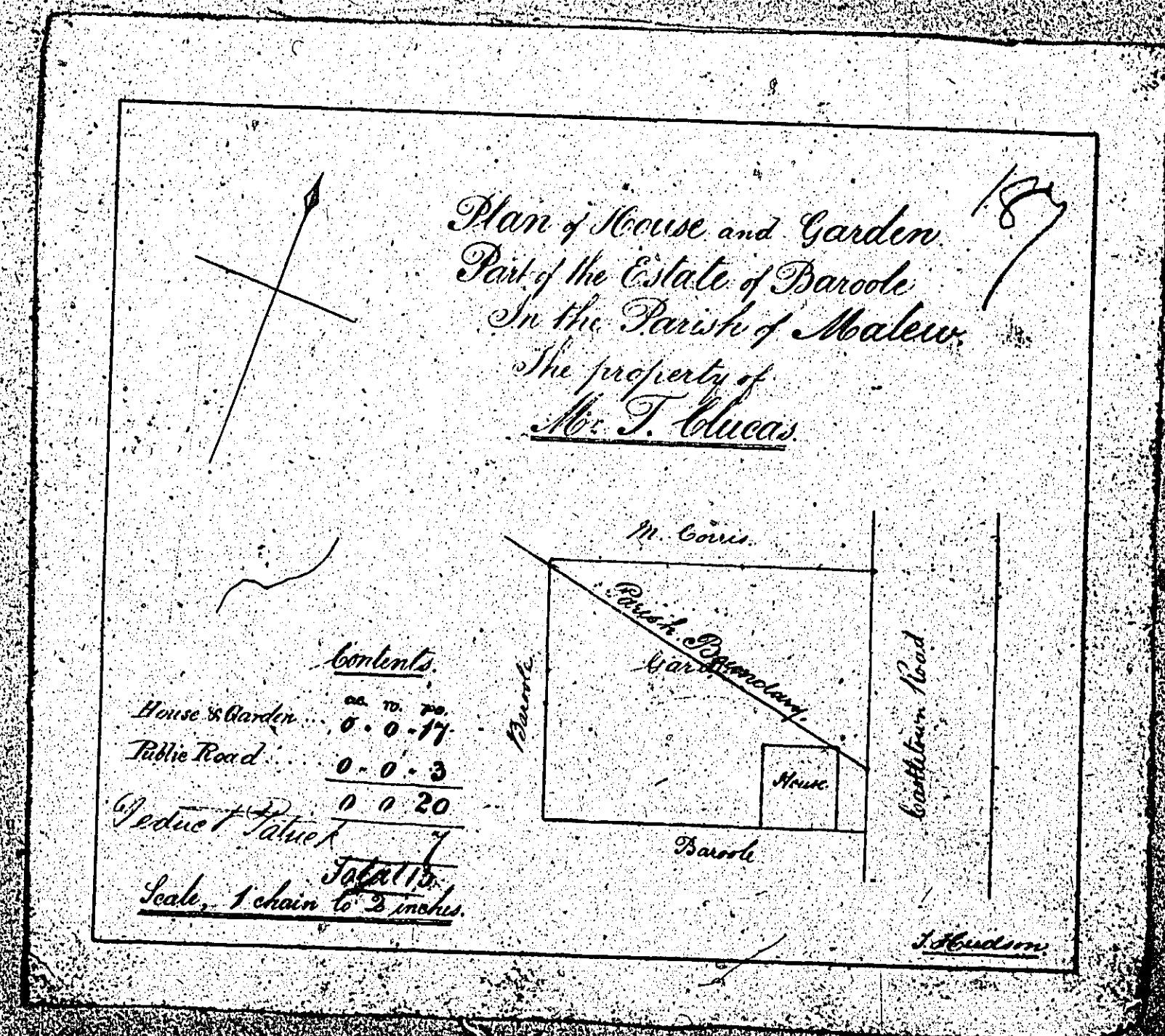
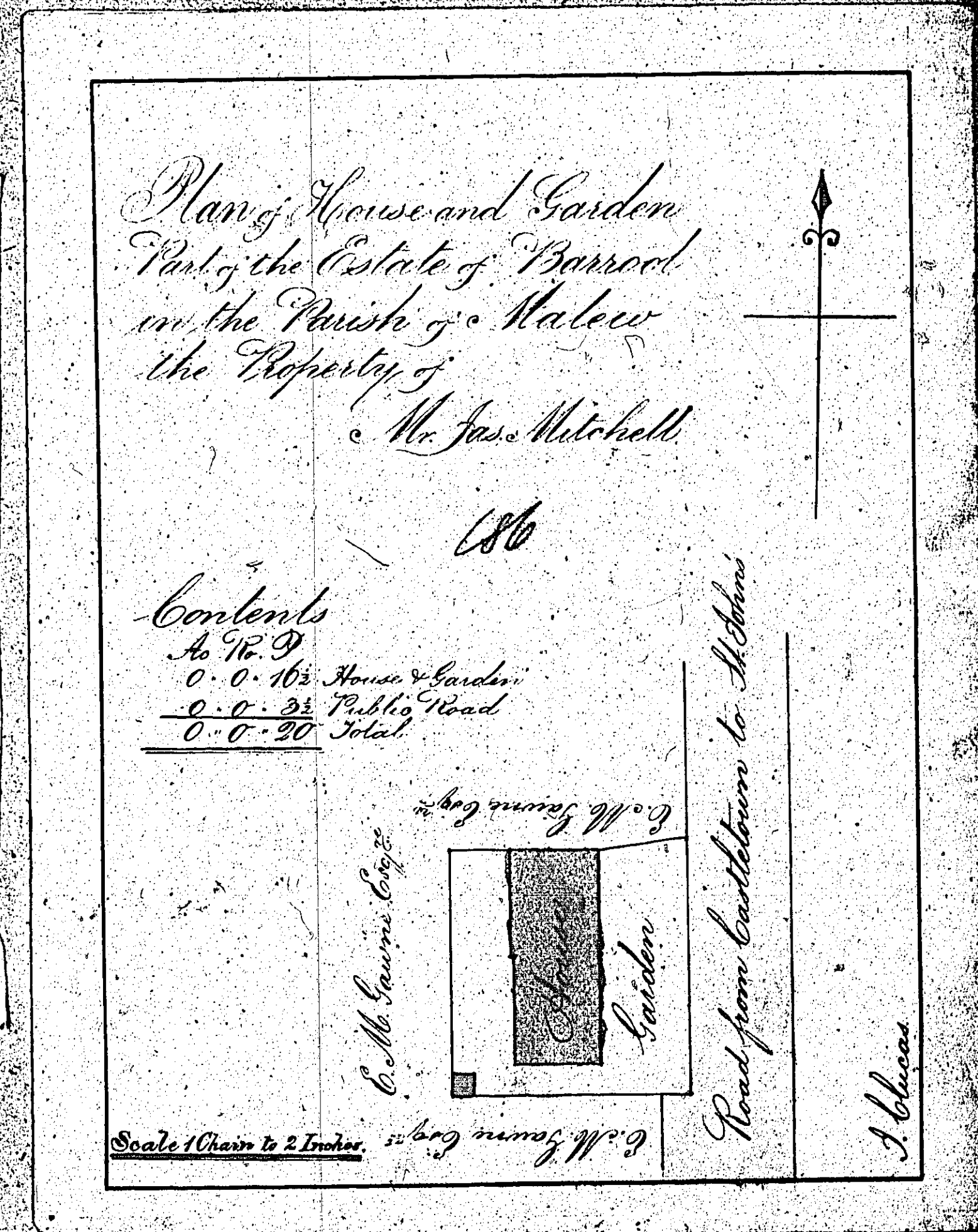
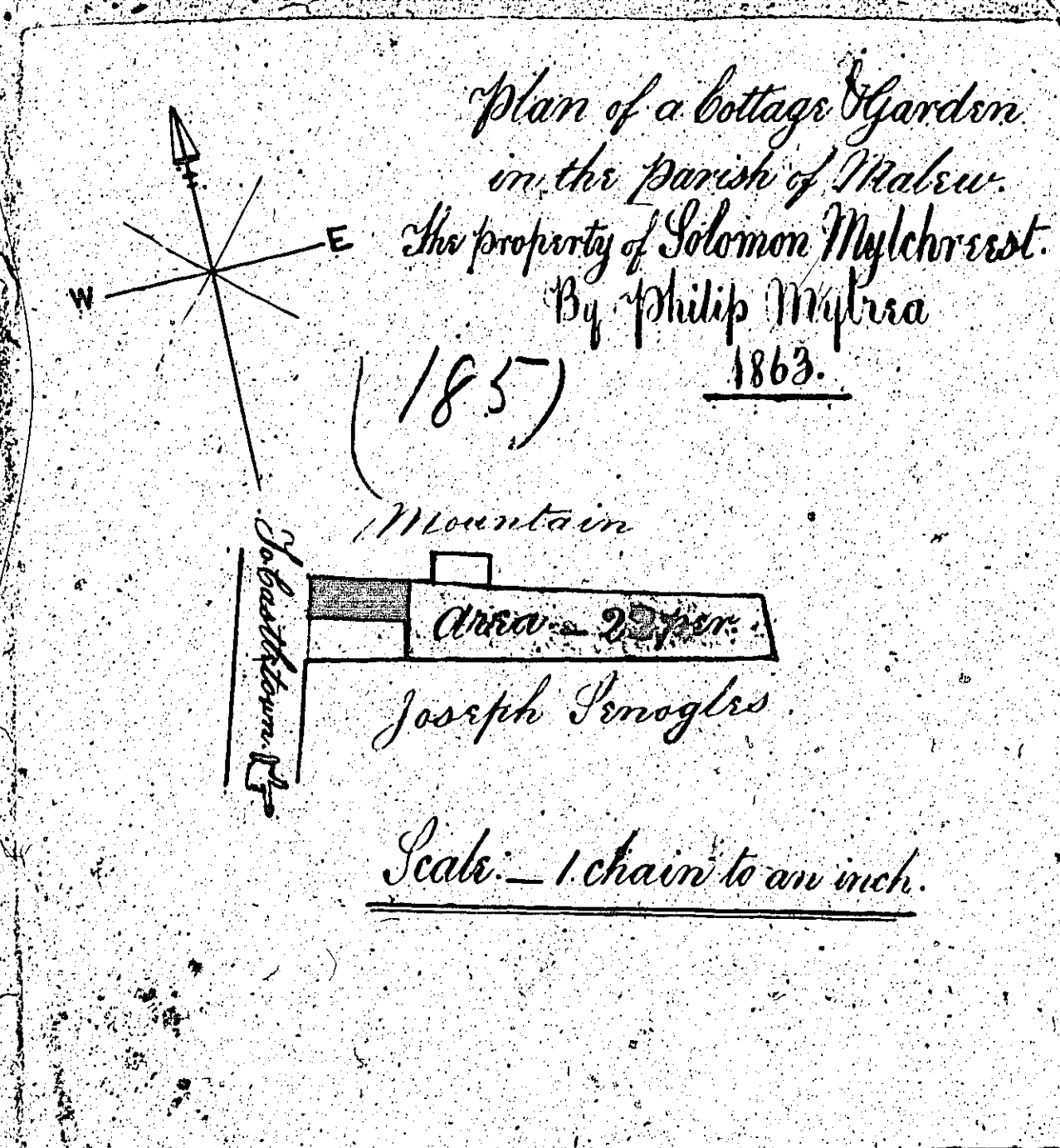

ISLE OF MAN GOVERNMENT: GENERAL REGISTRY

ASYLUM PLANS: PARISH OF MALEW

Original coloured

1:23

*Plan and survey of the Part of the Estate  
of Bannock Estate in the Parish of Malew  
the Property of Genl. M. James Esq. 188.*

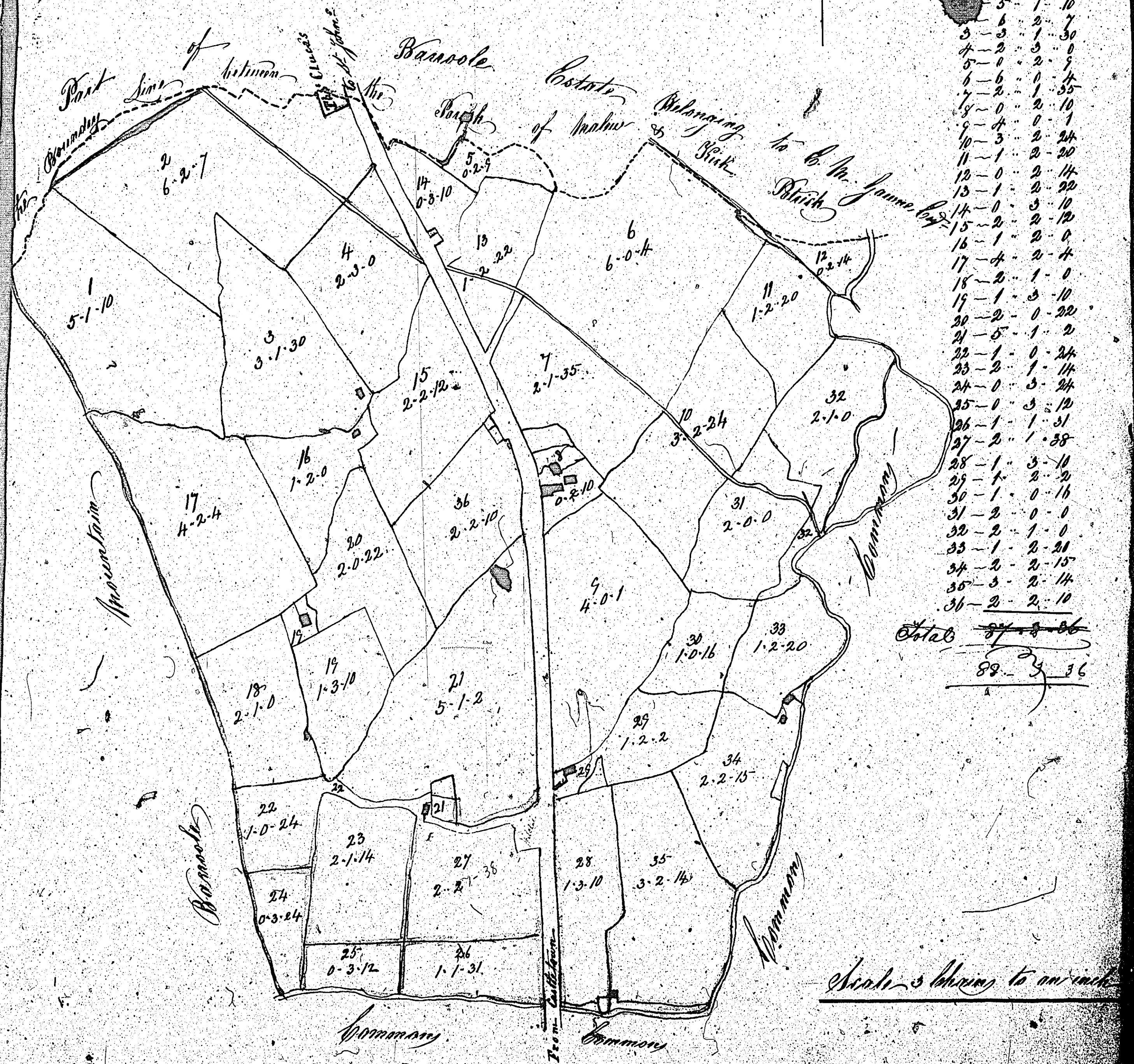

*Scale showing to an inch*

(189)

The following plan  
is not numbered  
but 189  
is on the backing.