

ISLE OF MAN GOVERNMENT: GENERAL REGISTRY

ASYLUM PLANS: PARISH OF MALEW

Original coloured

1:23

149

Plan and Survey of
 "part of Clough chor Moor,"
 Situate in Bourne quarter, parish of Malew,
 Isle of Man.
 The property of Samuel Heggins.
 By Philip Mybrea.
 1862.

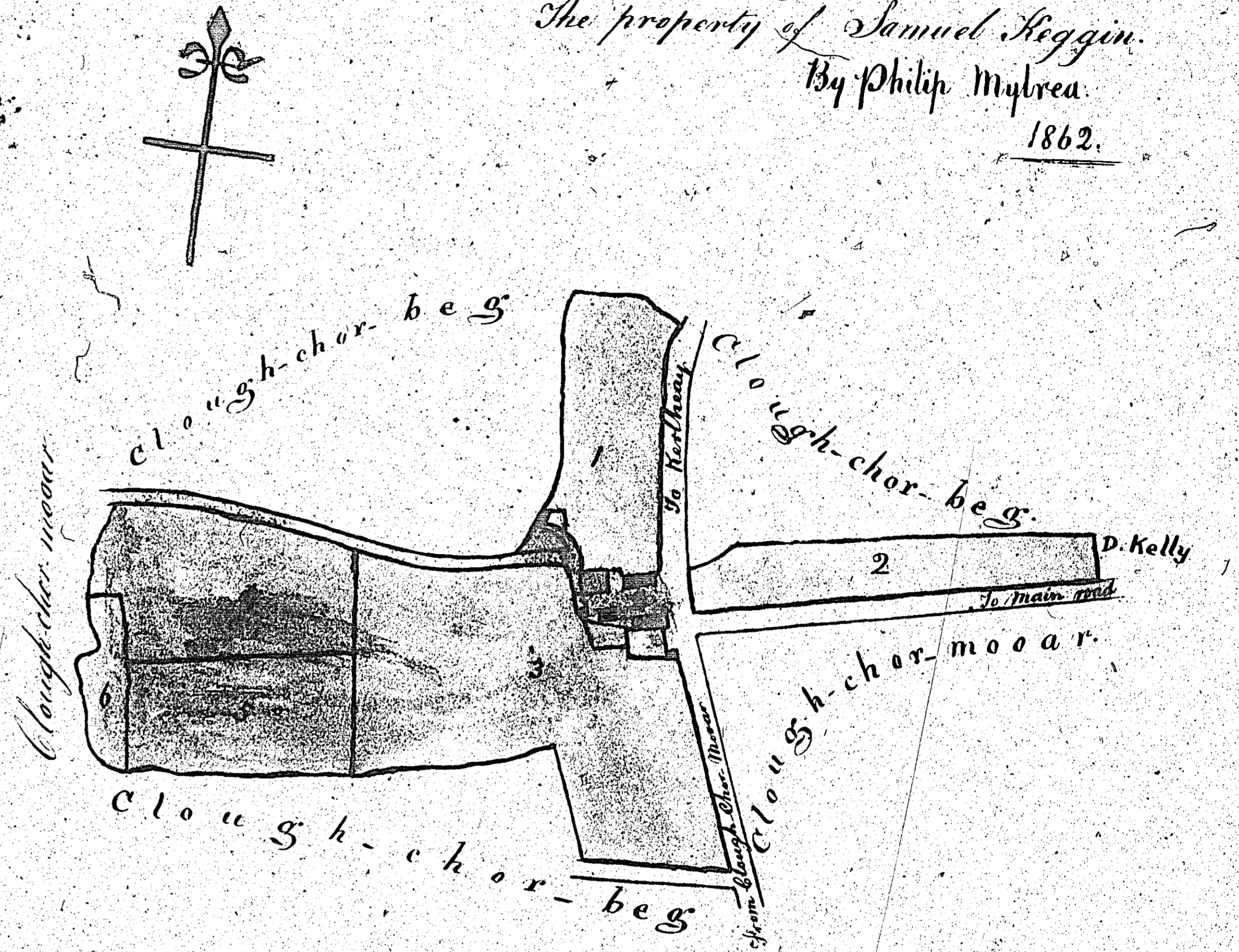
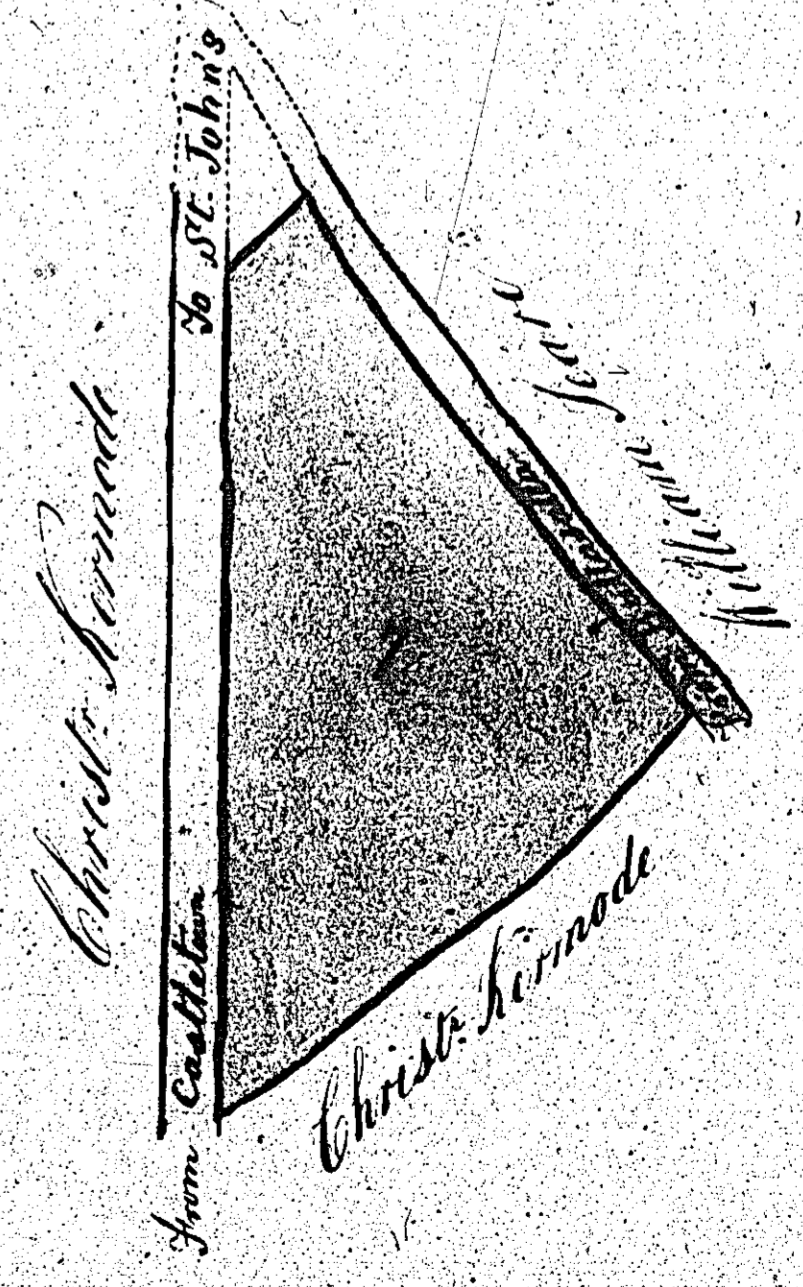

Table of Reference.

No.	A.	R.	P.
1	1	0	12
2	0	3	31
3	2	3	10
4	1	1	30
5	1	0	20
6	0	1	16
7	2	1	17
Yards, garden, &c.	0	0	34
Roads	0	3	17
Total	11	0	27

Scale 2 chains an inch.



ISLE OF MAN GOVERNMENT: GENERAL REGISTRY

ASYLUM PLANS: PARISH OF MALEW

Original coloured

1:23

*Plan of the Cortes
In the Parish of Malew
The Property of John Kelly Esq.
1863*

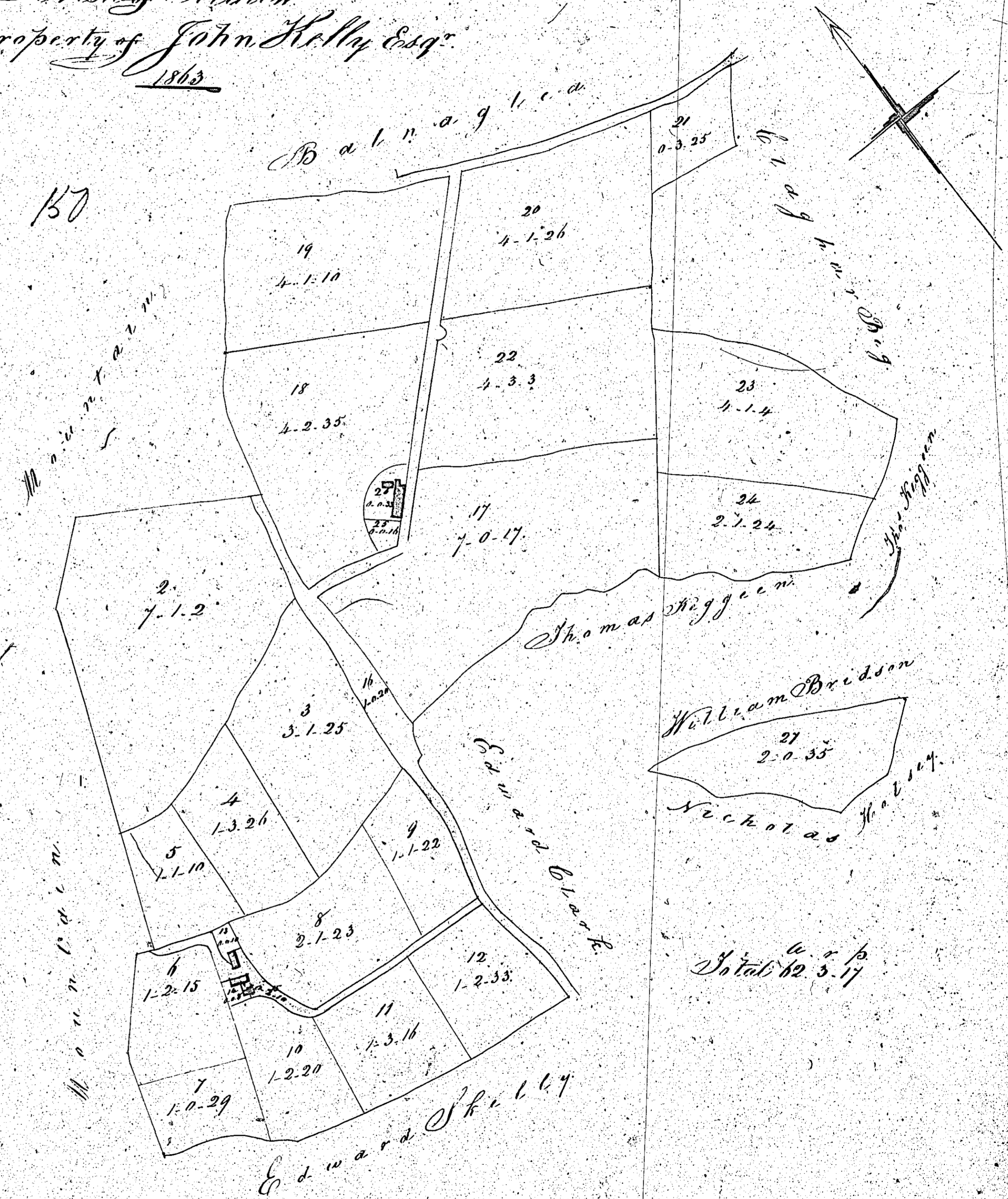

*Scale's Chains to an Inch
Surveyed by John Kelly 1860 Copied by W. Kelly*

ISLE OF MAN GOVERNMENT: GENERAL REGISTRY

ASYLUM PLANS: PARISH OF MALEW

1:23

- 151 Original coloured
- 152 Original monotone

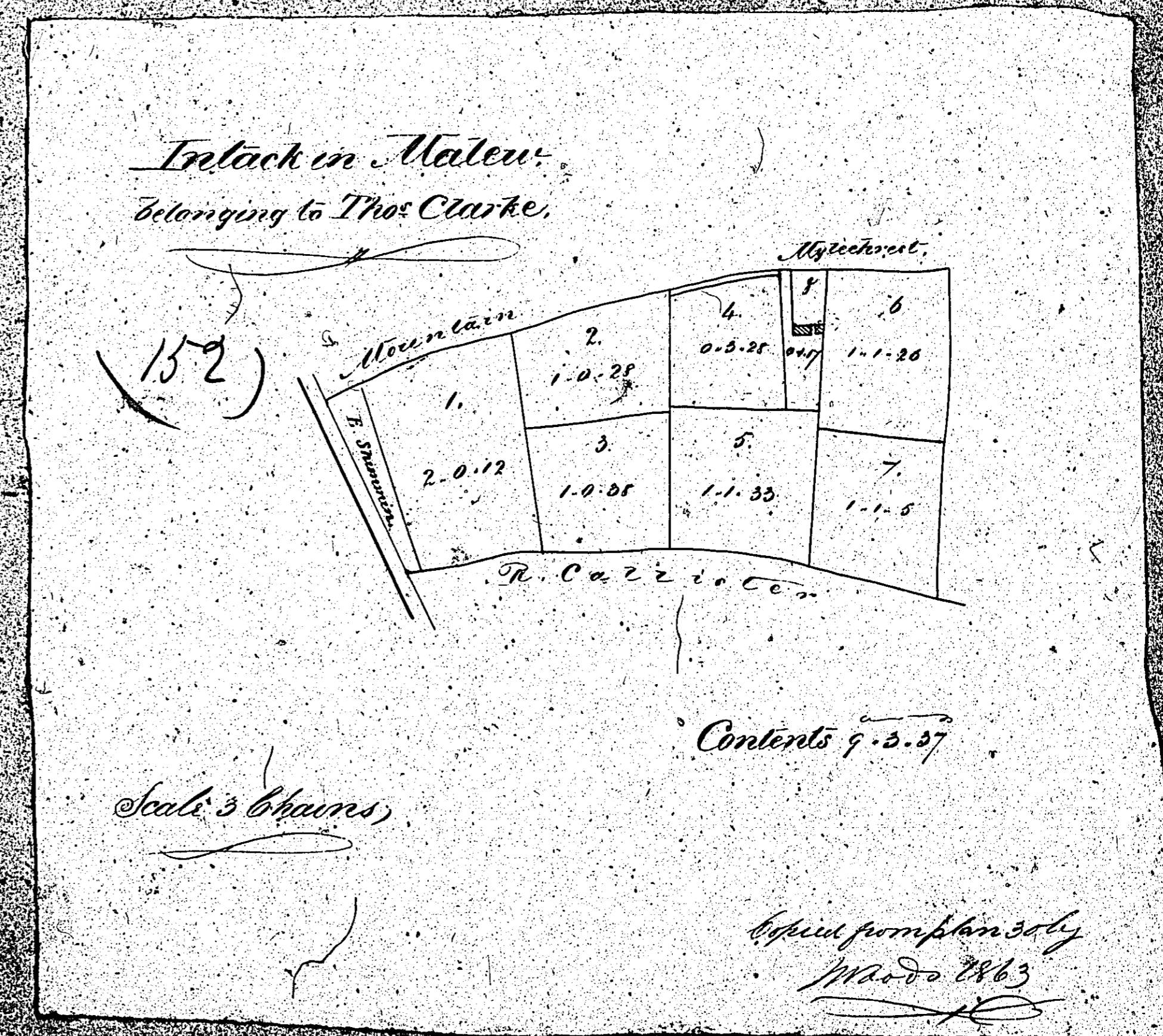
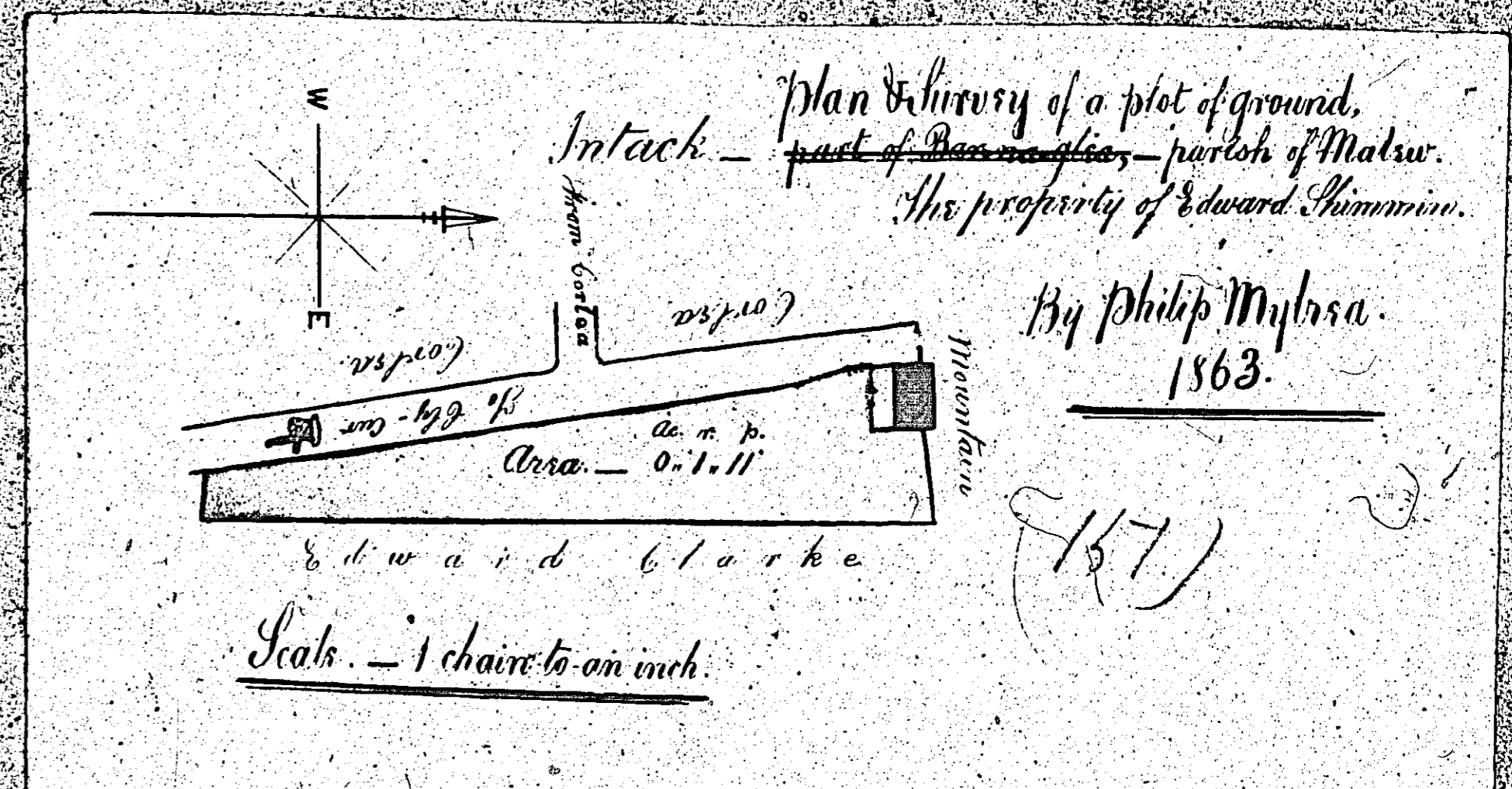

ISLE OF MAN GOVERNMENT: GENERAL REGISTRY

ASYLUM PLANS: PARISH OF MALEW

Originals coloured

1:23

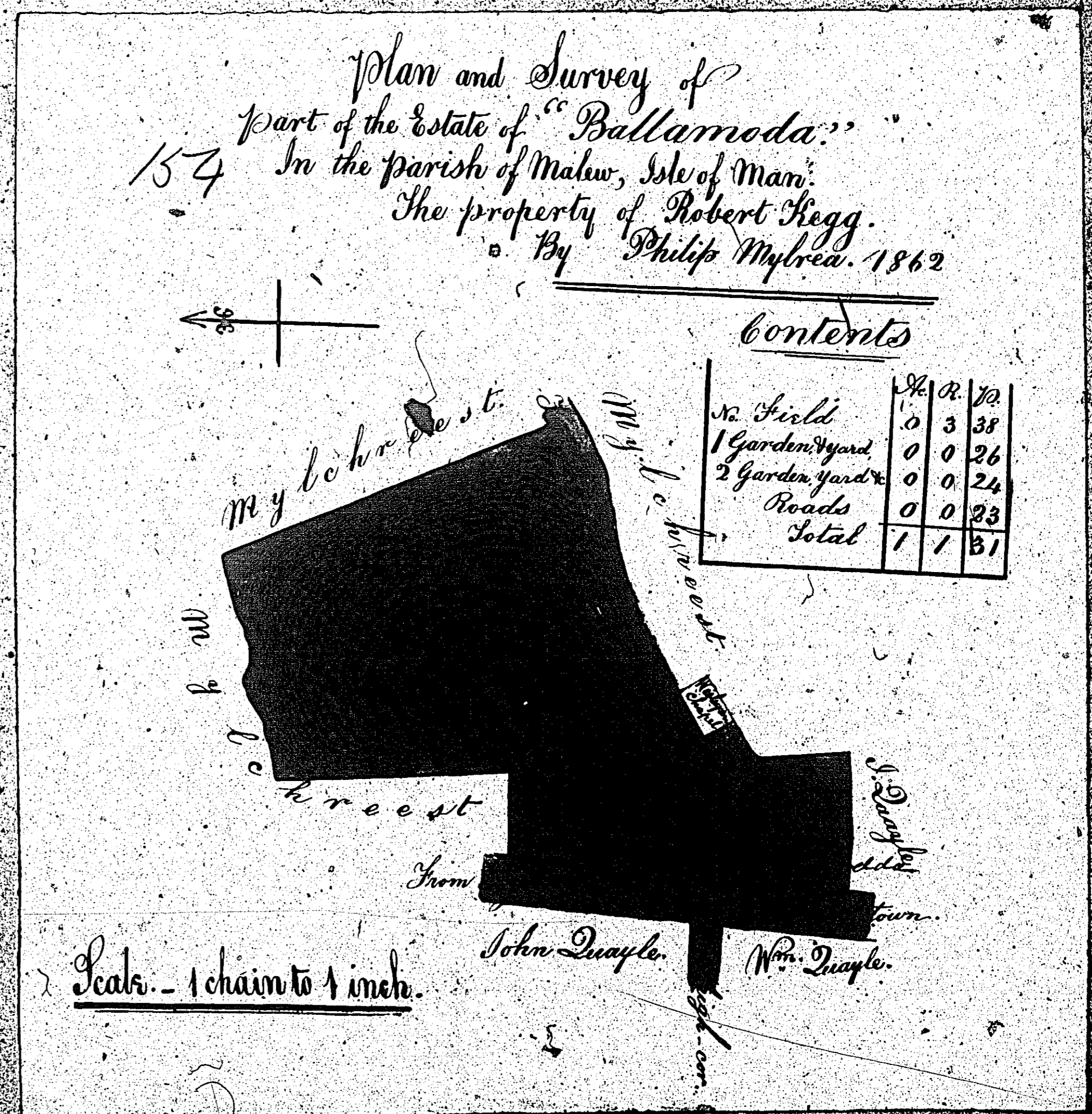
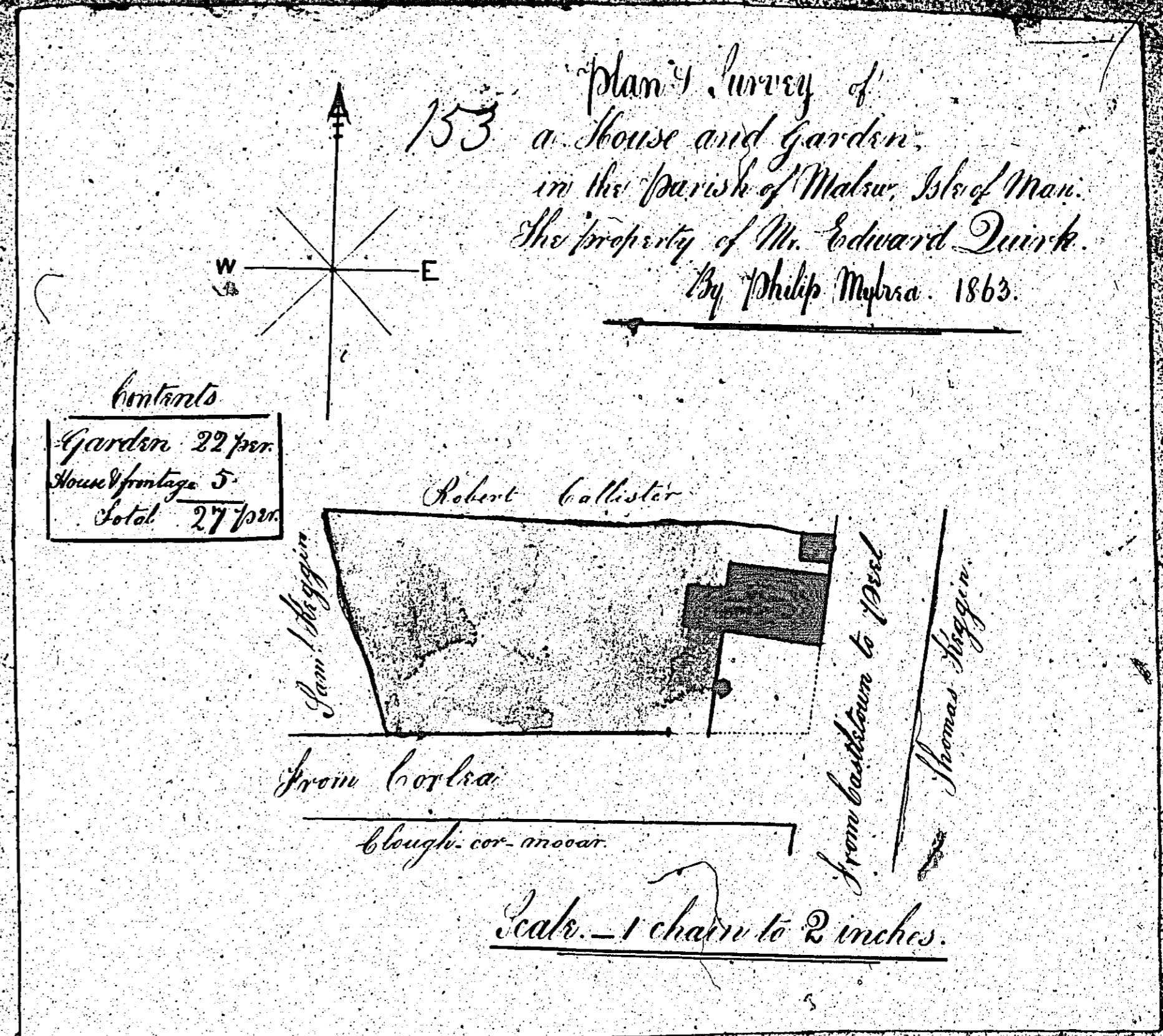

ISLE OF MAN GOVERNMENT: GENERAL REGISTRY

ASYLUM PLANS: PARISH OF MALEW

Original coloured

1:23

