

ISLE OF MAN GOVERNMENT: GENERAL REGISTRY

ASYLUM PLANS: PARISH OF MALEW

Original monotone

1:23

(26)

Property in

Mailews

Inclusing to

J. S. S. Taitman, Esq.

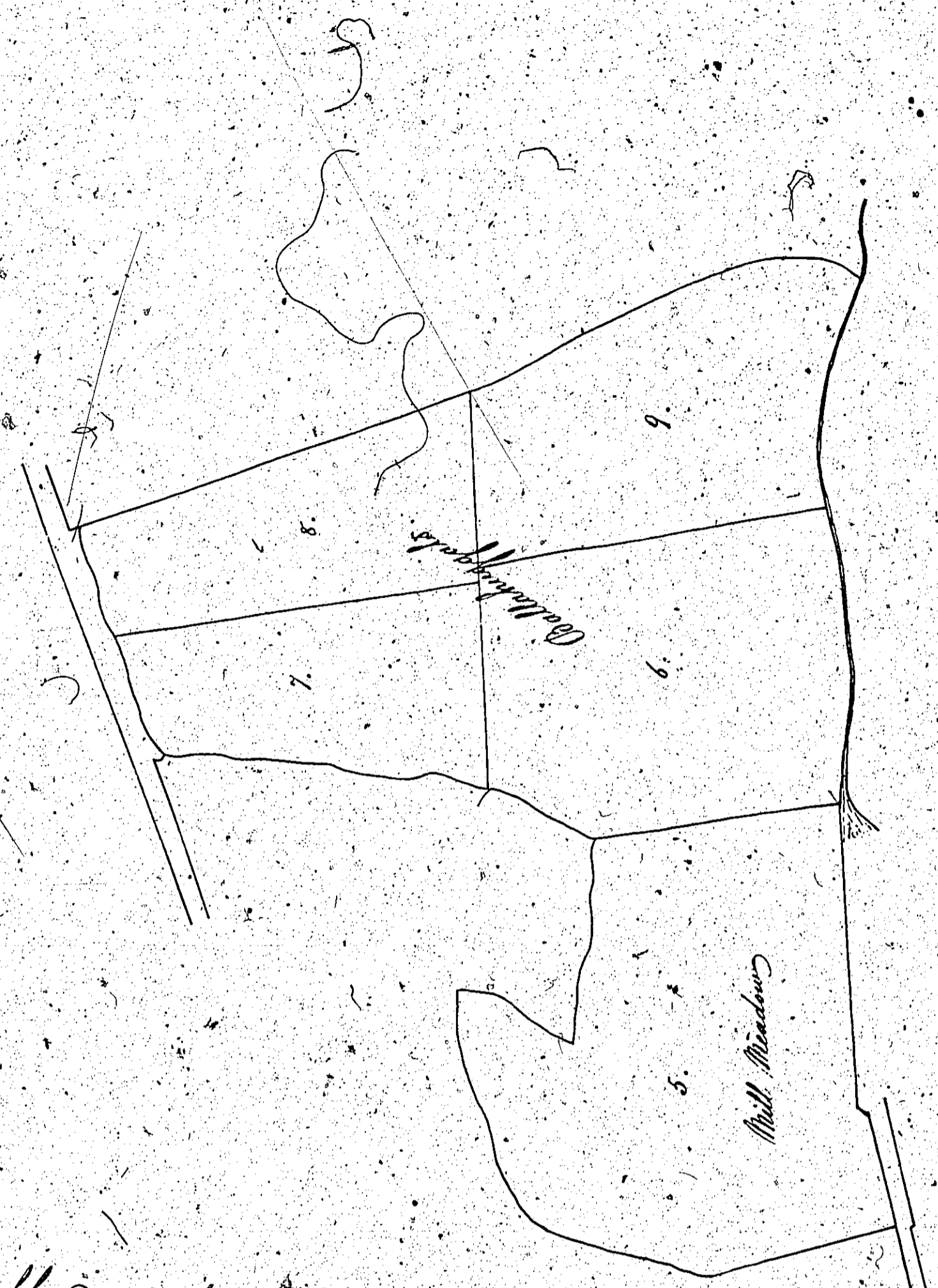
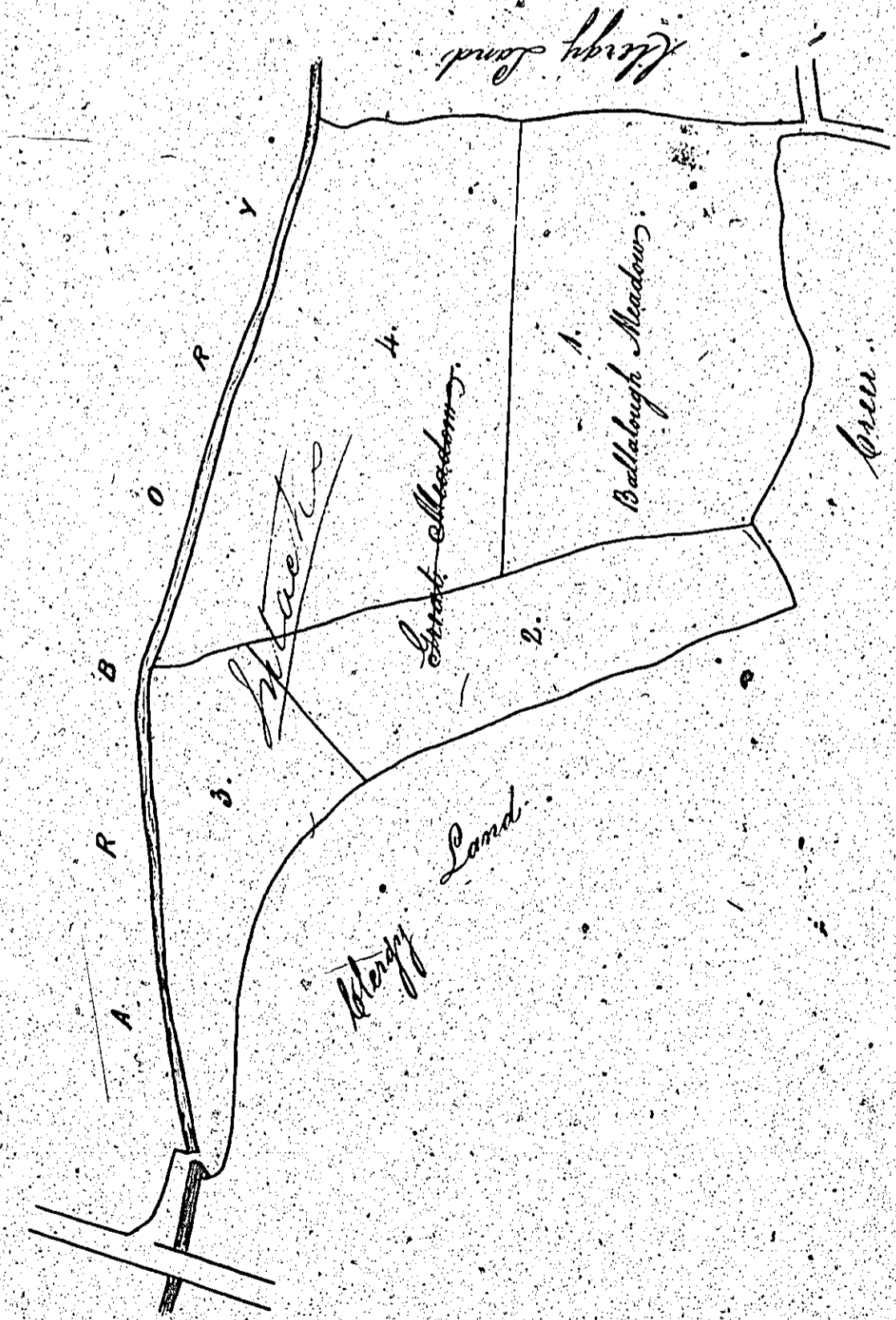

Acres

1	4.2.3
2	2.2.4
3	1.3.16
4	5.1.14
5	7.3.16
6	5.3.24
7	3.1.20
8	5.1.20
9	4.3.15
<u>Sub. 37.2.7</u>	

Copied from Mr. Kelly's survey  
By G. M. M. M. M. M. M. M. M.

Sub. 37.2.7

ISLE OF MAN GOVERNMENT: GENERAL REGISTRY

ASYLUM PLANS: PARISH OF MALEW

Original monotone

1:23

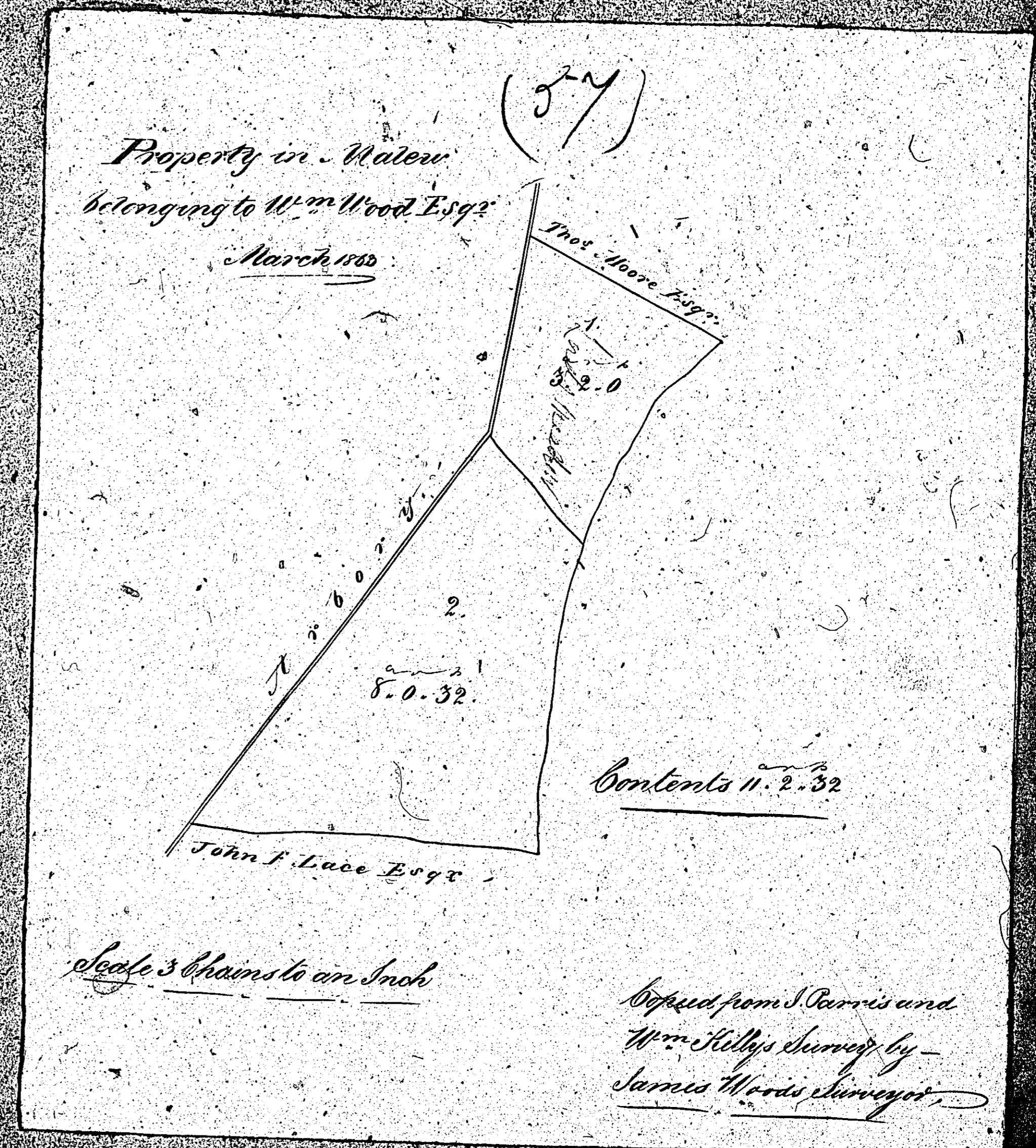

ISLE OF MAN GOVERNMENT: GENERAL REGISTRY

ASYLUM PLANS: PARISH OF MALEW

Original coloured

1:23

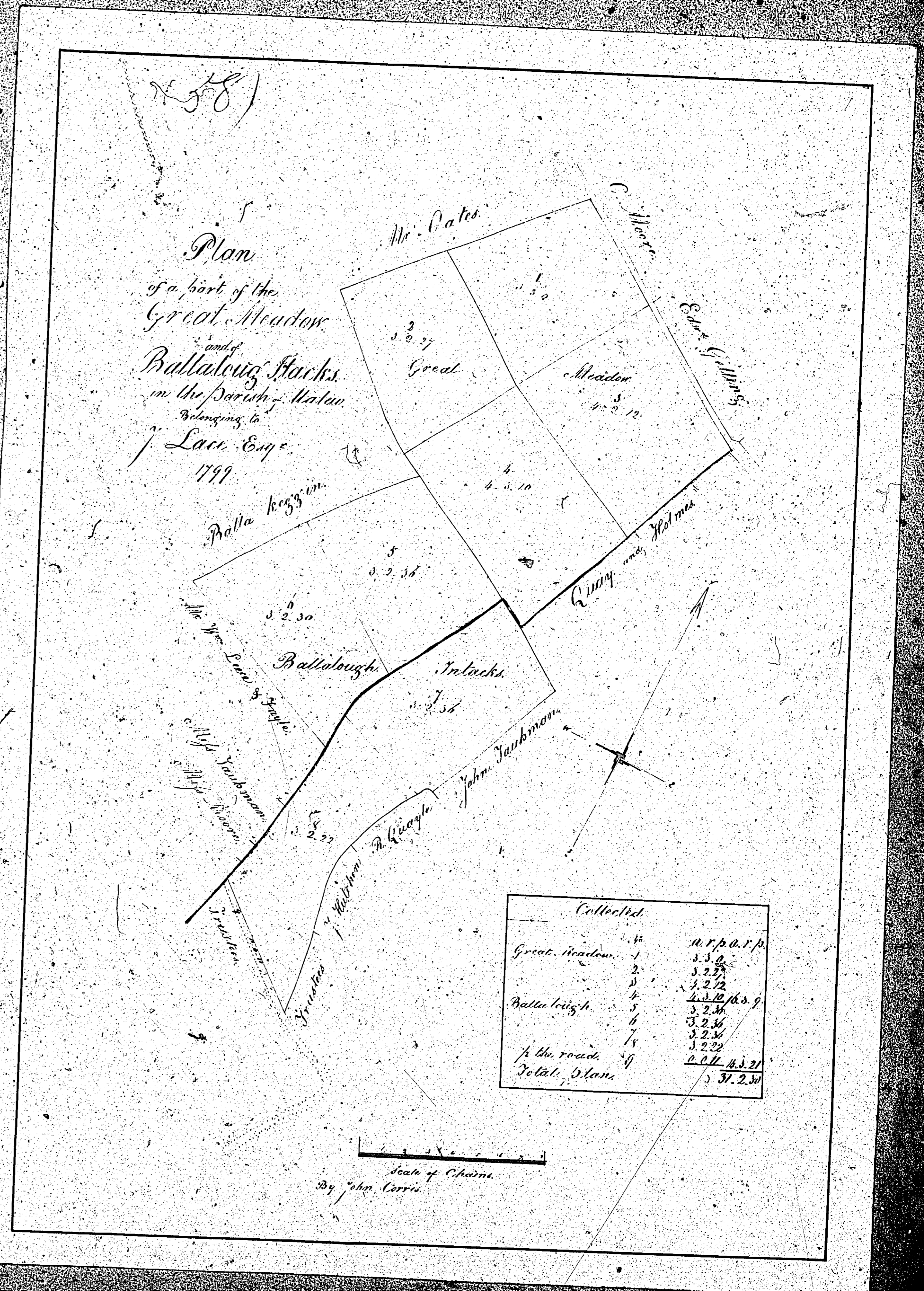

ISLE OF MAN GOVERNMENT: GENERAL REGISTRY

ASYLUM PLANS: PARISH OF MALEW

Original monotone

1:23

*Plan  
of part of the Estate  
of White Stone and  
Great Meadows Malew  
Property of the late  
Mrs Cath Cartman*

*Contents*

1	2	3	4	5	6	7	8	9	10
100	100	100	100	100	100	100	100	100	100

*See Plan  
of 27th 1871  
and  
see  
the Plan*

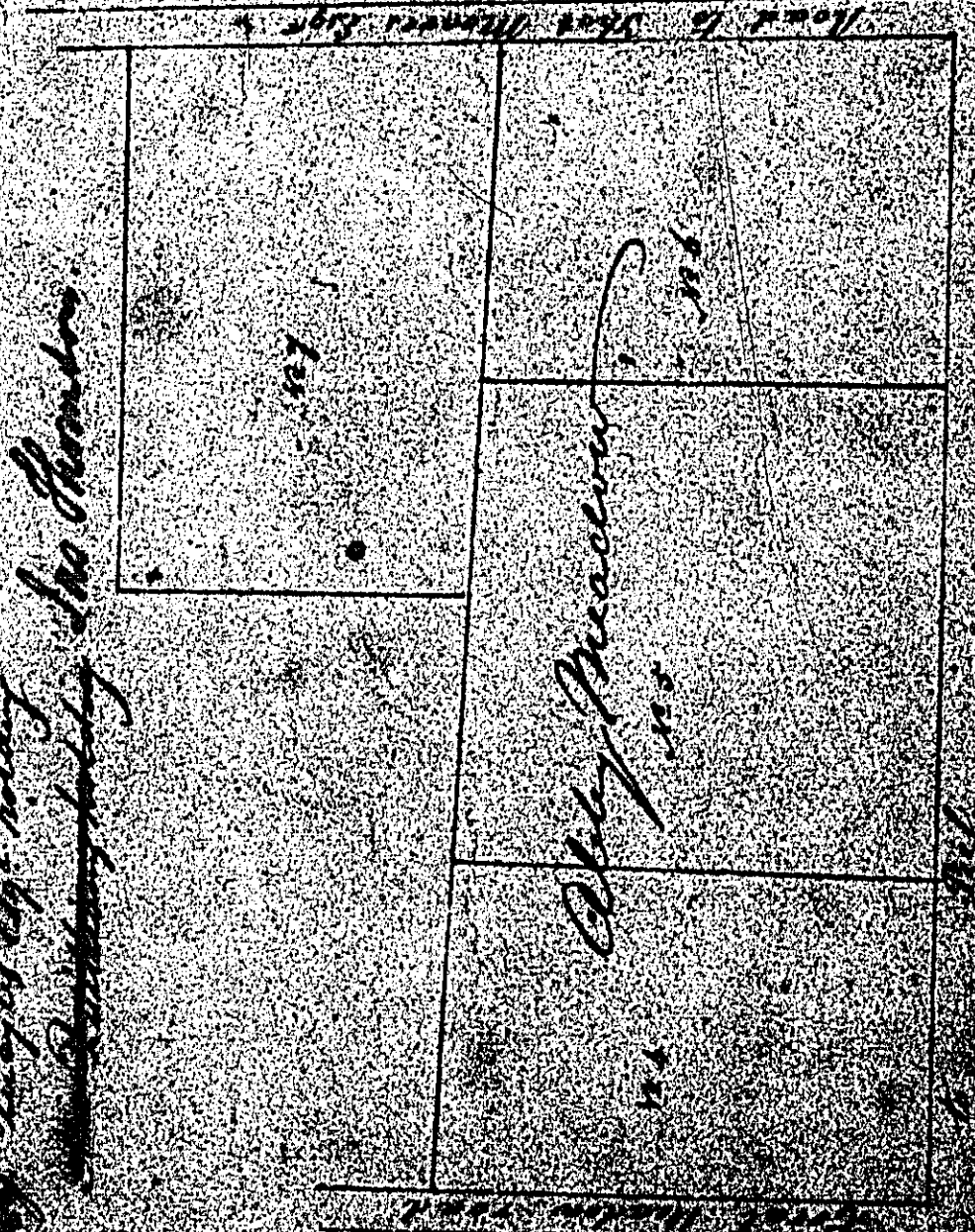

*Miss Moore*

ISLE OF MAN GOVERNMENT: GENERAL REGISTRY

ASYLUM PLANS: PARISH OF MALEW

Original coloured

1:23

THE GREAT MEADOW

IN THE PARISH OF MALEW

The Property of Mrs. John Harris.

September 17th 1856.

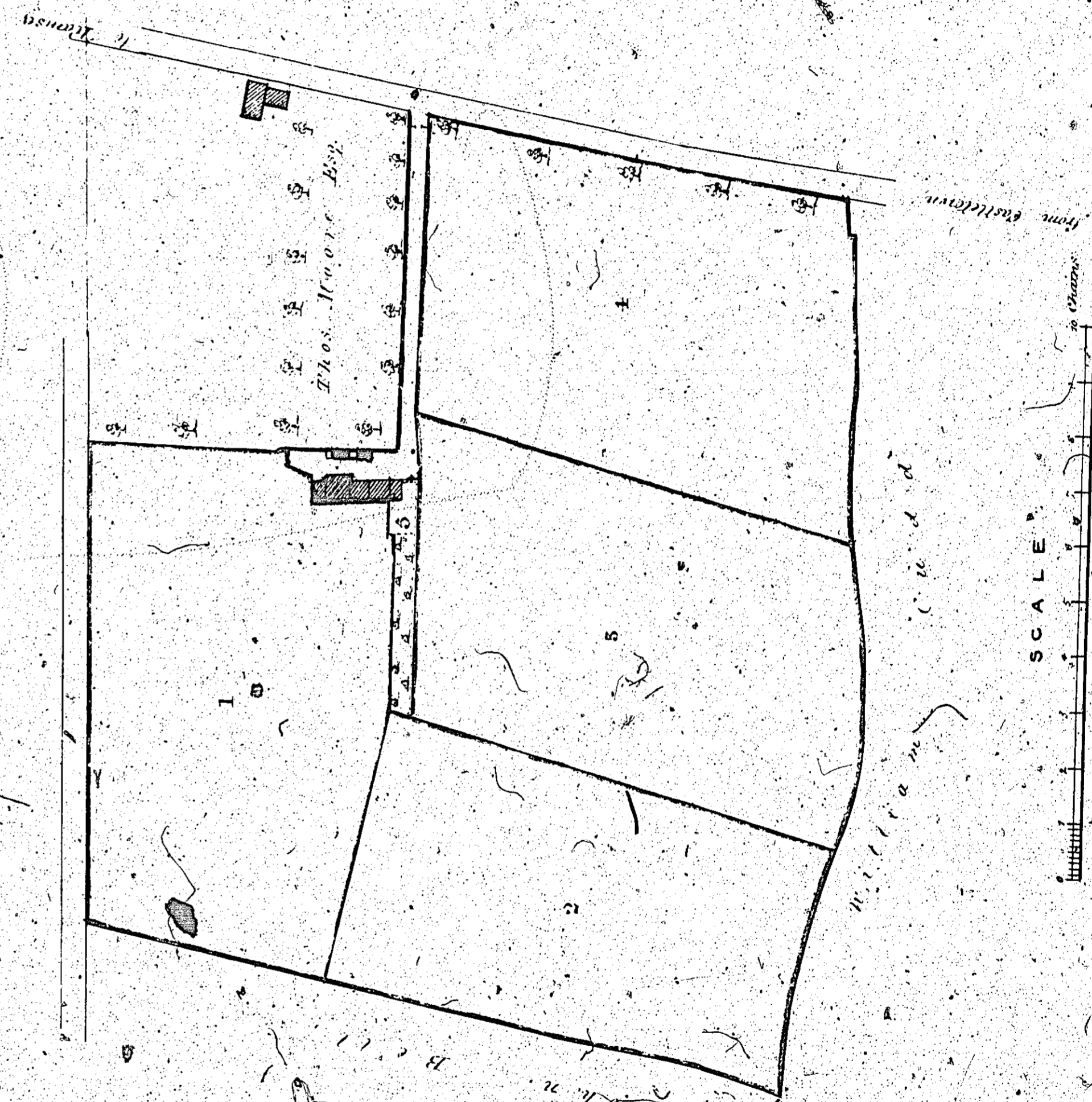

No.	A. R. P.
1	4.5.4
2	4.0.8
3	4.2.15
4	4.2.20
5	0.2.15
<b>Total 18.2.24</b>	

*Asphallum Langley*  
*Asphallum Douglas*

ISLE OF MAN GOVERNMENT: GENERAL REGISTRY

ASYLUM PLANS: PARISH OF MALEW

Originals monotone

1:23

