

START

APR 2

1 : 2 3

Isle of Man Government: General Registry

**PLANS DEPOSITED IN THE
ROLLS OFFICE
UNDER THE
LUNATIC ASYLUM ACT
1860**

Bell & Howell, Micromedia Division,
Telford Road, Bicester, Oxon, OX6 0UP

March 1998

NOTES

The plans have been filmed in their bound state

This will have caused some image distortion particularly where large plans go into the binding gutter and/or have been folded

Many of the larger plans are damaged

Where plans are coloured this has been noted; 'monochrome' indicates a single ink colour which may be black, brown or blue

START OF VOLUME

ISLE OF MAN GOVERNMENT: GENERAL REGISTRY

ASYLUM PLANS: PARISH OF GERMAN

Original coloured (decorative), marked

1:23

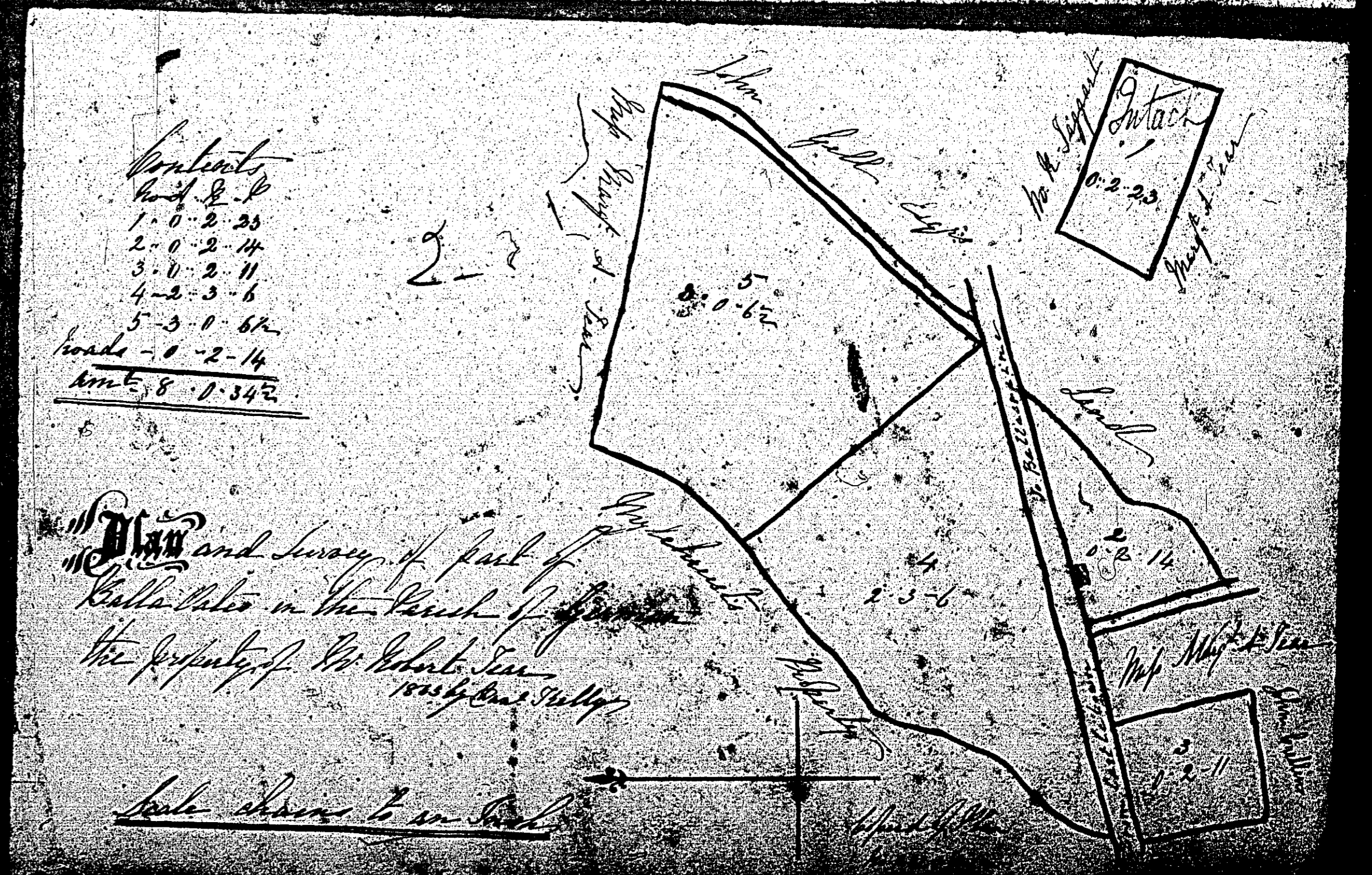
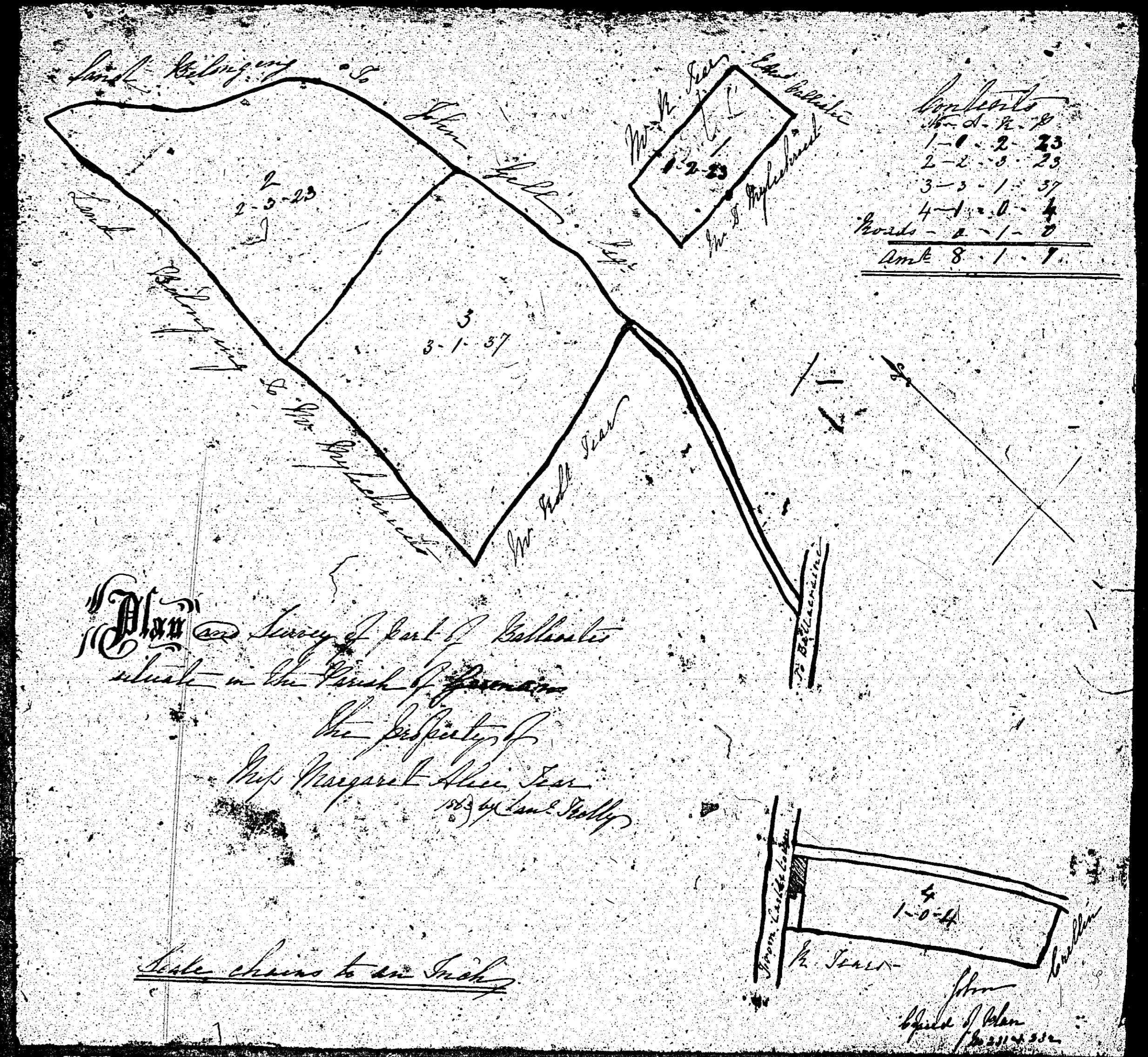

ISLE OF MAN GOVERNMENT: GENERAL REGISTRY

ASYLUM PLANS: PARISH OF GERMAN

Original coloured

1:23

A Plan and Survey
Of part of the Estate of
Mullin-ne-Clovie
in the parish of German
The property of
Thos. Mylchrest Esq.

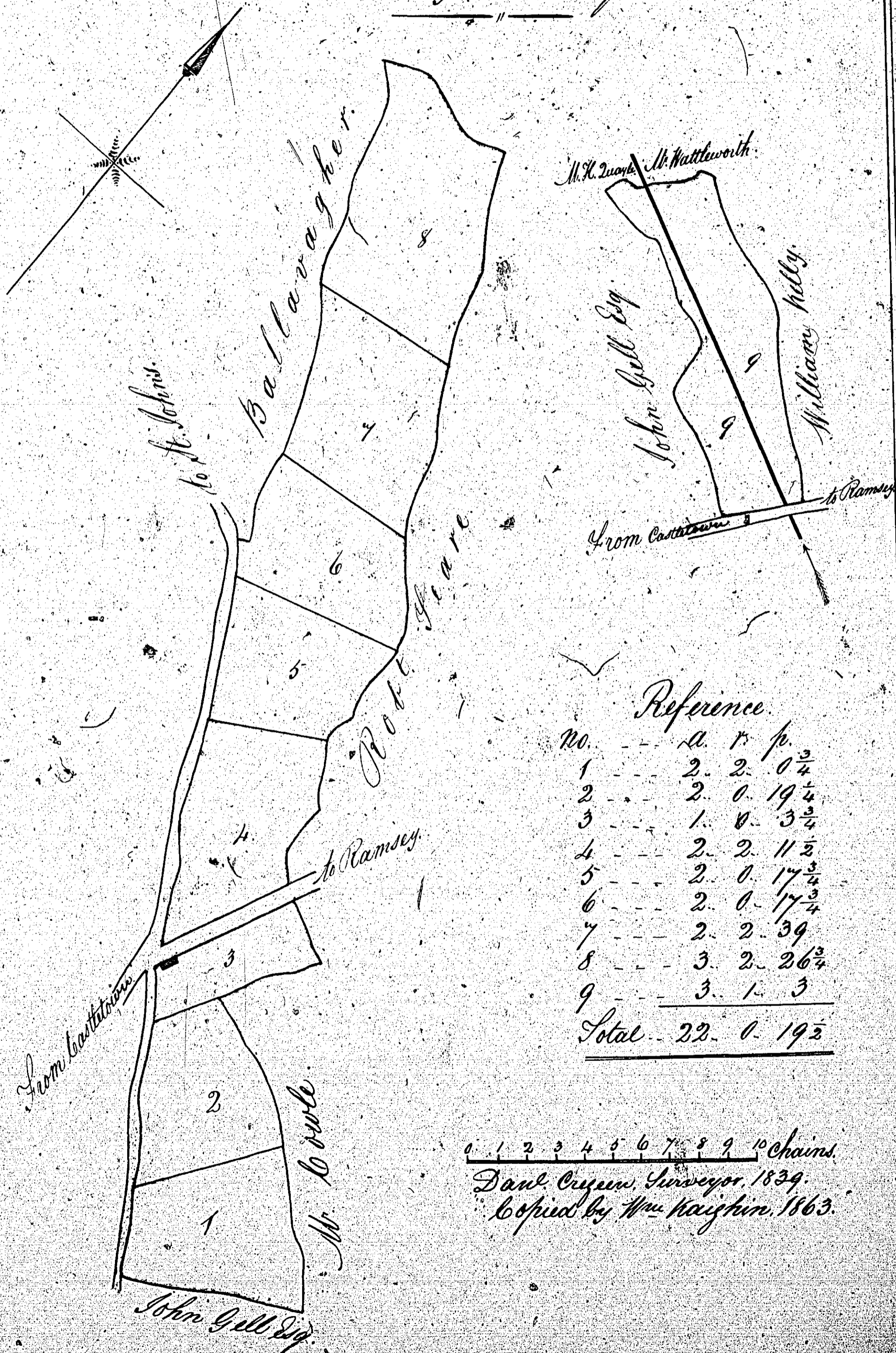

Plan and Survey
 of the Estate in the Parish of German.
 The Property of John Gott Esq.
 1862.



Reference			
No.	a	r	b
1	13	0	30
2	13	0	10
3	9	1	4
4	8	1	28
5	8	0	38
6	10	2	36
7	10	3	25
8	6	1	14
9	4	3	8
10	1	1	13
11	0	3	18
12	10	0	6
13	0	1	8
14	0	1	19
15	1	0	10
16	1	2	33
17	3	0	26
18	2	3	0
19	2	2	20
20	10	2	37
21	6	1	17
22	14	2	12
23	11	1	19
24	14	1	19
Private roads	2	0	21
Total contents	163	3	8

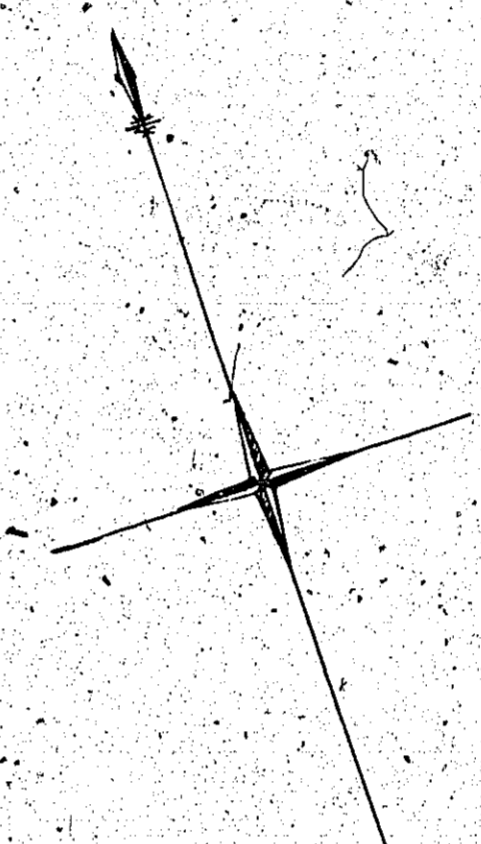

0 1 2 3 4 5 6 7 8 9 10 chains

From a plan by Jeffrey and Vagill 1840.
 by Wm Raigden, R. S. 1862.

2-12
 5-1-15
 6-1-15
 8-1-15

ISLE OF MAN GOVERNMENT: GENERAL REGISTRY

frame 1 of 2

ASYLUM PLANS: PARISH OF GERMAN

Original coloured

1:23

ISLE OF MAN GOVERNMENT: GENERAL REGISTRY

ASYLUM PLANS: PARISH OF GERMAN

Original coloured

1:23

Reference			
No.	a.	r.	b.
1	13	0	30
2	13	0	10
3	9	1	28
4	8	1	38
5	8	0	2
6	10	2	36
7	6	3	25
8	6	1	14
9	4	3	8
10	1	1	13
11	0	1	18
12	10	0	6
13	0	1	8
14	0	1	19
15	1	0	10
16	0	2	33
17	3	0	26
18	2	3	0
19	2	2	20
20	10	2	34
21	6	1	14
22	14	2	32
23	11	1	19
24	14	1	34
Private roads	2	0	21
Total content	163	3	8

2-2-12
 5-1-15
 6-1-15
 1-1-15

0 1 2 3 4 5 6 7 8 9 10 chains

From a plan by Jefferson and Dayll 1840.
 by Messrs. Raighin, St. Johns.

frame 2 of 2

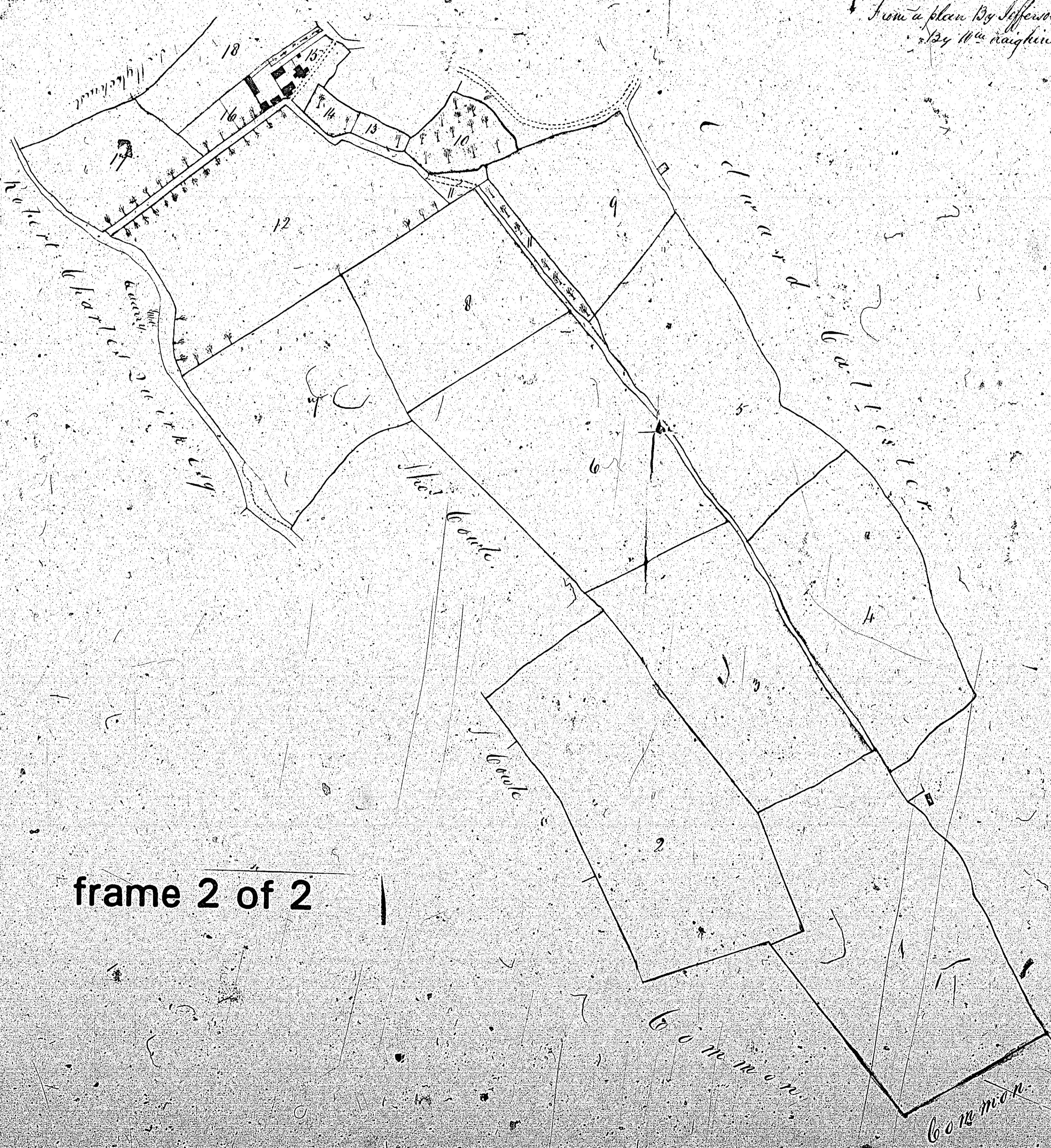

ISLE OF MAN GOVERNMENT: GENERAL REGISTRY.

ASYLUM PLANS: PARISH OF GERMAN

Original coloured

1:23

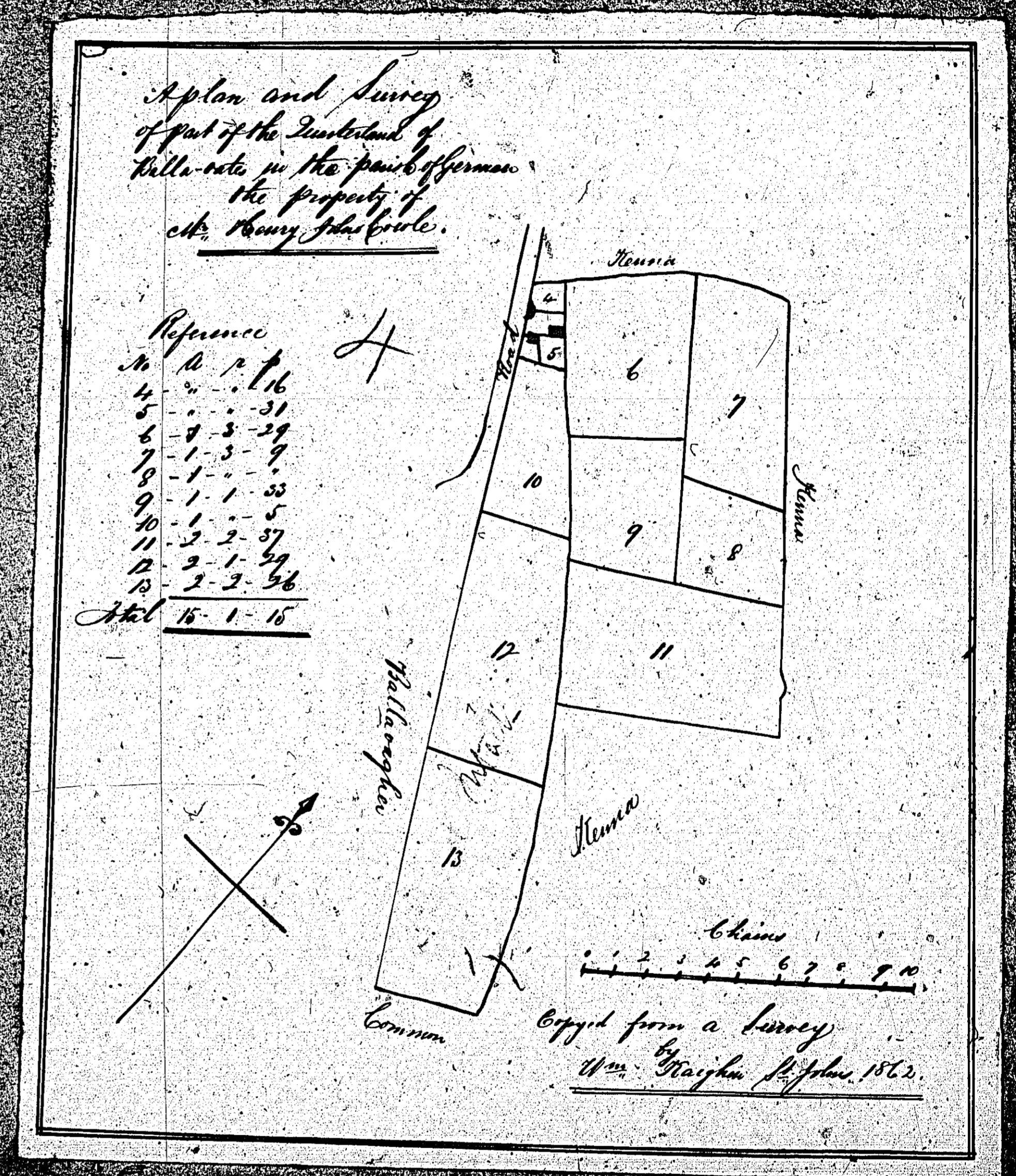

A Plan and Survey

of Herma Estate

Situate in the parish of German

Quarterland and Inlet

the property of

Mr Edward Collier.

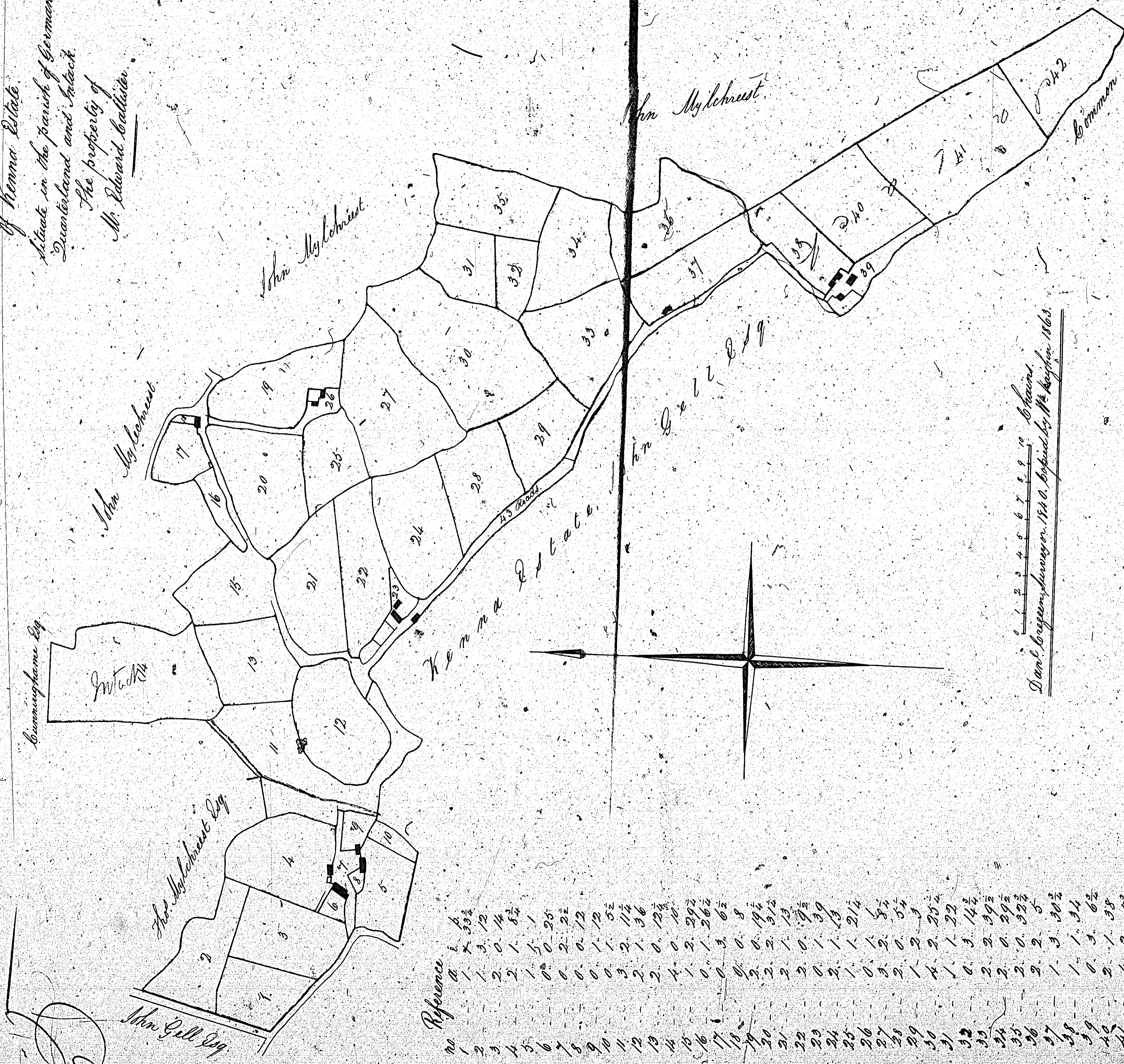

Reference	Area
1	0. 0. 12
2	0. 0. 12
3	0. 0. 12
4	0. 0. 12
5	0. 0. 12
6	0. 0. 12
7	0. 0. 12
8	0. 0. 12
9	0. 0. 12
10	0. 0. 12
11	0. 0. 12
12	0. 0. 12
13	0. 0. 12
14	0. 0. 12
15	0. 0. 12
16	0. 0. 12
17	0. 0. 12
18	0. 0. 12
19	0. 0. 12
20	0. 0. 12
21	0. 0. 12
22	0. 0. 12
23	0. 0. 12
24	0. 0. 12
25	0. 0. 12
26	0. 0. 12
27	0. 0. 12
28	0. 0. 12
29	0. 0. 12
30	0. 0. 12
31	0. 0. 12
32	0. 0. 12
33	0. 0. 12
34	0. 0. 12
35	0. 0. 12
36	0. 0. 12
37	0. 0. 12
38	0. 0. 12
39	0. 0. 12
40	0. 0. 12
41	0. 0. 12
42	0. 0. 12
Total Roads	2. 3. 0. 2
Total Amount	79. 0. 0

ISLE OF MAN GOVERNMENT: GENERAL REGISTRY
ASYLUM PLANS: PARISH OF GERMAN

Original coloured

1:23