

ISLE OF MAN GOVERNMENT: GENERAL REGISTRY

ASYLUM PLANS: PARISH OF ARBORY

Original monochrome

1:23

Ballycally and Ballyfoaddu

in Parish of Arbory

According to Jane Cusson 1863

55

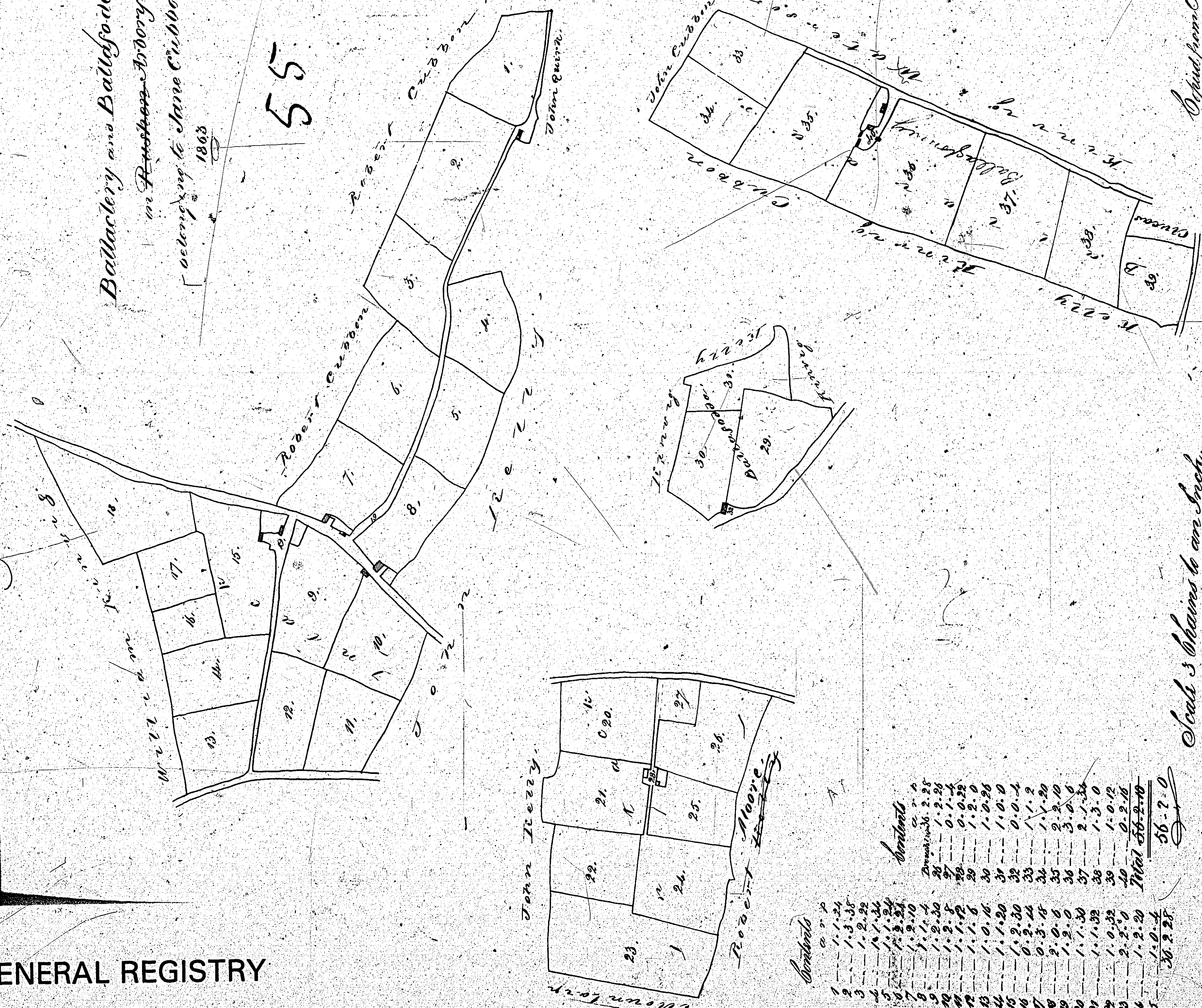

Scale 3 Chains to an Inch.

Spid from Plan 55 by James Woods Surveyor

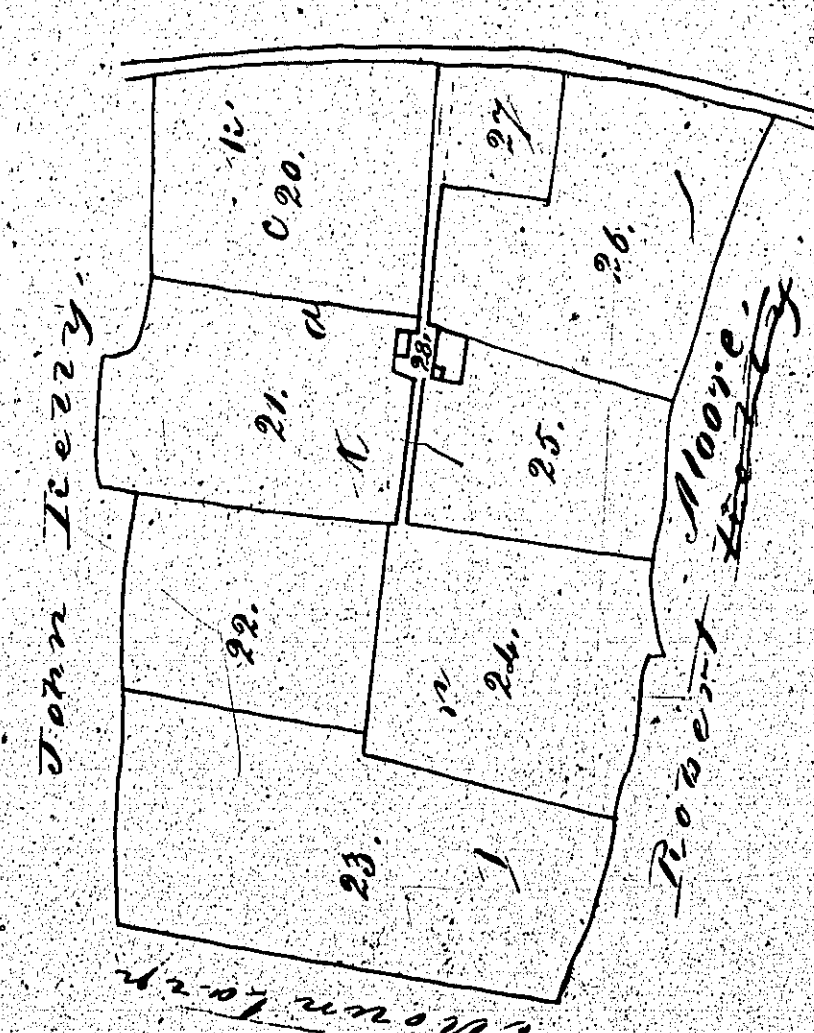

Acres

1	0.0.0
2	1.1.24
3	1.3.35
4	1.2.22
5	1.1.34
6	1.1.24
7	1.3.24
8	1.3.24
9	1.1.1
10	1.2.30
11	1.2.5
12	1.1.12
13	1.1.6
14	1.0.16
15	1.1.20
16	1.2.30
17	0.3.18
18	2.0.8
19	1.2.0
20	1.1.32
21	1.1.32
22	1.0.32
23	2.2.0
24	1.2.24
25	1.0.1
26	3.2.25
Total 56.7.0	

56.7.0

ISLE OF MAN GOVERNMENT: GENERAL REGISTRY

ASYLUM PLANS: PARISH OF ARBORY

Originals monotone

1:23

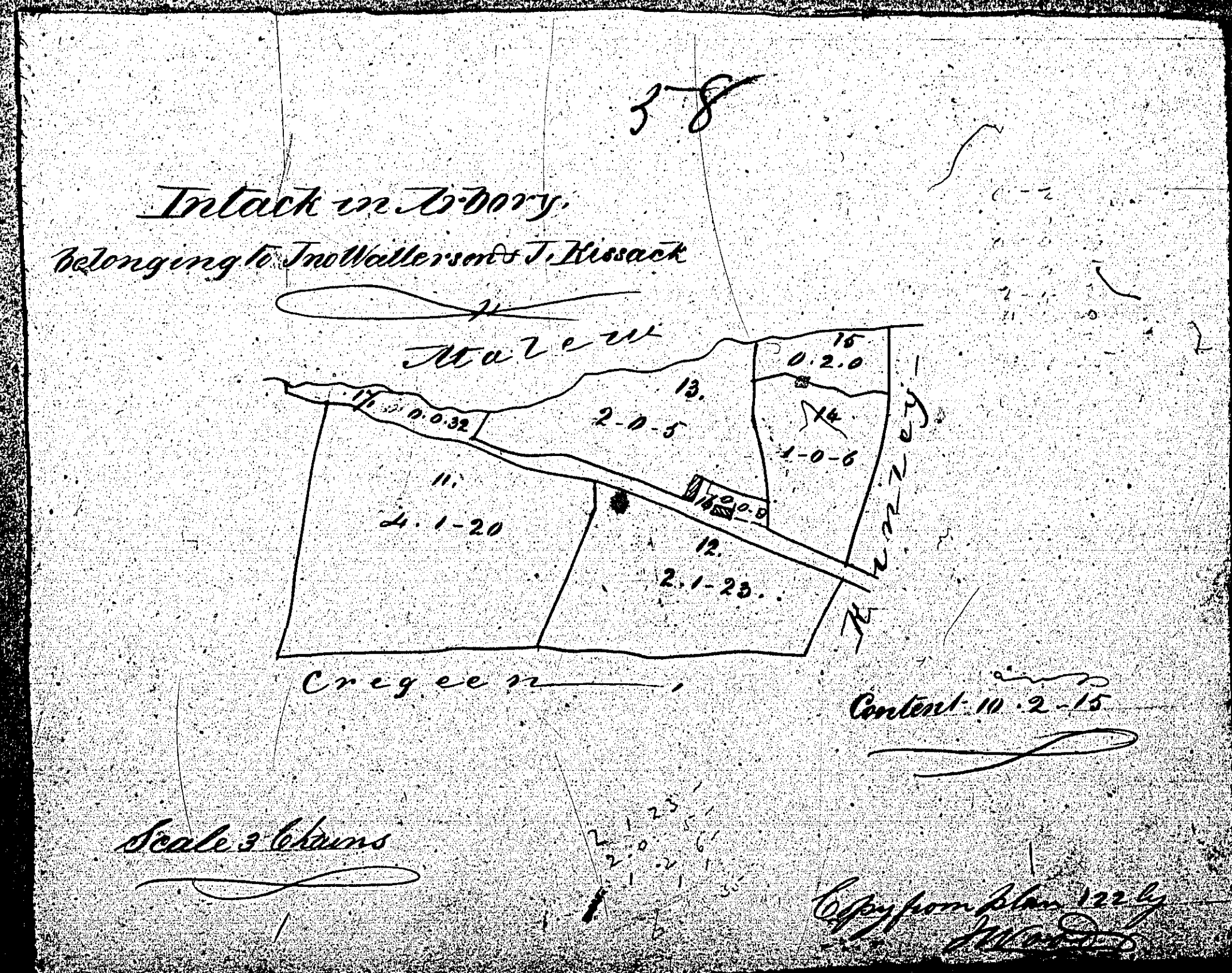
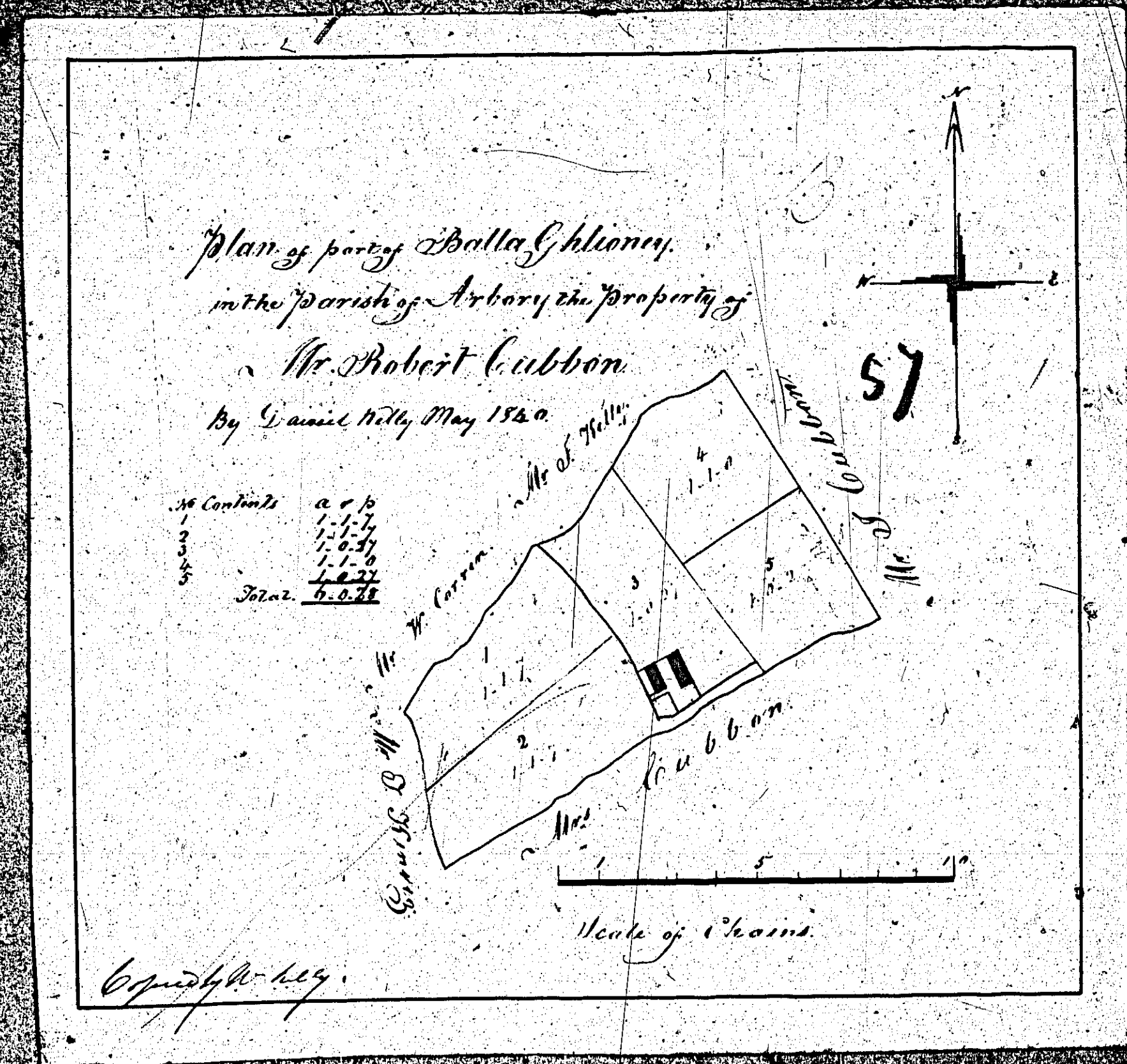

ISLE OF MAN GOVERNMENT: GENERAL REGISTRY

ASYLUM PLANS: PARISH OF ARBORY

Original monotone

1:23

Plan and Area
of Ballatasson
Situated in the Parish
of Arbory
The property of John Cullen

59

Contents	
1	2 1 21
2	2 3 15
3	3 1 36
4	2 1 20
5	2 3 5
6	3 0 12
7	1 1 34
8	2 1 5
9	1 3 20
10	2 3 30 = 25.2.1
total ground a/c	1 2 29
area garden road	1 1 0
total	28 1 30

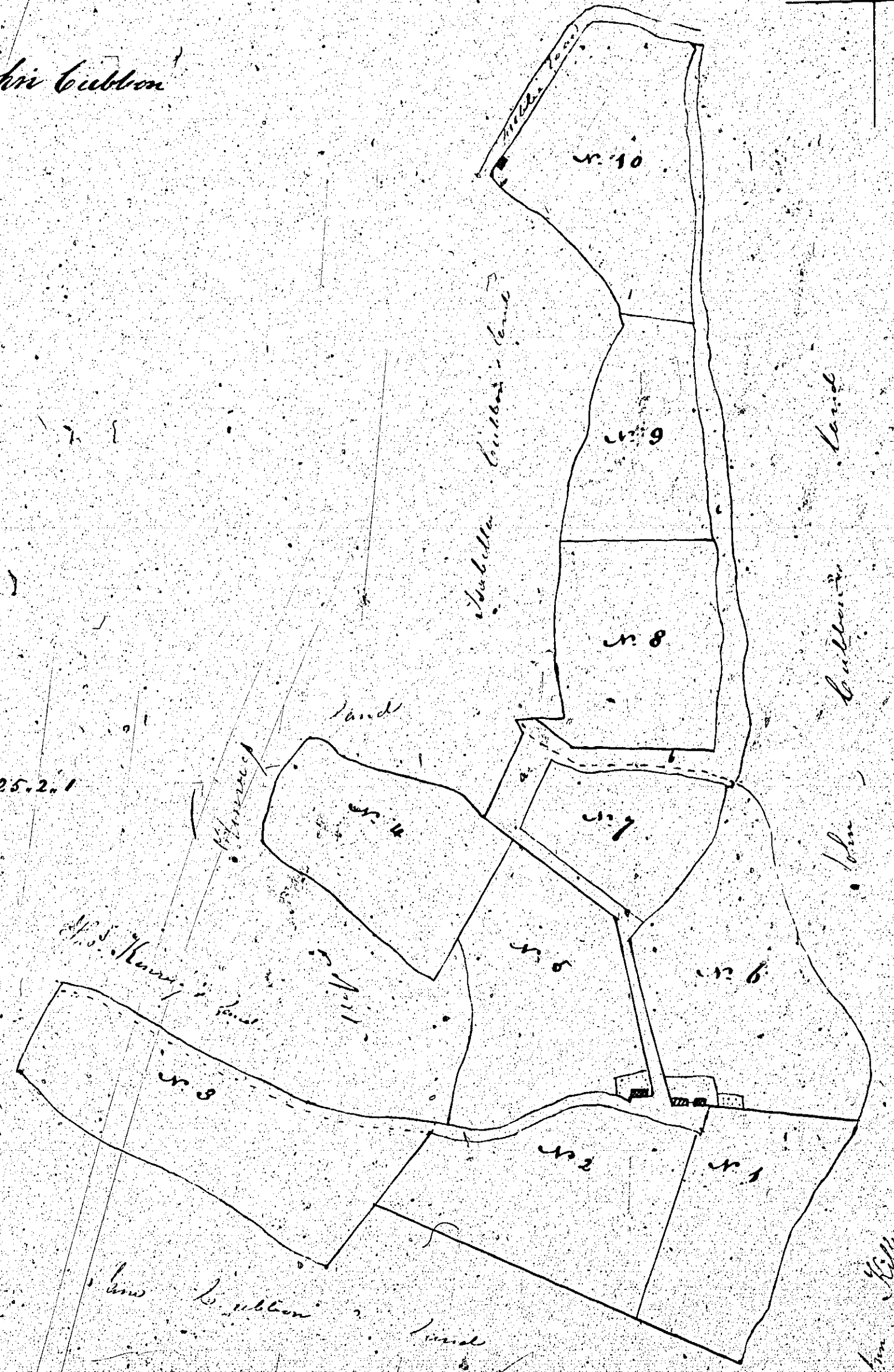

Scale of 3 chains to an Inch
By John Cullen

ISLE OF MAN GOVERNMENT: GENERAL REGISTRY

ASYLUM PLANS: PARISH OF ARBORY

Originals monotone

1:23

John Callister Esq

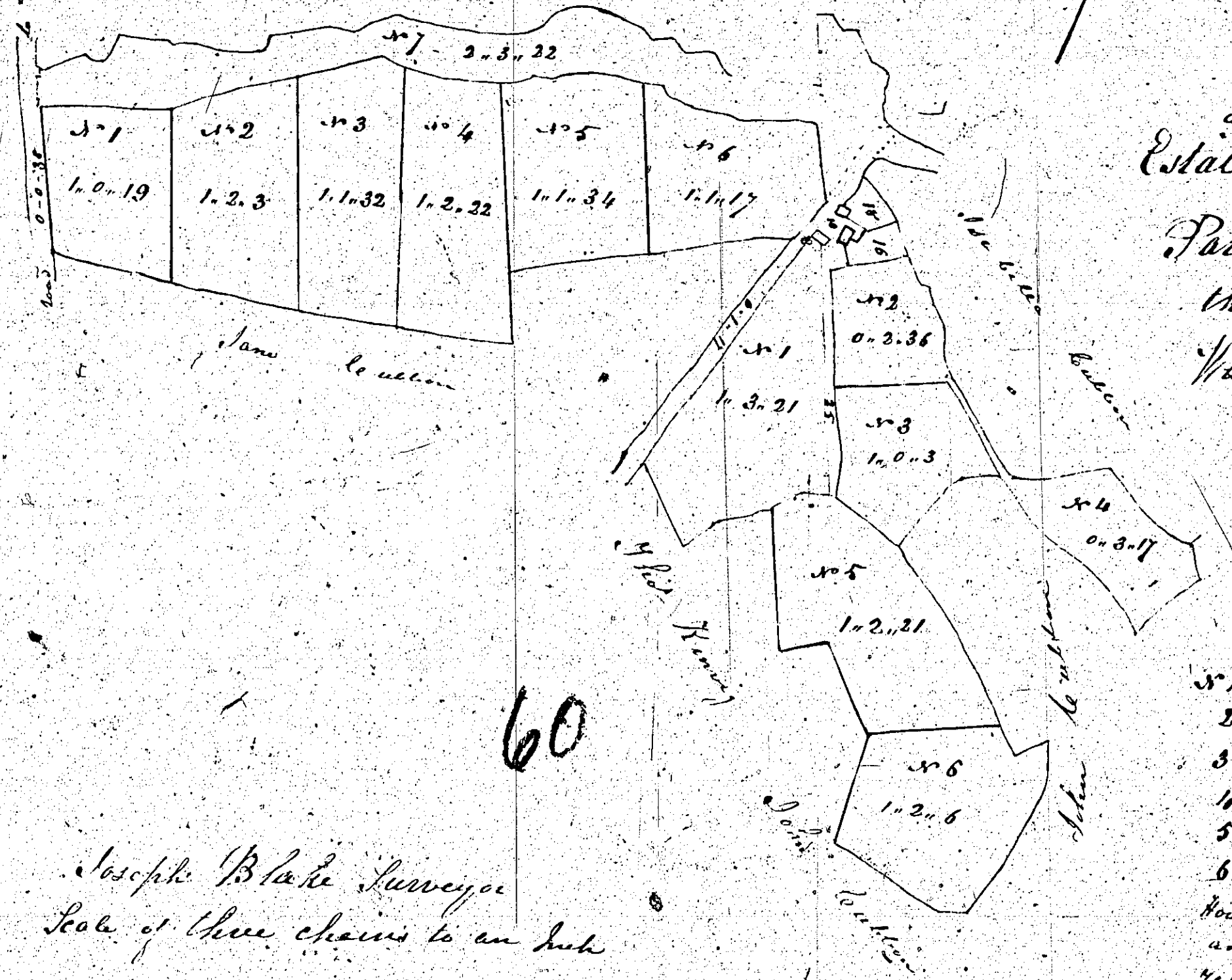

Plan of part of the Estate of Ronague in the Parish of Arbory the property of William Hurry (Mortg)

Contents

No. 1	1 0 19
2	1 2 3
3	1 1 32
4	1 2 22
5	1 1 34
6	1 1 17
7	4 3 32
8	11 1 39
9	8 0 33
10	19 3 12

*Joseph Blake Surveyor
Scale of three chains to an inch*

*Drawn over by
John Callister March 31st 1863*

Plan and Area of the Property of Mary Kelly part of the Inheritance of Kallarrick in the Parish of Arbory

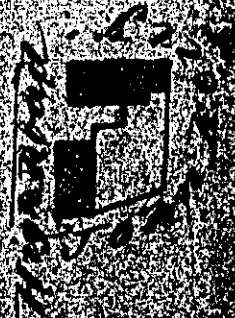
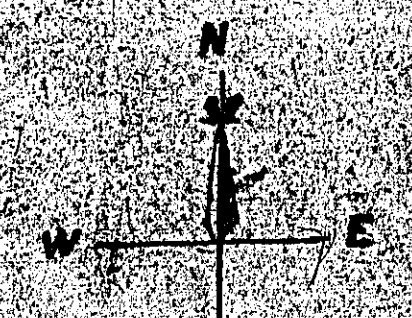

ISLE OF MAN GOVERNMENT: GENERAL REGISTRY

ASYLUM PLANS: PARISH OF ARBORY

- 62 Original monotone
- 63 Original coloured

1:23

