

ISLE OF MAN GOVERNMENT: GENERAL REGISTRY

ASYLUM PLANS: PARISH OF ARBORY

Originals monotone

1:23

(30) Ballabeg in Arbory
Belonging to Wm Clague,
March 1862

March 1862

46 B

Wm Clague

Contents 0.0.203

Shak's Plans to an Arch

Helly & Woods
Chungyo

(4) Ballabeg in Arbory
Belonging to the Wm & Warden's
March 1862

March 1862

46 B

Wm Clague

Contents 0.0.173

Shak's Plans to an Arch

Helly & Woods
Chungyo

(32) Ballabeg in Arbory
Belonging to R. Clague,
March 1862

March 1862

46 B

R. Clague

Contents 0.0.92

Shak's Plans to an Arch

Helly & Woods
Chungyo

(31) Ballabeg in Arbory
Belonging to R. Sturminster
March 1862

March 1862

46 B

R. Sturminster

Contents 0.0.248

Shak's Plans to an Arch

Helly & Woods
Chungyo

ISLE OF MAN GOVERNMENT: GENERAL REGISTRY

ASYLUM PLANS: PARISH OF ARBORY

Original monotone

1:23

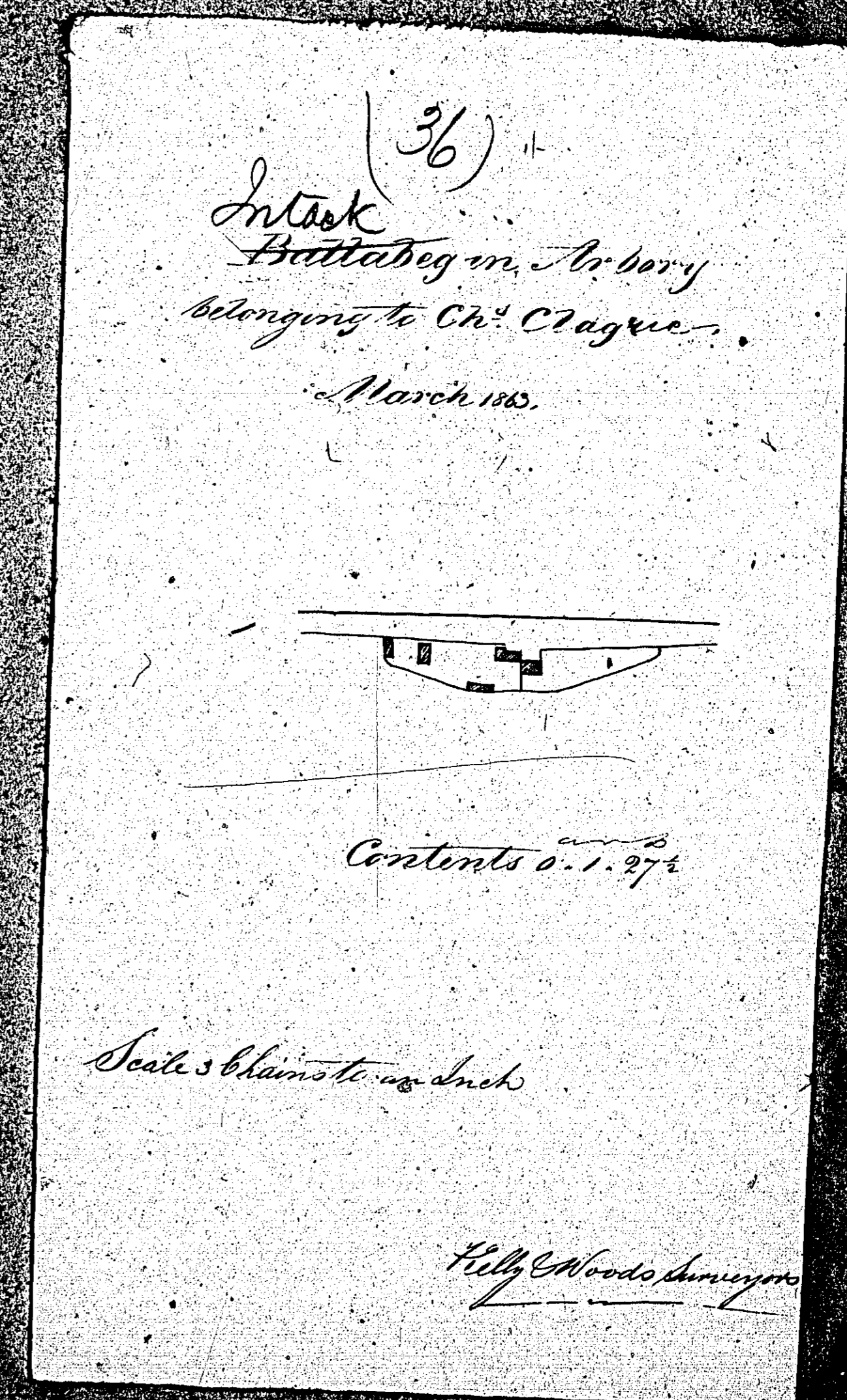

ISLE OF MAN GOVERNMENT: GENERAL REGISTRY

ASYLUM PLANS: PARISH OF ARBORY

Original monotone

1:23

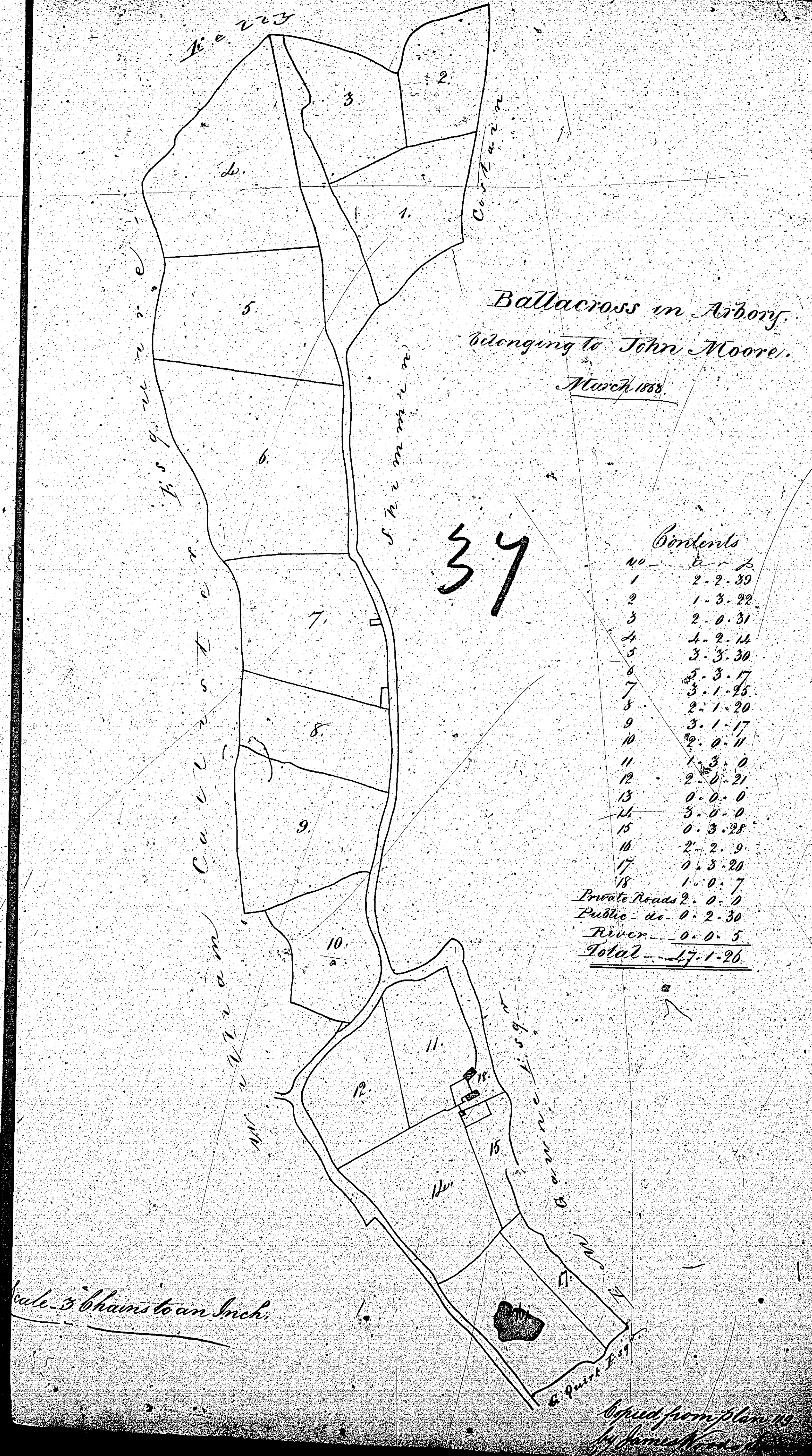

ISLE OF MAN GOVERNMENT: GENERAL REGISTRY

ASYLUM PLANS: PARISH OF ARBORY

1:23

- 39 Original coloured
- 40 Original monotone

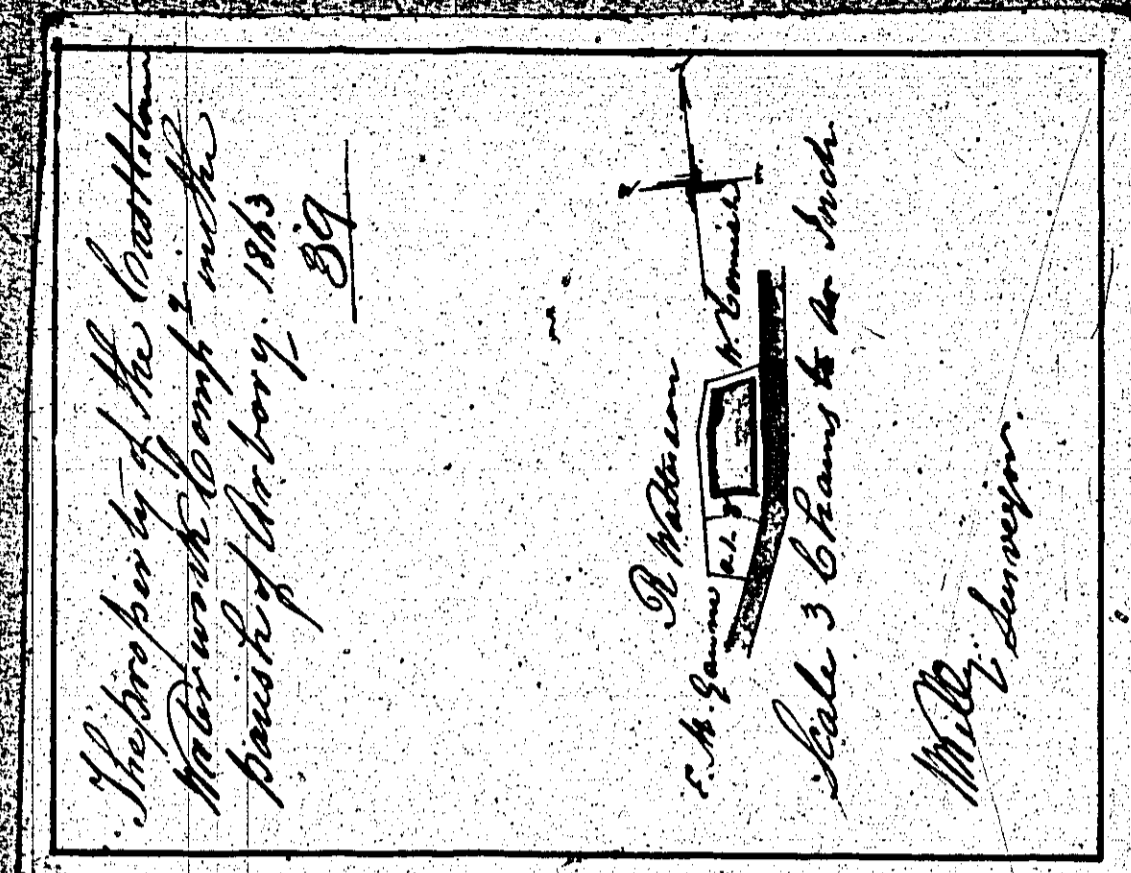

Ballacrapphey in Arbory
belonging to William Hall.

March 1865.

40

Contents

<i>no.</i>	<i>arp</i>
1	1.1.8
2	2.1.16
3	1.2.21
4	1.1.2
5	0.0.11
6	0.0.35
<i>Total</i>	<i>6.3.13</i>

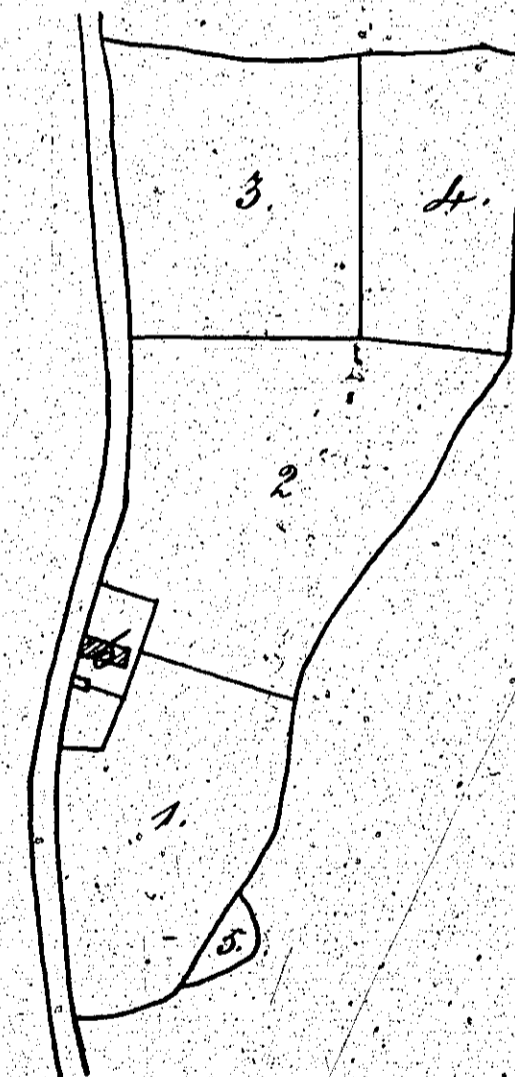

Scale 3 Chains to an Inch.

Copied from plan 81 by
James Wood, Surveyor.

ISLE OF MAN GOVERNMENT: GENERAL REGISTRY

ASYLUM PLANS: PARISH OF ARBORY

Originals monotone

1:23

