

ISLE OF MAN GOVERNMENT: GENERAL REGISTRY

ASYLUM PLANS: PARISH OF ANDREAS

Original coloured

1:23

110

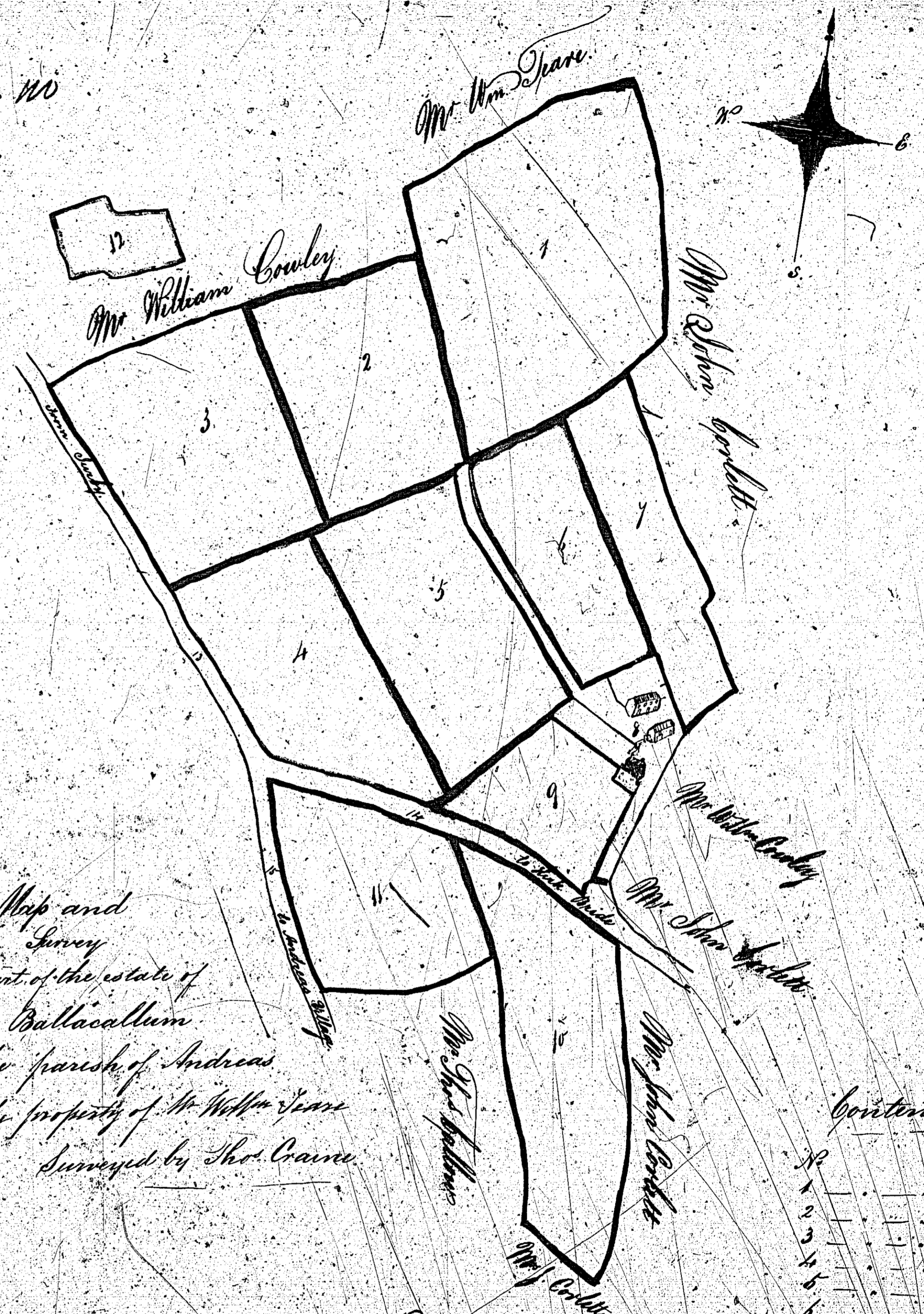

Map and Survey
of a part of the estate of
Ballacallum
in the parish of Andreas
the property of Mr. Wm. Shaw
Surveyed by Tho. Craun

Contents

No.	A.	R.	P.
1	1	2	59
2	3	1	12
3	4	3	9
4	5	2	14
5	4	3	12
6	3	0	19
7	2	3	11
8	1	2	10
9	2	0	8
10	5	1	11
11	5	3	11
12	0	3	11
Roads	2	0	1
Total	32	18	157

116

ISLE OF MAN GOVERNMENT: GENERAL REGISTRY

ASYLUM PLANS: PARISH OF ANDREAS

Original coloured

1:23

M.S.
Map & Survey
of a part of the estate of
Ballacollin
in the parish of Andreas
the property of John Corlett
surveyed by J. Martin

Contents

NR.	A.	R.	P.
1	1	0	2
2	2	0	30
3	1	3	18
4	1	3	14
5	3	0	26
6	3	3	33
7	1	2	34
8	3	2	34
9	2	1	39
10	0	3	10
11	1	1	34
12	1	0	14
Total			25 1 14

(J.C.)

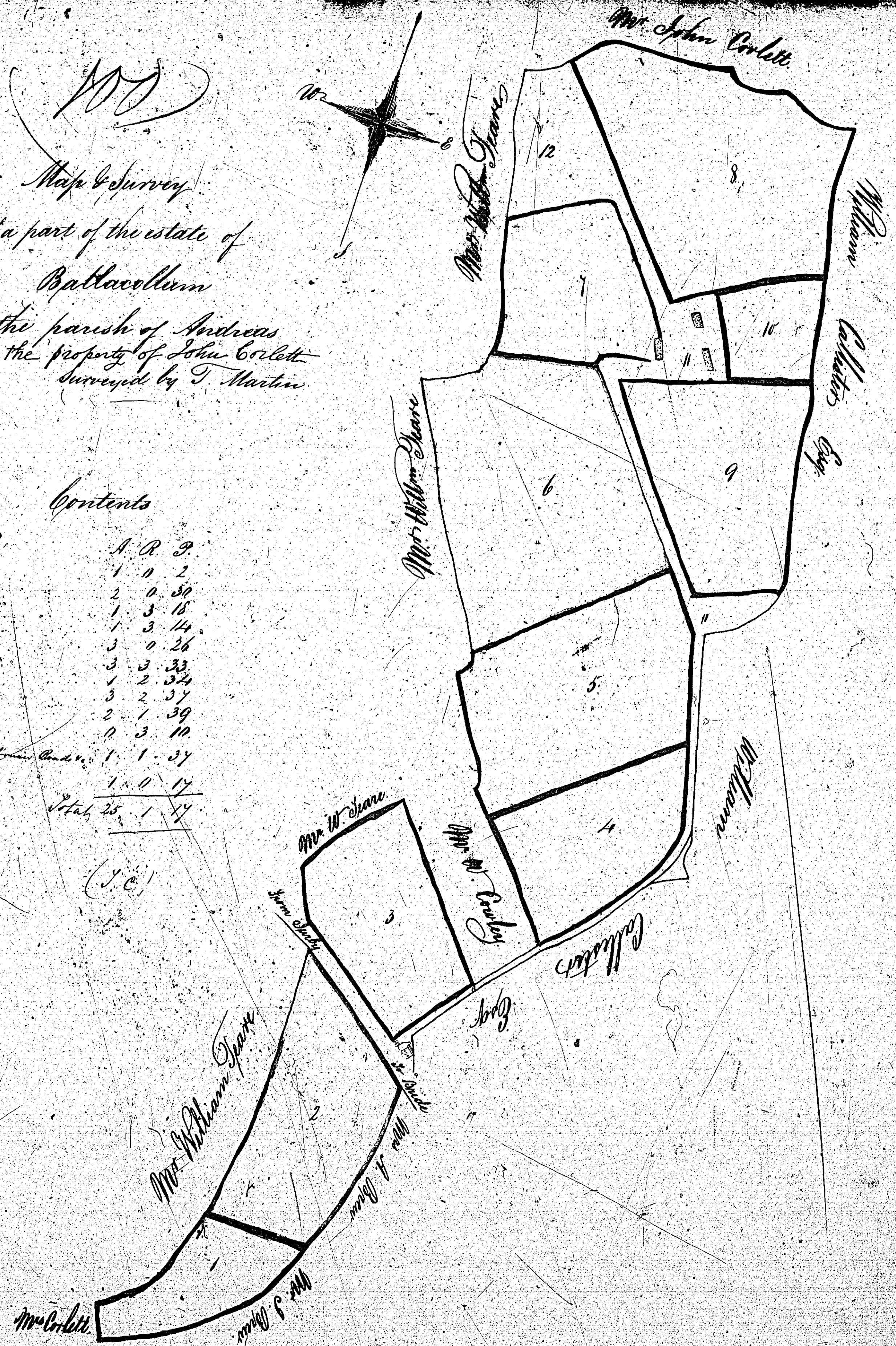

The following two
plans are both
numbered
101

ISLE OF MAN GOVERNMENT: GENERAL REGISTRY

ASYLUM PLANS: PARISH OF ANDREAS

Original monotone

1:23

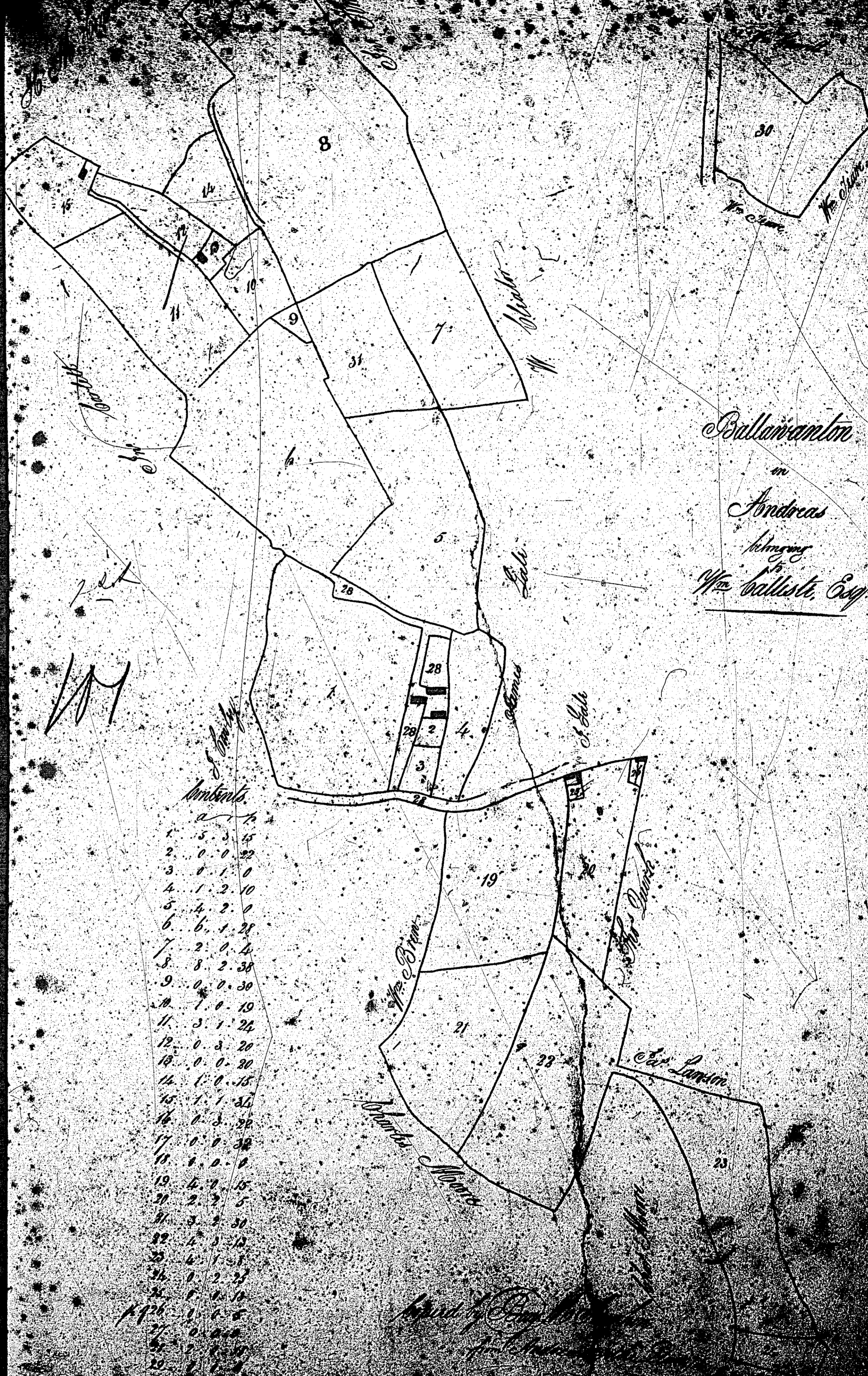

ISLE OF MAN GOVERNMENT: GENERAL REGISTRY

ASYLUM PLANS: PARISH OF ANDREAS

Original monotone

1:23

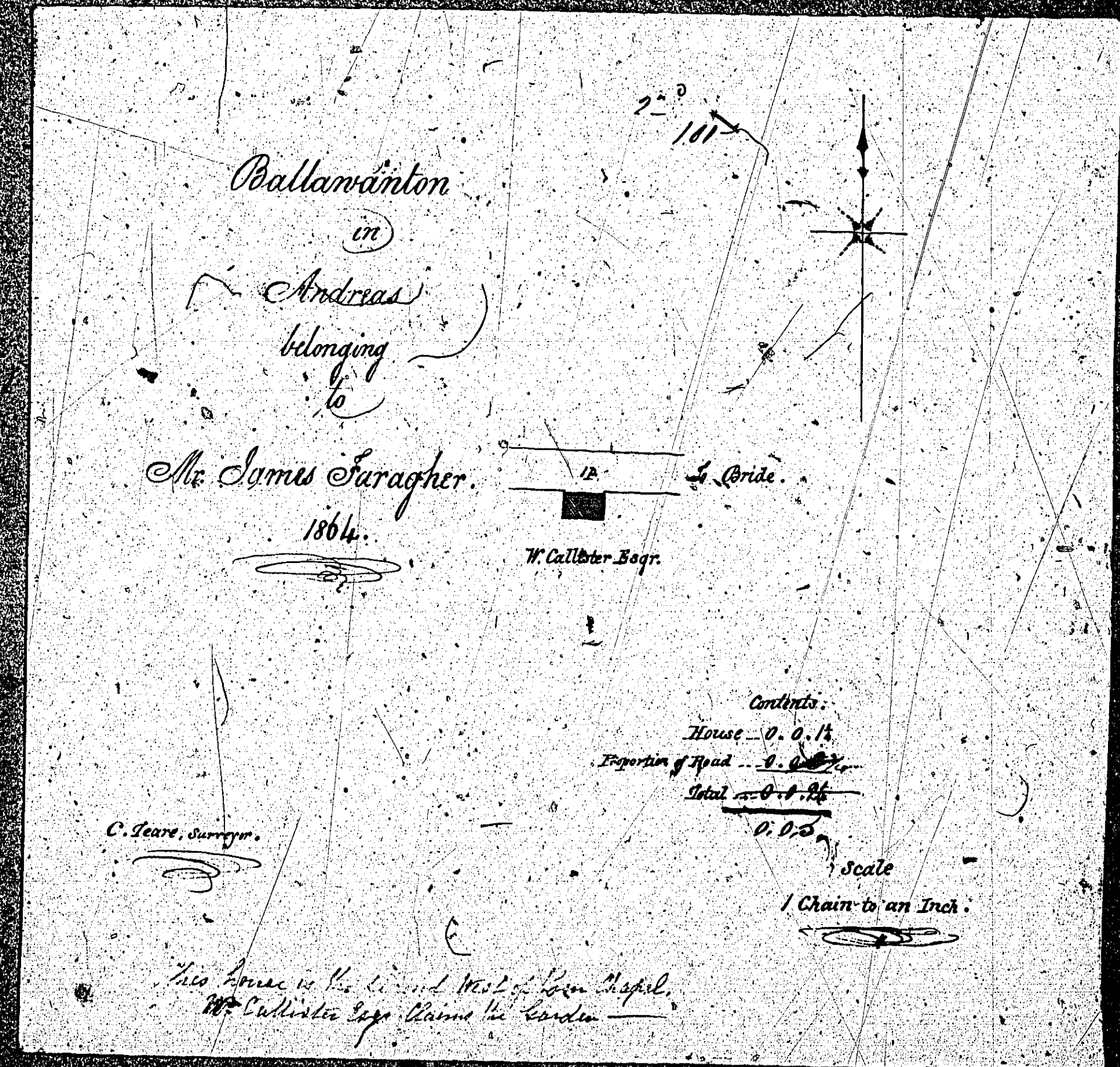

ISLE OF MAN GOVERNMENT: GENERAL REGISTRY

ASYLUM PLANS: PARISH OF ANDREAS

Original monotone

1:23

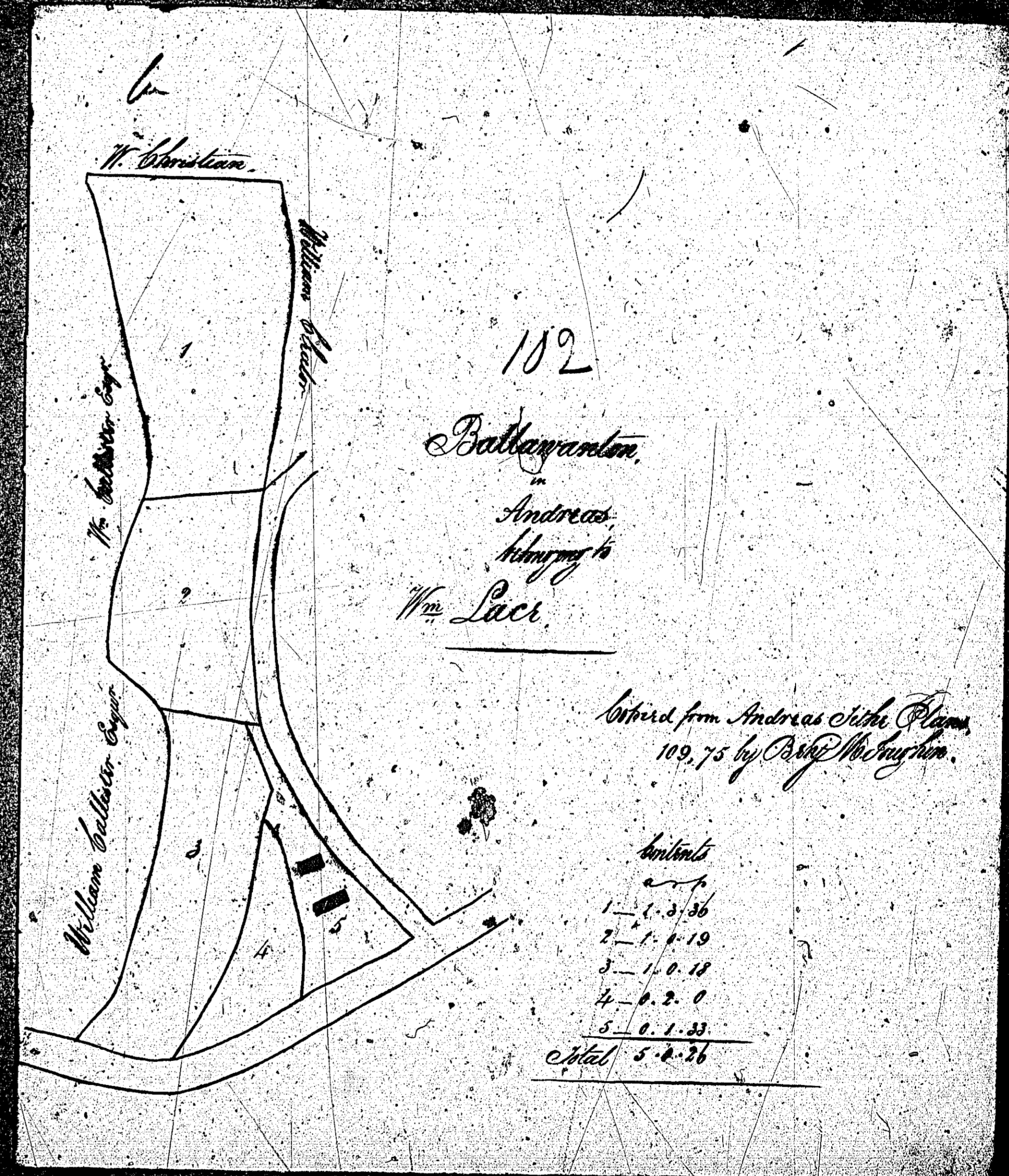

Plan 107 is bound
out of sequence
with plans
103 and 104

ISLE OF MAN GOVERNMENT: GENERAL REGISTRY

ASYLUM PLANS: PARISH OF ANDREAS

Originals monotone

1:23

