

Registered Plans 1833-1982

Overview

The Isle of Man Rolls Office was often used as a store house for important Government documents. One such series was the Registered Plans. These maps and plans depict topography, proposed buildings or other elements of infrastructure described and sanctioned by Tynwald legislation. The purpose of registering them with the Rolls Office was two-fold: to enable public access and to preserve an authenticated document. When the Rolls Office became the General Registry in 1965, it continued this function.

1) The Registered Plans

Some of the earliest registered plans were created in connection with the 1852 Towns Act, and provide a visual definition of Douglas, Peel, Ramsey and Castletown.

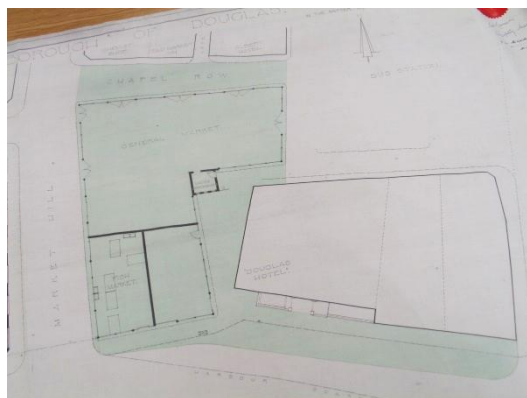

This series also includes (but is not limited to) plans connected to the following legislation:

- Property Act 1869
- Peel Town Act signed 1883
- Castletown Waterworks Act 1884
- Douglas Town Improvement Acts 1889 and 1891
- Upper Douglas Tramway Act 1895
- Laxey Water Act 1909
- Land Drainage Act 1934

Detail of A43/161 depicting the General Market in Douglas

Other infrastructure projects that did not necessarily have a legislative basis were also registered in the Rolls Office/General Registry as a way of enabling public consultation. There are also a few plans that were deposited because they were referred to in High Court Judgments.

2) Why the Registered Plans are Useful

As well as providing definitive snapshots of specific buildings and infrastructure elements sanctioned for construction by Tynwald, the Registered Plans can provide an insight into the history of the topography and land use of the Isle of Man.

They also reflect political involvement in the development of the Island's towns and transport and amenities infrastructure.

3) Accessing the Registered Plans

Most of the registered plans are available for consultation at the Public Record Office. A small number are too fragile to be served to the public.

As some of the Public Record Office records are held on a separate site, it is advised that a prior appointment is made before visiting, so that any required records can be located ahead of time.

4) Contact Us

We welcome enquiries relating to any aspect of the information given in this factsheet. To ask us any questions or to arrange an appointment, please contact our public enquiries service on 01624 693569 or email us at public.records@gov.im. For more information about visiting the IOMPRO, including our opening hours and identification requirements, please see our service guide: www.gov.im/pro.