

Notizen
17

Notizen

41

2. 41
Teil d. Insel
Baltisches
Schiffung
N. Daniel Hennich



Supplement

N ^o	A	B	P
1	1	1	12
2	3	6	16
3	1	2	14
4	3	1	21
5	3	1	10
6		2	33
7	4	1	15
8	3	2	14
Sum			19 3 28



Notizen
18

4-2

Plan and Survey
of the
St. Peter's Estate
commonly called
Grainy, Moor
Parish of St. Anne,
property of
Mrs. Anne Leese.

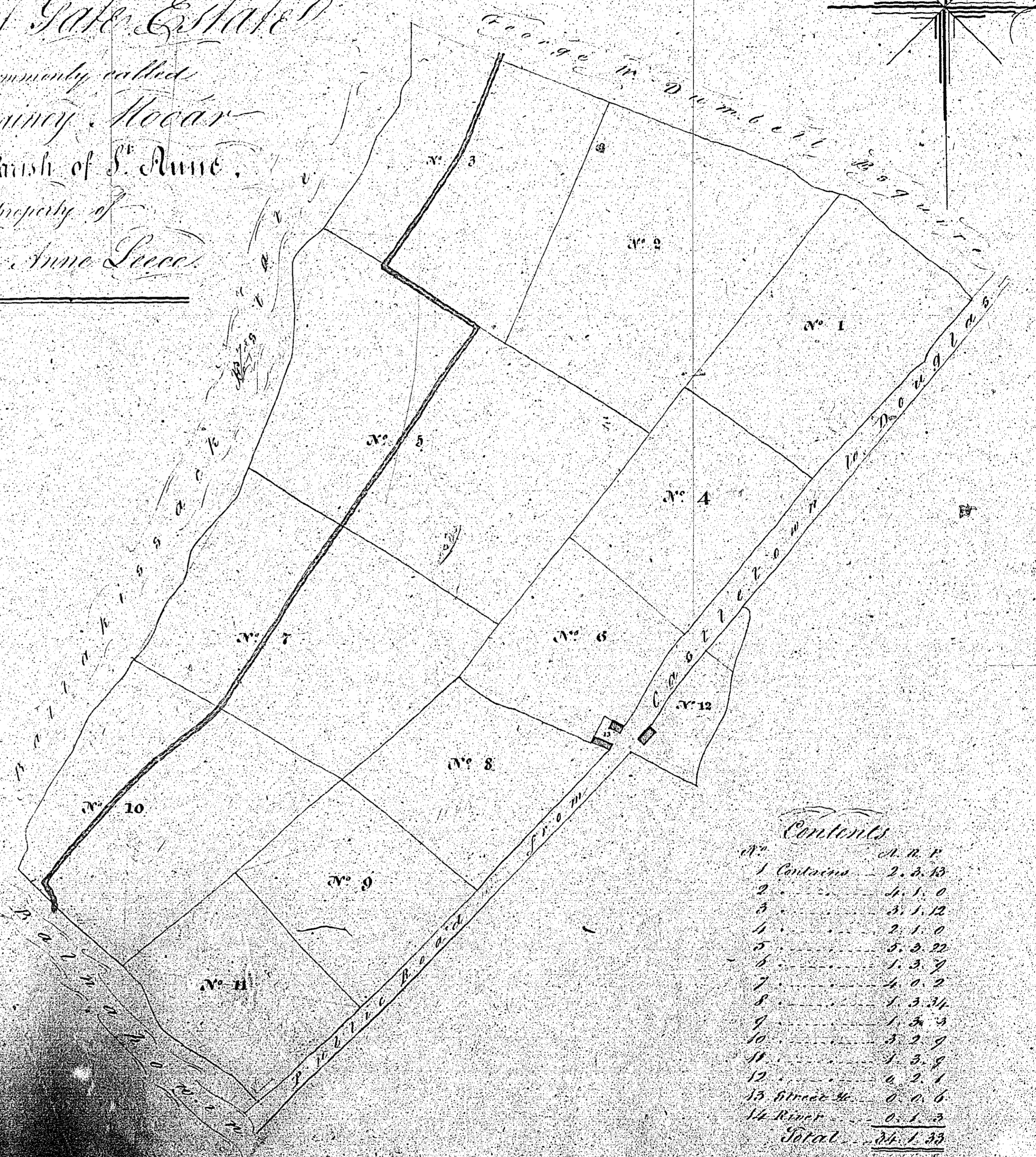
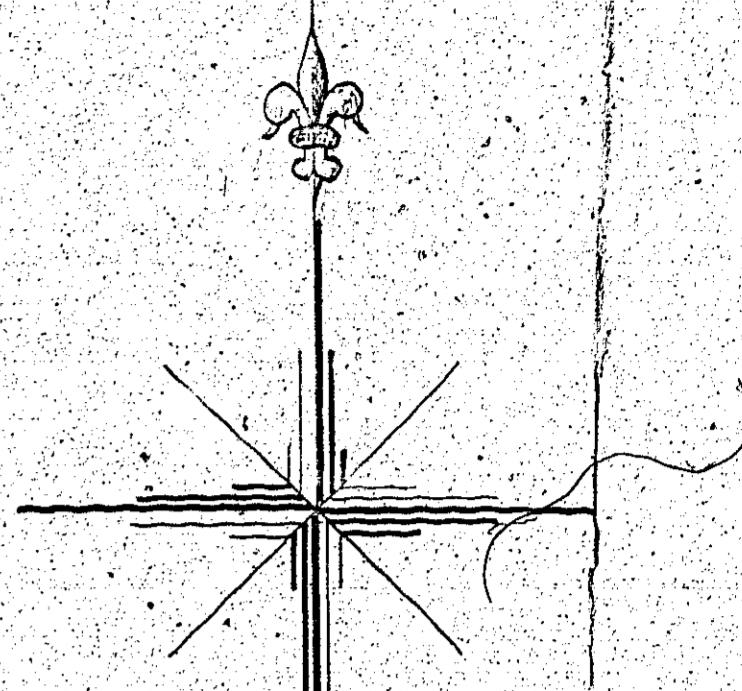

Contents

No. 1	2. 5. 13
2	3. 1. 0
3	3. 1. 12
4	2. 1. 0
5	3. 3. 22
6	1. 3. 7
7	4. 0. 2
8	1. 3. 34
9	1. 5. 5
10	3. 2. 9
11	1. 3. 9
12	0. 2. 1
13 Street	0. 0. 6
14 River	0. 1. 3
Total	34. 1. 33

Scale 2 Chains to an Inch

Thos. Cook Surveyor 1839.

Plan and Survey

of the Estate of
Cronk-freie
 in the Parish of Saint Anne,

THE PROPERTY OF

M^{rs} Anne Leeces

Hon. Col. Murray

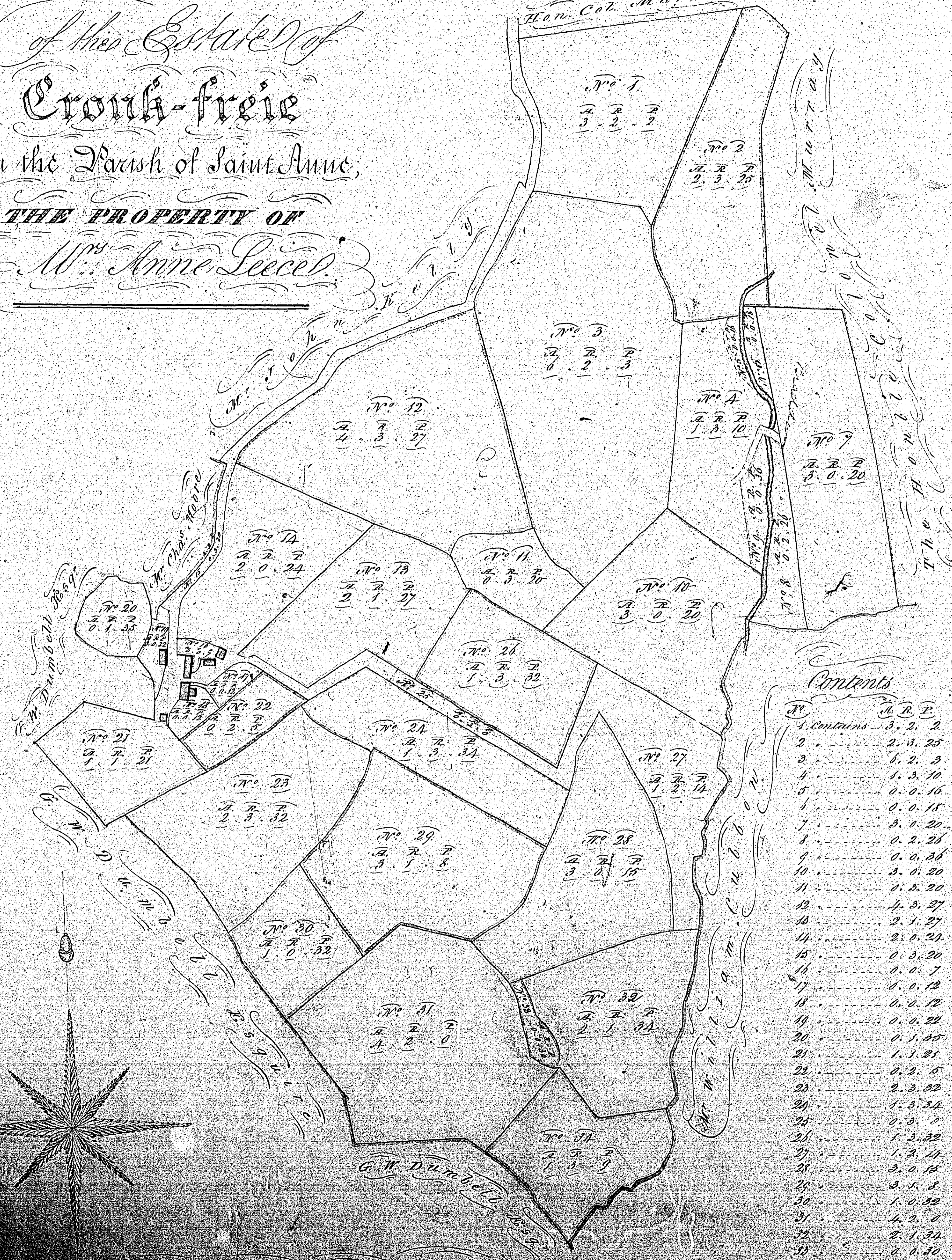

Contents

No.	A. B. C.
1. Containd	3. 2. 2.
2	2. 3. 25
3	6. 2. 3
4	1. 3. 10
5	0. 0. 16
6	0. 0. 18
7	3. 0. 20 Prescription
8	0. 2. 26
9	0. 0. 36
10	3. 0. 20
11	0. 5. 20
12	4. 3. 27
13	2. 1. 27
14	2. 0. 24
15	0. 3. 20
16	0. 0. 7
17	0. 0. 12
18	0. 0. 12
19	0. 0. 22
20	0. 5. 50
21	1. 1. 25
22	0. 2. 5
23	2. 3. 32
24	1. 5. 34
25	0. 3. 0
26	1. 3. 32
27	1. 3. 14
28	3. 0. 18
29	3. 1. 8
30	1. 0. 32
31	4. 2. 0
32	2. 1. 31
33	0. 0. 30
34	1. 3. 9
Total	41. 3. 8

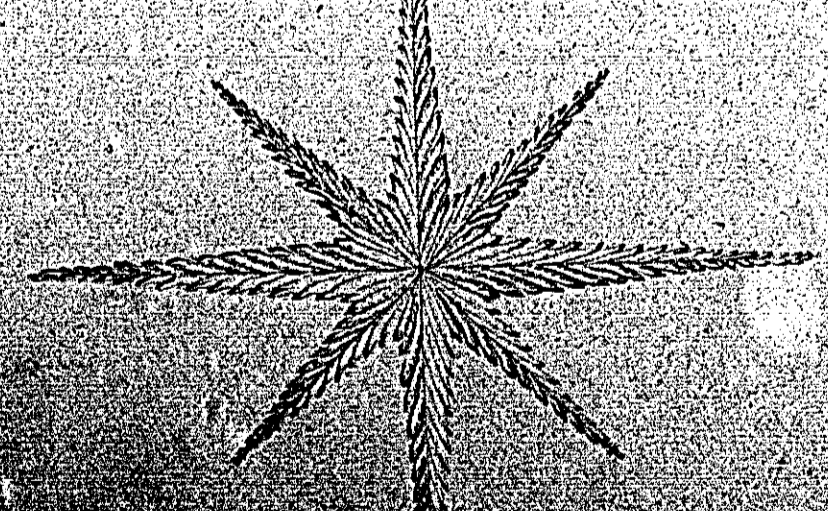

G. W. Dundell

G. W. Dundell

Per Arch. Surveyor 1839

A. B. Murray

44

PLAN AND SURVEY OF OATLAND ESTATE,

IN THE PARISH OF ST ANNE
THE PROPERTY OF F. MATTHEWS ESQ.

October 10th 1850

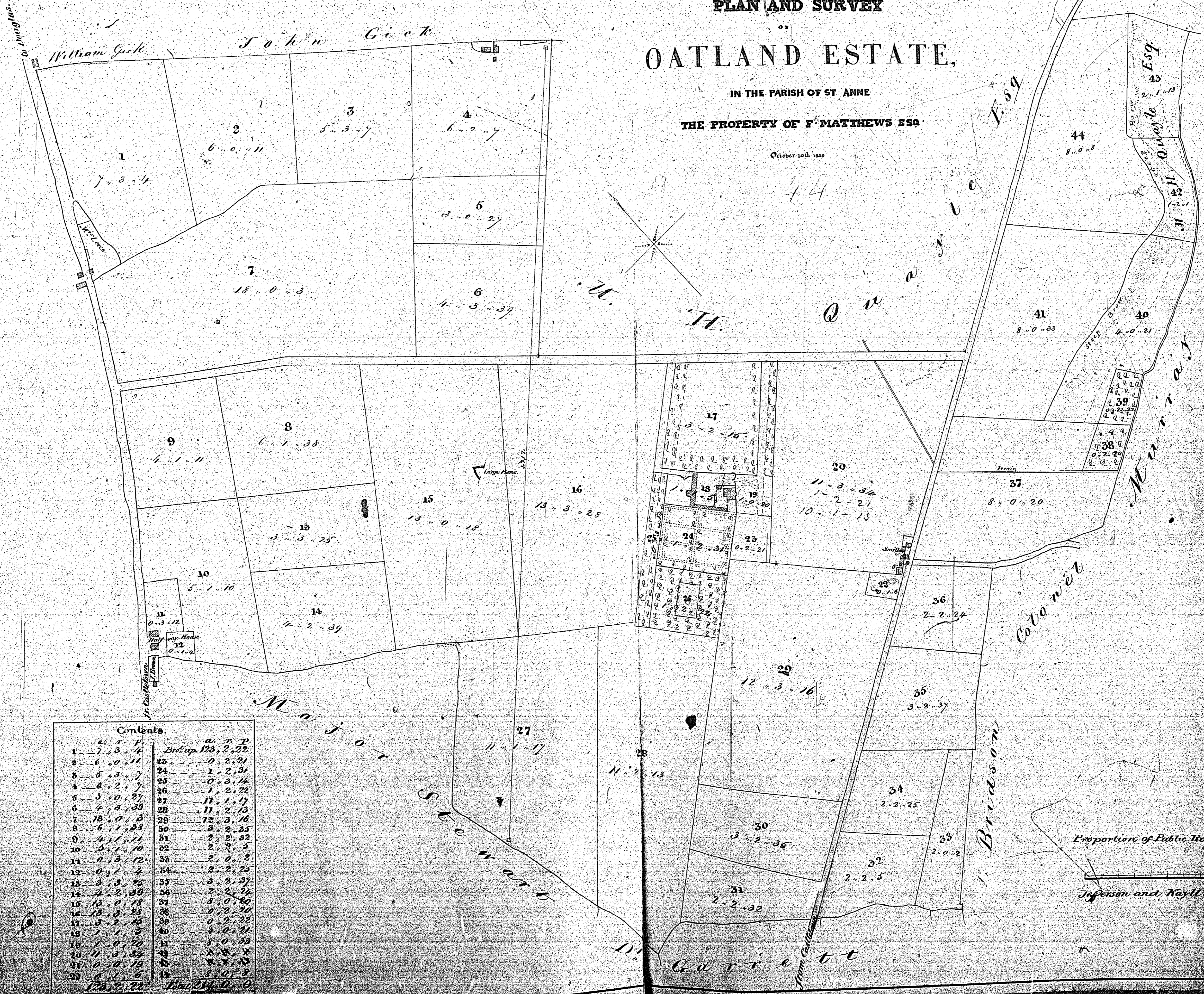

Contents.

Plot No.	Acres	Contents
1	7.3.4	Bro. sup. 123, 2.22
2	6.0.11	0.2.21
3	5.3.7	1.2.13
4	4.2.7	0.2.14
5	3.0.27	1.2.22
6	4.3.39	11.1.17
7	18.0.3	11.2.13
8	6.1.38	12.3.16
9	4.1.11	8.2.35
10	5.1.10	2.2.32
11	0.3.12	2.2.5
12	0.1.4	2.0.2
13	3.3.25	2.2.25
14	4.2.39	8.2.37
15	13.0.18	2.2.34
16	13.3.28	8.0.10
17	3.3.25	0.2.20
18	1.1.5	0.2.22
19	1.0.20	4.0.21
20	11.3.34	3.0.33
21	0.0.19	8.2.3
22	0.1.6	8.0.3
23	12.2.22	12.2.22
24	0.2.21	0.2.21
25	0.2.21	0.2.21
26	0.2.21	0.2.21
27	0.2.21	0.2.21
28	0.2.21	0.2.21
29	0.2.21	0.2.21
30	0.2.21	0.2.21
31	0.2.21	0.2.21
32	0.2.21	0.2.21
33	0.2.21	0.2.21
34	0.2.21	0.2.21
35	0.2.21	0.2.21
36	0.2.21	0.2.21
37	0.2.21	0.2.21
38	0.2.21	0.2.21
39	0.2.21	0.2.21
40	0.2.21	0.2.21
41	0.2.21	0.2.21
42	0.2.21	0.2.21
43	0.2.21	0.2.21
44	0.2.21	0.2.21

Proportion of Public Roads 4, 1, 1/2
 50 Chains
 Jefferson and Kayll Surveyors.

PLAN
 OF
BALLAHOW
 The Estate of
JOHN MOORE ESQ.
 Situate in the Parish of
KK. S. ANTON.
 1840.

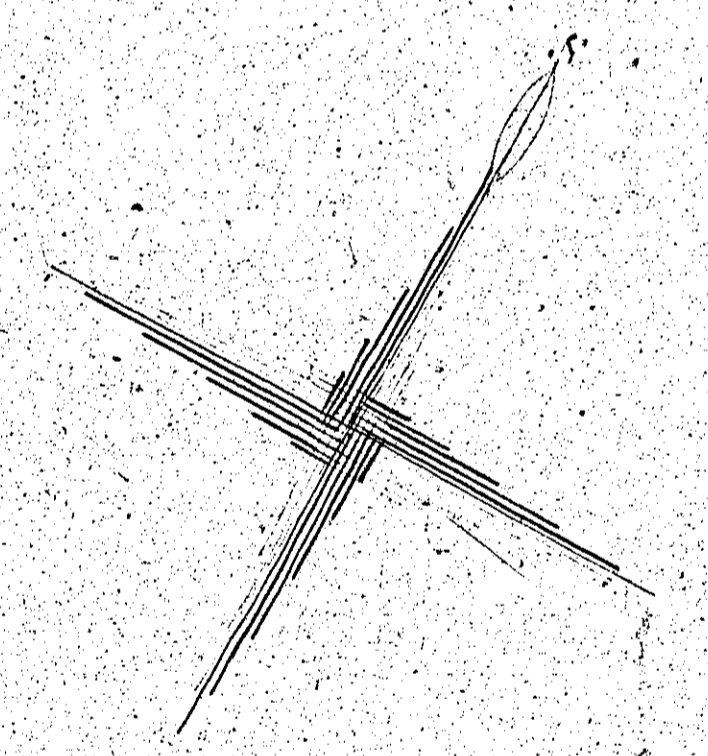

SCALE of CHAINS

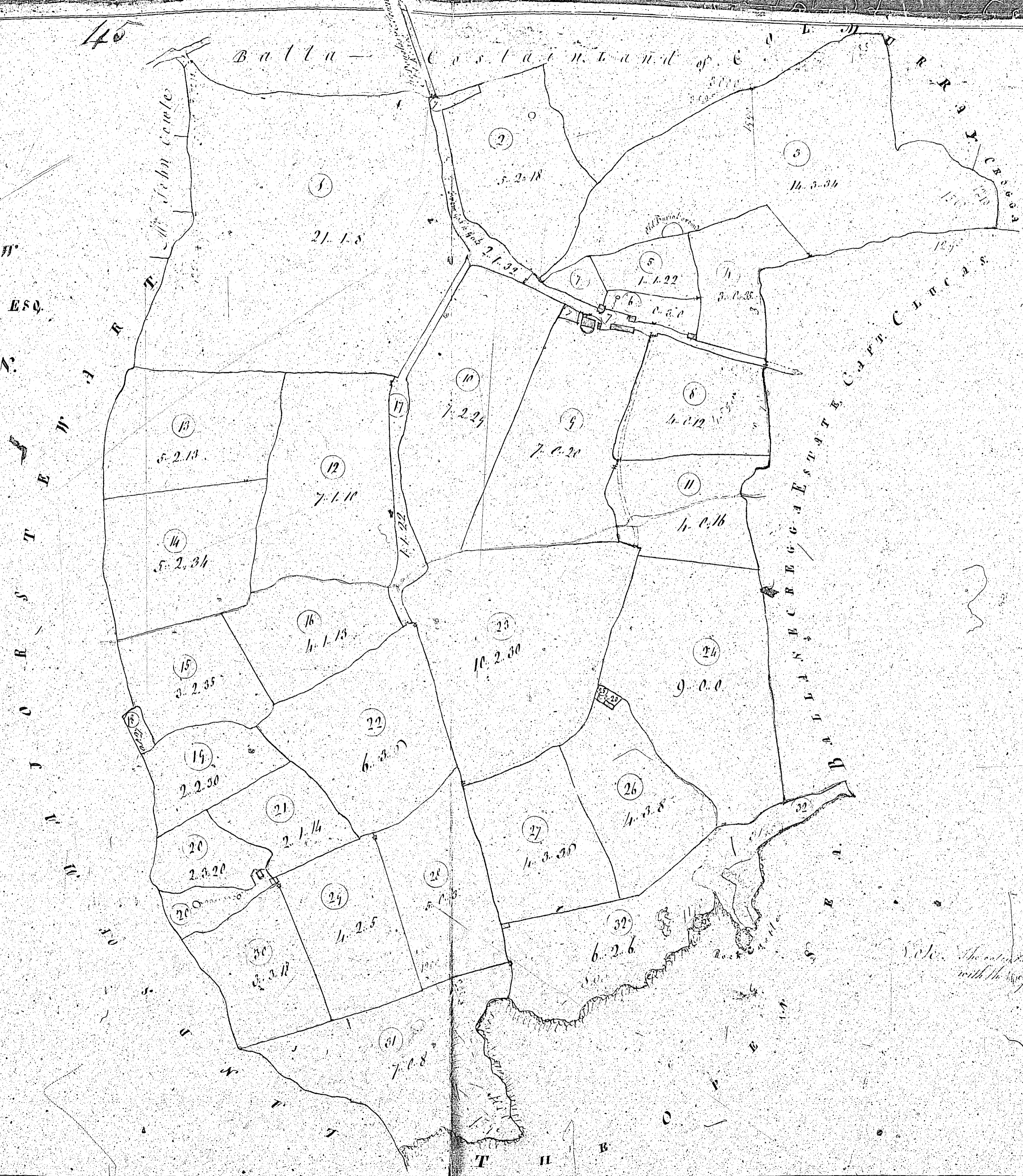

CONTENTS

No.	Description	Acres	Roods	Poles
1		21	1	8
2		5	2	18
3		14	3	34
4		3	0	35
5		5	1	22
6		0	3	0
7	Parson's Garden	2	1	32
8	Office Garden	4	0	12
9		7	0	20
10		7	2	24
11		4	0	16
12		7	1	10
13		5	2	14
14		5	2	34
15		3	2	35
16		4	1	13
17	Curlew's Garden	1	1	22
18	Mill Garden	0	0	27
19		2	2	30
20	College Garden	2	3	26
21		2	1	14
22		6	3	6
23		10	2	30
24		9	0	0
25	Therney	4	3	8
26	College Garden	0	0	20
27		4	3	30
28		4	3	36
29		5	0	3
30		4	2	5
31	Green House	3	3	18
32	Do.	7	0	7
	Total	172	0	24

Note: The calculation of the area is made by the method of the planimeter with the regulation.

Surveyed by J. Moore Esq. 1840.

46
PLAN AND SURVEY
of
BALLACOSTAIN,

In the Parish of St. Anne,
THE PROPERTY OF COL. HERBERT.
JANUARY 1810.

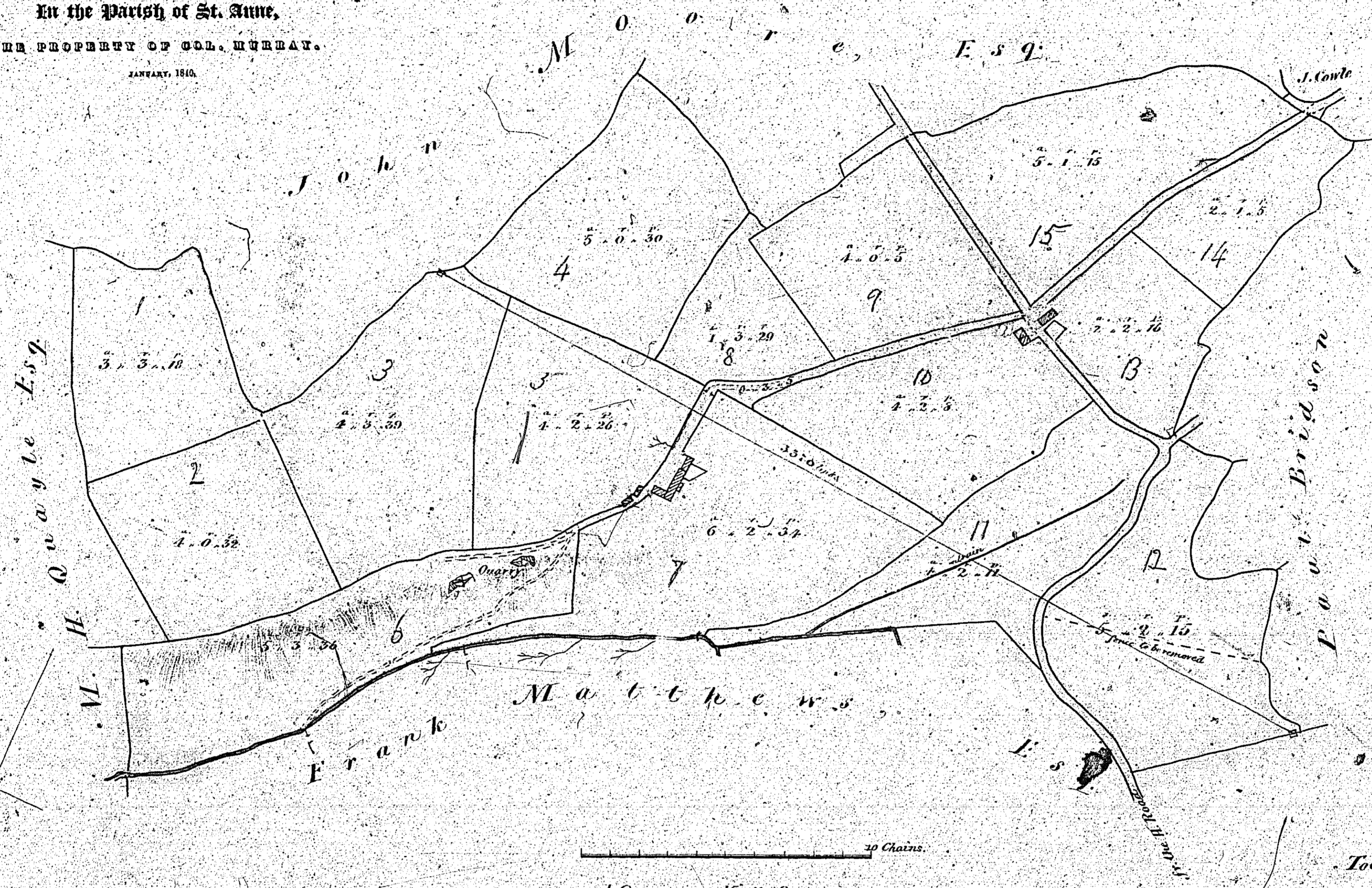

Jefferson and Kayll Surveyors.

Total 67 1/2
Proportion of Occupation Roads 0.3.7

ISLE OF MAN GOVERNMENT: GENERAL REGISTRY

TITHE PLANS: PARISH OF SANTON

Original coloured

1:30