

*Plan*  
 of  
**B. ALLAKISSACK**  
 The Estates of  
**MR. JOHN KISSACK**  
 Situate in the Parish of  
**KIRK-SAYTOA**  
 Within the  
**Isle of Man.**  
 1838.  
 by J. Parris.

**REFERENCE**

Names and Contents	A	R	P
A Oat Field	1	0	0
B Glen Kern	0	1	50
C Crank Field	7	2	50
D High Groye	5	3	50
E Middle Groye	0	3	50
F Large Groye	11	1	8
G Upper Groye	0	2	5
H Hill Groye Road	0	3	18
I Bread a ware of out Road	7	2	50
K Hill Field & half Road	7	1	5
L Home stall, West yard, garden	1	1	50
N East Side Lanch & half Road	4	2	50
O The Wood	1	2	55
P Middle Flat	4	0	0
Q West Side & half Road	5	3	55
R The Large allotment	6	0	58
S Groye & half Road	4	0	52
T Crank Field & Road	4	1	25
V Large Field & Road	6	0	18
W The Groye & Road	5	0	2
X Villa-Corran	4	1	54
Y The Wood	5	2	0
Z River Meadow & half Road	4	0	20
Total	122	0	25

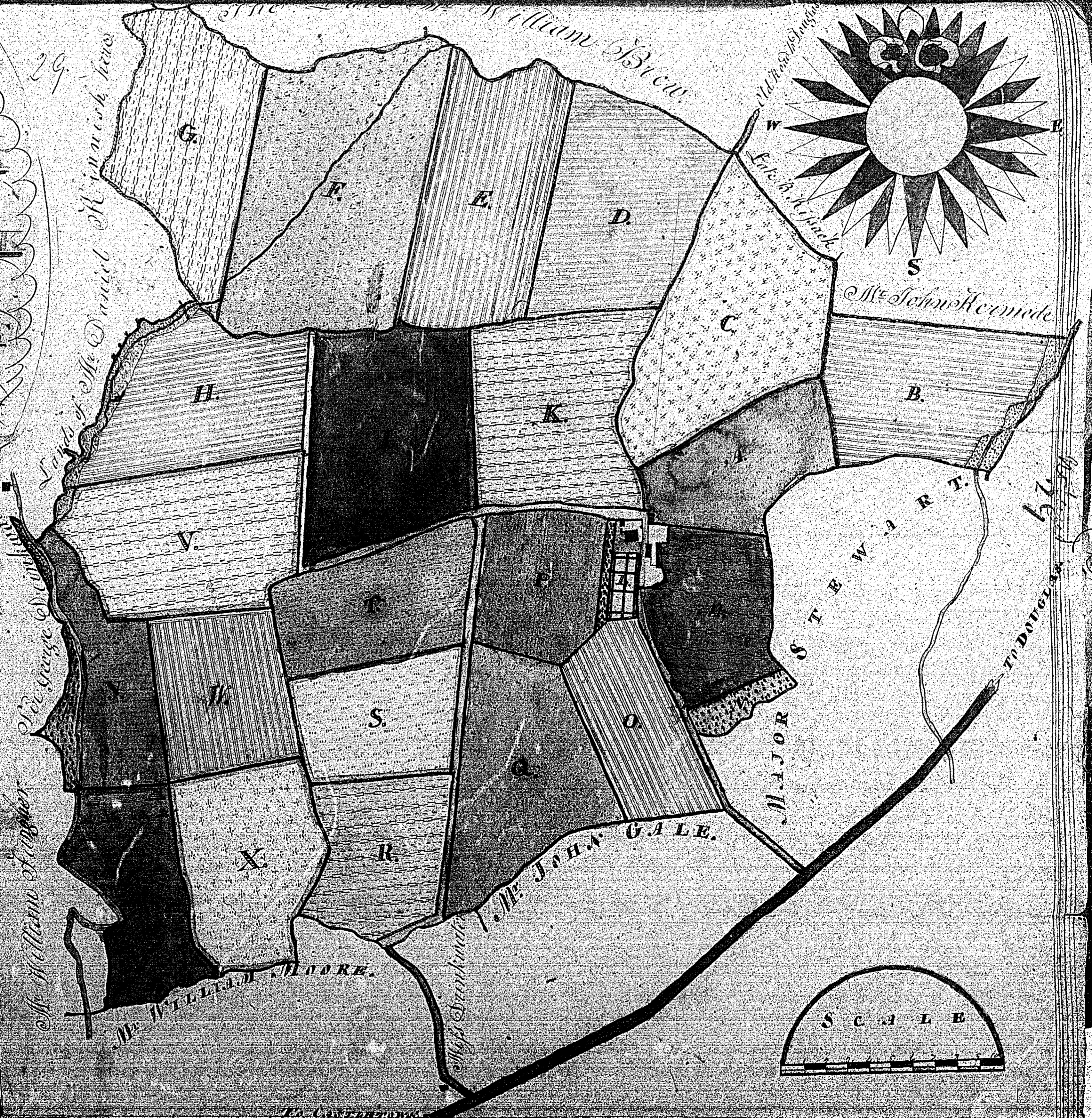

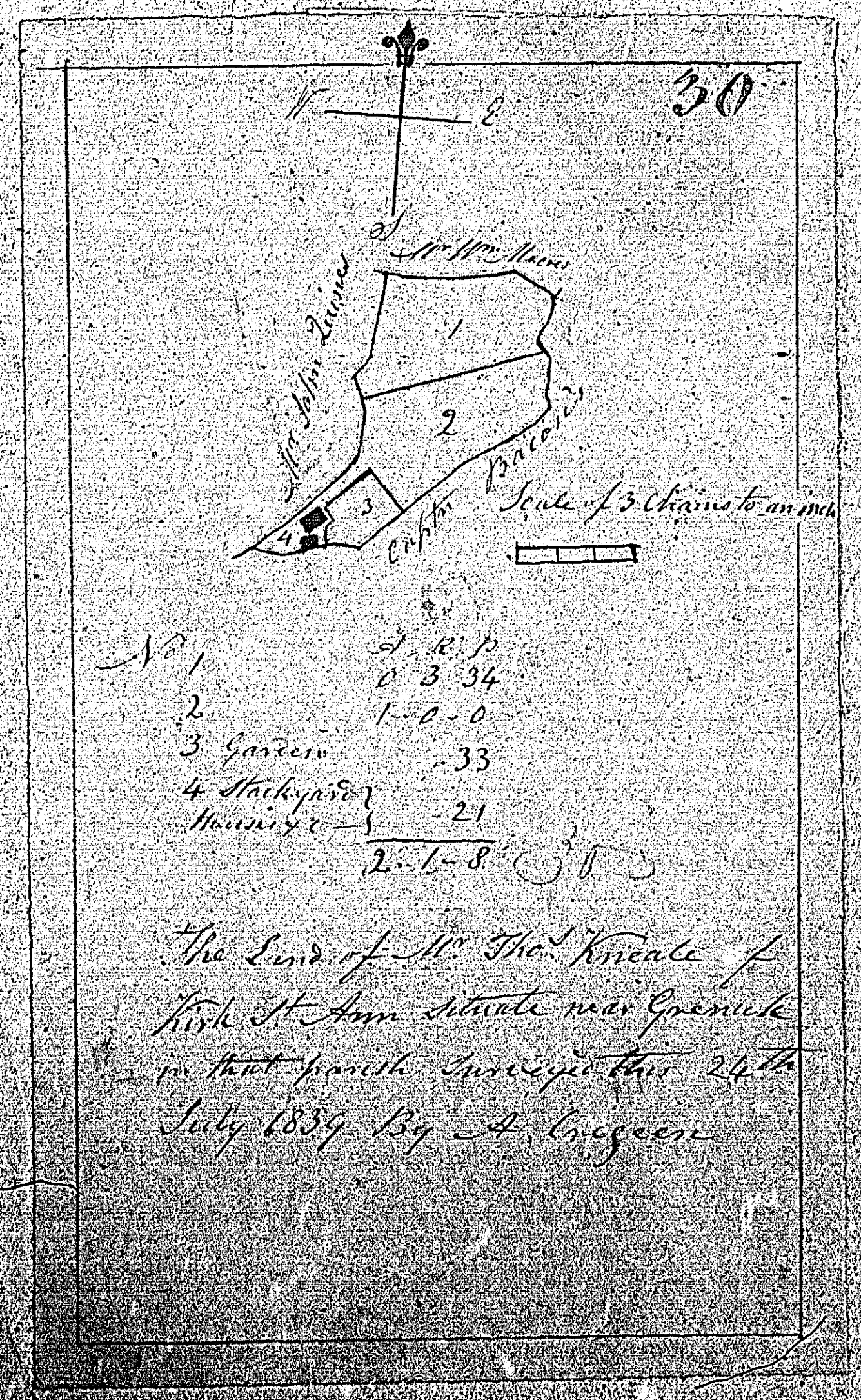

No 1	A. R. P.
2	0 3 34
3 Garden	1 0 0
4 Stackyard	0 33
House	0 21
	<hr/>
	2 1 8

The Land of Mr. Tho. Kneale of  
 Kirk St Ann Street near Granick  
 in that parish surveyed this 24th  
 July 1834 By A. Crogeen

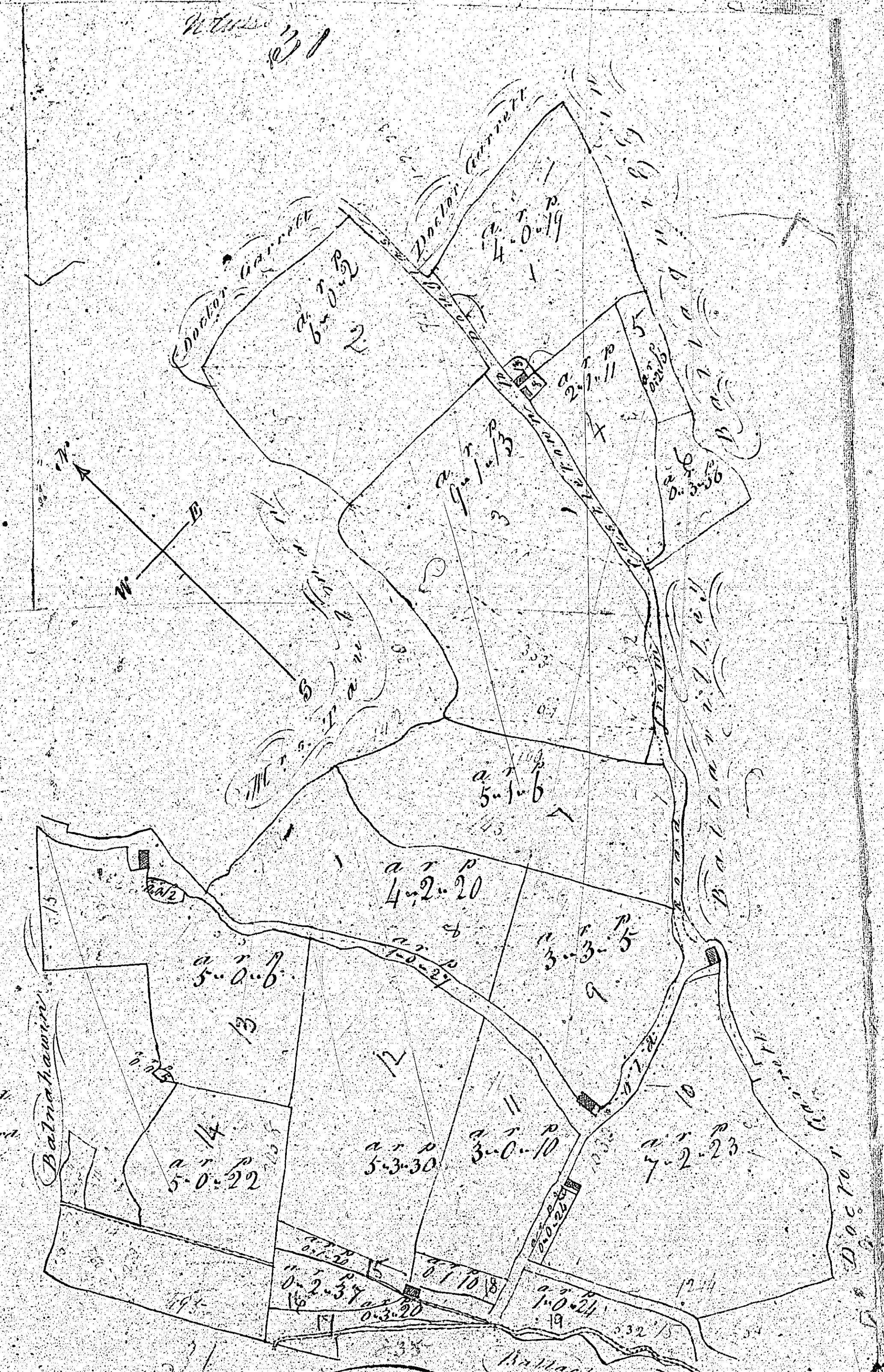

- 1.00
- 1.10
- 1.20
- 1.30
- 1.40
- 1.50
- 2.00
- 2.10
- 2.20
- 2.30
- 2.40
- 2.50
- 3.00
- 3.10
- 3.20
- 3.30
- 3.40
- 3.50
- 4.00
- 4.10
- 4.20
- 4.30
- 4.40
- 4.50
- 5.00
- 5.10
- 5.20
- 5.30
- 5.40
- 5.50
- 6.00
- 6.10
- 6.20
- 6.30
- 6.40
- 6.50
- 7.00
- 7.10
- 7.20
- 7.30
- 7.40
- 7.50
- 8.00
- 8.10
- 8.20
- 8.30
- 8.40
- 8.50
- 9.00
- 9.10
- 9.20
- 9.30
- 9.40
- 9.50
- 10.00
- 10.10
- 10.20
- 10.30
- 10.40
- 10.50
- 11.00
- 11.10
- 11.20
- 11.30
- 11.40
- 11.50
- 12.00
- 12.10
- 12.20
- 12.30
- 12.40
- 12.50
- 13.00
- 13.10
- 13.20
- 13.30
- 13.40
- 13.50
- 14.00
- 14.10
- 14.20
- 14.30
- 14.40
- 14.50
- 15.00
- 15.10
- 15.20
- 15.30
- 15.40
- 15.50
- 16.00
- 16.10
- 16.20
- 16.30
- 16.40
- 16.50
- 17.00
- 17.10
- 17.20
- 17.30
- 17.40
- 17.50
- 18.00
- 18.10
- 18.20
- 18.30
- 18.40
- 18.50
- 19.00
- 19.10
- 19.20
- 19.30
- 19.40
- 19.50
- 20.00
- 20.10
- 20.20
- 20.30
- 20.40
- 20.50
- 21.00
- 21.10
- 21.20
- 21.30
- 21.40
- 21.50
- 22.00
- 22.10
- 22.20
- 22.30
- 22.40
- 22.50
- 23.00
- 23.10
- 23.20
- 23.30
- 23.40
- 23.50
- 24.00
- 24.10
- 24.20
- 24.30
- 24.40
- 24.50
- 25.00
- 25.10
- 25.20
- 25.30
- 25.40
- 25.50
- 26.00
- 26.10
- 26.20
- 26.30
- 26.40
- 26.50
- 27.00
- 27.10
- 27.20
- 27.30
- 27.40
- 27.50
- 28.00
- 28.10
- 28.20
- 28.30
- 28.40
- 28.50
- 29.00
- 29.10
- 29.20
- 29.30
- 29.40
- 29.50
- 30.00
- 30.10
- 30.20
- 30.30
- 30.40
- 30.50
- 31.00
- 31.10
- 31.20
- 31.30
- 31.40
- 31.50
- 32.00
- 32.10
- 32.20
- 32.30
- 32.40
- 32.50
- 33.00
- 33.10
- 33.20
- 33.30
- 33.40
- 33.50
- 34.00
- 34.10
- 34.20
- 34.30
- 34.40
- 34.50
- 35.00
- 35.10
- 35.20
- 35.30
- 35.40
- 35.50
- 36.00
- 36.10
- 36.20
- 36.30
- 36.40
- 36.50
- 37.00
- 37.10
- 37.20
- 37.30
- 37.40
- 37.50
- 38.00
- 38.10
- 38.20
- 38.30
- 38.40
- 38.50
- 39.00
- 39.10
- 39.20
- 39.30
- 39.40
- 39.50
- 40.00
- 40.10
- 40.20
- 40.30
- 40.40
- 40.50
- 41.00
- 41.10
- 41.20
- 41.30
- 41.40
- 41.50
- 42.00
- 42.10
- 42.20
- 42.30
- 42.40
- 42.50
- 43.00
- 43.10
- 43.20
- 43.30
- 43.40
- 43.50
- 44.00
- 44.10
- 44.20
- 44.30
- 44.40
- 44.50
- 45.00
- 45.10
- 45.20
- 45.30
- 45.40
- 45.50
- 46.00
- 46.10
- 46.20
- 46.30
- 46.40
- 46.50
- 47.00
- 47.10
- 47.20
- 47.30
- 47.40
- 47.50
- 48.00
- 48.10
- 48.20
- 48.30
- 48.40
- 48.50
- 49.00
- 49.10
- 49.20
- 49.30
- 49.40
- 49.50
- 50.00
- 50.10
- 50.20
- 50.30
- 50.40
- 50.50
- 51.00
- 51.10
- 51.20
- 51.30
- 51.40
- 51.50
- 52.00
- 52.10
- 52.20
- 52.30
- 52.40
- 52.50
- 53.00
- 53.10
- 53.20
- 53.30
- 53.40
- 53.50
- 54.00
- 54.10
- 54.20
- 54.30
- 54.40
- 54.50
- 55.00
- 55.10
- 55.20
- 55.30
- 55.40
- 55.50
- 56.00
- 56.10
- 56.20
- 56.30
- 56.40
- 56.50
- 57.00
- 57.10
- 57.20
- 57.30
- 57.40
- 57.50
- 58.00
- 58.10
- 58.20
- 58.30
- 58.40
- 58.50
- 59.00
- 59.10
- 59.20
- 59.30
- 59.40
- 59.50
- 60.00
- 60.10
- 60.20
- 60.30
- 60.40
- 60.50
- 61.00
- 61.10
- 61.20
- 61.30
- 61.40
- 61.50
- 62.00
- 62.10
- 62.20
- 62.30
- 62.40
- 62.50
- 63.00
- 63.10
- 63.20
- 63.30
- 63.40
- 63.50
- 64.00
- 64.10
- 64.20
- 64.30
- 64.40
- 64.50
- 65.00
- 65.10
- 65.20
- 65.30
- 65.40
- 65.50
- 66.00
- 66.10
- 66.20
- 66.30
- 66.40
- 66.50
- 67.00
- 67.10
- 67.20
- 67.30
- 67.40
- 67.50
- 68.00
- 68.10
- 68.20
- 68.30
- 68.40
- 68.50
- 69.00
- 69.10
- 69.20
- 69.30
- 69.40
- 69.50
- 70.00
- 70.10
- 70.20
- 70.30
- 70.40
- 70.50
- 71.00
- 71.10
- 71.20
- 71.30
- 71.40
- 71.50
- 72.00
- 72.10
- 72.20
- 72.30
- 72.40
- 72.50
- 73.00
- 73.10
- 73.20
- 73.30
- 73.40
- 73.50
- 74.00
- 74.10
- 74.20
- 74.30
- 74.40
- 74.50
- 75.00
- 75.10
- 75.20
- 75.30
- 75.40
- 75.50
- 76.00
- 76.10
- 76.20
- 76.30
- 76.40
- 76.50
- 77.00
- 77.10
- 77.20
- 77.30
- 77.40
- 77.50
- 78.00
- 78.10
- 78.20
- 78.30
- 78.40
- 78.50
- 79.00
- 79.10
- 79.20
- 79.30
- 79.40
- 79.50
- 80.00
- 80.10
- 80.20
- 80.30
- 80.40
- 80.50
- 81.00
- 81.10
- 81.20
- 81.30
- 81.40
- 81.50
- 82.00
- 82.10
- 82.20
- 82.30
- 82.40
- 82.50
- 83.00
- 83.10
- 83.20
- 83.30
- 83.40
- 83.50
- 84.00
- 84.10
- 84.20
- 84.30
- 84.40
- 84.50
- 85.00
- 85.10
- 85.20
- 85.30
- 85.40
- 85.50
- 86.00
- 86.10
- 86.20
- 86.30
- 86.40
- 86.50
- 87.00
- 87.10
- 87.20
- 87.30
- 87.40
- 87.50
- 88.00
- 88.10
- 88.20
- 88.30
- 88.40
- 88.50
- 89.00
- 89.10
- 89.20
- 89.30
- 89.40
- 89.50
- 90.00
- 90.10
- 90.20
- 90.30
- 90.40
- 90.50
- 91.00
- 91.10
- 91.20
- 91.30
- 91.40
- 91.50
- 92.00
- 92.10
- 92.20
- 92.30
- 92.40
- 92.50
- 93.00
- 93.10
- 93.20
- 93.30
- 93.40
- 93.50
- 94.00
- 94.10
- 94.20
- 94.30
- 94.40
- 94.50
- 95.00
- 95.10
- 95.20
- 95.30
- 95.40
- 95.50
- 96.00
- 96.10
- 96.20
- 96.30
- 96.40
- 96.50
- 97.00
- 97.10
- 97.20
- 97.30
- 97.40
- 97.50
- 98.00
- 98.10
- 98.20
- 98.30
- 98.40
- 98.50
- 99.00
- 99.10
- 99.20
- 99.30
- 99.40
- 99.50
- 100.00

Part of the Estate of *Ballakelly* in the Parish of *Saintoline*  
 the Property of *M<sup>r</sup> John Pinnacker*  
 Scale 3 Chains to an Inch. *John Pinnacker Surveyor 1840*

34

There is no plan  
numbered 32

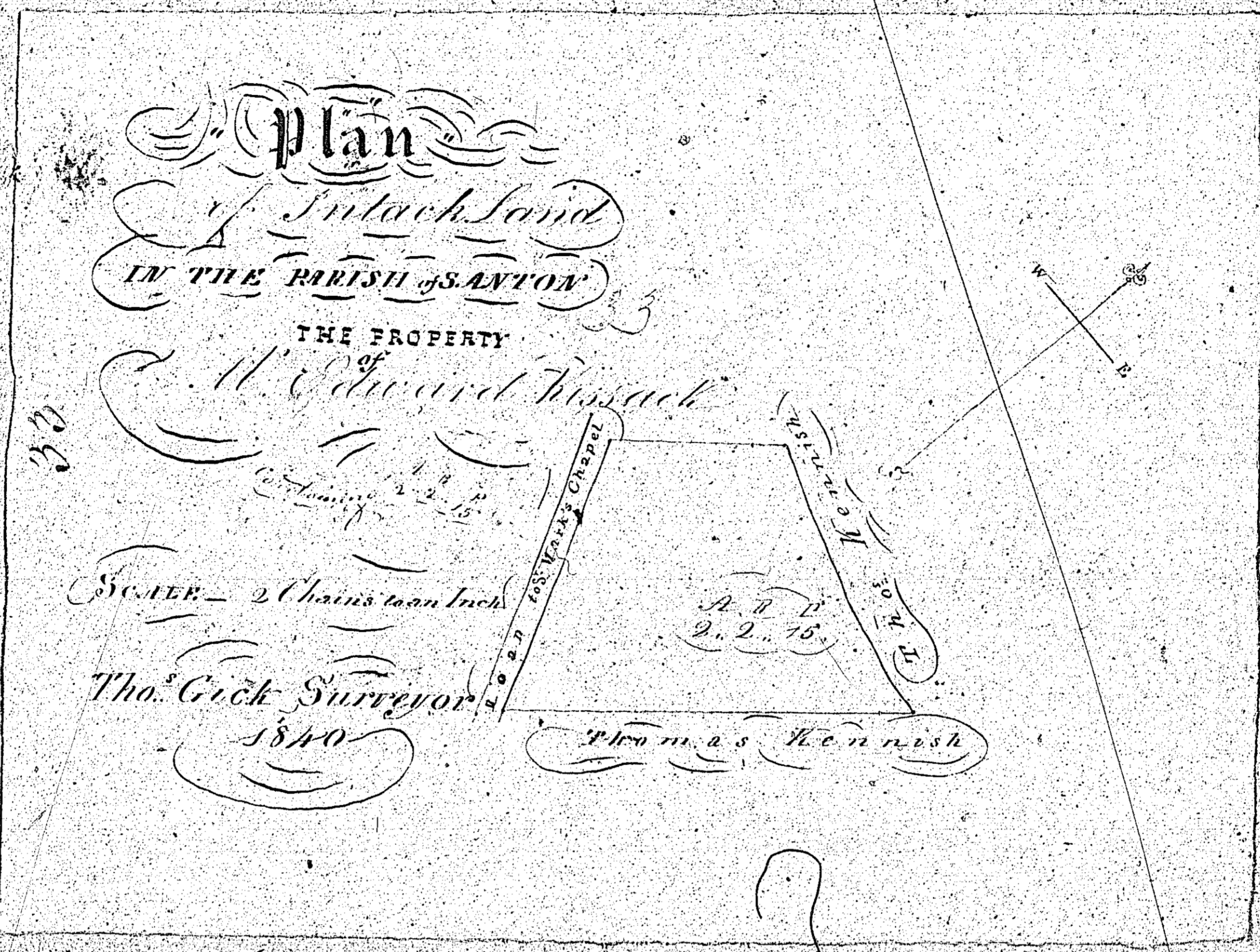

ISLE OF MAN GOVERNMENT: GENERAL REGISTRY

TITHE PLANS: PARISH OF SANTON

Original coloured (decorative), faint

1:30

34

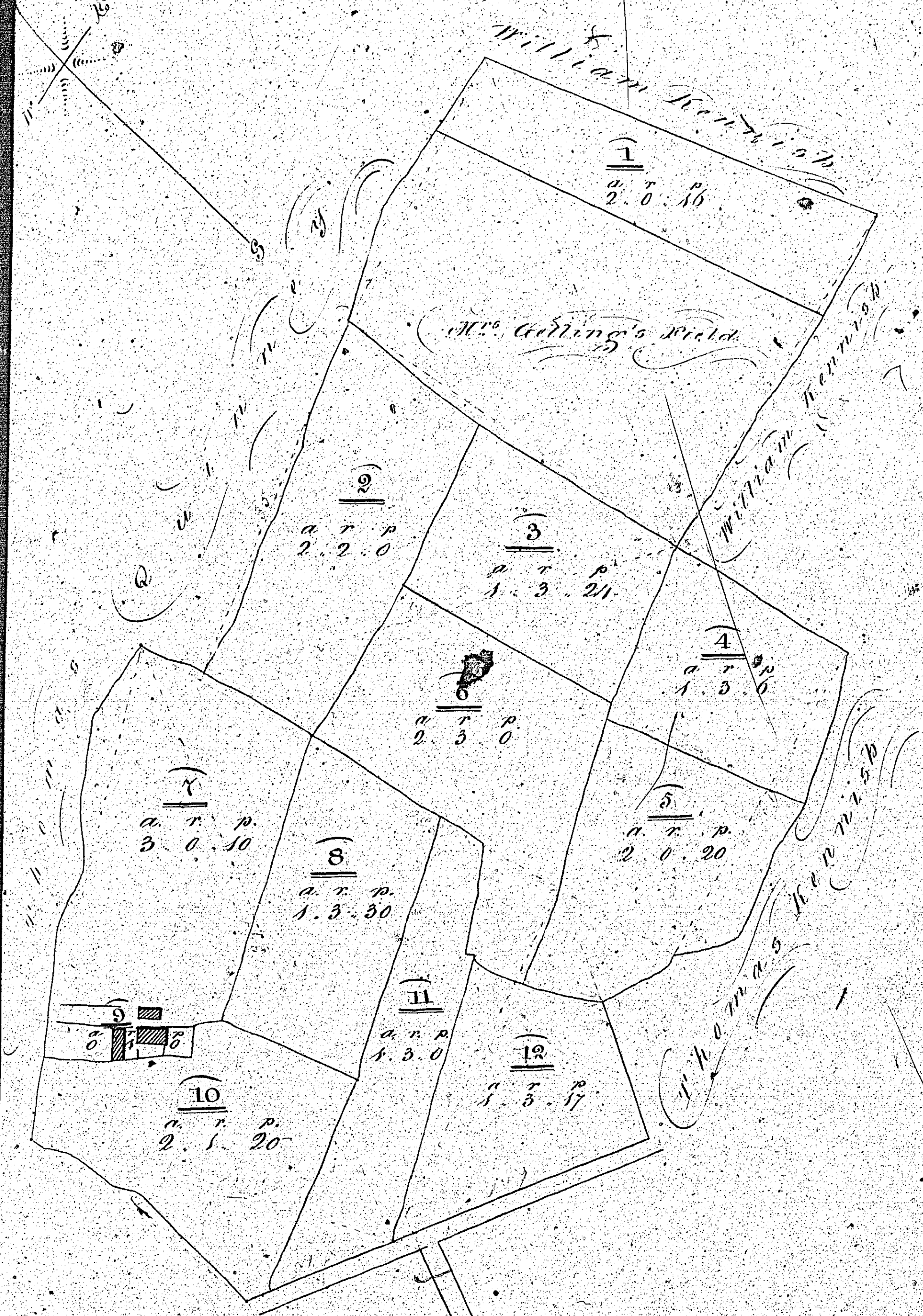

Plan

*of the Rush Estate  
in the Parish of Santon  
being Arable Land  
the property of  
Mr. William Henrichs*

*which area is 2 1/2  
Acres & 1 Rood & 10 Perches*

ISLE OF MAN GOVERNMENT, GENERAL REGISTRY  
TITHE PLANS: PARISH OF SANTON  
Original coloured (decorative) 1:30